

Multi-Purpose Mini EPM Clamp For General Gripping, Tooling & Fixturing



- A smaller version of the Magna Mill.
- Energy saving as electricity is used only for switching on and off.
- High clamping force is supplied by the super powerful NdFeB magnets.
- All metal surface provides stable working area.
- Ideal for quick setup for drilling with top or side clamping.
- Standard model comes with 4 Off-centered rotary pole extension blocks.



- Ideal for drilling applications on bench, pillar and radial drilling machines.
- Pole extension blocks raise the work piece above the chuck to provide clearance for drill through.

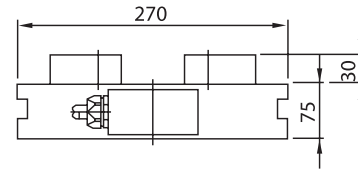
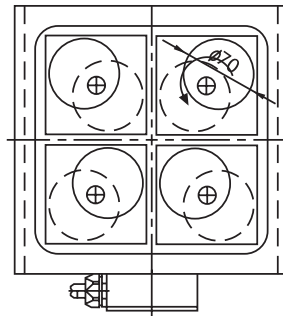

Product Code : EP-MD

All dimensions in metric units

Model No.	L	W	H	H1	P	Dia (D)	Weight (Kgs)
EP-MD220	239	229	60	30	75	50	25
EP-MD160	160	160	55	25	50	30	12

Dimensions are non-binding and can be custom designed. Pole Extension :30 or 50mm dia off-centered counterbore

Due to continuous upgradation in design there could be changes in specification. Other sizes on request. Before ordering, contact Supreme Magnets or your nearest dealer to confirm the suitability of this model for your application.

MAGNA DOUBLE

Quick Setup, Double Sided EPM Clamp For Large Plate Machining And Special Applications



- A special variation of the Magna MaxMill.
- Magnetic Power over 80 MT/SqM.
- Energy saving design : Electricity is required only for ON/OFF.
- Both primary faces are magnetic. The bottom face clamps to the steel platform or machine table. The top face clamps the job.
- Quickest setup time for drilling, welding, or unique clamping applications.
- Flexibility is maximum as the unit can be positioned anywhere on the table with ease.
- Waterproof construction, can be designed for 110/220/440 VAC, 2-15 Amp.



- Mold base machining .
- Radial, bench, pillar drilling applications.
- Large plate welding & machining applications.

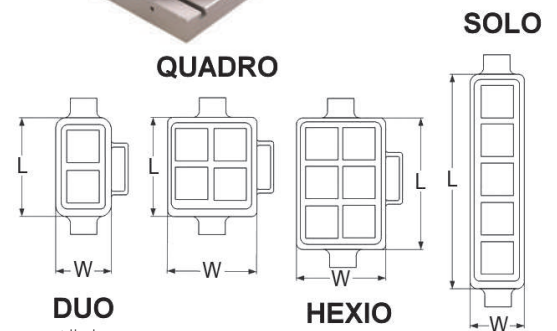
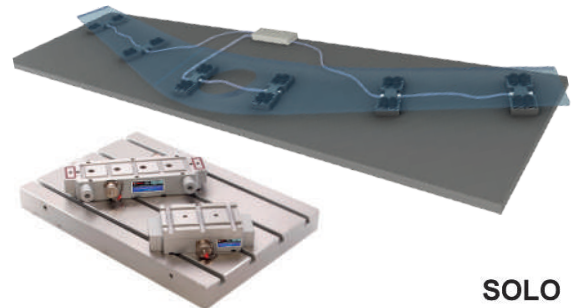

Product Code : EP-MDD

All dimensions in metric units

Model No.	L	W	T	Weight
50 X 50MM SQ POLE			Height without extension block	Weight of the module in Kgs
DUO-50	170	110	50	7
QUADRO-50	170	170	50	10
HEXIO-50	230	170	50	14
SOLO-50	Specify no. of squares	110	50	~
75 X 75MM SQ POLE				
DUO-75	220	135	65	11
QUADRO-75	220	220	65	22
HEXIO-75	305	220	65	31
SOLO-75	Specify no. of squares	135	65	~

Due to continuous upgradation in design there could be changes in specification. Other sizes on request. Before ordering, contact Supreme Magnets or your nearest dealer to confirm the suitability of this model for your application.

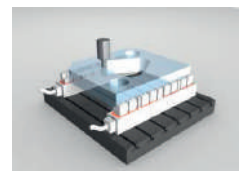
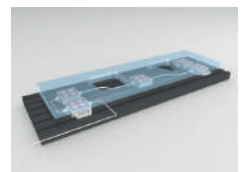

SuperNeo™ Manual Permanent Magnet Lifter Range

GENERAL INFORMATION

The manual permanent magnet Neolifter series is suitable for general purpose loads of both flat and round material. There are 3 models in the series and each are particularly adapted for different load characteristics.



- Safety Factor > 3x Rated Lifting Capacity for ideal conditions.
- State-of-the-art design, compact dimensions with low weight.
- Made with high energy rare earth NdFeB (Neo) magnets.
- Easily transportable, Single hand operating lever with positive spring lock for quick lock and release.



- For handling of steel plates, blocks, rounds, press moulds and loading/unloading in machines.
- Commonly used in machine tools and oxygen cutting operations.
- Can handle finished components without leaving any scratch marks, unlike binding and slinging.
- Can be used with spreader beam hanging multiple magnets for handling long plates/pipes/bars.
- Application temperatures of upto 80 Deg C Max.

Calculation of Lifting Capacity of a Lifting Magnet :- $T \times S \times M \times A \times C \times SWL$

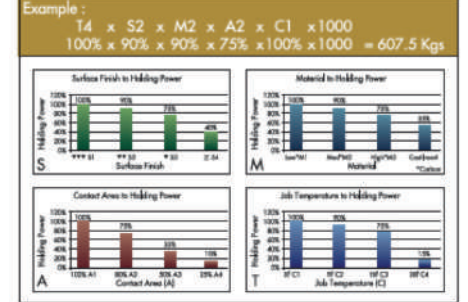

For hot-handling applications of upto 300 DegC, ask for our High temperature version of the P, PR or PF Series.



THICKNESS	(mm)	RATED CAPACITY (Safe Lifting or SWL)							
		5000kg	3000kg	2000kg	1000kg	500kg	300kg	200kg	100kg
T1	70	100%							
T2	60	90%	100%						
T3	50	85%	90%	100%	100%				
T4	45	80%	85%	90%		100%			
T5	40	70%	80%	85%	90%				
T6	35	60%	70%	75%	85%	90%			
T7	30	50%	60%	65%	80%		100%		
T8	25	40%	50%	55%	70%	80%			
T9	20	30%	40%	45%	60%	75%	90%	100%	100%
T10	15	20%	30%	35%	50%	60%	70%	90%	90%
T11	10	10%	20%	25%	35%	45%	50%	70%	70%
T12	5	5%	10%	15%	20%	25%	30%	40%	40%

- Testing plate thickness 55mm
- Lifting capacity depends with - Thickness of load - Roughness of job surface - Hardness of material - Contact area of magnet - Temperature of the load

Tip : Select a suitable model from the Neolifter family depending on the type of your load and consider whether your application suits the manual operation required of these models.

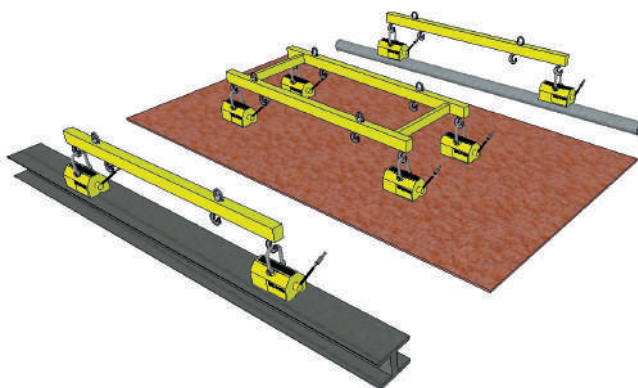

Note : Thin and long ferrous material are not suitable to be lifted by single units of similar capacities of permanent magnetic lifters. In other words, a 2 Ton plate of 9 Meters length cannot be lifted by a single 2 Ton capacity lifter.

TAKE NOTE

When working with the permanent magnet range a few points must be noted.

Factors to Watch Out For : Surface Condition of Workpiece, Temperature, Material property, Contact area and thickness

There is a slight reduction in the lifting capacity due to the quality of surface finish or air gap of the ferrous material due to rust, painting or coating as the pole face does not contact the ferrous material surface due to the quality of surface finish. Similarly, there is a reduction in magnetic force or lifting capacity if the material is at a high temperature in excess of 80 Deg C as the neo magnets are susceptible to high temperatures. Further, there is a reduction in lifting capacity depending on the grade and type of ferrous material; mild steel being the best for magnetic attraction. Equally importantly, full contact of the magnetic pole face area to the workpiece surface is imperative for safe magnetic lifting just as thickness of the ferrous material.

SAFETY FACTOR

To compensate for potential deration of lifting capacity due to the factors above, Supreme Magnets generally adheres to a safety factor of at least 3:1 for all lifting magnets.

PROPERTIES AND DIRECTIONS OF USE :

While the surface condition i.e. the area of contact is very important, in general; a smooth flat surface is good enough. The magnet should always be hung from the centre of the job i.e. used in equilibrium as far as possible. Should two (2) or more magnets be used to lift longer and larger loads (see sketch, right) these in-turn must be suspended from spreader beams. Depending on the nature of the load, lifting magnets may be distributed appropriately to prevent bending of the load as in case of a thin plate. Bear in mind however, that each magnet must be turned ON & OFF before and after every operation rendering this method impractical sometimes.



NEOLIFTER 'P' SERIES

SuperNeo™ Manual Permanent Magnet Lifter Range



- Safety Factor > 3x Rated Lifting Capacity for ideal conditions.
- State-of-the-art design, compact dimensions with low weight, made with high energy rare earth NdFeB (Neo) magnets.
- Easily transportable, Single hand operating lever with positive spring lock for quick lock and release.
- Easily removed Shackle hook for multi-purpose clamping application.
- Ideal for general purpose lifting of both flat & round material.



Tip : Select the 'P' model if the material you handle is both flat & round in even proportions. Flat material must be at least of 10mm thickness.

Product Code : NML-P

All dimensions in metric units

Model No. (P Series)	Rated		Self Weight (Kg)	Tested Flat Load (Kg)	Dimensions (mm)				Job Size Range (mm)			
	Flat	Dia			L	W	H	R	L	W	Dia Ø	Thk (Min)
	(Kg)	(Kg)										
NML-P-100	100	50	3	>300	92	64	67	123	1200	800	40 - 100	10
NML-P-300	300	150	7.5	>900	162	92	91	155	2000	1200	40 - 160	15
NML-P-600	600	300	23	>1800	233	122	118	196	2500	1500	40 - 200	20
NML-P-1000	1000	500	56	>3000	268	179	164	255	3000	2000	60 - 350	25
NML-P-2000	2000	1000	125	>6000	378	234	212	426	3500	2000	80 - 400	30
NML-P-3000	3000	1500	220	>9000	497	310	252	505	4000	2500	80 - 400	50
NML-P-6000	6000	NA	420	>18000	621	422	355	548	6000	2500	NA	70

Due to continuous upgradation in design there could be changes in specification. Other sizes on request. Before ordering, contact Supreme Magnets or your nearest dealer to confirm the suitability of this model for your application.

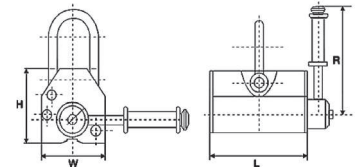

NEOLIFTER 'PR' SERIES

SuperNeo™ Manual Permanent Magnet Lifter Range



- Safety Factor > 3x Rated Lifting Capacity for ideal conditions.
- State-of-the-art design, compact dimensions with low weight, made with high energy rare earth NdFeB (Neo) magnets.
- Easily transportable, Single hand operating lever with positive spring lock for quick lock and release.
- Easily removed Shackle hook for multi-purpose clamping application.
- Ideal for better performance in handling round material and some flat material with more emphasis on round.



Tip : If you are handling mostly round material, select the 'PR' model with its enhanced V-face and better capacity for handling curved faces.

Product Code : NML-PR

All dimensions in metric units

Model No. (PR Series)	Rated		Self Weight (Kg)	Tested Flat Load (Kg)	Dimensions (mm)				Job Size Range (mm)			
	Flat	Dia			L	W	H	R	L	W	Dia Ø	Thk (Min)
	(Kg)	(Kg)										
NML-PR-100	100	70	3	>300	125	85	127	145	1200	800	40 - 100	10
NML-PR-300	300	210	12.5	>900	200	123	179	195	2000	1200	40 - 160	15
NML-PR-600	600	420	32.5	>1800	278	194	246	220	2500	1500	40 - 200	20
NML-PR-1000	1000	700	80	>3000	330	279	333	315	3000	2000	60 - 350	25
NML-PR-2000	2000	1400	200	>6000	450	371	444	460	3500	2000	80 - 400	30
NML-PR-3000	3000	2100	350	>9000	525	444	531	735	4000	2500	100 - 450	50

Due to continuous upgradation in design there could be changes in specification. Other sizes on request. Before ordering, contact Supreme Magnets or your nearest dealer to confirm the suitability of this model for your application.

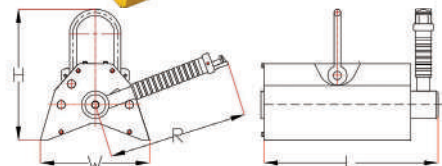

NEOLIFTER 'PF' Series

PM

SuperNeo™ Manual Permanent Magnet Lifter Range

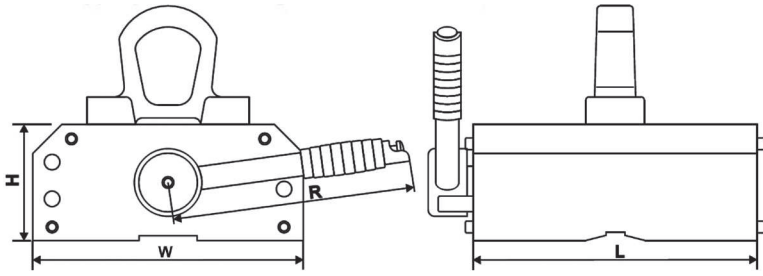

- Safety Factor > 3x Rated Lifting Capacity for ideal conditions.
- State-of-the-art design, compact dimensions with low weight, made with high energy rare earth NdFeB (Neo) magnets.
- Easily transportable, Single hand operating lever with positive spring lock for quick lock and release.
- Easily removed Shackle hook for multi-purpose clamping application.
- Ideal for better performance in handling thin and flat material and some flat material with more emphasis on round.

Tip : If you are handling mostly thin & flat material, select the 'PF' model with its flat bottom, double circuit face with better capacity for handling thinner plates.

Product Code : NML-PF

All dimensions in metric units

Model No. (PF Series)	Rated		Self Weight (Kg)	Tested Flat Load (Kg)	Dimensions (mm)				Job Size Range (mm)			
	Flat (Kg)	Dia (Kg)			L	W	H	R	L	W	Thk (Min)	
												Ø
NML-PF-300	300	100	9.5	>900	163	133	60	180	1200	800	20 - 80	8
NML-PF-600	600	200	21	>1800	234	162	74	220	2000	1200	30 - 120	10
NML-PF-1000	1000	300	37.5	>3000	302	190	87	265	2500	1500	30 - 150	15
NML-PF-2000	2000	600	77	>6000	341	231	107	380	3000	2000	40 - 200	20
NML-PF-3000	3000	X	165	>9000	416	417	146	450	3500	2000	50 - 250	40
NML-PF-6000	6000	X	410	>18000	584	422	206	820	4000	2500	60 - 300	50

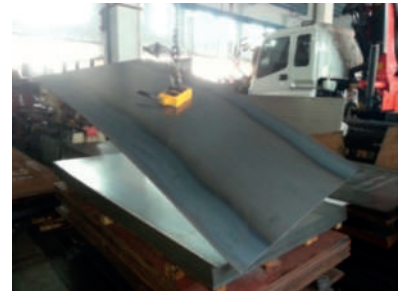

Thin sheet handling is better with the PF model

Due to continuous upgradation in design there could be changes in specification. Other sizes on request. Before ordering, contact Supreme Magnets or your nearest dealer to confirm the suitability of this model for your application.



Model PR-300 Application



Model PR-300 Application



Model PR-300 Application



Model PF-300 Application



Model PR-600 Application



Model PF-6000 Application

LIFTING



RECTANGULAR ELECTRO MAXLIFT

Rectangular Electro Lifting Magnet

EMLR-Coils



- Special magnetic pole is suitable for coiled bar of different diameter.
- The choice of electromagnet depends on the length of coiled bar.
- A long enough electromagnet can lift several coils of coiled bar in the direction of the length.

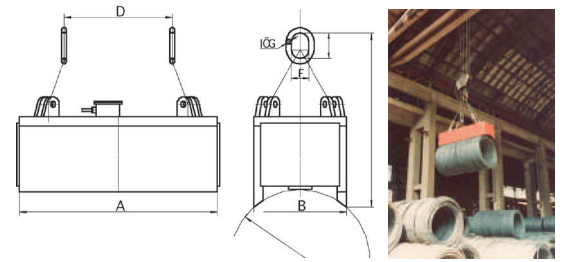

Product Code : EMLR-C

All dimensions in metric units

Model No.	Overall Dimension (mm)							Mass(kg)	current(A)	power(KW)
	A	B	C	D	E	F	G			
EMLR-C-10054	1000	540	1250	500	180	110	32	1520	30	6.6
EMLR-C-16054	1600	540	1210	700	180	110	32	2350	45.5	10
EMLR-C-20054	2000	540	1200	700	180	110	32	2480	58.2	12.8
EMLR-C-26054	2600	540	1220	800	210	125	40	3210	68.2	15
EMLR-C-30054	3000	540	1230	100	210	125	40	3800	80	17.7
EMLR-C-34054	3400	540	1230	1200	210	125	40	4250	86.4	19
EMLR-C-36054	3600	540	1250	1300	250	175	50	4450	89.5	19.7
EMLR-C-40054	4000	540	1250	1550	250	175	50	5000	99.5	21.9
EMLR-C-46054	4600	540	1250	1800	250	175	50	5650	120	26.4
EMLR-C-55054	5500	540	1250	3000	250	175	50	7100	126.4	27.8

Due to continuous upgradation in design there could be changes in specification. Other sizes on request. Before ordering, contact Supreme Magnets or your nearest dealer to confirm the suitability of this model for your application.

EMLR- Multiple Plates



- Designed for lifting and transporting steel plates of medium-thickness safely, accurately and quickly.
- A combination of several electromagnets when handling long steel plates are used to overcome possible bending and deforming that may happen to affect safe transportation.
- High temperature type products for handling steel plates below 700°C can be designed and manufactured upon specific requirements of the customers.

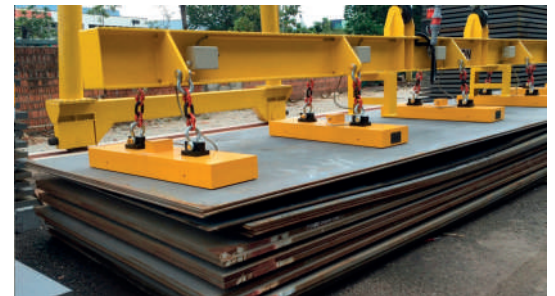

Product Code : EMLR-MP

All dimensions in metric units

Width of steel plate	1500 (mm)							2500 (mm)							4000 (mm)							
	Pieces							Pieces							Pieces							
Model No.	6	8	10	12	16	20	32	6	8	10	12	16	20	32	6	8	10	12	16	20	32	
EMLR-MP-10535	3	3	3	3	2	2	1	1	1	1	1	1	1	1	/	/	/	/	1	1	1	1
EMLR-MP-14035	4	4	3	3	2	2	1	3	2	2	2	2	1	1	/	/	/	/	1	1	1	1
EMLR-MP-17535	4	4	3	3	2	2	1	4	3	3	3	2	2	1	/	/	1	1	1	1	1	1
EMLR-MP-21035	4	4	4	3	2	2	1	4	3	3	3	2	2	1	/	2	2	2	1	1	1	1
EMLR-MP-24035	4	4	4	3	2	2	1	4	3	3	3	2	2	1	2	2	2	2	2	1	1	1
EMLR-MP-12040	6	4	4	4	3	3	1	3	3	3	2	2	2	1	2	1	1	1	1	1	1	1
EMLR-MP-16040	7	5	5	5	3	3	1	6	4	4	4	3	2	1	2	1	1	2	2	2	2	1
EMLR-MP-20040	7	5	5	5	3	3	1	6	5	4	4	3	3	1	2	2	3	3	2	2	2	1
EMLR-MP-24040	7	5	5	5	3	3	1	7	5	5	4	3	3	1	3	3	3	3	3	2	2	1

Model No.	Overall Dimension (mm)							Mass (kg)	Power (kW)	Lifting Width (mm)				
	A	B	C	D	E	F	G			6	8	10	12	16
EMLR-MP-9030	900	300	900	300	110	180	32	185	0.41	2300	2700	3000	3200	3600
EMLR-MP-10535	1050	350	960	400	110	180	32	330	0.9	2650	3150	3350	3550	4050
EMLR-MP-14035	1400	350	940	500	110	180	32	430	1.2	3000	3500	3700	3900	4400
EMLR-MP-17535	1750	350	940	700	110	180	32	510	1.5	3350	3850	4050	4250	4750
EMLR-MP-21035	2100	350	920	800	110	180	32	600	1.8	3850	4200	4400	4600	5100
EMLR-MP-24535	2450	350	980	900	110	180	32	720	2.5	4200	4550	4750	4950	5450
EMLR-MP-12040	1200	400	1017	400	110	180	32	550	3	3000	3500	3700	4000	4500
EMLR-MP-16040	1600	400	996	700	110	180	32	690	3.2	3400	3900	4100	4400	4900
EMLR-MP-20040	2000	400	970	800	110	180	32	840	5	3800	4300	4500	4800	5300
EMLR-MP-24040	2400	400	890	700	110	180	32	910	6	4200	4700	4900	5200	5700
EMLR-MP-13042	1260	420	1040	500	110	180	32	650	2.4	3060	3560	3760	4060	4560
EMLR-MP-17042	1680	420	1045	700	110	180	32	850	3.7	3480	3980	4180	4480	4980
EMLR-MP-21040	2100	420	1010	800	110	180	32	1050	4	3900	4400	4600	4900	5400
EMLR-MP-25042	2520	420	1050	900	110	180	32	1250	4.8	4320	4820	5020	5320	5820

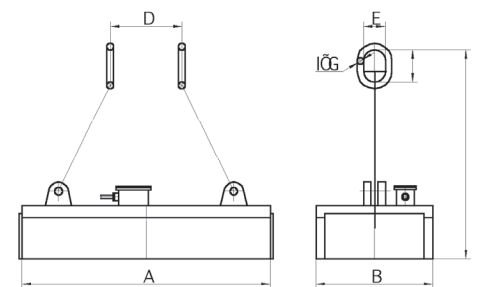

Due to continuous upgradation in design there could be changes in specification. Other sizes on request. Before ordering, contact Supreme Magnets or your nearest dealer to confirm the suitability of this model for your application.



Battery Operated Electropermanent Lifting Magnet



- Revolutionary technique for safe magnetic lifting.
- Electro Permanent Magnetic Lifter - battery powered.
- Light weight and robust construction.
- Safety factor of 3 is maintained for each magnet.
- No battery power is needed to keep magnet on.
- 2 Pole design for lifting both round and flat components.
- Maintenance free completely sealed rechargeable batteries.
- With battery fully charged- can switch On/Off approximately 300 times.
- Warning signal when battery charge level is low.
- Inbuilt battery charger with over charge protection.
- Battery Charging cable is in built in a sliding case.



- For handling off-cuts and small plates from & to CNC plate cutting tables. For loading & unloading plates from Vertical CNC machines.
- In stock yards for handling flats, plates, rounds.
- For loading/unloading in difficult environmental conditions.
- Since no mechanical lever is actuated, it is very comfortable for the operator even while working at odd site conditions.
- Automatic Sequential switching On/Off using contactless relay. The magnet initially is in Off condition, after placing on the load, when the hoist pulls up, it actuates a contactless relay and the magnet is automatically switched On. When it is hoisted down, the magnet remains On. And now when it is lifted the same is Off and releases the job.
- Ready to use magnets can be hooked to crane giving incredible flexibility and unbeaten cost reduction for moving ferrous load.

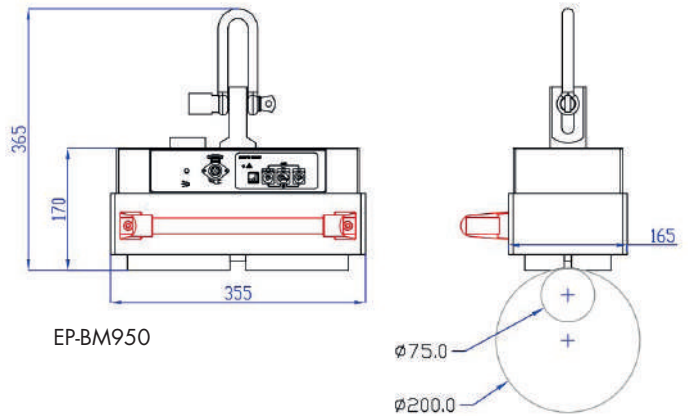

EP-BM950

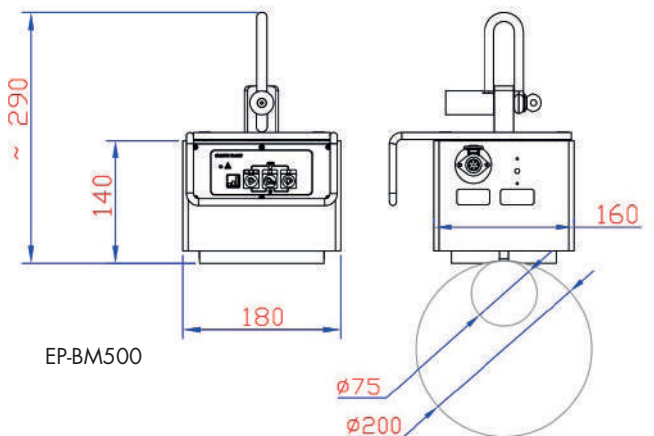

EP-BM500

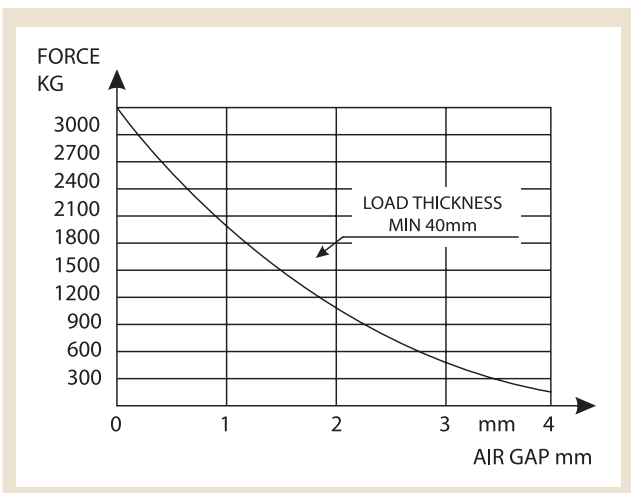

Battery Operated Electropermanent Lifting Magnet

LIFTING

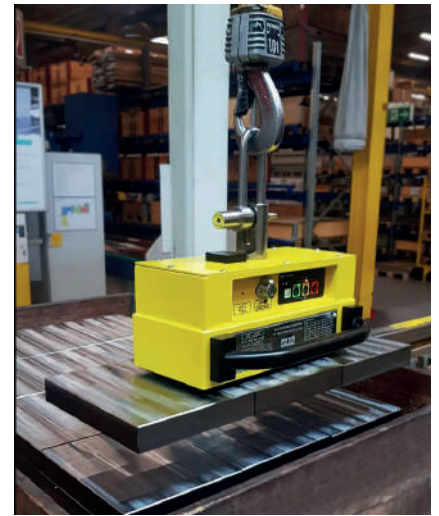

Product Code : EP-BM

All dimensions in metric units

Model	Flat Load	Round Load	Round Load Dia	Min thickness for Operation	Min Plate Thickness for Separation	Magnet Area	Gross Dimensions (mm)	Weight (kgs)	Full Charge Activation (Amps)
EP-BM200	200	50	75-150	8	4	115 x 50	150 x 85 x 150	10	1000
EP-BM500	500	200	75-200	10	4	145 x 25	180 x 160 x 140	25	1000
EP-BM950	950	400	75-200	12	4	320 x 130	355 x 165 x 170	40	1000
EP-BM3000	3000	1500	80-400	40	6	460 x 230	560 x 340 x 500	190	300
EP-BM5000	5000	2500	80-400	50	6	680 x 380	740 x 410 x 320	520	300
EP-BM10000	10000			70	6	1060 x 500	1160 x 500 x 600	715	300

Due to continuous upgradation in design there could be changes in specification. Other sizes on request. Before ordering, contact Supreme Magnets or your nearest dealer to confirm the suitability of this model for your application.

Charging Mains Source: 110 / 220 VAC, 50/60 Hz



- These lifting magnets are designed to be compact, low weight, high strength and reliable with full respect to industrial safety.
- Unique EPM technique using double magnet system.
- EPM needs electricity only during switching magnet ON and OFF.
- Can be controlled by a single operator staying at a safe distance.
- No battery back up is needed.
- Over 95% saving of electricity as compared to conventional electro magnets.
- Can be supplied with fixed structure having provision for shifting magnets to handle plates with various sizes.
- Special safety - Will not drop when load is hanging due to incorporation of safety contact-less switch.
- Each magnet is hanged from suspension springs to adjust to the bendness of plates.



- Ideal for handling single plates in stock yard of large fabrication shops.
- Loading of plates on flame cutting machines.
- Most effective in ship building industries.
- Can handle both small plates and large plates by selectively choosing the magnets in contact with plate.
- Telescopic spreader beam with adjustable arm for lifting plates 12M long and above and weighing 25 MT are available.

Latest technology for handling and lifting single plates of length upto 16mtr and width upto 4mtr. Completely eliminates the older electromagnetic conventional technology and its associated liabilities such as heavy electricity consumption, duty cycle adherence, battery backup, coil burnout and frequent maintenance.

Requiring hardly any maintenance and does not consume electricity during actual lift operation, the highly reliable Supreme EPML P series represents the answer to plate lifting operations in shipyards, stockyards, flame-cutting environments and similar single plate handling environments.

The magnetic power is generated by a double magnet combination driven by a brief electrical impulse only during charging and discharging. This generates a concentrated and controlled power during the period of actual operation while requiring no electricity and therefore saves nearly 95% power.

- Suitable for indoor and outdoor use.
- Control Panel with operator pendant control wired or wireless.
- Can be made to any size and capacity.

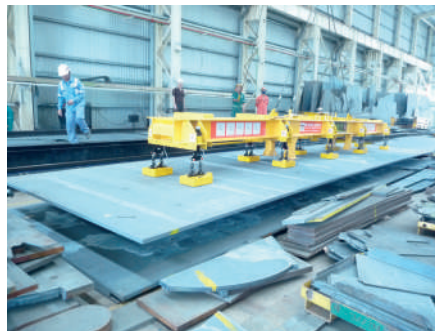

Electropermanent Plate Lifting Magnet

VARIOUS MODELS FOR DIFFERENT APPLICATIONS CAN BE SUPPLIED AS MENTIONED BELOW

- Fixed beams with steel tube structure having 2/4/6 cross beams with 2 magnets on each cross beam.
- Fixed or telescopic beam for handling wide plates to long sections.
- Special modular systems are tailor made by adapting them to the size of the plate and flame cut pieces. This allows easy and fast loading and unloading operation on any type cutting machine like plasma, oxyacetylene, laser. It quickly clears the table from cut plates and skeleton in single move to make machine available for next loading, thus saving space and time.

FLEXIBILITY

- Compact Modules (Single magnet modules can be added for added capacity to existing beam). No need to overhaul existing crane infrastructure.
- Electropermanent (EPM) Technology does not require constant supply of electricity to sustain magnetism thereby 95% savings in electrical consumption compared to older Electro Lifters.
- No more coil burnout due to operator forgetfulness to adhere to concept of Duty cycle of 60% or 70% in older Electro Lifters.
- No more downtime and frequent maintenance or repair of the lifting magnets as the magnets themselves hardly spoil due to the above reasons.

CONFIGURATION GUIDELINES

- Upto 6 Mtr Long Plates from thickness 5mm onwards.
Use the EPML P/4 system comprising of 2 magnet modules totaling 4 magnets. Each module consisting of 2 magnets each either in a chain/sling suspension or spring enabled housing suspended from a fixed beam structure.
- Upto 12 Mtr Long Plates from thickness 5mm onwards.
Use the EPML P/10 system comprising of 10 magnets. Each module consisting of 2 magnets either in a chain/sling suspension or spring enabled housing suspended from a fixed beam structure or telescopic beam. For smaller plate sizes of 6 Mtr or 9 Mtr, selective activation of the magnets are possible. The decision to recommend a single housing or individual suspended magnets will depend on plate handling characteristics and behavior. If the plates are loosely stacked, individual magnet suspension performs better. If the plates are neatly stacked, a double magnet housing is suitable.
- Upto 16 Mtr Long Plates from thickness 5mm onwards.
Use the EPML P/12 system comprising of 6 magnet modules totaling 12 magnets. Each module consisting of 2 magnets either in a chain/sling suspension or spring enabled housing suspended from a telescopic beam.
- Can handle both small plates and large plates by moving telescopic arm which hangs magnets.



TECHNICAL AND DIMENSION DATA : SUBJECT TO MODIFICATION

Every plate lifting requirement requires a near custom construction and field characteristics may require alteration of dimension data. SUPREME Magnets reserves the right to alter/amend any of the below data to suit the application at hand.

PROPERTIES AND DIRECTIONS OF USE

If the thickness is less and the length is more than 2000 mm, then, instead of a single high capacity magnet, more than one magnet of lower capacity is used, making sure that the overhanging on width is not more than 800 mm and length 1000 mm. For Example if you have to lift a plate of say 6000 x 2000 x 12 mm thick, you need to hang atleast 4 Sets of magnets (Each set consist of 2 Nos. magnet, side ways) and they are hanged from a spreader beam of 4000 mm x 1000 mm.

For handling plates of larger sizes, we recommend Telescopic Plate Handling System which is basically a spreader beam having 2 sets of fixed magnets and 2 set of magnets moving between 800 to 1100 mm each side. The magnets are hanged by Spring suspension box with loose chain so that it takes care of the bend of the plates available in market.

STANDARD / OPTIONS

- Switch selectable capability for selecting 4/8/6/10/12 magnets (STANDARD, depending on model).
- Radio Remote Control with PICK-UP/FULL-MAG / DEMAG / SAFE / OPEN / CLOSE functions (OPTION).
- Optional INTEGRATION WITH Operator Pendant.
- Integration into existing / new Crane Remote possible (OPTION).
- Cable Spring Drum with 12m cable, plug and socket (OPTION) Lamp block, pendant and T/R Control Panel with Saturation control system (STANDARD).

SAFETY FACTOR

SUPREME Magnets strictly adheres to a safety factor of 3:1 for all individual EPML lifting magnets. The total system with Fixed beam in its complete assembly will sustain a load of 1.5 : 1 for MILD STEEL plates and these are in conformity with the provisions of the Machinery Directive 98/37/EG, harmonized standards EN-292-1, EN-292-2 and with national implementing legislation.

CAUTION : The maximum rated lift is based upon lifting clean, smooth, flat, low-carbon steel plate, with the full area of the magnet's lifting surface in contact with the load. De-rating is required for round jobs, rusted jobs or alloy steels. Do not use on material less than 5mm thickness. Safety Manual contains more detailed ratings.

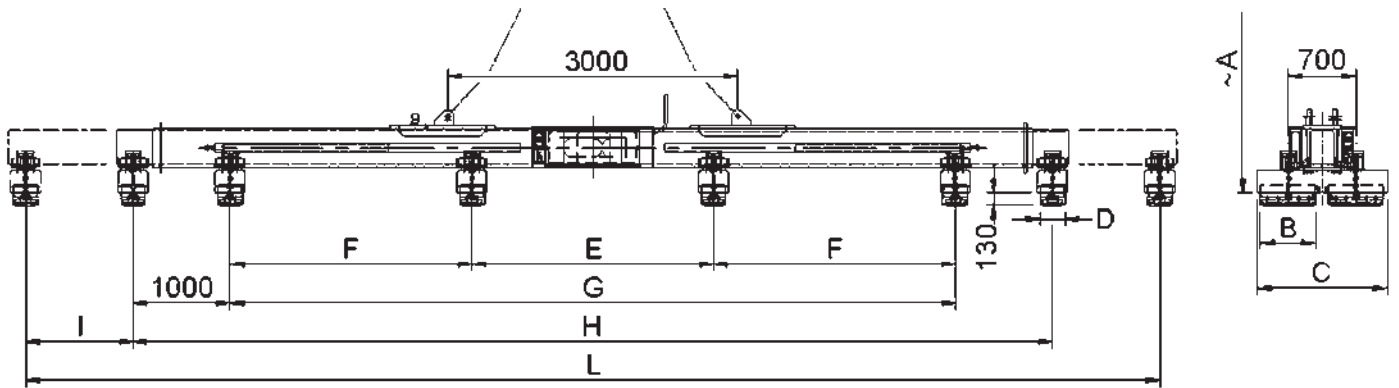

Product Code: EPML P

All dimensions in metric units

Model No.	A	B	C	D	E	F	G	H	I	L	WEIGHT	LENGTH	WIDTH	MIN THICK	SWL
EPML P/4	System of 4 magnets with spring dampers hanging from a Spreader Beam														
4T	2000	325	1250	235	3000	3050					1200	6000	3500	5	4000
8T	2000	600	1250	230	3000	3050					1200	6000	3500	8	8000
10T	2000	600	1550	250	3000	4000					1500	6000	3500	10	10000
EPML P/8 & P/10	System of 8 or 10 magnets with spring dampers hanging from a Spreader Beam. 8 Magnets for 9 Mtr Plate & 10 Magnets for 12 Mtr Plates														
6T	2500	330	1250	240	2500	1450		5000	1250	7500	2750	9000	3500	5	6000
8T	2500	330	1250	240	2500	1650		6000	1700	9500	2950	12000	3500	6	8000
10T	2500	350	1250	250	2500	1650		6000	1700	9500	2950	12000	3500	8	10000
12T	2500	415	1250	235	2500	1650		6000	1700	9500	2950	12000	3500	10	12000
15T	2500	505	1250	235	2500	1650		6000	1700	9500	2950	12000	3500	15	15000
EPML P/12	System of 12 magnets with spring dampers hanging from a Spreader Beam														
10T	2500	330	1250	240	2500	1650	6000	8000	1350	10000	3850	16000	3500	5	10000
12T	2500	350	1250	250	2500	1650	6000	10000	1650	12500	4250	16000	3500	8	12000
15T	2500	415	1250	235	2500	1650	6000	10000	1650	12500	4250	16000	3500	10	15000
20T	2500	505	1250	235	2500	1650	6000	10000	1650	12500	5450	16000	3500	15	20000
25T	2500	630	1500	250	2500	1850	6000	10000	1650	12500	6000	16000	3500	15	25000

Due to continuous upgradation in design there could be changes in specification. Other sizes on request. Before ordering, contact Supreme Magnets or your nearest dealer to confirm the suitability of this model for your application.

Electropermanent Magnet Heavy Duty Tube Lifter



- Compact Modules (Single magnet modules can be added for added capacity to existing beam, if necessary) —> No need to overhaul existing crane infrastructure.
- Electropermanent (EPM) Technology does not require constant supply of electricity to sustain magnetism thereby;
 - ☒ 95% savings in electrical consump on compared to older Electro Lifters.
 - ☒ No more coil burnout due to operator forgetfulness to adhere to concept of Duty cycle of 60% or 70% in older Electro Lifters.
 - ☒ No more downtime and frequent maintenance or repair of the lifting magnets as the magnets themselves hardly spoil due to the above reasons.



- Up to 12 Mtr long tubes of up to 2200mm diameter.

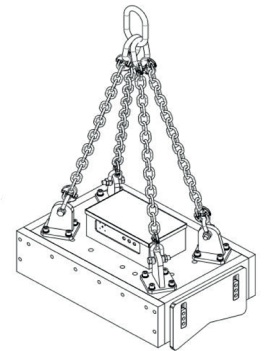
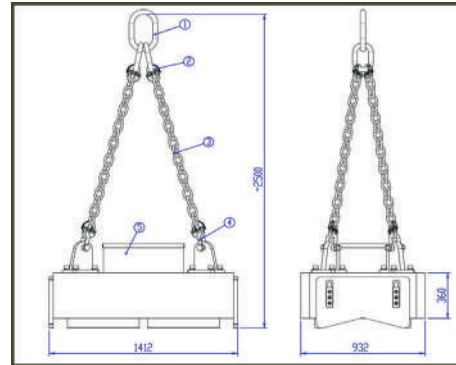
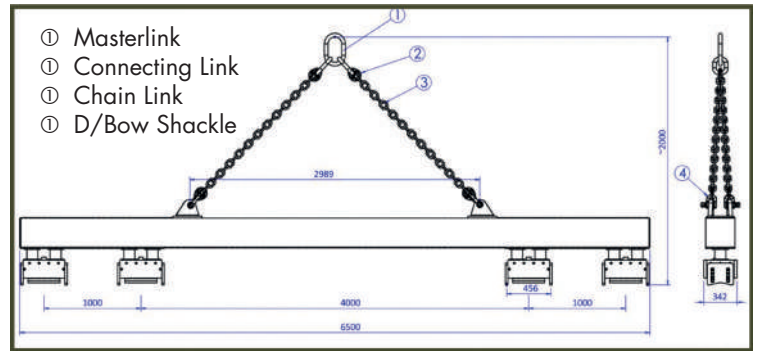

Product Code: EPMLP/T/X

TECHNICAL AND DIMENSION DATA FOR TYPICAL RANGE (NOT ALL POSSIBILITIES ARE LISTED HEREIN) : SUBJECT TO MODIFICATION

Model	Length (mm)		Wall Thickness Range (mm)	Dia Range (mm)	SWL Lifting Capacity (Tons)	No. of Modules	Lifting Cap of Module at 2mm AirGap / Min Safety Factor at 0 mm AirGap
	Min	Max					
EPML P/T/1	1000	4000	8 - 50	800 - 1800	5 - 15	1	5 - 15 / 3
EPML P/T/2	6000	12000	8 - 50	150 - 950	5 - 15	2	2.5 - 7.5 / 3
EPML P/T/3	1000	12000	8 - 50	150 - 950	5 - 15	3	1.5 - 5 / 3
EPML P/T/4	6000	12000	8 - 50	150 - 950	5 - 15	4	1.25 - 4 / 3

Due to continuous upgradation in design there could be changes in specification. Other sizes on request. Before ordering, contact Supreme Magnets or your nearest dealer to confirm the suitability of this model for your application.

HAND LIFTER

PM

Hand Operated Sheet Lifter



- Easy grip powerful magnet with handle.
- Can lift/ drag top sheet from stack for pulling out without any damage.
- Optimum flux density – effectively lifts thick/ thin sheets.
- Magnets are always ON. To release a cam mechanism pushes down the sheet at contact point.



- Useful for press shop for feeding one sheet at time in machine.
- These are used in single or in pairs for carrying sheets for either horizontal or vertical transportation.
- Most suitable for pulling or carrying small steel sheets.

Caution : Do not use it as a hoist for handling finished components after grinding operation, use thin plastic sheet to avoid scratch.

Product Code : HL

All dimensions in metric units

Model No.	L	W	H2	H1	Rated Cap (Vertical)	Max Pull (Vertical)	Wt (Kg)
HL-30	158	148	180	25	30	100	2

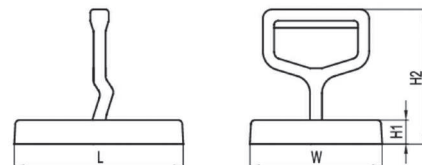

SHEET LIFTER

PM

Crane Operated Sheet Lifter



- Simple, easy, flexible, economical and very light weight.
- Can swivel 150° and lift sheets vertically and horizontally.
- Can lift non homogeneous parts with unbalanced weight and load.
- Optimum flux density effectively lifts thick/ thin sheets.
- Magnets always remain ON.
- Cam mechanism jack up lever releases the jobs easily with the help of long handle.



- Useful in shop floor for stacking of sheets size 1000 x 2000 mm.
- Suitable for loading/unloading of plates from horizontal milling machine.
- Most suitable near flame cutting machines.

Product Code : SL

All dimensions in metric units

Model No.	L	W	H2	R	H1	Rated Cap (Vertical)	Max Pull (Vertical)	Wt (Kg)
SL-25	190	120	260	290	40	250	625	5
SL-50	300	200	300	590	40	500	1500	15

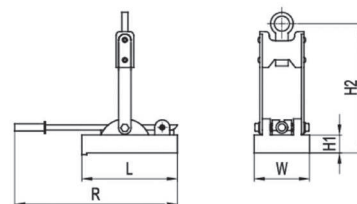

Caution : For handling finished components after grinding operation, use thin plastic sheet to avoid scratch.

MINI GIANT

PM

Handle Operated ON/OFF Versatile Lifting Magnet



- Handle grip, convenient & safe lifting solution.
- Perfect for handling uneven steel sections and profiles from 10 Kg to 100 Kg.
- Unit has a rated capacity of 100 Kgs and break-force of 300 kgs on a grinded finish 20mm thick mild steel plate.
- Equipped with a convenient ON/OFF lever and 2 pole face for a strong grip.



All dimensions in mm, units in metric

Model	Rated Max Load (Kg/Lbs)	L x W x H (Magnet)	ON/OFF Lever	Handle L x W	Weight (kgs)
MG-100	100 / 220	90 x 65 x 67	123	250 x 130	3.5



MAG-PRESS™

PM

Magnetic Press-Fit Welding Fabrication Machine



- Compact and relatively light-weight Stiffener Welding aid.
- Clamping forces of upto 4 Tons. Technically, higher forces are possible by upgrading the clamp.
- Complete hydraulic ram and Jack kit for 10 Tons & 10000 psi pressure.
- Set of three Extension Rods of 50, 100 & 200mm Length.
- Side Alignment screw pins for fine alignment of the profiles.
- Wheel and handle for easy movement of the machine along the length of the profile.
- Secure upto 3 meters of profile with one clamping point.

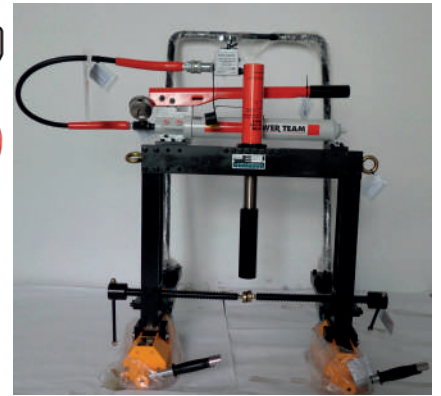

- Eliminate costly & time consuming steps to weld U clamps, hammer shims etc to weld stiffeners & profiles on plates.
- Effectively deploy human resources, make a laborious task easy & enjoyable.
- Easily increase productivity by 50 to 80%.

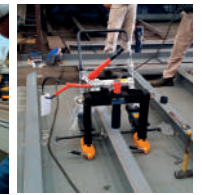

Product Code : MP

All dimensions are in mm

Model No.	L	W	H	H1	Vertical Clamp Force on 20mm thick Plate (Kgs)	Press Force Stroke (Tons/mm)	Stiffener / Profile Height (mm)	Wt (Kg)
MP-IV	800	600	580	900	3600	10 / 152	75 - 550	65
MP-V	1200	800	650	950	7000	10 / 152	150 - 600	115

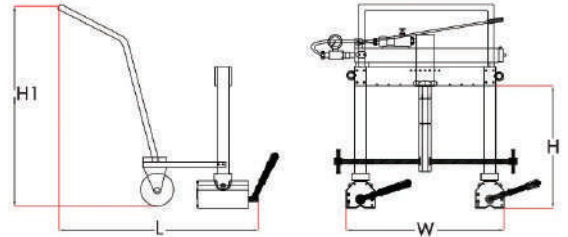

MAG-PRY™

PM

Plate Levelling and Fit-Up Tool



- Convenient Handle operated wheeled dolly tool.
- Maximum vertical clamping force of 3000 Kg or 6000 Kg (on 50mm thick MS Plate).
- Compact & light-weight permanent Magnet clamp.
- Position the magnet part on one plate and the vise-screw part on the adjacent plate.
- Switch ON the magnet and start turning the screw to obtain the desired leveling.
- Easy & convenient to operate!
- Overall dimensions of 1300 x 650mm.

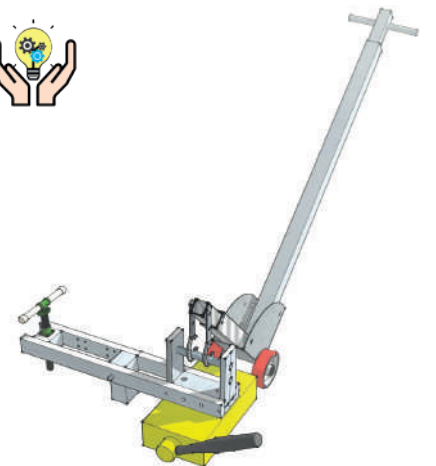

Versatile Multi-Purpose, Holding, Anchoring & Clamping Pot Magnet



- Compact & Lightweight powerful pot magnet, ideal for absolutely any clamping application.
- An invaluable fixturing tool for fabricators and engineers who may be looking for attractive mechanism to clamp any item to a steel base.
- Hang various tools & equipment overhead without need for welding any temporary hooks.
- Fabricate your own unique clamping solution.
- Clamping force from 4 to 160 Kg (on 50mm thick MS Plate).
- Suitable for application upto 80Deg C only.



F = Vertical pull force

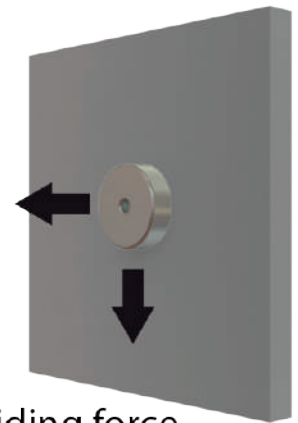

V = Sliding force = 1/4 Vertical force

SRBM-NA : Round Base Magnet with Countersunk Hole

Model	D (mm)	d (mm)	d1 (mm)	H (mm)	Unit Weight (g)	Adhesive Force (Kgs)	Sliding Adhesive Force (Kgs)
SRBM-NA10	10	3.5	6.5	4.5	3	1	0.2
SRBM-NA12	12	3.5	6.5	4.5	4	1.5	0.3
SRBM-NA16	16	3.5	6.5	5	7	6	1.2
SRBM-NA20	20	4.5	8.6	7	15	11	2.2
SRBM-NA25	25	5.5	10.6	8	24	22	4.4
SRBM-NA32	32	5.5	10.6	8	39	32	6.4
SRBM-NA36	36	6.5	11.3	8	50	43	8.6
SRBM-NA42	42	6.5	11.3	8.6	77	65	13
SRBM-NA48	48	8.5	15.5	11	120	75	15
SRBM-NA60	60	8.5	14.5	15	243	160	32
SRBM-NA70	70	10.5	16.5	17	440	200	40
SRBM-NA75	75	10.5	16.5	18	480	250	50
SRBM-NA80	80	10.5	16.5	18	655	280	56
SRBM-NA90	90	10.5	16.5	18	822	360	72
SRBM-NA120	120	12.5	22.5	18	1420	480	96

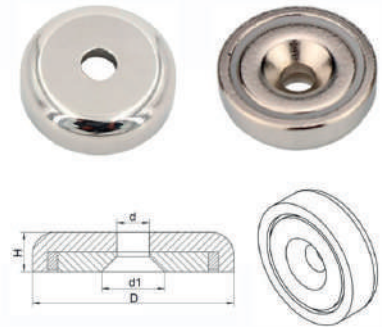

SRBM-NB : Round Base Magnet with Cap Screw Hole

Model	D (mm)	d (mm)	d1 (mm)	H (mm)	Unit Weight (g)	Attractive force (kg)	Sliding Adhesive Force (Kgs)
SRBM-NB12	12	3.5	6.5	4.5	4	1.5	0.3
SRBM-NB16	16	3.5	6.5	5	7	5	1
SRBM-NB20	20	4.5	8	7	13	10	2
SRBM-NB25	25	5.5	9	8	22	20	4
SRBM-NB32	32	5.5	9	8	38	30	6
SRBM-NB36	36	6.5	11	8	48	40	8
SRBM-NB42	42	6.5	11	8.6	75	60	12
SRBM-NB48	48	8.5	15	11	114	70	14
SRBM-NB60	60	8.5	15	15	235	150	30
SRBM-NB75	75	10.5	18	18	460	230	46

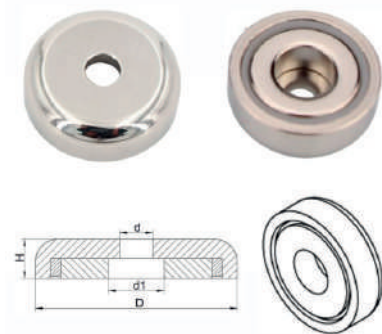

Instructions :

The adhesive force indicated for each part are under ideal conditions and refer to the Vertical pulling force on a 10mm thick mild steel grinded finish wall. Sliding forces are typically one-fifth of Vertical forces. Thinner steel walls or platforms will also derate the pulling forces.

Therefore you should design your application suitably, taking account of the forces in play. For eg., you will fail trying to hang a bucket of water weighing 40 kgs using an RBM NA-42 (65 Kg Adhesive force) from a 10mm thick steel wall. The NA-42 has only about 13 Kgs Sliding force resistance (65/5 Kg). You should try using the NA-75 (230/5) or 4 units of NA42 (4 x 65/5) instead.



Versatile Multi-Purpose, Holding, Anchoring & Clamping Pot Magnet

SRBM-NC : Round Base Magnet with Bolt

Model	D (mm)	M	H (mm)	h (mm)	Unit weight (g)	Vertical Adhesive force (kg)	Sliding Adhesive force (kg)
SRBM-NC10	10	3	12	5	4	1.5	0.3
SRBM-NC12	12	3	12	5	5	2	0.4
SRBM-NC16	16	4	14	5	9	8	1.6
SRBM-NC20	20	4	16	7	16	12	2.4
SRBM-NC25	25	5	17	8	26	25	5
SRBM-NC32	32	6	18	8	43	34	6.8
SRBM-NC36	36	6	17.6	8	54	50	10
SRBM-NC42	42	6	18.7	8.6	83	72	14.4
SRBM-NC48	48	8	24	11	130	81	16.2
SRBM-NC60	60	8	28	15	256	160	32
SRBM-NC75	75	10	35	18	510	270	54

Vertical adhesive force is measured perpendicular to a 10mm mild steel plate

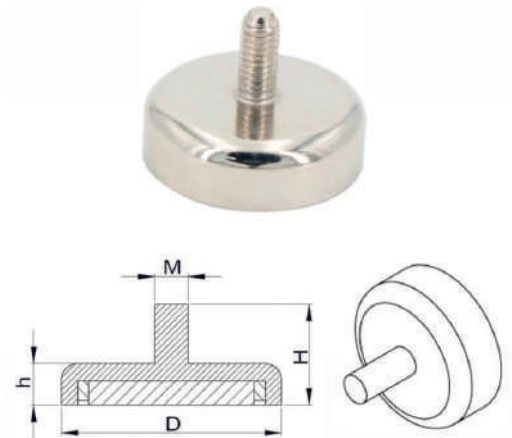

SRBM-ND : Round Base Magnet with Stud

Model	D (mm)	d (mm)	M	H (mm)	h (mm)	Unit weight (g)	Vertical Adhesive force (kg)	Sliding Adhesive force (kg)
SRBM-ND10	10	6	3	12.6	5	4	1.5	0.3
SRBM-ND12	12	6	3	12.6	5	5	2	0.4
SRBM-ND16	16	6.5	4	13.5	5	9	8	1.6
SRBM-ND20	20	6.5	4	15	7	17	12	2.4
SRBM-ND25	25	7.5	5	17	8	28	25	5
SRBM-ND32	32	10	6	18	8	45	34	6.8
SRBM-ND36	36	10	6	18.5	8	55	50	10
SRBM-ND42	42	10	6	18.8	8.6	84	72	14.4
SRBM-ND48	48	12	8	24	11	130	81	16.2
SRBM-ND60	60	12	8	28	15	263	160	32
SRBM-ND75	75	17	10	35	18	515	270	54

Vertical adhesive force is measured perpendicular to a 10mm mild steel plate

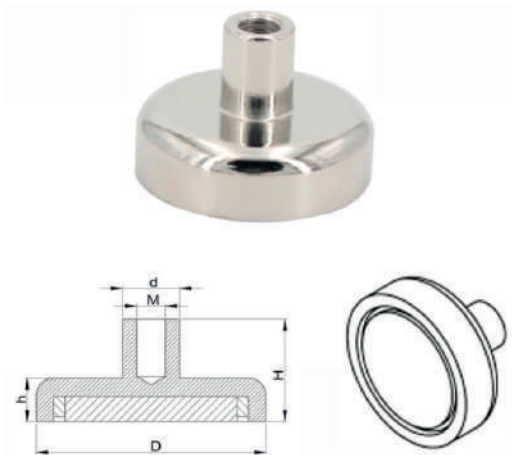

SRBM-NE : Round Base Magnet with Hook

Model	D (mm)	d (mm)	M	h1 (mm)	h (mm)	H (mm)	Unit weight (g)	Vertical Adhesive force (kg)	Sliding Adhesive force (kg)
SRBM-NE10	10	6	3	12.6	5	31.5	5	1.5	0.3
SRBM-NE12	12	6	3	12.6	5	31.5	7	2	0.4
SRBM-NE16	16	6.5	4	13.5	5	35.7	12	8	1.6
SRBM-NE20	20	6.5	4	15	7	37.8	21	12	2.4
SRBM-NE25	25	7.5	5	17	8	44.9	33	25	5
SRBM-NE32	32	10	6	18	8	47.8	54	34	6.8
SRBM-NE36	36	10	6	18.5	8	49.8	64	50	10
SRBM-NE42	42	10	6	18.8	8.6	50	93	72	14.4
SRBM-NE48	48	12	8	24	11	61	150	81	16.2
SRBM-NE60	60	12	8	28	15	66	283	160	32
SRBM-NE75	75	17	10	35	18	85	555	270	54

Vertical adhesive force is measured perpendicular to a 10mm mild steel plate



Versatile Multi-Purpose, Holding, Anchoring & Clamping Pot Magnet

SRBM-NF : Round Base Magnet with Eye-Bolt

Model	D (mm)	d (mm)	M	h1 (mm)	h (mm)	H (mm)	Unit weight (g)	Vertical Adhesive Force (kg)	Sliding Adhesive Force (kg)
SRBM-NF10	10	6	3	12.6	5	31.5	5	1.5	0.3
SRBM-NF12	12	6	3	12.6	5	31.5	7	2	0.4
SRBM-NF16	16	6.5	4	13.5	5	35.7	12	8	1.6
SRBM-NF20	20	6.5	4	15	7	37.8	21	12	2.4
SRBM-NF25	25	7.5	5	17	8	44.9	33	25	5
SRBM-NF32	32	10	6	18	8	47.8	54	34	6.8
SRBM-NF36	36	10	6	18.5	8	49.8	64	50	10
SRBM-NF42	42	10	6	18.8	8.6	50	93	72	14.4
SRBM-NF48	48	12	8	24	11	61	150	81	16.2
SRBM-NF60	60	12	8	28	15	66	283	160	32
SRBM-NF75	75	17	10	35	18	85	555	270	54

Vertical adhesive force is measured perpendicular to a 10mm mild steel plate



SRBM-NG : Round Base Magnet with Swivel Hook

Model	D (mm)	d (mm)	d1 (mm)	h (mm)	H (mm)	L (mm)	W (mm)	l (mm)	Unit weight (g)	Vertical Adhesive force (kg)	Sliding Adhesive force (kg)
SRBM-NG25	25	20	13.5	8	15.5	55	23	24	38	17	3.4
SRBM-NG32	32	20	13.5	8	15.5	55	23	24	52	30	6
SRBM-NG36	36	20	13.5	8	15.1	55	23	24	65	40	8
SRBM-NG42	42	20	13.5	8.6	16.5	55	23	24	92	60	12

Vertical adhesive force is measured perpendicular to a 10mm mild steel plate

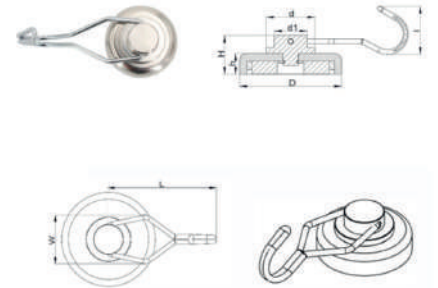

SRBM-NH : Round Base Magnet with Tapped Thru Hole

Model	D (mm)	H (mm)	M	Unit weight (g)	Vertical Adhesive force (kg)
SRBM-NH16	16	5.2	3	7	4
SRBM-NH20	20	7.2	4	14	8
SRBM-NH25	25	7.7	5	25	17
SRBM-NH32	32	7.8	5	44	27
SRBM-NH36	36	7.6	6	55	36
SRBM-NH42	42	8.8	6	86	55

Vertical adhesive force is measured perpendicular to a 10mm mild steel plate

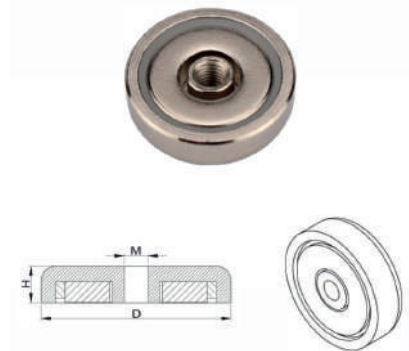

SRBM-NI : Round Base Magnet with Carabiner

Model	D (mm)	d (mm)	d1 (mm)	d2 (mm)	W (mm)	H (mm)	h (mm)	Unit weight (g)	Vertical Adhesive force (kg)
SRBM-NI25	25	12	4	5	5	17.7	8	30	17
SRBM-NI32	32	12	4	5	5	17.6	8	47	28
SRBM-NI36	36	15	5	5	5	17.8	8	59	35

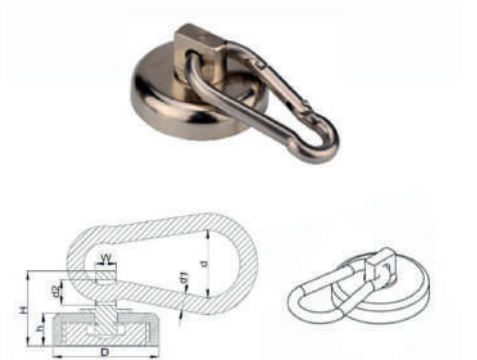

Versatile Multi-Purpose, Holding, Anchoring & Clamping Pot Magnet

CM : Double Countersunk Channel magnet

Model	L (mm)	CM (mm)	W (mm)	H (mm)	d (mm)	d1 (mm)	Unit weight (g)	Vertical Adhesive force (kg)
CM-40	40	30	13.5	5	3.3	6.5	19	17
CM-50	50	40	13.5	5	3.3	6.5	23	27
CM-60	60	50	13.5	5	3.3	6.5	28	30
CM-80	80	70	13.5	5	3.3	6.5	38	33
CM-100	100	90	13.5	5	3.3	6.5	47	36
CM-120	120	110	13.5	5	3.3	6.5	57	40

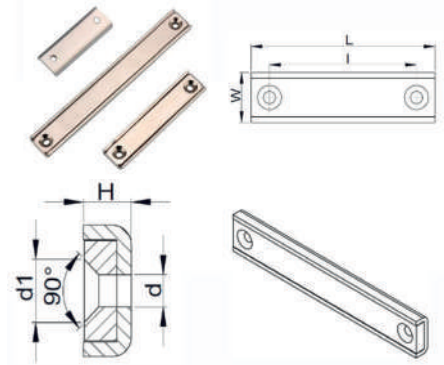

Fishing Magnets

Neodymium fishing magnet, with stainless steel hook, nickel coating. Ideal for retrieval of underwater objects, anchoring aids for divers, handy all purpose hooking points.

SRBM-NP1 : Round Base Fishing Magnet with 1 hanging point c/w Eye-Bolt

Model	D (mm)	H (mm)	L (mm)	d (mm)	d1 (mm)	M1 M2	Unit weight (g)	Breakaway Single Side (kg/lb)
SRBM-NP1-48	48	18	86	20	35	M8	280	80 / 175
SRBM-NP1-60	60	22	98	20	35	M8	420	135 / 300
SRBM-NP1-75	75	25	119	25	42	M10	885	220 / 500
SRBM-NP1-94	94	28	138	25	42	M10	1540	300 / 650
SRBM-NP1-116	116	32	167	29	47	M12	2435	450 / 1000
SRBM-NP1-136	136	34	187	29	47	M12	3355	600 / 1350

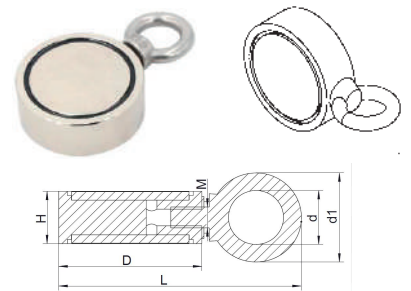

SRBM-NP2 : Round Base Fishing Magnet with 2 hanging points c/w Eye-Bolt

Model	D (mm)	h (mm)	H (mm)	L (mm)	d (mm)	d1 (mm)	M1 M2	Unit weight (g)	Breakaway Single Side (kg/lb)
SRBM-NP2-48	48	18	58	83	19.5	34.5	M8	211	70 / 160
SRBM-NP2-60	60	22	66	95	19.5	34.5	M8	551	135 / 300
SRBM-NP2-75	75	25	77	110	25	41.5	M10	945	220 / 500
SRBM-NP2-94	94	28	85	129	25	41.5	M10	1600	300 / 650
SRBM-NP2-116	116	32	92	160	29	47	M12	2745	450 / 1000
SRBM-NP2-136	136	34	92	190	29	47	M12	3580	600 / 1350

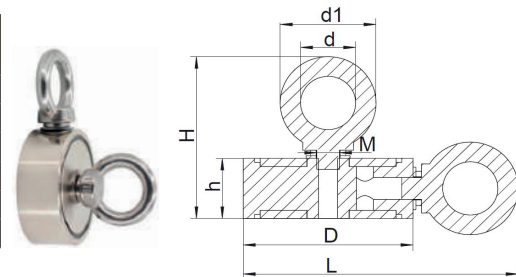

Rubber Coated Neodymium Pot Magnets

Rubber coated magnets, also known as weatherproof magnets, are made by Neodymium magnet, stainless steel and durable rubber coating. The protective rubber coating protects magnets from chipping, liquid, and corrosion. Thus can be regarded as an ideal solution for both indoor and outdoor holding applications which need high magnetic strength. Rubber coated magnets are frequently served to holding, mounting, and fixing purposes, in the meanwhile, the high friction of the rubber coating also achieved attractive force enhancement on the vertical surface.

SRBM-RNA : Round Base Rubber Coated Neodymium with Nut Type (A Type)

Model	D (mm)	Screw thread	d (mm)	h (mm)	H (mm)	Unit weight (g)	Vertical Adhesive force (kg)	Sliding Adhesive force (kg)
SRBM-RNA22	22	M4/M5/M6	8	6	11.5	11	3.5	2
SRBM-RNA34	34	M4/M5/M6	8	6	11.5	19	7.5	4
SRBM-RNA43	43	M4/M5/M6	8	6	10.5	31	10	5
SRBM-RNA66	66	M5/M6/M8	12	8	13.5	100	20	10
SRBM-RNA88	88	M6/M8/M10	12	8	13.5	179	42	21

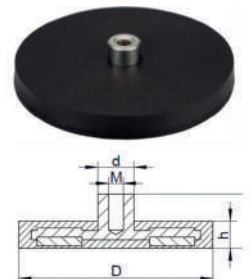

SRBM-RNB : Round Base Rubber Coated Neodymium with Bolt Type (B Type)

Model	D (mm)	Screw thread	h (mm)	H (mm)	Unit weight (g)	Vertical Adhesive force (kg)	Sliding Adhesive force (kg)
SRBM-RNB22	22	M4/M5/M6	6	13	11	3.5	3.5
SRBM-RNB31	31	M4/M5/M6	6	21	22	7.5	7.5
SRBM-RNB36	36	M4/M5/M6	7	22	27	8	8
SRBM-RNB43	43	M4/M5/M6	6	21	34	10	10
SRBM-RNB66	66	M5/M6/M8	8	23	100	20	20
SRBM-RNB88	88	M6/M8/M10	8	23	184	42	42

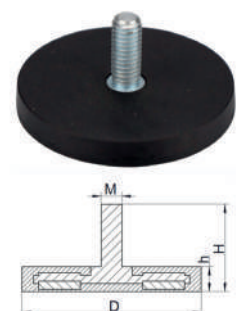

High Temperature, Versatile Holding & Clamping Pot Magnet

ALNiCo Shallow Pot



- Compact & lightweight ALNiCo Grade 5 magnets ideal for high temperature holding and clamping application.
- Temperature Upto 350° C.
- Red Painted coating.

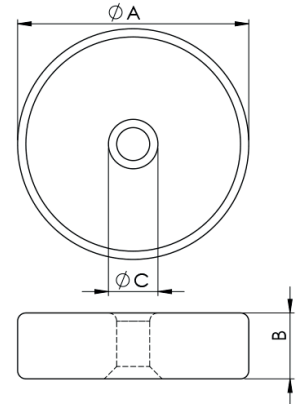
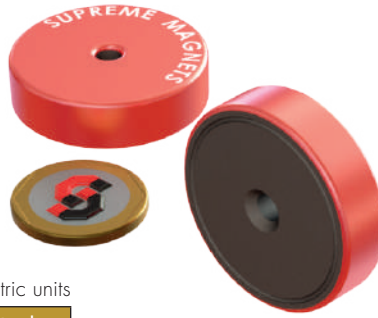

Product Code : ALCO-SP

All dimensions in metric units

Model No.	Size			Force	Weight
	A	B	C	N	G
ALCO-SP-19	19.1	7.5	3.7	28	13
ALCO-SP-28	28.6	8.5	4.8	45	36
ALCO-SP-38	38.1	10.4	4.8	125	80

ALNiCo Deep Pot



- Compact & lightweight ALNiCo Grade 5 magnets ideal for high temperature holding and clamping application.
- Temperature Upto 350° C.
- Red Painted coating.

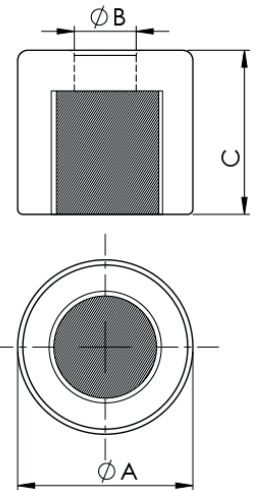

Product Code : ALCO-DP

All dimensions in metric units

Model No.	Dimensions			Force N	Weight G
	Dia (A)	B	C		
ALCO-DP-10	9.5	M3	15.1	10	5
ALCO-DP-12	12.7	M4	15.9	20	15
ALCO-DP-18	17.6	M6	16	26.5	23
ALCO-DP-20	20.5	M6	19	40	40
ALCO-DP-27	27	M6	25	61	85
ALCO-DP-35	35	M6	30	150	184
ALCO-DP-65	65	M12	43	400	460

ALNiCo HorseShoe Yoke



- Compact & lightweight ALNiCo Grade 5 magnets ideal for high temperature holding and clamping application.
- Temperature Upto 350° C.
- Red Painted coating.

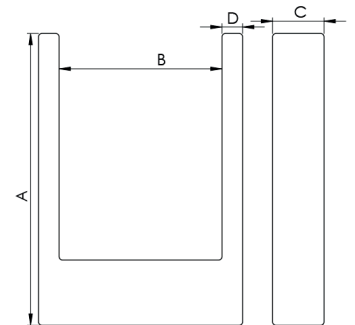

Product Code : ALCO-HSA

All dimensions in metric units

Model No.	Dimensions (mm)				Force (N)	Weight (Gms)
	A	B	C	D		
ALCO-HSA -85	85	48	15	6	58	230
ALCO-HSA -115	115	43.5	20	8	82	560

ALNICO POTS & HORSESHOE MAGNETS

PM

High Temperature, Versatile Holding & Clamping Pot Magnet

ALNiCo HorseShoe Arch



- Compact & lightweight ALNiCo Grade 5 magnets ideal for high temperature holding and clamping application.
- Temperature Upto 350° C.
- Red Painted coating.

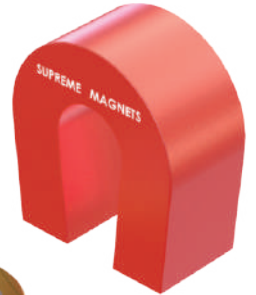
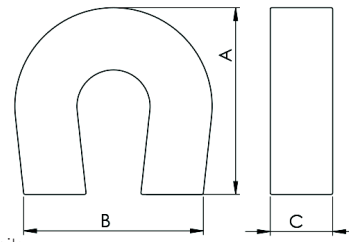

Product Code : ALCO-HSB

All dimensions in metric units

Model No.	Dimensions (mm)			Force N	Weight G
	A	B	C		
ALCO-HSB-8	22	11	8.5	21	13.5
ALCO-HSB-16	20	11	16	24	20

ALNiCo HorseShoe Inverted U



- Compact & lightweight ALNiCo Grade 5 magnets ideal for high temperature holding and clamping application.
- Temperature Upto 350° C.
- Red Painted coating.

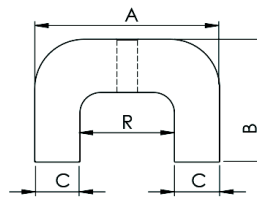
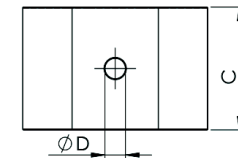

Product Code : ALCO-HSC

All dimensions in metric units

Model No.	Dimensions (mm)							Force N	Weight G
	A	B	C	D	E	F	G		
ALCO-HSC-22	22	17	25	7	7	8	9	42	75
ALCO-HSC-30	30	20	20	5.2	7.5	15	11	45	60
ALCO-HSC-40	40	25	25	5	10	20	13	86	120
ALCO-HSC-45	45	30	30	5	11	23	17	118	180

ALNiCo HorseShoe Pot



- Compact & lightweight ALNiCo Grade 5 magnets ideal for high temperature holding and clamping application.
- Temperature Upto 350° C.
- Red Painted coating.

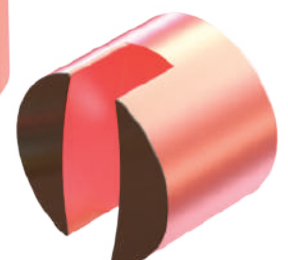
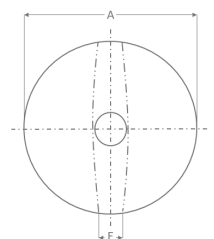
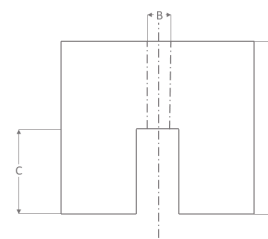

Product Code : ALCO-HSD

All dimensions in metric units

Model No.	Dimensions (mm)					Force N	Weight G
	A	B	C	D	E		
ALCO-HSD-13	12.7	4.4	4.8	9.6	4	7	6
ALCO-HSD-19	19.1	4.8	6.4	12.7	5.6	19	20
ALCO-HSD-25	25.4	4.8	7.9	15.9	5.6	29	50
ALCO-HSD-32	31.8	7.1	12.7	25.4	7.9	63	113

HOLDING / ANCHORING / FITTING



ROAD SWEEPER

PM

Road Sweeper Magnet Assembly



- Available in trolley mounted type models
- Operating height from 150mm.
- Sweeps the roads/shop floor and removes scattered iron particles.
- Magnets used are powerful Strontium Ferrite magnets.
- Quick actuation of lever for discharging of iron particles.
- Base Model of RS-1000 as building block and other models are built by combining RS-1000



Product Code: RS

All dimensions in metric units

Model	Dimensions (L x W x H)	Operating Height (mm)	Weight (Kgs)	Application
RS-1000	1000 x 300 x 100	150	85	Flat Road/Tarmac
RS-2000	2000 x 300 x 100	150	210	Flat Road/Tarmac
RS-3000	3000 x 300 x 100	150	310	Flat Road/Tarmac

These are manufactured as per customers' specification



- Ideal for airport, parking lots and factory roads.
- Very useful for repair shops, garage, fabrication, structural and assembling plants.
- Available upto 3000mm width.
- Larger units with built in diesel generator or battery operated can be made for effective cleaning and easier operation.

FORKLIFT SWEEPER

PM

Forklift Mounted Magnet Assembly

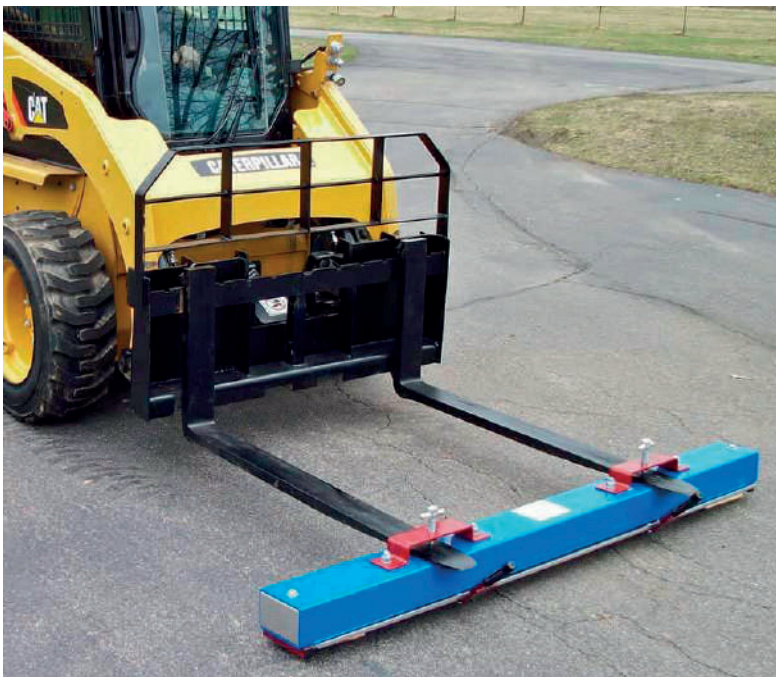

- Easily mounts on most forklifts.
- Constructed out of powerful Strontium Ferrite magnets.
- Lever actuated discharge.



- Fuss free maintenance of workshops, fabrication yards, factory premises.
- Zero maintenance device.

Product Code: YS

All dimensions in metric units

Model	Length	Coverage	Mounting Distance	Gr Wt (Kgs)	Application
YS-1400	1400	1400 x 100	860	115	Flat Road/Tarmac
YS-1800	1800	1800 x 100	1000	160	Flat Road/Tarmac





It's so much easier to set-up and hold my work with the On & Off Adjust-O Magnets because I'm not fighting the magnetic force."

- Jason T.



Demo Video

ADJUST-O™ MAGNET SQUARES

The fast & easy way to hold metal workpieces at 30°/60°, 45°, and 90°.

Turn the magnet Off or at the MID-POINT position when setting up, turn On when you're ready to work. Fast and safe set-up!

Ideal for round and square tubing, angle, and flat stock.

Easy to clean. Simply turn Off and wipe.

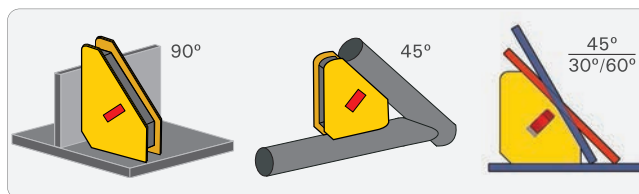

Made with strong rare earth magnets. Fully enclosed for easier cleaning.

On/Off Switch
Mid point switch position: for alignment / easy part placement.



DOUBLE Plate
Optimize magnetic force (-HD models)

Part No.	Max. Pull Force (kg)	Dimension (mm)	Weight (kg)
MSA45	30	110 x 95 x 25	0.5
MSA46-HD	40	110 x 95 x 29	0.7
MSA47	35	150 x 130 x 32	1.0
MSA48-HD	75	150 x 130 x 35	1.4
MSA53-HD	65	150 x 130 x 35	1.4

MSA53-HD



THIRD-AXIS MAGNETIC POSTS

Optional accessory for ALL MSA Magnets. Three posts per set. Quickly and easily set-up 3-sided work such as tank and gusset. Use on either side of the magnet squares.



Part No.	Max. Pull Force (kg)	Weight (kg)
MXE13	7	0.09

Adjust-O™ Dual Switch Magnet Squares

Angle magnet squares with the convenience of On/Off switches.



ADJUST-O™ 90° DUAL SWITCH MAGNET SQUARES

For professional jobs that demand strong hold down forces.

Holds flat and round metal work pieces.

- Two On/Off switches for independent operation.
- Turn the magnets Off when setting up, turn On when you're ready to work. Easy and safe set-up!
- Machined flat and V-surfaces are ideal for round and square tubing, angle, and flat stock.
- Choose from 55 - 120 kg pull force.



2 x On/Off Switch



V-Groove
For holding round & flat stock.

Part No.	Max. Pull Force (kg)	Dimension (mm)	Weight (kg)
MS2-80	55	152 x 152 x 38	1.2
MS2-90	120	197 x 197 x 48	2.7

ADJUST-O™ ANGLE MAGNET

- Adjustable from 30° - 275° with two On/Off switches.
- Machined flat surfaces and nickel/chrome body.
- V-Groove surfaces securely hold round and square tubing, angle, and flat stock.



Machined V-Groove
For holding round & flat stock.



Calibration w/ Vernier



2 x On/Off Switch

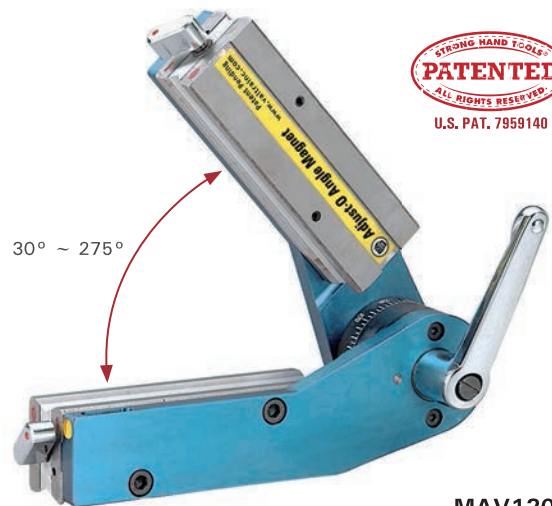

U.S. PAT. 7959140

MAV120

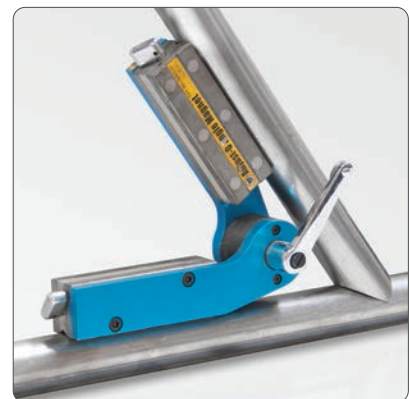

Adjustable Handle
For setting & locking the desired angle.



Part No.	Angles	Max. Pull Force (kg)	Dimension (mm)	Weight (kg)
MAV120	30° ~ 275°	50	197 x 197 x 95	2.4

Heavy Duty & Multi-Angle Magnets

Tools for sheet metal and large stock holding.

A-FRAME HD MAGNETS

For large and heavy stock holding.

Larger / wider magnets with large contact surface and stability. ON/OFF switches function with weaker force when lever at **MID-POSITION**, for adjustment / placement of parts.



Part No.	Max. Pull Force TOTAL (kg)	Dimension (mm)	Weight (kg)
MS2-300	120	330 x 330 x 32	3
MS2-450	300	550 x 550 x 45	11

STANDARD MAGNET SQUARES

Holding at multiple angles while soldering, brazing, and welding at 30°/60°, 45°, and 90°.

- Center hole for easy handling.
- Aluminium enclosed for easier cleaning.



MS346C
Multi-Angle

MS45
45°, 90°

MS60
60°, 90°

Part No.	Angles	Max. Pull Force (kg)	Dimension (mm)	Weight (kg)
MS346C	30°/60°, 45°, 90°	40	113 x 98 x 23	0.8
MS45	45°, 90°	30	113 x 98 x 19	0.5
MS60	60°, 90°	25	113 x 98 x 19	0.5

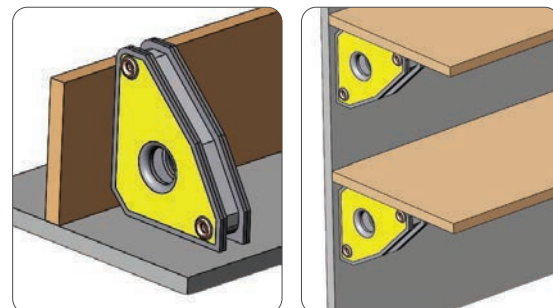

Mini & XYZ Magnet Squares

Unique 30°/60°, 45° and 90° angle combination.



MINI MAGNET SQUARES

Mini Magnets at just 58 mm in height provide low profile holding of stock in tight, hard to reach areas.

Use as many as needed for light duty holding of stock at multiple points.

Insert a screwdriver into the center hole to apply breakaway force.

Full aluminum rim enclosure for easy cleaning.



MS346AT
Mini Multi Angle

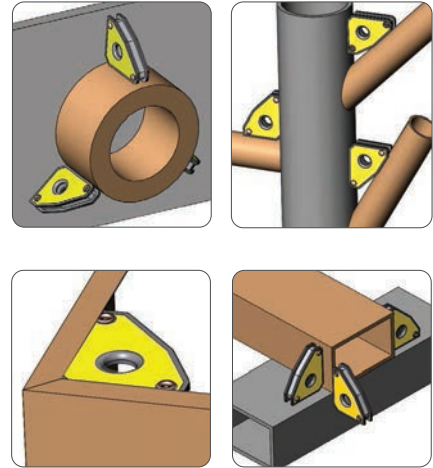

Part No.	Package	Angles	Max. Pull Force (kg)	Dimension (mm)	Weight (kg)
MS346AT	Twin Pack	30°/60°, 45°, 90°	10	59 x 50 x 16	0.3
MS346AK	6-Pack	30°/60°, 45°, 90°	10	59 x 50 x 16	0.8

XYZ MAGNET SQUARES

Quickly & easily set-up 2 or 3-Axis workpieces, such as gussets and steel panels.

Unique Magnetic Face Plate features two rare earth disc magnets for 3rd axis holding.

Rotate and **slide** Magnetic Face Plate into position as needed for each unique applications.

Use the face plate as an edge guide when joining square tubes and sheet metal.



MST348

Retractable, Rotatable Magnetic Face Plate

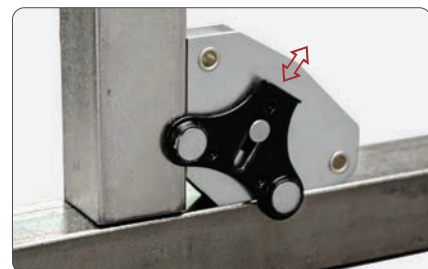

The face plate can be slid out of the boundary edges as edge guide.



Gusset Holding

Part No.	Package	Angles	Max. Pull Force (kg)	Dimension (mm)	Weight (kg)
MST348	Twin Pack	30°/60°, 45°, 90°	10	59 x 50 x 22	0.3

Inside Outside Angle Magnets

Hold stock using the Inside or Outside edges!



Hold stock from the outside when inside access is difficult.

Hold and position sheet metal, round pipes, square, angled or flat stock.

The Inside / Outside Angle Magnets are constructed from two independent rectangular magnets for consistent, undiminished magnetic force when both sides are attached to workpieces.

Use hex hole on magnet for breakaway leverage.



Demo Video

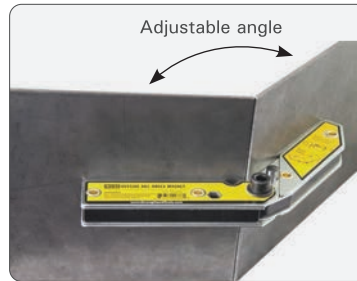

Part No.	Description	Height (mm)	Width (mm)	Thickness (mm)	Mag. Pull Force (kg)	Weight (kg)
MLDT350	Combo Pack, 1x MLD300 + 1x MLD500 (MLD300 and MLD500 not to be sold separately)					0.5
(MLD300) (MLD500)	Fixed Angle, 90°, 30°/60°	76 125	52 85	14 18	9 15	
MLD600	Fixed Angle, 90°, 30°/60°	165	110	20	18	0.8
MLA450	Adjustable Angle, 30 ~ 270°	120	120	18	12	0.5
MLA600	Adjustable Angle, 30 ~ 270°	156	156	20	15	0.9

Corner Magnets & V-Pad Kits

Ideal for positioning and holding sheet metal for butt welding.



CORNER MAGNETS

- Create 90° corners by holding from the outside, providing you with an unobstructed area for inside tack welds.
- One side corner "relief" provides clearance for tall lips.
- Use the outer edges of the Corner Magnet for setting up materials at 60°.

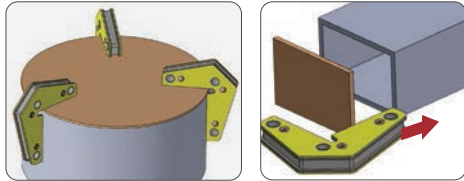

The compact and low profile Corner Magnet is ideal for light duty holding of stock at 90°.



Use the outer edges of the Corner Magnet to hold stock at 120°.

Part No.	Description	Dimension (mm)	Max. Pull Force (kg)	Weight (kg)
MST327	Twin Pack 90° & 60°	83 x 95 x 16	14	0,4

MAGHOLD™ V-PAD KITS

Light duty & tight spot holding! Build, Hold, and Position steel.

Hold and position round, flat, and square parts in light duty sub-assembly applications!

Small & Medium V-Pads

Magnets on both pad face & the bottom.

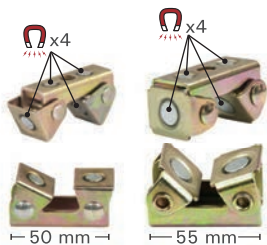

(XDV4) Max. Pull Force: 6 kg.
(XFV4) Max. Pull Force: 8 kg.

MVDF44

Medium & Large V-Pads

Magnets on the pad face only

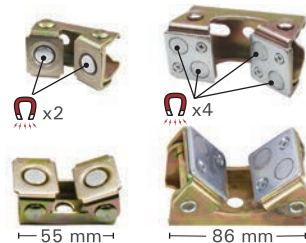

(XFV2) Max. Pull Force: 8 kg.
(XNV2) Max. Pull Force: 16 kg.

MVFN46

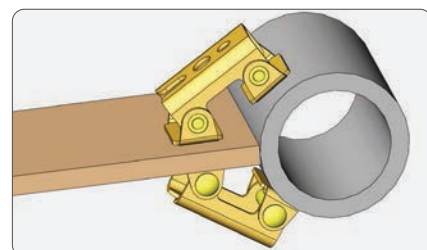
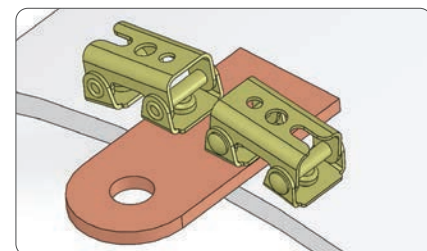
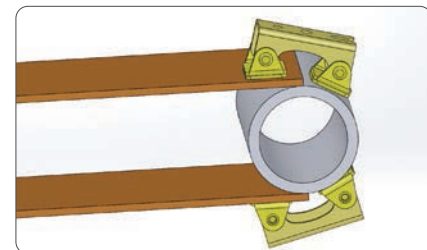

Part No.	Description	Kit Contents	Weight (kg)
MVDF44	Small & Medium V-Pads	2 pcs. V-Pads (XDV4) + 2 pcs. V-Pads (XFV4)	0,4
MVFN46	Medium & Large V-Pads	2 pcs. V-Pads (XFV2) + 2 pcs. V-Pads (XNV2)	1,1

MagTab Pro

More magnetic force, and a heavy duty build for larger tabs and metal pieces.

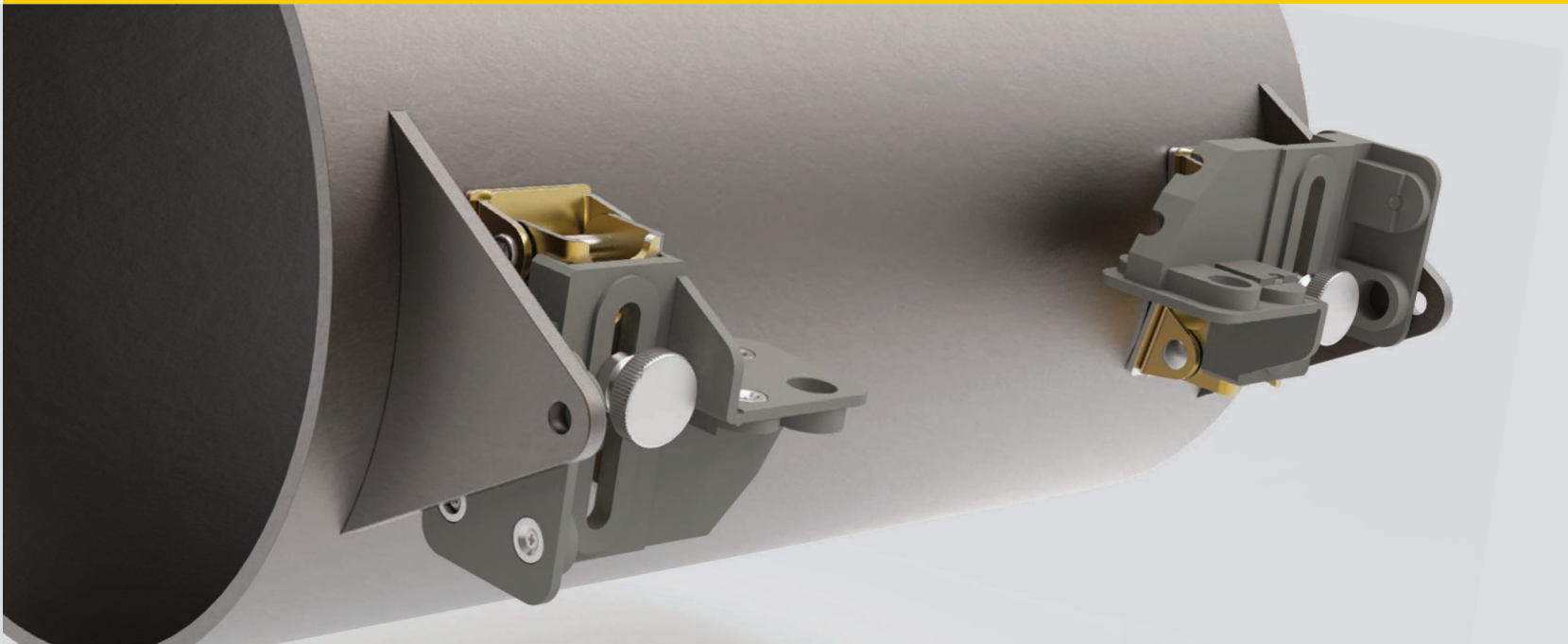

Designed and build from a single piece of cast aluminum, the MagTab PRO provides solid and sturdy magnetic holding of tabs in larger applications.

- **Replaceable Magnets:** MagTab PRO features fully replaceable magnets that allow you to quickly and easily change out weak or damaged magnets.
- **V-Pads:** The integrated V-Pad allows you to magnetically attach to various types of surface shapes; flat, curved or with multiple angles.
- Two 16 mm holes that allow you to use (optional) V-Blocks when needing to hold on to different diameter size tubes.

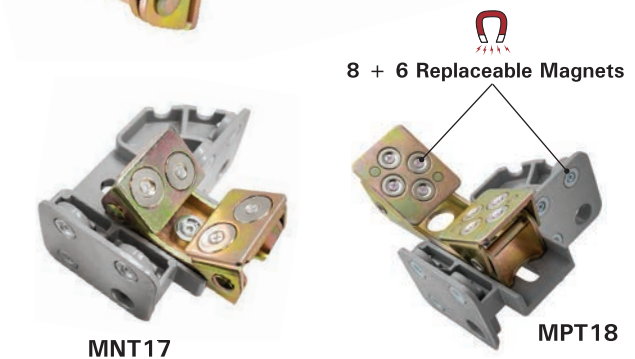
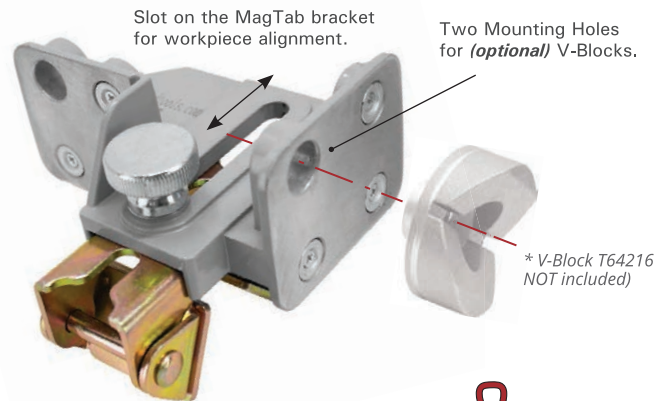
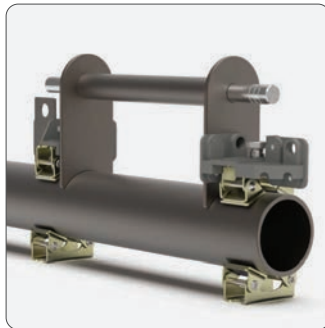
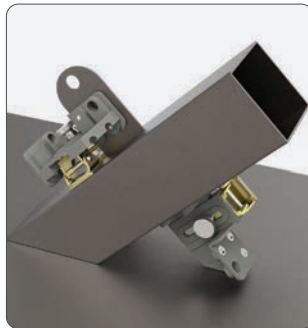

Part No.	Dimension (mm)	Max. Pull Force (kg)	Weight (kg)
MNT17	130 x 99 x 86	15	0.8
MPT18	162 x 135 x 89	30	0.9

Part No.	Descriptions	Weight (kg)
MRP9	Replacement Magnets for MNT17, 4 + 6 pc.	0.04
MRP13	Replacement Magnets for MPT18, 8 + 6 pc.	0.09

*Magnetic force is based on 10 mm flat steel surface.

Large Diameter Pipe Pliers & Pipe Joint Pliers

Large capacity pliers hold up to 150 mm diameter pipe.

NEW ITEM

LARGE DIAMETER PIPE PLIERS

The V-Pad holds round, square, or angled stock in different sizes.

V-Pad on top jaw and spindle on the bottom jaw securely clamp the round pipe against a flat surface.

Quick-release trigger and unique crank handle for fast, easy jaw opening and pressure adjustment.

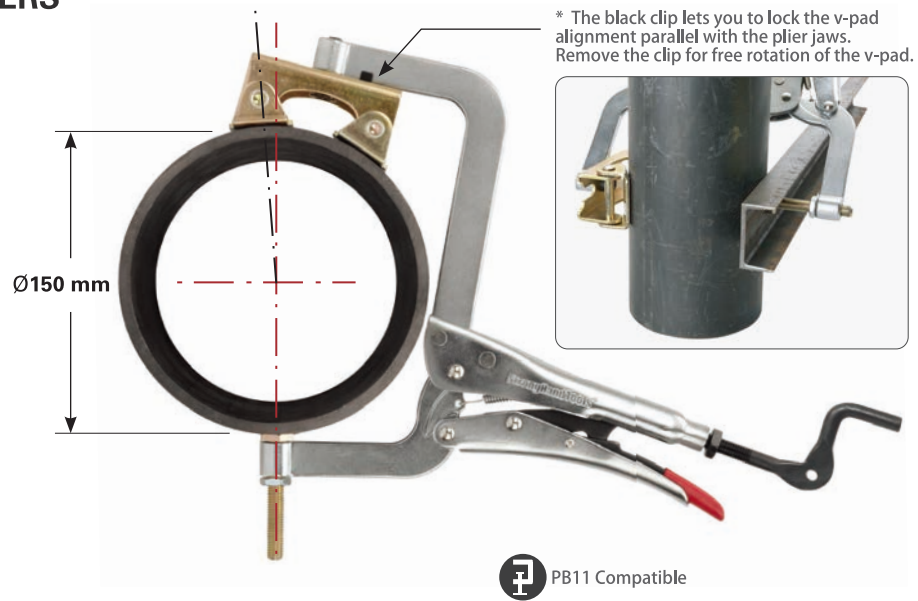
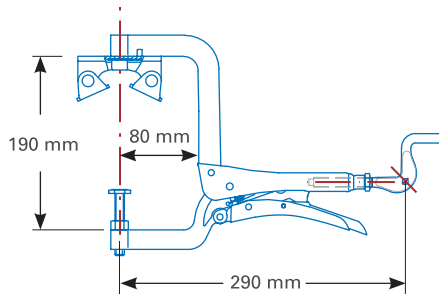

Part No.	MAX Clamping Capacity	Thread	Weight (kg)
PG1107V	150 mm Diameter	M10	1.3

NEW ITEM

PIPE JOINT PLIERS

- Hold tight, for load-bearing, as much as 22 kg.
- V-Pad on top jaw and spindle on the bottom jaw securely clamp the round pipe against a flat surface.
- Two aluminum V-Blocks on the aluminum bracket can be used with additional pliers or clamps for holding on to different diameter size tubes at different angles.

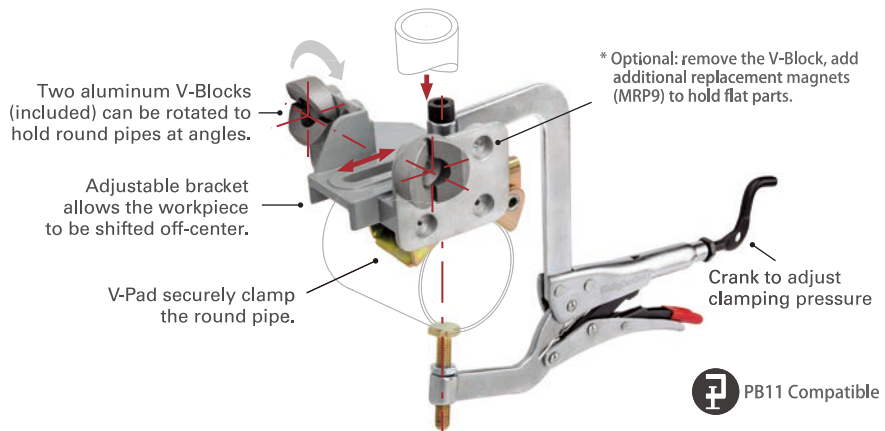

Use with Utility Clamp w/ Clip-on Top V-Pad to hold pipe at 90 degree



Use w/ MagSpring Clamp to join pipe at angle



Use w/ Locking C-Clamp to hold square piece

Part No.	Throat Depth (mm)	MAX Clamping Capacity (mm)	Thread	Weight (kg)
PPJ634	75	63.5	M8	0.7
PPJ1107	80	130	M10	1.7

Pipe Alignment and Fit-Up Clamps

The efficient way to accurately fit-up round pipes for butt welding.

PIPE ALIGNMENT CLAMPS WITH QUICK-ACTING LEVER

The New Pipe Alignment Clamp with Quick-Acting Lever is a fast, accurate fit-up clamp with a rugged frame.

Get a well-balanced hold on the clamp with the two wide Grip Plates while pressing the Quick-Acting Lever. The screw smoothly glides up and down for fast insertion and removal after welding.

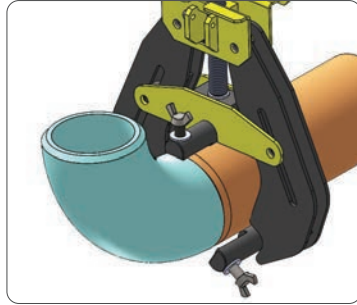

Pipe to Elbow

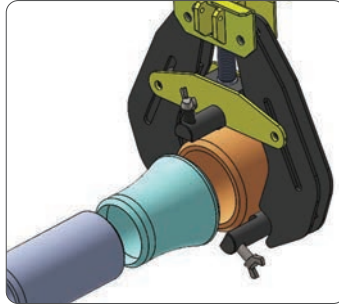

Pipe to Reducer

Part No.	Pipe Diameter Capacity (mm)	Weight (kg)
CPA60	50 ~ 152	5.0
CPA120	114 ~ 305	7.8

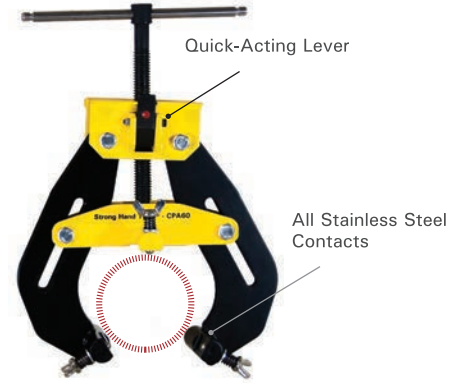

PRESS - SLIDE - SET

Wide Grip Plates make this Pipe Alignment Clamp easier to handle, with less user fatigue.

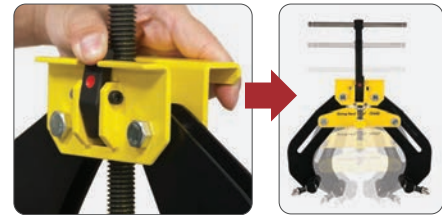

PIPE FIT-UP CLAMPS

A compact, light weight, portable clamp for the quick fit-up of round pipes and flanges for butt welding. 50 - 75% lighter than traditional alignment clamp. Easy-to-Use design for the rapid, repeated loading and unloading of workpieces.

Pre-set clamp opening for fast setup:

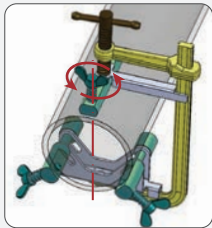

Turn three adjustment screws to preset.

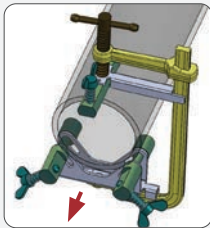

Loosen the main clamp arm.

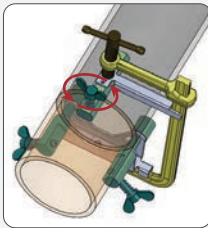

Tighten the main clamp arm.

Part No.	Pipe Diameter Capacity (mm)	Overall Length (mm)	Weight (kg)
CPL45	50 ~ 100	240	1.3
CPL75	100 ~ 140	305	2.1



Demo Video

All Stainless Steel Contacts
89 mm L Clamp Rods



Fine Adjustment Screws

Grounding Magnets, Clamps & Pliers

High clamping pressure improves arc stability and reduces power consumption.

NEW ITEM

POWERBASE™ GROUNDING MAGNETS

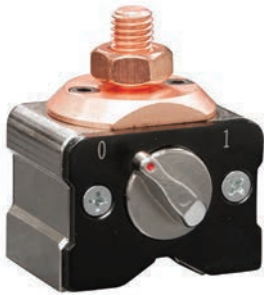

Turn OFF the PowerBase™ Grounding Magnet and metal chips fall away.

Power through your grounding applications! Start grounding instantly!

- The PowerBase™ Grounding Magnet sets up quickly and easily.
- Powerful rare earth magnet delivers heavy duty holding power.
- The "V" machined surface grips round parts.
- The copper connector stud allows for better conductivity.



Large copper connector for better conductivity.



Holds securely onto round or flat surfaces.



The ON/OFF Lever is easy to turn, even while wearing gloves.

Part No.	Amperage	Dimension (mm)	Magnetic Force (kg)	Weight (kg)
GM203	300A @ 60% Duty Cycle	50 x 50 x 64	20	0.5
GM205	500A @ 60% Duty Cycle	50 x 70 x 64	50	0.8

GROUNDING CLAMP

Clamping + Grounding at the same time.

Consistently rated at 300 AMPS

Solid, insulated copper U-Channel rotates for easy access and can attach to round / odd-shaped parts.

GB428M

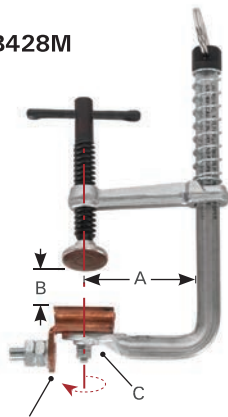

Insulated copper contact swivels



GROUND HOG™ CLAMP

Insulated Grounding Contact

The groove design on the copperhead seals out weld spatter and reduces particle buildup. Side screw provides a secure cable connection. Ground Hog body rotates for cable positioning.

- Controls the electrical current by isolating the contact surface and the cable connection.
- Improve arc stability and cable life, and reduce power consumption.

GP950

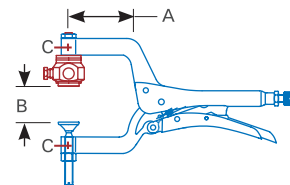

Ground Hog™
Rated at 450 AMPS @ 60% duty cycle (with 2/0 cable)

Part No.	Amperage / Cable Size	Throat Depth (A) (mm)	Max. Capacity (B) (mm)	Tapped Hole (C)	Clamping Pressure (kg)	Overall Length (mm)	Weight (kg)
GB428M	300A / --	64	75	M6	100	180	0.4
GP950	450A / 2/0 - 10.8 mm	89	64	M10	180	280	1.1

Grasshoppers

Use the "third hand" to steady parts for tack welding! Safe and convenient!

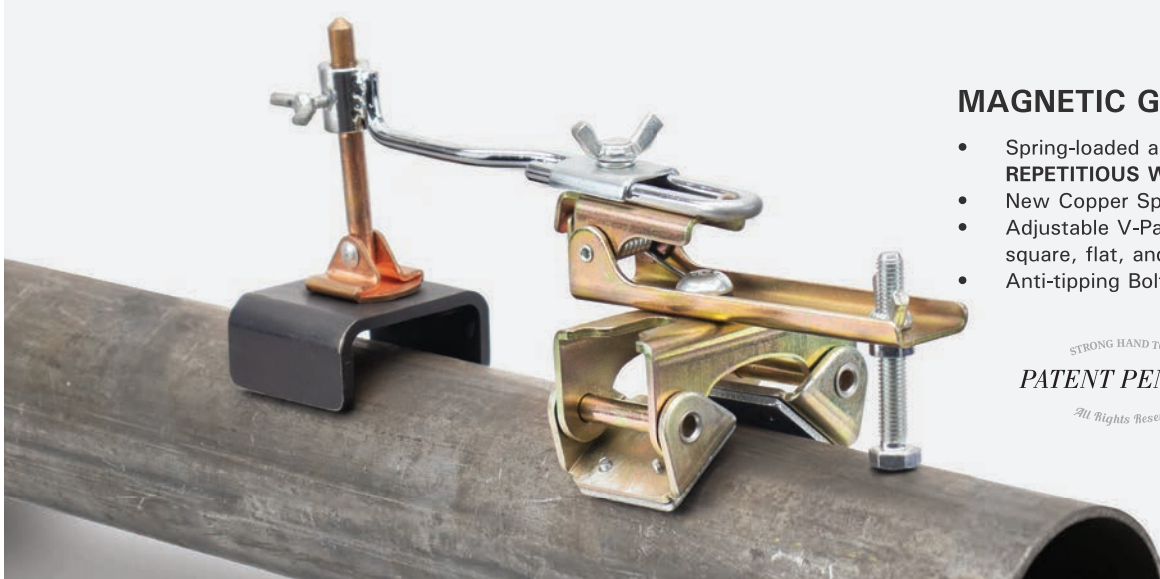

MAGNETIC GRASSHOPPERS

- Spring-loaded arm self-adjusts for REPETITIOUS WORK HOLDING.
- New Copper Spindle (deluxe model).
- Adjustable V-Pad Base adapts to: round, square, flat, and angled surfaces.
- Anti-tipping Bolt provides stability.

STRONG HAND TOOLS®
PATENT PENDING
 All Rights Reserved.

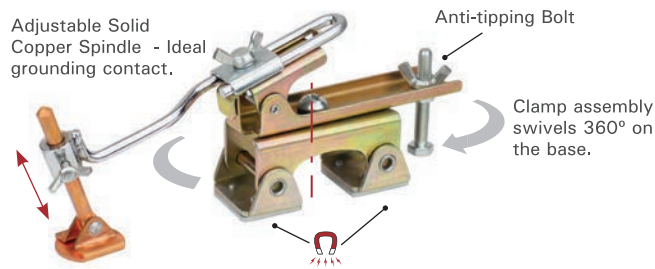

DELUXE MODEL - AGH240 / AGH270

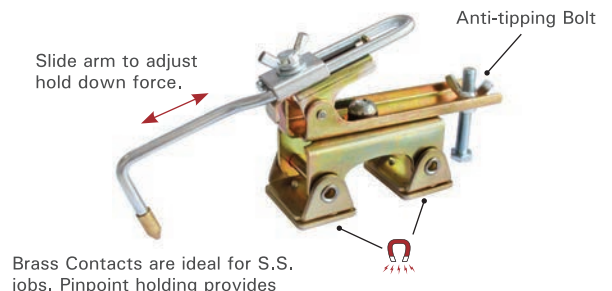

Brass Contacts are ideal for S.S. jobs. Pinpoint holding provides maximum clearance for tack welds.

AGH200 / AGH230

Part No.	Feature	Magnetic V-Pad Base	Anti-tipping Bolt	Max. Overall Length (mm)	Width x Height (mm)	Weight (kg)
AGH240	Copper Spindle	✓	✓	190	64 x 88	0.4
AGH270	Copper Spindle	✓	✓	250	100 x 115	0.8
AGH200	Brass Contact	✓	✓	203	64 x 76	0.3
AGH230	Brass Contact	✓	✓	234	100 x 100	0.6

STANDARD GRASSHOPPERS

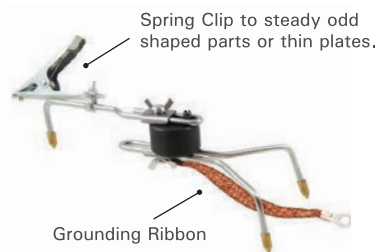

Pro Model - AGH130P



Econo Model - AGH130



Demo Video



Part No.	Product Includes	Max. Overall Length (mm)	Width x Height (mm)	Weight (kg)
AGH130P	Three Brass Contacts, Copper Ribbon, Spring Clip Attachment	300	114 x 100	0.7
AGH130	Brass Contact	300	114 x 100	0.7

MIG Torch Rests

Maximize comfort, productivity, and safety in welding!

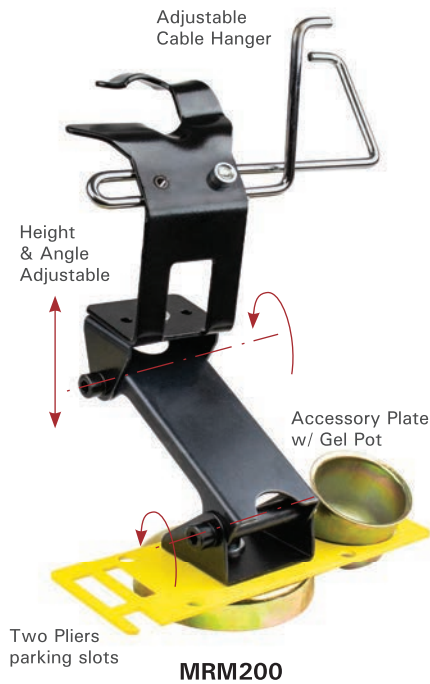

MRM200



MRM100



Park N' Snip

MRM300

- **MRM100** is Basic Model includes Adjustable Cable Hanger, Angled anti-spatter Gel Pot and two Pliers parking slots (MIG Pliers sold separately)
- **MRM200** is Height and Angle Adjustable.
- **MRM300** is Deluxe Model includes Park N' Snip feature.

STRONG HAND TOOLS®
PATENT PENDING
All Rights Reserved.



This deluxe MIG Rest includes the Park N' Snip feature!

Cut your MIG wire to the ideal length without taking off your gloves! Get a precise cut every time, without guesswork.

Insert your MIG Pliers through the two slots, rest your nozzle on the parking plate, and snip. Now you can easily trim the wire to the ideal length for better weld control.

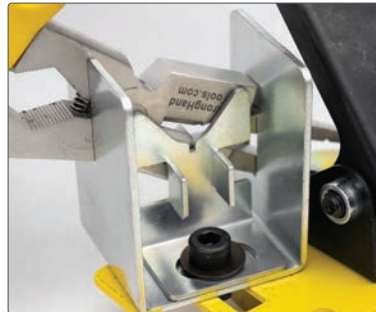

Part No.	Model	Description	Height (mm)	Weight (kg)
MRM100	Basic	MIG Torch Rest with Cable Hanger & Accessory Plate	150	1.0
MRM200	Adjustable	MIG Torch Rest with Cable Hanger & Accessory Plate, Adjustable Height	180 ~ 310	1.5
MRM300	Deluxe	MIG Torch Rest with Cable Hanger & Deluxe Accessory Plate, Adjustable Height	180 ~ 310	1.8