

Versatile Multi-Purpose, Holding, Anchoring & Clamping Pot Magnet

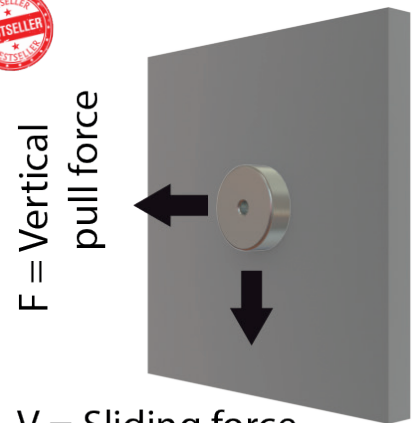

- Compact & Lightweight powerful pot magnet, ideal for absolutely any clamping application.
- An invaluable fixturing tool for fabricators and engineers who may be looking for attractive mechanism to clamp any item to a steel base.
- Hang various tools & equipment overhead without need for welding any temporary hooks.
- Fabricate your own unique clamping solution.
- Clamping force from 4 to 160 Kg (on 50mm thick MS Plate).
- Suitable for application upto 80Deg C only.



F = Vertical pull force

V = Sliding force = 1/4 Vertical force

SRBM-NA : Round Base Magnet with Countersunk Hole

Model	D (mm)	d (mm)	d1 (mm)	H (mm)	Unit Weight (g)	Adhesive Force (Kgs)	Sliding Adhesive Force (Kgs)
SRBM-NA10	10	3.5	6.5	4.5	3	1	0.2
SRBM-NA12	12	3.5	6.5	4.5	4	1.5	0.3
SRBM-NA16	16	3.5	6.5	5	7	6	1.2
SRBM-NA20	20	4.5	8.6	7	15	11	2.2
SRBM-NA25	25	5.5	10.6	8	24	22	4.4
SRBM-NA32	32	5.5	10.6	8	39	32	6.4
SRBM-NA36	36	6.5	11.3	8	50	43	8.6
SRBM-NA42	42	6.5	11.3	8.6	77	65	13
SRBM-NA48	48	8.5	15.5	11	120	75	15
SRBM-NA60	60	8.5	14.5	15	243	160	32
SRBM-NA70	70	10.5	16.5	17	440	200	40
SRBM-NA75	75	10.5	16.5	18	480	250	50
SRBM-NA80	80	10.5	16.5	18	655	280	56
SRBM-NA90	90	10.5	16.5	18	822	360	72
SRBM-NA120	120	12.5	22.5	18	1420	480	96

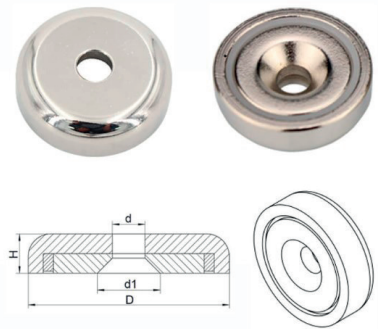

SRBM-NB : Round Base Magnet with Cap Screw Hole

Model	D (mm)	d (mm)	d1 (mm)	H (mm)	Unit Weight (g)	Attractive force (kg)	Sliding Adhesive Force (Kgs)
SRBM-NB12	12	3.5	6.5	4.5	4	1.5	0.3
SRBM-NB16	16	3.5	6.5	5	7	5	1
SRBM-NB20	20	4.5	8	7	13	10	2
SRBM-NB25	25	5.5	9	8	22	20	4
SRBM-NB32	32	5.5	9	8	38	30	6
SRBM-NB36	36	6.5	11	8	48	40	8
SRBM-NB42	42	6.5	11	8.6	75	60	12
SRBM-NB48	48	8.5	15	11	114	70	14
SRBM-NB60	60	8.5	15	15	235	150	30
SRBM-NB75	75	10.5	18	18	460	230	46

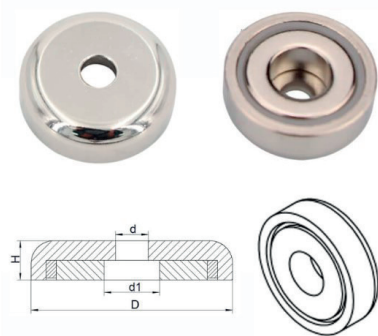

Instructions :

The adhesive force indicated for each part are under ideal conditions and refer to the Vertical pulling force on a 10mm thick mild steel grinded finish wall. Sliding forces are typically one-fifth of Vertical forces. Thinner steel walls or platforms will also derate the pulling forces.

Therefore you should design your application suitably, taking account of the forces in play. For eg., you will fail trying to hang a bucket of water weighing 40 kgs using an RBM NA-42 (65 Kg Adhesive force) from a 10mm thick steel wall. The NA-42 has only about 13 Kgs Sliding force resistance (65/5 Kg). You should try using the NA-75 (230/5) or 4 units of NA42 (4 x 65/5) instead.



Versatile Multi-Purpose, Holding, Anchoring & Clamping Pot Magnet

SRBM-NC : Round Base Magnet with Bolt

Model	D (mm)	M	H (mm)	h (mm)	Unit weight (g)	Vertical Adhesive force (kg)	Sliding Adhesive force (kg)
SRBM-NC10	10	3	12	5	4	1.5	0.3
SRBM-NC12	12	3	12	5	5	2	0.4
SRBM-NC16	16	4	14	5	9	8	1.6
SRBM-NC20	20	4	16	7	16	12	2.4
SRBM-NC25	25	5	17	8	26	25	5
SRBM-NC32	32	6	18	8	43	34	6.8
SRBM-NC36	36	6	17.6	8	54	50	10
SRBM-NC42	42	6	18.7	8.6	83	72	14.4
SRBM-NC48	48	8	24	11	130	81	16.2
SRBM-NC60	60	8	28	15	256	160	32
SRBM-NC75	75	10	35	18	510	270	54

Vertical adhesive force is measured perpendicular to a 10mm mild steel plate

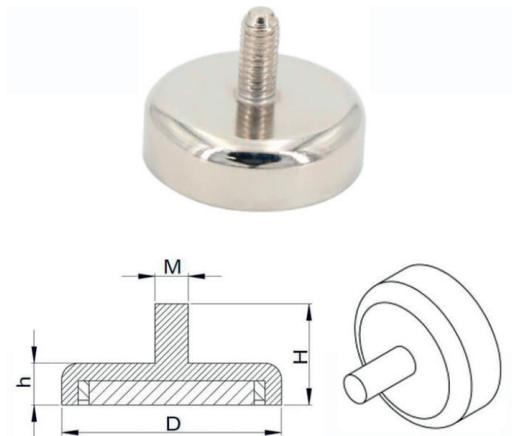

SRBM-ND : Round Base Magnet with Stud

Model	D (mm)	d (mm)	M	H (mm)	h (mm)	Unit weight (g)	Vertical Adhesive force (kg)	Sliding Adhesive force (kg)
SRBM-ND10	10	6	3	12.6	5	4	1.5	0.3
SRBM-ND12	12	6	3	12.6	5	5	2	0.4
SRBM-ND16	16	6.5	4	13.5	5	9	8	1.6
SRBM-ND20	20	6.5	4	15	7	17	12	2.4
SRBM-ND25	25	7.5	5	17	8	28	25	5
SRBM-ND32	32	10	6	18	8	45	34	6.8
SRBM-ND36	36	10	6	18.5	8	55	50	10
SRBM-ND42	42	10	6	18.8	8.6	84	72	14.4
SRBM-ND48	48	12	8	24	11	130	81	16.2
SRBM-ND60	60	12	8	28	15	263	160	32
SRBM-ND75	75	17	10	35	18	515	270	54

Vertical adhesive force is measured perpendicular to a 10mm mild steel plate

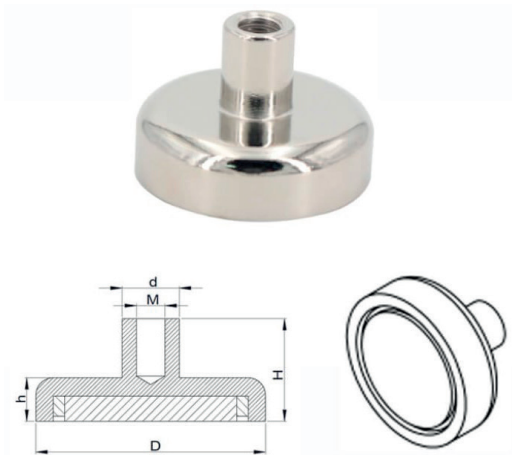

SRBM-NE : Round Base Magnet with Hook

Model	D (mm)	d (mm)	M	h1 (mm)	h (mm)	H (mm)	Unit weight (g)	Vertical Adhesive force (kg)	Sliding Adhesive force (kg)
SRBM-NE10	10	6	3	12.6	5	31.5	5	1.5	0.3
SRBM-NE12	12	6	3	12.6	5	31.5	7	2	0.4
SRBM-NE16	16	6.5	4	13.5	5	35.7	12	8	1.6
SRBM-NE20	20	6.5	4	15	7	37.8	21	12	2.4
SRBM-NE25	25	7.5	5	17	8	44.9	33	25	5
SRBM-NE32	32	10	6	18	8	47.8	54	34	6.8
SRBM-NE36	36	10	6	18.5	8	49.8	64	50	10
SRBM-NE42	42	10	6	18.8	8.6	50	93	72	14.4
SRBM-NE48	48	12	8	24	11	61	150	81	16.2
SRBM-NE60	60	12	8	28	15	66	283	160	32
SRBM-NE75	75	17	10	35	18	85	555	270	54

Vertical adhesive force is measured perpendicular to a 10mm mild steel plate



Versatile Multi-Purpose, Holding, Anchoring & Clamping Pot Magnet

SRBM-NF : Round Base Magnet with Eye-Bolt

Model	D (mm)	d (mm)	M	h1 (mm)	h (mm)	H (mm)	Unit weight (g)	Vertical Adhesive Force (kg)	Sliding Adhesive Force (kg)
SRBM-NF10	10	6	3	12.6	5	31.5	5	1.5	0.3
SRBM-NF12	12	6	3	12.6	5	31.5	7	2	0.4
SRBM-NF16	16	6.5	4	13.5	5	35.7	12	8	1.6
SRBM-NF20	20	6.5	4	15	7	37.8	21	12	2.4
SRBM-NF25	25	7.5	5	17	8	44.9	33	25	5
SRBM-NF32	32	10	6	18	8	47.8	54	34	6.8
SRBM-NF36	36	10	6	18.5	8	49.8	64	50	10
SRBM-NF42	42	10	6	18.8	8.6	50	93	72	14.4
SRBM-NF48	48	12	8	24	11	61	150	81	16.2
SRBM-NF60	60	12	8	28	15	66	283	160	32
SRBM-NF75	75	17	10	35	18	85	555	270	54

Vertical adhesive force is measured perpendicular to a 10mm mild steel plate



SRBM-NG : Round Base Magnet with Swivel Hook

Model	D (mm)	d (mm)	d1 (mm)	h (mm)	H (mm)	L (mm)	W (mm)	l (mm)	Unit weight (g)	Vertical Adhesive force (kg)	Sliding Adhesive force (kg)
SRBM-NG25	25	20	13.5	8	15.5	55	23	24	38	17	3.4
SRBM-NG32	32	20	13.5	8	15.5	55	23	24	52	30	6
SRBM-NG36	36	20	13.5	8	15.1	55	23	24	65	40	8
SRBM-NG42	42	20	13.5	8.6	16.5	55	23	24	92	60	12

Vertical adhesive force is measured perpendicular to a 10mm mild steel plate

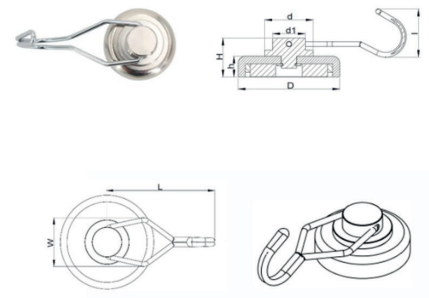

SRBM-NH : Round Base Magnet with Tapped Thru Hole

Model	D (mm)	H (mm)	M	Unit weight (g)	Vertical Adhesive force (kg)
SRBM-NH16	16	5.2	3	7	4
SRBM-NH20	20	7.2	4	14	8
SRBM-NH25	25	7.7	5	25	17
SRBM-NH32	32	7.8	5	44	27
SRBM-NH36	36	7.6	6	55	36
SRBM-NH42	42	8.8	6	86	55

Vertical adhesive force is measured perpendicular to a 10mm mild steel plate

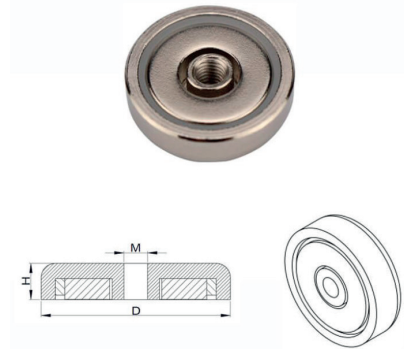

SRBM-NI : Round Base Magnet with Carabiner

Model	D (mm)	d (mm)	d1 (mm)	d2 (mm)	W (mm)	H (mm)	h (mm)	Unit weight (g)	Vertical Adhesive force (kg)
SRBM-NI25	25	12	4	5	5	17.7	8	30	17
SRBM-NI32	32	12	4	5	5	17.6	8	47	28
SRBM-NI36	36	15	5	5	5	17.8	8	59	35

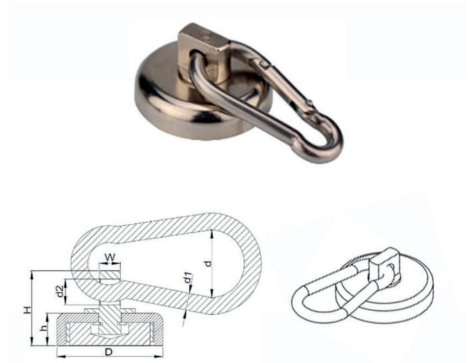

Versatile Multi-Purpose, Holding, Anchoring & Clamping Pot Magnet

CM : Double Countersunk Channel magnet

Model	L (mm)	CM (mm)	W (mm)	H (mm)	d (mm)	d1 (mm)	Unit weight (g)	Vertical Adhesive force (kg)
CM-40	40	30	13.5	5	3.3	6.5	19	17
CM-50	50	40	13.5	5	3.3	6.5	23	27
CM-60	60	50	13.5	5	3.3	6.5	28	30
CM-80	80	70	13.5	5	3.3	6.5	38	33
CM-100	100	90	13.5	5	3.3	6.5	47	36
CM-120	120	110	13.5	5	3.3	6.5	57	40

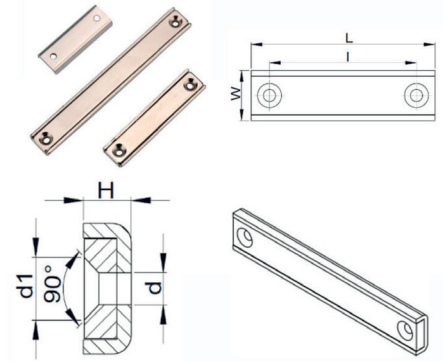

Fishing Magnets

Neodymium fishing magnet, with stainless steel hook, nickel coating. Ideal for retrieval of underwater objects, anchoring aids for divers, handy all purpose hooking points.

SRBM-NP1 : Round Base Fishing Magnet with 1 hanging point c/w Eye-Bolt

Model	D (mm)	H (mm)	L (mm)	d (mm)	d1 (mm)	M1 M2	Unit weight (g)	Breakaway Single Side (kg/lb)
SRBM-NP1-48	48	18	86	20	35	M8	280	80 / 175
SRBM-NP1-60	60	22	98	20	35	M8	420	135 / 300
SRBM-NP1-75	75	25	119	25	42	M10	885	220 / 500
SRBM-NP1-94	94	28	138	25	42	M10	1540	300 / 650
SRBM-NP1-116	116	32	167	29	47	M12	2435	450 / 1000
SRBM-NP1-136	136	34	187	29	47	M12	3355	600 / 1350

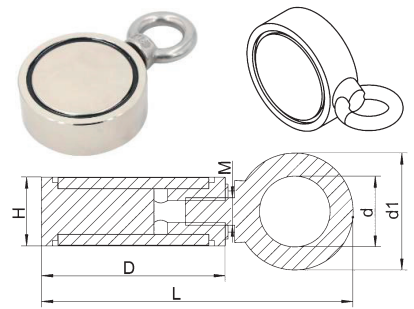

SRBM-NP2 : Round Base Fishing Magnet with 2 hanging points c/w Eye-Bolt

Model	D (mm)	h (mm)	H (mm)	L (mm)	d (mm)	d1 (mm)	M1 M2	Unit weight (g)	Breakaway Single Side (kg/lb)
SRBM-NP2-48	48	18	58	83	19.5	34.5	M8	211	70 / 160
SRBM-NP2-60	60	22	66	95	19.5	34.5	M8	551	135 / 300
SRBM-NP2-75	75	25	77	110	25	41.5	M10	945	220 / 500
SRBM-NP2-94	94	28	85	129	25	41.5	M10	1600	300 / 650
SRBM-NP2-116	116	32	92	160	29	47	M12	2745	450 / 1000
SRBM-NP2-136	136	34	92	190	29	47	M12	3580	600 / 1350

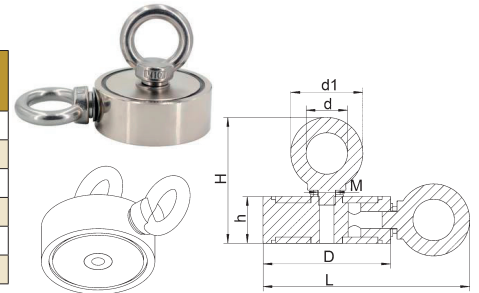

Rubber Coated Neodymium Pot Magnets

Rubber coated magnets, also known as weatherproof magnets, are made by Neodymium magnet, stainless steel and durable rubber coating. The protective rubber coating protects magnets from chipping, liquid, and corrosion. Thus can be regarded as an ideal solution for both indoor and outdoor holding applications which need high magnetic strength. Rubber coated magnets are frequently served to holding, mounting, and fixing purposes, in the meanwhile, the high friction of the rubber coating also achieved attractive force enhancement on the vertical surface.

SRBM-RNA : Round Base Rubber Coated Neodymium with Nut Type (A Type)

Model	D (mm)	Screw thread	d (mm)	h (mm)	H (mm)	Unit weight (g)	Vertical Adhesive force (kg)	Sliding Adhesive force (kg)
SRBM-RNA22	22	M4/M5/M6	8	6	11.5	11	3.5	2
SRBM-RNA34	34	M4/M5/M6	8	6	11.5	19	7.5	4
SRBM-RNA43	43	M4/M5/M6	8	6	10.5	31	10	5
SRBM-RNA66	66	M5/M6/M8	12	8	13.5	100	20	10
SRBM-RNA88	88	M6/M8/M10	12	8	13.5	179	42	21

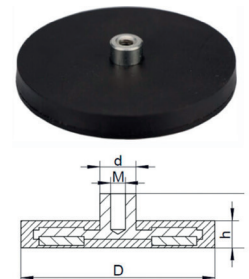

SRBM-RNB : Round Base Rubber Coated Neodymium with Bolt Type (B Type)

Model	D (mm)	Screw thread	h (mm)	H (mm)	Unit weight (g)	Vertical Adhesive force (kg)	Sliding Adhesive force (kg)
SRBM-RNB22	22	M4/M5/M6	6	13	11	3.5	3.5
SRBM-RNB34	34	M4/M5/M6	6	21	22	7.5	7.5
SRBM-RNB36	36	M4/M5/M6	7	22	27	8	8
SRBM-RNB43	43	M4/M5/M6	6	21	34	10	10
SRBM-RNB66	66	M5/M6/M8	8	23	100	20	20
SRBM-RNB88	88	M6/M8/M10	8	23	184	42	42

