

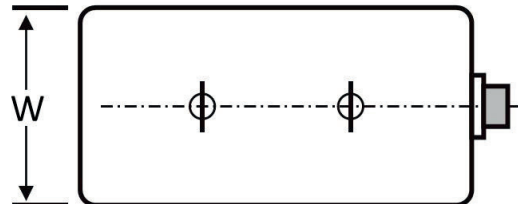

- Widely used for drilling, tapping, and robotic fixturing
- These magnets speed up the set-up process and allow for precise alignment
- These magnets also have consistent clamping pressure across the entire surface
- These magnets are available with fixed leads. The length of leads can be increased with connectors
- Pulling power figures are under ideal conditions and represent maximum tensile strength

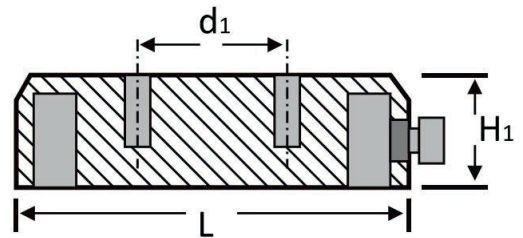

- Widely used for parts transfer, positioning, clamping, and robotic applications
- These magnets have a durable steel case and copper wound coil sealed in high temperature epoxy for years of watertight maintenance-free operation
- Available in 12/24VDC Continuous duty models



RECTANGULAR ELECTRO FLEXILIFT DIMENSION CHART

Dimensions are subject to slight changes due to continuous upgradation of product.

EFLR—Electro Flexi Lift Rectangular

All dimensions in metric units

Model EFLR	L	W	H1	D1/M (2x)	V1(DC)	A1(Amp)	V2(DC)	A2(Amp)	W1 W2(Watt)	Force(Kgs)
302020	30	20	20	10/M4	12	0.18	24	0.1	2 2.4	4
402020	40	20	20	18/M4	12	0.25	24	0.12	3 3	10
502520	50	25	20	25/M5	12	0.22	24	0.15	2.5 3.5	25
502525	50	25	25	25/M5	12	0.33	24	0.16	4 4	30
603025	60	30	25	30/M8	12	0.42	24	0.2	5 5	40
603030	60	30	30	30/M8	12	0.42	24	0.22	5 5	40
703530	70	35	30	35/M8	12	0.45	24	0.32	5.5 7.5	80
804030	80	40	30	40/M8	12	0.55	24	0.42	6.5 10	90
904030	90	40	30	45/M8	12	0.6	24	0.45	7 10	100
1003530	100	35	30	50/M8	12	0.6	24	0.4	7.2 9.5	100
1005040	100	50	40	50/M8	12	1	24	0.6	12 14	120
1204030	120	40	30	50/M8	12	0.8	24	0.45	9.5 11	150
1205040	120	50	40	70/M8	12	1	24	0.55	12 13	200
1206050	120	60	50	70/M8	12	1.2	24	0.6	14 14	240

Due to continuous upgradation in design there could be changes in specification. Other sizes on request. Before ordering, contact Supreme Magnets or your nearest dealer to confirm the suitability of this model for your application.

