

Rectangular Electro Lifting Magnet



- Easy & Speedy handling of Plates / Billets / Bundles / Rails / Coils / Beams.
- Available in Normal duty & Heavy-duty series.
- Manufactured in monobloc casted construction or fabricated welded construction depending on budget and application.
- Choice of Aluminum or Copper conductor with special H-C class insulation.
- Completely sealed with thermal conductive compound and protected terminal box.
- Operates on 220 VDC.
- Duty cycle available from 50% to 75%.



- Useful for production and stock yards.
- Loading/unloading of steel plates/ billets/ bars /blooms from trucks.
- Handles slabs, blooms and ingots.
- Can be used with mobile cranes.
- Can be used in tandem from spreader beam.
- Special design for handling large coils.



Normal Duty Construction

- Suitable for any ferrous material handling needs.
- For use in yards to heavy-duty steel industries.
- High-strength ribs and two protection shield of non-magnetic steel.
- Fabricated or Monobloc construction.
- 50 to 75% ED : To specify.

Heavy Duty Construction

- Suitable for high temperature ferrous material handling at 600 deg.
- For use in heavy-duty steel industries.
- High-strength ribs and two protection shield of non-magnetic steel.
- High strength alloy steel suspension chains.
- Monobloc construction.
- 50 to 75% ED : To specify.

For billet handling - one variation	For coiled bar handling	For high temperature applications	For I Beam handling	For normal temperature applications	For slab turning applications

Different configurations for different types of load

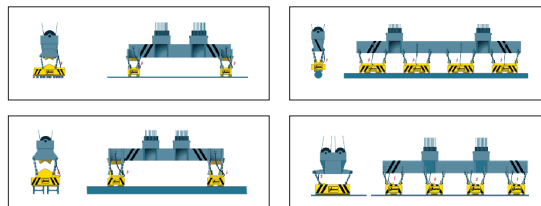

- Bi-polar magnet for coil handling upto dia 1200 x 3000mm long.

EMLR-Billets



- Special pole extension blocks can stretch out and draw back freely after contacting the attached material.
- Consequently it can obtain the maximum contacting area.
- Suitable for lifting many pieces of different length of blooming billets, pipe billets and stagger arrangement cast ingots.

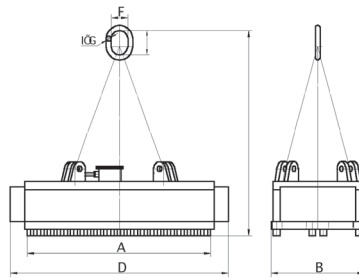

25 Ton Billet Lifter undergo load test

Product Code : EMLR-B

All dimensions in metric units

Model No.	Overall Dimension (mm)						Mass (kg)	Current (A)	power (kW)	Lifting Capacity Length(m) × number of piece				
	A	B	C	D	E	F				110×110 (mm)	130×130 (mm)	150×150 (mm)	200×200 (mm)	
Normal temperature type	EMLR-B-10060N	100	600	1180	1200	125	45	970	20.6	4.58	4.0×8	3.4×6	3.0×5	2.2×4
	EMLR-B-14060N	1400	600	1200	1610	125	38	1248	32.4	7.13	4.0×11	3.4×9	3.0×8	2.2×6
	EMLR-B-16065N	1600	650	1100	1800	125	45	1740	36.4	8	5.0×13	4.3×11	3.7×12	2.7×9
	EMLR-B-19065N	1900	650	1246	2100	175	50	1996	45.5	10	5.0×16	4.3×14	3.7×12	2.7×9
	EMLR-B-21070N	2100	700	1300	2300	175	50	2800	45.5	10	6.0×18	5.0×15	4.0×13	3.3×10
High temperature type	EMLR-B-10060H	100	600	1000	1200	125	38	1160	14.9	3.3	4×8	3.4×6	3.0×5	2.2×4
	EMLR-B-12084H	1200	840	1050	1510	125	38	1580	18.5	4.07	4×10	3.4×9	3.0×8	2.2×6
	EMLR-B-14060H	1400	600	1025	1610	125	38	1300	25	5.5	4×11	3.4×9	3.0×8	2.2×6
	EMLR-B-16065H	1600	650	1200	1800	125	38	1800	30.5	6.7	5.0×13	4.3×11	3.7×10	2.7×7
	EMLR-B-16090H	1600	900	1300	1860	175	45	3650	25.7	5.65	5.0×14	4.3×11	3.7×10	3.0×7
EMLR-B-19065H	1900	650	1300	2100	175	50	2100	36.4	8	5.0×16	4.3×14	3.7×12	2.7×9	
EMLR-B-21070H	2100	700	1400	3200	175	50	3000	36.4	8	6.0×18	5.0×15	4.5×13	3.3×10	

Due to continuous upgradation in design there could be changes in specification. Other sizes on request. Before ordering, contact Supreme Magnets or your nearest dealer to confirm the suitability of this model for your application.

EMLR-Bundles



- This series is designed with a strong magnetic circuit which can penetrate several layers of air-gap
- Suitable for lifting and transferring bundled bar material as well as heavy duty steel ingots or steel moulds.

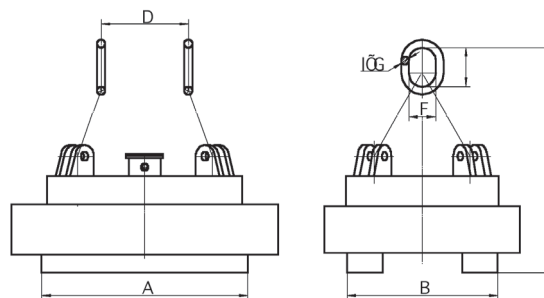

Single bundle lifter

Product Code : EMLR-B'

All dimensions in metric units

Model No.	EMLR-B'-11060L/2-6	EMLR-B'-12060L/2-6	EMLR-B'-15090L/2-6	EMLR-B'-15095L/2-6	EMLR-B'-18060L/2-6	EMLR-B'-26060L/2-6	
overall dimension (mm)	A	1140	1200	1500	1500	1800	2600
	B	600	600	930	950	605	605
	C	1050	1100	1020	1020	1750	1700
	D	400	400	650	650	1200	2000
	E	210	210	250	250	280	280
	F	125	125	175	175	175	175
	G	40	40	50	50	70	70
Mass (kg)	1515	1680	1980	2160	2180	3139	
Cold-state current(A)	37.5	40.4	43.1	43.2	44	51.5	
Cold-state Power(kW)	8.25	8.89	9.55	9.5	9.68	11.3	
Examples for lift capacity of four unit	Bar material Diameter	15 ~ 51	15 ~ 51	12 ~ 50	15 ~ 51	15 ~ 51	15 ~ 51
	Single bundle diameter	230 ~ 300	300	300 ~ 350	300	230 ~ 300	300
	Length	6~12m	8000	9~12m	9~12m	6~12m	9~12m
	Weight per bundle	2~3	2.6	2~3.5	2.5	2	3
	Bundle amount for lifting	3	3	2~4	4	6	8

Due to continuous upgradation in design there could be changes in specification. Other sizes on request. Before ordering, contact Supreme Magnets or your nearest dealer to confirm the suitability of this model for your application.

RECTANGULAR ELECTRO MAXLIFT

Rectangular Electro Lifting Magnet

EMLR-Coils



- Special magnetic pole is suitable for coiled bar of different diameter.
- The choice of electromagnet depends on the length of coiled bar.
- A long enough electromagnet can lift several coils of coiled bar in the direction of the length.

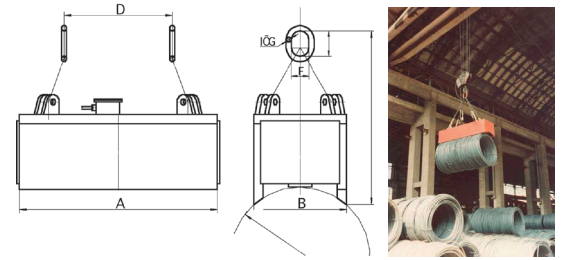

Product Code : EMLR-C

All dimensions in metric units

Model No.	Overall Dimension (mm)							Mass(kg)	current(A)	power(KW)
	A	B	C	D	E	F	G			
EMLR-C-10054	1000	540	1250	500	180	110	32	1520	30	6.6
EMLR-C-16054	1600	540	1210	700	180	110	32	2350	45.5	10
EMLR-C-20054	2000	540	1200	700	180	110	32	2480	58.2	12.8
EMLR-C-26054	2600	540	1220	800	210	125	40	3210	68.2	15
EMLR-C-30054	3000	540	1230	100	210	125	40	3800	80	17.7
EMLR-C-34054	3400	540	1230	1200	210	125	40	4250	86.4	19
EMLR-C-36054	3600	540	1250	1300	250	175	50	4450	89.5	19.7
EMLR-C-40054	4000	540	1250	1550	250	175	50	5000	99.5	21.9
EMLR-C-46054	4600	540	1250	1800	250	175	50	5650	120	26.4
EMLR-C-55054	5500	540	1250	3000	250	175	50	7100	126.4	27.8

Due to continuous upgradation in design there could be changes in specification. Other sizes on request. Before ordering, contact Supreme Magnets or your nearest dealer to confirm the suitability of this model for your application.

EMLR- Multiple Plates



- Designed for lifting and transporting steel plates of medium-thicknesses safely, accurately and quickly.
- A combination of several electromagnets when handling long steel plates are used to overcome possible bending and deforming that may happen to affect safe transportation.
- High temperature type products for handling steel plates below 700°C can be designed and manufactured upon specific requirements of the customers.

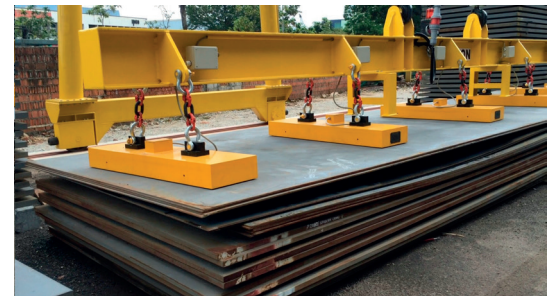

Product Code : EMLR-MP

All dimensions in metric units

Width of steel plate	1500 (mm)							2500 (mm)							4000 (mm)							
	Pieces							Pieces							Pieces							
Model No.	6	8	10	12	16	20	32	6	8	10	12	16	20	32	6	8	10	12	16	20	32	
EMLR-MP-10535	3	3	3	3	2	2	1	1	1	1	1	1	1	1	/	/	/	/	1	1	1	1
EMLR-MP-14035	4	4	3	3	2	2	1	3	2	2	2	2	1	1	/	/	/	/	1	1	1	1
EMLR-MP-17535	4	4	3	3	2	2	1	4	3	3	3	2	2	1	/	/	1	1	1	1	1	1
EMLR-MP-21035	4	4	4	3	2	2	1	4	3	3	3	2	2	1	/	2	2	2	1	1	1	1
EMLR-MP-24035	4	4	4	3	2	2	1	4	3	3	3	2	2	1	2	2	2	2	2	1	1	1
EMLR-MP-12040	6	4	4	4	3	3	1	3	3	3	2	2	2	1	2	1	1	1	1	1	1	1
EMLR-MP-16040	7	5	5	5	3	3	1	6	4	4	4	3	2	1	2	1	1	2	2	2	2	1
EMLR-MP-20040	7	5	5	5	3	3	1	6	5	4	4	3	3	1	2	2	3	3	2	2	2	1
EMLR-MP-24040	7	5	5	5	3	3	1	7	5	5	4	3	3	1	3	3	3	3	3	2	2	1

Model No.	Overall Dimension (mm)							Mass (kg)	Power (kW)	Lifting Width (mm)				
	A	B	C	D	E	F	G			6	8	10	12	16
EMLR-MP-9030	900	300	900	300	110	180	32	185	0.41	2300	2700	3000	3200	3600
EMLR-MP-10535	1050	350	960	400	110	180	32	330	0.9	2650	3150	3350	3550	4050
EMLR-MP-14035	1400	350	940	500	110	180	32	430	1.2	3000	3500	3700	3900	4400
EMLR-MP-17535	1750	350	940	700	110	180	32	510	1.5	3350	3850	4050	4250	4750
EMLR-MP-21035	2100	350	920	800	110	180	32	600	1.8	3850	4200	4400	4600	5100
EMLR-MP-24535	2450	350	980	900	110	180	32	720	2.5	4200	4550	4750	4950	5450
EMLR-MP-12040	1200	400	1017	400	110	180	32	550	3	3000	3500	3700	4000	4500
EMLR-MP-16040	1600	400	996	700	110	180	32	690	3.2	3400	3900	4100	4400	4900
EMLR-MP-20040	2000	400	970	800	110	180	32	840	5	3800	4300	4500	4800	5300
EMLR-MP-24040	2400	400	890	700	110	180	32	910	6	4200	4700	4900	5200	5700
EMLR-MP-13042	1260	420	1040	500	110	180	32	650	2.4	3060	3560	3760	4060	4560
EMLR-MP-17042	1680	420	1045	700	110	180	32	850	3.7	3480	3980	4180	4480	4980
EMLR-MP-21040	2100	420	1010	800	110	180	32	1050	4	3900	4400	4600	4900	5400
EMLR-MP-25042	2520	420	1050	900	110	180	32	1250	4.8	4320	4820	5020	5320	5820

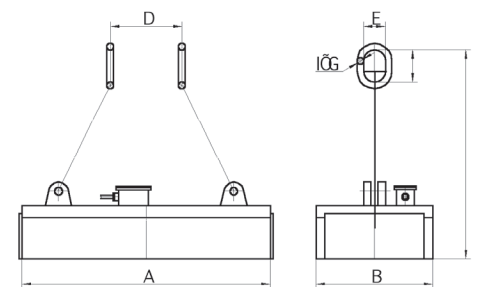

Due to continuous upgradation in design there could be changes in specification. Other sizes on request. Before ordering, contact Supreme Magnets or your nearest dealer to confirm the suitability of this model for your application.

