

• Components

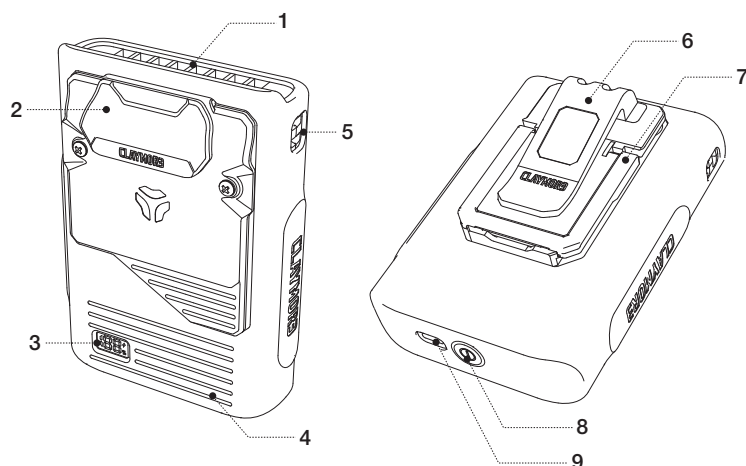

| No. | Name |
|-----|---|
| 1 | Discharge port |
| 2 | Front clip |
| 3 | Wind power / Battery indicator |
| 4 | Silicon cover |
| 5 | Hook for neck strap |
| 6 | Rear clip |
| 7 | Cradle |
| 8 | Power on & off / Fan speed control button |
| 9 | USB charging port |

• In the Box

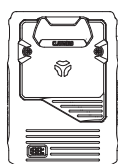

Main unit



Neck strap

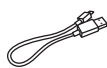

USB Charging Cable
(USB Type-C)

This product has a built-in lithium-ion rechargeable battery.

Please follow the user manual before use. If any abnormality is found in the product, discontinue the use and contact the dealer or a service center where the product was purchased.

⚠ Caution

- 1) When using the product for the first time or storing for an extended period, please fully charge the battery.
- 2) Overheating due to continuous use for an extended time may cause safety accidents such as product failure, fire, etc.
After 3-4 hours of continuous use, give some time to allow products to cool down.
- 3) Adjust the speed in the order of Max. level 3 while battery charging.
- 4) Keep it out of reach of children. (For children under the age of 10, please use it under adult supervision.)
- 5) Do not disassemble, modify or repair on your own.
- 6) Be careful in wet environments. Discontinue the use if it has water damage.
- 7) If the temperature rises or the outer appearance deforms during charging, discontinue the use and contact a service center.
- 8) Do not use it in high-temperature environments (near fires or heating appliances). It may cause an explosion or ignition.
- 9) Be careful of foreign objects when the wings are rotating and ensure that children does not play with the product.
- 10) Do not bend more than the permitted angle adjustment. This may cause damage to the product.
- 11) Do not use if it exceeds the operating temperature range (-10°C -40°C).
- 12) Avoid storing or using in vehicles that are exposed to direct sunlight. It may cause an explosion or product malfunction.
- 13) Do not charge it in contact with easily flammable materials like carpets or blankets.
- 14) After use, be sure to turn off the power for storage.
- 15) If the product is dropped or exposed to physical shock, damage may accumulate inside the product and unexpected malfunctions may occur even during normal use. Be careful not to apply physical shocks to the product.
- 16) Put away from knife, scissors or other sharpness in order to prevent from the damage on the silicon cover.

• Instructions

Power On

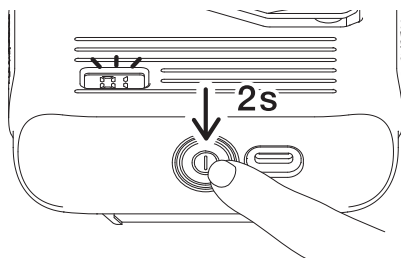

Press the button for 2 seconds.
The wind speed is adjusted with level 1
by indicating the number '01'.

Power Off

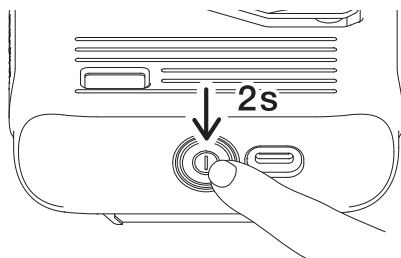

Press the button for 2 seconds.
The power will be off regardless of
current wind level

Wind speed control

When the fan is power-on, press the button each time shortly to increase the wind speed by one step.
The wind speed can be adjusted from level 1 to 5.

* If there is no button control for 3 seconds after indicating the wind speed level, the battery status will indicate on the screen.

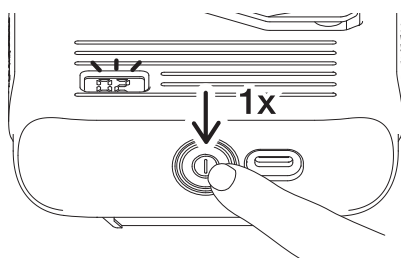

How to use the front & rear clip

The fan can be used with the front & rear clip by fixing on in the pocket.
Stably fix the top with the front clip.

* If the top is too long, wear the top outside of fan without fixing by the front clip.

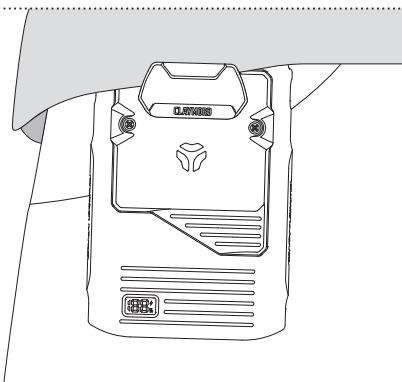

Using the cradle

Use the fan on the table as well by opening
the cradle behind the fan.

* The cradle can only support the weight of main unit.
Be careful not to excessively force.

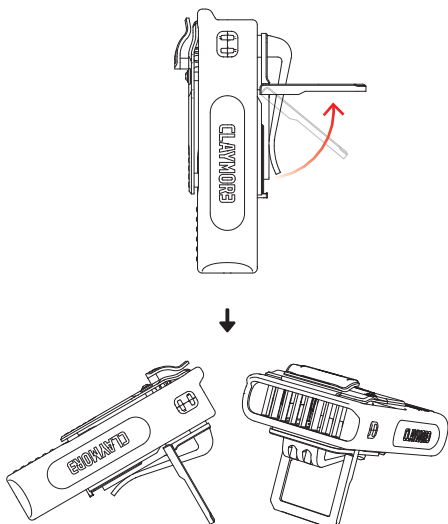

Connecting the neck strap

Use the fan around your neck by connecting
the neck strap as below picture.

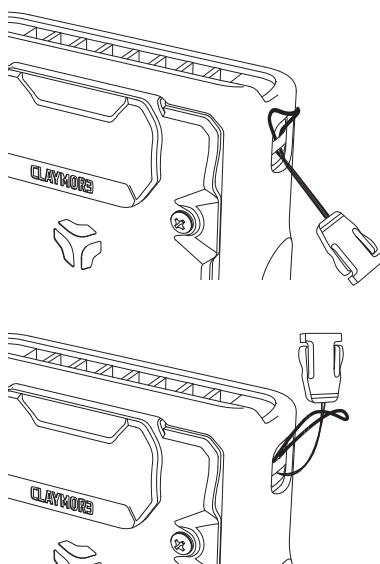

Using the neck strap

Adjust the length of neck strap from 55 ~ 95 cm.
By one-touch buckle on the strap,
it is easy to connect & disconnect.

* Be careful from damage or cut-off
when pulling the strap with excessive force.

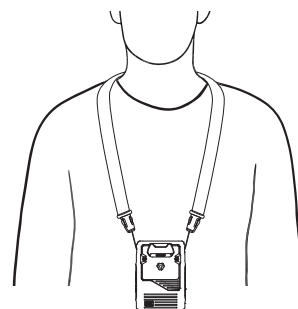

• Charging the Product

Connect the USB-C charging cable to the charging port to start charging.

When charging the product, the battery indicator with green color on the LCD will blink and show its charging status.

If the indicator disappears, the charging is complete.

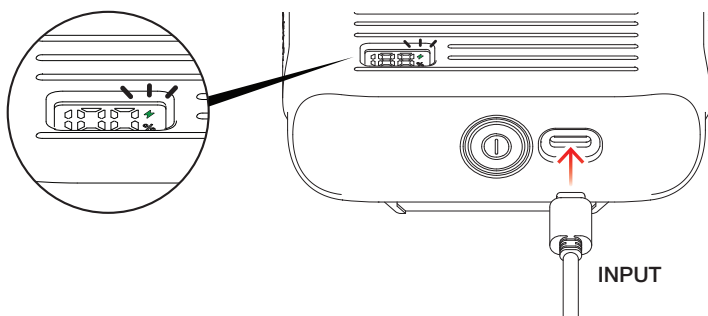

* If the battery remains 0%, the number '0%' on the LCD will blink and the power will be automatically off.

* Adjust the speed in the order of Max. level 3 while battery charging

Checking the battery status

When the power is off, press the button one time shortly to see the battery status.

After 3 seconds from the battery status indicated, the LCD will be turned off.

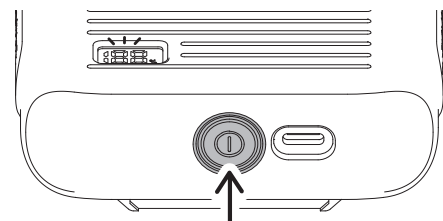

CLAYMORE

Specification

| | |
|-------------------|--|
| Product Name | CLAYMORE Clip Fan |
| Model No. | CLFN-CL01BGL |
| Power Consumption | 8.8W |
| Rated Voltage | DC 5V 1.5A |
| Charging Time | 4 hrs |
| Run Time | Max. 2 ~ Min. 17 hrs |
| Battery Capacity | Li-ion 3.7V 5,200mAh (19.24Wh) |
| Weight | 270 g / 0.6 lbs |
| Dimensions | 87 x 56.5 x 123 mm / 3.4 x 2.2 x 4.8 in (Strap : 55 ~ 95 cm / 23.2 ~ 37.4 in) |
| In the box | Main unit, Neck strap, USB-C cable |
| Origin | China |

※ Operating time may vary depending on the battery capacity and external environment.

Warranty

| | |
|-----------|-------------------|
| Item | CLAYMORE Clip Fan |
| Model No. | CLFN-CL01BGL |

- 1) Any functional defectives by normal use within the warranty period will be repaired free of charge. If repair is not possible, we will give you the replacement.
- 2) Warranty period: 1 year

Charged Service

- 1) Any defects or malfunctions that occur after the warranty period.
- 2) Defects caused intentionally or negligently by the consumer.
- 3) Defects caused by repairs or modifications performed by individuals or centers other than official servicing centers of Claymore.
- 4) Malfunction due to power failure or defective connecting devices.
- 5) Defects or malfunction caused by natural disasters.

※ The exterior and specifications of the products may be subject to change without prior notice for product development.



Headquarter

Prism Inc.

221, Pyeongcheon-ro, Bupyeong-gu, Incheon 21314, Republic of Korea

R&D Center

Prism Inc.

20, Magokjungang 8-ro 1-gil, Gangseo-gu, Seoul 07795, Republic of Korea

Claymore USA Inc.

6 Centerpointe Drive, Suite 700, La Palma, CA 90623, USA
info@claymoreoutdoor.com · www.claymoreoutdoor.com



Origin : Designed by Prism in Korea / Made in China