

# NURZVIY

## Home EV Charger

### USER MANUAL



# Product Information

---

## 1.1 In the Box



User Manual



Home EV Charger

5* Screw M10 x 50	1* Shaped Wrench
5* Wall Anchor	2* RFID Card

Note: If you are missing any of these parts, please call 1-408-400-3805.

# Product Information

---

## 1.2 Product Overview

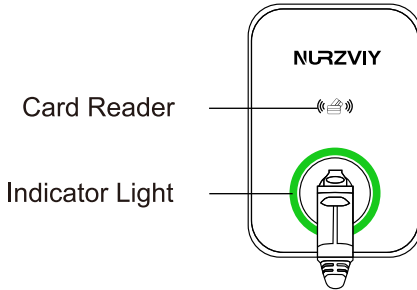

Appearance of Home EV Charger

## 1.3 Product Function

- **High-speed Charging:** Charging up to 50A at 12kW, delivering 37 mi/hr. Charge up to 9X faster than a Level 1 charger.
- **3 Ways to Initiate Charging:** Choose from the Nurzviy APP, RFID card, or auto-charging when connecting the EV charger nozzle.
- **Smart APP Control:** Connect to the Nurzviy APP via Bluetooth or WiFi, allowing users to remotely initiate or schedule charging for the EV Charger, monitor charging status, and view charging records.
- **Safe and Reliable:** Fire-resistant, with over-current/voltage/temperature protection. Durable and cost-effective.
- **SAE J1772 Compatibility:** Works with all EVs or PHEVs, including Tesla (adapter required), Chevrolet Volt/Bolt EV, Hyundai Kona/Ioniq, Kia NIRO, Nissan LEAF, and more.

# Product Information

## 1.4 Basic Parameters

Model	EVHome 40A	EVHome 50A
Working Current	40A	50A
Working Voltage	AC 90~260V	
Rated Power	9.6kW	12kW
Frequency	60Hz	
Cable Length	24 feet (7.3 m)	
Input Cord	NEMA 14-50 NEMA 6-50	Hardwired
Input Cord Gauge	L1 (6 AWG), L2 (6 AWG) and Ground (10 AWG THHN)	
Input Cord Length	33.46 inch (0.85m)	
IP Rating	IP65-Main unit / IP55-Connector	
Installation Mode	Wall Mounted	
Working Temperature	-22°F to 122°F (-30°C to 50°C)	
Working Humidity	5% to 95% RH	
Cooling Way	Natural Air Cooling	
Connector	J1772	
APP Name	NURZVIY	
Internet Access	WiFi/Bluetooth	
Certification	FCC	
Weight	18.7 lbs(8.5Kg)	
Dimensions	8.6x12.6x3.3 inch (220x320x85 mm)	
Warranty	2 Years	

# Important Safety Instructions

---

## SAVE THESE INSTRUCTIONS



**WARNING:** This manual contains important instructions for Nurzviy EVHome Charger.

When using electric products, always follow basic precautions, including the following.

**1. Read and follow all warnings and instructions before installing and operating the Nurzviy EVHome Charger.** Install and operate only as instructed. Failure to do so may lead to death, injury, or property damage, and will void the Limited Warranty.

**2. Only use licensed professionals to install your Nurzviy EVHome Charger and adhere to all national and local building codes and standards.** Before installing the Nurzviy EVHome Charger, consult with a licensed contractor, such as a licensed electrician, and use a trained installation expert to ensure compliance with local building and electrical codes and standards, climate conditions, safety standards, and all applicable codes and ordinances. Inspect the charging station for proper installation before use.

# Important Safety Instructions

---

**3. Always ground the Nurzviy EVHome Charger.** Failure to ground the EV charger can lead to risk of electrocution or fire. The EV Charger must be connected to a grounded, metal, permanent wiring system, or an equipment grounding conductor shall be run with circuit conductors and connected to the equipment grounding terminal or lead on the Electric Vehicle Supply Equipment (EVSE). Connections to the EVSE shall comply with all applicable codes and ordinances.

**4. Install the Nurzviy EVHome Charger using a Nurzviy approved method.** Failure to install on a surface that can support the weight of the EV charger can result in death, personal injury, or property damage. Inspect the EV charger for proper installation before use.

**5. This EV charger is not suitable for use in hazardous locations.** Do not install Nurzviy EVHome charger near flammable, explosive, or combustible materials.

**6. This device should be supervised when used around children.**

**7. Do not put fingers into the electric vehicle connector.**

# Important Safety Instructions

---

**8. Do not use this product if the flexible input power cable or EV charging cable is frayed, has broken insulation, or any other signs of damage.** Call Nurzviy customer support immediately at 1 408 400 3805.

**9. Do not use this product if the enclosure or the EV connector is broken, cracked, open, or shows any other indication of damage.** Call Nurzviy customer support immediately at 1 408 400 3805.

**10. Use 90°C wire copper conductors only.**

**11. Do not operate Nurzviy EVHome Charger in temperatures outside its operating range.** For EV charger set to 16-40A, the range is -22°F to 122°F (-30°C to 50°C). For EV charger set to 48A-50A, the range is -22°F to 113°F (-30°C to 45°C).

# Installation and Charging

---

## 2.1 Installation Instructions

Before beginning work, check the site for appropriate mounting location and electrical capacity.

1. Ensure the homeowner has chosen an installation location that allows the charging cable to reach the car's charging port while still providing slack. Ensure there is a stud available at the desired location for mounting the EV charger. Ensure there is WiFi signal available.

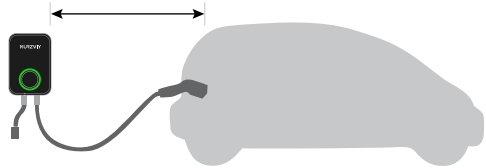

**Note:** Outdoor installation is an option, but requires an outdoor-rated, weather-resistant electrical outlet or hardwired installation.



**WARNING:** In areas with frequent thunderstorms, add surge protection at the service panel for all circuits. Ensure all power and ground connections, especially those at the breaker and bus bar, are clean and tight. Remove all oxide from all conductors and terminals before connecting wiring.

---

2. Determine the desired charging amperage with the homeowner. EVHome can be installed at a variety of amperages. Choose based on the availability of space or electrical capacity in the panel, the desired speed of charging, and whether the homeowner prefers a hardwired or plug-in installation.



# Installation and Charging

---



**CAUTION:** Nurzviy EVHome charger is a continuous load device. The circuit must be rated for 125% of the maximum load.

---

Model	Circuit Rating	Max Load	Estimated Range per Hour	Plug-in	Hardwired
EVHome 40A/50A	80A	50A	37 miles/60 km	x	√
	70A	50A	37 miles/60 km	x	√
	60A	48A	36 miles/58 km	x	√
	50A	40A	30 miles/48 km	√	√



**Important:** In Canada, a plug-in installation is only allowed with a 50 amp circuit.

---

# Installation and Charging

---

## Step 1

Drill holes according to the 3 holes on the backplane.

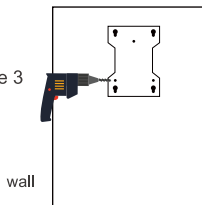

## Step 2

Hammer the M10 expansion tubes into the wall holes.

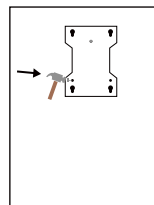

## Step 3

Use the screwdriver to fix the M10 tapping screws to the backplane on the wall.

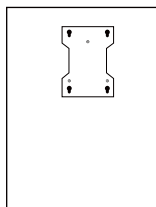

## Step 4

Install the charger on the backplane on the wall.

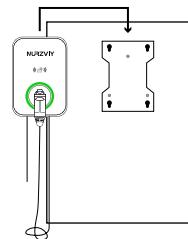

# Installation and Charging

## 2.2 Charging Instructions

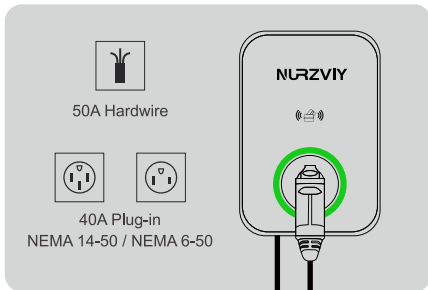

1. Insert the charging input to the power supply.

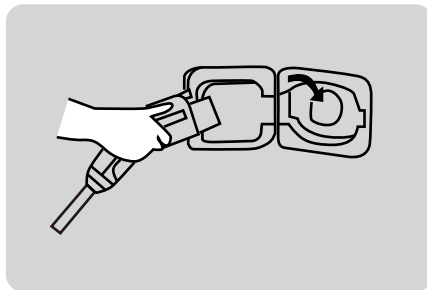

2. Insert the charging plug to the charging port.

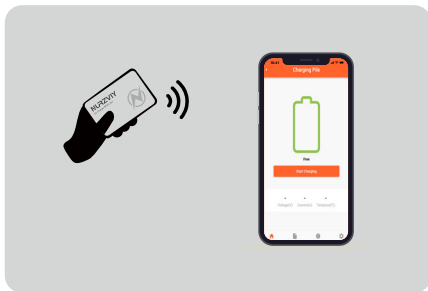

3. Start by swiping the card, APP control, or Plug n' Play.

**Note:** Plug n' Play should be set in APP for first-time use.

# Installation and Charging

---

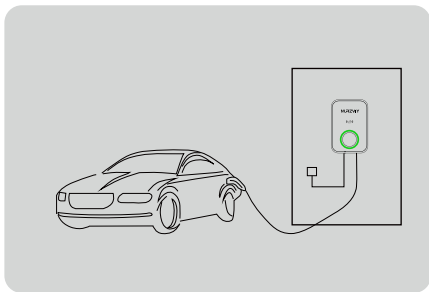

4. EV is in normal charging state.

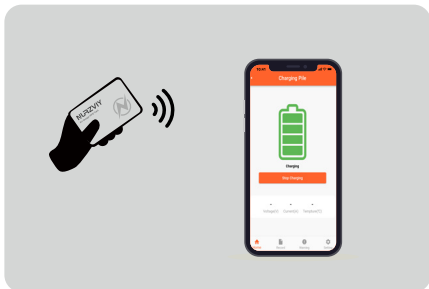

5. Finish by swiping the RFID card or APP control.

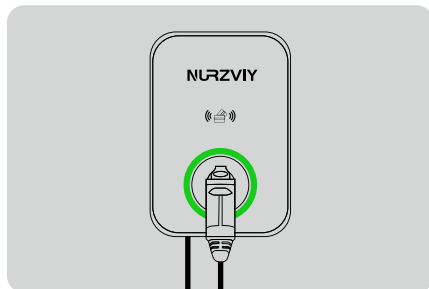

6. Remove the charger and put it back in place.

# APP Functions

## The NURZVIY app feature list:



Simplify setup of your home EV Charger via Wi-Fi.



Track your usage and charging session history.



Schedule charging sessions.



Get alarms for increased safety.

## Get Started:

1. Sign up or sign in with Email.

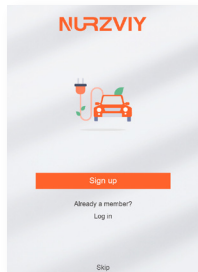

2. Add device via auto-discovery.

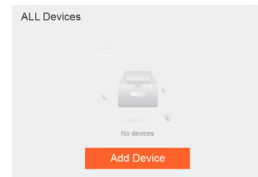

3. Click "Start Charging" or schedule a charging

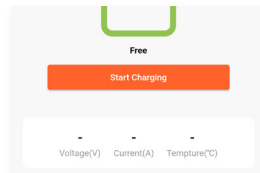

# APP Functions

---

## Charging Tips on the APP:

Both Wi-Fi and Bluetooth connection available.

Make sure the bluetooth of mobile phone has been enabled while configuring Wi-Fi.



### Tip 1 Start to Charge

Insert the charging plug into the charging port, click "Start Charging".

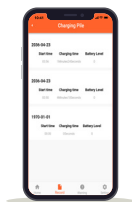

### Tip 2 Check Charging Record

Up to 1,000 charging history can be stored offline, and can be viewed on the APP when the network is restored.



### Tip 3 Alarm

When the device fails to work, an alarm will be prompted, and you can view the error info.



### Tip 4 Finish Charging

After charging completed, click to turn off the power to finish charging.

# LED Indicator

---

Working Status	Red	Green	Blue
Free	/	On	/
Wi-Fi Connecting	/	Flash	/
Wi-Fi Connected Successfully	/	/	On
Charging	/	/	Flash
Charging Complete	/	/	On
Fault Alarm	On	/	/

## Disclaimer of Warranties and Limitation of Liabilities

All information, specifications and illustrations in this manual are based on the latest information available at the time of printing.

Nurzviy reserves the right to make changes at any time without notice. While information of this manual has been carefully checked for accuracy, no guarantee is given for the completeness and correctness of the contents, including but not limited to the product specifications, functions, and illustrations.

Nurzviy will not be liable for any direct, special, incidental, indirect damages or any economic consequential damages (including the loss of profits).

Nurzviy shall not be liable for any damage caused by force majeure such as fire, typhoon, flood, earthquake or customer's intentional negligence, misuse or use under other abnormal conditions.

**Defect caused by the non-standard connectors is not compensable.**

# Nurzviy Energy, Inc.



| [service@nurzviy.com](mailto:service@nurzviy.com)



| +1 408 400 3805



| [www.nurzviy.com](http://www.nurzviy.com)



| 1024 Yarwood Ct, San Jose, 95128 United States

