



Premium Range

Cabinets & Information Sheet

Premium Range concept

Cost is really important to us all, but so is quality.

With the premium range we have tried to get together the best of both worlds.

How do we do that?

We pre cut and prepare cabinets to set sizes in bulk using the very best materials we can find, this helps to keep the cost as low as possible. We offer them Flat packed for the best Value, or Rigid.

In this document you will find the standard size cabinets we offer.

What about Bespoke units?

If however your kitchen needs some cabinets we don't have here—don't worry—we can create bespoke cabinetry to go with this range — But please note due to cost restrictions, and to keep the cost as low as possible for you, we make bespoke cabinetry using the same materials as our fully bespoke “Classic” range, mainly this is Oak Veneered MDF for cabinetry, Beech frames, MR MDF doors.

They will look identical when fully finished and installed and is a great way to get a bespoke kitchen at an affordable price.

Please also note that we have limited stocks of pre cut and prepared cabinets—if when making yours we don't have stock of a certain of a cabinet we will build it for you at the same cost but from the “bespoke” materials listed above

If you want to see examples of any just ask.

Cabinet information:-

Carcase Material—White oak Plywood

Door and Frame Materials—Birch or Beech

Centre Shaker panel—MDF

Drawer Box Construction—Dovetailed Oak

Drawer runners—soft close as standard (size of drawer permitting)

Hinges—Butt Hinges or Soft close Dampeners available

Finishes available— 1) Primed doors and frames and Lacquered interiors



Bespoke cabinets available to compliment this range—Bespoke cabinet will be made using the following materials

Carcase Material—White oak Veneered MDF

Door and Frame Materials—Beech or MDF

Centre Shaler panel—MDF

Drawer Box Construction—Dovetailed Oak

Drawer runners—soft close as standard (size of drawer permitting)

Hinges—Butt Hinges or Soft close (Soft close concealed hinges additional cost)

Finishes available— 1) Primed doors and frames and Lacquered interiors

2) Fully painted in a colour of your choice and Lacquered Interiors—Water based paint used



BASE CABINETS

Base Cabinets

870mm Tall—Single doors can be hinged Left or Right Hand - Standard Depth 580mm—Corner cabinets can be left or right also

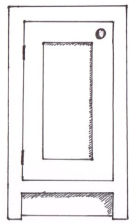

BH1 300
base cabinet
300mm

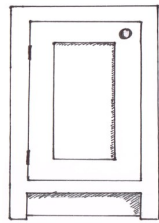

BH1 400 base
cabinet
400mm Wide

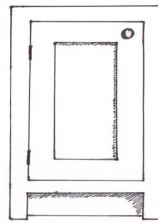

BH1 500
base cabinet
500mm

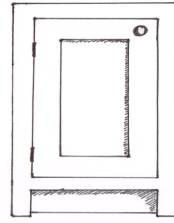

BH1 600 base
cabinet
600mm Wide

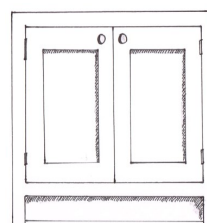

BH2 700
base cabinet
700mm Wide

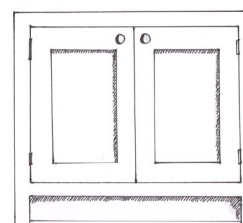

BH2 800
base cabinet

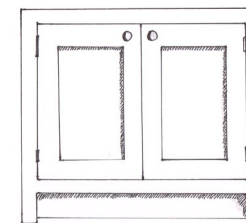

BH2 900
base cabinet
900mm Wide

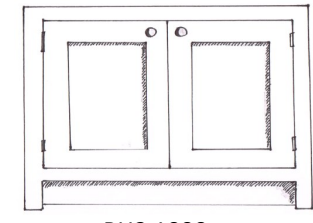

BH2 1000
base cabinet
1000mm Wide

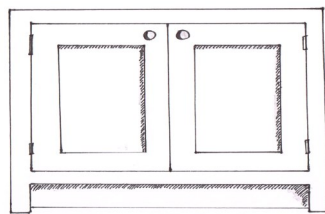

BH2 1200
base cabinet
1200mm Wide

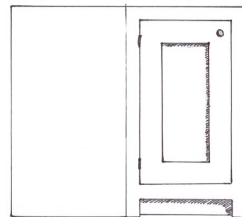

BCH 500—Blind Corner
500mm Wide
door & frame

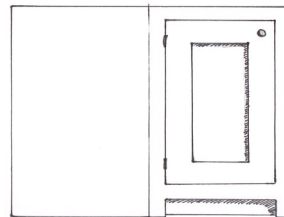

BCH 600—Blind Corner
600mm Wide
door & frame

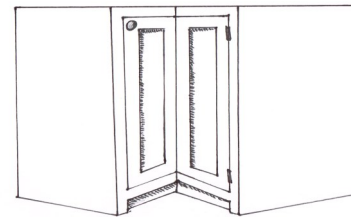

BCL —L Shaped
Corner
900 x 900 mm Wide



TST 150
Tray Space
150mm

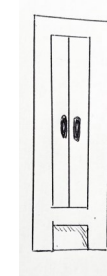

TB 2TR
200 wide
2 Tray base

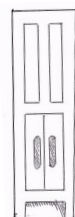

TSBT 200
Tray &
chopping
board Space
200mm wide

DRAWER CABINETS

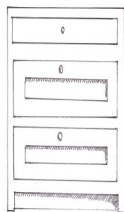

BD3 500
3 Drawer Base
500mm wide

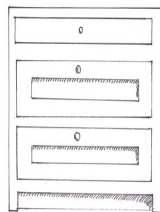

BD3 600
3 Drawer Base
600mm wide

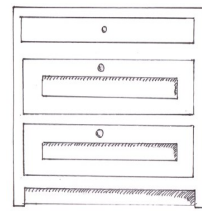

BD3 800
3 Drawer Base
800mm wide

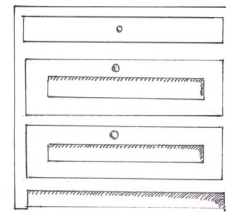

BD3 900
3 Drawer Base
900mm wide

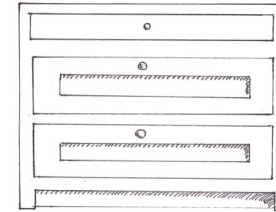

BD3 1000
3 Drawer Base
1000mm wide

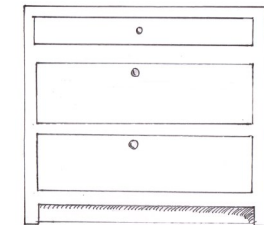

Slab Fronts
Also Available

DRAWER CABINETS

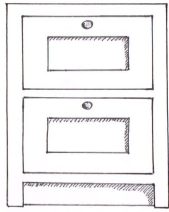

BD2 500

2 Drawer Base

500mm wide

1 x internal Drawer

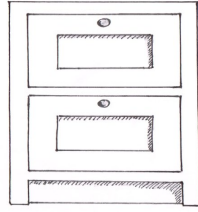

BD2 600

2 Drawer Base

600mm wide

1 x internal Drawer

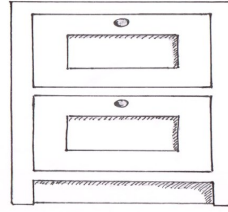

BD2 800

2 Drawer Base

800mm wide

1 x internal Drawer

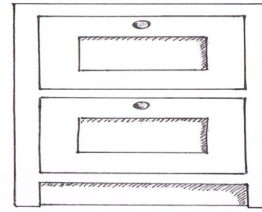

BD2 900

2 Drawer Base

900mm wide

1 x Internal Drawer

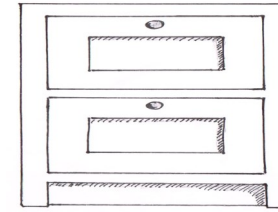

BD2 1000

2 Drawer Base

1000mm wide

1 x Internal Drawer

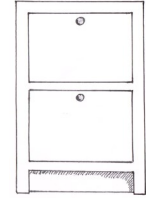

Slab Fronts

Also

Available

Hidden Internal drawer in all 2 drawer bases—can be left out of 2 deep drawers required

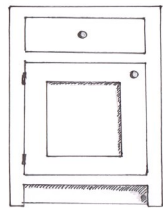

BDL 600

Drawerline base

600mm wide

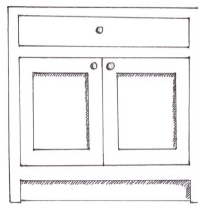

BDL 800

Drawerline base

800mm wide

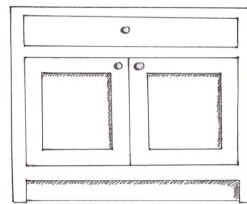

BDL 1000

Drawerline base

1000mm wide

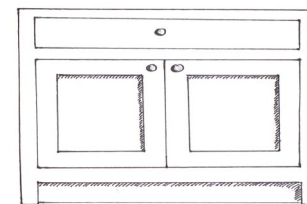

BDL 1200

Drawerline base

1200mm wide

BASE CABINETS

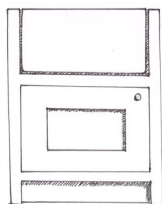

BPS2 680

Belfast Sink

base cabinet

680mm Wide

For 600mm sink

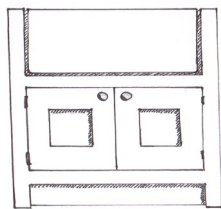

BDBD 880

Belfast Sink

base cabinet

880mm Wide

For 800mm sink

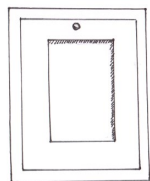

APD 450

446mm appliance

door

Designed for

slimline integrated
appliance

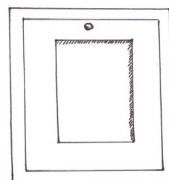

APD 600

596mm appliance

door

Designed for

standard inte-
grated appliance

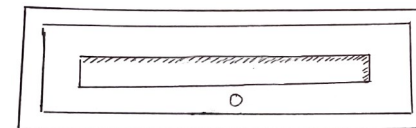

BRIDGE 2

1000mm wide SINGLE door

Bridge unit

330m tall

(SINGLE DOOR)

APPLIANCE CABINETS



BOH

680mm wide

Single oven
housing



TOH 1

680mm wide

2150mm Tall

Single oven housing



TOH 2

680mm wide

2150mm tall

Single oven & Com-
pact Oven housing



TOH 3

680mm wide

2150mm tall

2 x Single oven
housing

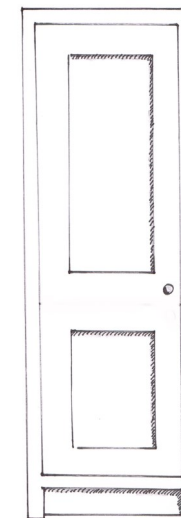

TFF

680mm wide

Tall Fridge Freezer Housing

Single door / 50;50 split / 60/40 split

TALL

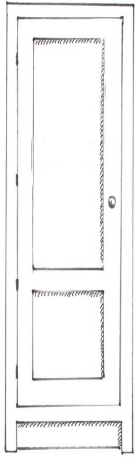

TL1 400

400mm wide

Single door
Shelved

Larder

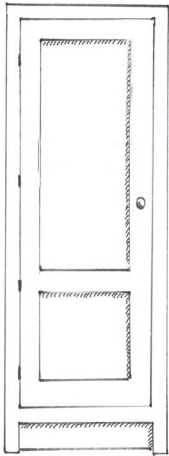

TL1 600

600mm wide

Single door
Shelved

Larder

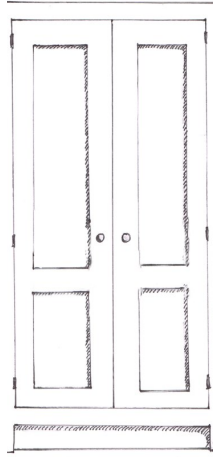

TL2 800

800mm wide

Double door
Shelved

Larder

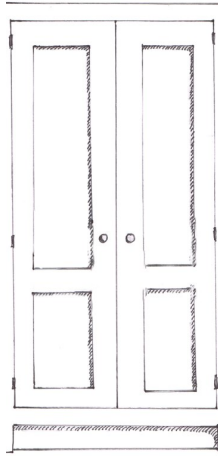

TL2 900

900mm wide

Double door
Shelved

Larder

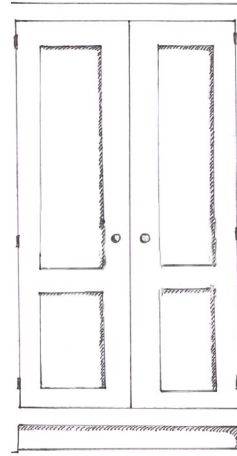

TL2 1000

1000mm wide

Double door
Shelved

Larder

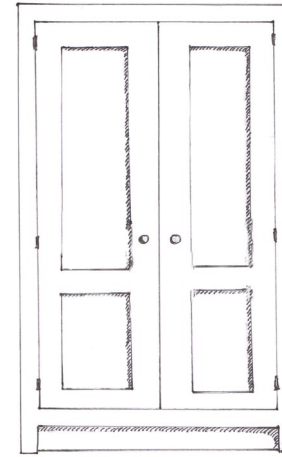

TL2 1200

1200mm wide

Double door
Shelved

Larder

Internal drawer packs

Available for most

larders

Also Spice/Bottle Racks



WALL CABINETS



WC1 300

300mm wide

Single door
Wall cabinet

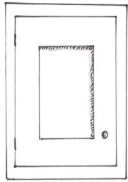

WC1 400

400mm wide

Single door
Wall cabinet

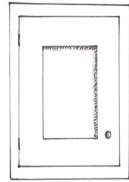

WC1 500

500mm wide

Single door
Wall cabinet

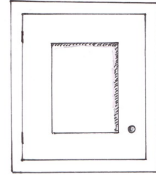

WC1 600

600mm wide

Single door
Wall cabinet

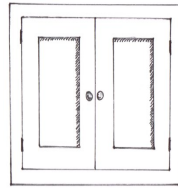

WC2 700

700mm wide

Double door
Wall cabinet

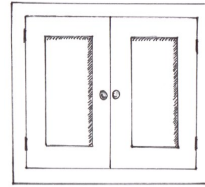

WC2 800

800mm wide

Double door
Wall cabinet

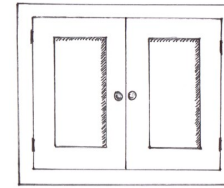

WC2 900

900mm wide

Double door
Wall cabinet

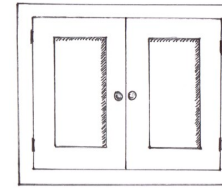

WC2 1000

1000mm wide

Double door
Wall cabinet

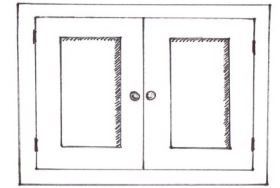

WC2 1200

1200mm wide

Double door
Wall cabinet

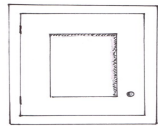

SWC600

Short wall cabinet

600mm wide

Single door Wall
cabinet

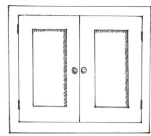

SWC680

Short wall cabinet

680mm wide

Double door Wall
cabinet

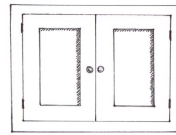

SWC800

Short wall cabinet

800mm wide

Double door Wall
cabinet

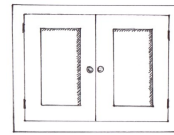

SWC880

Short wall cabinet

880mm wide

Double door Wall
cabinet

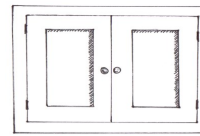

SWC1000

Short wall cabinet

1000mm wide

Double door Wall
cabinet

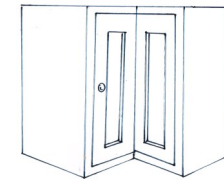

WCL

L Shaped wall cabi-
net

600x600mm wide
cabinet

- All single door wall cabinets can be Left or Right Hand Hinged

DRESSER TOPS

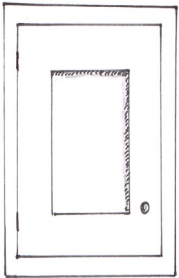

D1 600

Single Door

Dresser Cabinet

600mm wide

Single door

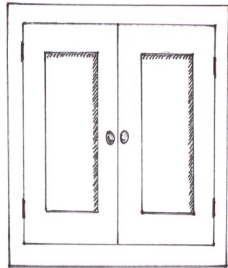

D2 1000

Double Door

Dresser Cabinet

1000mm wide

Double door

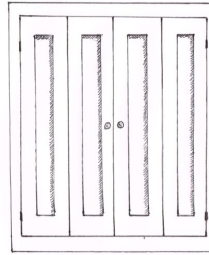

D2B 1000

Bifold doors

Dresser Cabinet

1000mm wide

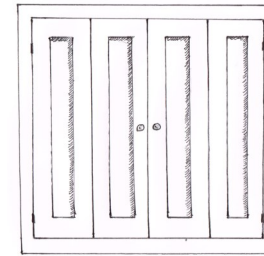

D2B 1200

Bifold doors

Dresser Cabinet

1200mm wide

PANELS & ACCESSORIES

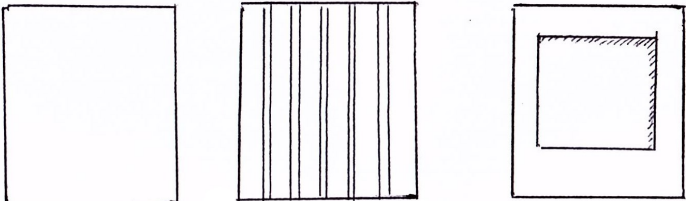

Panels

Plain—T&G Effect or Panelled



Cutlery or Utensil Trays



Spice Drawer, Tin Foil & Film Dispenser, Knife Block



Spice or Oil Racks

CARE & GENERAL ADVICE

*Before delivery—Double check all measurements in the room, where you have tall cabinets measure up high also as walls can sometime be not 100% vertical

Then check the order form THOROUGHLY before you agree it, once we start production changes will incur costs.

Anything out of the ordinary you are expecting on a cabinet HAS to be on the order form, so if it was agreed make sure it is there, as this is what will be built.

Check access to the property, can you carry in some of the largest items fully assembled? If not let us know and we will flat pack those items

*Storage before fitting and after fitting—Your kitchen is made entirely out of wood. It is very important that it is stored in a Dry heated room when delivered and not left in a cold or damp room as it will soak up moisture from the environment.

It is also really important that you do not put your kitchen in a freshly plastered room that hasn't yet fully dried as again it will soak up moisture.

Moisture will cause the wood to expand, and cause rubbing, it will also cause hairline cracks to appear in the freshly painted paint which when the wood dries and shrinks back down may cause problems.

Fitting:-

*Fitting— We have our own approved installers, they know the product inside out and will always leave you with a fantastically fitted kitchen. We often see “builders” fitting our kitchens, and whilst many do a great job, some really don't have the skills needed to fit an in-frame kitchen and can often cause more harm than good. Please speak to us about fitting if you are unsure of your fitters skills.

*Sealing around the bottom— Once fitted we strongly recommend that you seal with a good quality silicone around the legs and plinth to the floor, this will stop water from mopping or spills being able to get under the legs and soak into the wood and cause these problems above.

*Sitting water—Around sinks please do not allow water to sit on the frames or doors for long periods, we use water based paints and this will slowly cause damage as the water will eat away the paint and soak into the wood.

*Dishwashers—We strongly recommend (as will all other kitchen manufacturers) that you do not open a dishwasher as soon as it has finished its cycle to let the steam out, please leave the dishwasher to cool off before opening. Steam is a very powerful substance and will penetrate the wood and paint and will cause damage to any kitchen door, but especially a painted one

