

**Element:** Carbon Fiber

**Body:** Extruded anodized aluminum

**Remote Control:** 4 power levels and 3 timer settings

**Warm Up Time:** 10-15 minutes

**IP Rating:** IP54

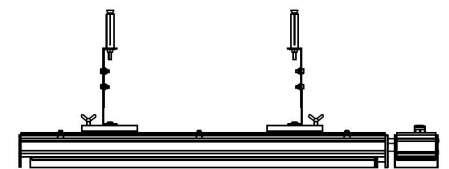

**IMPORTANT**

In exposed areas with air movement/wind, the far infrared spread may reduce by 1/3. In such areas, or when used in low air temperatures, we would recommend considering a heater from our medium wave Genesis Series or proportionally increasing the number of E Model heaters and mounting at the lowest height.

The recommended installation height of the E Models is 2.1m to 2.7m (84"-108") from the floor. Under no circumstances is the heater to be installed at less than 1.8m (71") from the floor. In all cases it should be installed at a height where it cannot be touched in operation. The heated zones detailed are based on the recommended mounting heights.

The Design Series E Models are guaranteed against failure due to faulty materials or workmanship for three years from the date of purchase. Warranty excludes remote control. In the unlikely event of failure of the unit within this time, the unit must be returned to the supplier for repair or replacement. Refer to the warranty policy on radtec.net for more details including exclusions. The guarantee is invalid if the correct installation instructions have not been adhered to.



**FEATURES AND BENEFITS**

The stylish and efficient E models are a high quality, electric, zero light and zero maintenance designer panel heater providing a modern and tasteful solution. With an IP rating of IP54, these heaters offer an ideal solution for heating sheltered outdoor spaces with low air movement.

The slimline E Models offer considerable flexibility when it comes to installation as they can be both ceiling and wall mounted and are easy to install. Wall/ceiling mounting brackets are provided with 90 degrees of adjustment. For ceiling installations over 9 feet, mounting extension kits can be purchased in 2, 3 and 4 ft. lengths.

Reliable, durable and long lasting, the E models are remote controlled. The remote control allows you to function through four power levels and set the timer for 2, 4, or 8 hours.

Far infrared heat produced by the RADtec Design Series E models heats people directly, without heating the air in between, producing a warm, comfortable and gentle heat. The heaters take between 10 and 15 minutes to reach full power and up to 30 minutes to raise the temperature of objects in their path. You should expect a 10 to 15 degree difference between the ambient temperature and objects in the coverage area. The perfect solution for keeping warm on those chilly evenings outdoors or for heating up those hard to heat areas in large indoor spaces such as sun rooms. The carbon fiber heating elements are rated to work for 30,000hrs, which equates to 4 hours of use each day for 20 years. Silent in operation and with zero light, this is a discreet, efficient, and environmentally friendly way to ensure clean, comfortable and effective warmth.

**MOUNTING DIAGRAM**

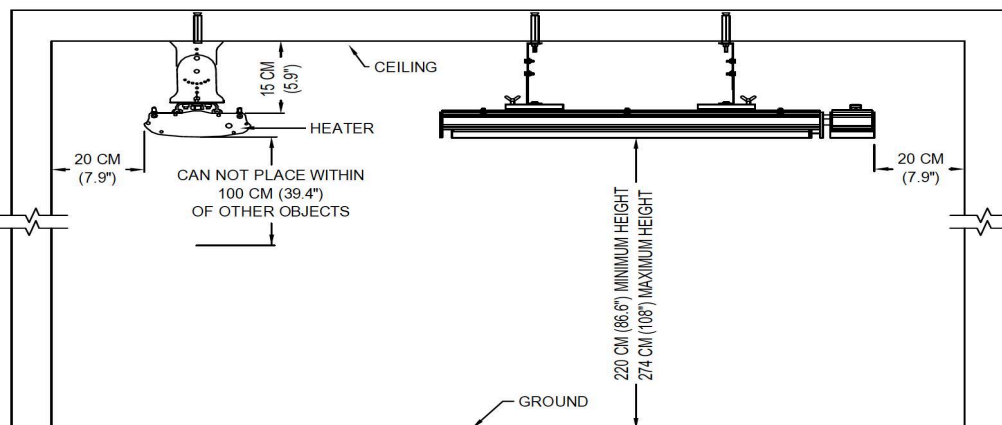

**Coverage Area Table**

Model No.	Indoors	Outdoor Enclosed	Outdoor Exposed
E15R	50ft <sup>2</sup> ~ 4.6m <sup>2</sup>	40ft <sup>2</sup> ~ 3.7m <sup>2</sup>	30ft <sup>2</sup> ~ 2.8m <sup>2</sup>
E18R	50ft <sup>2</sup> ~ 4.6m <sup>2</sup>	40ft <sup>2</sup> ~ 3.7m <sup>2</sup>	30ft <sup>2</sup> ~ 2.8m <sup>2</sup>
E24R	80ft <sup>2</sup> ~ 7.4m <sup>2</sup>	65ft <sup>2</sup> ~ 6m <sup>2</sup>	50ft <sup>2</sup> ~ 4.6m <sup>2</sup>
E32R	110ft <sup>2</sup> ~ 10.2m <sup>2</sup>	90ft <sup>2</sup> ~ 8.4m <sup>2</sup>	70ft <sup>2</sup> ~ 6.5m <sup>2</sup>

**HEAT AREA**

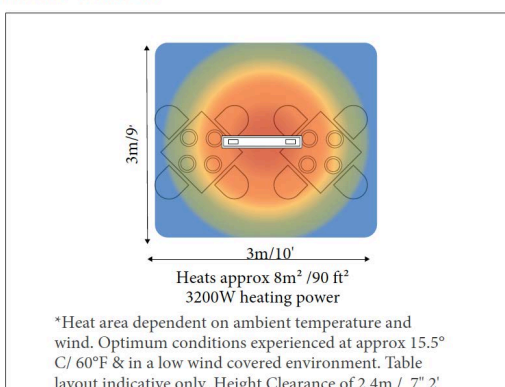

**HEAT AREA**

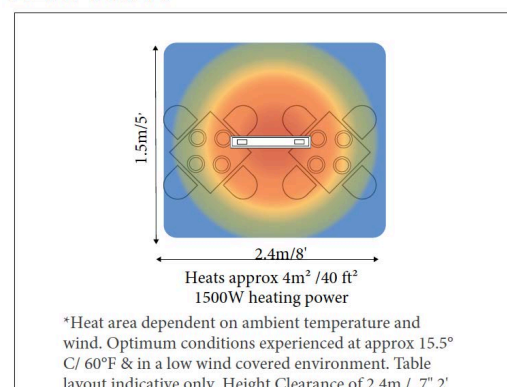

**\*HEAT COVERAGE AREA REFLECTS OUTDOOR EXPOSED SETTING\***  
**\*MOUNTING HEIGHT 7'-9' FOR ALL UNITS\***

E32R

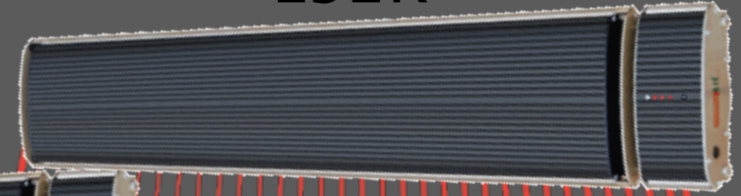

E24R

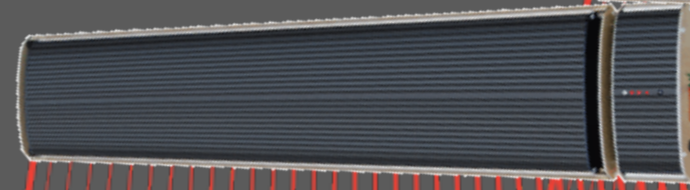

E18R

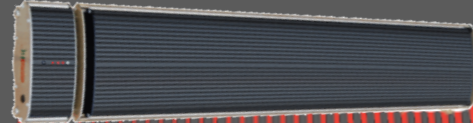

E15R

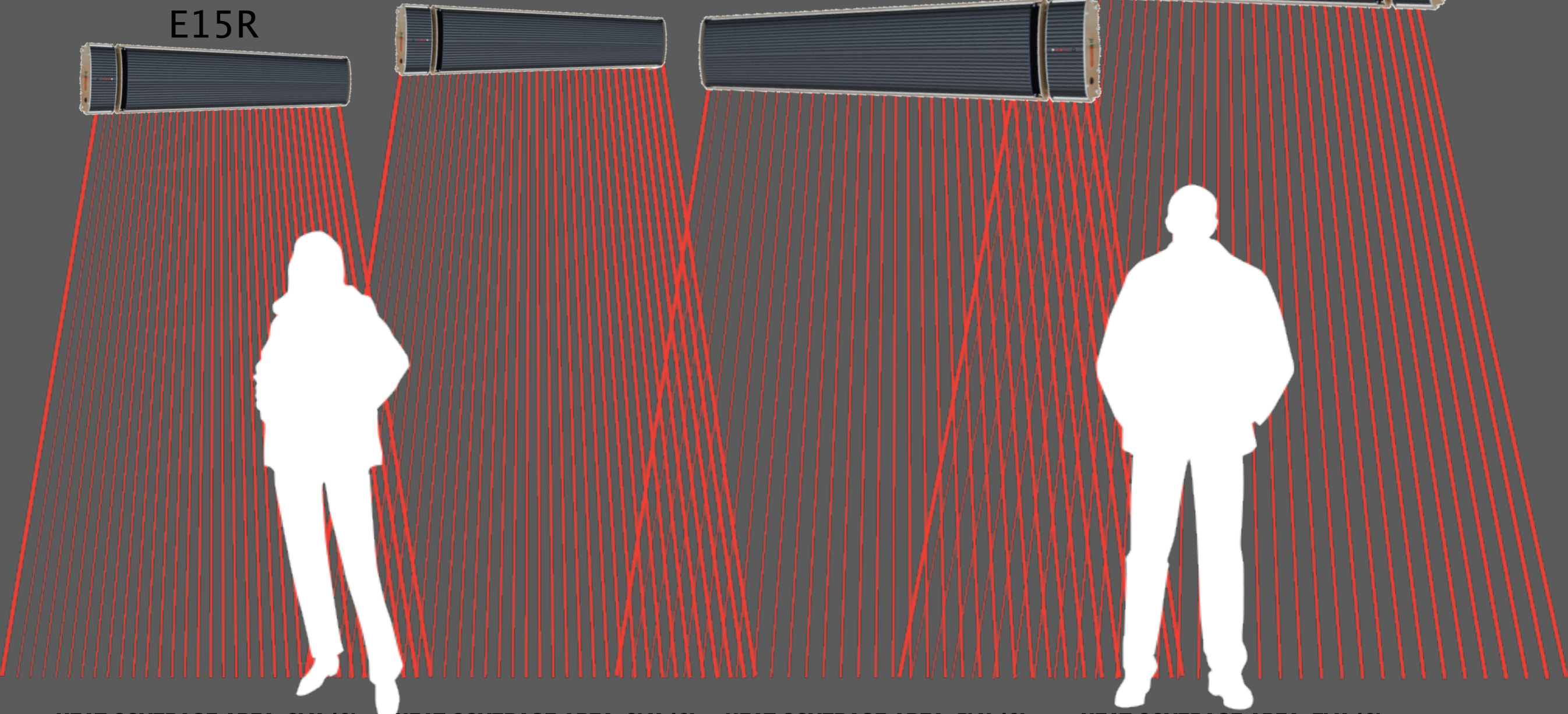
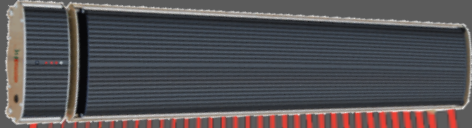

**HEAT COVERAGE AREA: 3' X 10'**  
**LENGTH: 43" | 1500 WATTS**

**HEAT COVERAGE AREA: 3' X 10'**  
**LENGTH: 43" | 1800 WATTS**

**HEAT COVERAGE AREA: 5' X 10'**  
**LENGTH: 62.5" | 2400 WATTS**

**HEAT COVERAGE AREA: 7' X 10'**  
**LENGTH: 82.5" | 3200 WATTS**



# **RAD**tec

The Outdoor Heating Source

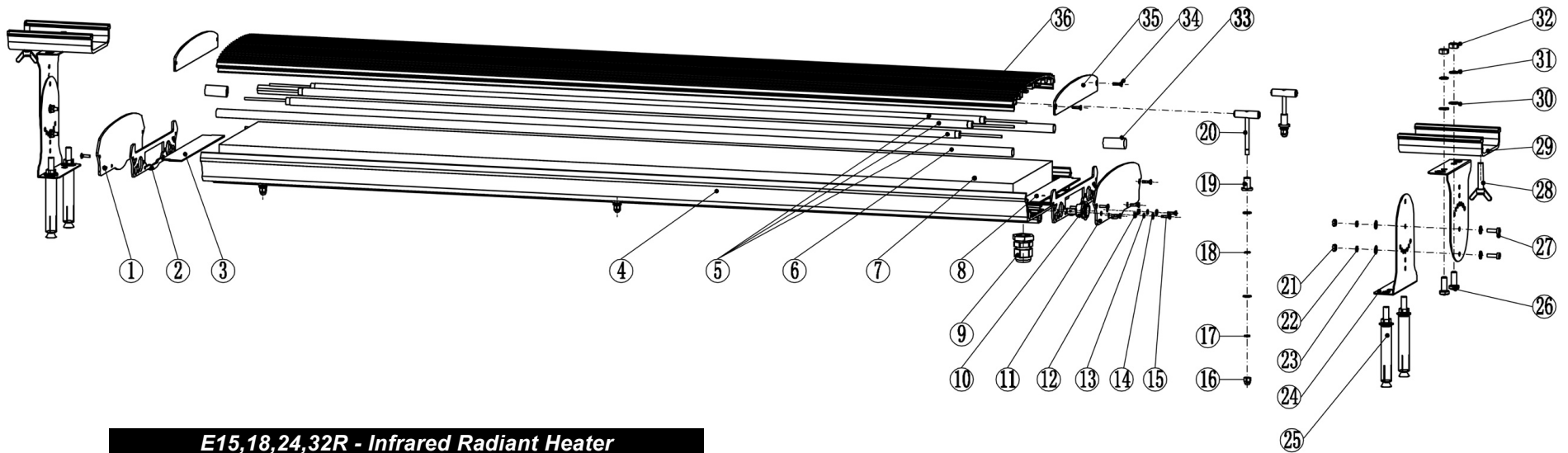

**E15,18,24,32R - Infrared Radiant Heater**

No.	Name	Qty
1	Side Plate – Left	1
2	Rubber Gasket	2
3	Spacer Block	1
4	Main Extrusion	1
5	Heating Rods	3
6	Insulation Sleeve	2
7	Ceramic Fiber Blanket	1
8	Printed Circuit Board	1
9	Plug	1
10	Thermostat Switch	1
11	Side Plate – Right	1
12	Stainless Steel Nut	2
13	Stainless Steel Lock Washer	2
14	Stainless Steel Flat Washer	2
15	Stainless Steel Screw	2
16	Stainless Steel End-Cap Nut	6
17	Stainless Steel Lock Washer	10
18	Stainless Steel Jump Ring	6

No.	Name	Qty
19	Rubber Sleeve	6
20	Stainless Steel T Bolt	6
21	Stainless Steel Nut	4
22	Stainless Steel Lock Washer	10
23	Stainless Steel Flat Washer	20
24	Stainless Steel Adjustable Mounting Bracket	4
25	Mounting Expansion Screw	4
26	Stainless Steel Hex-Bolt	4
27	Stainless Steel Phillips Head Screw	4
28	Stainless Steel Wing Bolt	2
29	Sliding Mounting Bracket	2
30	Stainless Steel Flat Washer	4
31	Stainless Steel Lock Washer	4
32	Stainless Steel Nut	4
33	Rubber Sleeve	2
34	Stainless Steel Self-Tapping Screw	12
35	Side Plate	2
36	Ceramic Coated Radiant Panel	1

# RADtec

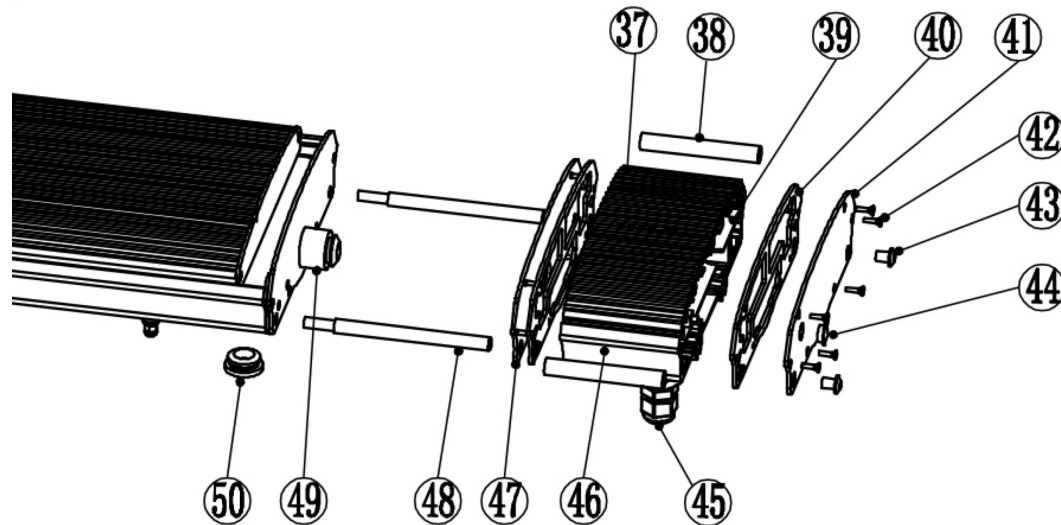

No.	Name	Qty
37	Ceramic Coated Control Panel	1
38	Insulation Sleeve	2
39	Control Circuit	1
40	Rubber Gasket	2
41	Side Plate – Right	1
42	Phillips Self-Tapping Screw	12
43	Pan Head Phillips Self-Tapping Screw	2
44	Manual Control Button Sleeve	1
45	Plug	1
46	Controller Extrusion	1
47	Side Plate – Left	1
48	Stainless Steel Guiding Rod	2
49	Wire Sleeve	1
50	Rubber Stopper	1

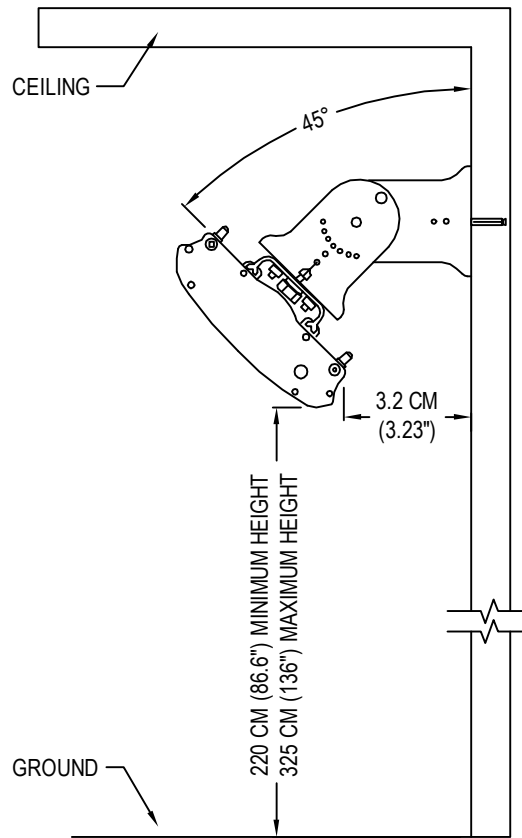

END ELEVATION

NOTES:

1. INSTALLATION TO BE COMPLETED IN ACCORDANCE WITH MANUFACTURER'S SPECIFICATIONS.
2. DO NOT SCALE DRAWING.
3. THIS DRAWING IS INTENDED FOR USE BY ARCHITECTS, ENGINEERS, CONTRACTORS, CONSULTANTS AND DESIGN PROFESSIONALS FOR PLANNING PURPOSES ONLY. THIS DRAWING MAY NOT BE USED FOR CONSTRUCTION.
4. ALL INFORMATION CONTAINED HEREIN WAS CURRENT AT THE TIME OF DEVELOPMENT BUT MUST BE REVIEWED AND APPROVED BY THE PRODUCT MANUFACTURER TO BE CONSIDERED ACCURATE.

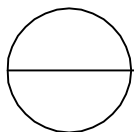

**ERAD RADIANT HEAT PANEL**

WALL MOUNT

SELECT DESIRED MODEL:

- ERAD15R
- ERAD18R
- ERAD24R
- ERAD32R

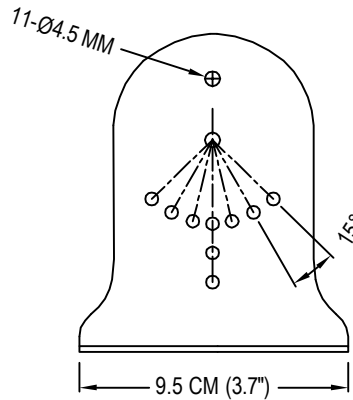

SIDE VIEW OF  
 ADJUSTABLE BRACKETS

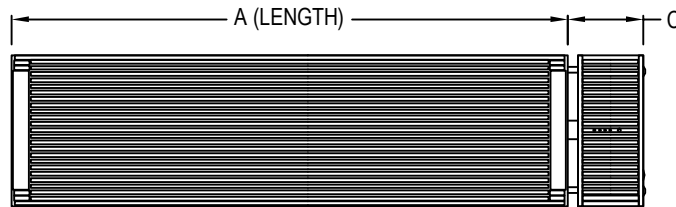

BOTTOM VIEW

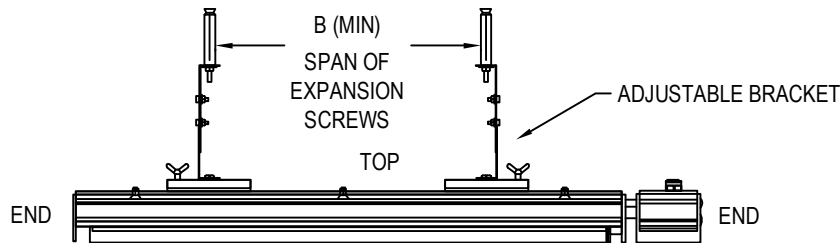

BOTTOM  
 SIDE ELEVATION

MODEL NUMBER	DIMENSIONS			ELECTRICAL REQUIREMENTS			
	DIMENSION A	DIMENSION B	DIMENSION C	WATTAGE (W)	AMPERAGE (A)	VOLTAGE(V)	WIRE LENGTH (IN)
ERAD15R	39.37"	27.60"	3.74"	1500	13.6	110-120	78.74
ERAD18R	39.37"	27.60"	3.74"	1800	7.8	220-240	78.74
ERAD24R	59.00"	47.20"	3.74"	2400	10.4	220-240	78.74
ERAD32R	78.70"	66.90"	3.74"	3200	13.9	220-240	78.74

NOTES:

1. INSTALLATION TO BE COMPLETED IN ACCORDANCE WITH MANUFACTURER'S SPECIFICATIONS.
2. DO NOT SCALE DRAWING.
3. THIS DRAWING IS INTENDED FOR USE BY ARCHITECTS, ENGINEERS, CONTRACTORS, CONSULTANTS AND DESIGN PROFESSIONALS FOR PLANNING PURPOSES ONLY. THIS DRAWING MAY NOT BE USED FOR CONSTRUCTION.
4. ALL INFORMATION CONTAINED HEREIN WAS CURRENT AT THE TIME OF DEVELOPMENT BUT MUST BE REVIEWED AND APPROVED BY THE PRODUCT MANUFACTURER TO BE CONSIDERED ACCURATE.

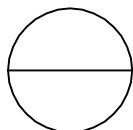

## ERAD RADIANT HEAT PANEL

SECTION VIEWS, DIMENSIONS, AND ELECTRICAL REQUIREMENTS

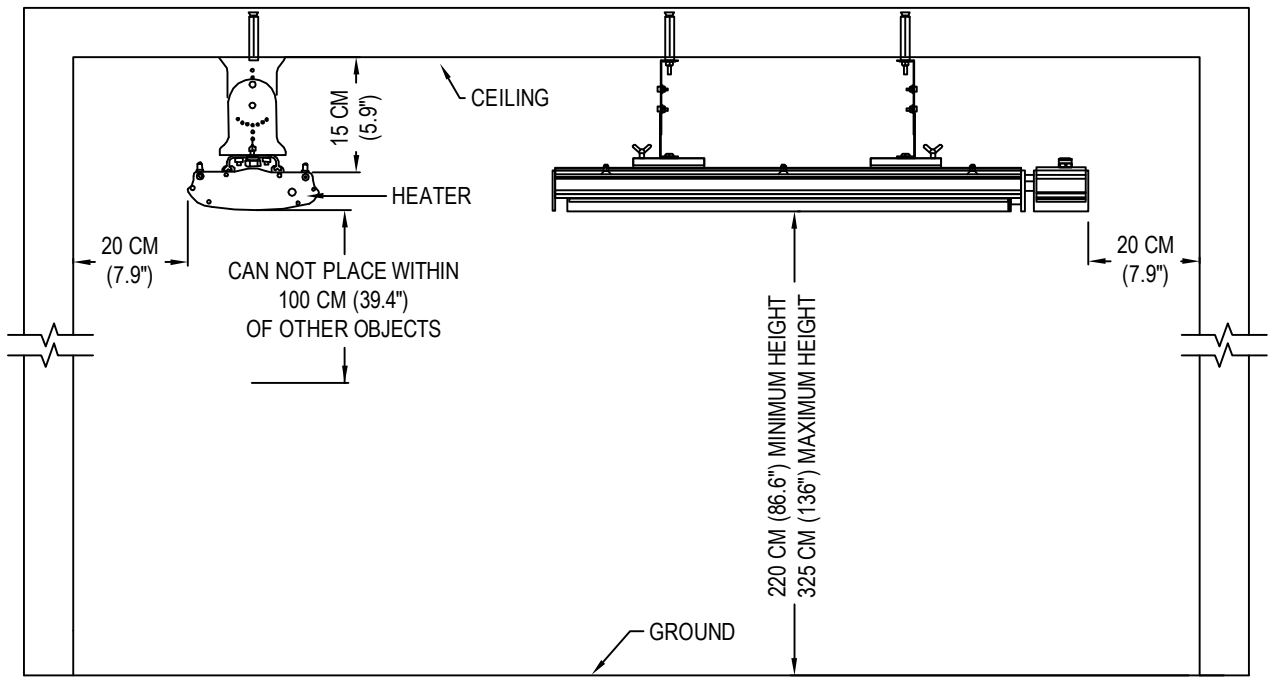

END ELEVATION

SIDE ELEVATION

NOTES:

1. INSTALLATION TO BE COMPLETED IN ACCORDANCE WITH MANUFACTURER'S SPECIFICATIONS.
2. DO NOT SCALE DRAWING.
3. THIS DRAWING IS INTENDED FOR USE BY ARCHITECTS, ENGINEERS, CONTRACTORS, CONSULTANTS AND DESIGN PROFESSIONALS FOR PLANNING PURPOSES ONLY. THIS DRAWING MAY NOT BE USED FOR CONSTRUCTION.
4. ALL INFORMATION CONTAINED HEREIN WAS CURRENT AT THE TIME OF DEVELOPMENT BUT MUST BE REVIEWED AND APPROVED BY THE PRODUCT MANUFACTURER TO BE CONSIDERED ACCURATE.

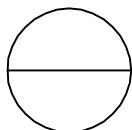

## ERAD RADIANT HEAT PANEL

CEILING MOUNT