

## NAVODILA ZA UPORABO USER MANUAL

Kavčič Pohištvo, Peter Kavčič  
s.p.

Šentjošt 18

1354 Horjul

Slovenia

www.kavcic-furniture.com

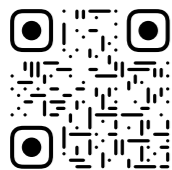

**HANGY je lepo oblikovan in vsestranski kos pohištva, ki združuje obešalnik za oblačila, omaro za čevlje in sedežno površino za obuvanje. Zahvaljujoč njegovim dimenzijam, zavzame le 0,1 m<sup>2</sup> tlorisne površine prostora. Njegova modularna zasnova omogoča najboljši možni izkoristek vašega prostora in dodaja polico za shranjevanje različnih stvari.**

**Funkcionalnost Hangy-ja se ujema z elegantno estetiko, doseženo z zaporedjem lesenih vertikal, ki lahko prikazujejo edinstvene motive po vašem osebnem okusu. Izdelan je iz visokokakovostnega masivnega lesa. Ta omogoča trpežnost in dolgo življenjsko dobo. Njegove naravne teksture, mehkoba in toplina ustvarjajo prijetno in pristno vzdušje v vsakem prostoru. Hangy je obvezna oprema za vsakogar, ki ceni tako obliko kot funkcijo svojega pohištva in želi čim bolj izkoristiti potencial svojega bivalnega prostora.**

### 3. Namestitev nosilcev

**3.1** S pomočjo vrtalnika naredite pilotne luknje (φ8mm) na označenih mestih za vijake.

**3.2** V luknje nato s pomočjo kladiva zabijete priložene vložke za vijake.

**3.3** Vzemite nosilec in ga poravnajte s pilotnimi luknjami.

**3.4** Skozi luknje nosilca, v pilotne luknje v steni vstavite vijake in jih tesno privijte z izvijačem ali baterijskim vijačnikom. Vijake zmerno zategnite.

Postopek ponovite za drug nosilec.

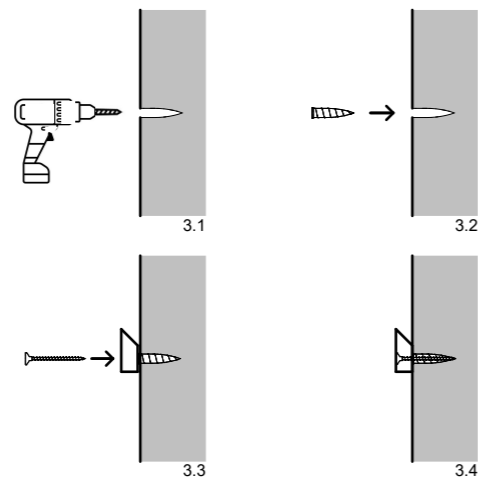

### OPOZORILA!

- Pred začetkom montaže preverite, ali je stena primerna za Hangy!
- Stena mora biti trdna in sposobna nositi težo le-tega z vsemi predvidenimi obremenitvami!
- Hangy je namenjen obešanju raznih stvari (oblačil, obutve,...) in pomožnemu sedenju (obuvanje, sezuvanje obutve), zato razno skakanje ali sunkovito usedanje se nanj NI dovoljeno! V nasprotnem primeru lahko pride do loma letvic!
- Zgornji dve vrsti letvic lahko prenesejo obremenitev do max 12,5kg, spodnje tri pa do max 100kg. Vendar jih moramo v primeru, da se nanje usedemo odpreti toliko, da se lahko normalno usedemo (vsaj 4).
- Hangy je testiran v skladu s certifikatom **SIST EN 14749:2016**.
- V primeru montaže na steno iz mavčnih plošč je potrebno preveriti trdnost le-te in uporabiti ustrezna pritrdila.
- Pohištvo je namenjeno standardni uporabi. Uporaba v ekstremnih razmerah izključuje vse reklamacije.

### 4. Namestitev Hangy

**Priporočljivo je, da sta med postopkom obešanja prisotni vsaj dve osebi, da zagotovite stabilnost in varnost.**

**4.1** Dvignite Hangy malce višje nad montirana nosilca in ga potisnite k steni.

**4.2** Previdno, počasi spuščajte Hangy, pri čemer poskrbite, da se pravilno usede.

**4.3** S pomočjo vodne tehtnice preverite, ali je nameščen vodoravno, tako da jo postavite ob zgornji rob.

**4.4** Ko je kos vodoraven, je varno obešen na nosilcih.

Preden se usedete ali nanj položite predmete, se prepričajte, da je trdno pritjen na steno!

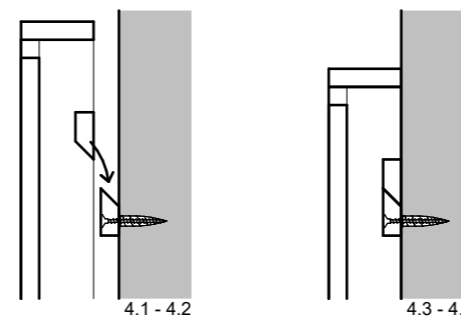

### 1. Priprava stene

**1.1** Z merilnim trakom in svinčnikom označite željene višine za nosilca na steni. Na primer, označite 600 mm in 1.760 mm od tal (skupno 1.160 mm med črtama), za optimalno namestitev.

**1.2** S pomočjo vodne tehtnice preverite, ali so oznake vodoravno poravnane.

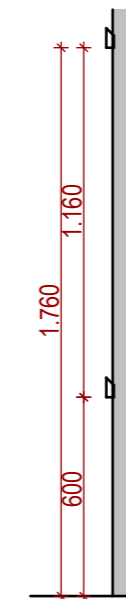

### NFC

Hangy ima na stranici vgrajen NFC čip, na mestu s spodnjo oznako:



Čip ni zaščiteno pred pisanjem, zato ga lahko uporabniki po želji prepisujete s svojo vsebino.

Za navodila, kako zapisati čip poskeniraj spodnjo QR kodo.

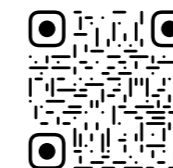

### 2. Označevanje lukenj nosilca

**2.1** Vzemite en nosilec in ga s spodnjim robom poravnajte s prvo oznako na steni.

**2.2** S pomočjo vodne tehtnice preverite, ali je nosilec vodoraven tako, da jo postavite ob zgornji rob nosilca.

**2.3** Ko je poravnan, s svinčnikom označite položaje lukenj za vijake na steni.

**2.4** Ponovite korake 2.1 do 2.3 za drug nosilec in drugo oznako na steni.

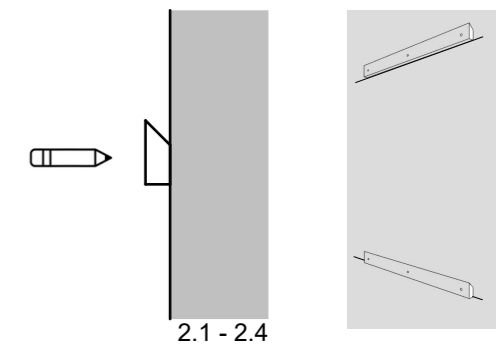

### Navodila za vzdrževanje

- Da bi dolgo časa ohranili lepoto pohištva je pomembno, da ga redno negujete.
- Uporabite lahko le pripomočke, ki so primerni za nego lesenih površin!
- Površine očistite z mehko vlažno krpo in jih zatem takoj obrišite s suho krpo.
- Uporaba čistil na osnovi topil, alkohola ali topil NI dovoljena!
- Les je naraven material, ki ima različne barvne in strukturne razlike, katere so posledica delovanja narave, zato le-te ne morejo biti vzrok reklamacije.
- Les potrebuje stalno zračno vlago 50-65%, v nasprotnem primeru so možne deformacije, ki ne morejo biti vzrok reklamacije.

HANGY is a beautifully designed and versatile piece of furniture that combines a coat rack, a shoe wardrobe, and a seating area for putting on shoes, all in a compact 0.1m<sup>2</sup> unit. Its modular design allows for the best possible use of your space and adds a shelf for storing various items.

Hangy's functionality is matched by its elegant aesthetic, achieved with a sequence of wooden verticals that can display unique motifs to suit your personal taste. Crafted from high-quality solid wood, Hangy is built to last and offers both durability and longevity. Its natural textures, softness, and warmth create a cozy and authentic atmosphere in any space. Hangy is a must-have for anyone who values both form and function in their furniture, and is looking to maximize the potential of their living space.

EN

#### 4. Hangy installation

It is recommended that at least two people are present during the hanging process to ensure stability and safety.

**4.1** Lift Hangy slightly higher than the mounted brackets and push it towards the wall.

**4.2** Carefully, slowly lower Hangy, making sure it settles correctly.

**4.3** Use a spirit level to check if it is installed horizontally by placing it against the top edge.

**4.4** When the piece is level, it is safely hung on the brackets.

Before you sit down or place items on it, make sure it is firmly attached to the wall!

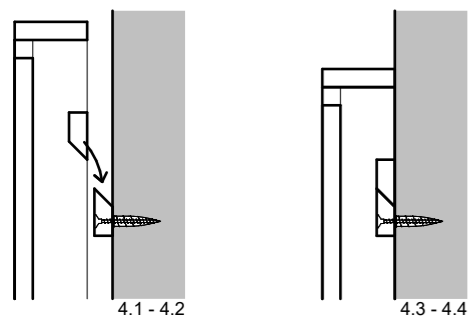

#### WARNINGS!

- Before starting installation, check if your wall is suitable for Hangy!
- The wall must be solid and capable of carrying its weight with all anticipated loads!
- Hangy is intended for hanging various things (clothes, shoes, ...) and seating (putting on, taking off shoes), so any jumping or sudden rough (?) sitting on it is NOT allowed! In that case, the slats may break!
- The top two rows of slats can carry a load of up to max 12.5kg, the bottom three up to max 100kg. In case we sit on them, we need to open enough of them, to be able to sit normally (at least 4 slats)
- Hangy is tested in accordance with the **SIST EN 14749:2016** certificate.
- In case of installation on a plasterboard wall, it is necessary to check its solidity and use appropriate fasteners.
- The furniture is intended for standard use. Use in extreme conditions excludes all refunds and complaints.

#### NFC

Hangy has an NFC chip built into the side, at the location with the bottom icon:



The chip is not write-protected, so users can overwrite it with their own content as desired.

For instructions on how to write to the chip, scan the QR code below.



#### 1. Preparing the wall

**1.1** With a measuring tape and pencil, mark the desired heights for the brackets on the wall. For example, mark 600 mm and 1.760 mm from the floor (a total of 1.160 mm between the lines), for optimal placement.

**1.2** With the help of a spirit level, check if the markings are horizontally aligned.

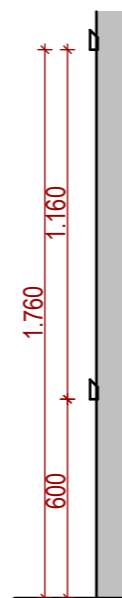

#### Maintenance

- To maintain the beauty of the furniture for a long time, it is important to take care of it regularly.
- You can only use tools that are suitable for the care of wooden surfaces!
- Clean the surfaces with a soft damp cloth and then immediately wipe them with a dry cloth.
- The use of solvents, alcohol or solvent-based cleaners is NOT allowed!
- Wood is a natural material that has different color and structural differences, which are the result of nature's work, so these cannot be a reason for a complaint.
- Wood needs a constant air humidity of 50-65%, otherwise deformations are possible, which cannot be a reason for a complaint.

#### 2. Marking the mounting holes

**2.1** Take one bracket and align its bottom edge with the first mark on the wall.

**2.2** With the help of a spirit level, check if the bracket is level by placing it against the top edge of the bracket.

**2.3** When it is aligned, mark the positions of the screw holes on the wall with a pencil.

**2.4** Repeat steps 2.1 to 2.3 for the other bracket and the other mark on the wall.

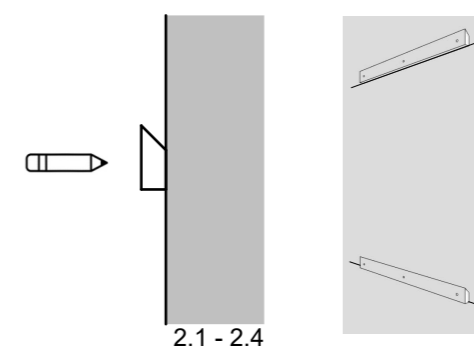

#### 3. Bracket mounting

**3.1** With the help of a drill, make pilot holes (φ8mm) at the marked places for the screws.

**3.2** Hammer the included screw inserts into the holes with a hammer.

**3.3** Take the bracket and align it with the pilot holes.

**3.4** Through the holes in the bracket, insert the screws into the pilot holes in the wall and tighten them tightly with a screwdriver or cordless screwdriver. Moderately tighten the screws. Repeat the procedure for the other bracket.

