

ADJUSTING SIZE

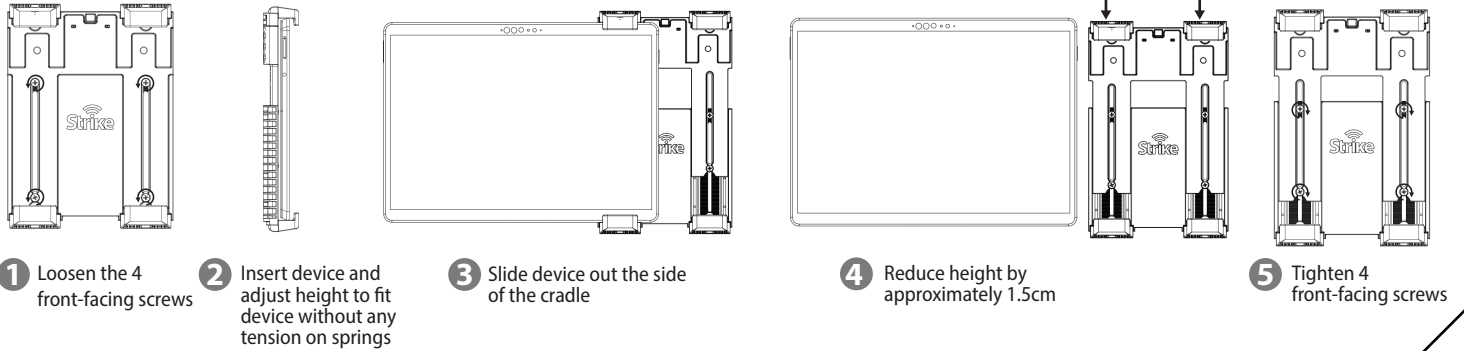

INSERTING DEVICE

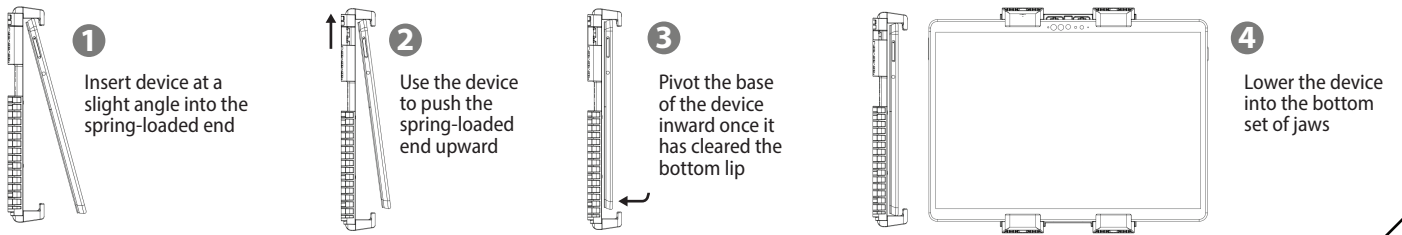

ADDING FOAM SPACERS

This is recommended if you are using a device that will be sitting flush against the back of the cradle, especially if it is not in a protective case.

- 1) Peel the foam spacer off the paper sheet
- 2) Stick the spacers in the areas shown

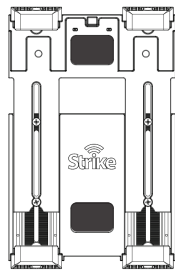

CHANGING JAWS

There is a larger set of jaws for devices that are too thick for the regular jaws.

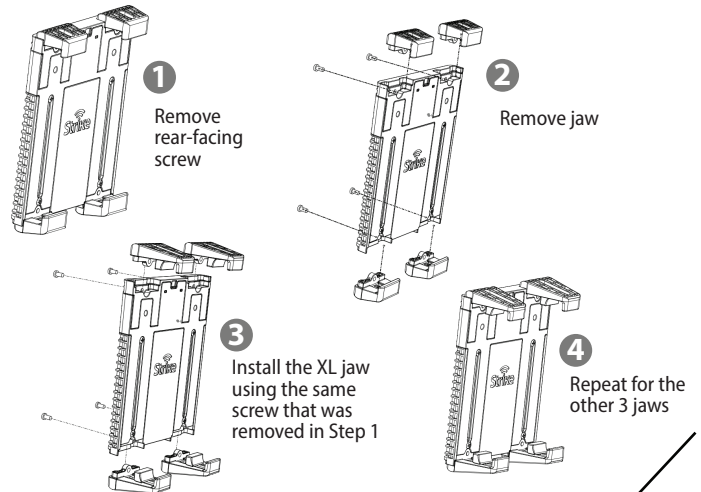

INSTALLING SLIDING CHOCK

The chock is helpful to stabilise the device of any forward and backward movement.

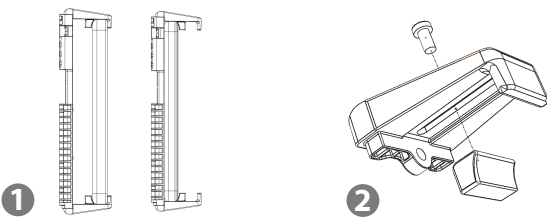

The chocks can be used to hold the device toward either the front or the back of the jaws. The curved, rubberised side should be directed toward the device.

Install chock into recessed channel of jaw, fixing in place from the other side with the screw provided in Bag B2. Do not fully tighten; the chock should still slide.

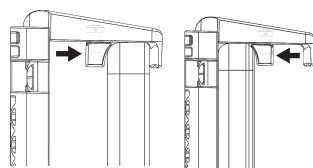

With device installed, slide chock so it is firm up against it, and fully tighten screw.

INSTALLING SIDE SUPPORT

If using the cradle in landscape, or side support is required for any reason, side supports are included in Bag C.

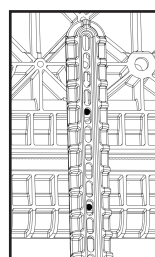
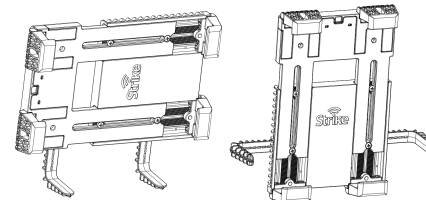

1 Place the bracket at the desired length, ensuring the rear slots line up with the mounting holes on the rear of the cradle

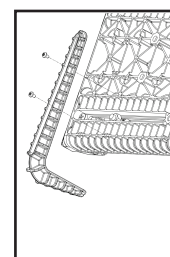

2 Insert and tighten screws provided (Bag C2)

BAG A

1 1 x Universal Tablet Cradle

2 2 x Foam Spacer

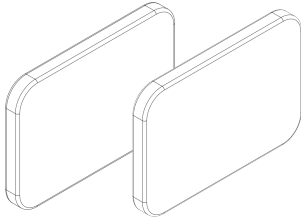

3 1 x Bag A2

a) 4 x M4 Washer

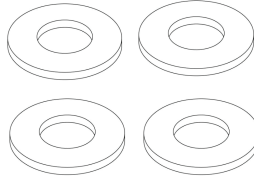

b) 4 x M4x12mm Machine Screw

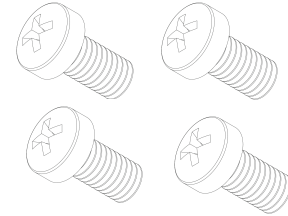

4 1 x Bag B

5 1 x Bag C

BAG B

1 4 x XL Jaw

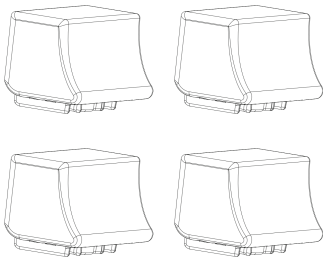

2 4 x Sliding Chock

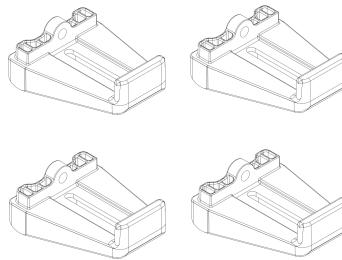

3 1 x Bag B2

a) 4 x M4x8mm Machine Screw

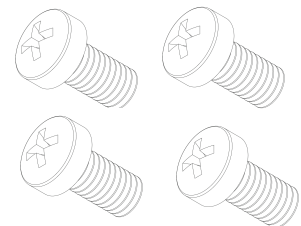

BAG C

1 2 x Side Support

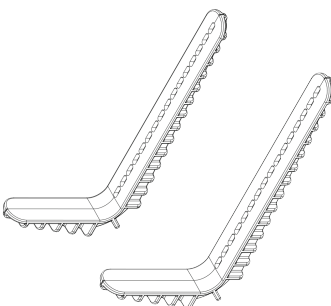

2 1 x Bag C2

a) 4 x Self-tapping Screw

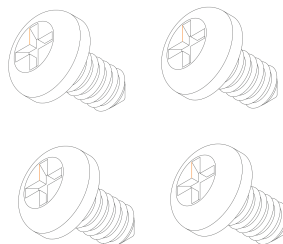

Need help? We're here for you.
Scan the QR Code.

