

Don't Break It

KG6804

Find the way to open and release the wine bottle but, Don't Break It.

Before you start to assemble the puzzle adjust the main rope to the desire height (you can determine the height by placing the bottle in the puzzle and start to adjust it - you want the rope to be tight) by making a notch in the rope at the bottom of the wooden piece that seat on top of the bottle head.

Solution: To assemble

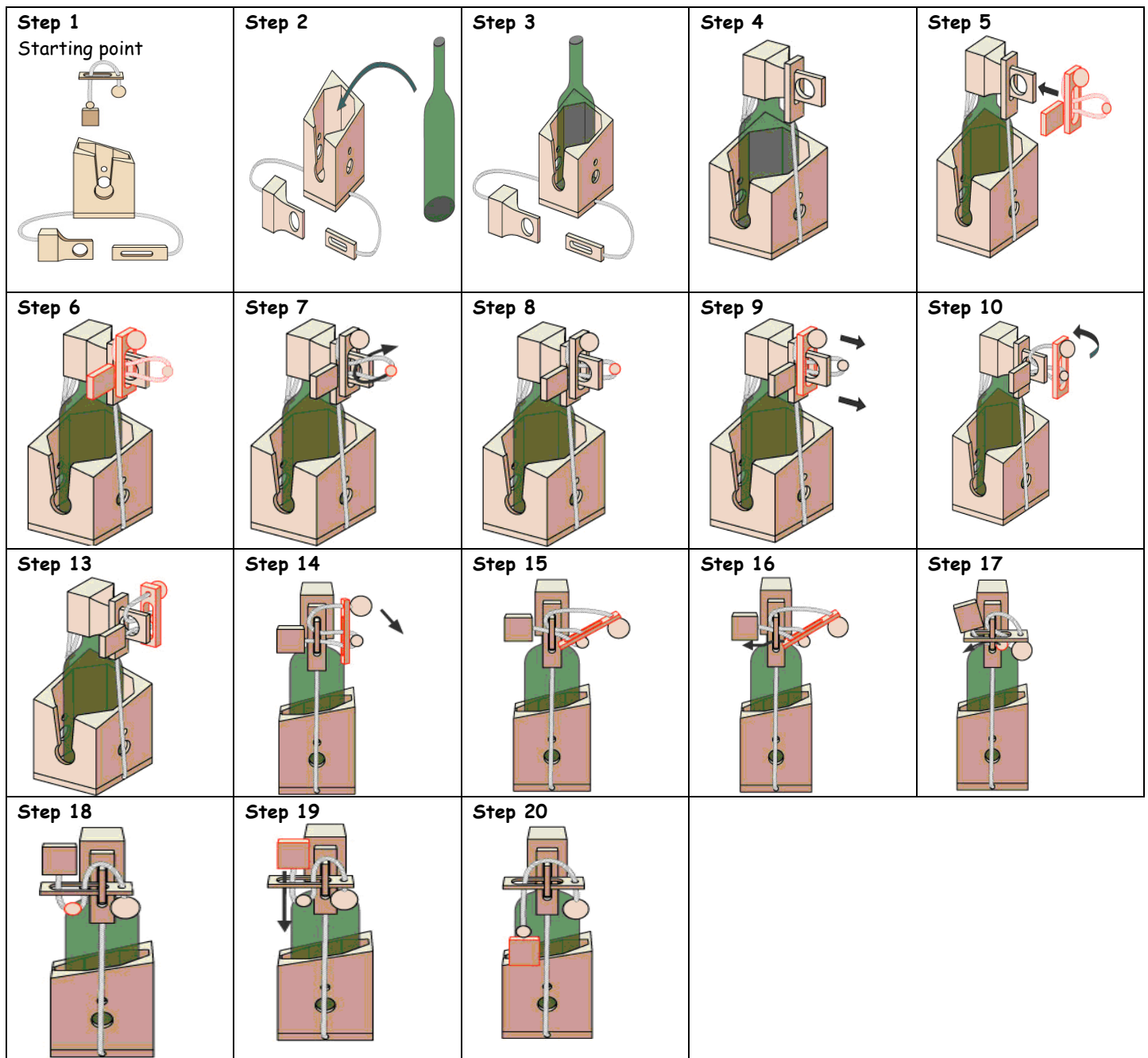

For the Don't Break It puzzle video solution please google:
[How To Solve The "Don't Break It" Wine Puzzle - BY KUBIYA GAMES](#)

Solution: To open

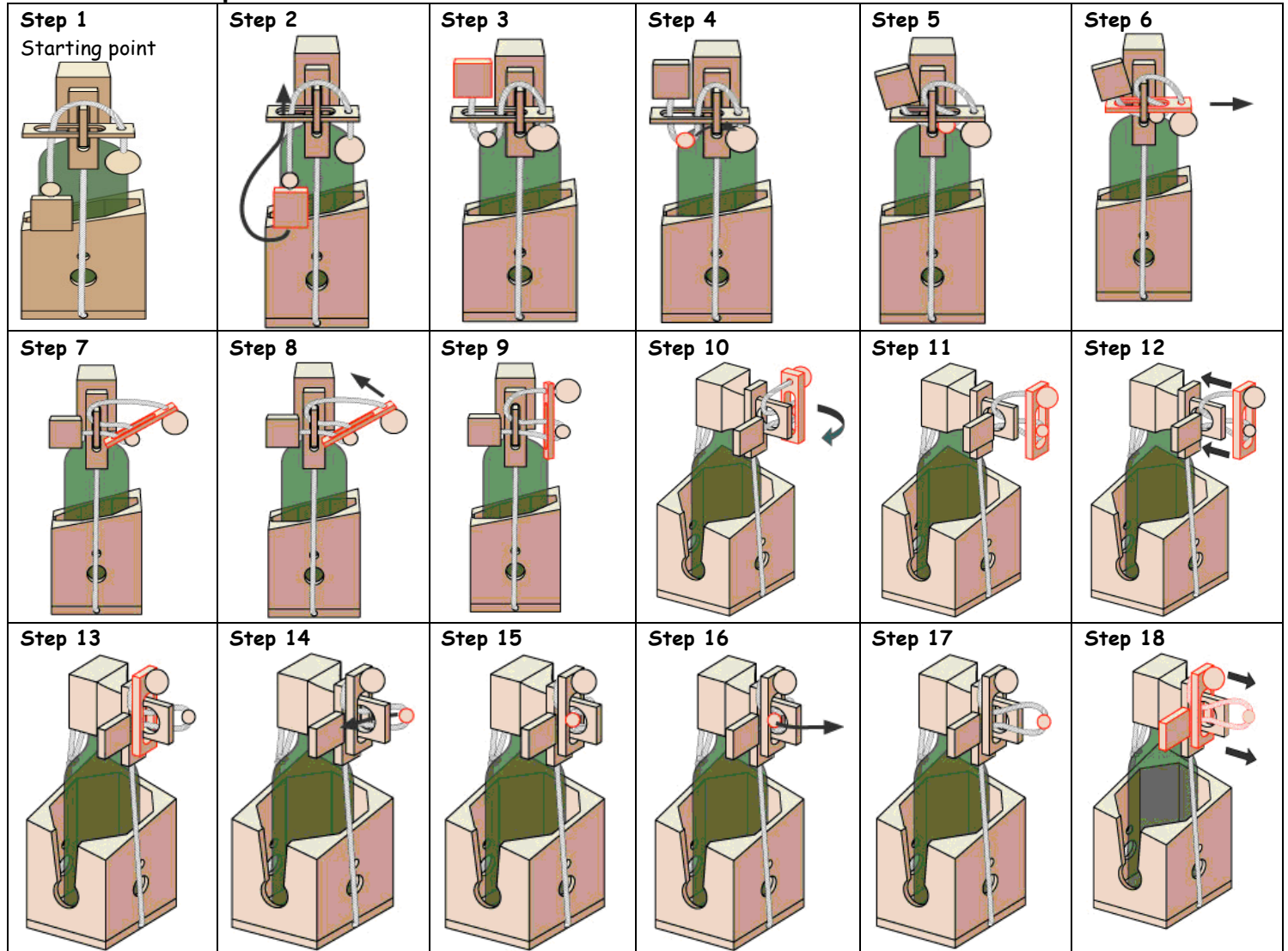

For the Don't Break It puzzle video solution please google:
[How To Solve The "Don't Break It" Wine Puzzle - BY KUBIYA GAMES](#)

