

SHIFTER STICKS



LIGHT WEIGHT ALUMINUM STICKS

Hurst aluminum shifter sticks are more resilient than steel in competition use, and are one-third lighter. 2024 aluminum heat treated to T-6. Ultimate tensile strength 68,000 psi. All aluminum sticks incorporate a 7/16 - 20 thread size and 7/8" center to center bolt spacing with 3/8" ID hole size.

NATURAL ALUMINUM FINISH

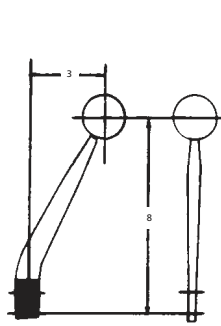

#538 0178
Used on shifters
366 0005, 391 8790

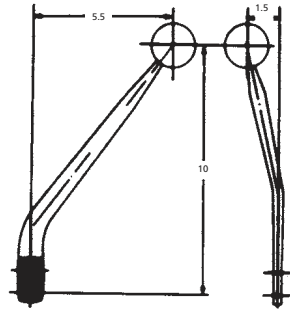

#538 0179
Used on shifters 391 4339, 366 4550

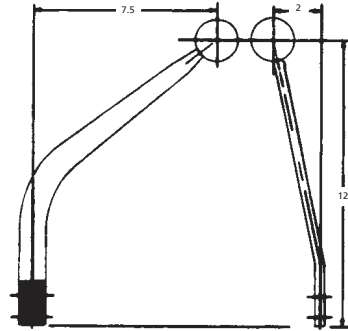

#538 0180

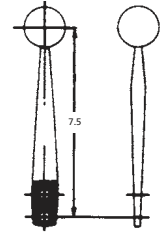

#538 0185
Used on shifters 391 7535,
391 0003, 391 7960, 491 0001

BLACK ANODIZED ALUMINUM FINISH

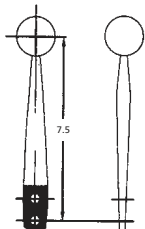

#538 0196
Used on shifters 391 0032,
391 5032, 391 5034

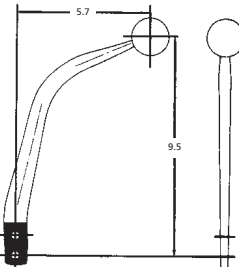

#538 0201
Used on shifter 391 0029

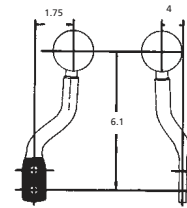

#538 0202
Used on shifter 391 0031

STEEL STICKS

Hurst steel sticks are constructed from a high strength steel and manufactured with Hurst quality.

BLACK STEEL STICKS

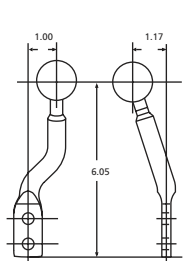

#238 5197
fits shifters 391 5030, 391 5072
12mm x 1.75 thread

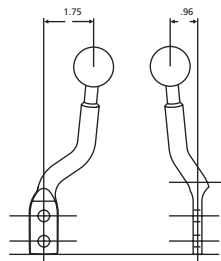

#238 5202
fits shifters 391 5031, 391 5070
12mm x 1.75 thread

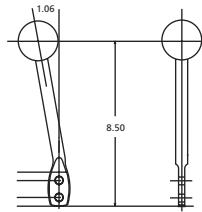

#238 8572
fits shifter 391 5060
16mm x 1.50 thread

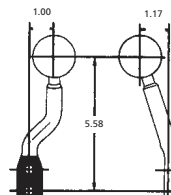

#538 0197
Used on shifters 391 0030, 391 0070
7/16-20 thread

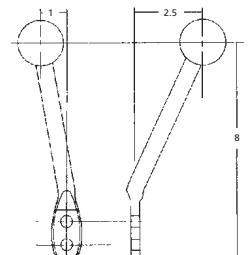

#538 8570
Used on shifter 391 0060
16mm x 1.50 thread



SHIFTER STICKS

STEEL STICKS

CHROME-PLATED STEEL STICKS

Hurst "bolt-on" shifter sticks are ideal for use in custom applications where a particular height or offset is required. These shifter sticks are constructed from high strength steel and are stamped with the Hurst name. All sticks incorporate a 3/8-16 thread size for use with many popular Hurst T-handles and shifter knobs. Bolthole size is 3/8" I.D. with 7/8" center-to-center spacing.

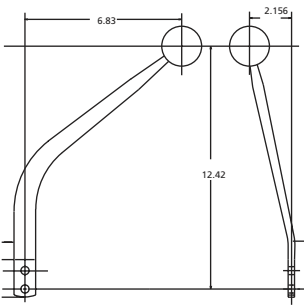

#238 0090
fits shifters 391 5040, 391 0033

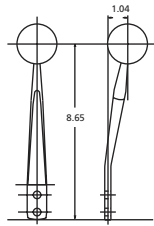

#238 0131
fits shifter 391 0028

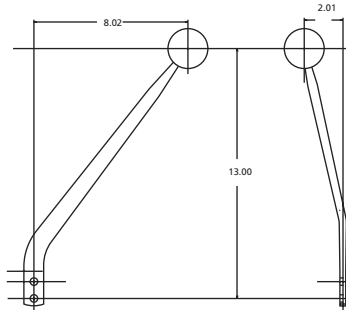

#238 0290
fits shifter 391 0110

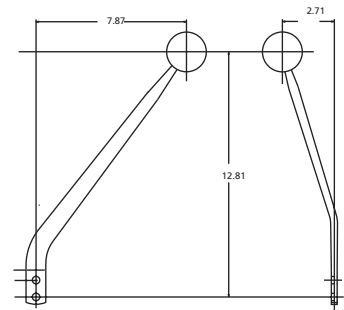

#238 0291
fits shifter 391 0120, 391 0121

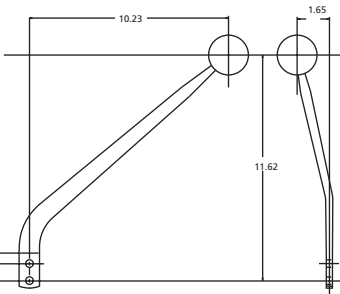

#238 0292
fits shifters 391 5050,
391 0111, 391 0155

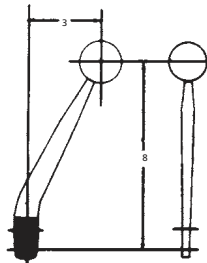

#538 0015
Used on shifters
391 8790, 366 0005

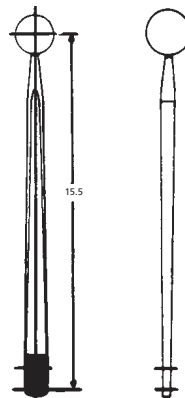

#538 0060
Used on shifter 366 0010

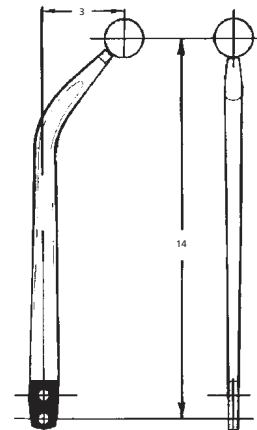

#238 0085
Used on shifter 391 0024

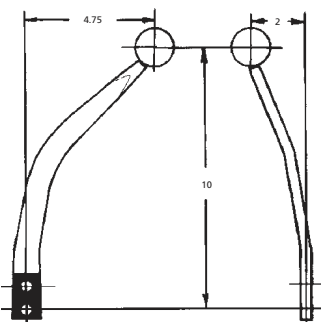

#538 0100
Used on shifter 407 0009

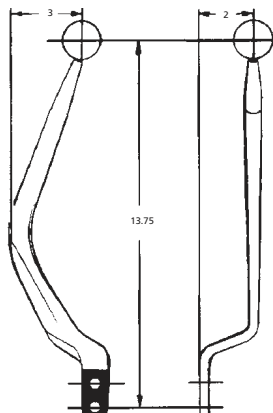

#538 0221

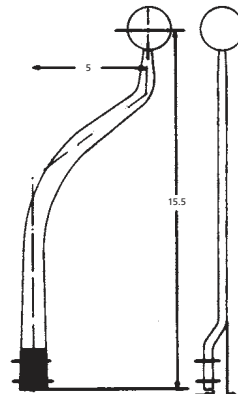

#538 4077

SHIFTER STICKS

STEEL STICKS

CHROME-PLATED STEEL STICKS

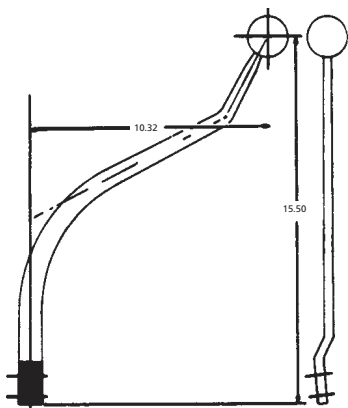

#538 4078
Used on shifter 391 6789

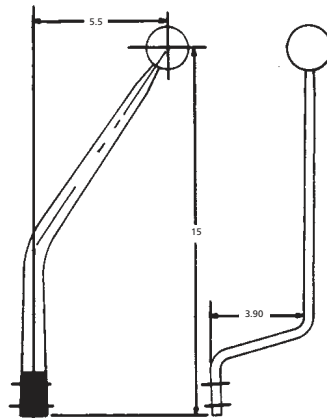

#538 4084
Used on shifter 391 6790

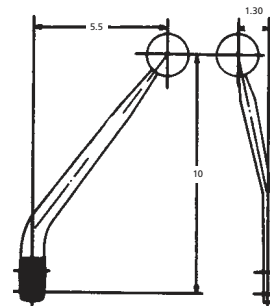

#538 4106
Used on shifters 391 4339,
391 7879, 366 4550

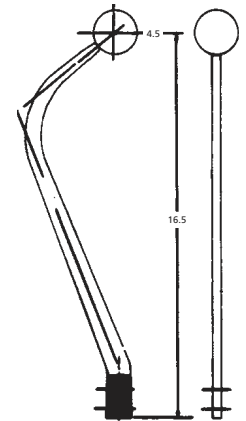

#538 4331
Used on shifters 391 0001,
391 0002, 366 6809

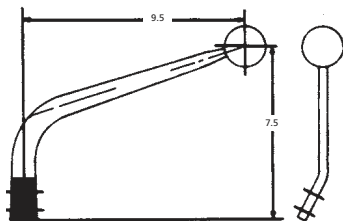

#538 6643

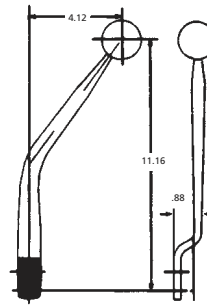

#538 6836
Used on shifters 391 6822,
391 7072, 391 6848

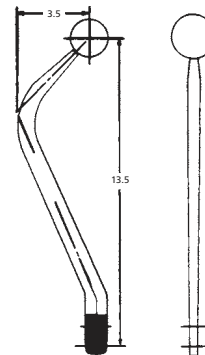

#538 6900
Used on shifters 366 6901,
391 8403, 391 8404, 391 5045

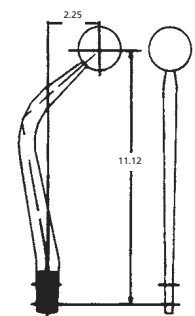

#538 7236
Used on shifters 391 7308,
391 7307, 391 7930, 366 7271

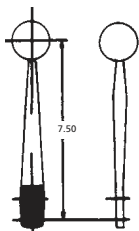

#538 7238
Used on shifters 391 7535,
391 5061, 391 7960

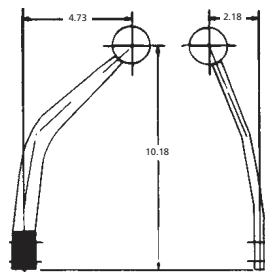

#538 7436
Used on shifters
391 7438, 366 7954

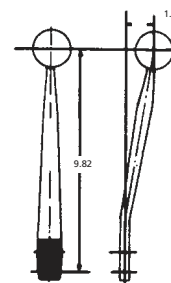

#538 7991
Used on shifter
391 7992

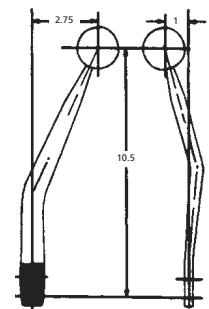

#538 8009
Used on shifters 391 8014,
391 8791, 391 8794

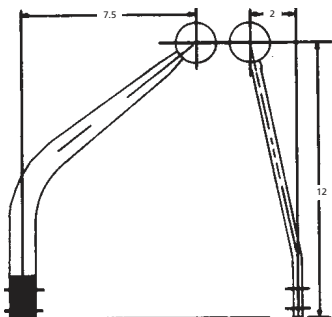

#538 8022
Used on shifter 366 8034

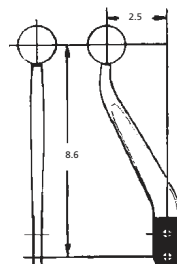

#538 8550
Used on shifter 391 0035,
391 0036, 319 0112

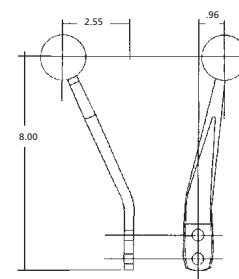

#538 8571
Used on shifter 391 0061

CHROME-PLATED STEEL STICKS

HURST "BOLT-ON" SHIFTER STICKS ARE IDEAL FOR USE IN CUSTOM APPLICATIONS WHERE A PARTICULAR HEIGHT OR OFFSET IS REQUIRED. These shifter sticks are constructed from high strength steel and are stamped with the Hurst name. All sticks incorporate a 3/8-16 thread size for use with many popular Hurst T-handles and shifter knobs. Bolt hole size is 3/8" I.D. with 7/8" center-to-center spacing.

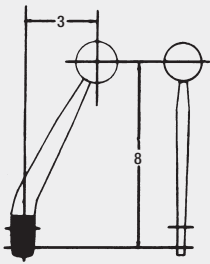

538 0015

Used on shifters
391 8790, 366 0005

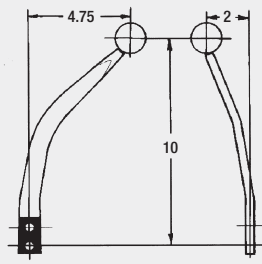

538 0100

Used on shifter 407 0009

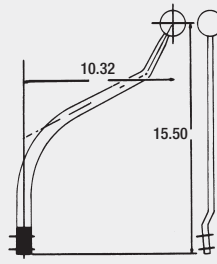

538 4078

Used on shifter 391 6789

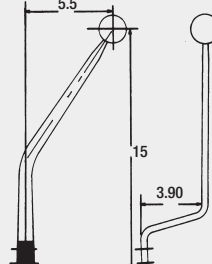

538 4084

Used on shifter 391 6790

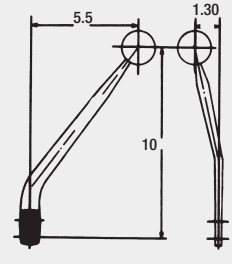

538 4106

Used on shifters 391 4339,
391 7879, 366 4550

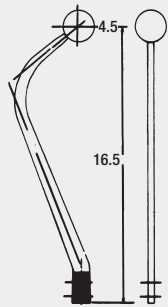

538 4331

Used on shifters 391 0001,
391 0002, 366 6809

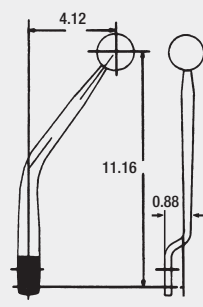

538 6836

Used on shifters 391 6822,
391 7072, 391 6848

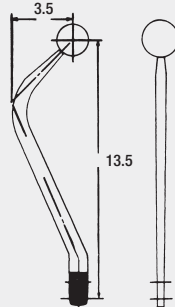

538 6900

Used on shifters
366 6901, 391 8403,
391 8404, 391 5045

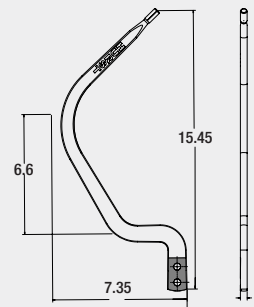

538 8620

Used for bench seats

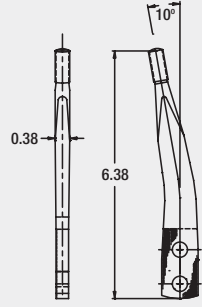

538 7201

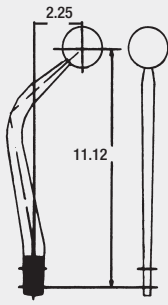

538 7236

Used on shifters
391 7308, 391 7307,
391 7930, 366 7271

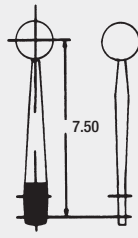

538 7238

Used on shifters 391 7535,
391 5061, 391 7960

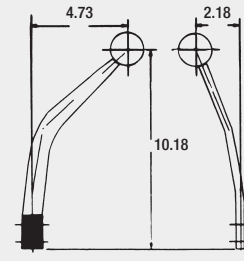

538 7436

Used on shifters
391 7438, 366 7954

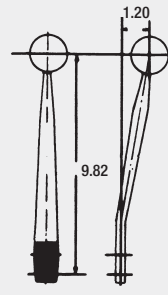

538 7991

Used on shifter
391 7992

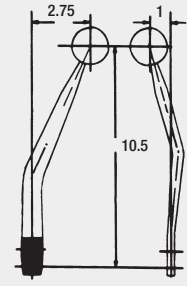

538 8009

Used on shifters 391 8014,
391 8791, 391 8794

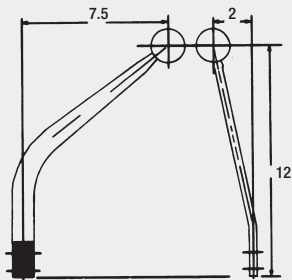

538 8022

Used on shifter 366 8034

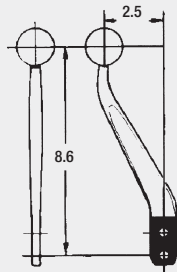

538 8550

Used on shifters
391 8790, 366 0005

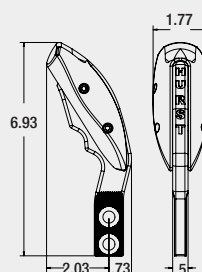

538 8655 / 538 8665

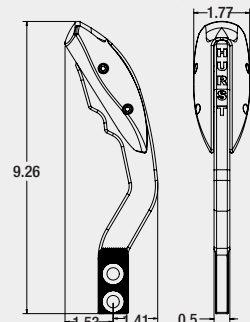

538 8650 / 538 8660

