

**VALYÖU**

**Shell Chair**

019

HOW TO PUT TOGETHER

Ⓐ x1

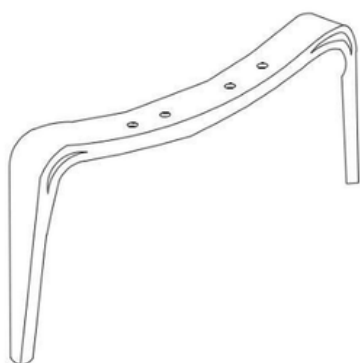

Ⓑ x1

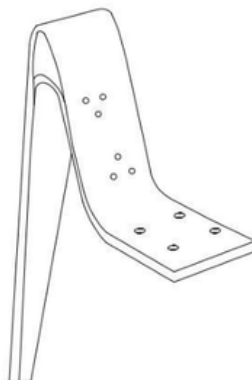

Ⓒ x1

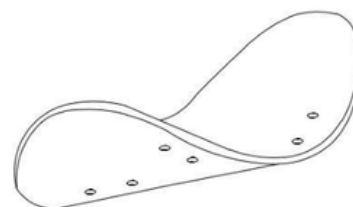

Ⓓ x1

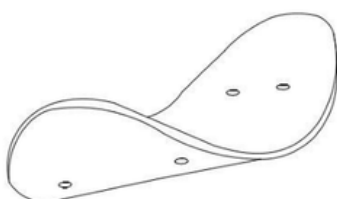

Ⓔ x1

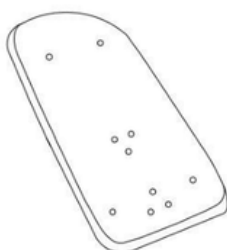

Ⓕ x1



Ⓖ x1



Ⓕ x6



Ⓖ x7



Ⓗ x15



Ⓙ x1

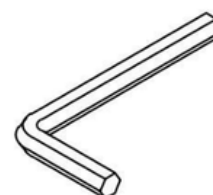

## Step1

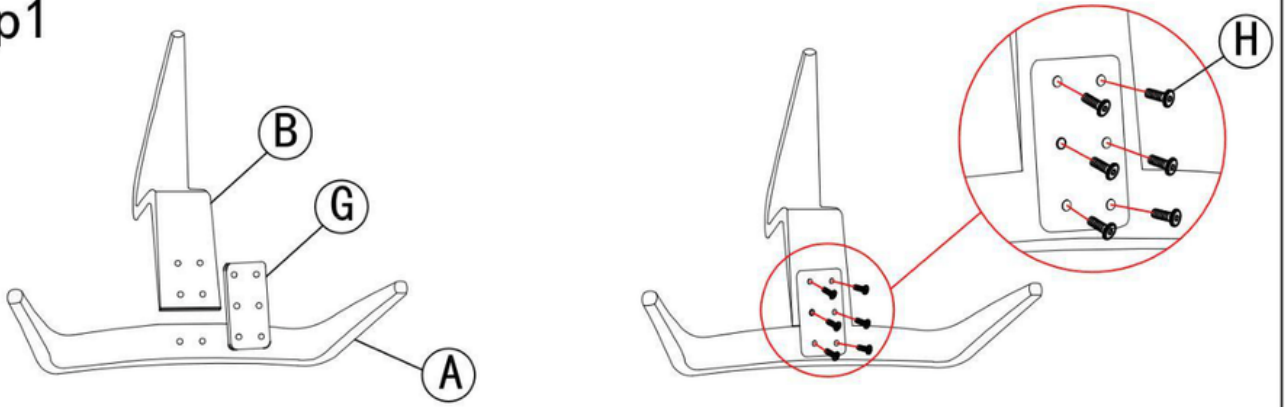

## Step2

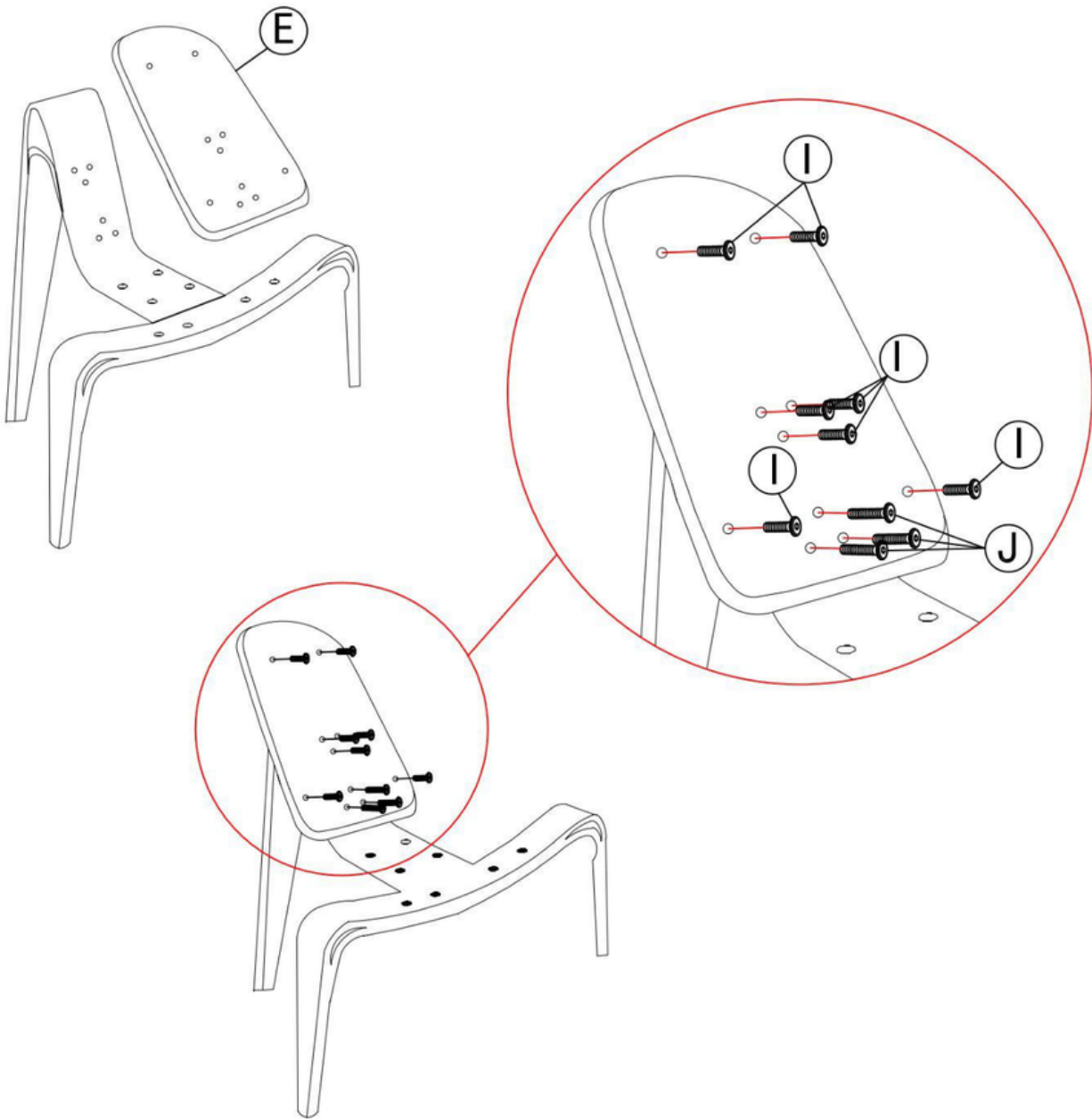

### Step3

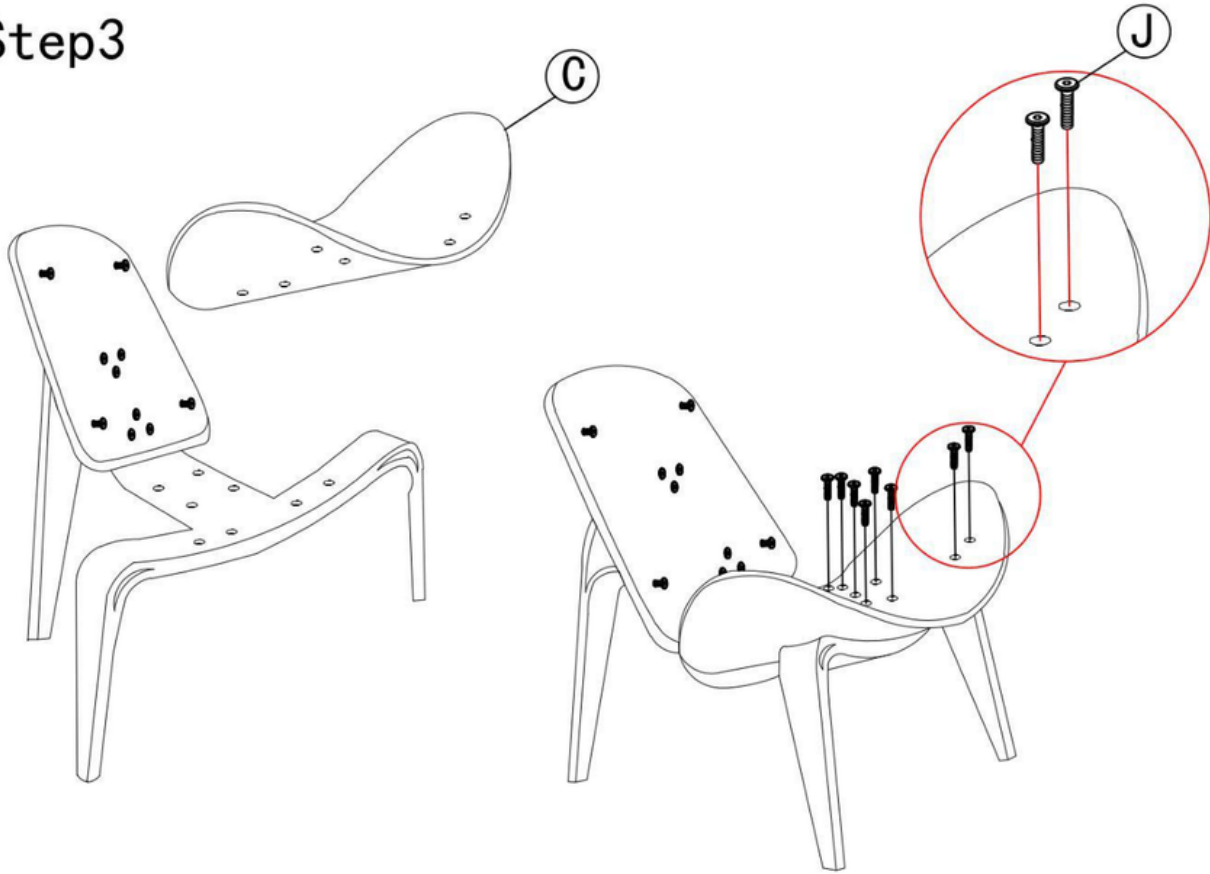

### Step4

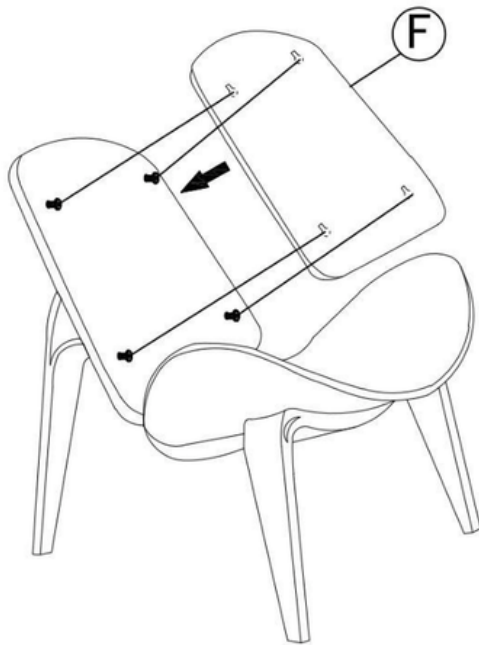

Use the four holes on the back of F to align the four screws on E and hang them up



Step 5

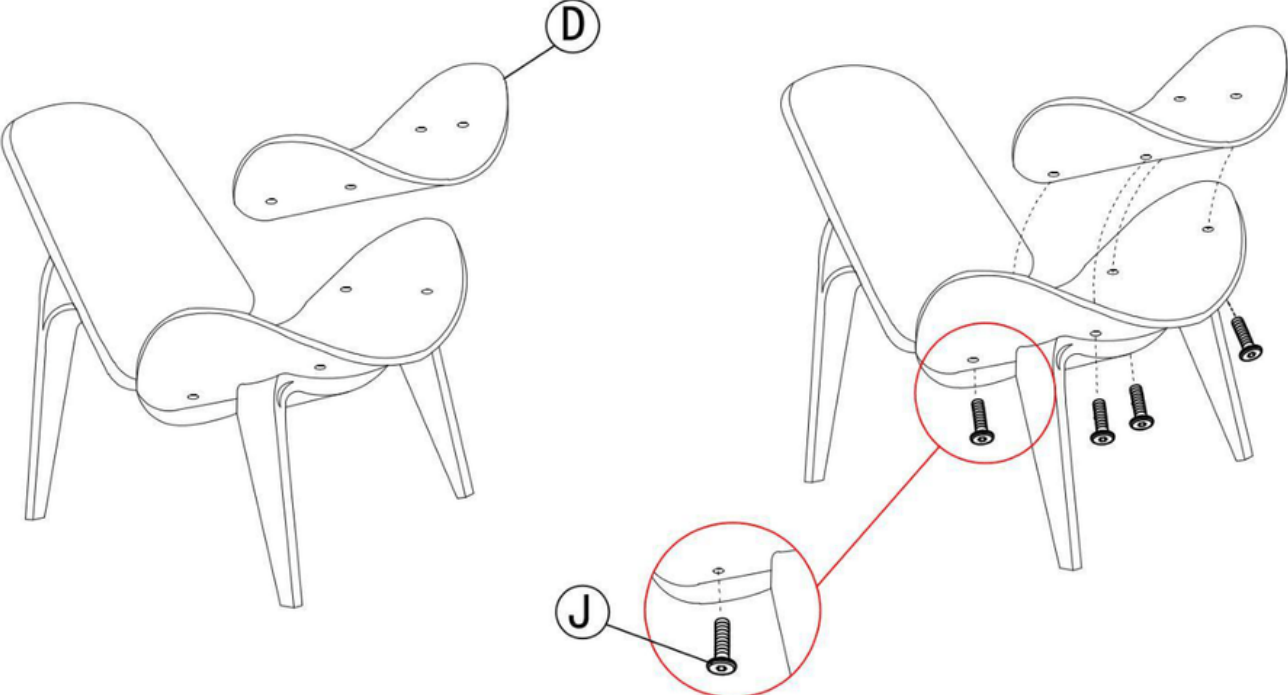

**MANUFACTURED BY**  
VALYOU FURNITURE® HONOLULU, HAWAII

**CUSTOMER SERVICE:**  
SERVICE@VALYOUFURNITURE.COM

**FOLLOW US:**  
@VALYOU FURNITURE

