



**euro**  
*appliances*

rangehoods

USAGE AND  
CARE GUIDE

PRODUCT  
CODE:  
EAF600SS/WH



# **CONTENTS**

WARNING .....	3
MAIN PARAMETERS .....	5
DESCRIPTION OF THE DEVICE .....	5
INSTALLATION .....	6
OPERATION .....	9
REPLACING BULB .....	10
CLEANING AND MAINTENANCE .....	10
DISPOSAL .....	11

## **WARNING**

1. There shall be adequate ventilation of the room when the range hood is used at the same time as appliances burning gas or other fuels.
2. Do not check the status of the filters while the cooker hood is operating.
3. Do not touch the light bulb within half an hour after appliance use.
4. Do not flambé under the range hood.
5. Avoid opening gasometer when there is no pan on the stove, as it is damaging for the filters and a fire hazard.
6. Constantly check food frying to avoid that the overheated oil may become a fire hazard.
7. If the supply cord is damaged, it must be replaced by the manufacture, its service agent or similarly qualified persons in order to avoid a hazard.
8. The socket outlet for the range hood must be located so it is easily accessible for the user after installation. Ensure the mains supply voltage corresponds with that of the appliance.
9. There is a fire risk if cleaning is not carried out in accordance with the instructions.
10. This appliance can be used by children aged from 8 years and above and persons with reduced physical, sensory or mental capabilities or lack of experience and knowledge if they have been given supervision or instruction concerning use of the appliance in a safe way and understand the hazards involved.
11. Children shall not play with the appliance.
12. Cleaning and user maintenance shall not be made by children without supervision.
13. When the hood is in repair, maintenance, replacement of parts, please pull out the plug, ensure the safety of the people.
14. To protect the main body from corrosive of the long time accumulation of dirt, the cooker hood should be cleaned with hot water with non-corrosive detergent every two months.

15. The air must not be discharged into a flue that is used for exhausting fumes from appliances burning gas or other fuels.
16. Regulations concerning the discharge of air have to be fulfilled.
17. The minimum distance between the supporting surface for the cooking vessels on the hob and the lowest part of the range hood. This distance shall be at least 65 cm. If the instructions for installation specify a smaller distance, this has to be taken into account. The distance of 65 cm can be reduced for: non-combustible parts of range hoods, except grease filters, and parts operating at safety extra low voltage, provided these parts do not give access to live parts if deformed.
18. Regarding the instructions for the method of fixing and how the appliance is to be fixed to its support, thanks to refer to the section "INSTALLATION".
19. Regarding the instructions for the blub replacement, thanks to refer to the section "REPLACING BLUB".
20. Regarding the instructions for the method and frequency of cleaning, thanks to refer to the section "CLEANING AND MAINTENANCE".
21. Range hoods and other cooking fume extractors may adversely affect the safe operation of appliances burning gas or other fuels (including those in other rooms) due to back flow of combustion gases. These gases can potentially result in carbon monoxide poisoning. After installation of a range hood or other cooking fume extractor, the operation of flued gas appliances should be tested by a competent person to ensure that back flow of combustion gases does not occur.

#### **CAUTION:**

Accessible parts may become hot when used with cooking appliances.

Please keep this instruction booklet in a safe place for future reference. Please read this instruction manual careful: it contains important information concerning the safe operation, installation and maintenance of the appliance.

## MAIN PARAMETERS

Rated Voltage and Frequency: 220-240V~ 50Hz

Motor Input Power: 125W

In certain circumstances electrical appliance may be a danger hazard.

## DESCRIPTION OF THE DEVICE

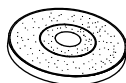
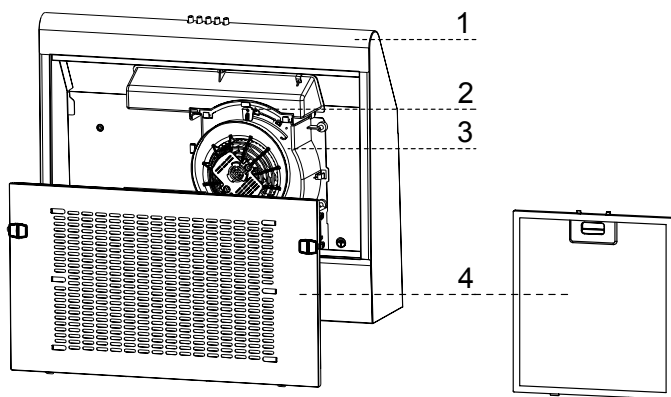

5



6



7



8



9

The cooker hood

1. Air Duct Assembly
2. Venting Knob
3. Main Body
4. Filter Assembly (optional)

Other accessories:

5. Carbon Filter (optional)
6. Check Valve (1 pcs)
7. Air Outlet Cap (1 pcs)
8. Screws 5mm x 49mm (4 pcs)
9. Plastic Wall Plugs  
10mm x 43.3mm (4 pcs)

# INSTALLATION

## Before installing your wall canopy:

- Please read the instructions carefully.
- Unpack the canopy and check that all functions are working. Ensure that the voltage (V) and the frequency (Hz) indicated on the serial plate match the voltage and frequency at the installation site.
- Check that the area behind the installation surface to be drilled is clear of any electrical cables or pipes, etc.
- The stainless steel and glass surfaces of the canopy are very easily damaged during installation if grazed or knocked by tools. Please take care to protect the surfaces during installation.
- Protect the cooktop surface below with cardboard, or the like, to prevent damage occurring whilst the wall canopy is being installed above.
- The manufacturer shall not be liable for failure to observe all safety regulations in force for the correct and normal operation of electrical parts.

## Choose a venting mode:

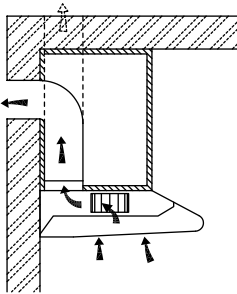

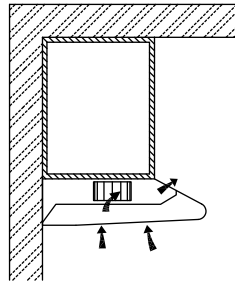

Exaction-air mode

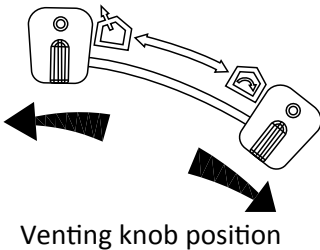

Recirculation mode



	Extraction-air mode: Turn the venting knob here means venting outside
	Circulating-air mode: Turn the venting knob here means recirculation

## Information

- Sufficient air is needed for proper combustion and exhaustion of gases through the flue (chimney) of fuel burning equipment to prevent back drafting. Ductless fans must always be vented to the outdoors.
- When assessing the air pressure, the entire ventilation system in the house/apartment must be taken into account, e.g. hob and/or gas cooker, this rule does not apply.
- Government regulations must be observed for the conveyance of exhaust air. If the extractor hood is used in circulating air mode with activated carbon filter, there are no operating restrictions.
- If you choose extraction-air mode, install check valve on the vent hole .

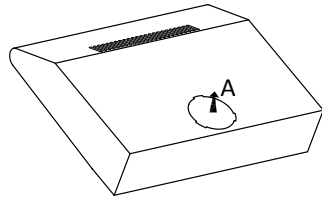

## Prepare the installation:

Ensure the power has been turned off before beginning this installation. Plug must be assembled in places easy to drag and insert.

To install this hood you will require two assistants. You will need following tools and material to complete this installation.

Tools you will need:

- Drill appropriate to your wall
- Phillips Screwdriver
- Tape Measure
- Hand Saw or Jig Saw

Installation work and electrical wiring must be done by qualified person(s) in accordance with all applicable codes and standards, including fire rated construction.

Do not discharge the exhaust air into a flue from other appliances burning gas or other fuels. Regulations concerning the discharge of air have

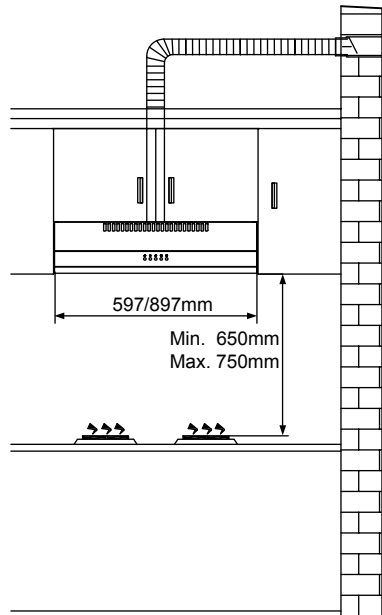

to be fulfilled.

The cooker hood must be placed at a minimum distance of 65cm above the cooking surface of a hob.

### Cupboard mounting installation:

1. Drill a 130mm diameter and four 3.5mm diameter hole as below picture.
- **ATTENTION:** If your cooker hood works at circulating-air mode, it is not necessary to drill 130mm diameter hole.
2. Use the 4 screws to fix the cooker hood to a kitchen cupboard .Check that your fixings are correctly located, by temporarily fitting the cooker hood. If correct, fit the unit into position. Tighten the screws if necessary.

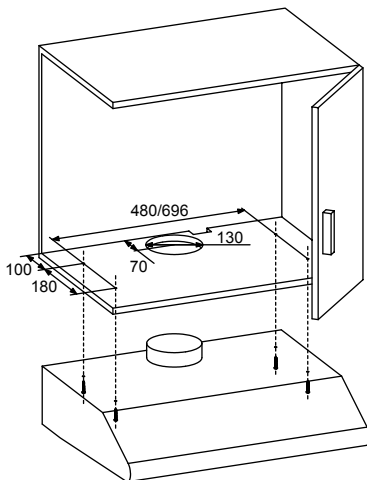

### Wall mounting installation:

1. To mount on the wall, drill two 10mm diameter holes 538/696mm with the vent hole on the top of the cooker hood in the middle as below picture. Make sure the hood is aligned directly over the hob.
2. Insert two plastics wall plugs (supplied) into the holes.
3. Insert two screws into the upper two plastic wall plugs and tighten them leaving 3mm protruding from the wall.
4. Mount the cooker hood onto the two screws and mark the bottom two screw positions.
5. Remove the hood and drill the bottom two screw holes and Insert the plastic wall plugs.
6. Mount the hood on the top screws, Insert the bottom screws and fully tighten all the screws.

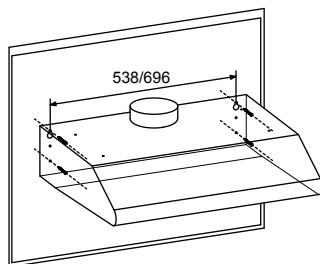



**⚠ Information**

The air must not be discharged into a flue that is used for exhausting fumes from appliances burning gas or other fuels.

**OPERATION**

➤ **Switch A:**



①	OFF MOTOR SWITCH: Press on this switch to stop the motor operation.
🌀	SPEED SWITCH: Press on this switch, the motor runs at LOW speed.
🌀	SPEED SWITCH: Press on this switch, the motor runs at MEDIUM speed.
🌀	SPEED SWITCH: Press on this switch, the motor runs at HIGH speed.
💡	ON/OFF LIGHTING SWITCH: Press on this switch to turn on the lights, and press again to turn them off.

➤ **Switch B:**

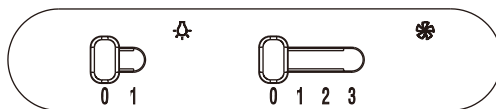

💡	0	Off lighting.
	1	On lighting.
🌀	0	Off motor.
	1	The motor runs at LOW speed.
	2	The motor runs at MEDIUM speed.
	3	The motor runs at HIGH speed.

## REPLACING BULB

1. Switch off the extractor hood and isolate the extractor hood by pulling out the mains plug or switching off the fuse.
2. Remove the grease filter.
3. Replace the lamp (commercially) led modules, separate ballast.
4. Reconnect the power by inserting the mains plug or by switching on the fuse.

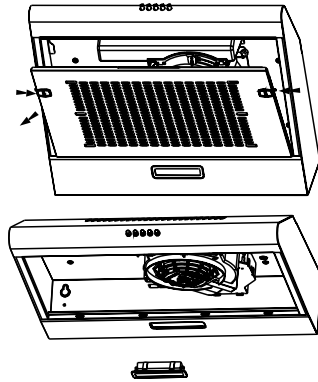

	Max power	Voltage	Picture	Lamp Cap	ILCOS D code
LED modules, separate ballast	1.5W	220-240V	 Square/Diameter:33.2mmx120mm		DSH-1.5-S-33.2/120

### Information

Clean ventilation fans frequently. Grease should not be allowed to accumulate on fan or filter.

## CLEANING AND MAINTENANCE

Disconnect range hood from power supply before cleaning or servicing.

1. Cleaning the surface of hood frequently. Use mild soap or detergent to clean the hood.
2. Do not use harsh alkalis or abrasives.
3. Avoid the use of scouring powders or dishwasher compounds.
4. Grease filter may be washed using mild soap or detergent. (Heavy grease build-up may not be cleaned easily and the filter may require replacement)
5. Charcoal filter cannot be cleaned and must be replaced regularly.

### Information

Cleaning water must not enter into motor, control switch etc. electrical parts.

It is recommendable to clean the metallic filter every three months by carrying out the following instruction:

1. Remove the metallic filter from the cooker hood and wash it in a solution of water and neutral liquid detergent, leaving to soak.

2. Rinse thoroughly with warm water and leave to dry.
3. The metallic filter may alter in color after several washes. This is not cause for customer complaint or replacement of metallic filter.

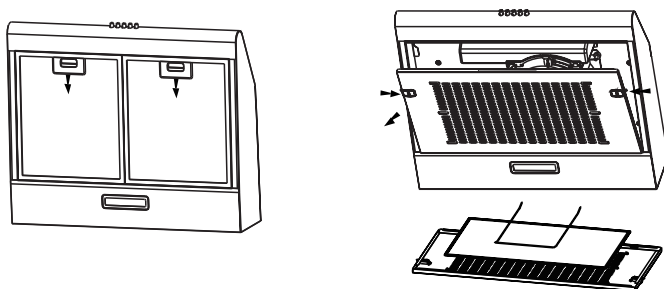

### Information

There is a fire risk if cleaning is not carried out in accordance with the instructions.

### Installing the carbon filter:

1. Remove the grease filter
2. The charcoal filter is located at end of the motor. Turn the carbon filter until it is unscrewed.
3. Replace a new carbon filter, apply reverse procedure for re-installation.

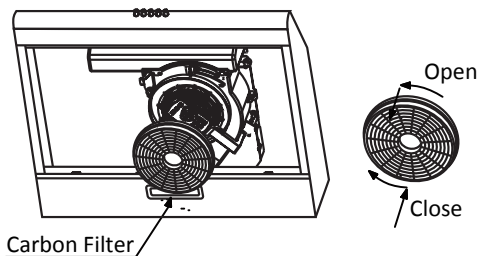

- **Warning:** the carbon filter cannot be washed or recycled. It should be replaced after approximately 2-3 months of use.
- **Remark:** Carbon filter is not supplied with your appliance.

## DISPOSAL

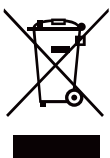

Please dispose of it at your local community waste collection / recycling center and ensure it presents no danger to children while being stored for disposal. The plug must be rendered useless and the cable cut off to prevent misuse.



**Pronto** Service + Support: 1800 440 335 Email:  
service@eurostylegroup.com.au

HEAD OFFICE  
65 Glynburn Road, Glynde SA 5070  
Ph: 08 8165 1012

**[www.euroappliances.com.au](http://www.euroappliances.com.au)**