

MPPT SOLAR CHARGE CONTROLLER

Features:

- ✦ High-efficient MPPT algorithm, conversion rate $\geq 99.5\%$
- ✦ Auto-recognition of battery system (voltage)
- ✦ Support Seal/Gel/Flooded battery and customized batteries
- ✦ Three stages charging mode: CC, CV, CF
- ✦ Current-limited charging function
- ✦ Various electronic protections
- ✦ High definition LCD segment display
- ✦ RS485 communication port
- ✦ Support PC and APP (Android & iOS) monitoring
- ✦ CE, RoHS, FCC certifications approved
- ✦ 3 years warranty, life-time free technical support

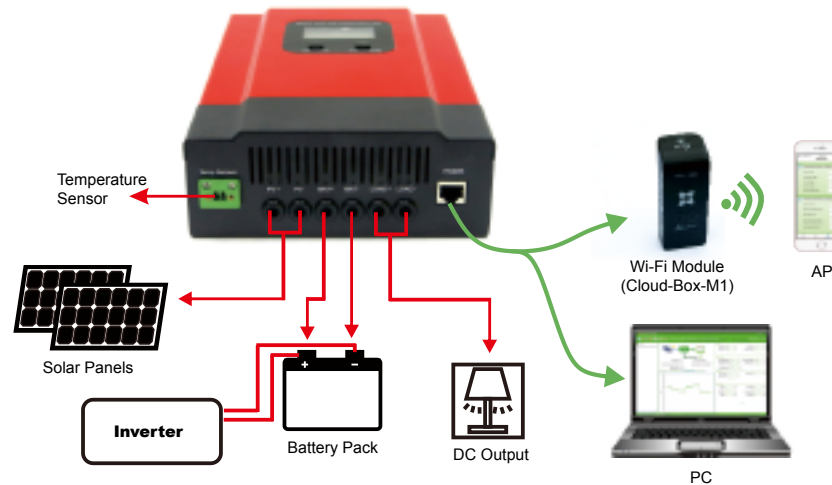

Standard accessories

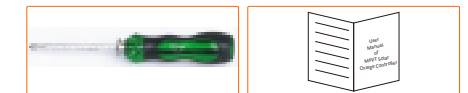

- ✦ Screw driver
- ✦ User manual



- ✦ Temperature sensor
- ✦ Hang bracket

Optional accessories



- RS485-USB cable
- Wi-Fi module

More colors and functions can be customized (OEM/ODM)

eSmart Series		eSmart-20A	eSmart-30A	eSmart-40A	eSmart-50A	eSmart-60A
Product Category	Controller Properties	MPPT (Maximum Power Point Tracking)				
	MPPT Efficiency	≥99.5%				
	Standby Power	0.5W-1.2W				
	System Voltage	Auto-recognition				
	Heat-dissipation	Fan-cooling				
Input Characteristics	Max. PV Input Volt Point	DC150V				
	Start Charge Volt Point	Battery Voltage +3V				
	Low Input Volt Protection Point	Battery Voltage +2V				
	Over Voltage Protection Point	DC150V				
	PV Rated Power	12V System	260W	390W	520W	650W
24V System		520W	780W	1040W	1300W	1560W
36V System		780W	1170W	1560W	1950W	2340W
48V System		1040W	1560W	2080W	2600W	3120W
Charge Characteristics	Battery Types	Gel battery (Default), Sealed lead-acid battery, Flooded battery, User-defined				
	Rated Charge Current	20A	30A	40A	50A	60A
	Charge Method	3 stages: CC (Constant Current), CV (Constant Voltage), CF (Floating Charge)				
Load Characteristics	Load Voltage	Same as battery voltage				
	Rated Load Current	40A			60A	
	Load Control Mode	On, Off, PV control, Dual time control, PV+Time control				
Display & Communication	Display	High definition LCD segment backlight display				
	Communication	8Pin RS485 for PC and APP				
Others	Protections	Input over/low voltage, output over/low voltage, reverse connection, over temperature, short circuit, battery shedding etc.				
	Operation Temperature	-20 ℃ - +50 ℃				
	Storage Temperature	-40 ℃ - +75 ℃				
	IP (Ingress Protection)	IP21				
	Max. Connection Cable	20 MM ²			30 MM ²	
	Net Weight (KG)	2.3			2.6	
	Gross Weight (KG)	3.0			3.5	
	Product Size (MM)	240*168*66			270*180*85	
Packing Size (MM)	289*204*101			324*223*135		