

XTRACYCLE

..... EdgeRunner Swoop/Classic ASSEMBLY MANUAL
.....



Rev 1A

This guide is designed to help you build an EdgeRunner Swoop or Classic as efficiently as possible. Please follow the assembly instructions in order. This guide covers most common accessory variations and all models, with notes on common problems and troubleshooting. While thorough, this guide is not exhaustive - you should already be familiar with all bike component installation and adjustment procedures. If you are not, please refer to the component documentation to ensure correct installation and adjustment.

A note to the builder, before diving in:

As longtail cargo bike pioneers, we do things differently. This bike has unusual chain length, rear wheel dish, steer tube length and rider fit (not to mention all of our custom accessories).

1. **The chain is intentionally 168 links.** Longtail cargo bikes are unique - they have a wide gear range and an extra long chain. When you check the shifting, particularly "big-big" cross-chain, the extreme derailleur extension may look a little painful. However, in testing, we noticed the rear derailleur works better, the chain bounces less and the drivetrain relaxes over time. Sometimes fiddling with the B-tension screw can raise the derailleur slightly.
2. **Asymmetrical rear wheel dish.** We redesigned our dropouts to create better chain/derailleur/tire clearance which "shifted" the rear axle toward the drive side. The rear wheel is then dished back toward the non-drive side. The result is a stronger load-bearing wheel that keeps the derailleur and chain clear of the tire.
3. **We like our steer tubes long.** Unlike traditional road and mountain bikes, cargo bikes benefit from a much more upright riding position. While it is always an option to cut down the steer tube, we recommend letting the customer ride it for a while before making the decision to shorten it. If you chose to cut the steer tube short, check to be sure that any stem-mounted lights will clear the porter rack, if applicable.
4. **Help select stem/post kit for optimal rider fit.** In the separately-shipped accessory box, you should find the stem and seatpost kit ordered with this bike. Many shops will stock all three sizes so that the rider(s) can be best accommodated. This is important when sharing the bike between differently sized riders (i.e. families or demo bikes) and is a surprisingly effective way to customize fit on upright bikes.

Warning:

Always use wheel protection like WheelSkirts or Xtracycle bags when riding with passengers or cargo.

XTRACYCLE



IN THE BOX

NOTE:

To assemble an EdgeRunner you'll need two boxes - One very large one containing the bike, and another that will include a sizing kit containing the stem and seatpost, and other accessories like EdgeRunner WheelSkirts or CargoBays, and a KickBack 3.

Included

1. Large Box: Bike frame with assembled back wheel, derailleurs, tailpiece, V-Racks, and FlightDeck (will need additional bolts depending on chosen accessories), assembled handlebars with brakes, gears, and cables, the front fork, and front wheel. In addition, the accessory box will include pedals, seat, owner's manual, reflectors, headset and spacers, handlebar stabilizer, remaining deck bolts for standard install, and front brake rotor.

2. Smaller Box with Sizing Kit: Will include: an Xtracycle seatpost and a stem. May include Xtracycle Kickback 3, Herrmans lightset, Xtracycle bags or WheelSkirts, and other accessories you've ordered.

STEP 1

Unboxing the EdgeRunner



- Open the box
- Remove the accessory box from the back of the bike.
- Lift the bike out (team lift recommended) and set it upright on the floor.
- Pull the seatpost out from the sizing kit, grease the seat tube and insert the seatpost to the minimum insert line. Torque the seatpost collar bolt to 5nM.



- Fold the corner of the cardboard block closest to the seat post back and out of the way, to make room for the clamp.
- Lift the bike into the stand (team lift recommended) and clamp it by the seat post.

STEP 2

Remove the Fork and Front Wheel



Remove the fork from above the rear wheel - this does not require removing the deck.



Both the front wheel and the handlebars are attached to the thick, protective cardboard "front wheel block." Remove the bars first and zip tie them to the top tube to avoid damaging the hoses or derailleur cables. Then remove the block and front wheel.

STEP 3

Remove the Packaging



Starting from the back of the bike, remove the packaging.

STEP 4

Install the Fork



4A

Find the headset and spacers in the included small parts box, and the S/M/L sized stem (paired with seatpost) in the separately-shipped accessory box.



4B

The headset includes a thin rubber seal that sits on the lip of the crown race. Install this first, then the lower bearing (the lower bearing is larger than the upper). Grease liberally.



4C

Slide the steerer tube up through the headtube, taking care to make sure the hoses and housing are routed correctly.



Pro tip: Zip-tie or toe-strap the fork to the down-tube to assist during stem/headset assembly.

Note: The cable housing and hoses are routed past the head tube on the same side as they come up the down tube - don't cross them under the downtube!

STEP 5

Install the Headset & Stem



5A

Slide on the upper bearing, top race, split bushing, bearing cap, spacers, and the stem.



5B

Install the stem cap and bolt to hold things in place, but do not adjust at this point.



STEP 6

Install Handlebar



- Remove the faceplate with integrated light mount from the stem, and install the handlebars so that the ends of the bars will lie parallel to the ground. Torque the stem faceplate bolts to 6nM.
- Angle the shifter/brake lever down 45 degrees.

STEP 7

Adjust the Headset



Tension the headset bolt to adjust the headset. You may now release the zip-tie or toe-strap that was holding the fork.

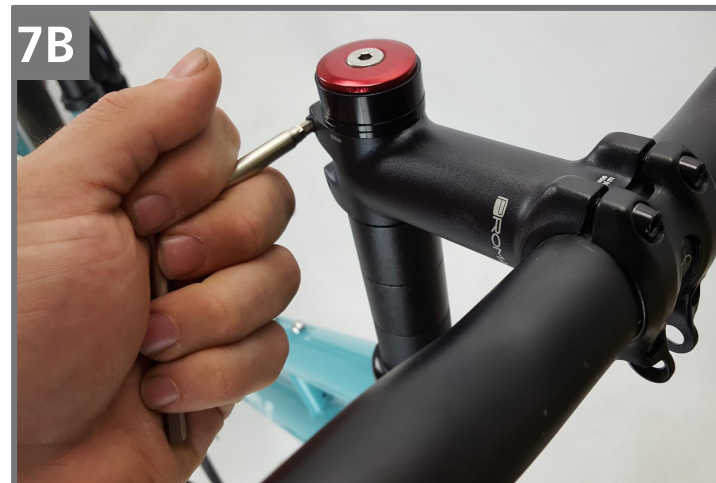

Tighten the stem clamp bolts to 6nM to lock in the adjustment.

STEP 8

Bolt Brakes to Fork

8



The front brake and its bolts are attached to the handlebars - bolt the brake to the fork per the included shimano instructions, but do not torque it down yet.

STEP 9

Install the Rotor

9



The 180mm front rotor is in the accessory box - attach it to the front wheel, this requires a 16-notch external bottom bracket tool to tighten the center lock nut.

STEP 10

Install Front Wheel & Adjust Brakes



10A
Remove cardboard from thru axle. Install the front wheel, and secure the thru-axle.



10B
Now adjust the front brake.

Adjust the Rear Brake



11

STEP 12

Adjust the Derailleurs



12



Pro tip: If you are installing U-Tubes, now is a good time to do it - refer to the U-Tube documentation, found on the Xtracycle Support page, for details.

STEP 13

Check RackLocks & V-Racks



Make sure the RackLocks and V-Racks are seated correctly: The racks should be fully inserted into the uprights and the RackLocks should be pushed all the way down on the uprights and the outer clamp should fully cover the inner collar. Torque all bolts to 5nM.

STEP 14

Check Tailpiece Bolts



Make sure the tailpiece bolts are tight, use a wrench on the backing nut to keep it from spinning. Torque to 6nm.

STEP 15

Installing the WheelSkirts

15a

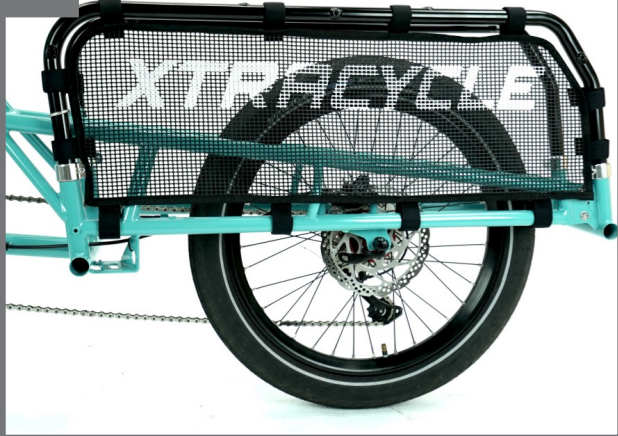

Install the EdgeRunner WheelSkirts, these should be tight enough to keep anything from pushing it into the wheel - you may need to loosen the bolts holding the deck on to slip the straps between the deck and V-Racks.

15b



On the lower straps, make sure not to wrap straps around the derailleur cable.

*

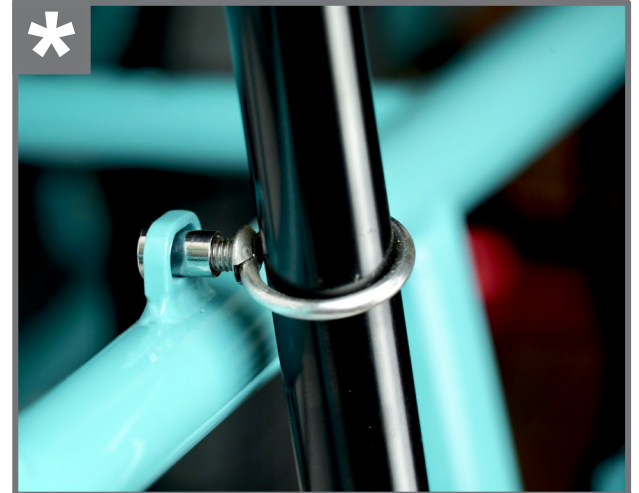

Note: If you are installing a Hooptie, now is a great time to do it. You may need to loosen the WeddingRings that connect the seat stays to the racks.

***Pro Tip:** If you are installing bags, the WheelSkirts are not necessary. This is the right time to install Xtracycle bags.

STEP 16

Bolt Down the Deck

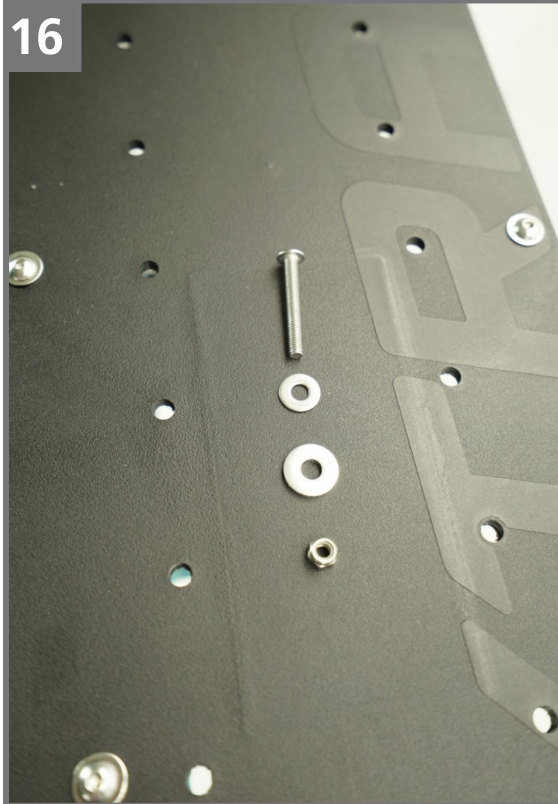

If you've already installed your Hooptie handrails (optional) secure the deck by tightening the four bolts already in the deck and installing the four long bolts and nylock nuts provided into the empty bosses on the V-Rack - two in the front and two in the rear.

Note: The larger thicker washer goes between the deck and the V-Rack.

Note: If you are having a hard time aligning the holes in the deck to the holes in the rack bosses, loosen the WeddingRings so that you can move the V-Racks slightly.



STEP 17

Adjust the WeddingRings



17 Finally, apply some blue loctite to the threads of the WeddingRings, and tighten them to a more harmonious union - take out the slack, then add a full turn for tension.

STEP 18

Install Handlebar Stabilizer



18a Use pliers to thread the spring.



18b Install protective cover over stabilizer spring.

STEP 19

KickBack Installation



Refer to Kickback instructional manual.

STEP 20

Install The Front Light

(Skip to step 21 if your model didn't come with a front light)



Remove the black nut and bolt holding the light to its bracket. Note that the nut will fit into a hexagonal pocket on one side of the bracket, so you won't need to hold it by hand/wrench.

Hold the back of the light and pull forwards on the clear plastic tab to remove the light's cover.

Install the provided batteries, then reinstall the bracket with the black bolt and nut.

STEP 20 CONT'D

Install the Front Light Cont'd

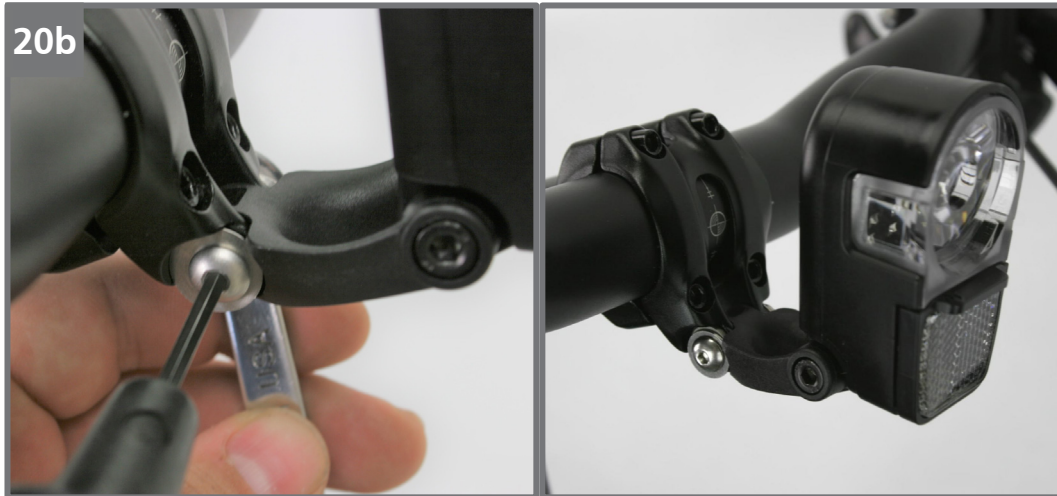

Attach the bracket to the mounting eyelets on the stem using the shorter silver bolt and matching nut. The semi-spherical washers should go on either side of the eyelets, pointing inwards.

This bolt should be tightened enough that the light will stay in place if the front end of the bike is bounced on the ground.

Note: It is possible to flip the stem's faceplate to lift the light above cargo on the PorterRack.

STEP 21

Pedals, Seat, and Air

Install the pedals, drop the bike out of the stand, install the seat and adjust the seat height, air up the tires and take the bike for a test ride!



XTRACYCLE

