

# **SIM LAB**

## INSTRUCTION MANUAL

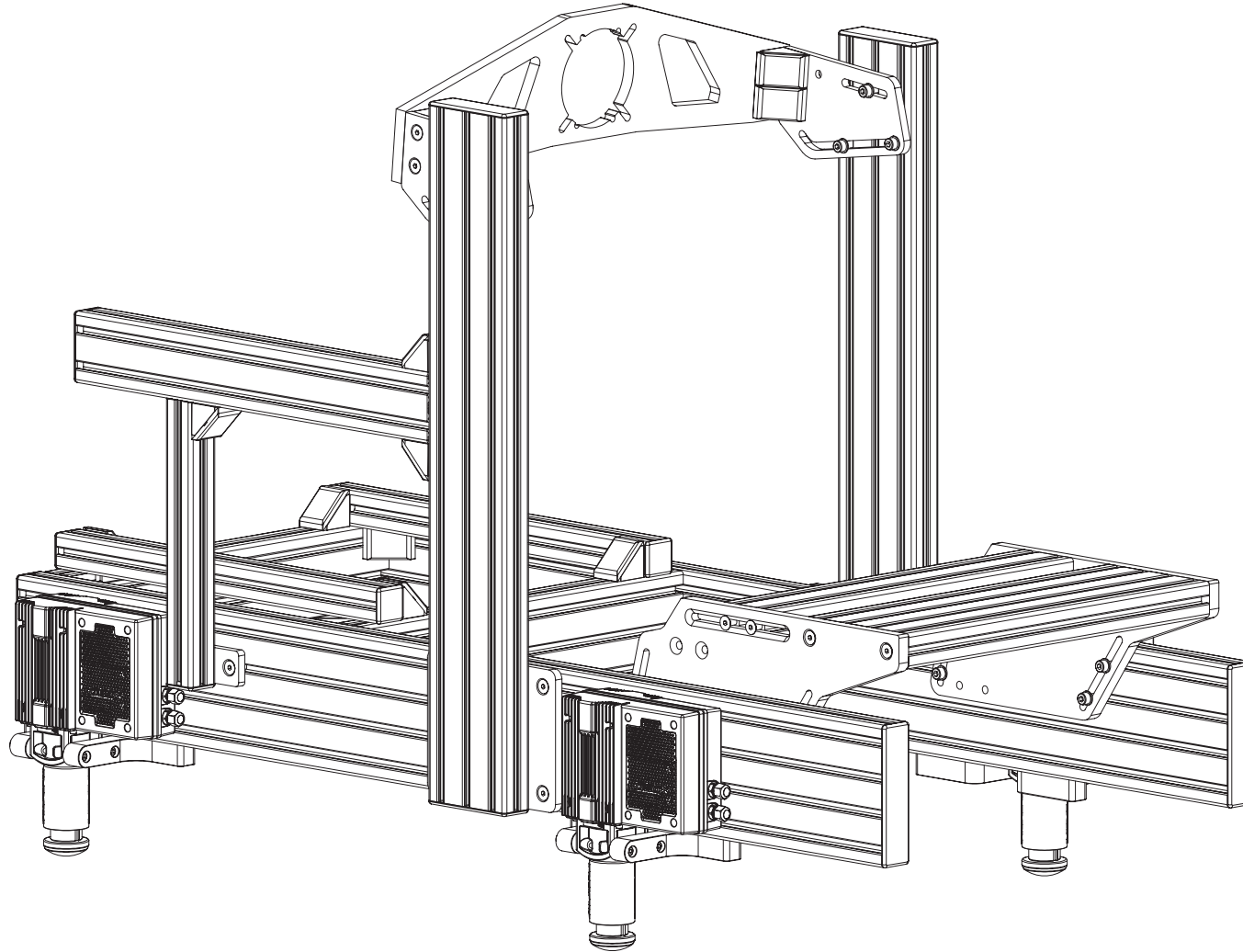

## **D-BOX GEN5 CNC BRACKETS**

**VERSION 2.0**

Last updated: 05-02-2024

## BEFORE YOU START:

Thank you for purchasing this Sim-Lab product! On the following pages, you will find detailed instructions on assembly. This requires only a set of simple tools and some of your time. Please check the bill of materials before starting (page 7) and make sure all the parts are delivered.

This product only consist of brackets to mount your D-BOX GEN5 motion system. For more information about D-BOX GEN5 we strongly recommend to read the product manual provided by D-BOX. This manual only provides the instructions needed to install all components to an existing Sim-Lab cockpit.

### Inserting Slot-Nuts:

You got excited, finished the build, put the caps on, but forgot to install one element. Do not worry. It happens to everyone. In this diagram, you can see how to insert a Slot-Nut directly into the slot from the side. You can also use one of your smaller Hex wrenches to help wiggle the Slot-Nut in place.

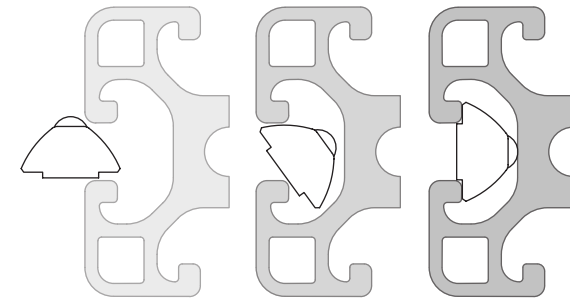

Tools needed:

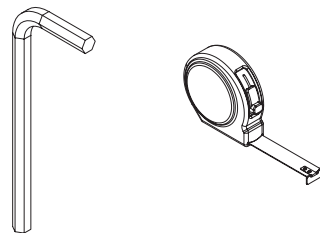

5/6MM

Slot-Nut M8

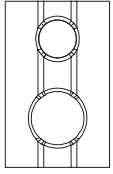

16X

In case you have a side mount, move this towards the uprights like shown.

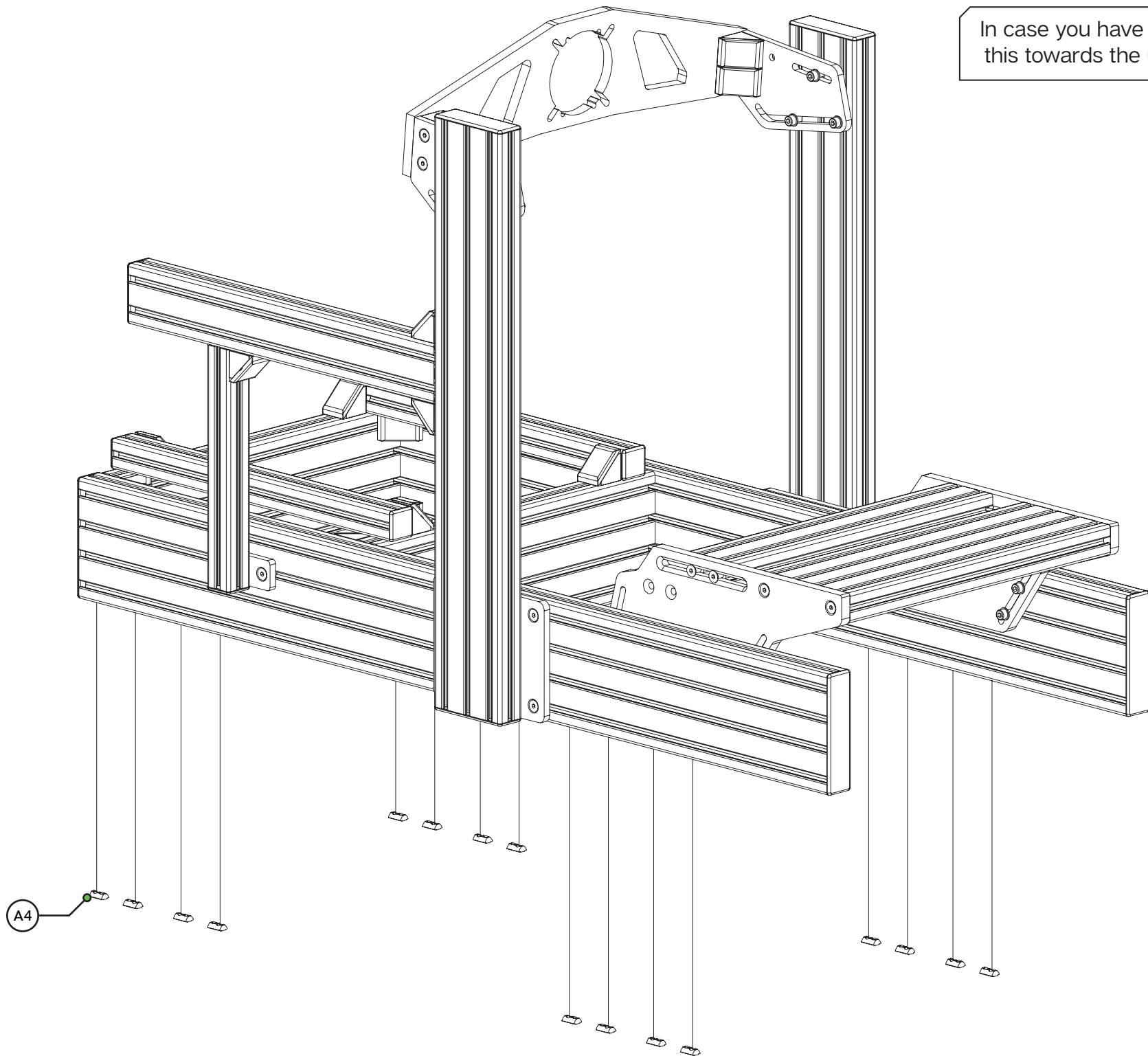

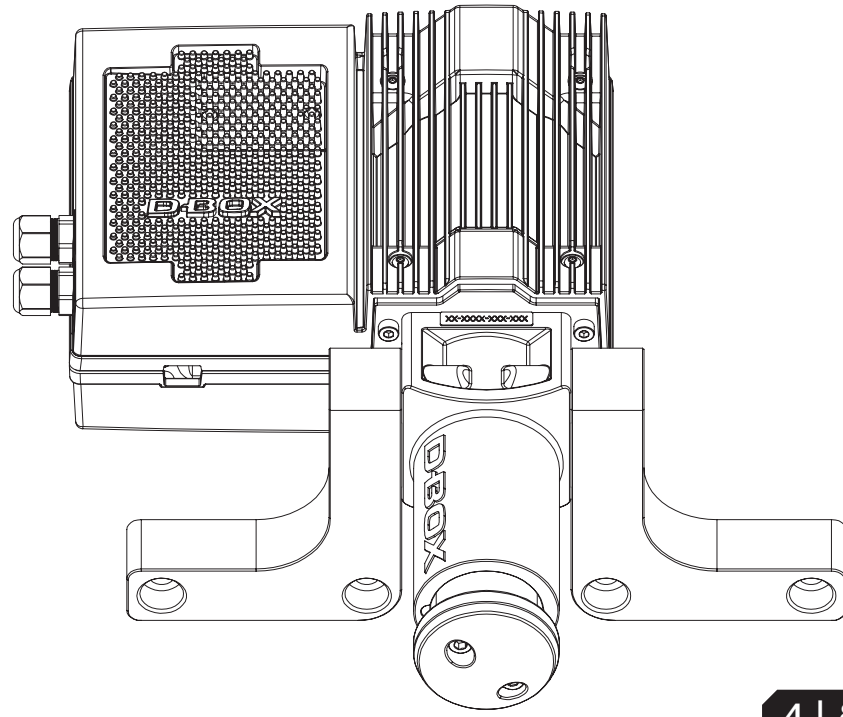
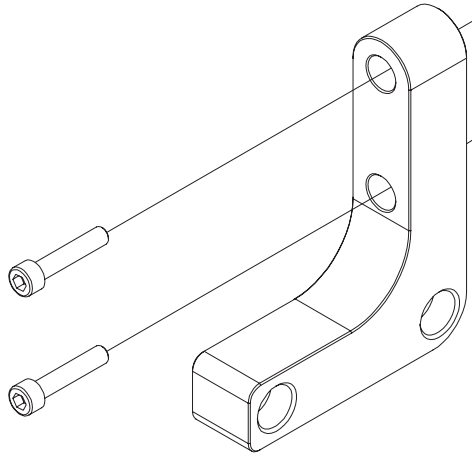
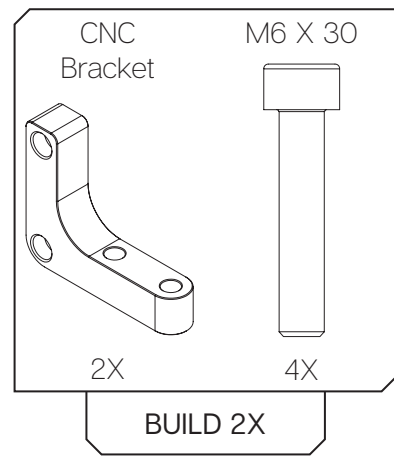
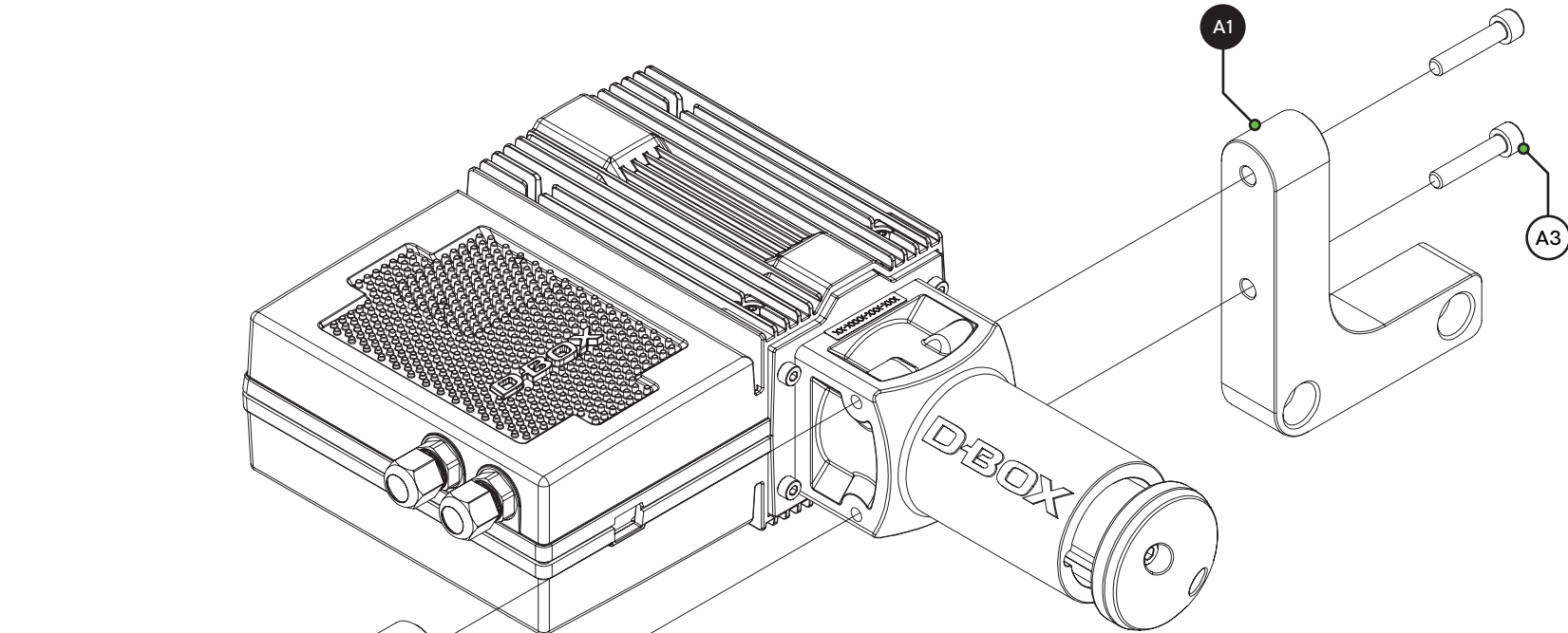

Refer to stickers on your actuators to determine where on the cockpit to place them.

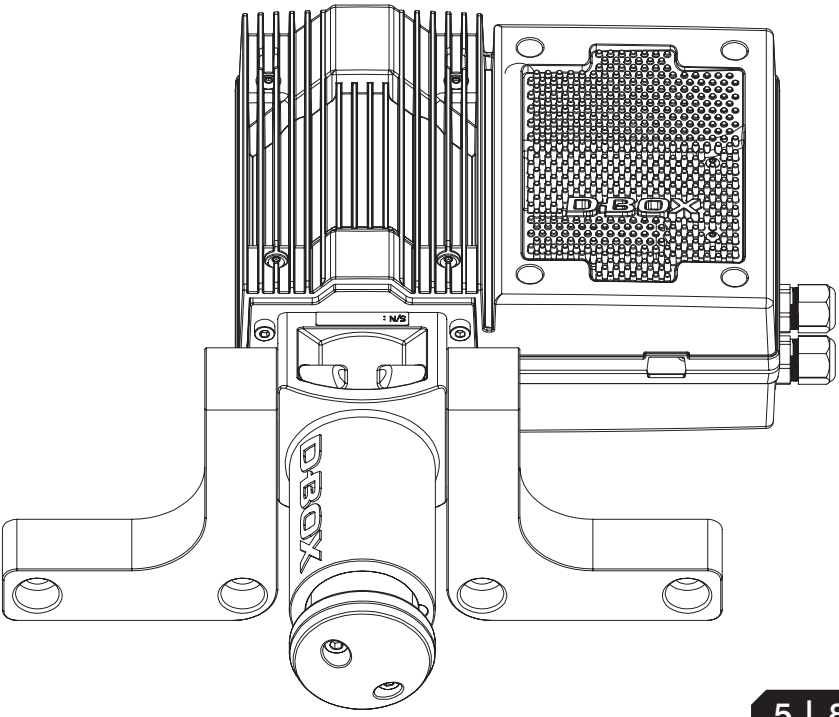
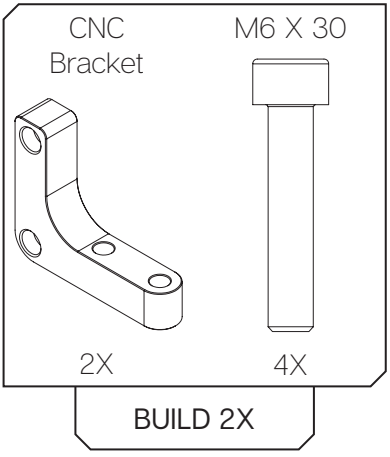
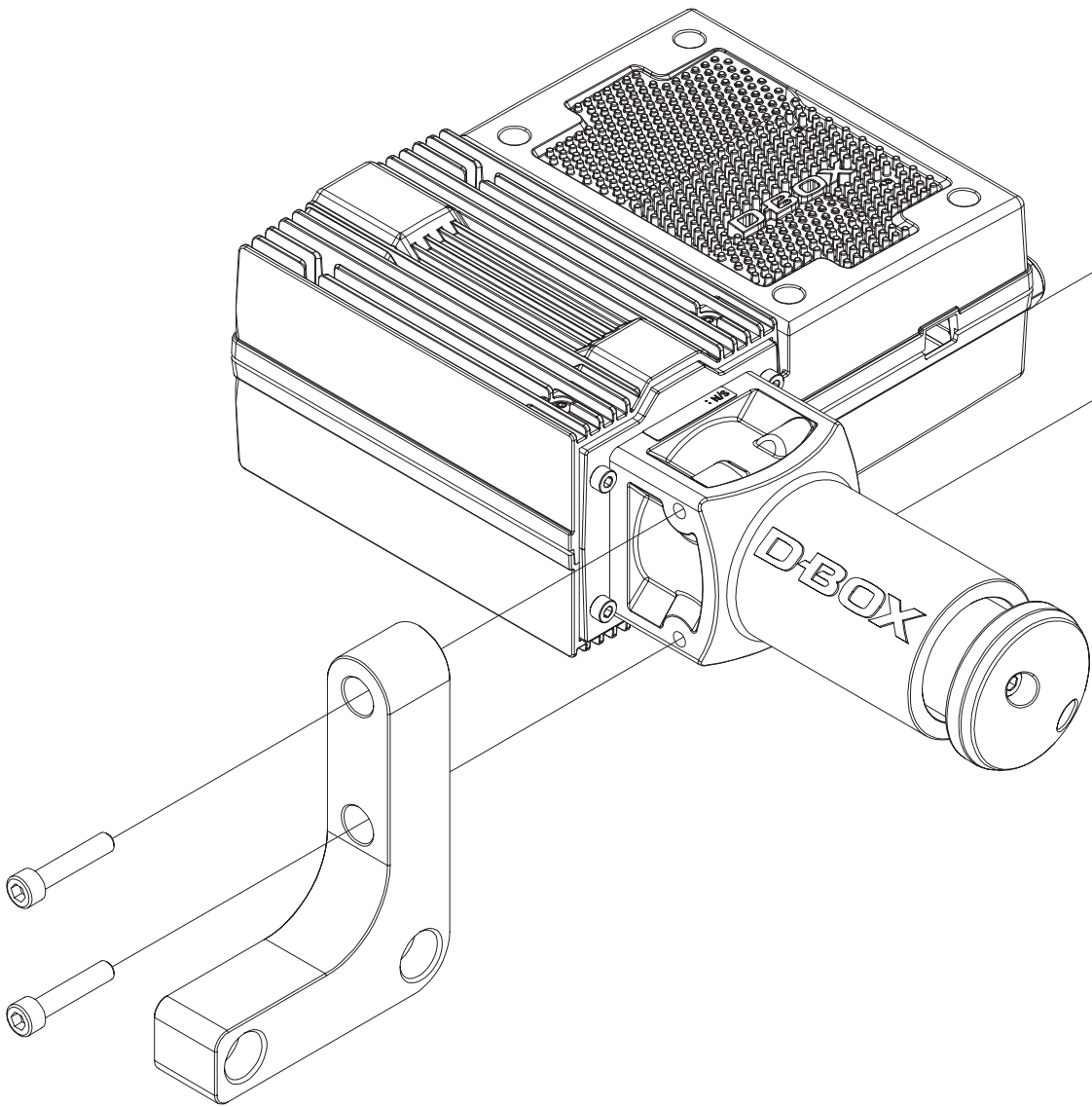

Refer to stickers on your actuators to determine where on the cockpit to place them.

M8 X 25

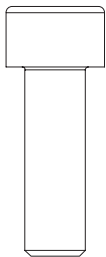

16X

Mind the orientation of the actuators in relation to the cockpit and the brackets.

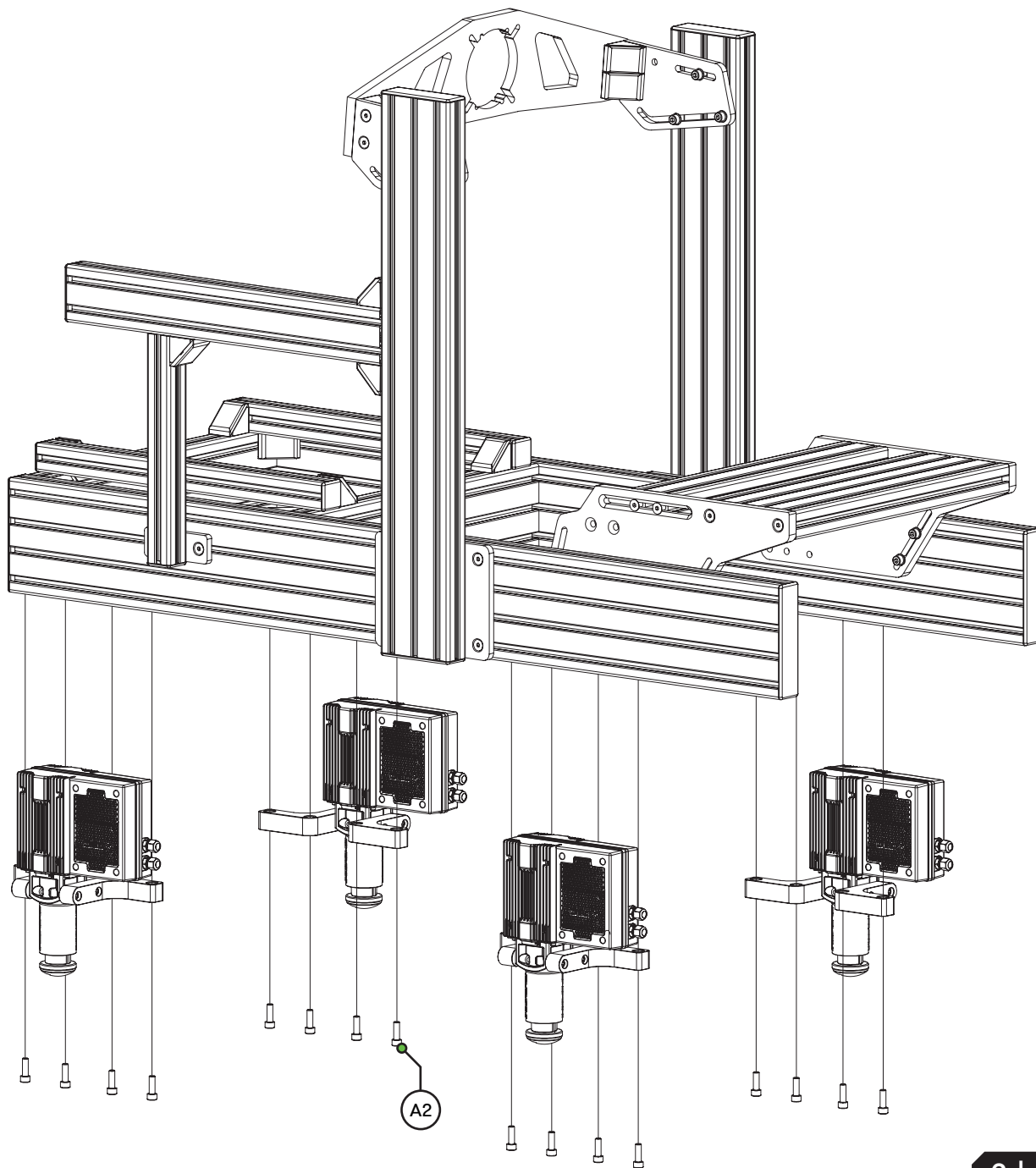
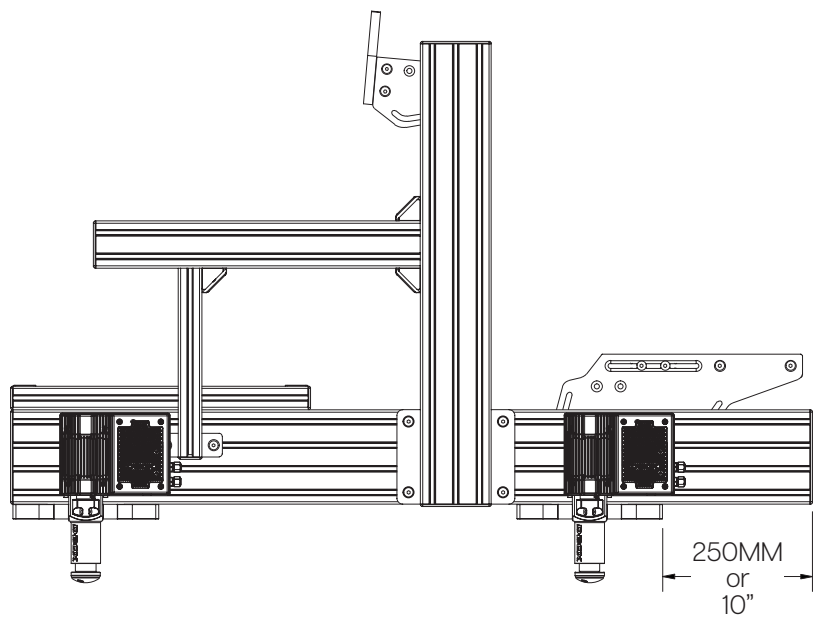

**BOX A - Brackets set  
HARDWARE KIT**

#	Part	QTY	Note
A1	D-BOX CNC Bracket	8	
A2	Bolt M8 X 25 DIN 912	16	
A3	Bolt M6 X 30 DIN 912	16	
A4	Slot-Nut M8	16	

*Disclaimer: for some entries on this list, we supply more than required as spare materials. Don't worry if you have some leftovers, this is intentional.*

**BOX B - Actuator 1**

#	Part	QTY	Note
B1	Actuator	1	

**BOX C - Actuator 2**

#	Part	QTY	Note
C1	Actuator	1	

**BOX D - Actuator 3**

#	Part	QTY	Note
D1	Actuator	1	

**BOX E - Actuator 4**

#	Part	QTY	Note
E1	Actuator	1	

**BOX F - Controller**

#	Part	QTY	Note
F1	Controller	1	

If you still have some questions regarding assembly of this product or about the manual itself, please refer to our support department. They can be reached at

support@sim-lab.eu

Alternatively, we now have a Discord server where there are quite some experienced Sim-Lab customers hanging out. They might just help you along if you ask them nicely ;)

[www.sim-lab.eu/discord](http://www.sim-lab.eu/discord)

If you feel like printing this manual, please consider the environment before doing so. For the best results, make sure you print at 100% scale without borders.

[Product page on the Sim-Lab website:](#)

