

CHILD SAFETY DEVICES



CHILD SAFE
PRODUCT

FITTING INSTRUCTIONS

FACE FIX - RH180/CLR



1. Ensure length of operating chain is in compliance with BS EN13120*. Position device at max distance possible from the control mechanism. Mark hole positions on substrate.
2. Drill pilot hole and screw device into position. Use applicable wall plugs if required.
3. Ensure the distance between the two strands of the loop is not more than 50mm at the point of exit from the device.

RECESS FIT - RH181/CLR



1. Ensure length of operating chain is in compliance with BS EN13120*. Position device at max distance possible from the control mechanism. Mark hole position on substrate.
2. Drill pilot hole and screw device into position. Use applicable wall plugs if required.
3. Ensure the distance between the two strands of the loop is not more than 50mm at the point of exit from the device.

* For a full overview of the requirements of BS EN13120, please refer to the relevant product Child Safety Guide.

All the above components are tested to ensure compliance with the Child Safety requirements of BS EN13120. Using any alternative components would not be covered by our certification and require additional testing to ensure compliance. Make sure the required labels are left on the device & blind when installation is complete.

eclipse

ECLIPSE BLIND SYSTEMS INCHINNAN BUSINESS PARK RENFREW PA4 9RE SCOTLAND UK
TEL: +44 (0) 141 812 3322 FAX: +44 (0) 141 812 5253 www.eclipseblinds.co.uk

CHILD SAFETY DEVICES



CHILD SAFE
PRODUCT

FITTING INSTRUCTIONS

CONTROL CHAIN SAFETY CLIP - LH891 (SMALL)



1. Ensure length of operating chain is in compliance with BS EN13120*. Position device at max distance possible from the control mechanism. Mark hole position on substrate.
2. Drill pilot hole and screw device into position. Use applicable wall plugs if required.
3. Ensure the distance between the two strands of the loop is not more than 50mm at the point of exit from the device.

CONTROL CHAIN SAFETY CLIP - LH892 (LARGE)

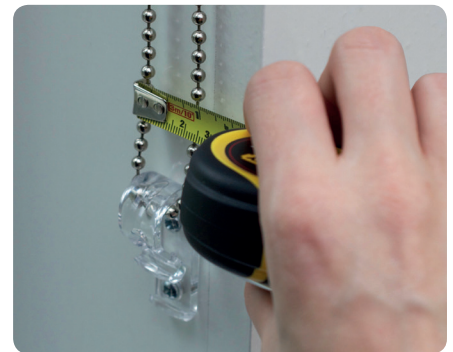
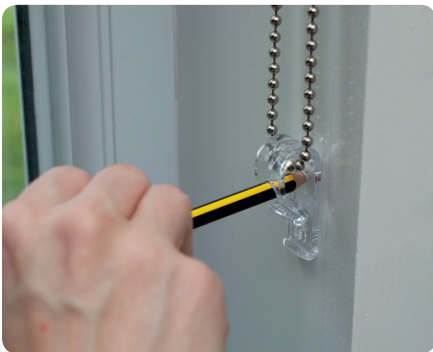

1. Ensure length of operating chain is in compliance with BS EN13120*. Position device at max distance possible from the control mechanism. Mark hole positions on substrate.
2. Drill pilot holes and screw device into position. Use applicable wall plugs if required.
3. Ensure the distance between the two strands of the loop is not more than 50mm at the point of exit from the device.

* For a full overview of the requirements of BS EN13120, please refer to the relevant product Child Safety Guide.

All the above components are tested to ensure compliance with the Child Safety requirements of BS EN13120. Using any alternative components would not be covered by our certification and require additional testing to ensure compliance. Make sure the required labels are left on the device & blind when installation is complete.

eclipse

ECLIPSE BLIND SYSTEMS INCHINNAN BUSINESS PARK RENFREW PA4 9RE SCOTLAND UK
TEL: +44 (0) 141 812 3322 FAX: +44 (0) 141 812 5253 www.eclipseblinds.co.uk

CHILD SAFETY DEVICES



CHILD SAFE
PRODUCT

FITTING INSTRUCTIONS

CORD CLEAT - VH140

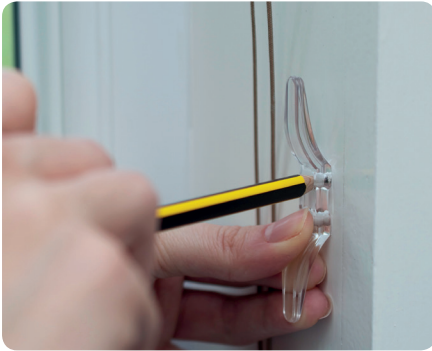

1. Position device as close to the headrail as possible and in all cases, no less than 1.5m from the floor in compliance with BS EN13120*. Mark hole positions on substrate.



2. Drill pilot holes and screw device into position. Use applicable wall plugs if required.



3. Ensure complete length of pull cords can be accumulated and maintained when the internal blind is in the fully retracted position.

* For a full overview of the requirements of BS EN13120, please refer to the relevant product Child Safety Guide.

All the above components are tested to ensure compliance with the Child Safety requirements of BS EN13120.

Using any alternative components would not be covered by our certification and require additional testing to ensure compliance.

Make sure the required labels are left on the device & blind when installation is complete.

eclipse

ECLIPSE BLIND SYSTEMS INCHINNAN BUSINESS PARK RENFREW PA4 9RE SCOTLAND UK
TEL: +44 (0) 141 812 3322 FAX: +44 (0) 141 812 5253 www.eclipseblinds.co.uk

CHILD SAFETY DEVICES



CHILD SAFE
PRODUCT

FITTING INSTRUCTIONS

ROMAN REAR CORD BREAKAWAY - RH471



1. Sew tube tape at bottom along panel & insert support rod. For recommended number of panels refer to Tech Spec TS037.



2. Apply the Roman Rear Cord Breakaway Connector to the tapes on the back of the blind. *N.B. Use one device at each point where the cord passes the tapes on the back of the blind.*



3. Thread the cord through each of the Roman Rear Cord Breakaway Connectors on each column.



4. Tie the cord off at the bottom. Repeat for each column.

REASSEMBLY INSTRUCTIONS



1. Should your safety devices breakaway **do not** try to operate the blind.



2. For smaller blinds, simply reconnect the breakaway components. For larger blinds remove the blind from the brackets and reconnect the breakaways.

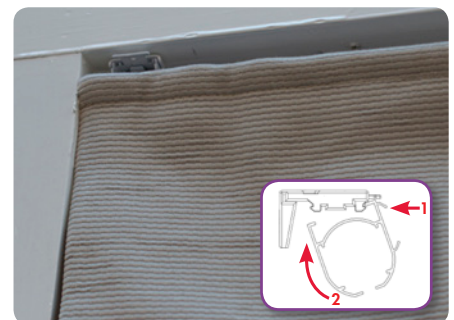

3. Rehang the blind as per the fitting instructions if required and ensure the blind is level and operating correctly.

All the above components are tested to ensure compliance with the Child Safety requirements of BS EN13120. For a full overview of the requirements of BS EN13120, please refer to the relevant product Child Safety Guide. Using any alternative components would not be covered by our certification and require additional testing to ensure compliance. Make sure the required labels are left on the device & blind when installation is complete.

eclipse

ECLIPSE BLIND SYSTEMS INCHINNAN BUSINESS PARK RENFREW PA4 9RE SCOTLAND UK
TEL: +44 (0) 141 812 3322 FAX: +44 (0) 141 812 5253 www.eclipseblinds.co.uk