

STELLAR CONCRETE MIRROR

600mm H x 400mm W - No Lighting



Dimensions* Height: 600mm
Width: 400mm
Depth: 64mm

Weight* 11.5kg

Frame Material Glass Fibre Reinforced Concrete

Frame Finish Satin - Low gloss

Mount Type Wall mounted supplied french cleat supplied. French cleats for both horizontal and vertical mounting supplied. See mounting guide for details.

Warranty 2 years

Lighting No Lighting (option with LED backlighting also available)

FRONT VIEW



SIDE VIEW



BACK VIEW

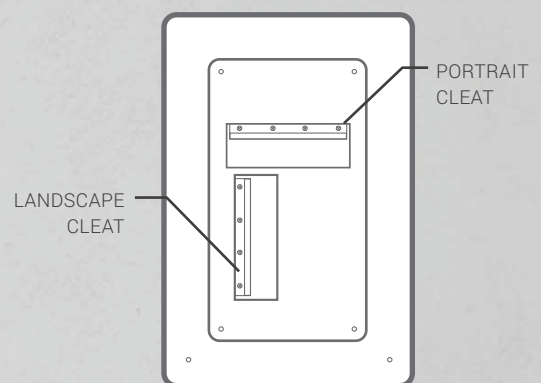

* The dimensions and weight are nominal measurements only. Due to the nature of concrete, there may be slight variation in colour, finish and weight. For more details on the characteristics of concrete, please refer to our Qualities of Concrete Guide.