

Slate/Marble/Sandstone

Installation Instructions

Preconditions

Tools needed

Installation steps

Metal trim options



INSTALLATION PRECONDITIONS



Flatness

Ensure there is no obvious bump on the surface of the substrate.

Temperature

For optimal application, ensure the temperature is above 50°F (10°C) during installation.

A heat gun is recommended to help expedite the flattening of the product when it is rolled up, especially in low temperatures. MACA stone veneers are heat-resistant up to 400°F (205°C).

Saw We recommend using a circular saw or track saw for cutting.

*A 60-tooth carbide tipped blade is rec'd.

Do not use a diamond blade.

Adhesive Use qualified adhesive for the non-translucent collection and waterproof adhesive for wet or outdoor applications.

Others Measure tool, Pen/pencil, Pressure roller, Masking tape, and metal trims if needed.



Saw



Adhesive



Measure



Pencil



Roller



Masking tape

INSTALLATION STEPS

1 Unboxing Preparation

Remove the products from the box. If they are rolled up, lay them flat on the ground.

This process may take up to 48 hours, typically taking longer in lower temperatures.

It's normal for the stone surface to exhibit slight flaking during unboxing and installation.

*a heat gun is recommended to help expedite the flattening process.



2 Measurement and Marking

Measure the desired size on the veneers and mark where you need to make cuts.



3 Cutting with Precision

Use a circular saw or track saw to cut the sheets to your desired dimensions.



4 Surface Preparation

Ensure the substrate where you intend to apply MACA stone veneers is clean. Remove dust and ensure there are no significant bumps on the surface.



5 Masking before Adhesive Application

Cover all the edges of the veneers with masking tape to prevent the adhesive from staining the stone surface during application.

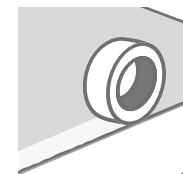

6 Adhesive Application

Apply qualified adhesive to the entire back of the product or the substrate surface. (For wet or outdoor applications, use waterproof adhesive).

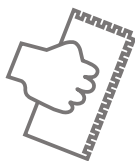

7 Enhancing Adhesion

Use a pressure roller to enhance the adhesion of the products to the wall or other substrates.

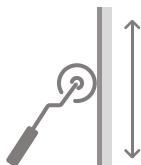

8 Grout Application Guide

If you choose to use grout over metal trims, make sure to use masking tape again to cover the edge of the veneers and leave the desired gap (1/16" to 1/8" recommended) for clean grout. Then use a grout gun with grout of your preferred color. A silicone grout is recommended.



9 Drying Period

Allow it to dry for up to 24-48 hours (depending on the adhesive used and temperature).



10 Completion

Installation is complete — your space is now ready for its new natural look!



METAL TRIM OPTIONS (OPTIONAL)

Metal trims can be added as per design preference and for aesthetic appeal.

A U-Shape Trim

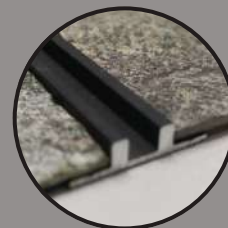

B T-Shape Trim



C L-Shape Trim

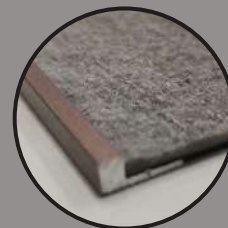
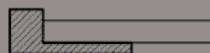

D Outside Corner Trim



E Inside Corner Trim

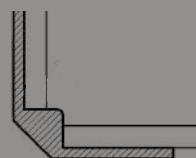

ADHESIVES FOR MACA STONE

	Drywall	Painted Surfaces	MDF	Doors & Cabinetry	Concrete & Backer board	Ceramic	Wood	Metal	Fiberglass
Interior	+ ○ □ △	+ ○ □ △	+ □ △	+ □ △	+ ○ □ △	○ □ △	+ □ △	+ □ △	□ △
Exterior	N/A	□ △	N/A	□ △	□ △	□ △	□ △	△	△
Wet Areas	N/A	N/A	N/A	N/A	□ △	□ △	N/A	△	△

+ : Construction Adhesive: Boss 635 Contact Adhesive (Spray) or Boss 165 Multi-Seal *(Cartridge)*(One Surface Must be Porous)

○ : K100 Hyperflex Litokol

□ : X90 Epoxy Litokol

△ : Litoelastic Epoxy / Polyurethane Litokol

N/A : Not Applicable or Not Recommended

SEALERS FOR MACA STONE VENEER

SIZES AVAILABLE

Tile Doctor Natural Sealer. Solvent Based Sealer for Large Projects

Gallon

Tile Doctor Advanced Hydro Protect, Premium Water Based Sealer

Pint/Quart/Gallon

Tile Doctor Advanced Hybrid Sealer, Penetrating Sealer No-Gloss

Pint/Quart/Gallon

Tile Doctor Advanced Green Enhance and Protect, Semi-Gloss Enhancer

Pint/Quart/Gallon

GLEANERS

Tile Doctor Advanced Tile and Stone Cleaner, PH Neutral Cleaner Concentrate

Quart/Gallon