



PHENIX TECHNOLOGY, INC. FIRE HELMETS

CARE AND MAINTENANCE MANUAL

Please read all of the information contained in this manual. Fill out the form on the last page and send it to Phenix Technology, Inc. KEEP A COPY FOR YOUR RECORDS.

FAILURE TO COMPLY WITH THIS REQUEST WILL VOID ALL WARRANTIES ON YOUR HELMET.

The end user receiving this helmet must fill out the form in completion and the form must be mailed to or scanned and emailed to Phenix Technology, Inc. to be kept on file.

These helmets provide limited thermal and radiant heat protection in compliance with NFPA 1971. Firefighting is inherently dangerous. You may be burned without heat sensation or warning or without any sign of damage to the helmet. Always keep your gear clean and free from debris.

WARRANTY FORM

CHECK ONE

FIRST DUE _____ TL2 _____ TC1 _____

DEPARTMENT ISSUED _____ PERSONAL PURCHASE _____

NAME: _____

PHONE NUMBER: _____

ADDRESS: _____

EMAIL: _____

DEPARTMENT: _____ RANK: _____

DATE OF ISSUE: _____

.....

LABEL IDENTIFICATION INFORMATION (LOCATED UNDER GRAY IMPACT DOME ON RIGHT SIDE)

MODEL#: _____

LOT#: _____

DATE OF MANUFACTURE: _____

.....

COLOR OF HELMET: _____

TYPE OF EYE PROTECTION ISSUED WITH HELMET:

ESS FIRE PRO GOGGLES _____

PAULSON ATAC GOGGLES _____

TINTED, SCRATCH RESISTANT FACESHIELD _____

.....

PLEASE MAIL THIS FORM TO:
PHENIX TECHNOLOGY
ATTN: WARRANTY CONTROL
12391 SAMPSON ST. #H
RIVERSIDE, CALIFORNIA 92503

Failure to return warranty form will VOID any warranty on your helmet purchase.

PHENIX TECHNOLOGY, INC.
12391 SAMPSON STREET, SUITE H.
RIVERSIDE, CALIFORNIA 92503

WWW.PHENIXFIREHELMETS.COM

951-272-4938

Congratulations! You have in your possession one of the most ergonomically correct, comfortable, and most handsome fire helmets on the market today. Designed with a low center of gravity, your helmet was designed by firefighters for firefighters. It can be worn for long periods of time without undue strain on the head or neck.

NFPA, National Fire Protection Agency, provides guidelines and is NOT a testing agent, certifying agency, or third party registering company for any product, helmet, or accessory. The 1971 NFPA Standard states that it is NOT to be used as purchasing criteria and only determines recommended testing standards.

NFPA Standard 1851 states helmets must be retired ten (10) years from the manufacture date. The date of manufacture can be found on the sticker on the interior of the shell under the gray foam impact cap.

According to NFPA 1971 section 6.5.2 Helmets shall consist of at least the following assembled components: 1) Shell, 2) Energy absorbing system, 3) Retention system (chinstrap), 4) Fluorescent and retro-reflective trim, 5) Ear covers, 6) A faceshield or goggles or both. Each of these components must also meet the requirements set forth in the standard. For more comprehensive information, you can get the full standard online at the NFPA website.

PHENIX FIRE HELMETS



TRADITIONAL LEATHER SHELL

The TL2 outer shell is made of top grain veg-tanned cowhide. This type of leather is strong, flexible, and very durable. The inner shell is made of injection molded high temperature thermoplastic. The shell meets or exceeds the specifications in the NFPA1971 standard. The helmet is hand painted with a specialized shoe paint made for leather. This protects the leather further and customizes the helmet to your rank or departments specification. The paint we use and recommend is Angelus Leather paint. If you scrape or gouge your helmet it will show, but can be touched up with the paint if this occurs.

TRADITIONAL COMPOSITE SHELL

The TC1 shell is made of a high temperature, chemical resistant, light weight material which is compression molded into the proprietary traditional shape of your TC1. The inner shell is made of injection molded high temperature thermoplastic. The shell is very durable and meets or exceeds the specifications in the NFPA 1971 standard.

CONTEMPORARY THERMOPLASTIC SHELL

The First Due shell is made of high temperature, chemical resistant thermoplastic material which is injection molded into the proprietary iconic shell shape your First Due is known for. It is a very durable material that meets or exceeds the specifications in the NFPA 1971 standard.

To clean the outer shell of your Phenix helmet, use a soft cloth, hot water, and mild liquid dish soap. If your shell is beyond a simple cleaning, call for further instructions.

WARRANTY FOR THE CONTEMPORARY THERMOPLASTIC HELMET FIRST DUE REVISED 1/2014

THE FIRST DUE HELMET SHELL IS GUARANTEED FOR FIVE YEARS. THIS INCLUDES:

- THERMOPLASTIC SHELL
- CHINSTRAP ATTACHMENT POINTS
- ALL HARDWARE, INCLUDING ATTACHMENT HARDWARE FOR ID SHIELDS
- ANY INEXPLAINABLE CRACKS OR CHIPS

THE SUSPENSION LINER AND CHINSTRAP ARE WARRANTED FOR ONE YEAR. THIS INCLUDES:

- NOMEX STITCHING
- BUTTONS AND PLASTIC RIVETS
- ALL PLASTIC MATERIAL
- ALL METAL PARTS
- RATCHET SYSTEM
- CHINSTRAP MATERIAL

ANY ALTERATIONS TO SUSPENSION LINER WITHOUT PHENIX APPROVAL WILL VOID THIS WARRANTY

PHENIX WILL REPLACE ANY PART OF A FIRE HELMET THAT HAS BEEN DAMAGED IN AN EMERGENCY INCIDENT. (I.E. FIRES, RESCUES, ETC.)

- PHENIX WILL INQUIRE AS TO HOW THE HELMET WAS DAMAGED AND THE DAMAGE MUST BE VERIFIED BY AN OFFICER OF THE AGENCY.

HELMETS DAMAGED DURING HIGH HEAT TRAINING SCENARIOS WILL VOID WARRANTY.

HELMETS DAMAGED IN ANY OTHER MANNER SHALL BE EVALUATED BY PHENIX FOR REPLACEMENT.

ANY STICK-ON DEVICE OR ATTACHMENTS PLACED ON THE HELMET MUST BE APPROVED BY PHENIX PRIOR TO ATTACHMENT.

NO HOLES ARE TO BE DRILLED WITHOUT PRIOR APPROVAL FROM PHENIX.

MOST INFORMATION ABOUT THE HELMET REGARDING CARE, MAINTENANCE, REPAIR AND CLEANING IS LOCATED IN THE CARE AND MAINTENANCE MANUAL WHICH IS SHIPPED INSIDE OF EACH AND EVERY HELMET. IF YOU DO NOT HAVE THIS MANUAL YOU CAN DOWNLOAD IT FROM OUR WEBSITE. **READ IT AND KEEP IT IN A FILE FOR FUTURE REFERENCE.**

ANY TECHNICAL INFORMATION ABOUT THE PHENIX TRADITIONAL LEATHER TL2 FIRE HELMET SHOULD BE DIRECTED TO PHENIX AT 951-272-4938.

WARRANTY FOR THE TRADITIONAL LEATHER HELMET TL2 REVISED 1/2014

THE TL2 HELMET SHELL IS GUARANTEED ON WORKMANSHIP FOR FIVE YEARS. THIS INCLUDES:

- LEATHER DEFECTS OTHER THAN ABRASIONS OR NATURAL LEATHER IMPERFECTIONS
- INNER THERMOPLASTIC DOME
- CHINSTRAP ATTACHMENT POINTS
- ALL NUTS AND BOLTS, INCLUDING ATTACHMENT HARDWARE FOR ID SHIELDS
- 12 GAUGE WIRE USED IN THE CONSTRUCTION OF THE OUTER BRIM
- ANY FUNGUS IN THE LEATHER

THE SUSPENSION LINER AND CHINSTRAP ARE WARRANTED FOR ONE YEAR. THIS INCLUDES:

- NOMEX STITCHING
- BUTTONS AND PLASTIC RIVETS
- ALL PLASTIC MATERIAL
- ALL METAL PARTS
- RATCHET SYSTEM
- CHINSTRAP MATERIAL

ANY ALTERATIONS TO SUSPENSION LINER WITHOUT PHENIX APPROVAL WILL VOID WARRANTY

PHENIX WILL REPLACE ANY PART OF A FIRE HELMET THAT HAS BEEN DAMAGED IN AN EMERGENCY INCIDENT. (I.E. FIRES, RESCUES, ETC.)

- PHENIX WILL INQUIRE AS TO HOW THE HELMET WAS DAMAGED AND THE DAMAGE MUST BE VERIFIED BY AN OFFICER OF THE AGENCY.

HELMETS DAMAGED DURING HIGH HEAT TRAINING SCENARIOS WILL VOID WARRANTY.

HELMETS DAMAGED IN ANY OTHER MANNER SHALL BE EVALUATED BY PHENIX FOR REPLACEMENT.

ANY STICK-ON DEVICE OR ATTACHMENTS PLACED ON THE HELMET MUST BE APPROVED BY PHENIX PRIOR TO ATTACHMENT.

NO HOLES ARE TO BE DRILLED WITHOUT PRIOR APPROVAL FROM PHENIX.

MOST INFORMATION ABOUT THE HELMET REGARDING CARE, MAINTENANCE, REPAIR AND CLEANING IS LOCATED IN THE CARE AND MAINTENANCE MANUAL WHICH IS SHIPPED INSIDE OF EACH AND EVERY HELMET. IF YOU DO NOT HAVE THIS MANUAL YOU CAN DOWNLOAD IT FROM OUR WEBSITE. **READ IT AND KEEP IT IN A FILE FOR FUTURE REFERENCE.**

ANY TECHNICAL INFORMATION ABOUT THE PHENIX TRADITIONAL LEATHER TL2 FIRE HELMET SHOULD BE DIRECTED TO PHENIX AT 951-272-4938.

EARLAPS/NECK PROTECTION

To clean the earlaps, whether sewn in or detachable, soak them in cold water with mild liquid dish soap for up to 30 minutes. Remove, rinse with clean water, and let air dry in a cool dry place out of the sun. **DO NOT** machine wash. When reinstalling the detachable earlaps, attach the Velcro strap on the earlaps to the Velcro on the rear of the suspension liner. Place the loops through the space in between the suspension liner and your head headband so that the loops will not rub on the side of your head with movement. Earlaps should always be worn down for maximum protection against both thermal and convective heat transmission.

CHINSTRAP

The chinstrap is made from Nomex webbing. There are 3 options of chinstraps. If equipped with the postman, the postman slider web clamp will always come on the right side of the helmet. You may reverse the assembly without voiding the warranty if it is more comfortable for you. If you are removing it to clean or replace, take a look at the assembly first and be mindful of all the parts involved and it is fed through the attachment slot.

To clean the chinstrap soak it in cold water with mild dish soap and lay flat on a dry surface out of the sun. Reinstall the chinstrap in the proper configuration for the safety of the wearer. If a chinstrap changes color such as: white, yellow, magenta, or anything in between, the chinstrap has been subjected to extreme heat. If this occurs or if the chinstrap begins to fray, it should be replaced.

STAY SAFE,

RAY M. RUSSELL
PRESIDENT AND CO-FOUNDER

PHONE: 951-272-4938
FAX: 951-279-8399

EMAIL:
SALES@PHENIXFIREHELMETS.COM

WEBSITE:
WWW.PHENIXFIREHELMETS.COM

BECOME A FAN:
WWW.FACEBOOK.COM/PHENIXFIREHELMETS

NFPA COMPLIANT TESTING LAB
NTS: NATIONAL TECHNICAL SYSTEMS
FULLERTON, CALIFORNIA

THINGS TO REMEMBER ABOUT YOUR PHENIX HELMET

* YOUR HELMET SHOULD BE CLEANED OF DIRT, DEBRIS, AND ANY OTHER RESIDUE AFTER BEING USED AT ANY EMERGENCY CALL.

* NEVER USE HYDROCARBON PRODUCTS TO CLEAN ANY PART OF YOUR HELMET. (NO PETROLEUM-BASED CLEANERS)

ADJUSTABLE SIZING INSTRUCTIONS

The liner provided with this helmet must be properly sized if it is to give you the proper degree of protection. To begin, put the helmet on your head and test the fit of the liner. The helmet should rest on the head without tipping either forward or backward. The helmet should be well balanced and the wearer's ears and temple area should be protected by the brim of the helmet shell. If the helmet sits too high or low on the head, readjust the black rope that threads through the four adjustment straps and the oval foam cap. Tie the rope tighter to raise the helmet, or loosen the rope for a lower fit. The rope must be tied in a square knot so that it will not loosen or slack-up on usage. The tension on the rope should be checked periodically to make sure proper clearance is provided. The four adjustable straps should rest easily on the head, but not bulge at the crown of the head. If the helmet is too loose or too tight, place the helmet in your lap and reposition the Velcro attachments on each side of the headband taking care to keep the plastic liner tabs inserted into the headband. If you have the neck strap suspension, the Velcro closure at the rear of the helmet should be released and readjusted to fit snugly. The ratchet suspension will have a screw knob that will allow for loosening and tightening of the suspension. If the ratchet becomes loose, overtighten the center screw with a phillips head screw driver. **DO NOT OVERTIGHTEN** the screw as it will strip the ratchet. Although our helmet liner is designed for most people, if you have attempted all of the above sizing adjustments and are still having difficulties with the fit of your helmet, please contact us at 951-272-4938 as you may need an extra large or extra small suspension liner.

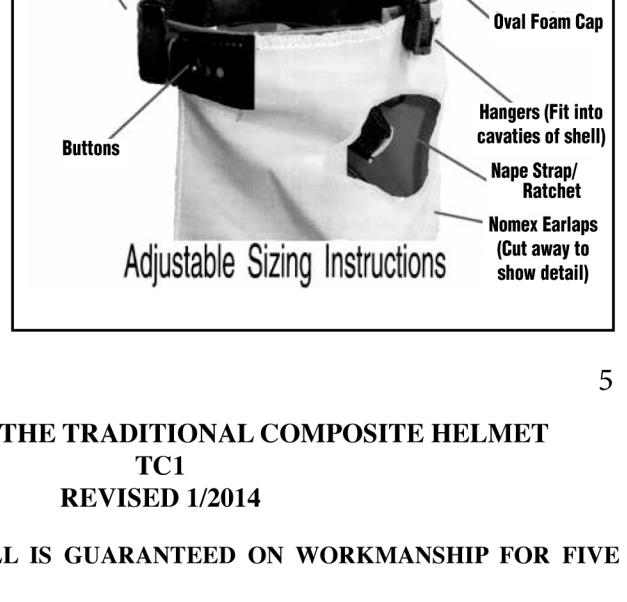

WARRANTY FOR THE TRADITIONAL COMPOSITE HELMET TC1 REVISED 1/2014

THE TC1 HELMET SHELL IS GUARANTEED ON WORKMANSHIP FOR FIVE YEARS. THIS INCLUDES:

- INNER THERMOPLASTIC DOME
- CHINSTRAP ATTACHMENT POINTS
- ALL NUTS AND BOLTS, INCLUDING ATTACHMENT HARDWARE FOR ID SHIELDS
- BRIM TRIM
- GLUE ATTACHMENT BETWEEN FIBERGLASS OUTER SHELL AND THERMOPLASTIC INNER SHELL

THE LINER AND CHINSTRAP ARE WARRANTED FOR ONE YEAR. THIS INCLUDES:

- NOMEX STITCHING
- BUTTONS AND PLASTIC RIVETS
- ALL PLASTIC MATERIAL
- ALL METAL PARTS
- RATCHET SYSTEM
- CHINSTRAP MATERIAL

ANY ALTERATIONS TO SUSPENSION LINER WITHOUT PHENIX APPROVAL WILL VOID WARRANTY

PHENIX WILL REPLACE ANY PART OF A FIRE HELMET THAT HAS BEEN DAMAGED IN AN EMERGENCY INCIDENT. (I.E. FIRES, RESCUES, ETC.)

- PHENIX WILL INQUIRE AS TO HOW THE HELMET WAS DAMAGED AND THE DAMAGE MUST BE VERIFIED BY AN OFFICER OF THE AGENCY.

HELMETS DAMAGED DURING HIGH HEAT TRAINING SCENARIOS WILL VOID WARRANTY.

HELMETS DAMAGED IN ANY OTHER MANNER SHALL BE EVALUATED BY PHENIX FOR REPLACEMENT.

ANY STICK-ON DEVICE OR ATTACHMENTS PLACED ON THE HELMET MUST BE APPROVED BY PHENIX PRIOR TO ATTACHMENT.

NO HOLES ARE TO BE DRILLED WITHOUT PRIOR APPROVAL FROM PHENIX.

MOST INFORMATION ABOUT THE HELMET REGARDING CARE, MAINTENANCE, REPAIR AND CLEANING IS LOCATED IN THE CARE AND MAINTENANCE MANUAL WHICH IS SHIPPED INSIDE OF EACH AND EVERY HELMET. IF YOU DO NOT HAVE THIS MANUAL YOU CAN DOWNLOAD IT FROM OUR WEBSITE. **READ IT AND KEEP IT IN A FILE FOR FUTURE REFERENCE.**

ANY TECHNICAL INFORMATION ABOUT THE PHENIX TRADITIONAL COMPOSITE TC1 FIRE HELMET SHOULD BE DIRECTED TO PHENIX AT 951-272-4938.

LEATHER IDENTIFICATION SHIELDS

The ID shields are made of Chrome Tanned leather. This gives them better water resistance. The lettering is Foil Stamped and very durable. To care for your Leather ID shield use clean water and a soft cloth to gently wipe the shield.

BRASS EAGLE FINIAL

A quick wipe down with a damp cloth on this piece will keep it looking like the fine piece of art that it is.

GOGGLES

When using SCBA, it is recommended to place your goggles in a secure pocket instead of storing them on your helmet. If the goggles are attached to the helmet, a goggle sleeve will provide further heat protection. Even NFPA compliant goggles may become inoperable if they are exposed to too much heat. To maintain the lens on your goggles, clean ONLY with water. NEVER use cleaners or solvents as these may weaken the lens and may result in cracking. Use a soft cotton cloth to gently wipe clean. NEVER use paper products to clean the lens. The goggle body can be hand washed with mild soapy water, rinsed, and air dried. Store goggles in a cool dry place away from direct sunlight. Goggles with retainer systems are attached to the brim of the helmet. Attachment kits should be inspected before or after every shift to ensure components have not become loose.

FACESHIELD (FOR FIRST DUE HELMET ONLY)

The tinted scratch resistant faceshield should be cleaned by wiping with a damp soft cloth. The attachment kit converter pivot screws may become loose with wear. Check the security of the attachment kit before and after every shift. If your vision becomes impaired by the faceshield, it should be immediately replaced.

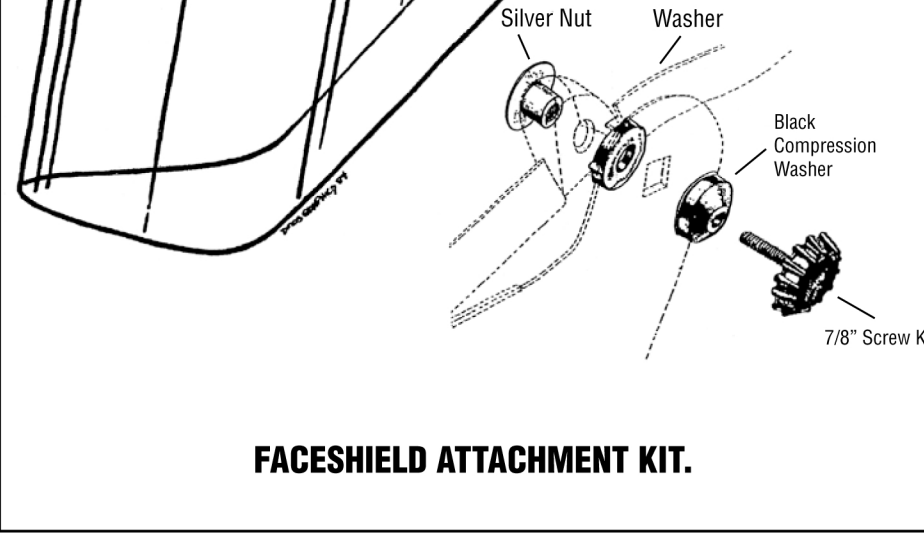

FACESHIELD ATTACHMENT KIT.

* TREAT YOUR FIRE HELMET WITH CARE AND A REGULAR MAINTENANCE ROUTINE AND IT WILL PROVIDE YOU YEARS OF SERVICE.

* ONLY USE THE HELMET AS A HEAD PROTECTION DEVICE. IT IS NOT A VENTILATION OR FORCEABLE ENTRY TOOL.

* COOL YOUR HELMET IN BETWEEN BURNS BY REMOVING IT FROM THE HEAT SOURCE AND ALLOW IT TIME TO AIR COOL.

* NEVER STORE YOUR HELMET IN DIRECT OR INDIRECT SUNLIGHT, OR UNDER FLUORESCENT LIGHTING.

* NEVER USE RETIRED HELMETS FOR TRAINING PURPOSES. USE OF RETIRED HELMETS MAY RESULT IN SERIOUS INJURY.

* NEVER ALTER THE STRUCTURE OF THIS HELMET OR ADD FLAMMABLE COMPONENTS.

* YOU MUST CLEAN YOUR HELMET REGULARLY TO MAINTAIN FLAME AND HEAT RESISTANCE.

* FIREFIGHTING IS INHERENTLY DANGEROUS. YOUR HELMET MUST BE PROPERLY ADJUSTED AND SECURED TO THE HEAD WITH ALL COMPONENTS IN PLACE, CHINSTRAP SECURED. NO AMOUNT OF PERSONAL PROTECTION APPAREL CAN PROTECT YOU FROM ALL POTENTIAL HAZARDS. NO HEAD PROTECTION SYSTEM CAN PROTECT YOU FROM ALL OF THE SITUATIONS YOU MAY ENCOUNTER, INCLUDING BURNS, INJURIES, DISEASE OR HAZARDOUS CONDITIONS. ONLY THOSE FULLY TRAINED IN FIREFIGHTING AND RESCUE TECHNIQUES SHOULD UTILIZE THIS HELMET.

* IF YOU HAVE ANY QUESTIONS ABOUT YOUR HELMET, CALL US AT 951-272-4938.