

Sleavon

Commercial Dehumidifier

Please read the manual carefully
before using the unit

508E

USER MANUAL

FOR CUSTOMERS

Thank you for purchasing our dehumidifier.

Sleavon wishes that our products and services can bring convenience to your work and life. We highly recommend that you keep the manual for reference if you encounter unexpected events using the unit.

Please read the manual carefully to ensure proper use of the dehumidifier. Our dehumidifiers are widely used in family bedrooms, bathrooms, basements, offices and storage rooms, etc.

The dehumidifiers from **Sleavon** provide quick and efficient operation to reduce room's humidity and bring you a healthy and comfortable life.

TO ACCESS CUSTOMER SUPPORT FASTER

If there is any problem of the product, please contact Sleavon Customer Service at support@sleavon.com with your Purchase Order ID to help you address the problem more effectively.

BEFORE FIRST USE:

To prevent any internal damage, it is very important to keep refrigeration units (like this one) upright throughout their journey.

Please leave it standing upright and outside the box for **24 HOURS** before plugging it in.

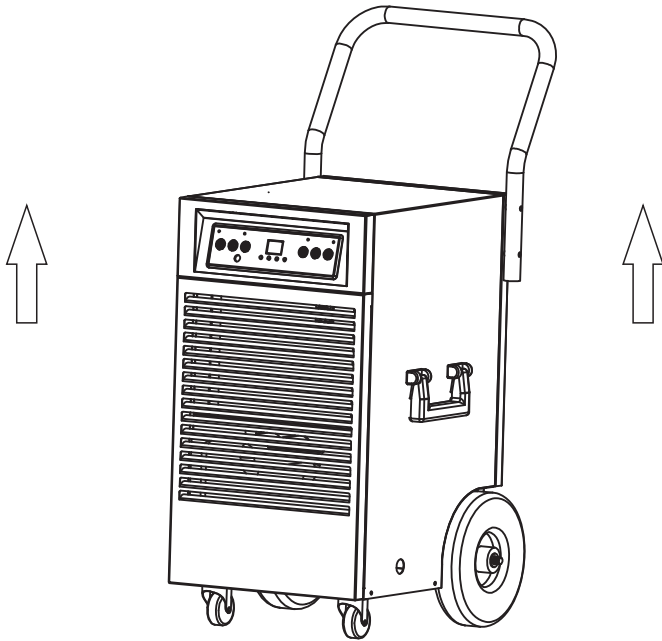

TABLE OF CONTENTS

SAFETY INSTRUCTIONS.....1

FEATURES & SPECIFICATIONS.....3

PRODUCT DRAWINGS.....4

WATER DRAINAGE.....5

MACHINE SETUP&OPERATION6

OTHER FUNCTIONS.....8

MAINTENANCE & STORAGE.....10

TROUBLE SHOOTING11

SPECIAL NOTES.....12

WARRANTY & CONTACT US.....13

SAFETY INSTRUCTIONS

IMPORTANT NOTICE FOR FIRST USE :

The dehumidifier is used to remove excessive moisture from the air in order to reduce the relative humidity to protect buildings and their contents from the adverse effects of excess humidity.

For your safety, please read the manual carefully and keep the manual for future reference. Please use this product according to the instructions of installation and operation of this manual.

- This appliance is intended to be used by expert or trained users in shops, light industry and on farms, or for commercial use by lay persons.
- This appliance can not be used by children aged under 8 years old and persons with reduced physical, sensory or mental capabilities or lack of experience and knowledge unless they have been given supervision or instructions concerning use of the appliance in a safe way and understand the hazards involved. Children shall not play with the appliance. Cleaning and user maintenance shall not be made by children without supervision.
- The refrigerant loop is sealed. Only a qualified technician should attempt to service!
- Do not discharge the refrigerant into the atmosphere.
- If the supply cord is damaged, it must be replaced by the manufacturer, its service agent or similarly qualified persons in order to avoid a hazard.
- The A-weighted sound pressure level is below 70 dB.
- The appliance shall be disconnected from its power source during maintenance.
- Always operate the unit from a power source of equal voltage, frequency and rating as indicated on the product identification plate.
- Always use a power outlet that is grounded.
- Unplug the power cord when cleaning or when not in use.
- Do not operate with wet hands. Prevent water from spilling onto the unit.
- Do not immerse or expose the unit to rain, moisture or any other liquid.
- Do not leave the unit running unattended. Do not tilt or turn over the unit.

SAFETY INSTRUCTIONS

- Do not unplug while the unit is operating.
- Do not unplug by pulling on the power cord.
- Do not use an extension cord or an adapter plug.
- Do not put objects on the unit.
- Do not climb or sit on the unit.
- Do not insert fingers or other objects into the air outlet.
- Do not touch the air inlet or the aluminum fins of the unit.
- Do not operate the unit if it is dropped, damaged or showing signs of product malfunction.
- Do not clean the appliance with any chemicals.
- The unit shall be installed in accordance with national wiring regulations.
- Do not use means to accelerate the defrosting process or to clean, other than those recommended by the manufacturer.
- The appliance shall be stored in a room without continuous operation sources (for example: open flames, an operating gas appliance or an operating electric heater).
- The appliance shall be stored in a place preventing mechanical damage from occurring.
- Do not pierce or burn the refrigerant loop.
- Compliance with national gas regulations shall be observed.
- Keep any required ventilation openings clear of obstruction.

FEATURES & SPECIFICATIONS

PRODUCT FEATURES

Large Capacity

Movable and Easy to Store

Built-in Auto Defrost System to protect key working components

Adjustable Humidity

Timed Operation

Quiet Running

Energy-saving Design

SPECIFICATIONS

Model No.	508E
Power Source	AC115V 60Hz
Power Consumption / Current(80°F,60%RH)	635W / 6.0A
Power Consumption / Current(86°F,80%RH)	728W / 6.75A
Moisture Removal (65°F,60%RH)	42 Pints/Day(19.8L/Day)
Moisture Removal (80°F,60%RH)	70 Pints/Day(33.1L/Day)
Moisture Removal (86°F,80%RH)	110 Pints/Day(52.0L/Day)
Moisture Removal (95°F,90%RH)	130 Pints/Day(61.4L/Day)
HIGH PRESSURE	522psig(3.6MPa)
LOW PRESSURE	240psig(1.65MPa)
Noise	≤68dB(A)
Refrigerant / Charge	R410A / 11.6oz(330g)
Working Temp.	41°F - 95°F
Product Dimensions	16.2*18.2*25.6in.
Net Weight	36Kg/79.3LBS

PRODUCT DRAWINGS

Front

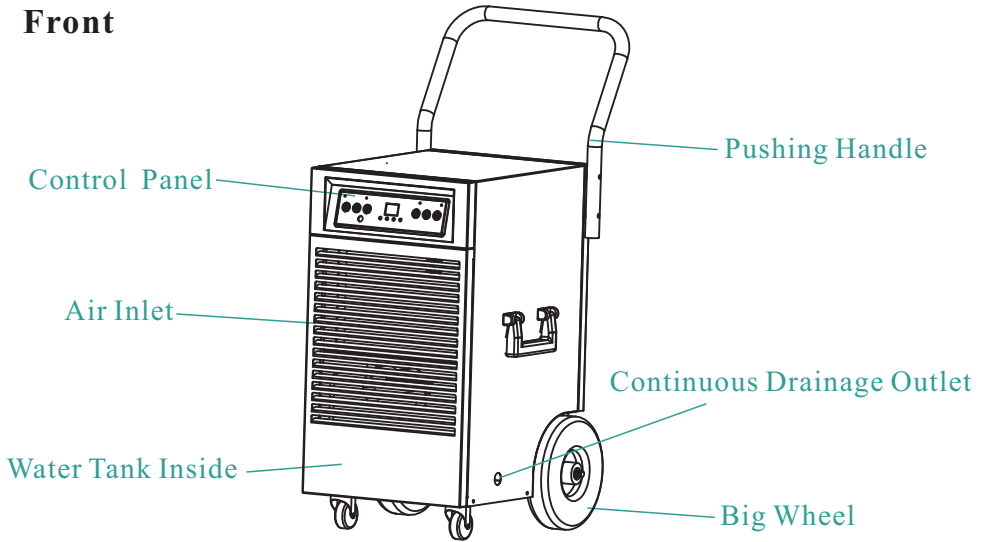

Back

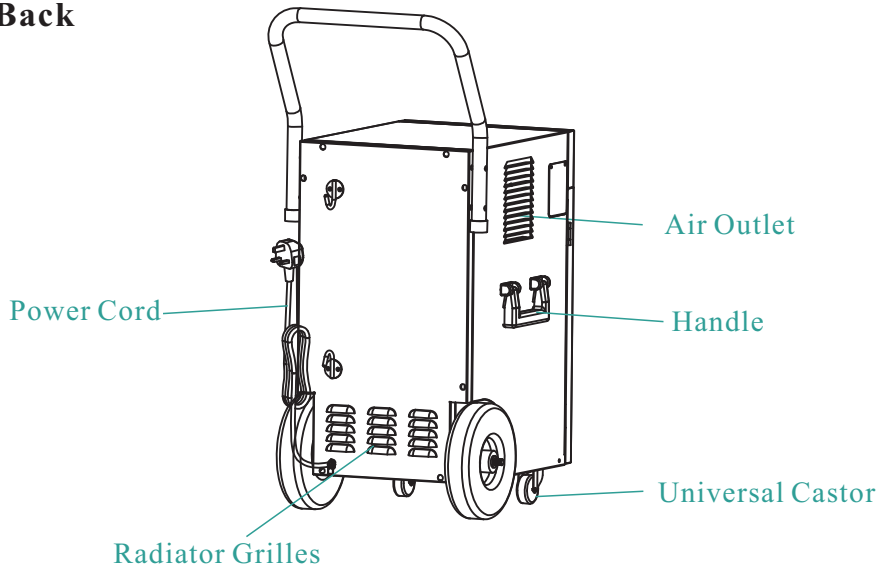

WATER DRAINAGE

Manual Drainage

1. When the tank is full, the “FULL” light will turn on.
2. The unit will also make a buzzing sound. To stop this, press the power button to turn off the machine.
3. To clear the water tank, open the front panel to access the water tank.
4. Grab the handle of the water tank and pull it out horizontally.
5. After disposing of the water, place the tank back to the unit and close the front panel.

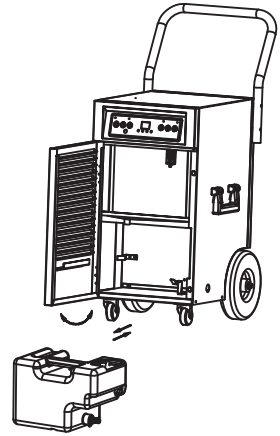

Continuous Drainage

In extremely wet conditions, the tank may need frequent clearing. It can be set up for continuous drainage by the following ways:

1. Open the front cover, take off the water tank, and clear the water inside.
2. Remove the plug and install the included drainage hose to the connecting port of the water tank, then direct the hose to the desired area before operating the machine. See the picture on the right.
3. Make sure the water tank and drainage hose are not blocked, then shut the front panel.
4. When you do not use continuous drainage and turn to use the water tank again, just plug the connecting port of the tank again to stop the water from outflowing.

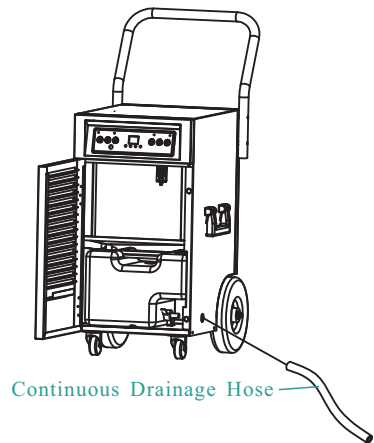
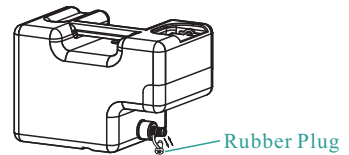

WARNING:

Do not block the drainage hose. The drainage end of the hose should not be higher than the machine outlet hole. Otherwise, it would cause damage to the components of the unit.

MACHINE SETUP & OPERATION

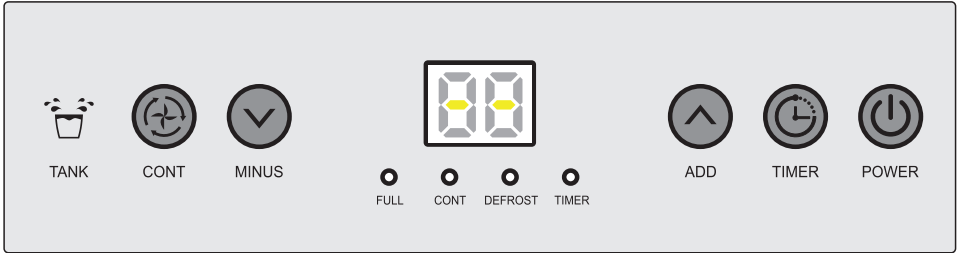

Button Function

1. Power

POWER

Press this button when plug in the power, screen light will be on, machine will automatically go to continuous mode, display screen will show the environmental humidity and the compressor will be on after the fan's running for 3 seconds.

Press this button again, compressor will stop, display screen will show “- -”, machine will go to standby mode, and the fan will run for another minute and stop.

2. Timer Setting

TIMER

Press this button while the machine is powered on. When the button light goes on, press “MINUS” or “ADD” you can set a time to start the machine. When the count down is over, the fan and compressor will start working.

Press this button while machine is running. When the button light goes on, press “MINUS” or “ADD” you can set a time to stop the machine. When the count down is over, the fan and compressor will stop working.

Press this button for 3 seconds will show the current temperature, and return to current humidity after 10 seconds. Long press this button will show the temperature again.

3. Humidity Increase

ADD

Press this button at normal working mode, the humidity will increase by 5%RH with each press, buzzer will ring each time with the press.

Press the button for more than 1 second can increase the humidity setting continuously.

4. Humidity Decrease

MINUS

Press this button at normal working mode, the humidity will decrease by 5%RH with each press, buzzer will ring each time with the press.

Press the button for more than 1 second can decrease the humidity setting continuously.

Note:

1. The default humidity is 50%RH, you can increase and decrease the humidity value as below:

20%-25%--30%-35%-40%-45%-50%-55%-60%-65%-70%-75%-80%-85%-90%

2. Environmental humidity and setting humidity will decide the status of compressor and fan as follow:

Environmental humidity \geq machine setting humidity by 3%RH, the compressor and fan will start running.

Environmental humidity $<$ machine set humidity by 3%RH, the compressor and fan will stop running.

5. Continuous Mode

CONT

When the machine is working in Continuous Mode (the display screen will show the current humidity and the machine will keep running), continuous mode light will be on, humidity setting is invalid but time setting is available.

Press the "CONT" button at continuous working mode will switch back to the normal dehumidification mode, continuous mode light will be off, you can set the humidity value manually.

OTHER FUNCTIONS

1. **Full Water Tank Alarm**

TANK

1. 5 seconds after the water tank is full, the water tank light will go on red, buzzer will ring for 15 times, and compressor and fan will stop.

After empty the water tank, the machine will automatically switch back to the previous mode, compressor will start after its 3 minutes' self-protection.

Alarm will stop in 3 seconds after the water tank is emptied and put back, the fan will start and compressor will start in 3 minutes.

2. The compressor will not need 3 minutes for self-protection if it was the first time to start the machine, press "POWER" button can power off the machine.

When plugged in, press "POWER" button, compressor will start immediately.

3. The system has auto memory. When all the mode setting have been finished, if there is sudden power cut during operation, or plug slipping-out from the power jack, the system may store the current status before the power is cut and enter the operation mode before power cut automatically after power is supplied.

2. **Defrost Function**

DEFROST

1. When the environmental temperature is lower than 41°F, or higher than 95°F, the compressor and fan will stop.

2. Defrosting requirement: When the compressor has run above 30 minutes, and the temperature sensor senses the temperature $\leq 30^{\circ}\text{F}$ (last for 10 seconds), the compressor will stop, defrost will start, and the fan will continue to run, defrost light will go on.

When the pipe temperature goes to 41°F or the defrosting process has lasted for 15 minutes, defrost will stop.

Note: during defrost, light won't be off until the defrost is over.

ERROR PROMPT

1. “E1”: If the temperature sensor got failure, it will show “E1”. The system will work in the cycle of dehumidification for 30 minutes and defrosting for 15 minutes. You should replace the failure temperature sensor with a new one.
2. “E2”: If the humidity sensor got failure, it will show “E2”. The humidity adjusting button will not work. The system will work in the cycle of dehumidification for 30 minutes and defrosting for 15 minutes. You should replace the failure humidity sensor with a new one.
3. “CL”: When the room temperature $<41^{\circ}\text{F}$, it will show “CL”, machine will stop running.
4. “CH”: When the room temperature $>95^{\circ}\text{F}$, it will show “CH”, machine will stop running.
5. “LO”: When the room humidity $<20\%\text{RH}$, it will show “LO”, machine will stop running.
6. “HI”: When the room humidity $\geq 95\%\text{RH}$, it will show “HI”, indicating the machine is working normally.

MAINTENANCE & STORAGE

MAINTENANCE

1. Clean the machine with a soft wet cloth.
2. Pull the louver on the front panel out to gain access to the filter.
3. Remove the filter mesh out of the unit.
4. Use a clean rag to absorb the surface dust on the filter mesh. If the filter is extremely dirty, use tap water to flush the filter. Fully dry the filter before putting it back into the air inlet fence.

A clean filter will increase the machine's dehumidification capacity.

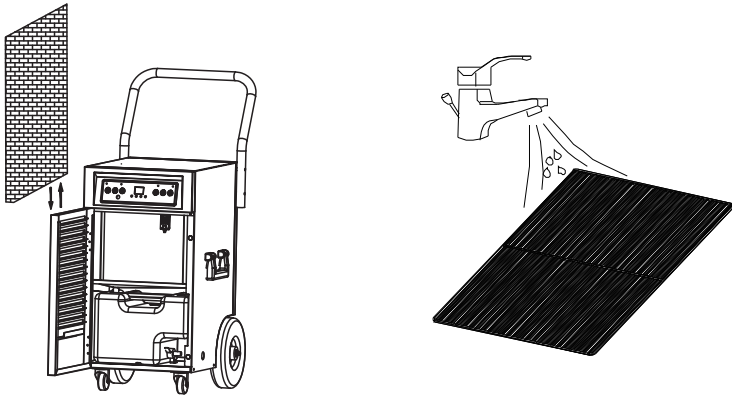

MACHINE STORAGE

If you don't use the unit for an extended period of time, please store it per the following steps:

1. Clean the filter mesh.
2. **ATTENTION:** the evaporator inside the machine has to be dried out before the unit is packed to avoid component damage and molds. Unplug the unit and place it in a dry open area for days to dry it out. Another way to dry the unit is to set the humidity point more than 2% higher than the ambient humidity to force the fan to dry the evaporator for a couple of hours.
3. Collect the power cord, bunch it, and hang it on the power cord hook at the back of unit.
4. Store in a clean, dry environment.

TROUBLE SHOOTING

If the following condition happens, please review the list before calling the customer service.

Trouble	Cause	Solution
Machine Does Not Run	Unit is not plugged in.	Plug in the unit.
	Room temperature under 41°F or above 100°F.	To protect the machine, use it only when ambient temperature is between 41-100°F.
Machine Runs But does Not Dehumidify	When the humidity setting point is 3% higher than ambient humidity.	Reset the humidity to a lower setting point, or power off the machine if the humidity has satisfied you.
Reduced Dehumidifier Capacity	Filter mesh jammed.	Clean the filter mesh according to manual.
	Air-in and/or Air-out louvers jammed.	Clear the blockage from Air-in and/or Air-out louvers.
No Air from the Air Outlet	Filter mesh or air-in louver jammed.	Clean filter according to instructions or clean the louver blockage.
Loud Operation	Machine situated on an incline or decline slope.	Move to flat ground.
	Filter mesh jammed.	Clean filter mesh according to instructions.

Cautions:

Switch off the unit and unplug it immediately if anything abnormal happens. Then contact a qualified electrician.

Do not dispose of electrical appliances as unsorted municipal waste, use separate collection facilities.

Contact you local government for information regarding the collection systems available.

WARNING

This product can expose you to chemicals including Styrene and its compounds, which are known to the State of California to cause cancer and birth defects or other reproductive harm. For more information, please visit: www.P65Warning.ca.gov.

SPECIAL NOTES



- 1 When using, please do not put the machine at the soft and uneven ground, avoid vibration and movement.



- 2 Do not insert thin rods and hard objects into the machine body to avoid malfunction and danger.

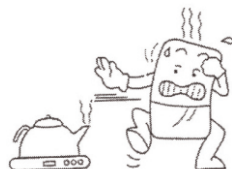

- 3 When using, please keep the machine away from heating furnace, electric kettle and other heat sources.



- 4 When using, please close doors and windows to achieve the best remove humidity effect.



- 5 Please do not put objects around the body. If the ventilation is blocked, the dehumidification effect will be affected.



- 6 If do not use the product for a long time, please unplug the power cord.



- 7 When cleaning the dehumidifier, please use the wet textile to wipe gently, do not shoot the water directly.

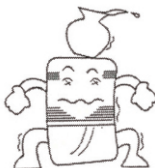

- 8 Please do not put any object on the dehumidifier.



- 9 Please clean the filter every two weeks (do not use hot water above 104°F, alcohol, gasoline or toluene.)



- 10 When continuous drainage, the drain hose must be placed horizontally, without unevenness and winding.



- 11 After cleaning the filter, please do not dry it under direct sunlight, in case deformation.



- 12 Before moving and carrying the machine, please first pour out the water in the tank.

WARRANTY & CONTACT US

Warranty

Sleavon offers a 12-month warranty to all of our products together with the original proof of purchase when a defect occurred, including those newly purchased and unused, from Sleavon or through an authorized reseller, wholly or substantially, or as a result of faulty manufacturing parts, or workmanship during the Warranty Period.

The warranty does not apply if damage is caused by other factors, including but without limitation of:

- (a) Normal wear and tear;
- (b) Abuse, mishandling, accident or failure to follow operating instructions;
- (c) Exposure to liquid or infiltration of foreign particles;
- (d) Servicing or modification of the product other than by Sleavon.

There are our general terms for the warranty service, but we always encourage our customers to contact us if any issues, regardless of warranty terms.

If you are experiencing an issue with Sleavon product, you can reach out to us at support@sleavon.com, we will dedicate our efforts to resolve it for you.

Extend Your Warranty by 1 Year

Register your product at www.sleavon.com to extend your 1-year warranty by an additional year.

*Please fill out all required fields and include your Order ID, Date of Purchased if applicable.

Customer Support

If you have any questions or concerns about your product, please feel free to contact our expert support team. Sleavon customer service is here to help.

Sleavon Office

13211, Spring Street Baldwin Park, CA, US

Email: support@sleavon.com

Live Chat: www.sleavon.com

Support Hours

24 Hours available

*Please have your Order Number ready before contacting customer support.

Sleavon

For FAQs and more information please visit:
www.sleavon.com



@ Sleavon



@ Sleavon



@ Sleavon



@ Sleavon



(Scan the QR Code for Live Chat)

We are expecting to see our products fulfill your life and hear your voice.

Your satisfaction means a lot to us.

Please tag us if you share a snap on your social media.

www.sleavon.com