

Install Strike Plate to the Non Active/Fixed Door Leaf

Install the Latch & Lock to the Active/Swinging Door Leaf

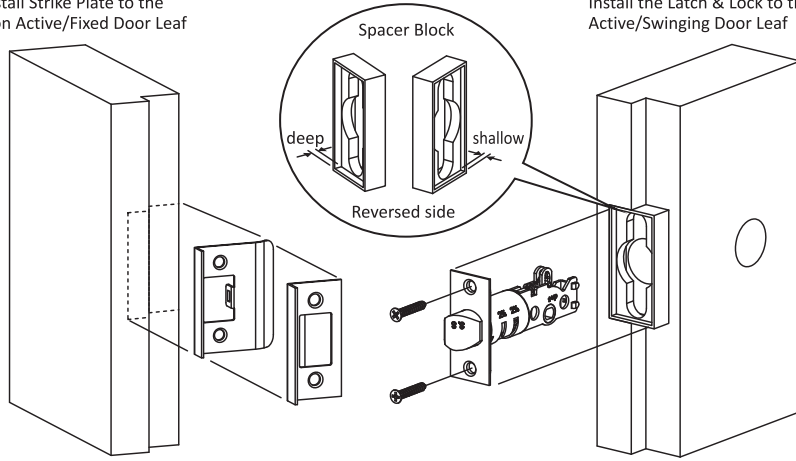

\*\*Matte Black finish warranty is 12 months only



## Inoxus Universal Rebate Kit Installation Sheet

### Strike Plate Installation

**1**

Choose either the D-Shaped Strike Plate or Deadbolt Strike Plate for proper installation.

Mark position of the Strike Plate on the Non Active/Fixed door leaf.

**2**

Cut and chisel the timber to fit the chosen Strike Plate.

Make sure the Strike Plate sits flush with the door edge.

**3**

Place the Strike Plate onto the chiselled area, mounting with the Shorter wood screw to fasten the Strike Plate.

For the D-shape Strike Plate, strike plate tab can be adjusted if there is interference between the latch and the strike.

### Latch Installation

**1**

Mark position of Spacer Block on the Active/Swinging door leaf.

**2**

Cut and chisel the timber to fit the Spacer Block.

To ensure the Latch Face Plate to sit flush to the door edge, chose the deeper or shallow side of Spacer Block when installing.

**3**

Drill 25mm (1") Latch Hole.  
**Note:** It is important to drill the Latch Hole squarely on the center line of the door thickness.

Place the Latch along with the Spacer Block, mounting with Longer wood screw.

### Usage of the Universal Rebate Kit

	Product	Abode	Abode ZB	Domaine	Infinity	Inoxus G2	Maison	Rustique	Strike to be used
ZURK Universal Rebate Kit	Knob Set	✓		✓		✓	✓	✓	D-Shaped
	Lever Set	✓	✓	✓		✓	✓	✓	D-Shaped
	Deadbolt	✓		✓			✓	✓	Retangle
	Handle Set						✓	✓	D-Shaped
	Infinity Set				✓				D-Shaped

This product is warranted to be free from mechanical & workmanship defects for 7 years and free from finish & surface defects for 5 years from the original date of purchase. Should a mechanical or finish defect occur within this warranty period just return the product along with proof of purchase to point of purchase for replacement. Premature finish deterioration due to the use of solvents, acid cleaners, paints, climatic conditions i.e. salt air or surface abrasion by keys or jewellery is not considered a defect & thus not covered by this warranty. The same applies for mechanical failure due to the incorrect installation, misuse or abuse will not be covered by this warranty. The removal & refitting of the product & any associated handling & transportation costs is not covered by this warranty. N2LOK reserves the right to modify product styles & finishes without notification. If the same product model is no longer available a similar product model will be supplied. Any accessories, spare parts & trim purchased separately to complete & compliment the lockset or hardware are not covered by this warranty.  
\*\*Matte Black finish warranty is 12 months only

