

# CLAWLAB

## TUFTING GUN H1



Please review the entire guide before operating the gun.

**USER MANUAL**

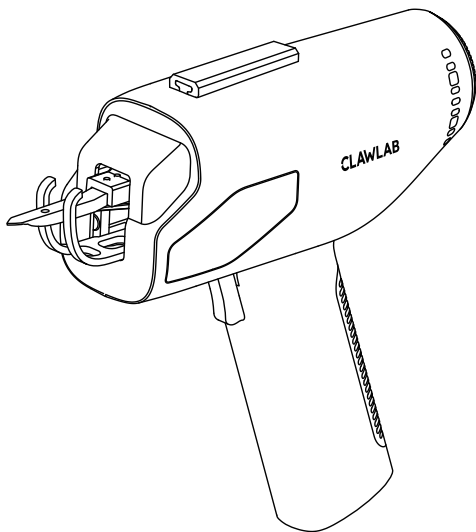

**CLAWLAB**  
Where Art Meets Innovation.



Please visit [wiki.clawlabtech.com](https://wiki.clawlabtech.com) for more information.

If you like to share your first tufting pieces, follow and DM us on Instagram [@clawlab\\_official](https://www.instagram.com/clawlab_official).

# CONTENTS

Safety Instructions	▶ 1
Packaging List	▶ 1
Product Specification	▶ 2
Preparation & Basic Operation	▶ 4
Quick Operation Technique	▶ 8
Product Maintenance	▶ 10
More Information & Tutorials	▶ 11

## Safety Instructions



### Attention!

- Inspect all moving and fixed parts for any damage before each use.
- Ensure the machine remains dry and is kept away from rain, flammable liquids, and gases.
- Store in a dry, secure location, out of reach of children, when not in use.

## Packaging List

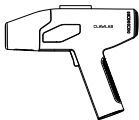

Tufting Gun



Carry Bag



Maintenance Screwdriver x 2



Lubricant



Threading Apparatu x 3

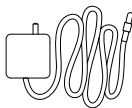

Power Adapter



Clean Brush



Regulator



Desiccant



## Product Specification



Name	CLAWLAB Tufting Gun H1
Weight	550g
Voltage	100V-240V
Power	40W
Working Speed Range	1-20 Stitches Per Second

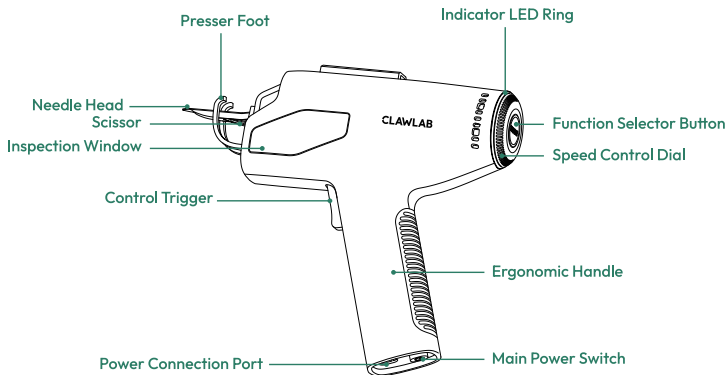

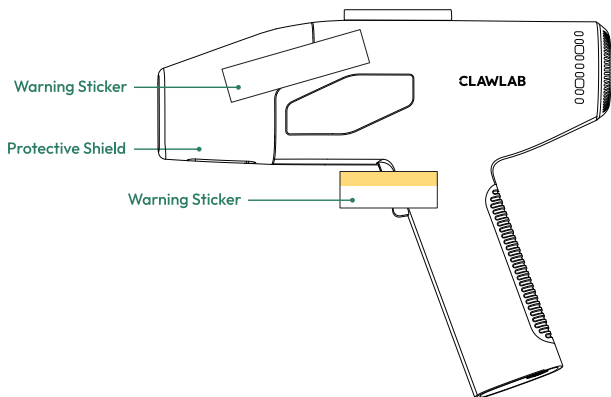

### **Note!**

Keep hands away from the gun's front and exercise caution while operating.



### **Use with care!**

**Beware of trigger hazards.  
Avoid inadvertent contact.**

## Preparation & Basic Operation



### 1.Remove the Protective Shield

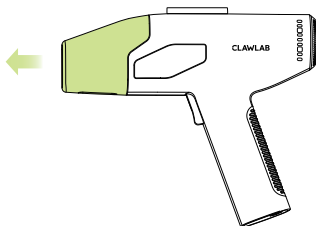

### 2.Regulator Installation (Optional)

**Function of the Regulator:** Adjusts the size of the threading hole, accommodating a wider variety of yarn types, plies, and thicknesses. Effectively prevents yarn from slipping off.

a.

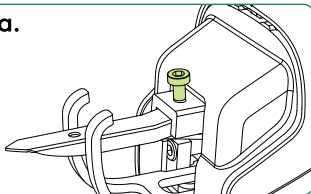

a. Remove the screw from the needle.

b.

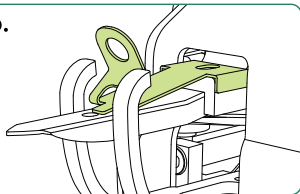

b. Align the oval hole of the regulator with the screw hole at the needle.

c.

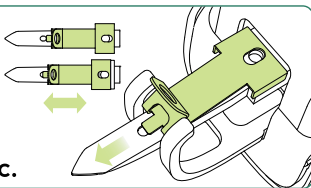

c. Slide the regulator to adjust the size of the threading hole. Adjust it to fit the thickness of the yarn.

d.

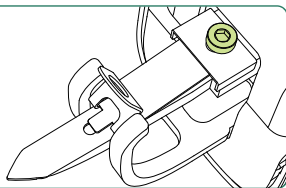

d. Reinsert the screw from step a and tighten it securely.

### 3. Threading

**Attention:** Always turn off the machine during threading.

**Suggestion:** It is currently recommended to use 3 strands of 2-ply yarn, 1 strand of 8-ply milk cotton, and 2 strands of 6-ply milk cotton.

#### Method 1 (If the Regulator Is **Not** Installed)

Threading through Hole A only, and removing the threading apparatus.

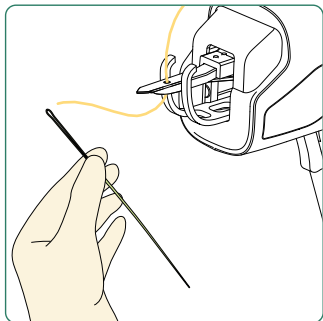
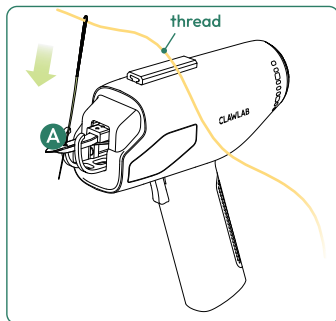

#### Method 2 (If the Regulator Is Installed)

Threading through Hole B, then proceeding to Hole A. (Refer to the diagram for hole locations).

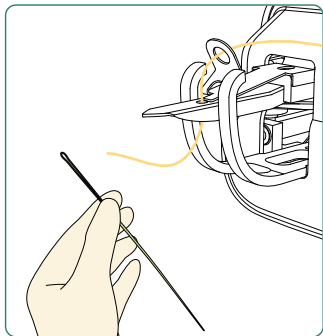
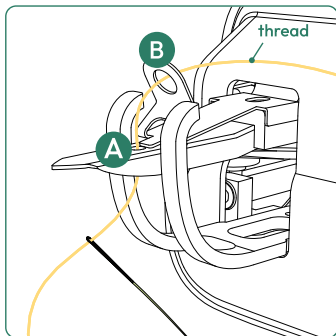

## 4. Power On & Speed Adjustment

**Attention:** The machine should only be powered on after threading is complete. Proceed with the following steps only once threading is finalized.

### Step 1

Connect the adapter and cable, then plug the other end into the power supply port at the bottom of the tufting gun.

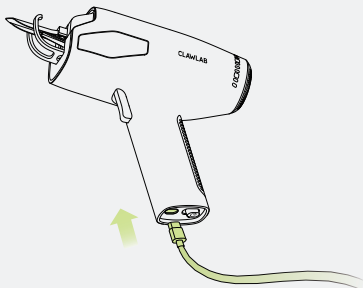

### Step 2

Switch on the power located at the bottom.  
The indicator light ring on the back will illuminate when powered on.

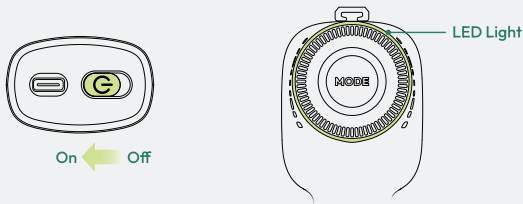

## Speed Adjustment

The rear rotary knob controls the tufting speed. The green LED ring indicates the current speed: a fully lit green ring represents the maximum speed of 20 stitches per second, while a quarter-lit green ring corresponds to a speed of 5 stitches per second, with increments in between, and so forth.

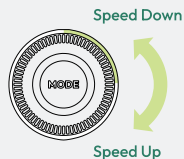
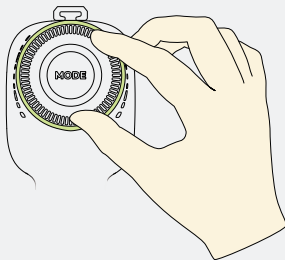

**Suggestion:** Beginners are advised to start at 3 to 4 stitches per second, roughly indicated by 1/5 of the rear LED's brightness.

## Quick Operation Technique



### 1. Proper Needle Insertion Technique

As shown in the diagram. Hold the tufting gun firmly and insert the needle into the tufting fabric, keeping the gun perpendicular to the fabric surface for optimal results.

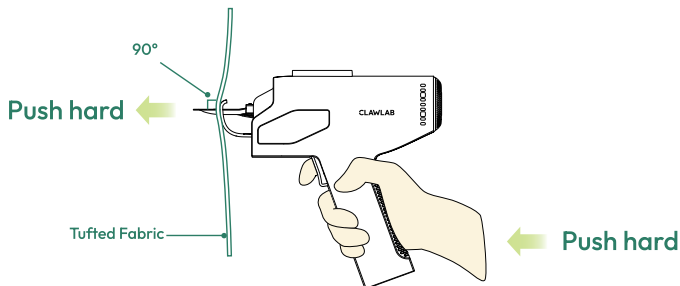

### 2. Forward Pressure Only

While tufting, apply force solely in the forward direction; avoid pressing upwards or downwards. Do not lift or pull the tufting gun in any other direction. Instead, allow the tufting gun to guide your hands, ensuring smooth and controlled movement.

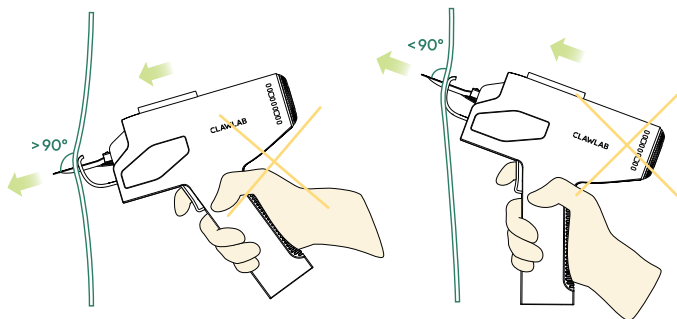

### 3. Curved Paths

For curved paths, gently guide the tufting gun to follow the curve, allowing it to move smoothly along the desired patterns.

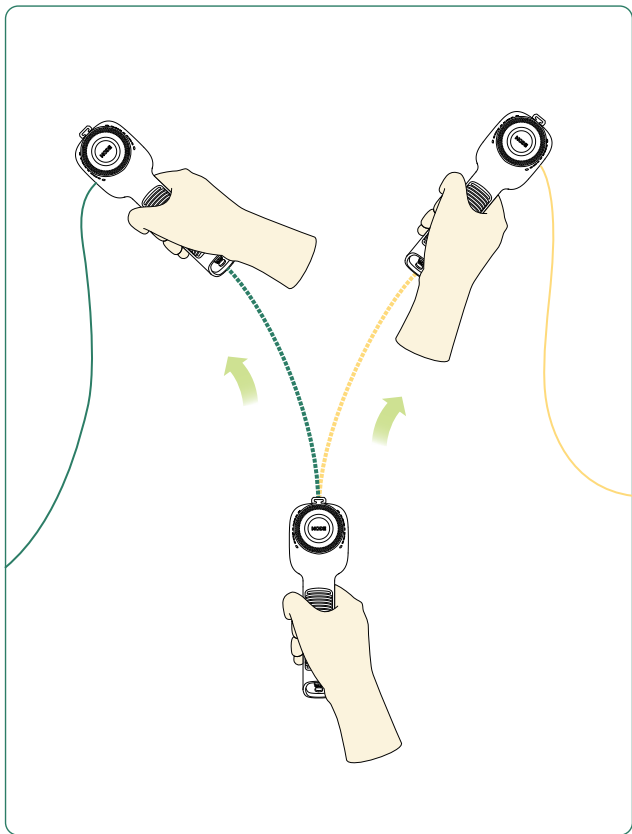



## Product Maintenance



- The ClawLab H1 tufting gun is made of durable, low-maintenance materials, minimizing regular upkeep.
- Avoid powering the device without loaded yarn.
- If the device is not in use for an extended period, apply the included lubricant to the front end of the scissors (see diagram below for the exact location).

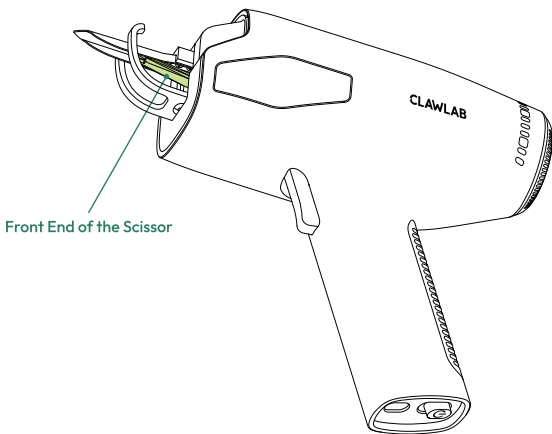

**Q:** Why does my device often not respond when I press the trigger?

**A:** Check if the indicator light ring is illuminated. If it's not lit, ensure the adapter and power connection are properly inserted and that the device is powered on. If the light is on and displays blue, the device is in self-lock mode. In this case, press the MODE button located behind the gun to resume normal operation.



Please visit [wiki.clawlabtech.com](https://wiki.clawlabtech.com) for more information.

If you like to share your first tufting pieces, follow and DM us on Instagram [@clawlab\\_official](https://www.instagram.com/clawlab_official).

# **CLAWLAB**

Where Art Meets Innovation.

[www.clawlab.com](http://www.clawlab.com)