

Parts Included In Your Yard Arm Kit



- A. Yard Arm (1)
- B. Ropes (2)
- C. Parts bag (1) Includes:
 - Rope cleats (2)
 - 3mm Screws (4)
 - Arm bolts (May already be installed)
 - Flag Clips (4)

Flags not included. Additional flag clips can be purchased from service first.

YARD ARM KIT

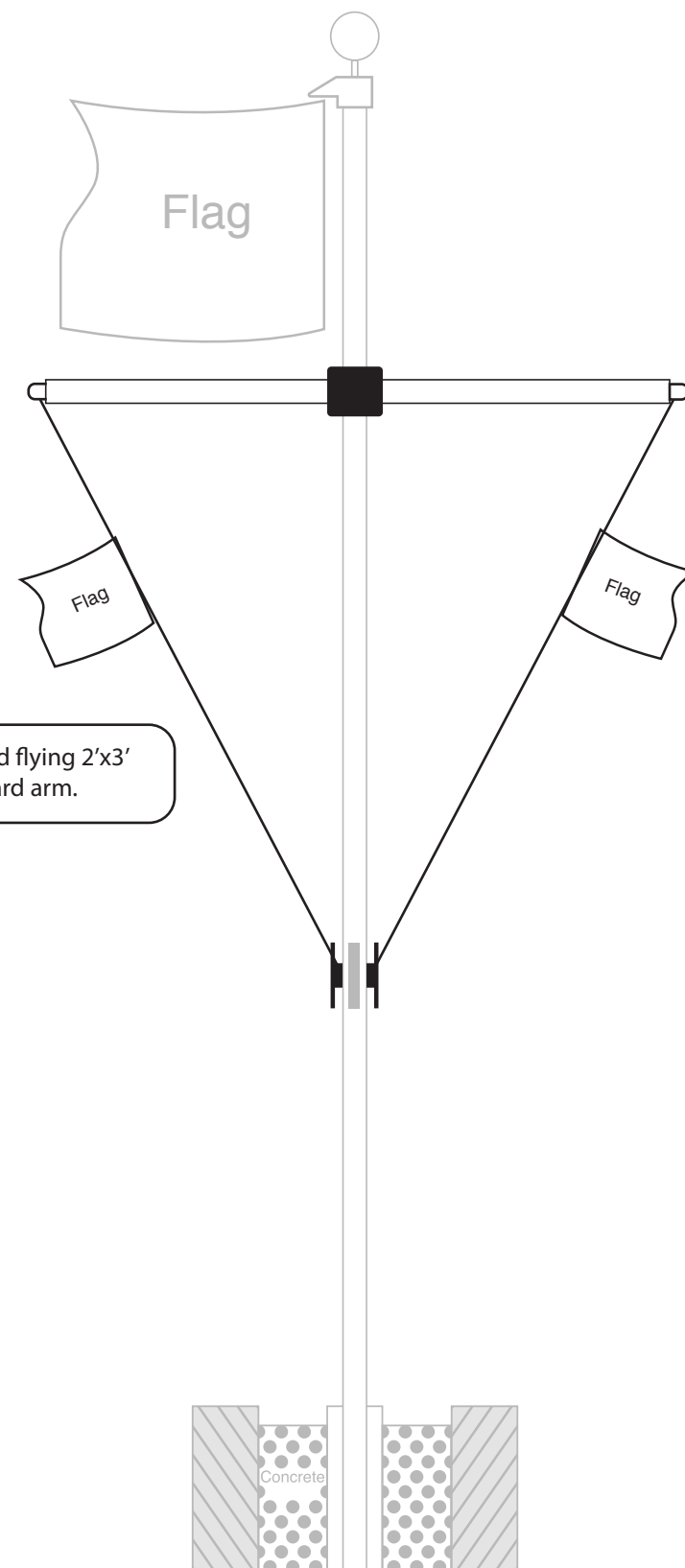

*We recommend flying 2'x3' Flags on your yard arm.



385-985-7244

ServiceFirstProducts.com

Designed in USA, Made in China

- When extreme weather conditions are present, it is recommended to lower and store the flagpole.

Patent Pending



Yard Arm Instructions

PREPARING YOUR FLAGPOLE



STEP ONE: Position the Cleat(s) 3-4ft from the bottom of the flagpole. Or to your preferred height. With a pencil or marker, mark where the holes will be.



STEP TWO: Use a 9/64" drill bit to drill holes into the marked locations. Use extreme caution when drilling into your flagpole.



STEP THREE: Using the 3mm screws provided. Secure the cleat to the flagpole (be careful not to over-tighten screws)



STEP FOUR: Repeat steps 2-3 for each side of the pole. A level is recommended to make sure that your hooks are at the same position around the pole.

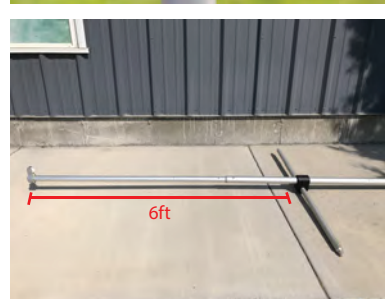

STEP FIVE: slide your yard arm from the top down and position approximately 6ft from the top of the pole.



STEP SIX - EIGHT: Remove the vertical securing bolt (shown in 6 and 7) and mark the position of the hole with a marker/pencil. Make sure yard arm is perpendicular to the front with the flat section facing forward (See diagram 6) Next, drill a hole into the marked location using a 3/16" drill bit to create a pilot hole. Once the pilot hole is finished, use a 5/16" drill bit to increase the size of the hole making it ready for the securing bolt.

Use extreme caution when drilling into your flagpole. Check measurements and placement carefully before drilling into your flagpole.

ASSEMBLING YOUR YARD ARM



STEP ONE: Thread rope through one side on the yard arm, directly through the hole. Repeat on the opposite side.



STEP TWO: Take the rope ends and insert into the connector. Once inserted, smash the connector with a hammer to secure the rope ends.



STEP THREE: Center the yard on so there is equal distance on both sides Tighten the front bolt on the yard arm connector to secure the yard arm left to right. ****Do not over-tighten**

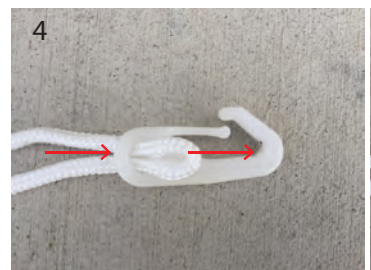

STEPS 4-5 (INSTALLING FLAG CLIPS): Loop part of the rope and thread through the bottom hole in the clip. Take the looped rope and wrap over the top of the clip.

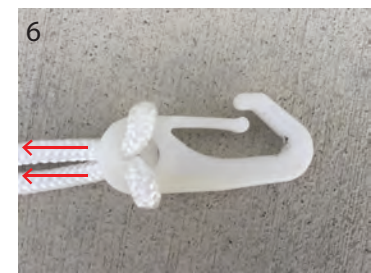

STEPS 6-7: Pull on down on the rope to secure the loop onto the clip. The distance of your clips will be determined by the size of flag you choose to fly. Attach the clips to the holes on the flag. Repeat steps 3-6 for the other clips.



Once your yardarm is installed on your flagpole, tie the loose ropes to the cleats that you previously installed.

ATTACHING YOUR YARD ARM (Telescoping Flagpole)



STEP ONE: Unscrew the top screw on your flagpole.

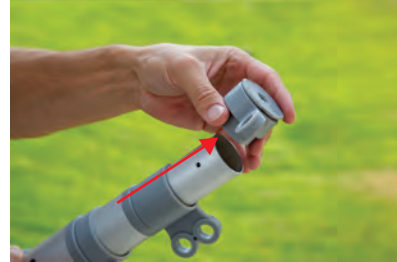

STEP TWO: Remove the top piece of the flagpole



STEP THREE: Remove the flag rings from the pole.



STEP FOUR: Extend the 1st and 2nd top sections of the pole. Slide the yard arm onto the pole and align with the previously drilled hole.



STEP FIVE: Secure yard arm in the pre-drilled hole from step seven of "preparing your flagpole". The screw is designed to fit through the 1/4" hole and provide a secure fit.

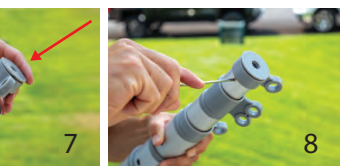
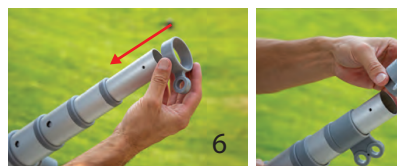

STEPS 6-8: Place rings back on flagpole. Place topper onto the flagpole. Secure with the provided screw.

Service first also offers a halyard conversion system that will allow your telescoping pole to use a role and halyard instead of the flag rings. For more information, contact service first.

PLEASE NOTE: Installing the cleats on the flagpole will make it so the telescoping flagpole cannot be fully collapsed. To fully collapse the telescoping flagpole, remove the installed cleats.

ATTACHING YOUR YARD ARM (Sectional Flagpole)



STEP ONE: Unscrew the top screw on the pulley top on your flagpole.



STEP TWO: Remove the pulley top of the flagpole



STEP THREE: Slide the yard arm onto the pole and align with the previously drilled hole.



STEP FOUR: Secure yard arm into the pre-drilled hole from step seven of "preparing your flagpole"



STEP FIVE: Place the pulley topper back on the top of the pole



STEP SIX: Screw pulley topper to tighten and secure.

*We recommend flying 2'x3' Flags on your yard arm.