

LED Emergency Exit sign

User Manual

INSTALLATION

Flexible conduit only.

PACKAGE CONTENT

INCLUDED



A x2

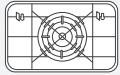

B x1

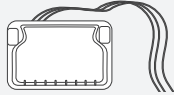

C x1

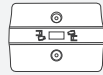

D x1



E x1



F x4



G x3



H x2



I x2

NECESSARY TOOLS (Not included)



IMPORTANT SAFETY INSTRUCTIONS

- Do not use outdoors.
- Do not let power supply cords touch the hot surfaces.
- Do not mount near gas or electric heaters.
- Use caution when servicing batteries. Battery acid can cause burns to skin and eyes. If acid is spilled on skin or in eyes, flush acid with fresh water and contact a physician immediately.
- Equipment should be mounted in locations and at heights where it will not readily be subjected to tampering by unauthorized personnel.
- Do not use this equipment for other than intended use.
- To prevent risk of electric shock, turn off the power at the main circuit breaker box before installation.
- This product must be installed in accordance with the applicable installation codes by a person familiar with the construction and operation of the product and the hazards involved. Consult a qualified electrician to ensure correct branch circuit conductor.
- This product is rated 120/277 VAC and must be connected to a suitable power source.
- The product employs non-replaceable LED light sources.
- All servicing should be performed by a qualified personnel only.
- This product is intended for emergency lighting applications such as stairways and hallways. During an electrical power failure, the sign automatically lights up for a minimum of 90 minutes.
- This product is intended to be used in dry and damp indoor areas only.
- No liability will be accepted for damages resulting from improper use or non-compliance with these instructions.

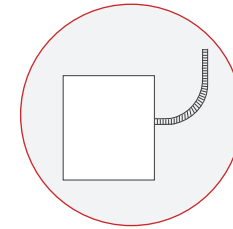
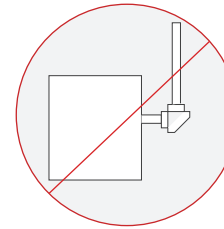

- 1 Turn off the main power switch before installation.

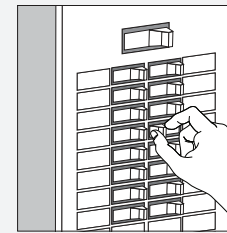

- 2 Push into the holes of the housing (C) to release the front panel (A).

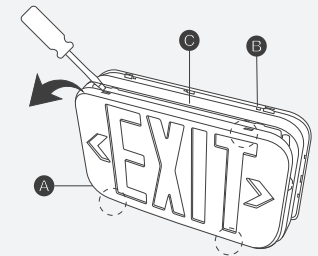

- 3 Connect the battery cable.
NOTICE: This product is supplied with a battery for use when main power source is not available. Refer to chapter "SPECIFICATIONS" for the battery replacement date.

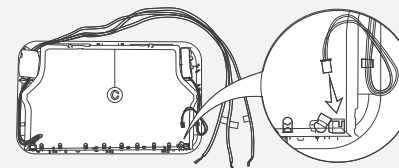

Wall mounting

- 1 Drill through the knockouts on the mounting plate (B) for wires and screws, then feed the wires through the center hole.

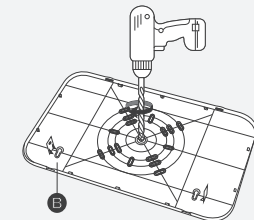

- 2 Use twist-on wire connectors (G) to join the wires to the electrical box. Refer to chapter "WIRING" for more details.

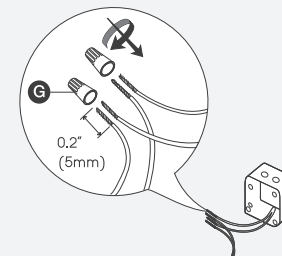

- 3 Screw the mounting plate (B) to the electrical box using screws (I) making sure no wires are pinched.

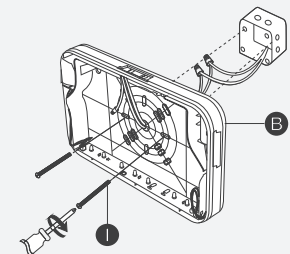

- 4 Clip on the front plate (A). Turn on main power source then press the TEST button (J). The emergency sign should dim, and the AC ON indicator goes off.

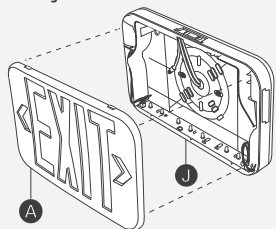

- 5 Insert direction arrow (s) (F) into the front and/or back plate (A) to hide the incorrect exit direction.

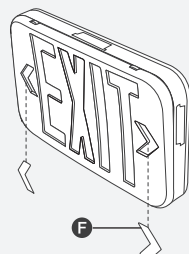

Side or ceiling mounting

NOTICE: If you require EXIT signs on both sides of the housing, remove the mounting plate (B) and replace with the spare front plate (A).

1

Using a screwdriver, remove the top or side knockout from the housing (C), then feed the wires through the hole, mounting bracket (D) and crossbar (E).

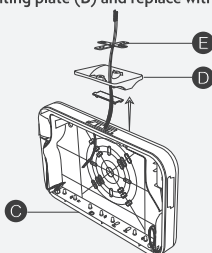

- 2 Use twist-on wire connectors (G) to join the wires to the electrical box. Refer to chapter "WIRING" for more details.

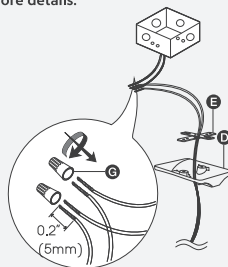

- 3 Screw the crossbar (E) to the electrical box using screws (H) making sure no wires are pinched, then screw the mounting bracket (D) to the crossbar (E) using screws (I).

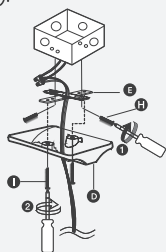

- 4 Align the clips on mounting bracket (D) to the housing (C) and twist the housing to secure.

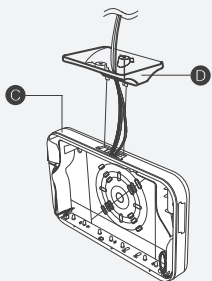

- 5 Clip on the front plate (A). Turn on power from the mains then press the TEST button (J). The emergency sign should dim, and the AC ON indicator goes off.

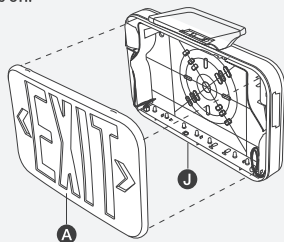

- 6 Insert direction arrow (s) (F) into the front and/or back plate (A) to hide the incorrect exit direction.

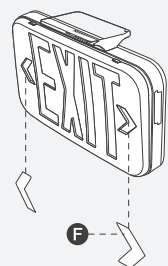

WIRING

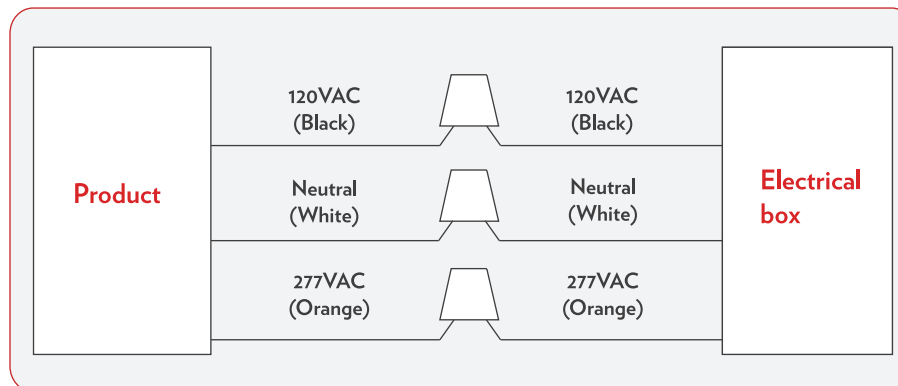

WARNING: Risk of electric shock!

- To prevent risk of electric shock, turn off the power at the main circuit breaker box before installation.
- Connect the black (live) and white (neutral) wires to the building utility for 120 VAC.
- Connect the orange (live) and white (neutral) wires to the building utility for 277 VAC.
- Cap off unused wire with wire connector (G).

MAINTENANCE

1. Battery replacement

This product is fitted with a Nickel-Cadmium battery which needs to be replaced as specified in chapter "SPECIFICATIONS".

2. Product testing

- In accordance to NFPA 101, this product must be tested monthly for a minimum of 30 seconds and annually for 90 minutes.
- To test, press the TEST button. The emergency sign should dim, and the AC ON indicator goes off.

SPECIFICATIONS

RATED VOLTAGE:	120/277 VAC 60 Hz
POWER INPUT:	4 W
CURRENT CONSUMPTION:	60 mA
BATTERY TYPE:	1.2 V 1000 mAh, AA Nickel-Cadmium
BATTERY REPLACEMENT DATE:	30/5/2024
OPERATING CONDITIONS:	32 °F to 104 °F (0 °C to 40 °C)
NET WEIGHT:	approx. 1.41 lbs (0.64 kg)
DIMENSIONS (W x H x D):	approx. 11.61 x 8.19 x 1.77" (29.5 x 20.8 x 4.5cm)