



LeonLite | LITE^{edge}

4-Light Smart Track Lighting Kit

User Manual
Notice d'Emploi
Manual De Usuario

DOWNLOAD LITEEDGE APP



PACKAGE CONTENT

INCLUDED

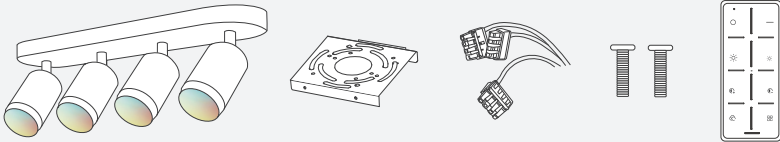

NECESSARY TOOLS (Not included)



PRODUCT FEATURES



2.4GHZ



BLUETOOTH



ELECTRICIAN
REQUIRED



JUNCTION BOX
REQUIRED



100-240V
ONLY



NOT
WATERPROOF



INDOOR USE
ONLY



0-12 CHILDREN
WARNING

IMPORTANT SAFETY INSTRUCTIONS



- Most electrical accidents are caused by a lack of understanding of electrical installation. Using basic knowledge of electricity, carefulness, and airing on the side of caution, you can safely take on many household electrical repairs. Here are some basic guidelines for working with electricity.
- Before you begin to work on a circuit, it is important to go to the main service panel and remove the fuse or trip the breaker that controls that circuit. Place a sign on the panel that warns others that the circuit is being worked on and that they should not turn it on or engage with it.
- Before touching any wire, use a voltage tester to make sure it's not live.
- Whenever you check for voltage in a receptacle, check both outlets - each may be controlled by a separate wiring circuit.
- When replacing fuses, turn off the main power first. Make sure your hands and feet are dry and place one hand behind your back to prevent electricity from making a complete circuit through your chest. Touch a plug fuse only by its insulated rim. Remove cartridge fuses with a fuse puller.
- Use tools with insulated handles and ladders made from wood or fiberglass.
- To protect children, place safety covers over any unused outlets.
- When unplugging a power tool or appliance, pull on the plug, not on the power cord.
- Improperly used extension cords are a leading cause of electrical fires. They are for temporary use only - do not use them to extend a circuit permanently.
- Keep dry-chemical fire extinguishers in the kitchen, basement, and workshop.
- Never disable grounding devices. Make sure that all appliances requiring grounding are properly grounded, and that the electrical system itself is properly grounded.
- Meet or exceed all electrical code requirements that cover the work you are doing.
- Always work with enough light to see what you are doing; it's easy to make mistakes when you're working in dim light.
- When in doubt about the safety of any electrical repair or test, call in a professional.

- 1 Turn off the main power switch before installation.



- 2 Place the mounting plate between the light and the ceiling, and connect wires.

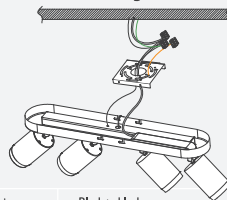

Black	Live	Black to black
White	Neutral	White to white
Green	Ground	Green to bare copper



- 3 Fasten the mounting plate to the electric box with screws.

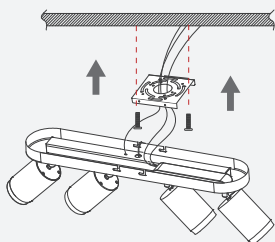

- 4 Hold the light close to the mounting plate, align all L-shaped notches (4) to the pre-installed screws, then slide it to lock in place.

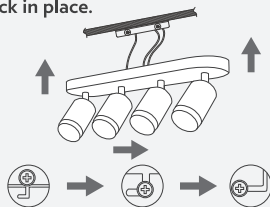

- 5 Secure the light with screws.

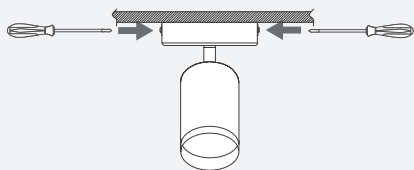

- 6 Adjust the direction of track light heads for the best illumination results.

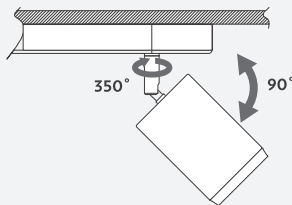

- 7 Flip the switch to bring your light back to life.

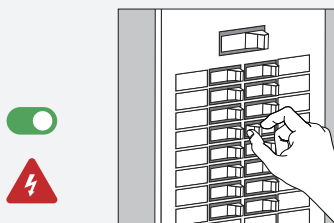

- 8 Keep an eye out - when it starts blinking, you'll know that it's ready for a connection with your smartphone. If not, cycle the power OFF-ON five times and watch as everything resets itself into pairing mode.

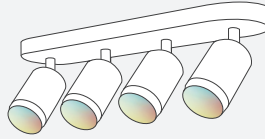

 Blinking

- 9 Link to online quick start guide.



1-800-990-7688 (Toll Free)



www.leonlite.com/contact



LeonLite Product innovation has always been a critical driver of LEONLITE's business. In a highly competitive industry, we constantly strive to develop new products that offer homeowners unique advantages in terms of style, installation, and energy efficiency. In addition, our products meet the industry's strictest safety and performance standards to ensure product quality.



TORCHSTAR CORP

LeonLite

LITEdge

3768 Milliken Ave, Suit A
Eastvale, CA 91752

Questions or Comments

1-800-990-7688

info@leonlite.com

www.leonlite.com

© 2022 TORCHSTAR CORP

All rights reserved