



LeonLite | LITE^{edge}

50W Smart Pendant Light

User Manual
Notice d'Emploi
Manual De Usuario

DOWNLOAD LITEDGE APP

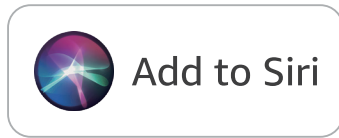

PACKAGE CONTENT

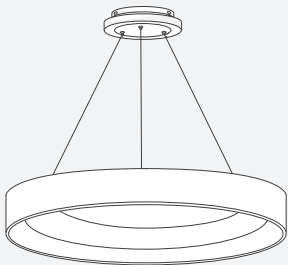

PRODUCT FEATURES



2.4GHZ



BLUETOOTH



NOT
EXPOSE TO SUN LIGHT



ELECTRICIAN
REQUIRED



AC120-240V
ONLY



3000LM



-4°F-104°F
WORKING TEMP



0-12 CHILDREN
WARNING

IMPORTANT SAFETY INSTRUCTIONS



1. PLEASE READ ALL INSTRUCTIONS BEFORE UNPACKING AND ASSEMBLING THE LAMP.

2. ATTENTION: Please note that all work on electrical system must be carried out by a trained or authorized specialist.

3. Please follow these instructions and keep them for future cases.

4. If you pass the light to a third party, only together with this manual.

5. Before the lamp is installed, the existing power supply must be compared with the technical data of the lamp.

6. Avoid damage or clamping of the cable. Cables must never be routed over sharp edges.

7. Do not look directly into the light sources -> Risk of Blinding!

8. If any electrical parts of the lamp fail, they must be replaced only by an authorized specialist.

9. The transformer must not be exchanged for a different model.

10. WARNING: This lamp is suitable only for indoor use.

11. WARNING: Before starting any work on the electrical system, the power must be turned off. Remove the fuse or switch them off.

INSTALLATION

- 1 Adjust the wire length if necessary. To adjust the wire length, press the self-lock wire fittings and then push or pull the wires. Keep the light horizontal while adjusting.

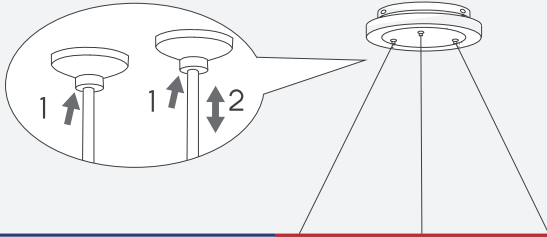

A. J-BOX MOUNTING

- a2 Install the mounting plate to the j-box using screws.

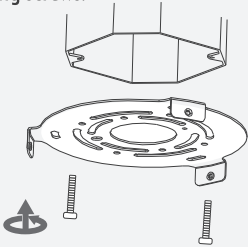

B. CEILING MOUNTING

- b2 Drill holes and install the mounting plate.

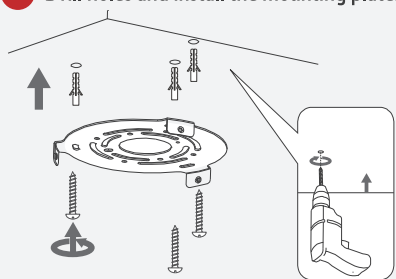

- 3 Connect the ground wire to the copper wire terminal; black wire to black wire terminal; white wire to white wire terminal.

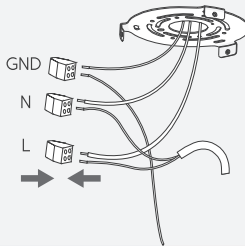

- 4 Wrap the ground copper wire around the ground screw and fasten the ground screw to the mounting plate.

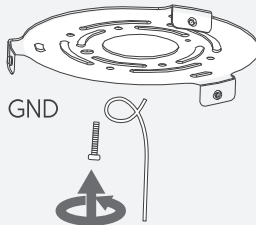

- 5 Install the light firmly to the mounting plate using screws.

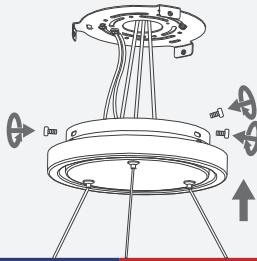

- 6 Flip the switch to bring your lights back to life. Keep an eye out - when it starts blinking, you'll know that it's ready for a connection with your smartphone. If not, cycle the power OFF-ON five times and watch as everything resets itself into pairing mode.

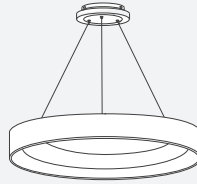
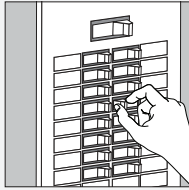

- 7 Link to online quick start guide.



1-800-990-7688 (Toll Free)



www.leonlite.com/contact



LeonLite Product innovation has always been a critical driver of LEONLITE's business. In a highly competitive industry, we constantly strive to develop new products that offer homeowners unique advantages in terms of style, installation, and energy efficiency. In addition, our products meet the industry's strictest safety and performance standards to ensure product quality.



TORCHSTAR CORP

LeonLite

LITEdge

3768 Milliken Ave, Suit A
Eastvale, CA 91752

Questions or Comments

1-800-990-7688

info@leonlite.com

www.leonlite.com

© 2022 TORCHSTAR CORP

All rights reserved