



LeonLite | LITE^{edge}

4-Light Smart Ceiling Fixture

User Manual
Notice d'Emploi
Manual De Usuario

DOWNLOAD LITEDGE APP

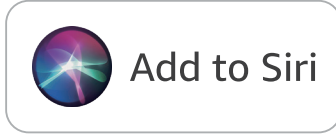

PACKAGE CONTENT

INCLUDED

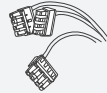
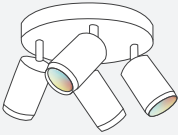

NECESSARY TOOLS (Not included)



PRODUCT FEATURES



2.4GHZ



BLUETOOTH



ELECTRICIAN
REQUIRED



JUNCTION BOX
REQUIRED



100-240V
ONLY



NOT
WATERPROOF



INDOOR USE
ONLY



0-12 CHILDREN
WARNING

IMPORTANT SAFETY INSTRUCTIONS



- Product appearance may vary from image shown.
- Use only with 100-240V AC line voltage power.
- Junction Box Mount Only 4-Light Smart Ceiling Fixture.
- This luminaire and power supply unit is intended for installation in accordance with the National Electrical Code and local code specifications. Failure to adhere to these codes and instructions may result in serious injury and/or damage to the PSU and void the warranty.
- These instructions do not purport to cover all details or variations in equipment, nor to provide for every possible contingency related to installation, operation, maintenance, or mounting situation. Should specific problems occur that are not addressed by these instructions, contact your Sales Representative or distributor for assistance.
- Read all instructions and safety information before use.
- Small parts may pose choking hazards. Keep device and box contents out of reach of children.
- Risk of fire or electric shock. Before touching any wire, use a voltage tester to make sure it's not live. Touch a plug only by its insulated rim. Use tools with insulated handles.
- Disconnect main power at fuse or circuit breaker before installing or servicing the light.
- Do not use where directly exposed to water or weather.
- SAVE THESE INSTRUCTIONS for future reference.

INSTALLATION

- 1 Turn off the main power switch before installation.

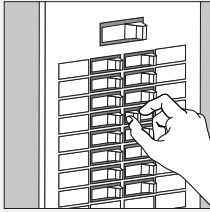

- 2 Remove the mounting plate from the back of light.

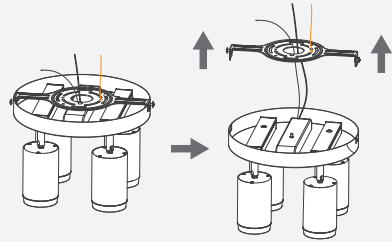

- 3 Locate the junction box in the ceiling.

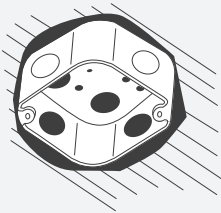

- 4 Connect wires and fasten the mounting plate to the electric box.

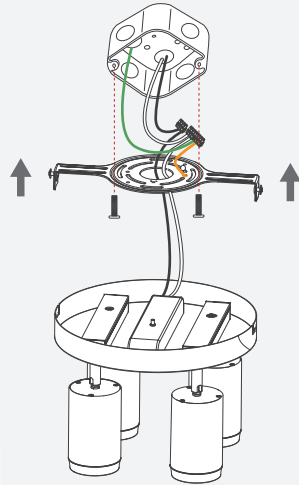

Black	Live	Black to black
White	Neutral	White to white
Green	Ground	Green to bare copper

- 5 Push the light upward, and rotate it clockwise.

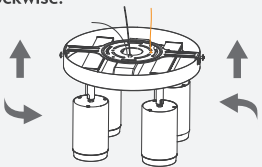

- 6 Secure the light with screws.

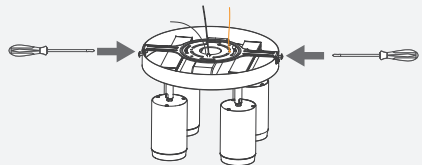

- 7 Flip the switch to bring your light back to life.

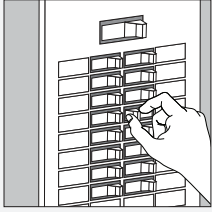

- 8 Keep an eye out - when it starts blinking, you'll know that it's ready for a connection with your smartphone. If not, cycle the power OFF-ON five times and watch as everything resets itself into pairing mode.

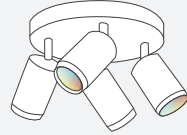

- 9 Link to online quick start guide.



1-800-990-7688 (Toll Free)



www.leonlite.com/contact



LeonLite Product innovation has always been a critical driver of LEONLITE's business. In a highly competitive industry, we constantly strive to develop new products that offer homeowners unique advantages in terms of style, installation, and energy efficiency. In addition, our products meet the industry's strictest safety and performance standards to ensure product quality.



TORCHSTAR CORP

LeonLite

LITEdge

3768 Milliken Ave, Suit A

Eastvale, CA 91752

Questions or Comments

1-800-990-7688

info@leonlite.com

www.leonlite.com

© 2022 TORCHSTAR CORP

All rights reserved