

TECHNICAL SPECIFICATION

System Type: 2.4 GHz wireless transmitter/receiver

Camera (including antenna) Art. No. 1100

Operating frequency	2400 – 2483.5 MHz
Sensor	Color CMOS
Resolution	720p
Maximum output power	22 dBm
Transmission distance	100 m
Operation temperature	- 20°C to + 70°C
IP classification camera	IP69K
Minimum illumination	0.1 Lux
Night vision range	10 m
Angle of view	110°
Power supply	12 V – 32 VDC
Power consumption	2 W
Size (W x H x D)	10 cm x 8 cm x 9 cm
Weight	397 g

Monitor (including antenna) Art. No. 1097

Operating frequency	2400 – 2483.5 MHz
Screen type	7" IPS digital panel
Transmission distance	up to 100 m
Latency	100 ms
Frame rate	30f/s
Operation temperature	- 20°C to + 70°C
Brightness	450 cd/m ²
Resolution	1024 x 600
Power supply	6V–32 VDC
Power consumption	2.5 W
Size (W x H x D)	22.5 cm x 14 cm x 6.1 cm
Weight	400 g

LudaFarm_OIG_MC_Mobility HD_2023_01

PowerBank 12000 Art. No. 1119

Description	Power Bank for 12V cameras with Luda.Farm waterproof connector
Dimensions	71.5 x 110 x 51mm.
Weight	420g
Ingress protection	IP68
Input power	DC 5-16V; 800 - 1300 mA
Full Charging time	9 hours
Output voltage	12V / 1.2A (max)
Battery capacity	12000mAh,44.4Wh,3.7V
Operation temperature	-20°C to +60°C

Charger

Charger input	100 - 240V - 50/60 Hz
Charger output	DC12V/1A
IP rating	IP60 (not waterproof)
Operating temperature	-10 - 60°C

Battery time up to

MachineCam HD	14 h (Day, IR lights off)
MachineCam Mobility HD	22 h (Day, IR lights off)
TrailerCam HD	22 h (Day, IR lights off)



FAQ

- 1. Is the signal between the camera and the monitor encrypted?**
Yes.
- 2. How many cameras can connect to the monitor?**
2 cameras.
- 3. Why does the frame rate sometimes drop when I am driving?**
This can occur when camera and monitor are positioned in a bad angle towards each other.
- 4. Is the camera water resistant?**
The camera is classed IP69K. This means that the camera is well protected from both dust and humidity. It can be placed outside and be cleaned with water.
- 5. Does the camera have a microphone?**
No.
- 6. I am using the camera for reversing, how do I mirror the image?**
Please see the instructions in the "Operation" section.
- 7. What do I do if the monitor has bad signal reception?**
Move the camera or monitor to a better position, if that does not help, please visit www.support.luda.farm for help/support.
- 8. How does the camera react to minus degrees?**
At very low temperatures the picture might tone into red. At extremely low temperatures the camera might turn off. However, when the temperature gets higher again the camera will regain its functionality.
- 9. How much time is needed to fully charge the PowerBank?**
The battery will be fully charged in about 9 h, using the provided charger.
- 10. The frame rate is low.**
Try to move the camera to see if you can get better signal reception.
- 11. The picture on the monitor is black and white.**
In dark conditions, the IR LEDs will automatically switch on, resulting in pale colors. With very limited lighting, the picture will become completely black & white.

machineCam Mobility HD QUICK GUIDE



3
Years
Warranty

Register your product today
and get 3 years warranty.
luda.farm/warranty-register

For more detailed information



→ www.support.luda.farm

ENGLISH

LUDA FARM

www.Luda.Farm, Krokslätts fabriker 30, 43137 Mölndal, Sweden

INCLUDED IN THE BOX



Camera
Art. No. 1100



7" Monitor
Art. No. 1097



12V Power Cable
Art. No. 6047



Monitor Holder
Art. No. 7034



Powerbank 12000
Art. No. 1119



Charger for Powerbank
Art. No. 6038



Camera Power Cable
Art. No. 6043

INSTALLATION

POWERBANK

- 1 Charge the Powerbank

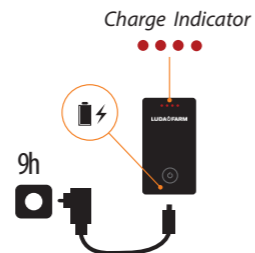

- 2 Connect the Powerbank to the camera



! When not in use, turn off to save battery time

MONITOR

- 1 Connect the monitor to a USB or 12V outlet (CIG outlet)

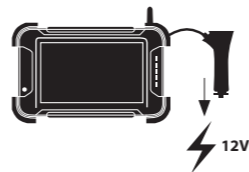

OPERATION

- 1 Power on

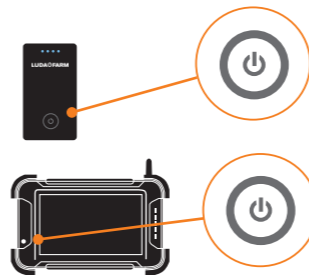

- 2 Change channel with the CH button to the right

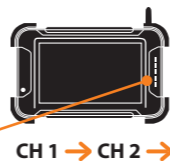

Example of installation



Mirror Mode



Press the "M/Pair" button several times until you see "Mirror mode".



Press the + button until you see the mirrored image on the monitor.

Black screen

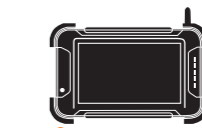
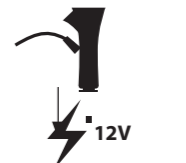
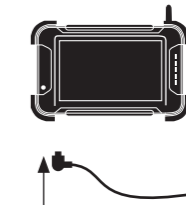

Power on

Camera does not work

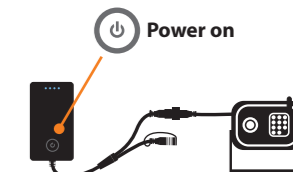

Right channel?
Press on CH button

CH 1 -> CH 2 ->

Paired?



Press the pair button for 1s