

Owner's Manual & Safety Instructions

BATTER OPERATED LIQUID TRANSFER PUMP

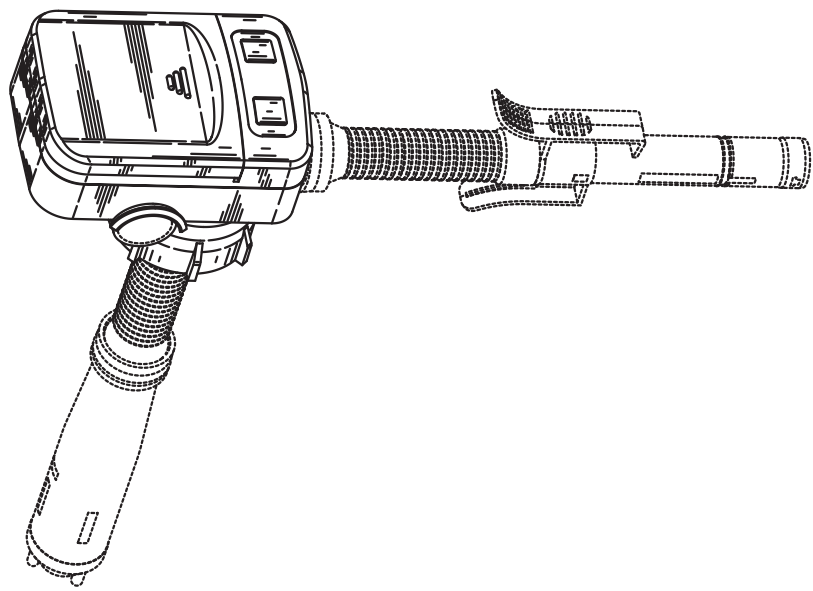

Model: FX801

Save This Manual Keep this manual for the safety warnings and precautions, assembly, operating, inspection, maintenance and cleaning procedures. Write the product's serial number in the back of the manual near the assembly diagram (or month and year of purchase if product has no number). Keep this manual and the receipt in a safe and dry place for future reference.



WARNING

Read this material before using this product. Failure to do so can result in serious injury.

SAVE THIS MANUAL.



DANGER

This is the safety alert symbol. It is used to alert you to potential personal injury hazards. Obey all safety messages that follow this symbol to avoid possible injury or death.

This is the safety alert symbol. It is used to alert you to potential personal injury hazards. Obey all safety messages that follow this symbol to avoid possible injury or death.

WARNING

Indicates a hazardous situation which, if not avoided, could result in death or serious injury.

CAUTION

Indicates a hazardous situation which, if not avoided, could result in minor or moderate injury

NOTICE&CAUTION

Addresses practices not related to personal injury.

Specifications:

Power	Requires 4 "AA" Batteries (NOT Included)
Suction Tube	18 inch
Discharge Hose	39 inch
Delivery Volume	2.4 Gallons per Minute
Auto-Stop	Built-in Auto-Stop System
Applications	Gasoline, diesel, kerosene, light oils Non-potable water
Package Dimensions	3.35 x 13.82 x 6.06 inch
Package Weight	1.06 Lbs

IMPORTANT SAFETY INFORMATION

⚠ WARNING Read all safety warnings and instructions. Failure to follow the warnings and instructions may result in serious injury. Save all warnings and instructions for future reference

1. Do not use with corrosive liquids. Not for use with drinking water.
2. When pumping gasoline and flammable liquids, be alert to possible explosion hazard. Flammable fluid fumes and gasoline vapors can be an explosive hazard. Avoid sparks and use only with adequate ventilation.
3. Wear ANSI-approved safety goggles and heavy-duty, chemical resistant work gloves during use.



4. This product is not a toy. Do not allow children to play with or near this item.
5. Use as intended only. Only use pump for transferring gasoline, water, oil, and other non-corrosive liquids.
6. Do not use if Pump is hot.
7. Verify that all connections are tight before use to eliminate leaking.
8. Do not pump used, dirty oil.
9. Do not use near open flame or heat sources.
10. Do not turn Pump upside down after use.
11. Remove batteries when not in use.
12. Know and obey city and state laws for proper disposal of oil and gasoline. Dispose of properly in accordance with all local laws and regulations.
13. Follow all guidelines regarding materials being pumped, including SDS instructions and EPA regulations.
14. Do not mix old and new batteries. Do not mix alkaline, standard (carbon-zinc), or rechargeable (nickel-cadmium) batteries. Position batteries in proper polarity. Do not use swollen or leaking batteries.
15. Do not operate when tired or when under the influence of drugs or medication.
16. Inspect before every use; do not use if parts are loose or damaged.
17. Maintain product labels and nameplates. These carry important

SAVE THESE INSTRUCTIONS.

Operating Instructions

Read the ENTIRE WARNING section at the beginning of this manual including all text under subheadings therein before set up or use of this product

Note:

For additional information regarding the parts listed in the following pages, refer to the Parts List and Diagram on page



HOW TO PLACE THE BATTERIES

Insert 4 AA batteries according to + and - signs

How To Open The Battery Cover

Place thumb in grooves as shown in picture, push and slide the cover off in the direction of arrow

Direction Of Batteries as indicated in below picture

* Replace all 4 batteries at the same time

* Use the same brand/type of batteries

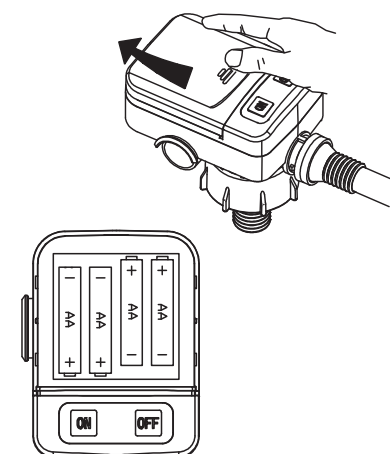

EMERGENCY CASE WHEN ALL (4) BATTERIES ARE NOT AVAILABLE

It is recommended to use all 4 AA batteries when you are able, but it is possible to operate with 2 AA batteries during emergencies.

* Can pump out approximately 50x 5 gallon fuel cans using 4 batteries and with 2 batteries can pumps out approximately 25x 5 gallon fuel cans.

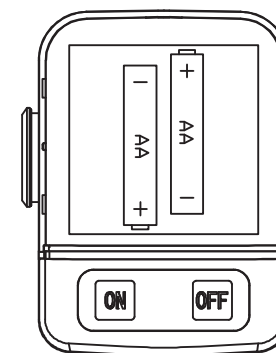

WHEN TO REPLACE THE BATTERIES

- Motor does not operate, even after pressing ON switch or transfer rate becomes slower than in normal operation
- Batteries can begin to discharge if they are stored for a long period of time. Check the expiration dates of batteries

Operation:

1. Insert the Suction Tube as far as possible into the liquid to be transferred.
2. Place the Delivery Hose into a container (not included) in which to pump the liquid. Do not place receiving container higher than the Battery Housing.
3. Turn the ON/OFF Switch to ON. Make sure the battery compartment remains sealed during operation.



NOTICE:

Do not run unit dry. Make sure Suction Tube is fully submerged in liquid before turning on.

- When the transfer is complete, turn the Switch OFF. After use, do not turn Pump upside down.
- Rinse unit with water and wipe dry. Remove batteries and store in a clean, dry location out of reach of children.

HOW TO USE

- Find the adaptor that is the best fit and make sure it is fastened tightly to your supply tank

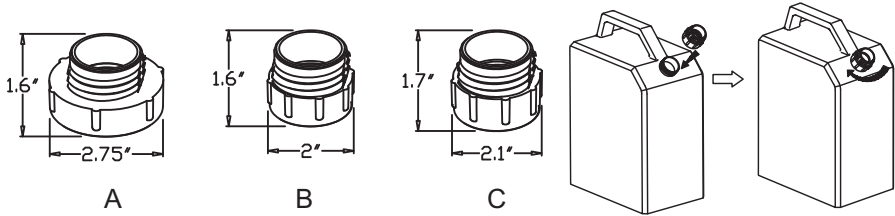

- Insert intake hose through the adaptor and fasten the pump's joint nut tightly.

* Do not lift up or push down the pump while it is attached to the fuel tank.

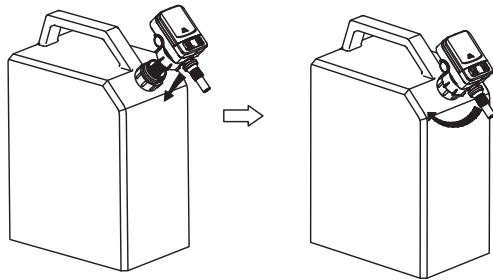

- Attach the discharge hose to your receiving tank using the clip, Make sure the discharge nozzle is a vertical position.

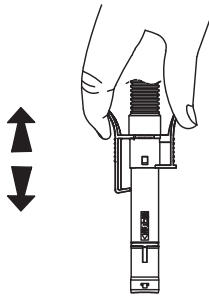

* Make sure that the supplying tank and receiving tank are on the same level when pump is operating.

* For tanks which are not fit with the clip, make sure the discharge nozzle is in a vertical position.

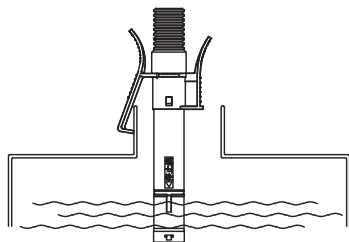

HOW TO STORE

- When the pump is not being used for long periods of time, take the pump out of the tank, make sure no remaining fuel is in the hose, and wipe it down with a cloth before store it.
- Make sure to take the batteries out before storing the pump.
- Do not store the pump in enclosed airtight container.

Maintenance

SAFETY INSTRUCTIONS

NOT FOR DRINKING WATER

DO NOT DO THIS :

- Do not transfer fuel while vehicle or the vehicle's heater is ON (may cause a fire).
- Do not leave the pump unattended (may cause oversupply of oil, a fire or any accident).
- Do not alter or disassemble the pump (may cause failure of the product or an accident).
- Do not place the pump in a wet area (may cause failure of the product or an accident).
- Do not use deteriorated or aged fuels (these may cause our product to fail).
- Do not use for drinkable liquids, or with thinners, solvents, hot liquid, Aceton, Benzen, Creoso, Ethy, Pheno, Methy, ethy concentrated caustic soda liquid, Nitric acid, Hydrochloric acid, Sulfuric acid, etc.
- Do not shock the pump (may cause a failure or damage of the product).
- Do not run the pump 'dry' or let the pump idle without transferring (may cause failure of product)
- Do not close the hole of sensor inlet transparent vessel under direct sunlight (may not stop automatically and overflow liquid)
- Do not put the product in a vehicle with all windows closed, direct sunlight area, or next to any heating appliances may cause an accident or transform the product).
- Do not allow children to operate the product without adult supervision.
- Do not use the product on carpet, wood floor or combustible area (may cause a fire). Be careful not to damage the floor surface and or carpet by fuel leakage.
- Do not store the pump in enclosed airtight container.

YOU MUST DO THIS

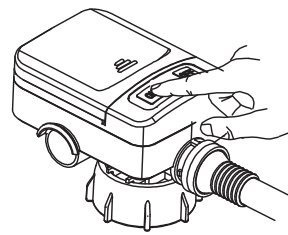

- Start the flow of fuel by pressing the ON button.

* Automatically stop when the fuel reaches the stop line.

- After automatically stopping bring the discharge hose up above the tank to drain the excess fuel or liquid back into the supply tank.

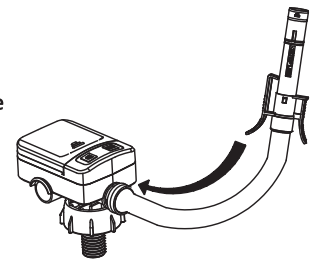

As shown on the right

- Put the discharge nozzle in discharge compartment and lock into place with clip.

* Place the discharge nozzle into discharge nozzle compartment properly after fueling.

In the event the fuel tank falls over, and the discharge hose is not in its storage hole, the liquid can leak out.

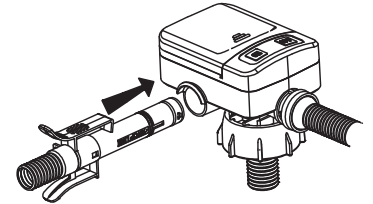

Parts List :

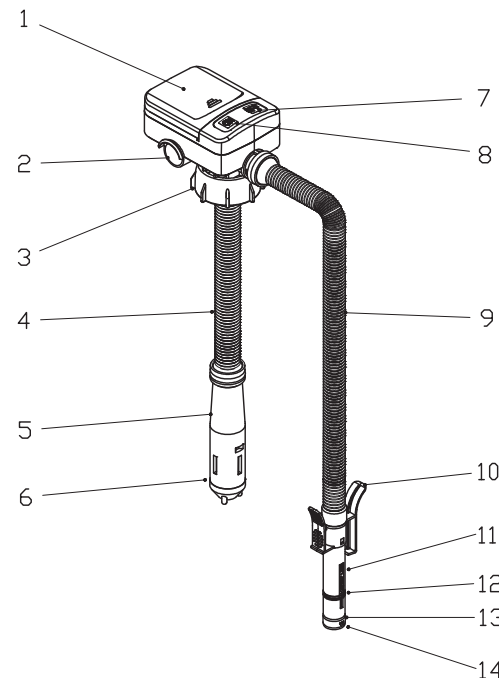

1	Battery Case Cover
2	Discharge Nozzle Compartment
3	Joint nut
4	Intake hose
5	Liquid intake
6	Motor inside
7	OFF Button
8	ON Button
9	Discharge hose
10	Clip
11	Discharge nozzle
12	Rubber ring
13	Sensor Inlet
14	Discharger Outlet



WARNING:

IMPROPER USE CAN CAUSE A DEATH OR SERIOUS INJURY

! Make sure to use the pump on even surface

(If the tank falls down during the liquid supply, liquid will leak and may cause a fire an accident)

! Make sure the pump is tightly secured to the tank before turning the pump on.

! Make sure the sensor on the discharge nozzle is vertical (may not stop automatically, could cause fuel to overflow).

! Make sure remove any left-over fuel in the pump after each use (may cause of failure of the pump if fuel remains around the sensor).

! Make sure to detach the tank from the pump when moving (may cause leak of fuel if moved while the tank is attached).

Troubleshooting

FAULTS	CHECKS (possible causes)	REMEDIES
Pump does not operate even after pressing ON	A: Batteries may be incorrectly placed B: Batteries are depleted	A: Ensure the batteries are placed in the pump correctly B: Replace the batteries
Pumps performance is low	A: Batteries are depleted B: Elevation of receiving tank is higher than supplying tank	A: Replace the batteries B: Make sure that the receiving tank is not elevated above the supply tank
Pump starts after pressing ON button but then stops unexpectedly	Filter of receiving tank may be blocked with foreign material	Clean foreign material from the filter
Pump immediately stops after pressing the ON button	Batteries are depleted	Replace the batteries
Motor stops before receptacle tank is full	A: Batteries are depleted B: Sensor is too low and is touching the liquid	A: Replace the batteries B: Adjust the discharge nozzle up so that the sensor is closer to the top of the supply tank

