

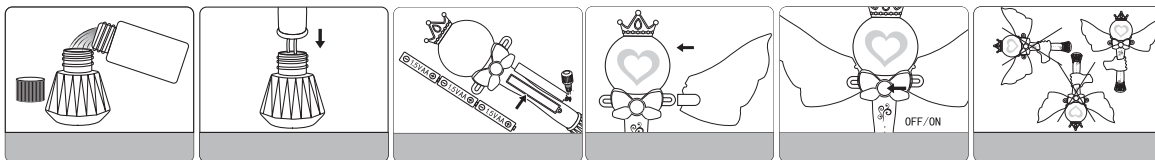

Directions:

1. Unscrew the back of the battery compartment and insert 3 AA batteries. Screw back the battery compartment cover.
2. Attach the wings to the sides of the bubble wand.
3. Fill the bubble container with the bubble solution and screw the bubble container on the bottom of the wand holding it upright. Both of the tubes must go in the container.
4. Press the on/off button on the back of the bubble wand. Wait 20 seconds after turning the wand on for the bubble solution to travel through the wand. For the best outcome keep the wand upright.
5. Press the on/off switch a second time to turn the wand off.



Battery Use Instructions and Cautions:

1. Use correct battery size as indicated. Insert batteries following the correct polarity as shown.
2. Do not mix different battery types. Do not mix new and old batteries.
3. Do not use rechargeable batteries.
4. Remove batteries when not in use.
5. Batteries not included.
6. Requires 3 AA batteries.

CAUTION:

- Do not drink the bubble solution.
- Do not touch your eyes after touching the bubble solution as it may cause discomfort.
- Recommended for outdoor use.
- Specifications, colors, and contents may vary from illustrations.

Tips:

- To clean the bubble wand use a damp towel and do not immerse in water.
- If bubbles stop coming out or the light is getting dim, replace the batteries.



Please include your order number when you contact us at support@usatoyz.com for fast, friendly service.

Warning: Choking Hazard
Contains small parts. Not for children under 3 years



Made in China

Not suitable for children under 3 years