

ITEM	QTY	PART NUMBER	DESCRIPTION	MATERIAL
1	1	2433-1002	RING: 1524 ALUMINUM	A356.0-F

REVISIONS			
REV.	DESCRIPTION	BY	DATE
00	PRODUCTION RELEASE	GB	5/31/2023

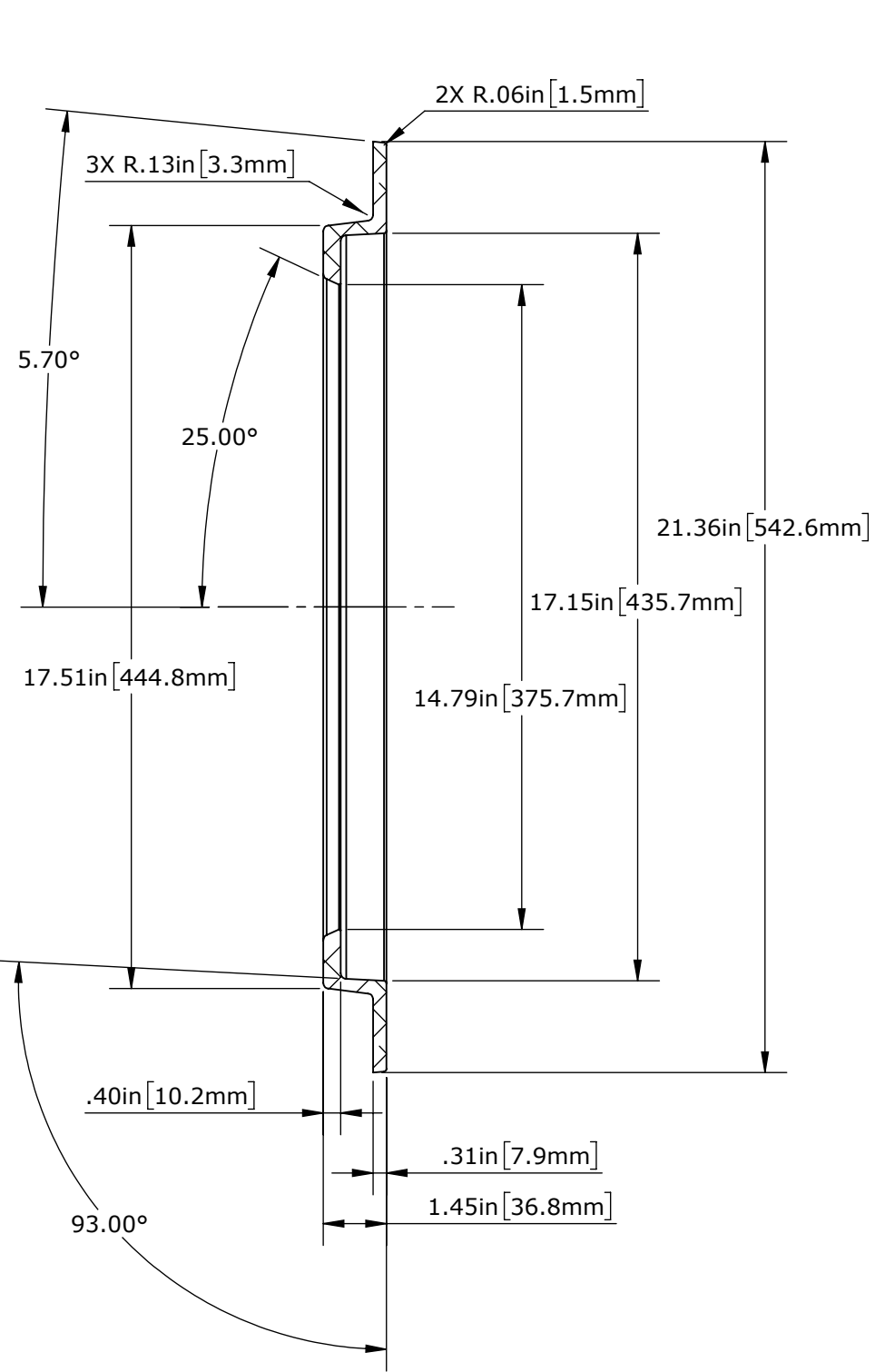

SECTION A-A

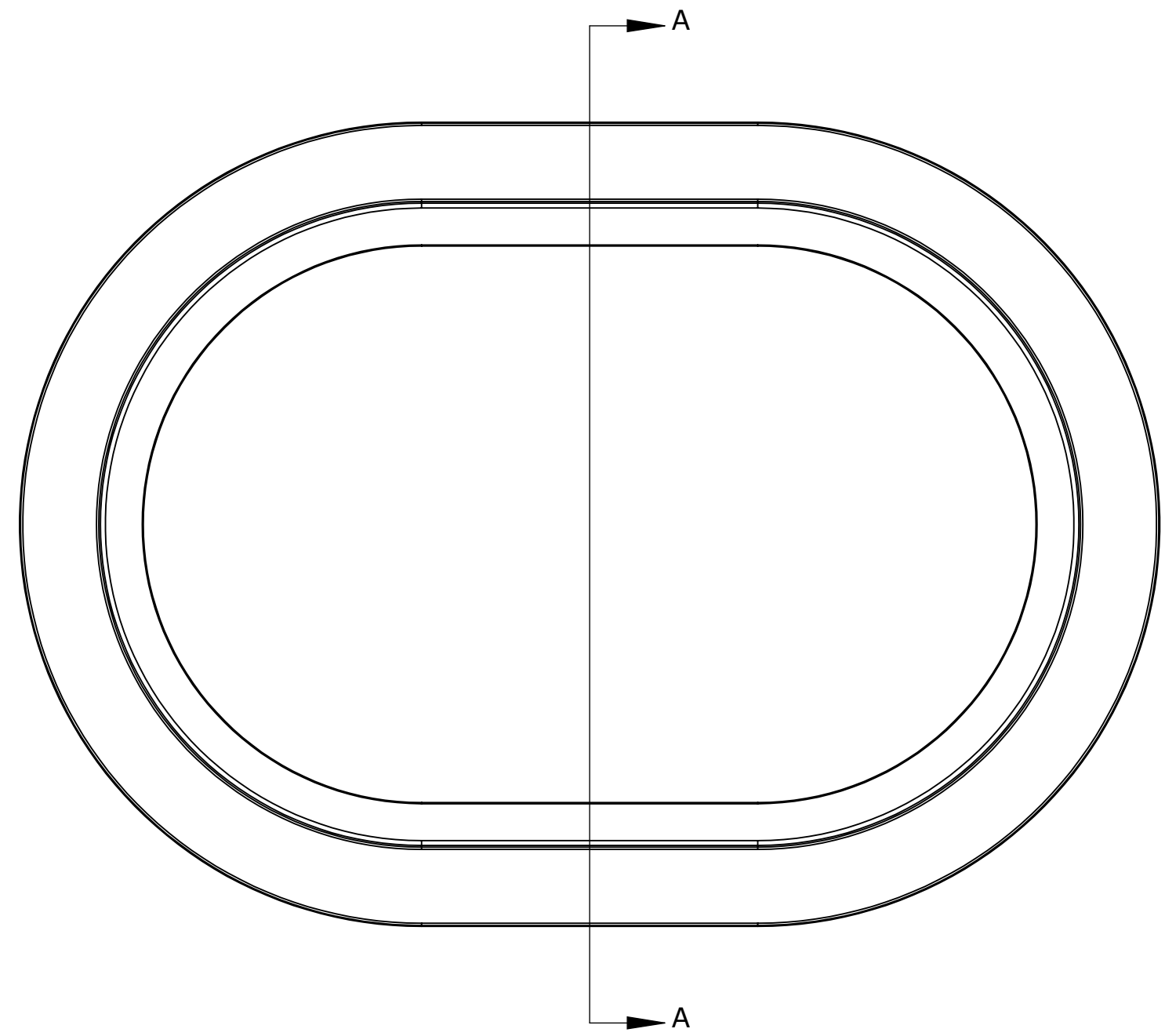

- GENERAL NOTES**
- BREAK SHARP EDGES AND DEBURR.
  - FINISH:
  - APPROX. ESTIMATED WEIGHT: 9.89lb or 4.4kg

**CUSTOMER APPROVAL**

IMPORTANT! THIS DRAWING SUPERSEDES ALL OTHER DOCUMENTS. BY SIGNING THIS APPROVAL YOU ACCEPT AND AGREE THAT THE DIMENSIONS AND DETAILS SHOWN ARE CORRECT AND PROPERLY FIT YOUR APPLICATION, REGARDLESS OF ANY DIFFERENCES BETWEEN THIS DRAWING AND ANY PRIOR CONTRACT SPECIFICATIONS. SHOULD YOU HAVE ANY QUESTIONS OR SEE ANY ERRORS, DO NOT SIGN THIS APPROVAL UNTIL THE DRAWING IS CORRECTED.

SIGN \_\_\_\_\_ DATE \_\_\_\_\_

UNLESS OTHERWISE SPECIFIED, DIMENSIONS ARE IN MILLIMETERS. TOLERANCES FOR ROUGH AND CLEAR OPENINGS ARE ±3mm (.125"). ALL OTHERS ARE:

METRIC	X	.X	.XX	ANGLES
	±2.5	±.8	±.25	±2°
IMPERIAL	.X	.XX	.XXX	ANGLES
	±.1	±.03	±.010	±2°

3RD ANGLE 

CAGE CODE  
64747



COPYRIGHT 2016 ADVANTEC GLOBAL INNOVATIONS. ALL RIGHTS RESERVED. CONFIDENTIAL PROPERTY OF ADVANTEC GLOBAL INNOVATIONS. UNAUTHORIZED USE, REPRODUCTION OR DISTRIBUTION IS STRICTLY PROHIBITED. COPIES REMAIN THE PROPERTY OF ADVANTEC GLOBAL INNOVATIONS AND MUST BE RETURNED UPON REQUEST.

CLIENT  
**FREEMAN MARINE**

PROJECT TITLE  
**1524 ALUMINUM RING**

DWG TITLE  
**RING: 1524 ALUMINUM**

SCALE	DRAWN	DATE	CHECKED	DATE	SIZE
1:4	GB	5/31/2023			B

S.O. NO	DWG NO	SHEET	REV
	2433-1002-01	1 of 1	00