

ITEM	QTY	PART NUMBER	LEGACY	DESCRIPTION	MATERIAL
1	1	104258	ES10-Z0111	PIN 17-4PH CHR 1INOD 4.8	17-4PH H1150 Cr ROD
2	2	105935	SM08-Z0102 \ SHAR-D0400	PIN-CAP 316 POL 1.5OD .188	316 Stainless
3	2	105168	FAST-FHS0010	SCRW 316 .25-20 .5 FSH A FP	316 STAINLESS
4	4	104274	ES10-Z0113 / SM08-Z0107	SPCR UHMW WH 1ID 1.5ODx.0626	UHMW PE - WHITE

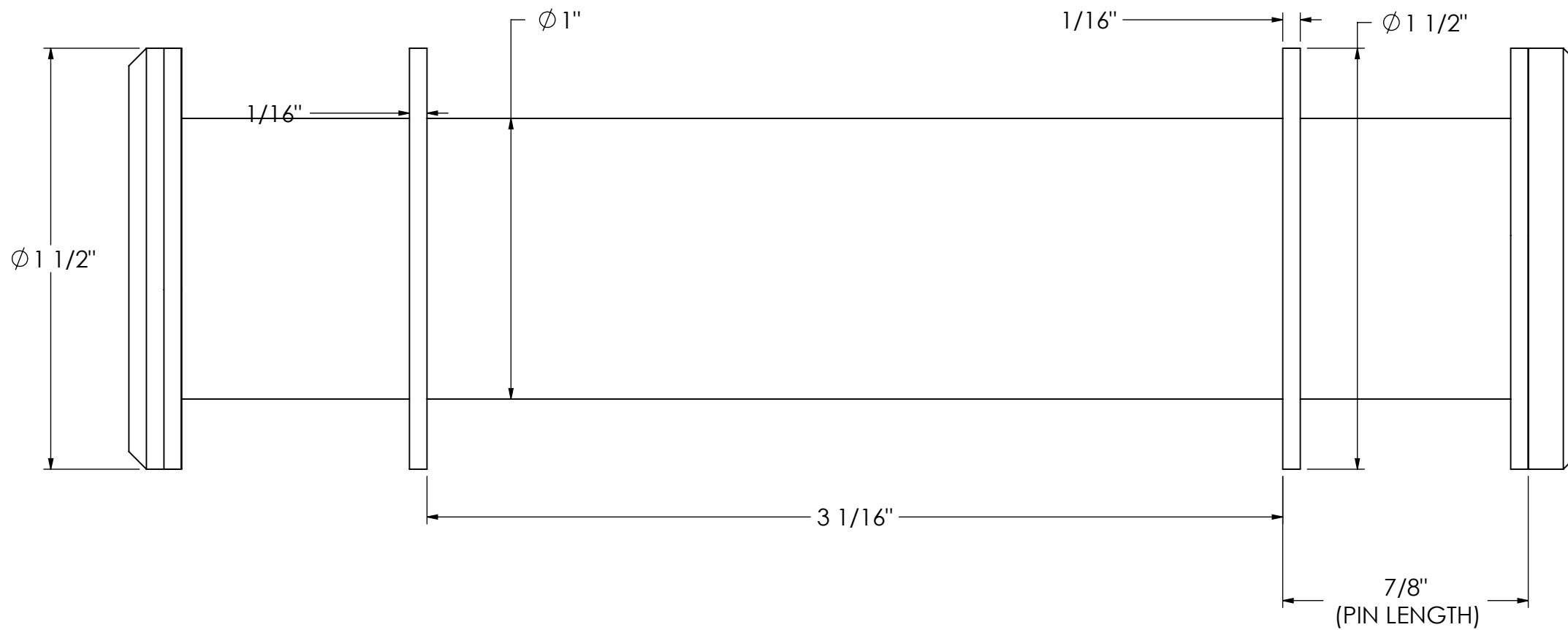
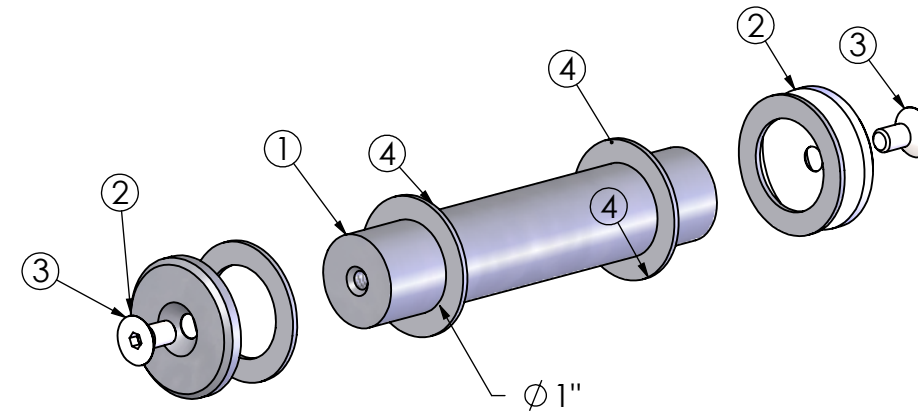

REVISIONS

REV.	DESCRIPTION	BY	DATE
00	EPDM MIGRATION RELEASE WITH VISUAL PART ID	DEC	2023-05-18

GENERAL NOTES

- REMOVE ALL BURRS AND BREAK SHARP EDGES AND CORNERS .75mm [.03in] MAX.

UNLESS OTHERWISE SPECIFIED, DIMENSIONS ARE IN INCHES. TOLERANCES FOR ROUGH AND CLEAR OPENINGS ARE ±3mm (.125"). ALL OTHERS ARE:

METRIC	X	.X	.XX	ANGLES
	±1.25	±.4	±.125	±1°
IMPERIAL	.X	.XX	.XXX	ANGLES
	±.03	±.015	±.005	±1°



COPYRIGHT 2016 ADVANTEC GLOBAL INNOVATIONS. ALL RIGHTS RESERVED. CONFIDENTIAL PROPERTY OF ADVANTEC GLOBAL INNOVATIONS. UNAUTHORIZED USE, REPRODUCTION OR DISTRIBUTION IS STRICTLY PROHIBITED. COPIES REMAIN THE PROPERTY OF ADVANTEC GLOBAL INNOVATIONS AND MUST BE RETURNED UPON REQUEST.

DWG TITLE: **ASSY 17-4PH ES10 PIN BB**

LEGACY: **ES10-Z0400**

SCALE	DRAWN	DATE	CHECKED	DATE	SIZE
1:1	G.R.	11/05/2007		1800-01-02	B
DWG NO: 114260				SHEET	REV
				1	00
				of	1