



User Manual

It's my pleasure to help you!



WARNING

TO PREVENT FIRE OR SHOCK HAZARD, DO NOT USE THIS PLUG WITH AN EXTENSION CORD, RECEPTACLE OR OTHER OUTLET UNLESS THE BLADES CAN BE FULLY INSERTED AND THERE IS NO BLADE EXPOSURE. TO PREVENT FIRE OR SHOCK HAZARD, DO NOT EXPOSE THIS APPLIANCE TO RAIN OR MOISTURE.

 <p>The lightning flash with arrow-head symbol, within an equilateral triangle is intended to alert the user to the presence of uninsulated 'dangerous voltage' within the product's enclosure that may be of sufficient magnitude to constitute a risk of electric shock to persons.</p>	<p>CAUTION RISK OF ELECTRIC SHOCK DO NOT OPEN</p> <p>WARNING: TO REDUCE THE RISK OF ELECTRIC SHOCK DO NOT REMOVE COVER (OR BACK). NO USER SERVICEABLE PARTS INSIDE. REFER SERVICING TO QUALIFIED SERVICE PERSONNEL.</p>	 <p>The exclamation point within an equilateral triangle is intended to alert the user to the presence of important operating and maintenance (servicing) instructions in the literature accompanying the appliance.</p>
--	--	---

IMPORTANT SAFETY INSTRUCTIONS

- 1.) Read these instructions. Keep these instructions. Follow all instructions. Heed all warnings.
- 2.) Do not use this apparatus near water.
- 3.) Clean only with dry cloth.
- 4.) Do not block any ventilation openings. Install in accordance with the manufacturer's instructions.
- 5.) Do not install near any heat sources such as radiators, heaters, stoves, or other apparatus (including amplifiers) that produce heat.
- 6.) Do not defeat the safety purpose of the polarized or grounding-type plug. A polarized plug has two blades with one wider than the other. A grounding type plug has two blades and a third grounding prong. The wide blade or the third prong is provided for your safety. If the provided plug does not fit into your outlet, ask an electrician for replace the obsolete outlet.
- 7.) Protect the power cord from being walked on or pinched particularly at plugs, convenience receptacles and the point where they exit from the apparatus.
- 8.) Only use attachments / accessories specified by the manufacturer.
- 9.) Unplug this apparatus during lightning storms or when unused for long periods of time.
- 10.) Refer all servicing to qualified service personnel. Servicing is required when the apparatus has been damaged in any way, such as power-supply cord or plug is damaged, liquid has been spilled or objects have fallen into the apparatus, the apparatus has been exposed to rain or moisture, does not operate normally or has been dropped.
- 11.) Use only with the cart, stand, tripod, bracket, or table specified by the manufacturer, or sold with the apparatus. When a cart is used, use caution when moving the cart / apparatus combination to avoid injury from tip-over.
- 12.) The AC adaptor must not be exposed to dripping or splashing and no objects filled with liquids, such as vases, shall be placed on apparatus.



- 13.) The AC plug is used as a disconnect device and it must remain readily accessible during intended use. In order to disconnect the apparatus from the AC power completely, the AC plug must be removed from the AC outlet completely.
- 14.) The battery must not be exposed to excessive heat such as sunshine, fire or the like.

CAUTION: Danger of explosion if battery is incorrectly replaced. Replace only with the same or equivalent type.

PREPARATION FOR USE

Unpacking and Set Up

- Remove the radio from the carton and remove all packing material from the radio. **Save the packing material, if possible, in case the radio ever needs to be serviced or transported. The original carton and packing material is the only safe way to pack your radio to protect it from damage in transit.**
- Remove any descriptive labels or stickers on the front or top of the cabinet. Do not remove any labels or stickers from the back or bottom of the cabinet.
- Note the serial number on the bottom of your radio and write this number in the space provided on the Warranty page of this manual.
- Place your radio on a level surface such as a table, desk or shell, convenient to an AC outlet, out of direct sunlight, and away from sources of excess heat, dirt, dust, moisture, humidity or vibration.
- Unwind the Line cord connecting the AC adapter and extend it to its full length.

Protect Your Furniture

This model is equipped with non-skid rubber feet to prevent the product from moving when you operate the controls. These "feet" are made from non-migrating rubber material specially formulated to avoid leaving any marks or stains on your furniture. However certain types of oil-based furniture polishes, wood preservatives, and cleaning sprays may cause the rubber "feet" to soften and leave marks or a rubber residue on the furniture. To prevent any damage to your furniture we strongly recommend that you purchase small self adhesive felt pads, available at hardware stores and home improvement centers everywhere, and apply these pads to the bottom of the rubber "feet" before you place the product on fine wooden furniture.

Power Source

This radio is designed to operate on normal AC Power Source. For North America, it works only under 120V 60Hz. For Europe, it works only under 220V-240V. Do not attempt to operate the radio on any other power source. You could cause damage to the radio that is not covered by your warranty. This radio should be connected to an AC outlet that is always "live". Do not connect it to an outlet that is controlled by a wall switch. When the power to the radio is interrupted, the built in lithium battery takes over to maintain the time and alarm settings. To maximize the life of the lithium battery keep the radio connected to a "live" outlet at all times.

IMPORTANT NOTES

- Avoid installing this unit in places exposed to direct sunlight or close to heat radiating appliances such as: electric heaters, on top of other stereo equipment that radiates heat, places lacking ventilation, dusty areas, places subject to constant vibration and/or humid or moist areas.
- Operate controls and switches as described in the manual.
- Before turning on the power, make certain that the AC adapter is properly installed.
- When moving the set, be sure to first disconnect the AC adapter.

LOCATION OF CONTENTS AND INDICATORS

FRONT PANEL

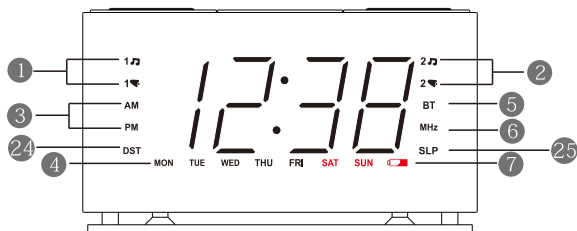

TOP PANEL

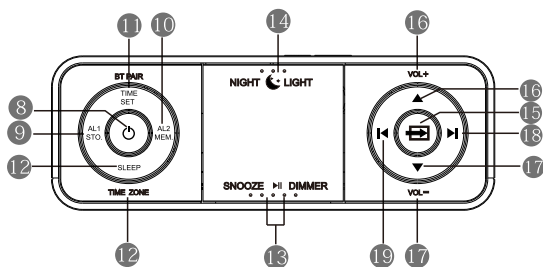

BACK PANEL

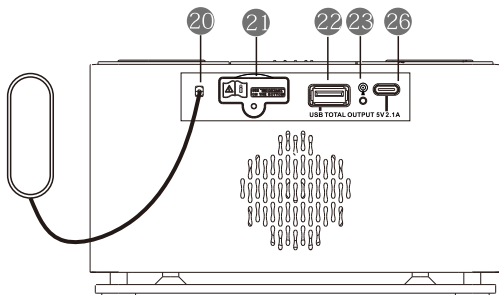

- | | |
|---|---|
| 1. ALARM 1 Radio 🎵 /Buzzer 📢 Indicator | 15. SOURCE Button |
| 2. ALARM 2 Radio 🎵 /Buzzer 📢 Indicator | 16. VOLUME+ ▲ Button |
| 3. AM/PM Indicator | 17. VOLUME- ▼ Button |
| 4. DAY OF WEEK Indicator | 18. SET/TURN ► Button |
| 5. BLUETOOTH(BT) Indicator | 19. SET/TURN ◀ Button |
| 6. MHZ Indicator | 20. AC Adapter |
| 7. LOW BATTERY Indicator | 21. BACKUP BATTERY
COMPARTMENT
(located on back of unit) |
| 8. POWER Button | 22. USB CHARGING Port |
| 9. ALARM 1/STORE Button | 23. FM ANTENNA |
| 10. ALARM 2/MEMORY Button | 24. DST Indicator(Dst Start) |
| 11. TIME SET Button / BT PAIR | 25. SLP Indicator(Sleep on) |
| 12. SLEEP/TIME ZONE Button | 26. USB Type C charging Port |
| 13. ► SNOOZE/DIMMER Button | |
| 14. NIGHT LIGHT Button | |

SETTING THE TIME ZONE

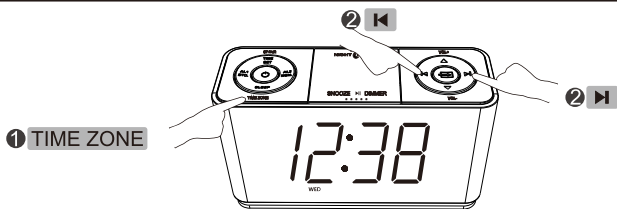

1. Press and hold "TIME ZONE" for 2 seconds, the "HOUR" digits on the display will blink.

2. Press "◀" or "▶" to adjust the hour to your desired time zone.

Note: Time Zone and clock setting can only be adjusted when the radio and Bluetooth function are disabled (MHz and BT indicators are OFF).

Daylight Saving Time Setting

This clock was preset Auto DST(Daylight Saving Time) for different countries as below:

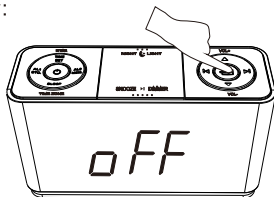

PRODUCT CODE	DISPLAY INDICATION	AREA
DE	d EU	Europe
NA	d US	America/Canada
UK	d En	United Kingdom
AU	d AU	Australia
CO	d Co	Mexico
JP	d JP	Japan

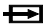
- Once the product RESET (factory setting) becomes, the product needs to set DST before reuse. This DST setting can be set in the Time Setting, the setting of hour, minute, month, day, year and 12/24 hours and DST, and this method can be available only in this condition.
- You can also set the DST Time area by long press the  button until the DST words (OFF/d-EU/d-US/d-En/d-AU/d-Co/d-JP) flashes, then by short press the **▲ VOL+** / **▼ VOL-** button to switch to your local DST. (OFF is for Turn off DST; EU is for Europe; US is for United States or Canada; En is for The United Kingdom; AU is for Australia; Co is for Mexico; JP is for Japan)

SETTING THE TIME

(Turn off the clock display before setting the time)

Check the Current Time
Time / Month / Day / Year

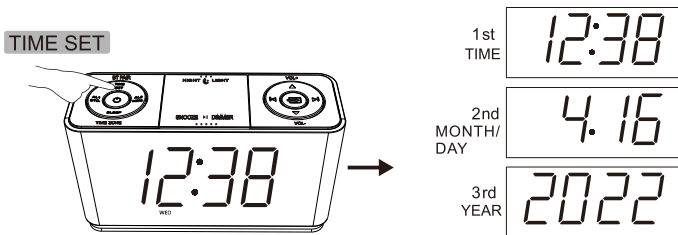

To check the current time and date, short press "TIME SET" repeatedly and the "MONTH/ DAY/ YEAR" digits will appear on the display.

Setting the Time Manually

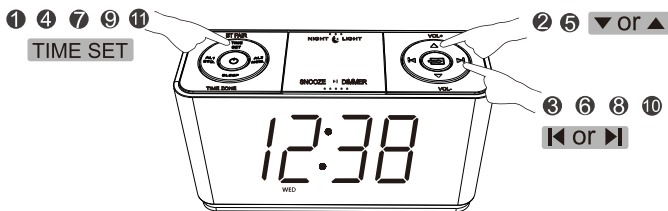

Time → Month/Day → Year

- ① Press and hold "TIME SET" until the "HOUR and MINUTE" digits blink.
- ② Press "▼" or "▲" to adjust the minute.
- ③ Press "◀" or "▶" to adjust the hour.
- ④ Press "TIME SET" again, the "MONTH /DAY" digits will blink.
- ⑤ Press "▼" or "▲" to adjust the day.
- ⑥ Press "◀" or "▶" to adjust the month.
- ⑦ Press "TIME SET" again, the "YEAR" digits will blink.
- ⑧ Press "◀" or "▶" to adjust the year.
- ⑨ Press "TIME SET" again, the "H12" digits will blink.
- ⑩ Press "◀" or "▶" to choose H12 or H24.
- ⑪ Press "TIME SET" again or wait for 40 seconds to return to the clock display.

SETTING THE ALARM

(Turn off the clock radio before setting the alarm)

Your clock radio has two separate alarms (Alarm 1 and Alarm 2) that can be set and used independently. Please ensure that you have set the wakeup time(s) and alarm day(s) correctly.

- 1 / 2 Wake to Radio
- 1 / 2 Wake to Buzzer

If you choose the standard time (H12), if the PM indicator is ON, it means afternoon. If AM indicator is ON, it means before noon.

SETTING ALARMS FOR THE DAY(S) OF THE WEEK

- **EVERYDAY** : Monday to Sunday
- **WEEKDAYS** : Monday to Friday
- **WEEKENDS** : Saturday and Sunday
- **SINGLE DAY**: Monday/Tuesday/
Wednesday/Thursday/Friday/
Saturday/Sunday

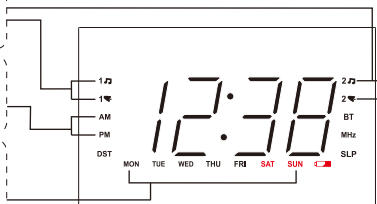

Setting the Wakeup Alarms



- ① Press "AL1/STO." repeatedly to select your alarm ringtone:
When "1🔊" is on the display, Alarm 1 (Wake to Buzzer) is turned on.
When "1🎵" is on the display, Alarm 1 (Wake to Radio) is turned on.
If both "1🔊" and "1🎵" disappear on the display, Alarm 1 is completely turned off. After selecting your desired alarm ringtone,
- ② Press and hold "AL1/STO." for 2 seconds and the "HOUR and MINUTE" digits will blink.
- ③ Press "▼" or "▲" to adjust the minute.
- ④ Press "◀" or "▶" to adjust the hour.
- ⑤ Press the "AL1/STO." button again, and the "CURRENT VOLUME LEVEL" digits will blink. The volume levels range from 1 to 15, with level 15 being the loudest. (applicable only for wake to Radio mode)
- ⑥ Press "▲/▼/◀/▶" to adjust to your desired alarm volume level.
- ⑦ Press the AL1/STO. button again, and the "DAY (S) OF THE WEEK" texts (MON...SUN) will blink
- ⑧ Press "▲/▼/◀/▶" to select the day(s) of the week needed for the alarm.
- ⑨ Press "AL1/STO." or wait for 40 seconds to finish the alarm setting.

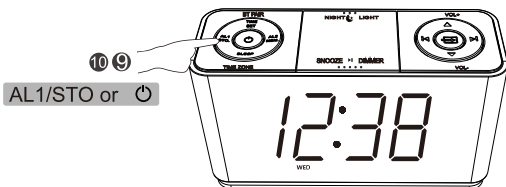

- ⑩ When the alarm goes off, press "AL1/STO." or "⏻" to turn off the alarm. Please follow the above steps for setting the Alarm 2 (by pressing "AL2/MEM.")
When the alarm goes off, it begins with the minimum volume and gradually increases to your preset alarm volume.

SNOOZE/REPEAT/STOP THE ALARM

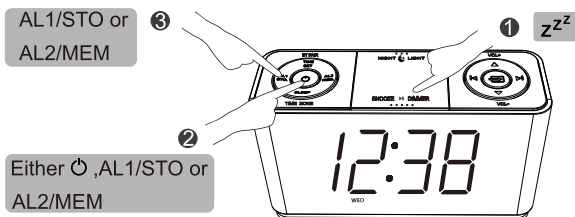

- 1 When the alarm goes off, you can press "zzz" to doze for another 9 minutes. Press "zzz" again to further doze for another 9 minutes and you can repeatedly press "zzz" for more dozings during the 60-minute snooze cycle.
 - 2 When the alarm goes off, press " \odot ", "AL1/STO." or "AL2/MEM." to turn off the alarm (AL1 for Alarm 1 and AL2 for Alarm 2). The alarm will sound again when it is required again.
 - 3 To completely deactivate the alarm, press "AL1/STO." or "AL2/MEM" until all the alarm indicators disappear from the display.
- Note: If no operation is performed while the alarm is sounding, the alarm will stop after 60 minutes.**

PLAYING THE RADIO

Keep the clock radio away from other electronic devices to avoid radio interference. For better reception, fully extend and adjust the position of the antenna.

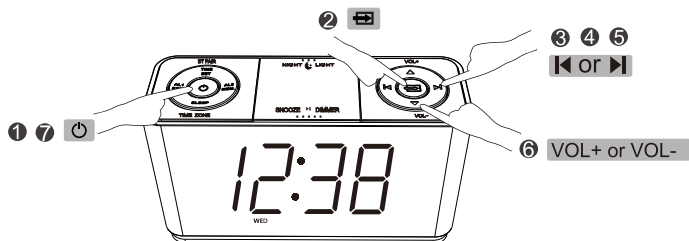

- 1 Press " \odot " to turn on the clock radio.
- 2 Press " FM " to switch to the radio mode, which will be the last radio station setting, and the "MHz" digits will appear on the display.
- 3 Press " \ll " or " \gg " to adjust the radio frequency.
- 4 Press and hold " \ll " or " \gg " for auto-search. The search will stop at the next available lower or higher station.

- ⑤ Keep pressing "**◀**" or "**▶**" will speed up the search and it will not stop until you release the button.
- ⑥ While listening to your desired station, you can press "**VOL-**" or "**VOL +**" to adjust the radio volume level.
- ⑦ When you turn off the radio (by pressing "**⏻**"), the last station you listened to will be your wake-to-radio station.

Storing Radio Station Presets (Max. 20 presets)

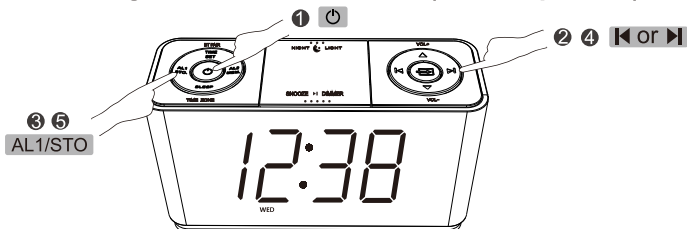

There are 20 station presets that can be stored on the radio clock.

- ① Press "**⏻**" to turn on the clock radio and press "**📻**" to switch to the radio mode.
 - ② Search your desired station by pressing "**◀**" or "**▶**"
 - ③ Press "**AL1/STO.**" until the "**PROGRAM NUMBER**" (from P01 to P20) blinks.
 - ④ Press "**◀**" or "**▶**" to select the desired Program Number.
 - ⑤ Press "**AL1/STO.**" again and the desired station will be stored under the desired Program Number.
- Repeat the above steps 1-5 to store additional stations as presets.

Recalling Preset Radio Stations

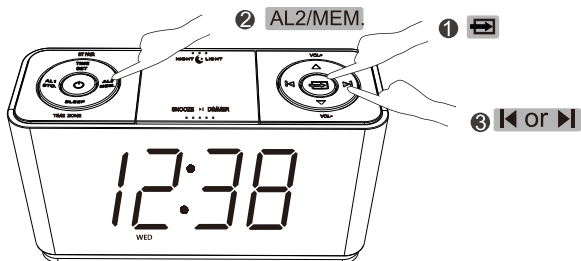

- ① Press "**⏻**" to turn on the clock radio and press "**📻**" to switch to the radio mode.
- ② Press "**AL2/MEM.**" once and the Program Number will appear on the display.
- ③ Press "**◀**" or "**▶**" repeatedly to select your desired preset station.

USING THE SLEEP TIMER

You can fall asleep to the radio using the sleep timer, which is set up in 10-minute increments (The sleep timer duration ranges from 10 minutes to 90 minutes). After reaching the desired duration, the radio will turn off automatically.

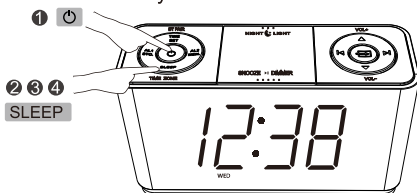

- 1 Press " ⏻ " to turn on the clock radio.
- 2 Press "SLEEP" and the "10" digit will appear on the display which indicates the sleep timer has been set for 10 minutes.
- 3 To change the sleep timer duration, keep pressing "SLEEP" until your desired duration appears.
- 4 To deactivate the sleep timer, keep pressing "SLEEP" until "OFF" appears on the display, or press " ⏻ " to turn off the sleep timer directly.

BLUETOOTH CONNECTION

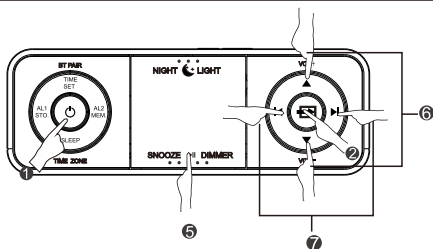

- 1 Press the " ⏻ " button to turn on the clock.
- 2 Press the " → " button to switch the function mode to BT (Bluetooth).
- 3 The "BT" sign blinks means searching is on from the clock. Please turn on the Bluetooth of your external audio devices and look for **CKS507**, then connect. Once connected, the "BT" sign will stop blinking. Then you can play the music source from your external audio device through the clock speaker.
- 4 You can control the music playing on either your audio device or the clock.
- 5 Press the "SNOOZE/ ▶||" button to Play/Pause.
- 6 Press "▼"/VOL- or "▲"/VOL+ button to adjust the volume level of the music.

⑦ Press "▶" or "◀" button to play previous or next.

Note: If pairing unsuccessful, all previously paired Bluetooth devices around should be disconnected first by pressing and holding the **BT PAIR/TIME SET** button until it prompts, or turn Off their Bluetooth connection, in order to avoid making any auto reconnection between them. Then, set this unit to Bluetooth mode, and tap the Bluetooth switch on your phone/device Off and back 'On' again to refresh/ search any nearby **CKS507** for pairing.

5-LEVELS OF DIMMER CONTROL

To adjust the display brightness, keep "▶|| SNOOZE/DIMMER Button" desired brightness level appears. Brightness is available in 5 levels and can be adjusted even when the radio connection is in use.

Press "▶|| SNOOZE/DIMMER Button" button, you can adjust the brightness level as below:

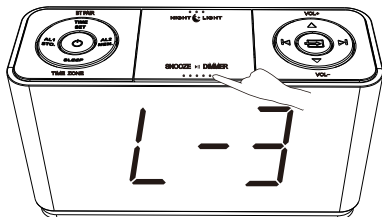

Highlighted

L-3

Medium

L-2

Low dark

L-1

OFF

OFF

Automatic
recognition brightness

-AU-

NIGHTTIME LED

Press 

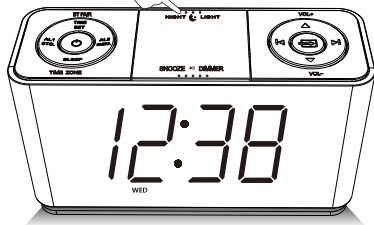

The clock has a nighttime LED built in the bottom of the clock. You can press "☾" button to adjust the brightness of nighttime LED in the dark.

The nighttime LED has 3 brightness "OFF/HIGH/LOW" ."

USB CHARGING PORT

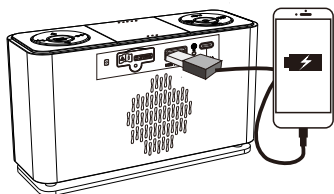

This clock radio has two USB charging port in the back, include a TYPE-C port, which can provide up to 5V 2.1A to charge devices like smart phone, tablet etc. via a USB cable (not provided).

Note: Electrical energy drawn from the USB port may vary due to different charging cable condition, battery characteristic or power management system of your device being charged.

CHANGING THE LITHIUM BATTERY

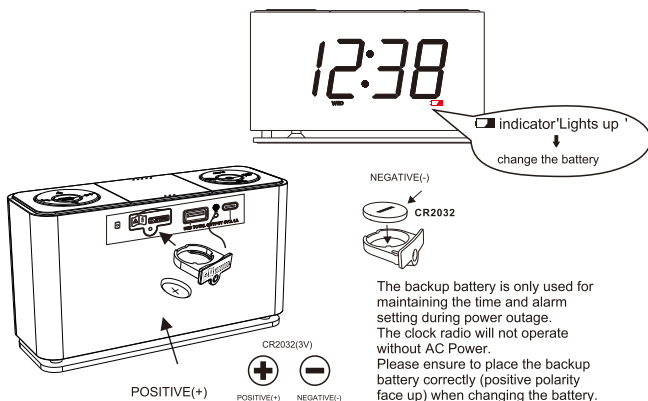

The backup battery is only used for maintaining the time and alarm setting during power outage. The clock radio will not operate without AC Power. Please ensure to place the backup battery correctly (positive polarity face up) when changing the battery.

WARNING

DANGER OF EXPLOSION IF BATTERY IS INCORRECTLY REPLACED.
REPLACE ONLY WITH THE SAME OR EQUIVALENT TYPE.
DO NOT INGEST BATTERY,CHEMICAL BURN HAZARD

This product contains a coin/button cell battery.If the coin/button cell battery is swallowed,it can cause severe internal burns in just 2 hours and can lead to death.

Keep new and used batteries away from children.If the battery compartment does not close securely,stop using the product and keep it away from children.

If you think batteries might have been swallowed or placed inside any part of the body,seek immediate medical attention.

CARE AND MAINTENANCE

Care of Cabinets

If the cabinet becomes dusty, wipe it with a soft cloth. If the cabinet becomes smudged or dirty, clean it with a soft, slightly dampened cloth. Never allow water or any liquid to get inside the cabinet. Never use any abrasive cleaners or cleaning pads as these will damage the finish of your radio.

Lithium Battery Precautions

- Dispose of the old battery properly. Do not leave it lying around where a young child or pet could play with or swallow it. If the battery is swallowed, contact a physician immediately.
- The battery may explode if mistreated. Do not attempt to recharge it or disassemble it. Do not dispose of the old battery in a fire.

The apparatus must not be exposed to dripping or splashing and objects filled with liquids, such as vases, must not be placed on the apparatus.

This marking indicates that this product should not be disposed of with other household wastes throughout the country. To prevent possible harm to the environment or human health from uncontrolled waste disposal, recycle this unit responsibly so as to promote the re-use of material resources. To return your used device, please use return and collection systems or contact the retailer where the product was purchased as they know how to safely recycle this product.



FCC WARNING

FCC PART 15.19 WARNING STATEMENT

THIS DEVICE COMPLIES WITH PART 15 OF THE FCC RULES. OPERATION IS SUBJECT TO THE FOLLOWING IWO CONDITIONS:

- (1)THIS DEVICE MAY NOT CAUSE HARMFUL INTERFERENCE. AND
- (2)THIS DEVICE MUST ACCEPT ANY INTERFERENCE RECEIVED, INCLUDING INTERFERENCE THAT MAY CAUSE UNDESIRED OPERATION.

FCC PART 15.21 WARNING STATEMENT

NOTE: THE GRANTEE IS NOT RESPONSIBLE FOR ANY CHANGES OR MODIFICATIONS NOT EXPRESSLY APPROVED BY THE PARTY RESPONSIBLE FOR COMPLIANCE. SUCH MODIFICATIONS COULD VOID THE USER'S AUTHORITY TO OPERATE THE EQUIPMENT.

FCC Part 15.105 Warning Statement

Note: This equipment has been tested and found to comply with the limits for a Class B digital device, pursuant to part 15 of the FCC Rules. These limits are designed to provide reasonable protection against harmful interference in a residential installation. This equipment generates, uses and can radiate radio frequency energy and, if not installed and used in accordance with the instructions, may cause harmful interference to radio communications. However, there is no guarantee that interference will not occur in a particular installation. If this equipment does cause

harmful interference to radio or television reception, which can be determined by turning the equipment off and on, the user is encouraged to try to correct the interference by one or more of the following measures:

- Reorient or relocate the receiving antenna.
- Increase the separation between the equipment and receiver.
- Connect the equipment into an outlet on a circuit different from that to which the receiver is connected.
- Consult the dealer or an experienced radio/TV technician for help.

RF warning statement:

The device has been evaluated to meet general RF exposure requirement. To maintain compliance with FCC's RF exposure guidelines, this equipment should be installed and operated with a minimum distance of 20cm between the radiator and your body.

iTOMA **1-Year Limited Warranty**

iTOMA (Hong Kong) Company Limited (iTOMA) warrants to be original consumer of this iTOMA product that it will furnish a replacement for, or, at its sole option, repair any part which proves (upon inspection by iTOMA) to be defective under normal use within 1 year of the original purchase date.

This warranty does not apply to appearance items, including, but not limited to, antennas, knobs, cabinets, or cases, and in the case of batteries, for damage caused by leaking batteries. It also does not apply to the product, or to any part thereof, that has been damaged through misuse or negligence.

Furthermore, this warranty will become invalid if, in the judgment of iTOMA the product or any part thereof has been installed incorrectly, repaired or altered by other than iTOMA Service Department.

This warranty gives you specific legal rights and you may also have other rights which vary from state to state. Some states do not allow the exclusion or limitation of incidental or consequential damages or limitations on how long an implied warranty lasts, so the above exclusions and limitation may not apply to you.

For Service, Warranty, or Product Information,
Please contact iTOMA (Hong Kong) Company Limited,
info@itoma.com

**PLEASE SAVE THIS CARD TOGETHER WITH ORIGINAL DATED PROOF
OF PURCHASE FOR YOUR RECORDS AND FOR CUSTOMER SERVICE.**