

## Base Preparation

### I. GENERAL INFORMATION

The **GenieMat** line of products for impact sound insulation is engineered to provide better performance than any other sound control product available, and has been rigorously tested to achieve proven results. Made from up to 94% recycled rubber content and backed by over 100 independent laboratory and field tests, **GenieMat** has been selected and used in some of the best hotels and condominiums in the world.

With the use of **GenieMat FAS**, **GenieMat FAS2**, and **GenieMat FASHM** adhesives, it can be installed under a variety of floor finishes and coverings, including nail-down and floating hardwood, engineered wood, and laminate, ceramic, stone, porcelain, and marble tile, luxury vinyl tile (LVT), vinyl sheet, plank, and tile and carpet, in wood, steel, and concrete construction. All floor covering assemblies shall have prior approval before installation.

### II. JOB SITE CONDITIONS

Areas to receive **GenieMat** should be weather tight and maintained at minimum, a constant room temperature between 65°F - 95°F (18°C - 35°C) for 48 hours before, during, and after installation.

### III. SUBFLOOR REQUIREMENTS AND PREPARATION

**NOTE:** Please follow the subfloor requirements and preparation recommendations determined by the flooring manufacturer. Use the following subfloor requirements and preparation guidelines only when no such recommendations exist for the floor finishing product.

1. All subfloors/substrates must be inspected prior to installation.
2. Install **GenieMat** over wood, concrete, and approved self-levelling materials.
3. Wood subfloors should be double construction with a minimum thickness of one inch. The floor must be rigid and free from movement with a minimum of 18 inches of well-ventilated air space below.
4. Wood subfloors (when installed with use of grouted floor coverings like tile) must be prepared according to ANSI L/360 standards, as required by the floor covering manufacturer.
5. Concrete floors must be fully cured and permanently dry. Subfloor shall be dry, clean, smooth, level, and structurally sound. It should be free of dust, solvent, paint, wax, oil, grease, asphalt, sealers, curing and hardening compounds, alkaline salts, old adhesive residue, and other extraneous materials, according to ASTM F710.
6. Subfloor should be smooth to prevent irregularities, roughness, or other defects from affecting the material above it. The surface should be flat to the equivalent of 3/16" in 10', as described in ACI 117R, or as recommended by the floor manufacturer.

7. Mechanically remove all traces of old adhesives, paint, or other debris by scraping, sanding, or scarifying the substrate. DO NOT use solvents.
8. Grind high spots until level and fill low spots with an approved leveling compound.
9. All saw cuts (control joints), cracks, indentations, and other non-moving joints in the concrete must be filled with an approved patching/levelling compound. Allow patching material to dry thoroughly.
10. Any concrete subfloor can be a source of moisture-related flooring failures. It is the installer's responsibility to test the concrete or other cement-like material for moisture.
11. Maximum moisture vapor emission of the concrete must not exceed 5 lbs/1,000 ft<sup>2</sup> in a 24-hour period, as measured by the calcium chloride test method in accordance with the ASTM F1869 standard. If vapor emissions exceed acceptable limits, **GenieMat FASHM** adhesive must be used for conditions up to 10 lbs/1,000 ft<sup>2</sup> in 24 hours, or a **Pliteq** recommended vapor retardant must be used.
12. Maximum relative humidity must not exceed 85% RH, as measured by the relative humidity test method in accordance with the ASTM F2170 standard. If relative humidity exceeds acceptable limits, **GenieMat FASHM** adhesive must be used for conditions up to 90% RH, or a **Pliteq** recommended vapor retardant must be used.

#### IV. HAZARDS

##### A. SILICA WARNING

Concrete, floor patching compounds, toppings, and levelling compounds can contain free crystalline silica. Cutting, sawing, grinding, or drilling can produce respirable crystalline silica (particles 1-10 micrometers). Respirable silica is classified by OSHA as a 1A carcinogen and is known to cause respiratory diseases like silicosis. Avoid actions that cause dust to become airborne. Use local or general ventilation or protective equipment to reduce exposure below applicable exposure limits.

##### B. LEAD WARNING

Certain paints may contain lead. Exposure to excessive amounts of lead dust presents a health hazard. Refer to applicable federal, state, and local laws and the publication, *Lead Based Paint: Guidelines for Hazard Identification and Abatement in Public and Indian Housing*, available from the United States Department of Housing and Urban Development.

##### C. ASBESTOS WARNING

Resilient flooring, backing, lining felt, paint, or asphaltic "cutback" adhesives could contain asbestos fibers. Avoid actions that cause dust to become airborne. DO NOT sand, dry sweep, dry scrape, drill, saw, beadblast, mechanically chip, or pulverize. Regulations may require that the material be tested to determine asbestos content. Consult the documents titled, *Recommended Work Practices for Removal of Existing Resilient Floor Coverings*, available from the Resilient Floor Covering Institute.

### V. MATERIAL STORAGE AND HANDLING

1. Deliver the material to the job site in its original unopened packaging with all labels intact and stored appropriately to prevent damage.
2. Inspect all material for visual defects before beginning the installation. **Pliteq** will honor no labor claim on material installed with any visually apparent defects.
3. Verify the material delivered is the correct type, thickness, and amount. Report any discrepancies immediately.
4. The material and any adhesive must be acclimated at room temperature for a minimum of 24 hours before starting the installation.
5. Roll material is stretched slightly when it is rolled at the factory. At the job site, the installer should allow all cuts to relax before gluing down. Shaking the material once it is unrolled can help it to relax more quickly.

## Products

### I. GenieMat<sup>®</sup> PMI

#### A. DESCRIPTION

Flat, resilient, single-ply white polyethylene foam perimeter isolation strip that is used to build a tub around the floor so that no hard floor covering surface touches any hard vertical surface (protrusion or wall).

#### B. APPLICATION

Attached at the base of the perimeter wall of the entire subfloor, as well as the perimeter of any protrusions, prior to unrolling and installing **GenieMat** products, in order to isolate or break the vibration transmission path between the floor and the wall.

### II. GenieMat<sup>®</sup> RST

#### A. DESCRIPTION

Robust reduced sound transmission mat made from 94% recycled rubber content used when superior sound control is required in multifamily housing, high-rises, or commercial buildings. It is available in rolls and five nominal thicknesses - 2mm, 5mm, 10mm, 12mm, and 15mm. Custom sizes and thicknesses are available upon request.

#### B. APPLICATION

Used directly under a variety of floor coverings in wood, steel, and concrete construction, yielding exceptional results for impact sound insulation and substrate crack prevention.

### III. GenieMat® RSTPS

#### A. DESCRIPTION

Robust reduced sound transmission mat made from 94% recycled rubber content laminated with an adhesive layer used when superior sound control is required in multifamily housing, high-rises, or commercial buildings. It is available in rolls and nominal thicknesses of 2mm and 5mm.

#### B. APPLICATION

Use either adhesive side up or adhesive side down directly underneath a variety of floor coverings in wood, steel and concrete construction, yielding exceptional results for impact sound insulation and substrate crack prevention.

### IV. GenieMat® FAS

#### A. DESCRIPTION

**GenieMat FAS** is a high-solids, cross-linking, amide-ester-acrylate-resin blend adhesive. It is solvent-free, non-flammable, has low-odor and low-VOC content, contains no hazardous chemicals as per OSHA Regulation CFR 1910.1200, and meets all federal, state, and local government indoor air quality regulations. This specially formulated adhesive has good early strength buildup for immediate grab and gradually builds into a tenacious but resilient bond as the chemicals in the adhesive cross-link.

#### B. APPLICATION

**GenieMat FAS** is used for bonding **GenieMat** sound control underlayments to various subfloors/substrates, and for bonding specified wood finish floors to **GenieMat** sound control underlayments.

### V. GenieMat® FAS2

#### A. DESCRIPTION

**GenieMat FAS2** is a cross-linking, pressure-sensitive, amide-ester-acrylate-resin blend adhesive. It is solvent-free, non-flammable, has low-odor, demonstrates excellent water and alkali resistance, features high aggressive peel strength and shear strength, and is very quick to use and easy to trowel. This specially formulated adhesive has plasticizer migration resistance that allows installation of a broad variety of vinyl floor products.

#### B. APPLICATION

**GenieMat FAS2** is used for bonding **GenieMat** sound control underlayments to various subfloors/substrates, and for bonding all specified finish floors and coverings, including vinyl floor products, to **GenieMat** sound control underlayments.

### VI. GenieMat® FASHM

#### A. DESCRIPTION

For Your Project Specific Questions

T. 416.449.0049 | E. [info@pliteq.com](mailto:info@pliteq.com)

© Pliteq Inc. 2020  
®™ Trademarks of Pliteq Inc. The information provided is accurate to the best of our knowledge at the time of issue. However, we reserve the right to make changes when necessary without further notification. Suggested application may need to be modified to conform with local building codes and conditions. We cannot accept responsibility for products that are not used, or installed, to our specifications. All listed dimensions are nominal. 09.2020

**GenieMat FASHM** is a one-component, 100% solids, cross-linking, modified silane polymer-based adhesive. It is solvent-free, water-free, and isocyanate-free, non-flammable, has low-odor, negligible VOC content, contains no hazardous chemicals as per OSHA Regulation CFR 1910.1200, and meets all federal, state, and local government indoor air quality regulations. This specially formulated adhesive is a Class 1 vapor barrier, features extremely low-permeability ratings, withstands maximum moisture levels of 10 lbs and 90% RH, and is unaffected by concrete slab alkalinity, has good early strength buildup for immediate grab and gradually builds into a tenacious but resilient bond as the chemicals in the adhesive cross-link, and plasticizer migration resistance that allows installation of a broad variety of vinyl floor products.

### B. APPLICATION

**GenieMat FASHM** is used in high-moisture applications for bonding **GenieMat** sound control underlayments to various subfloors/substrates, and for bonding specified finish floors and coverings to **GenieMat** sound control underlayments.

## Installation

### I. GenieMat PMI

#### A. GenieMat PMI INSTALLATION

1. Attach **GenieMat PMI** perimeter isolation strip to the base of the perimeter wall of the entire subfloor, as well as the perimeter of any protrusions (see *Diagram #1*).

Diagram #1

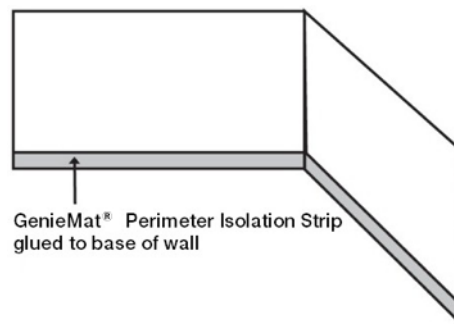

### II. GenieMat RST

#### A. GenieMat RST INSTALLATION

1. Unroll and place **GenieMat RST** underlayment perpendicular to subsequent installation direction of finished floor (see *Diagram #2*).
2. Trim ends of each section to fit floor surface area.

3. Align lengthwise edges of underlayment with neighboring sheets by butting up or overlapping them.
4. Determine whether installation will be floating floor or glue-down and follow the corresponding instructions.

Diagram #2

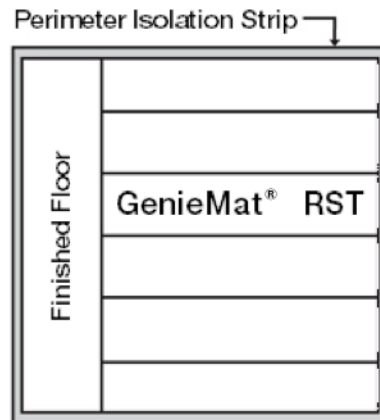

### B. FLOATING FLOOR INSTALLATION

1. Use duct tape or high-quality carpet tape to secure butt joints and seams, and prevent underlayment from moving.
2. Proceed to Finished Floor Installation.

### C. GLUE-DOWN INSTALLATION

1. Fold the first sheet of underlayment halfway lengthwise.
2. Spread adhesive using the appropriate notch trowel and **GenieMat FAS adhesive** (refer to **GenieMat FAS** product spec guide). For alternative adhesives and thinsets, refer to the Recommended Products section on page 9.
3. Carefully lay underlayment into wet adhesive.
4. Fold over second half of first sheet and first half of second sheet.
5. Spread adhesive perpendicular to seam (see *Diagram #3*).
6. Continue this process for each consecutive sheet.
7. Use a 30 to 50 lb roller over sheets to ensure proper transfer of adhesive.
8. Provide enough time to allow adhesive to set before installing finished floor.

Diagram #3

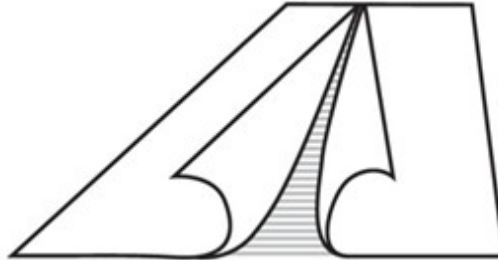

#### D. VINYL FLOOR COVERING INSTALLATION

**NOTE:** Follow the flooring manufacturer's directions for the installation of vinyl floor coverings. Seek **Pliteq** approval before using their recommended adhesives, procedures, and equipment.

1. Install self-locking floors, such as vinyl plank, over **GenieMat RST** following the flooring manufacturer's recommendations.
2. Adhere all other vinyl sheet, plank, or tile flooring goods directly to **GenieMat RST** using **GenieMat FAS**, **GenieMat FAS2**, or **GenieMat FASHM** adhesive, depending on the application. Follow instructions on the adhesive pail or those available from **Pliteq** or the flooring manufacturer.
3. When the flooring installation is complete, trim any excess **GenieMat** material so that it is flush with the surface of the floor covering.

### III. GenieMat RSTo2PS

#### A. ADHESIVE SIDE UP INSTALLATION

1. Unroll GenieMat RSTPS with the liner facing up and cut to desired length, placing rolls perpendicular to subsequent finished floor.
2. Trim ends of each section to fit floor surface area.
3. Align edges of underlayment with neighboring sheets by butting them up.
4. Peel up the liner approximately 1 tile length at a time and fold down. Install vinyl planks the entire width. Peel up next section of liner and repeat.
5. Once the entire floor has been installed, use a floor roller to activate pressure sensitive cure (100lbs). Apply even and consistent pressure throughout the installed area.

#### B. ADHESIVE SIDE DOWN INSTALLATION

1. Peel back the liner approximately 12”.
2. Place the exposed adhesive down to anchor the **GenieMat RSTPS**, ensure the edges are butted up tight to adjacent underlayment.
3. Pull the liner as you unroll the rest of the mat in place.
4. Trim perimeter as necessary.
5. Use a floor roller (100lbs) over top the **GenieMat RSTPS**. Install finish flooring.

## IV. FINISHED FLOOR

### A. FINISHED FLOOR INSTALLATION

1. Install all finished floors according to manufacturer’s recommendations.
2. If installing a floating finished floor, interlock or glue planks together without gluing the planks to the underlayment.
3. If the manufacturer recommends installation of plywood or cement board between the underlayment and finished floor, adhere the board to the underlayment.
4. DO NOT nail or screw through the underlayment.
5. Adhere all finished floors using appropriate notch trowel and **GenieMat FAS** adhesive (refer to **GenieMat FAS** data sheets).
6. Alternative adhesives recommended by manufacturer shall be pre-approved by **Pliteq** Technical Services.
7. Install grouted flooring materials in a thin or thick-set mortar bed applied directly over underlayment.
8. Tile and stone sizes smaller than 4” x 4” shall be pre-approved by **Pliteq** Technical Services.

## V. BASEBOARD

### A. BASEBOARD INSTALLATION

1. Trim excess **GenieMat PMI** perimeter isolation strip flush or below the surface of the finished floor or vinyl floor covering (see *Diagram #4*).
2. Install baseboard to wall 1/4" minimum above **GenieMat PMI** and floor surface (see *Diagram #4*).
3. Seal entire perimeter with acoustical sealant.

Diagram #4



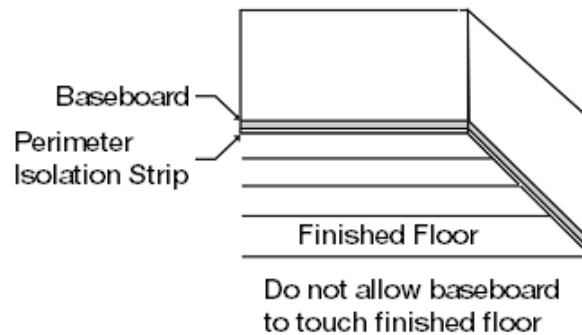

## Recommended Products

**NOTE:** All materials shall be delivered to the job site in the original containers with the manufacturer's identification on each package. Unauthorized modification to any product is not permitted. The following materials are listed because of their extensive testing and field experience with **GenieMat** products. If you would like us to evaluate any materials as alternatives, call **Pliteq** Technical Services at (416) 449-0049.

### I. FLOOR ADHESIVES

- A. **GenieMat FAS, GenieMat FAS2, GenieMat FASHM**
- B. Taylor 2071
- C. Taylor Pinnacle<sup>®</sup>
- D. Taylor Resolute<sup>®</sup>
- E. Bostik's BEST<sup>®</sup>
- F. Henry<sup>®</sup> 971 PlankPro<sup>™</sup>

### II. THIN-SET MATERIALS

- A. Laticrete<sup>®</sup> 253 Gold
- B. Laticrete 254 Platinum
- C. Bostik Single-Flex<sup>®</sup>
- D. ARDEX FB 9 L<sup>™</sup>

### III. GROUT MATERIALS

- A. Laticrete PERMACOLOR<sup>®</sup> Grout
- B. Laticrete SPECTRALOCK<sup>®</sup> Grout
- C. Bostik Hydroment<sup>®</sup> Grout

For Your Project Specific Questions

T. 416.449.0049 | E. [info@pliteq.com](mailto:info@pliteq.com)

© Pliteq Inc. 2020  
<sup>®</sup>™ Trademarks of Pliteq Inc. The information provided is accurate to the best of our knowledge at the time of issue. However, we reserve the right to make changes when necessary without further notification. Suggested application may need to be modified to conform with local building codes and conditions. We cannot accept responsibility for products that are not used, or installed, to our specifications. All listed dimensions are nominal. 09.2020

D. ARDEX Flex Grout

#### IV. ACOUSTICAL SEALANT

A. Tremco Acoustical Sealant

B. Pecora AC-20<sup>®</sup> FTR

## Warranty Information

1.1: Project Warranty: Refer to Conditions of the Contract for project warranty provisions.

1.1.1: The recommendations for applications and installation are based on our extensive experience and on current technological practice. Our liability and responsibility in the event of damages is limited to the extent defined in our General Terms and Conditions of Business and is not in any way increased by the above recommendations or by advice given by our sales representatives or applications engineering staff.

1.1.2: **Pliteq** Inc. is a corporation duly organized and validly existing under the laws of the province of Ontario. **Pliteq** offers a limited lifetime warranty on the **GenieMat** brand of Sound Control Underlayment products against defects in material and workmanship and that **GenieMat** shall meet all published specifications and shall perform effectively. **Pliteq** warrants that during the warranty period **GenieMat** shall not harden, become brittle, chip, crack, tear, or exhibit any signs of excessive deterioration except for normal wear and tear. All other warranties including implied warranties for a purpose are expressly excluded. The sole remedy against the seller will be the replacement or repair of the defective goods, or at seller's option, credit may be issued not exceeding the selling price of the defective goods.

1.1.3: To qualify for replacement or repair, a claim is required to be made directly to **Pliteq**. All claims are required to be made by telephone at 416-449-0049 or a written claim can be sent to the following address:

Pliteq Inc.  
131 Royal Group Crescent  
Vaughan, ON  
L4H 1X9  
Canada

1.1.4: **Pliteq** must be notified within 14 days of the discovery of a defect and prior to installation. Any claims initiated outside of this limitation period are deemed invalid. A **Pliteq** claim form including customer requirements must be completed and submitted to **Pliteq** within 30 days of notification of defect. Once a claim process is initiated, a material inspection may be performed at **Pliteq's** discretion to ensure the situation is resolved in a comprehensively fair manner.

## General Terms and Conditions of Business

For Your Project Specific Questions  
T. 416.449.0049 | E. [info@pliteq.com](mailto:info@pliteq.com)

© Pliteq Inc. 2020  
®™ Trademarks of Pliteq Inc. The information provided is accurate to the best of our knowledge at the time of issue. However, we reserve the right to make changes when necessary without further notification. Suggested application may need to be modified to conform with local building codes and conditions. We cannot accept responsibility for products that are not used, or installed, to our specifications. All listed dimensions are nominal. 09.2020

[www.pliteq.com](http://www.pliteq.com)

Our general terms and conditions of business, as may be amended from time to time, shall apply to all transactions between us and our customers. Any differing conditions or terms of buyer are herewith objected to and shall not apply. Any agreement affecting the execution of this contract must be in writing. We reserve the right to adapt prices, for confirmed orders as well, to reflect any increase in our costs, for any reason beyond our control, if this increase happens after confirmation of order but before delivery of goods. Our prices do not include taxes. Confirmed delivery dates are not fixed dates, unless stated otherwise. Samples and catalogues are to be considered non-binding material for illustration and/or test purposes, giving only an approximation of properties and specification. Unless agreed otherwise, our invoices are to be paid with payment terms of 30 days upon receipt of merchandise and invoice. Should a customer fail to comply within 30 days, he will automatically be in default of payment. Payment is considered made when it is at our disposal. Should there be reasons to doubt the solvency or credit standing of the client, we reserve the right to demand securities or prepayment for any outstanding delivery or declare immediate maturity of all outstanding claims. Our technical advice is given according to our best knowledge and experience and proven laboratory testing. We require 50% payment up front for all custom orders with the remaining balance to be paid upon agreed upon payment terms. Shipping will be quoted at the time of shipping, any estimated amount provided prior to that shall be for estimation purposes only. We reserve the right to issue a credit, not a refund, on products that are returned. We will not accept returns without prior authorization. We charge a 25% restocking fee for items not received on an Order Acknowledgement, or, for items returned to us. Without agreed upon ship dates, storage fees of \$16USD/pallet/month will be charged to the customer. Discounts for TL (truckload) orders are only applied to orders that require 30 days lead time on delivery and this is at the companies discretion (we may ship sooner if the product is available). For all warranty information please see specific product specification guides as found on our website.