

# FUNKY Monkey bars<sup>®</sup>

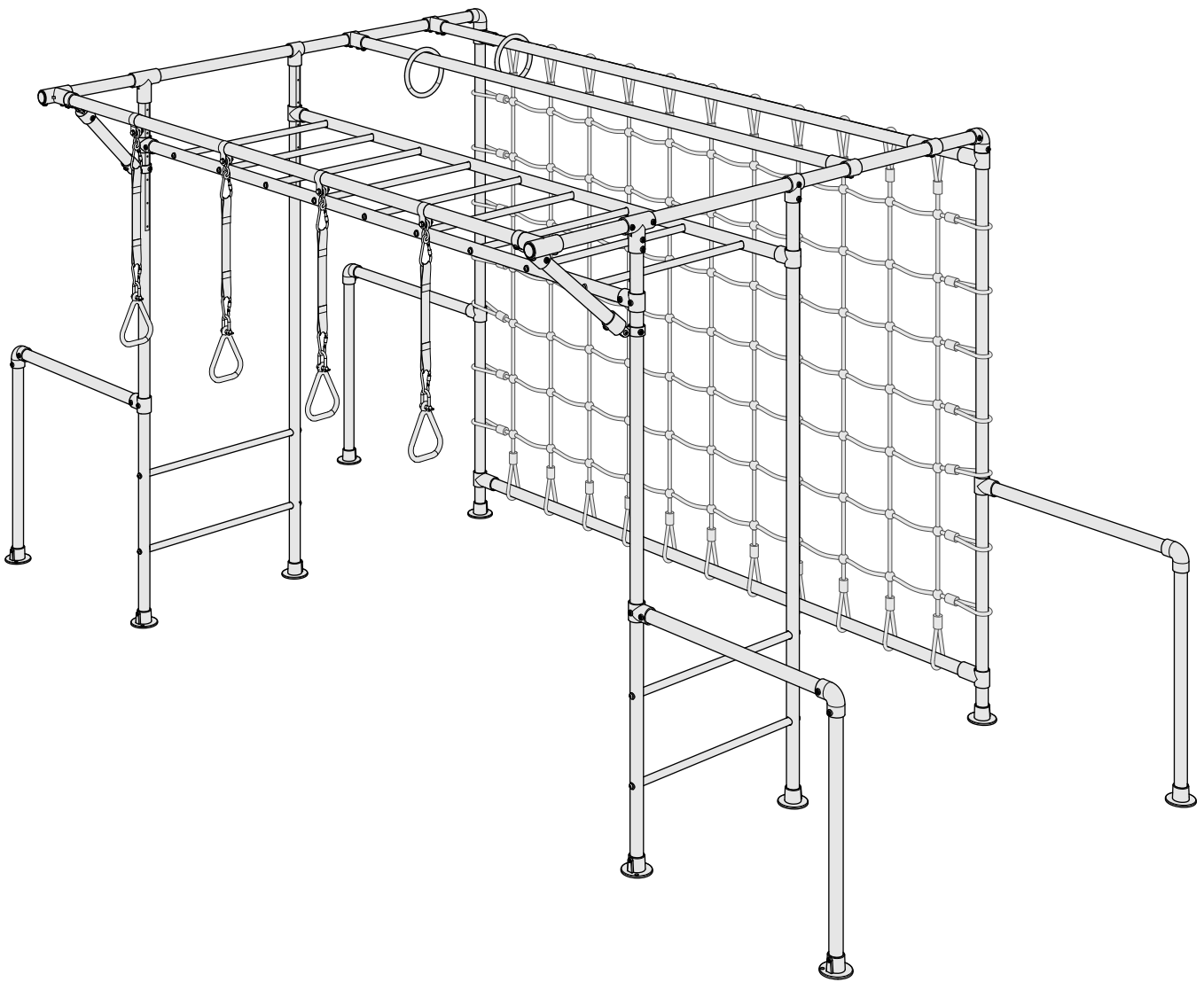

## THE SPIDER MONKEY ASSEMBLY INSTRUCTIONS

## CONTENTS

Warnings . . . . .	Page 1
Load Rating . . . . .	Page 3
Dimensions . . . . .	Page 4
Assembly Tips . . . . .	Page 5
Inventory . . . . .	Page 7
Assembly Instructions . . . . .	Page 10
Ladder Bar Assembly . . . . .	Page 10
Leg Assembly . . . . .	Page 12
Main Monkey Bar Assembly . . . . .	Page 17
Swing Bar Assembly . . . . .	Page 19
Accessories Bar Assembly . . . . .	Page 21
Cargo Net Assembly . . . . .	Page 22
Floating Accessories Bar Assembly. . . . .	Page 25
Twirly Whirly Bar Assembly . . . . .	Page 29
Load Twirly Whirly Bars . . . . .	Page 31
Sticker Placement Guide . . . . .	Page 33
Maintenance . . . . .	Page 34

## WARNING

PLEASE CAREFULLY READ ALL INFORMATION CONTAINED IN THIS ASSEMBLY MANUAL BEFORE YOU INSTALL AND USE YOUR FUNKY MONKEY BARS®.

## SAFETY NOTICE

1. Any person handling or using the Funky Monkey Bars® products must follow the instructions as described in this document. The person in charge of assembling and using the equipment must ensure that the recommendations for use given in this document are seen by all users.
2. Only use the Funky Monkey Bars® after they have been fully assembled and after checking that the fittings are tightened properly (*refer to page 5 - Correct Tightening Method*).
3. DO NOT install your Funky Monkey Bars® over concrete, asphalt, packed earth, wood decking or any other hard surface. A fall onto a hard surface can result in serious injury or death.
4. Inspect all grub screws, bolts and nuts at the beginning of each play session to ensure your Funky Monkey Bars® are tight and secure.
5. Ensure all tubes are fully inserted into fittings until you hear the magic "CLUNK" sound.
6. Ensure your Funky Monkey Bars® are properly secure at ALL times. Pegs are in place and inserted fully into the ground.
7. DO NOT exceed the maximum load/weight limit as recommended by Funky Monkey Bars®.
8. Children should be supervised by an adult at all times.
9. Installing a gym/crash mat under the fall zone area of your Funky Monkey Bars® would be recommended for children learning this new skill. This will reduce the chance of injury and build the child's confidence while they build strength and master the skill.
10. Ensure you have thoroughly read your assembly and installation instructions and viewed our on-line installation videos at <https://www.funkymonkeybars.com/blogs/installation-maintenance-videos>
11. DO NOT climb, sit or stand on top of the monkey bar (horizontal ladder) section.
12. DO NOT jump from the top of any section of the monkey bar.
13. DO NOT use your Funky Monkey Bars® when wet as the steel will be slippery.
14. DO NOT attach items to your frame that are not designed specifically to be used with Funky Monkey Bars®, especially lower quality products that have not been approved by Funky Monkey Bars®.
15. Ensure the height of your Funky Monkey Bars® (horizontal ladder) are set at a level that is age appropriate.
16. DO NOT install your Funky Monkey Bars® over or near objects that could interfere with users in an unsafe way. Maintain a clear area around your Funky Monkey Bars®.
17. DO NOT use your Funky Monkey Bars® while under the influence of drugs and alcohol.
18. Wear clothing free of drawstrings, hooks, loops or anything that could get caught while using your Funky Monkey Bars® and result in entanglement and/or strangulation.

## ASSEMBLY

1. Keep small children away from the Funky Monkey Bars® during assembly.
2. Do not attempt to use the Funky Monkey Bars® until it is completely assembled and every fitting is tight and secured.
3. Installation typically takes 4-5 hours to complete. Two people are recommended for assembly.
4. Ensure all fittings are tightened to the correct tightening method as described on page 5.
5. Assembly should be carried out on clean, dry, level surface

Please refer to the video section on the Funky Monkey Bars® website for more handy tips and assembly instructions at <http://www.funkymonkeybars.com/pages/videos>

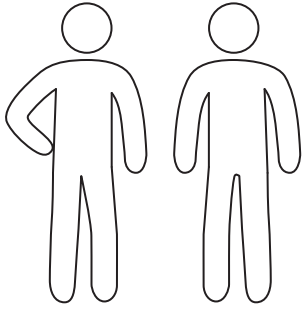

Assembly requires 2 adults.

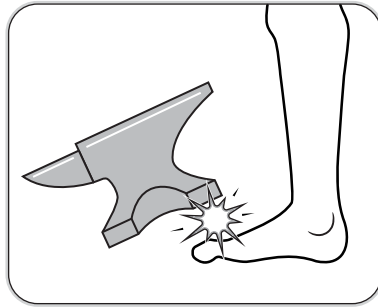

Heavy items !

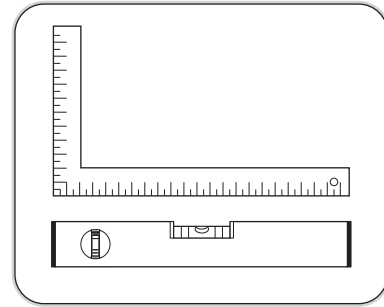

Work on flat level surface.

## LOCATION

1. A safe fall zone around your Funky Monkey Bars® is essential. A minimum distance of 1.5m to 2m (5 ft to 6.5ft) is recommended around the elevated hanging points of your Funky Monkey Bars®.
2. Place your Funky Monkey Bars® on level ground, away from any structure or obstruction such as a fence, garage, house, overhanging branches, laundry lines or electrical wires and remove any obstructions beneath your Funky Monkey Bars®.
3. Ensure your Funky Monkey Bars® are positioned away from retaining walls, pool fences, structures and other play equipment. Maintain a clear space around the whole perimeter of your Funky Monkey Bars®.
4. Place your Funky Monkey Bars® on the most level surface available.

## MAINTENANCE

1. At the beginning of each heavy play session we recommend the following maintenance processes be performed on your Funky Monkey Bars®:
  - Tighten all bolts, grub screws and applicable hardware (as per page 5)
  - Lubricate all metallic moving parts as per instructions (flying fox, swing hooks etc)
  - Check all protective coverings on bolts, pipes, edges and corners. Replace if they are loose, cracked or missing.
  - Check all moving parts including swing seats, shackles, snap hooks, chains and trolleys for wear, rust, or other deterioration. Replace as needed.
2. Twice a month during play season we would recommend the following maintenance processes be performed on your Funky Monkey Bars®:
  - Tighten all connections and hardware
  - Check all protective coverings on bolts, pipes, edges and corners. Replace if they are loose, cracked or missing.
3. Once a month during play season we would recommend the following maintenance processes be performed on your Funky Monkey Bars®:
  - Lubricate all metallic moving parts as per instructions (flying fox, swing hooks etc). If swings start to squeak then lubricate swing hooks.
  - Check all moving parts including swing seats, ropes, chains and trolleys for wear, rust, or other deterioration. Replace as needed.
  - Owners shall be responsible for maintaining the legibility of any warning labels.

For additional information concerning your Funky Monkey Bars®, please contact our customer service team or check our website for any important updates. Phone - 1300 912 198 or [www.funkymonkeybars.com](http://www.funkymonkeybars.com)



**QUALITY & INDEPENDENT TESTING**

At Funky Monkey Bars® we take the quality of our designs and safety very seriously. All Funky Monkey Bars® frames go through a stringent, independent structural testing process prior to being made available for release to our customers.

Our frames are designed within the parameters of the Australian Standard for Playground Equipment AS4685.1:2014.

The structural integrity of our frames has been tested for performance through a combination of engineering calculations and physical testing. The tests have been performed by independent, certified structural engineers in accordance with Australian Standard for Playground Equipment AS4685.1:2014 and European Standards EN1176-1:2008.

The independent testing conducted on The Spider Monkey certified the frame to a load rating of 1257kgs or 22 users.

<b>LOAD TESTING CERTIFICATION</b>				
<b>DATE OF TEST</b>	<b>MODEL</b>	<b>NUMBER OF USERS</b>	<b>USER LOAD (KG)</b>	<b>LOAD RATING (KG)</b>
29 July 2020	Spider Monkey	22	60	1257kg
I hereby confirm all testing was undertaken in accordance with Physical Testing of Structural Integrity requirements of AS 4685.1: 2014 App C / EN 1176-1:2008 <sup>o</sup> except where noted below;				
<b>COMMENTS:</b> N/A				
<b>APPROVED BY:</b> Funky Monkey Bars®			<b>WITNESSED BY:</b> Independent Engineer	
				
<b>DATE :</b> Jul 2020			<b>DATE :</b> Jul 2020	

# DIMENSIONS

## FUNKY MONKEY BARS® THE SPIDER MONKEY OVERALL DIMENSIONS

A minimum of 2.0 metres clear fall zone is recommended around the elevated hanging points of your Funky Monkey Bars®.

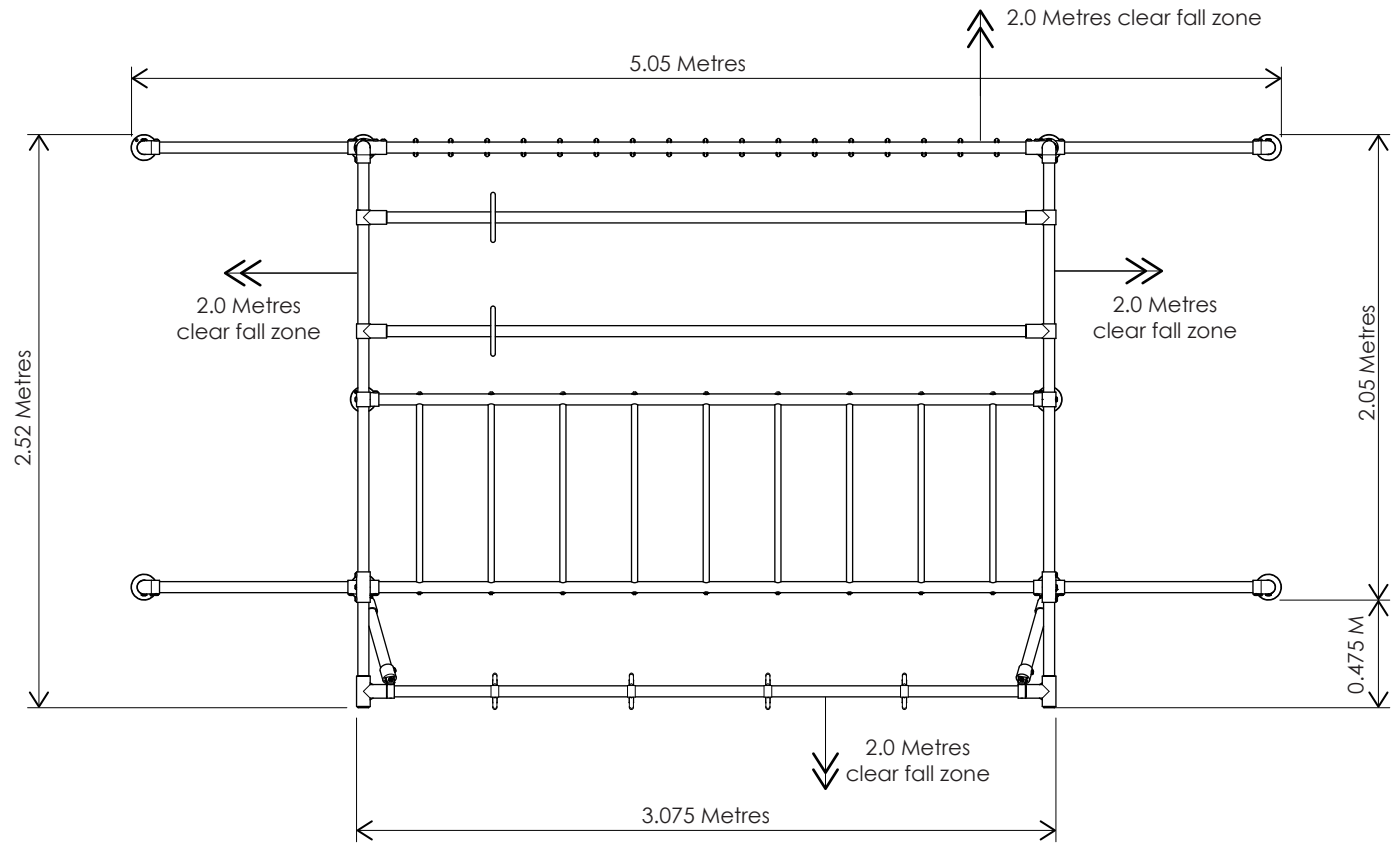

**PLAN VIEW**  
(not to scale)

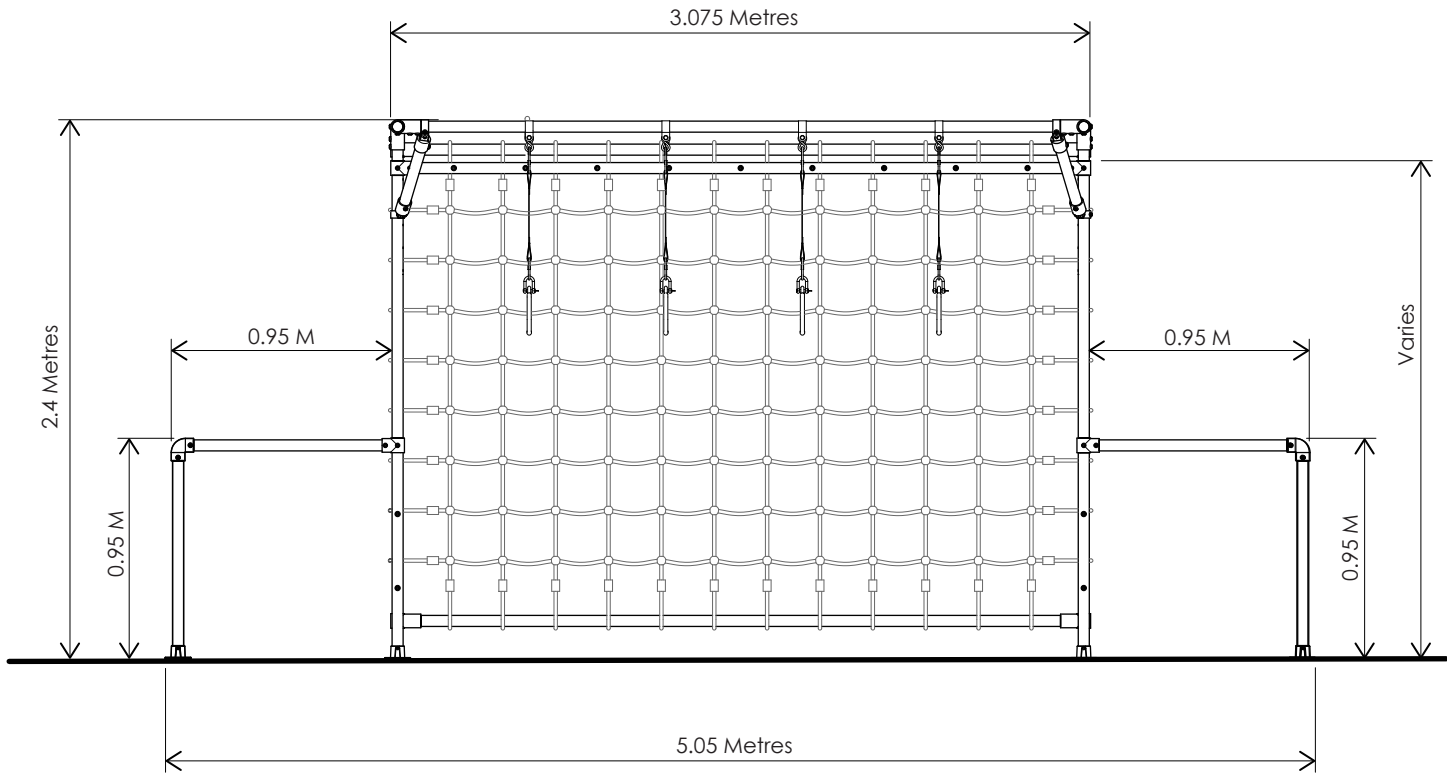

**SIDE VIEW**  
(not to scale)

## ASSEMBLY TIPS

### CORRECT INSERTION INTO FITTINGS - (INDICATIVE DIAGRAM SHOWN)

All tubes must be fully inserted until contact is made with adjoining tube.

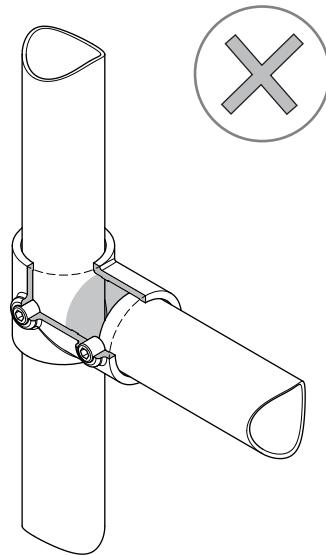

Gap.

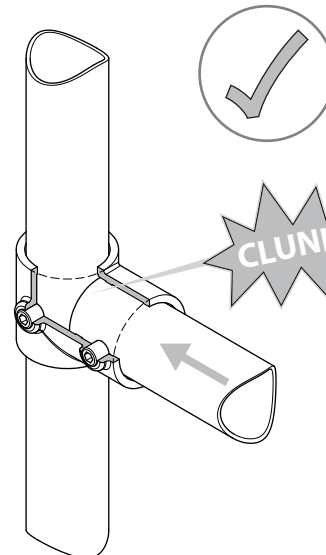

No gap.

### CORRECT TIGHTENING METHOD OF GRUB SCREWS - (INDICATIVE DIAGRAM SHOWN)

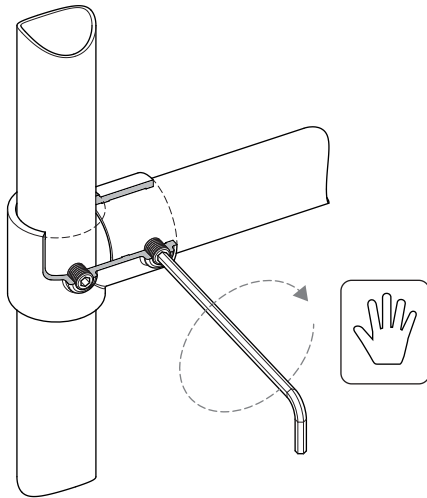

1. With long end of allen key, hand tighten grub screw as much as possible.

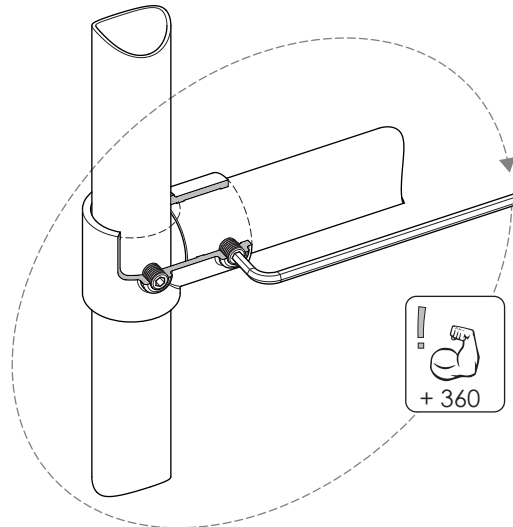

2. Using other end of the allen key do one full 360 degree turn as a minimum, use muscles!



### CORRECT TIGHTENING METHOD OF RUNG BOLTS - (INDICATIVE DIAGRAM SHOWN)

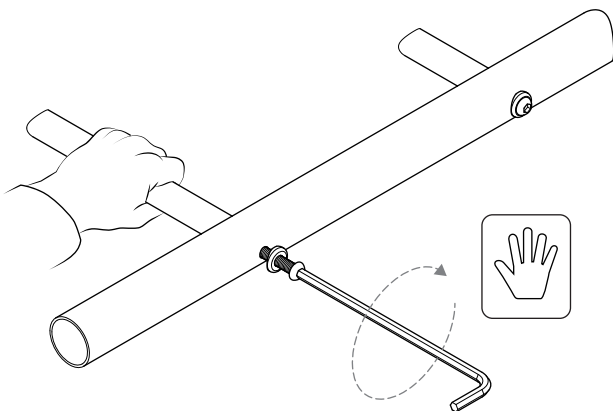

1. With long end of allen key, hand tighten bolt hard up against washer and outside of tube. Hold rung to avoid rotation.

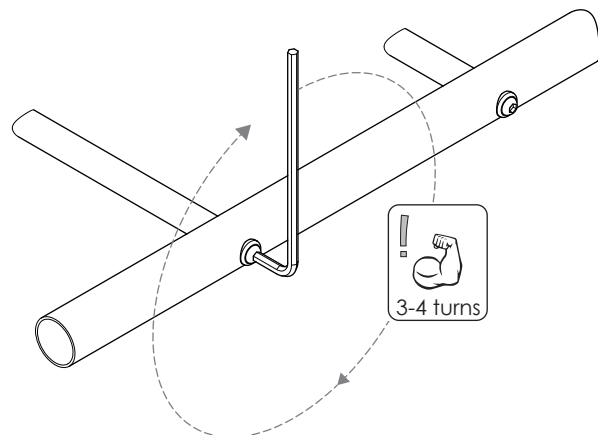

2. Using short end of the allen key fully tighten, approximately 3-4 full turns .



## ASSEMBLY TIPS (CONTINUED)

### IT IS CRITICAL YOUR MAIN FRAME IS 100% SQUARE AND LEVEL (INDICATIVE DIAGRAM SHOWN)

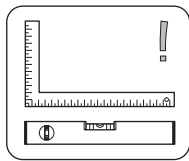

Check assembly is 100% level, square & straight.

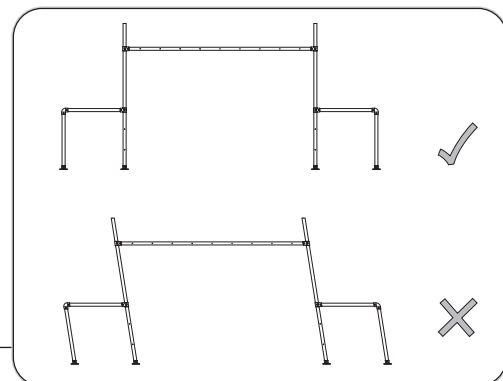
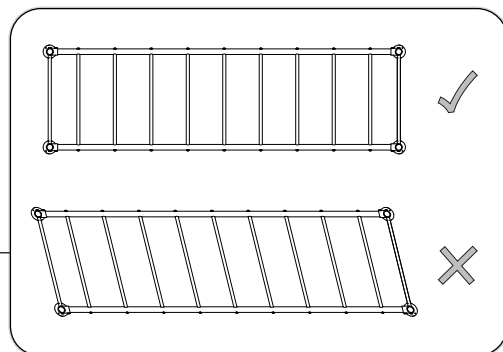
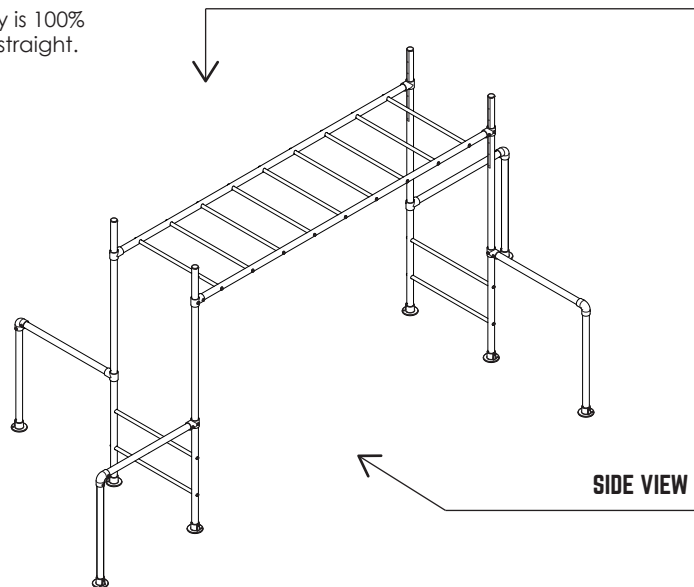

If your frame is not straight or level remove pegs, loosen grub screws, re-adjust re-tighten and re-peg the frame.

### INSTALLATION ON A SLOPE

If your frame is being installed on a slope ensure the monkey ladder bar is level. Either install at different heights on the legs or dig down at one end until level.

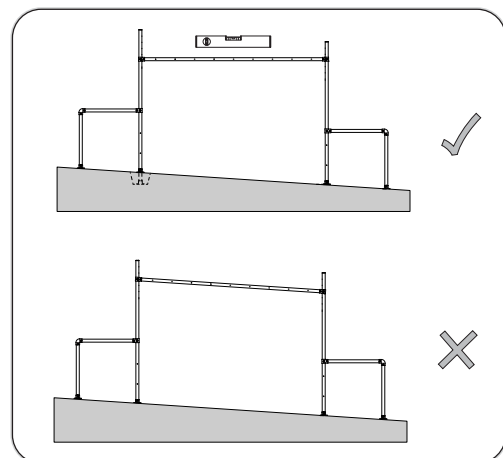

### FIXING TYPICAL ORIENTATION - (INDICATIVE DRAWING SHOWN)

Unless otherwise stated all grub screws and fittings should face downwards and outwards. This will reduce weathering damage, help with assembly and ease of maintenance.

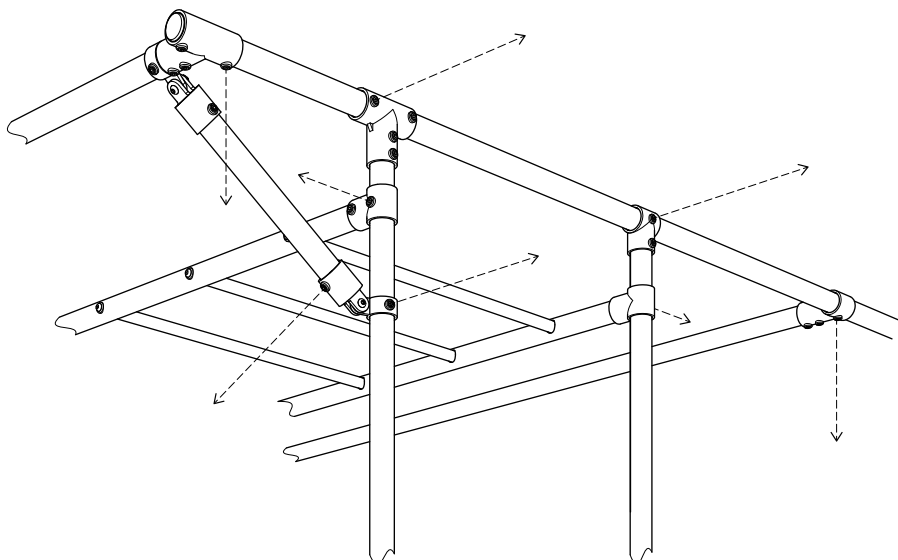

# INVENTORY

## SUPPLIED BOXES.

NOTE: The Spider Monkey frame comprises of a total of 20 boxes: (some found inside other boxes)

QUANTITY.	CODE.	DESCRIPTION.
1	A1	2 x Ladder Tubes
2	B1	4(Total) x Adjustable Leg Tubes
1	C1	8 x Colour Twirly Whirly Tubes
1	D-13	13 x Colour Rung Tubes
1	F1	1 x Silver 2950mm Accessories Tube
2	F2	4(Total) x Silver 2950mm Accessories Tubes
1	F3	2 x Silver 1900mm Swing Bar Tubes
1	F5	2 x Silver 2300mm Swing Leg Tubes
1	M2	4 x Silver 600mm Brace/Extension Tubes
1	N	Accessories Box
1	O2	Cargo Net
1	P3/P4 or P5	Round or Long Ninja Grips or Delta Rings (Inside box N)
1	Q3	Fittings and Hardware (Inside box N)
1	Q14	Fittings and Hardware (Inside box N)
1	Q20	Fittings and Hardware
2	Q32	Fittings (Inside box N)
1	TRAV	Rocket Rings (inside box N)
Total 20		

## TOOLS REQUIRED FOR INSTALLATION

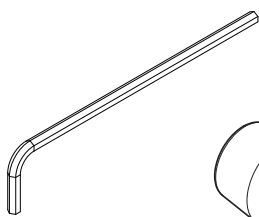

**1x**  
8mm Allen key  
(Included)

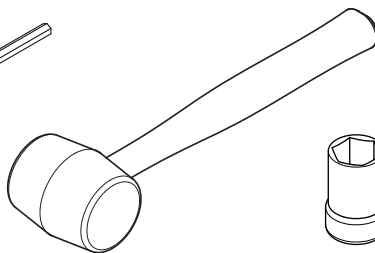

**1x**  
Soft Hammer  
(Not included)

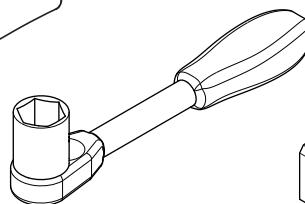

**1x**  
17mm Ratchet  
(Not included)

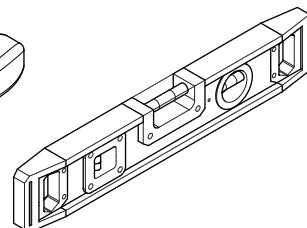

**1x**  
Spirit Level  
(Not included)

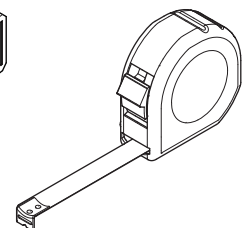

**1x**  
Tape Measure  
(Not included)



# INVENTORY (CONTINUED)

## TUBES

**4x**  
Extension Tube/  
Brace Tube 

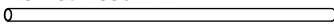
**13x**  
Rung Tube 

**8x**  
Twirly Tube 

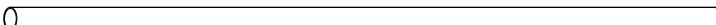
**2x**  
Swing Bar Tube  
(short) 

**2x**  
Swing Leg Tube 

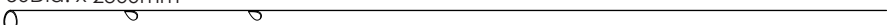
**4x**  
Adj. Leg Tube 

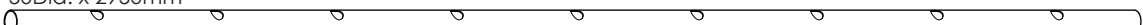
**2x**  
Ladder Tube 

**5x**  
Flying Fox Tube/  
Accessories Tube 

## FITTINGS

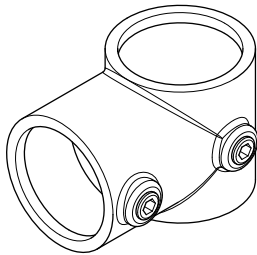

**10x**  
Short Tee  
D-101

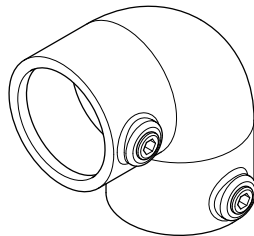

**6x**  
Elbow  
D-125

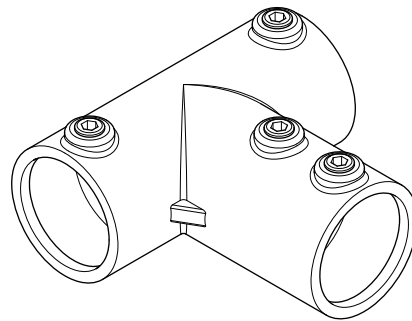

**4x**  
Extra Long Tee  
D-104L

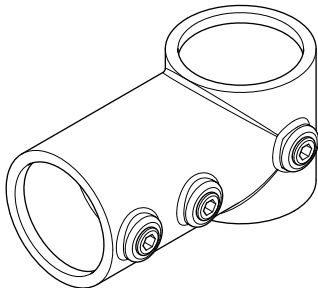

**8x**  
Long Short Tee  
D-101L

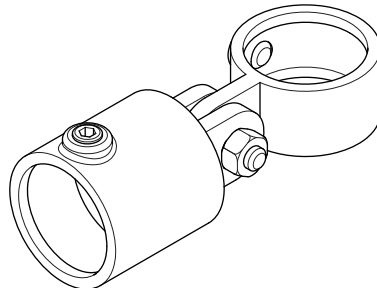

**4x**  
Swivel Brace  
D-173

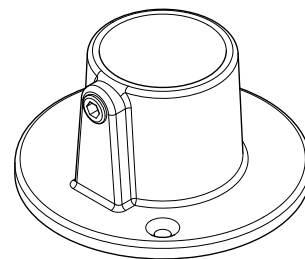

**10x**  
Base Plate  
D-131

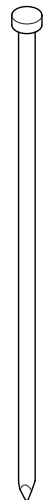

**10x**  
Peg

# INVENTORY (CONTINUED)

## HARDWARE

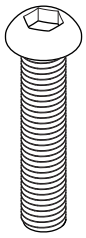

**27x**  
M10 Bolt

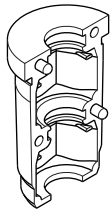

**54x**  
Rung Insert

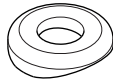

**27x**  
Washer



**54x**  
M10 Hex Nut

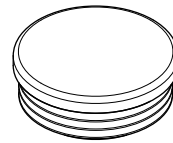

**6x**  
Plastic End Cap



**1x**  
Manufacture Sticker



**2x**  
Logo Sticker



**1x**  
Warning Label Sticker



**2x**  
Australia Made Sticker

## COMPONENTS (ACCESSORIES IF APPLICABLE)

**4x**  
Swing Hooks



**2x**  
Rocket Rings

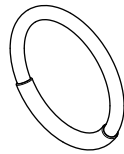

**4x**  
Delta Rings



**1x**  
3m Cargo Net  
(11x7 rungs)

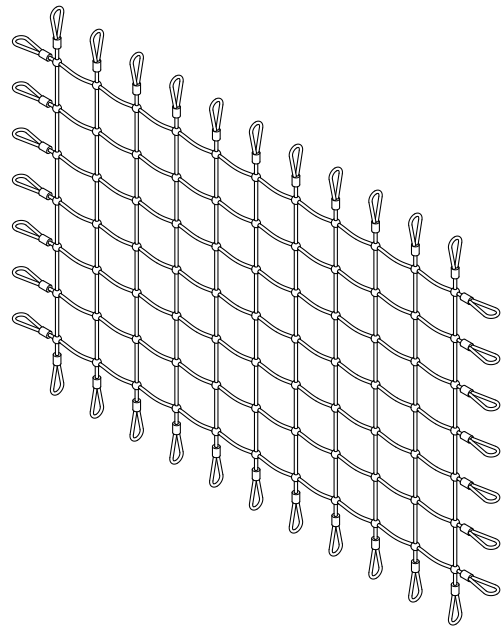

NOTE: Refer to separate accessory installation instructions if supplied.

One of the best things about Funky Monkey Bars® is the ability to add new equipment and accessories as your child and family grows. You can swap or add accessories to your existing frame, or add extra frames that will give you more versatility to attach equipment. Check out what we've got in store now at...

[WWW.FUNKYMONKEYBARS.COM](http://WWW.FUNKYMONKEYBARS.COM)

# ASSEMBLY INSTRUCTIONS - LADDER BAR ASSEMBLY

## 1 RUNG ASSEMBLY (X13)

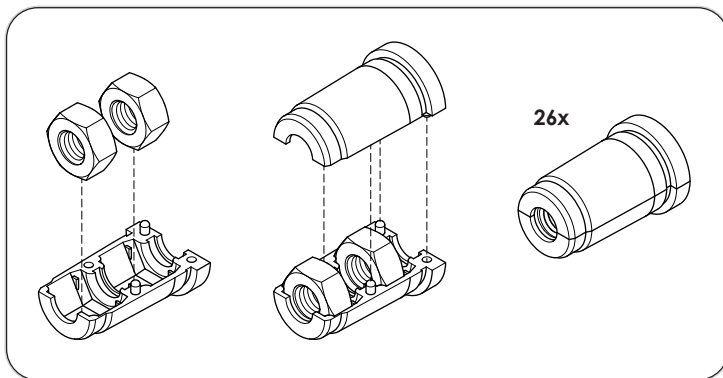

1. Assemble plastic rung inserts as shown above.

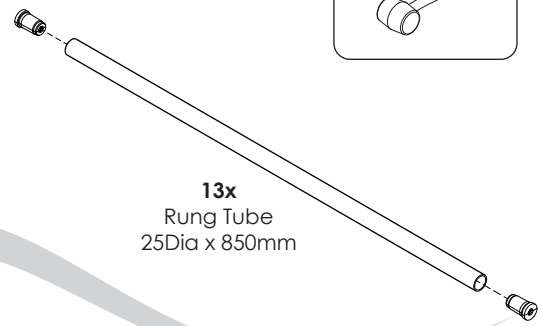

2. Push inserts into both ends of all rungs.

## 2 MONKEY BAR LADDER ASSEMBLY

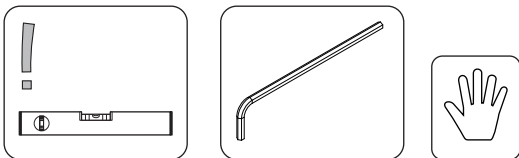

On flat surface insert rungs from step 1 into a ladder tube. Hand tighten grub screws.

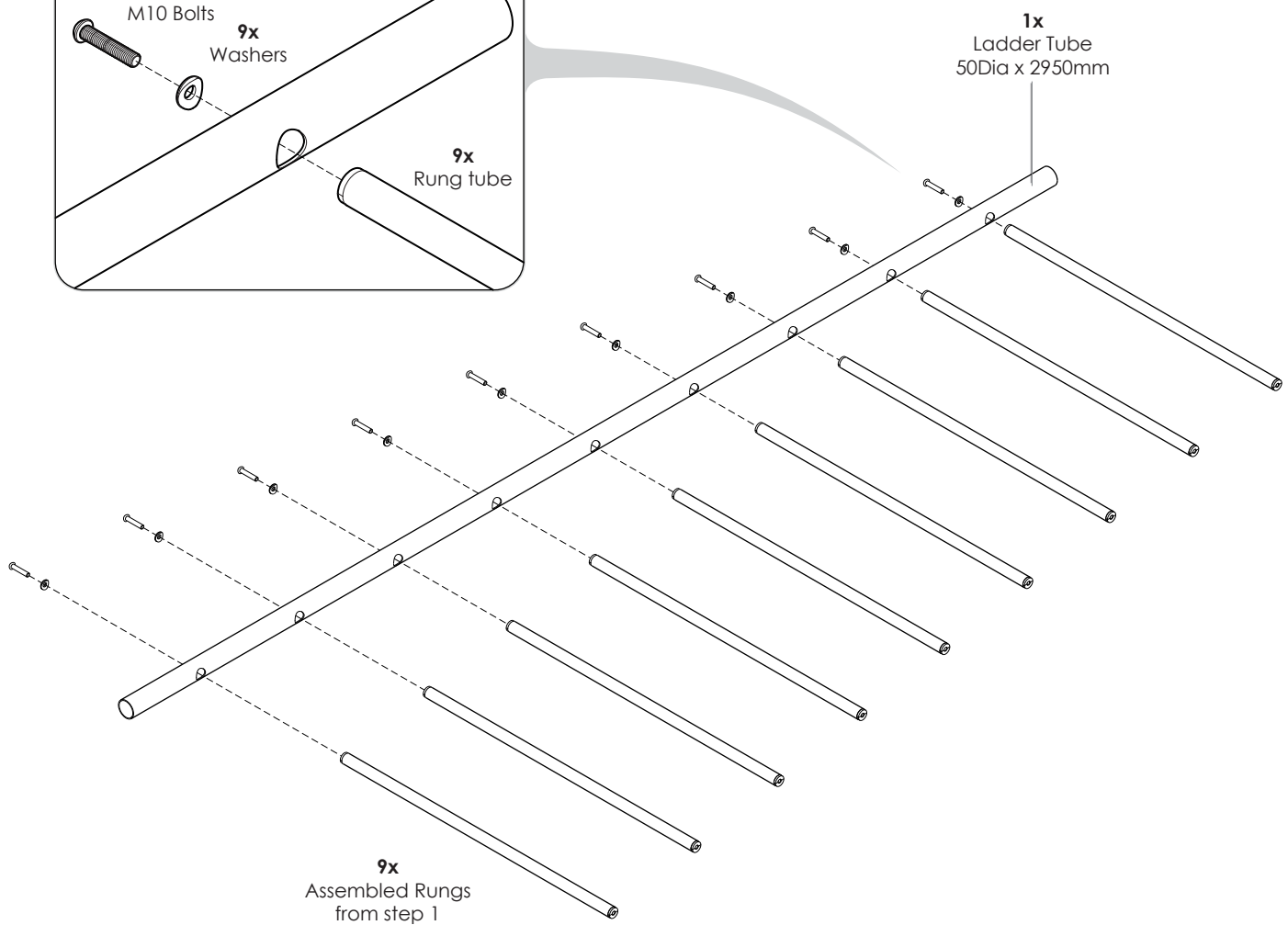
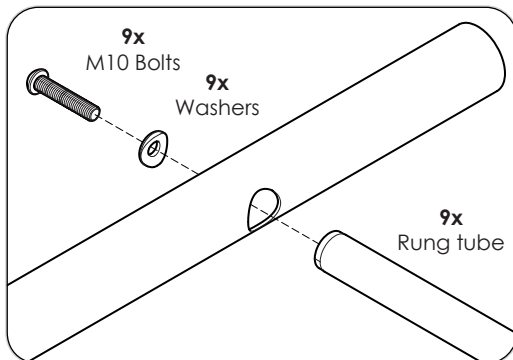

### 3 ATTACH SECOND LADDER TUBE

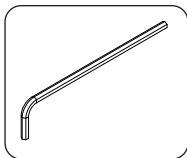

Hand tighten all bolts

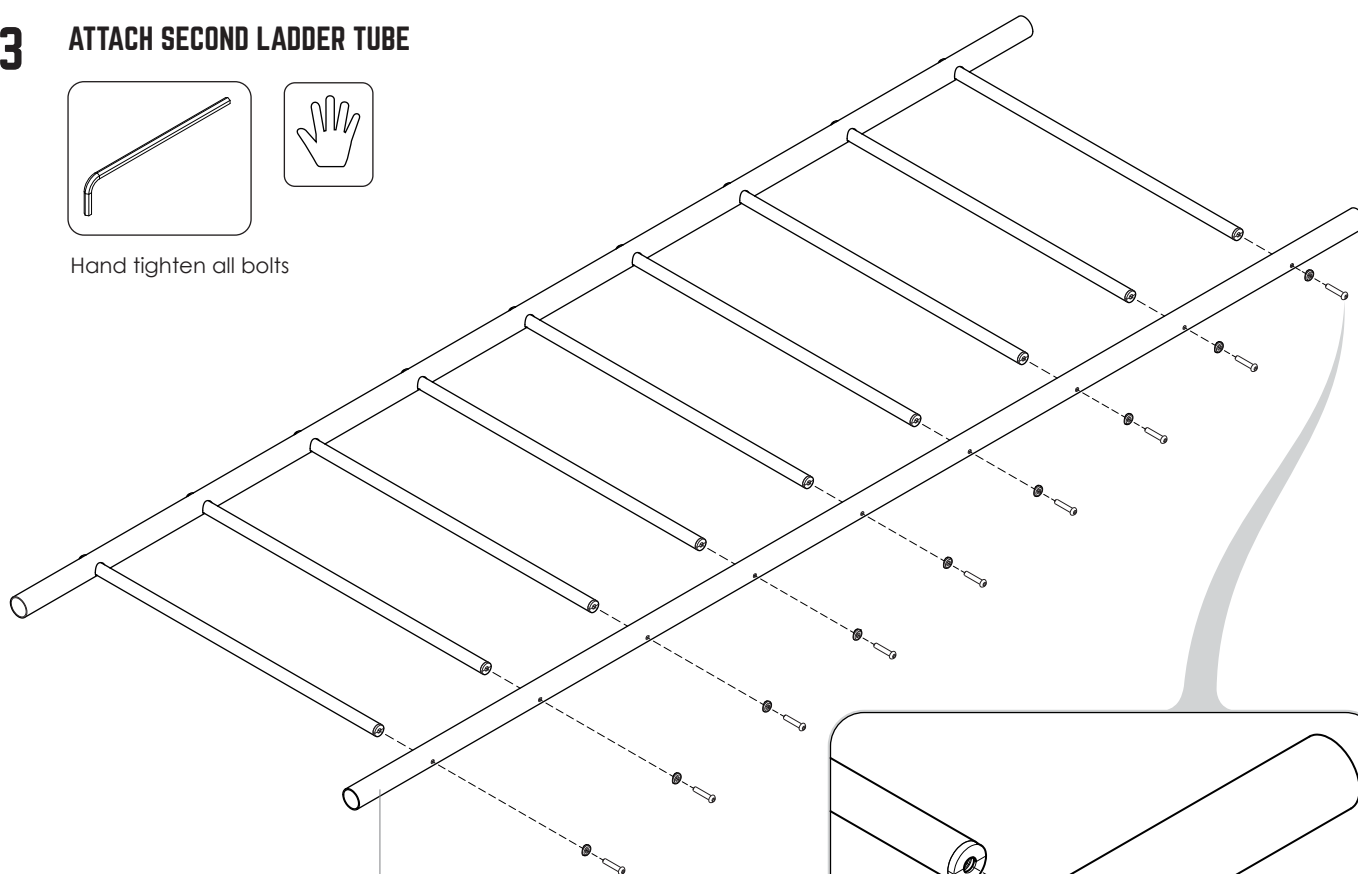

1x  
Ladder Tube  
50Dia x 2950mm

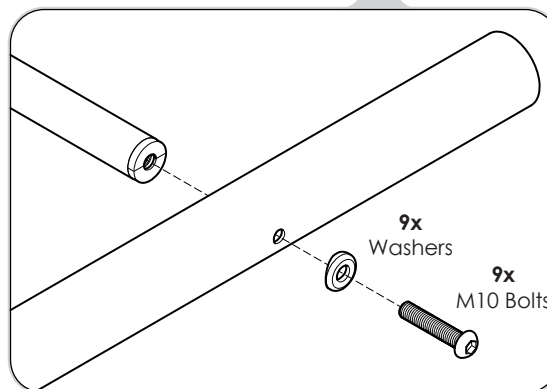

### 4 FIRMLY TIGHTEN ALL RUNG BOLTS.

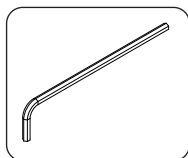

See page 5 for correct tightening method.

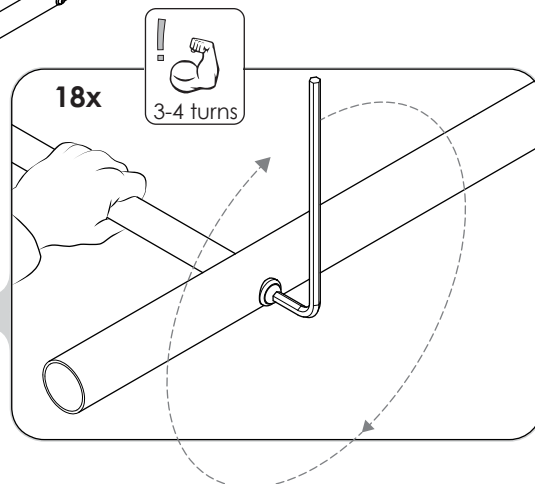
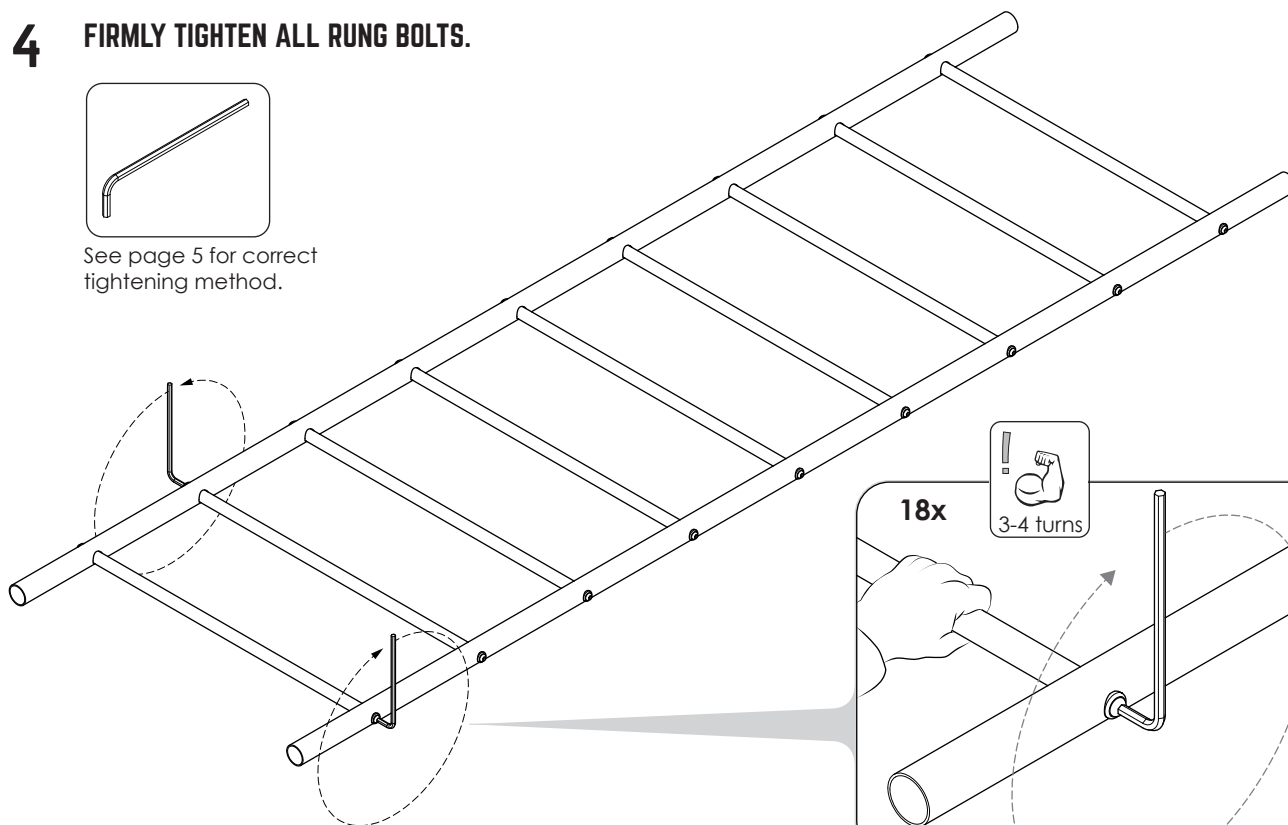

# ASSEMBLY INSTRUCTIONS - LEG ASSEMBLY

## 5 LEG ASSEMBLY x 2

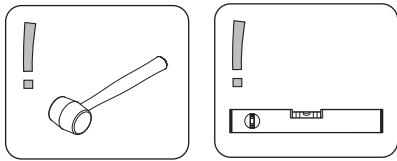

Insert plastic end caps into leg tubes.

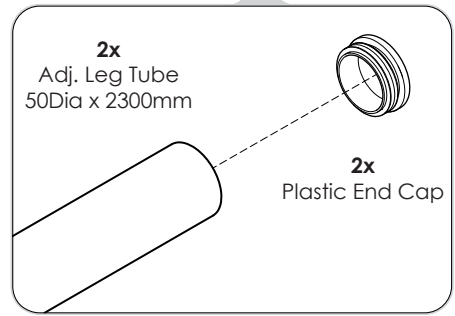
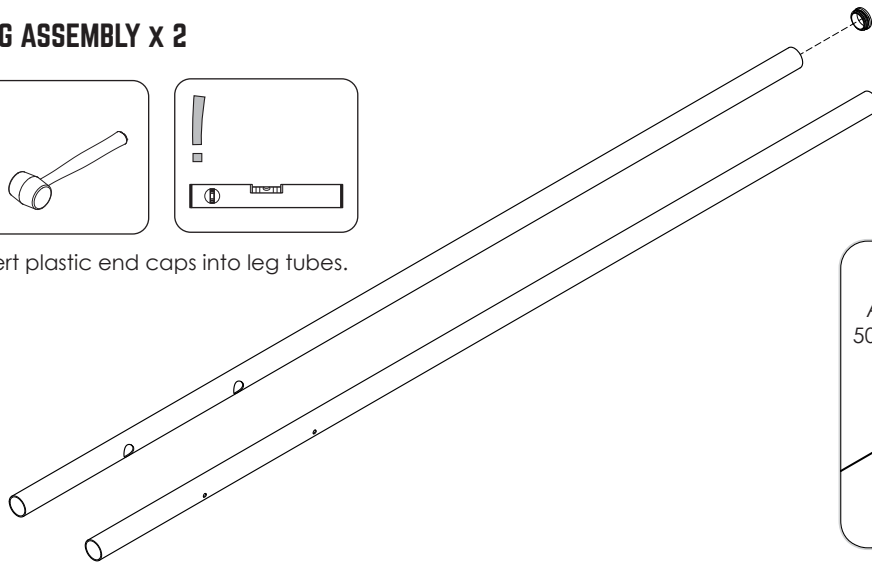

## 6 INSERT RUNGS

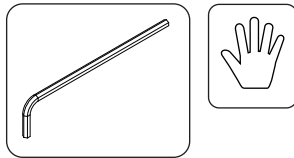

Hand tighten all bolts.

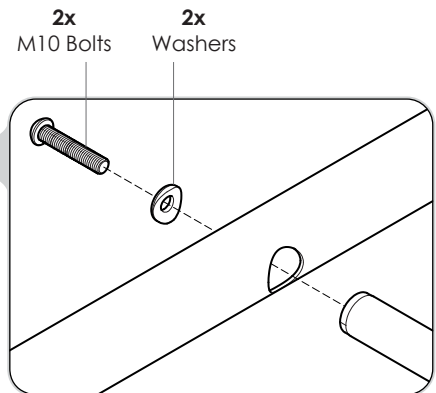
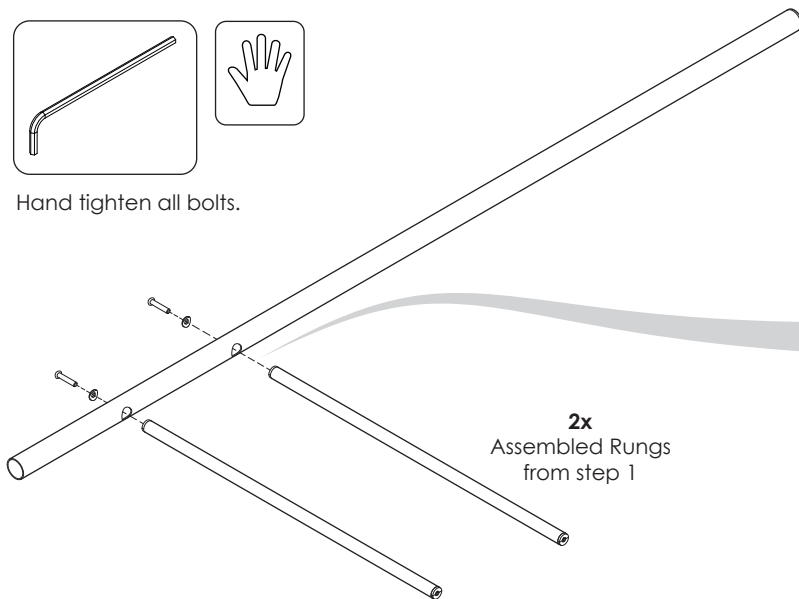

## 7 ATTACH SECOND LEG

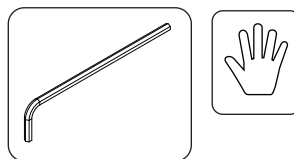

Hand tighten all bolts.

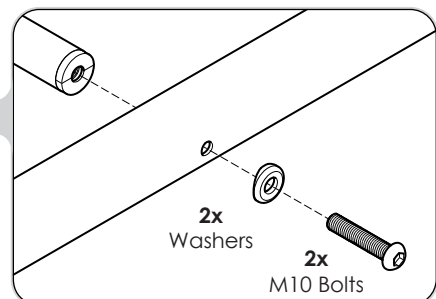
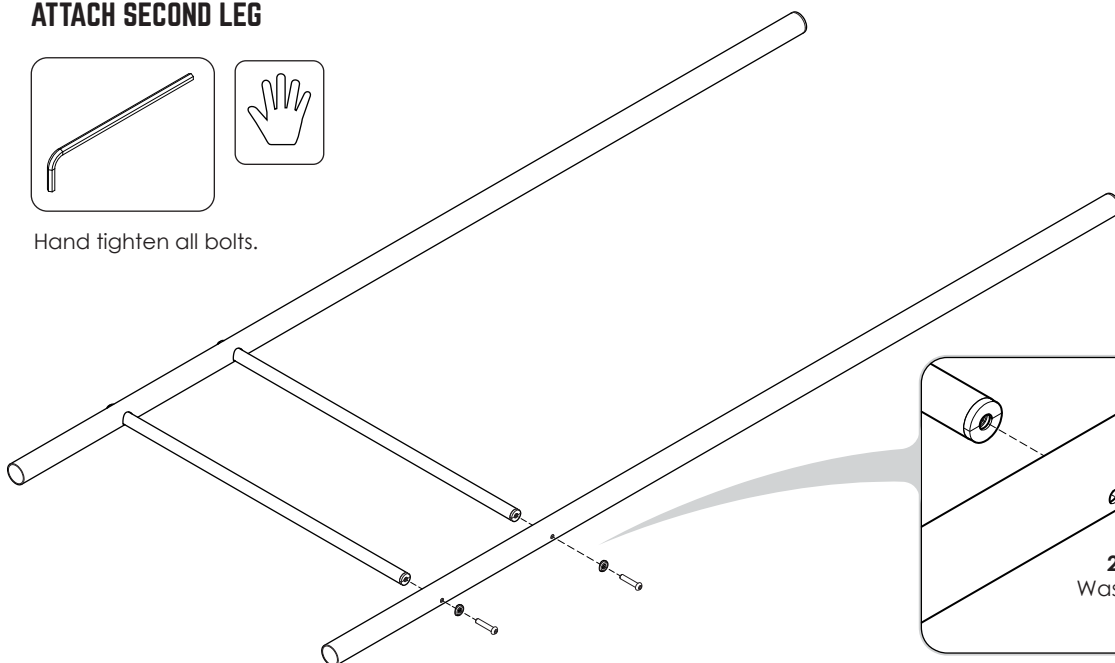

## 8 ATTACH BASE PLATES

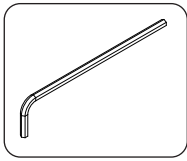

Tighten all grub screws.

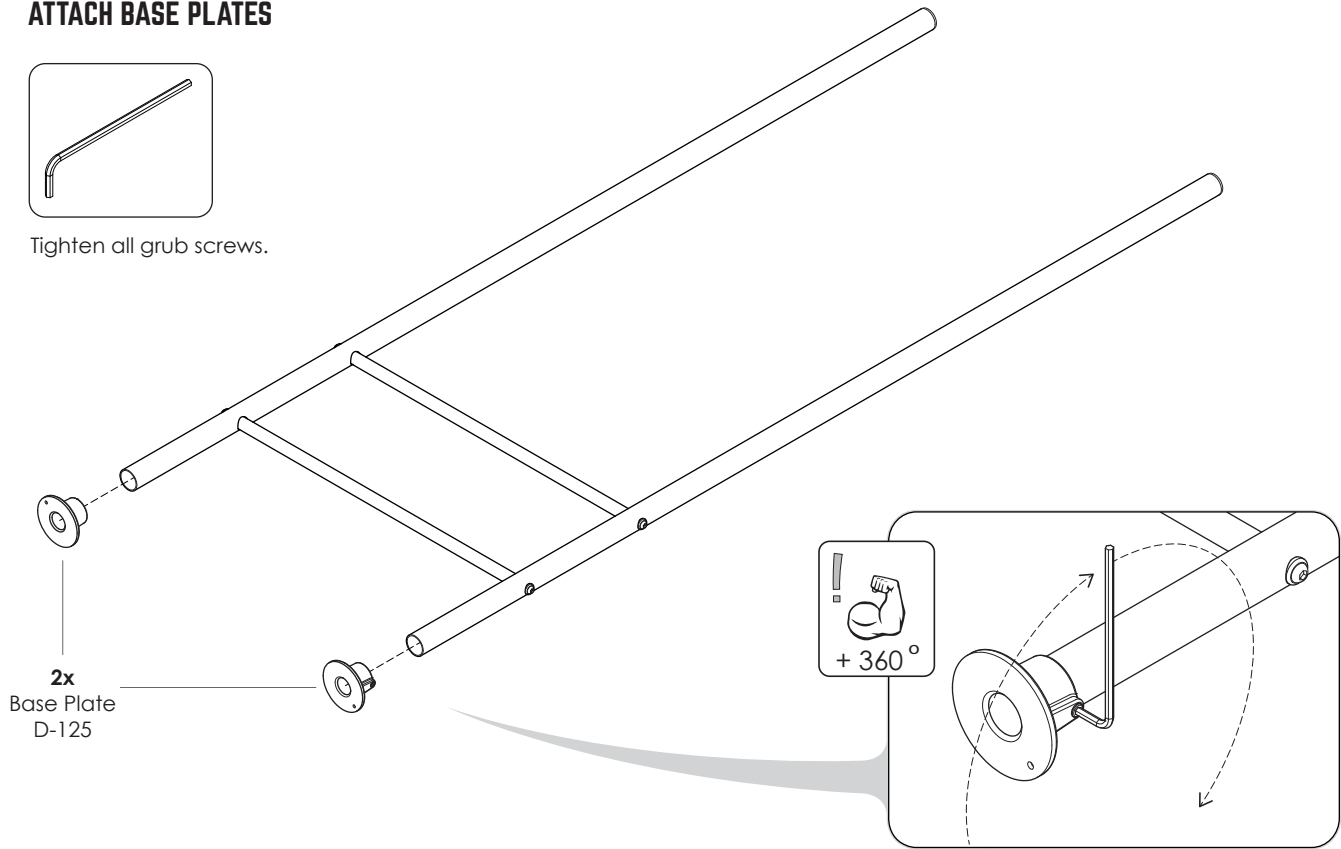

2x  
Base Plate  
D-125

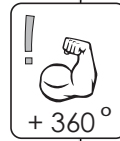

+ 360°

## 9 SLIDE ON SHORT TEE 'A' AND SWIVEL BRACE 'B'

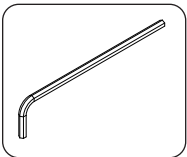

1. Slide on short tee and swivel brace.  
Ensure swivel brace grub screw is facing downwards to the base plate.
2. Hand tighten grub screws.  
(Temporary location.)

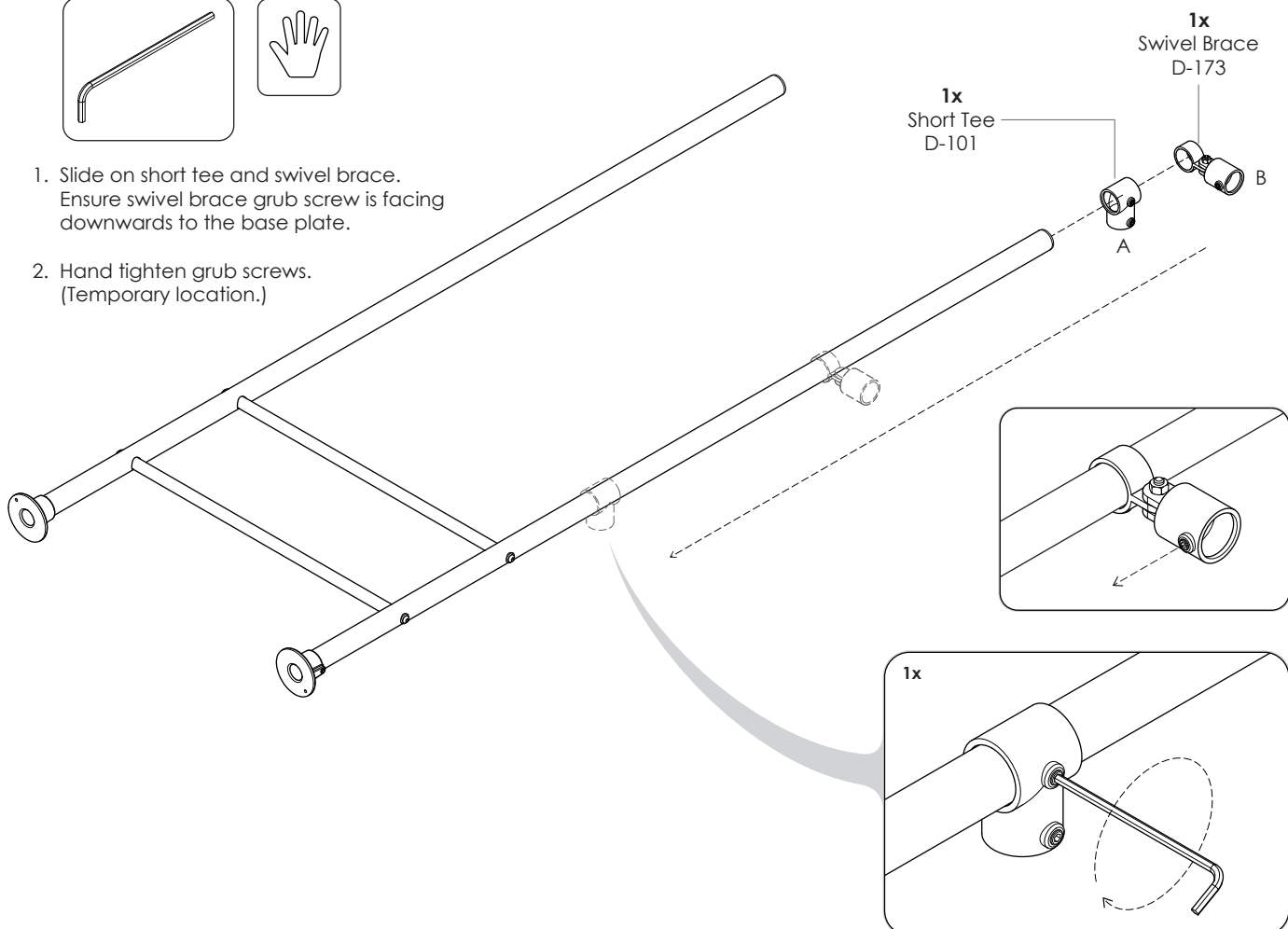

1x  
Short Tee  
D-101

1x  
Swivel Brace  
D-173

A B

1x

# 10 APPLY HEIGHT STICKERS.

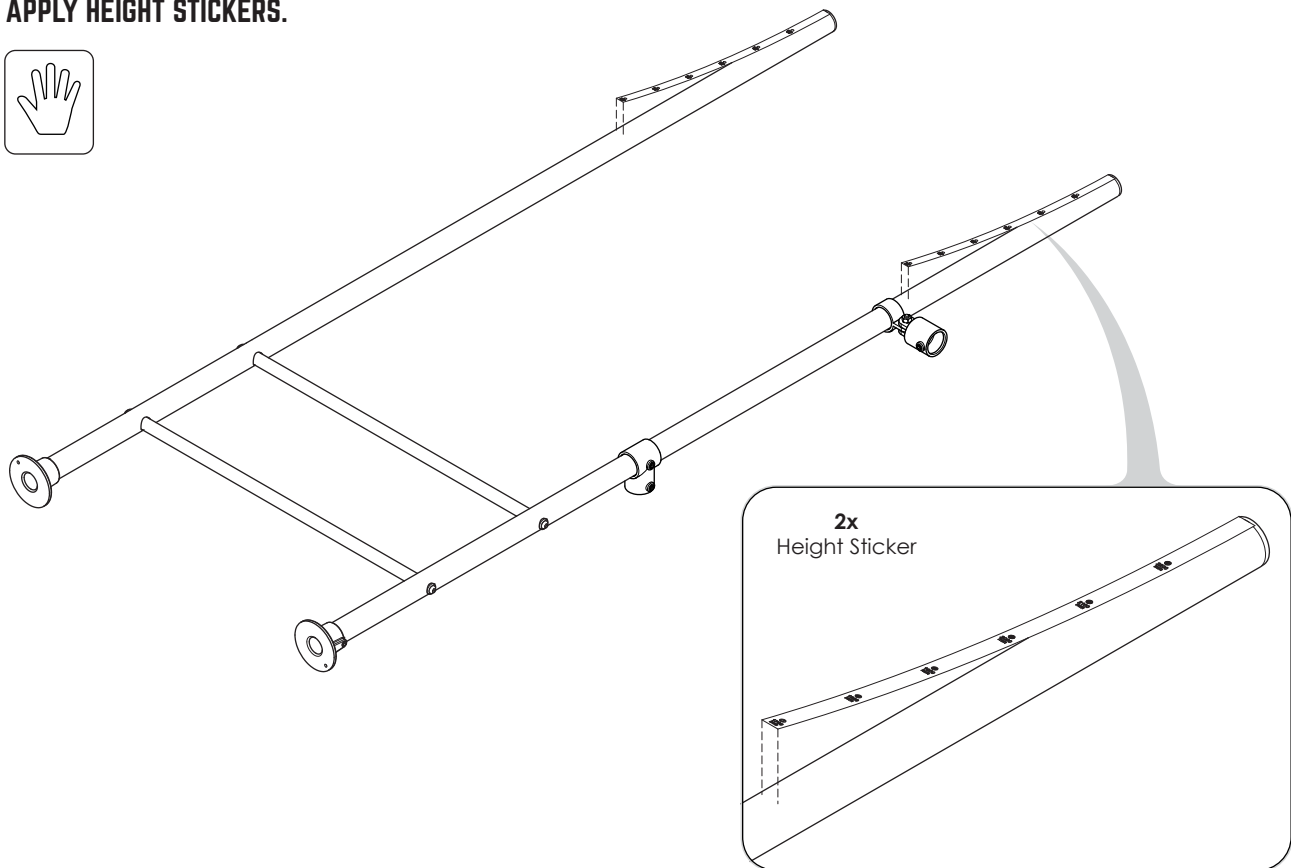

2x  
Height Sticker

# 11 SET LADDER BAR HEIGHT.

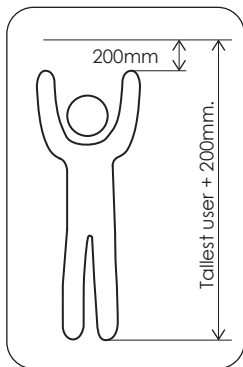

Good starting height is 100-200mm above reach.

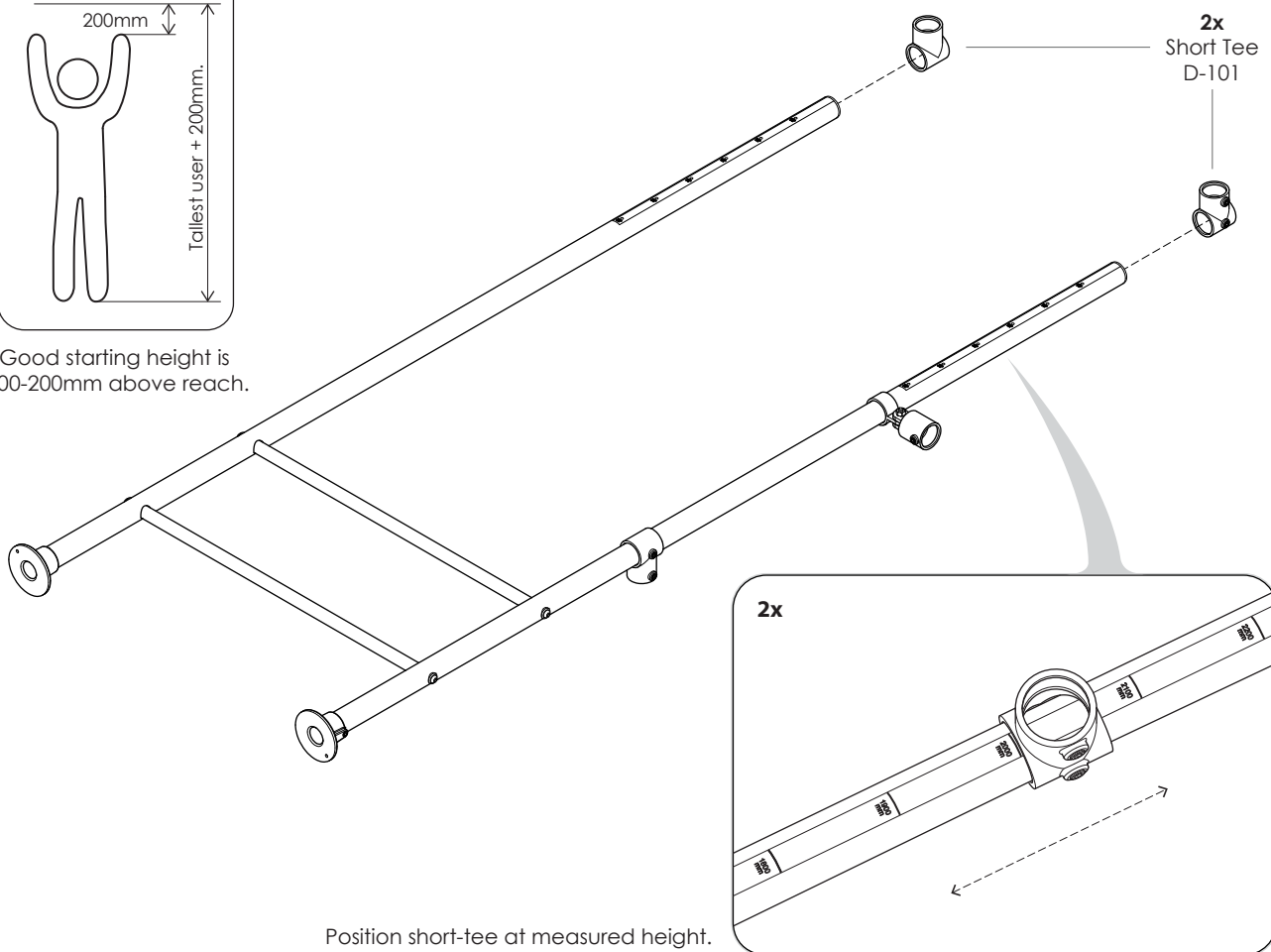

2x  
Short Tee  
D-101

2x

Position short-tee at measured height.

## 12 FIRMLY TIGHTEN ALL GRUB SCREWS & RUNG BOLTS.

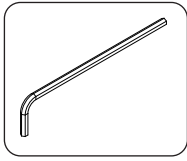

Hand tighten grub screws on A & B (Temporary location).  
Fully tighten all others.

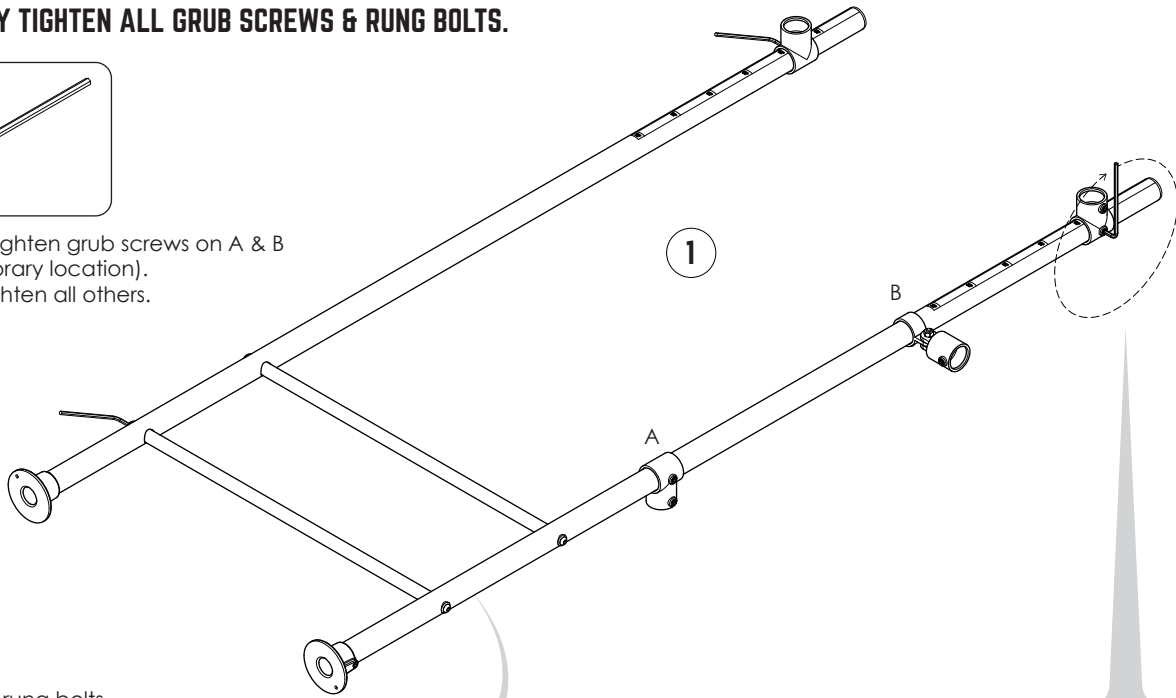

Fully Tighten rung bolts.

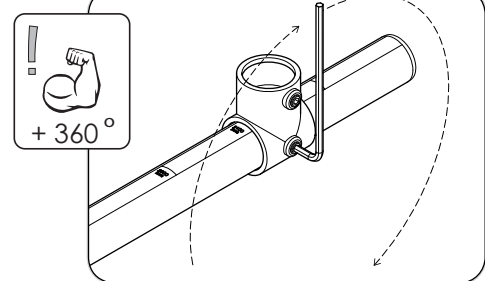
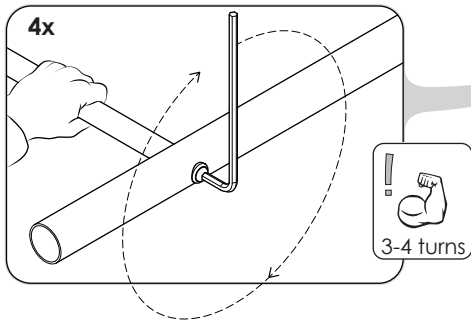

## 13 REPEAT STEPS 5-12 FOR 1x MORE LEG ASSEMBLY. SAME PROCEDURE BUT SHORT TEE A & SWIVEL BRACE B PLACED ON OTHER LEG- (SEE STEP 14 FOR FINAL RESULT)

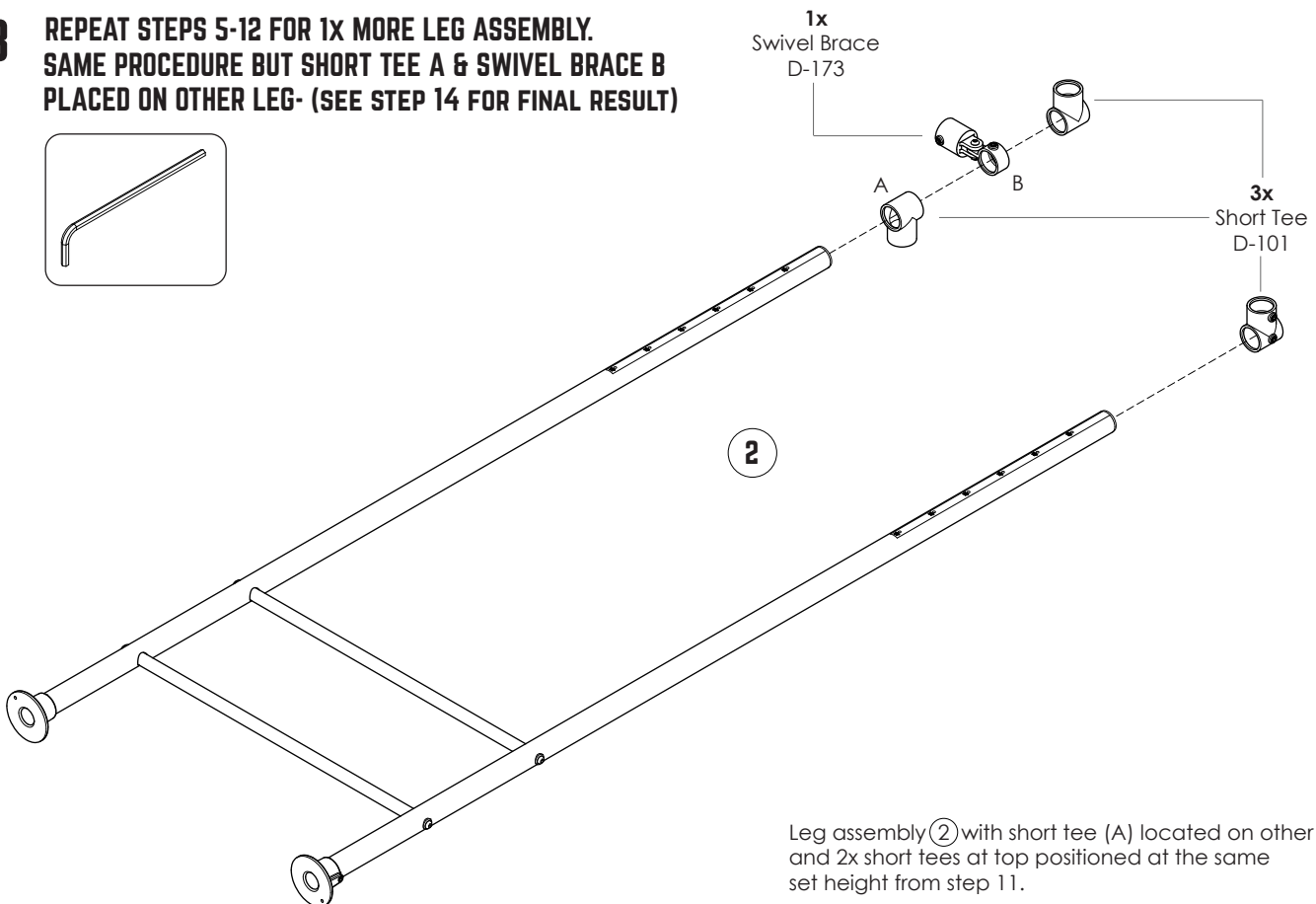
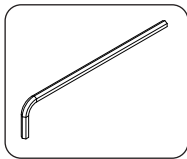

Leg assembly ② with short tee (A) located on other leg and 2x short tees at top positioned at the same set height from step 11.



# 14 LEG ASSEMBLY x2.

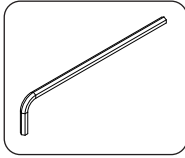

Stand legs up with top tees facing each other.  
Check all grub screws are fully tightened.  
Leave short tee 'A' and brace  
swivel 'B' hand tight only.

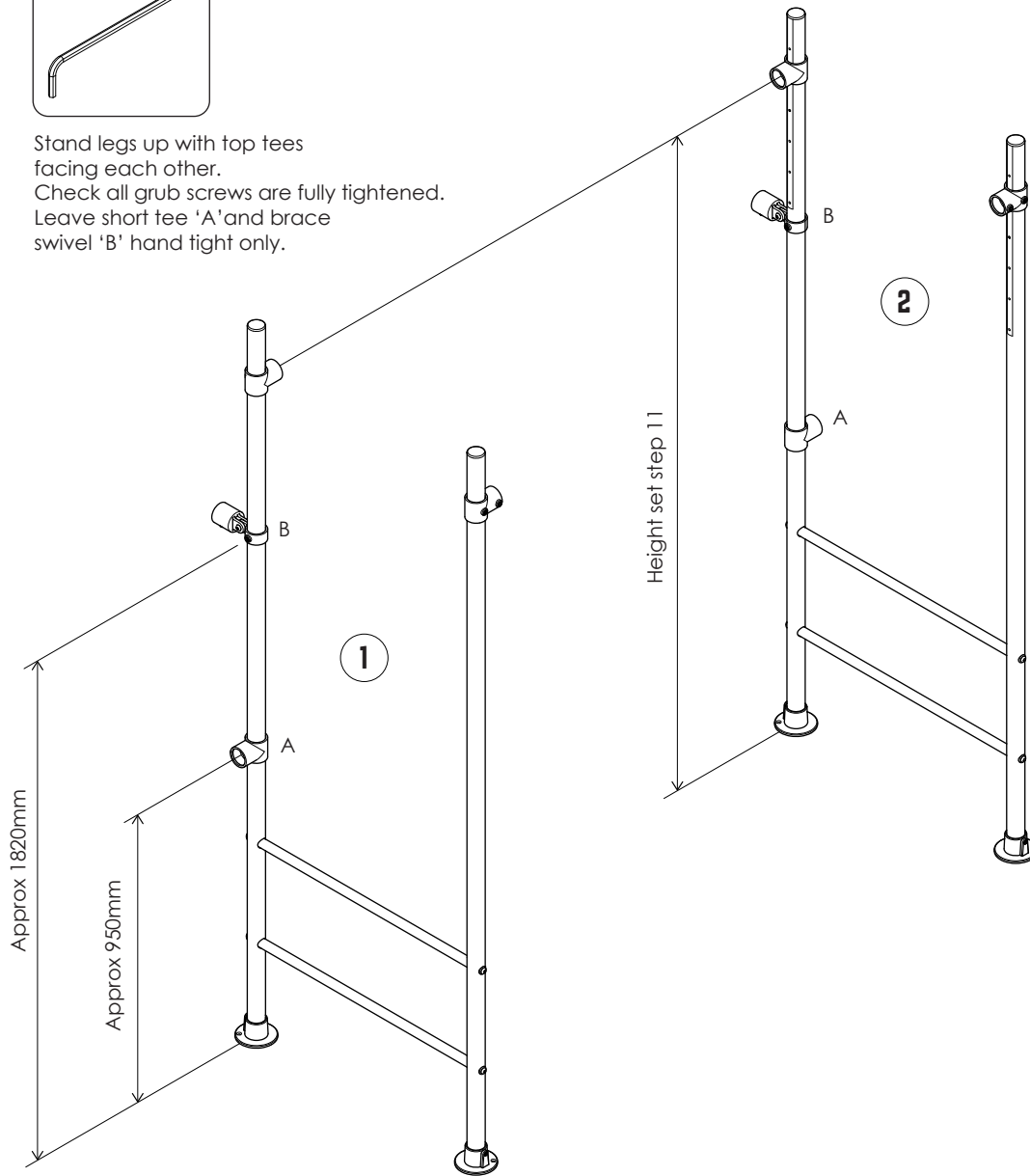

# 15 CHECK ALL FITTING GRUB SCREWS AND RUNG BOLTS ARE FULLY TIGHTENED

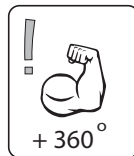
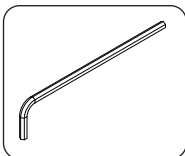

Firmly tighten all grub screws and bolts,  
Leave short tee A loose.

## 16 FLIP LEGS 1 & 2 OVER

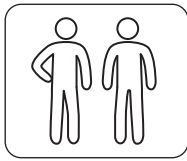

For the following step the legs should be flipped over & attached one at a time.

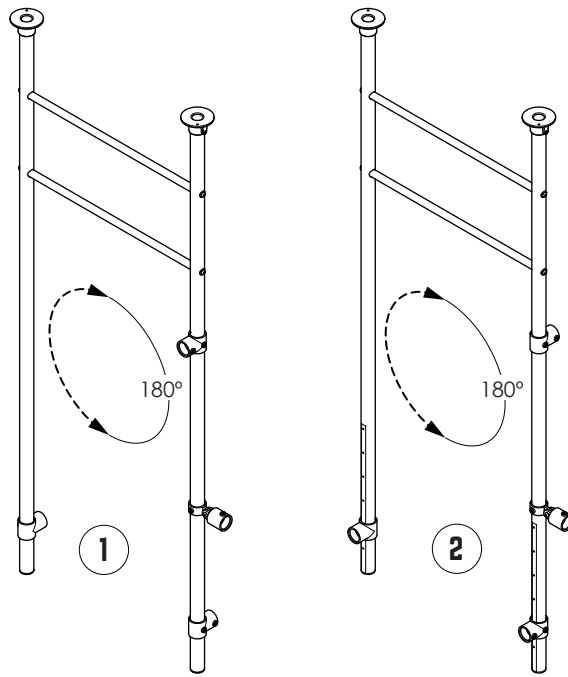

## 17 ATTACH 2x LEGS TO LADDER

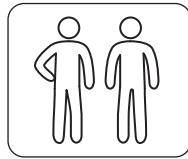
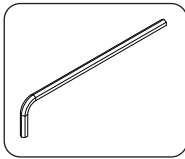

1. Attach first set of legs ① - tighten all grub screws.
2. Attach second set of legs ② - tighten all grub screws.

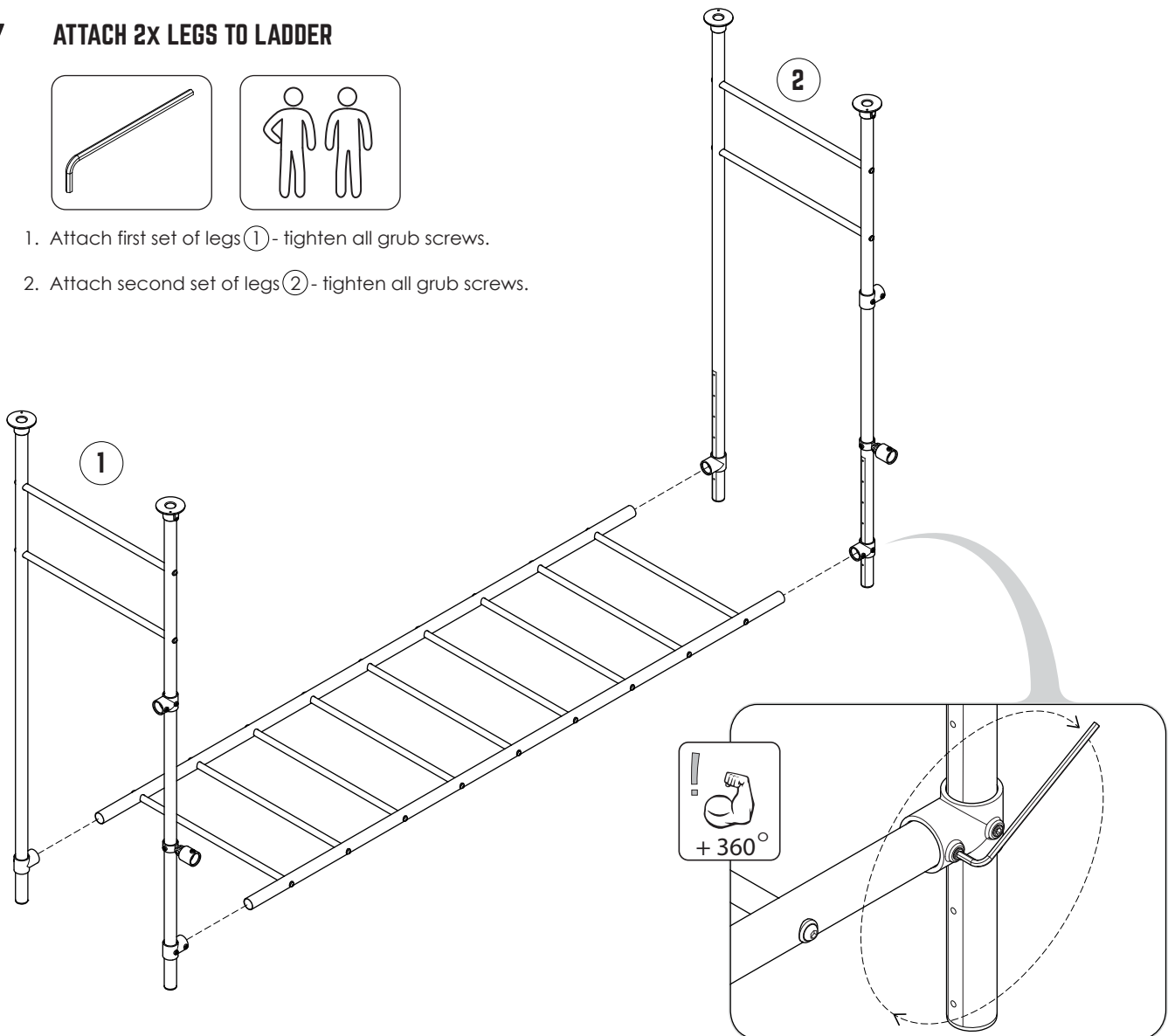

## 18 FLIP ASSEMBLY OVER

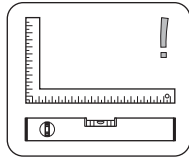
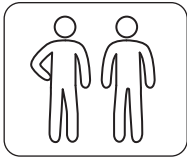

1. With 2 people flip the assembly over on its base plates.
2. Check that it is square and level.

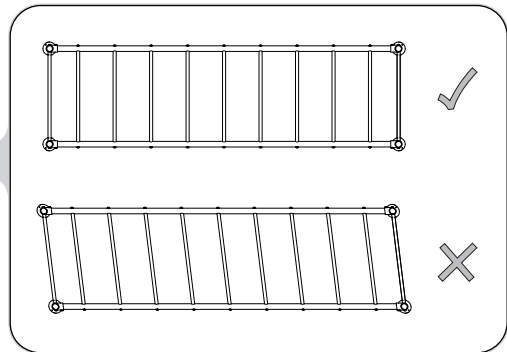
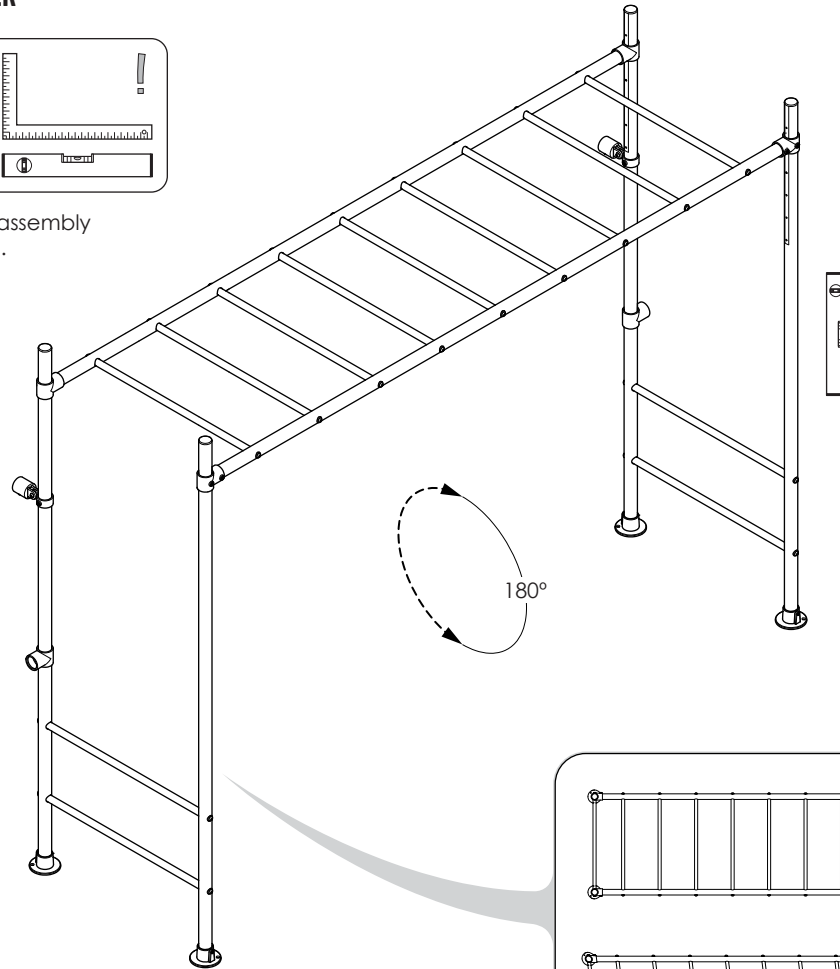

**CRITICAL : ENSURE YOUR FRAME IS 100% SQUARE AND LEVEL (AS PER PAGE 6) BEFORE MOVING ONTO THE REST OF THE ASSEMBLY**

## 19 SECURE TO GROUND

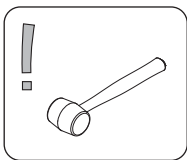

1. Move into selected suitable location with adequate fall zone. (refer to page 4).
2. Hammer in pegs x4.

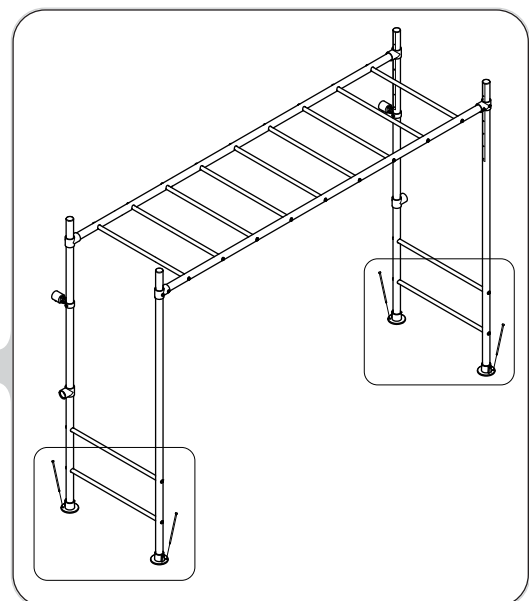
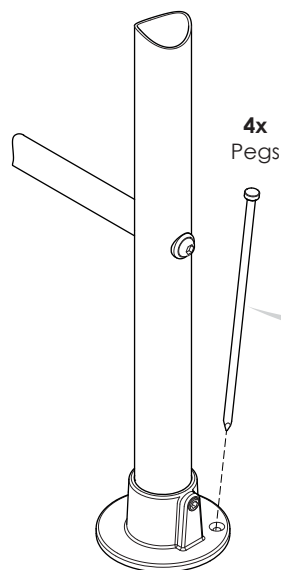

## ASSEMBLY INSTRUCTIONS - SWING BAR ASSEMBLY

### 20 ASSEMBLE SHORT SWING BARS

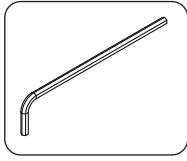

1. On flat level ground slide on all fittings and fully tighten extra long tee (D-104L) grub screws onto swing bar tube. Ensure the extra long tee is centrally located as per the detail below before tightening.
2. Leave short tees hand tight only for assembly adjustment in a later step (approx 825mm from end).

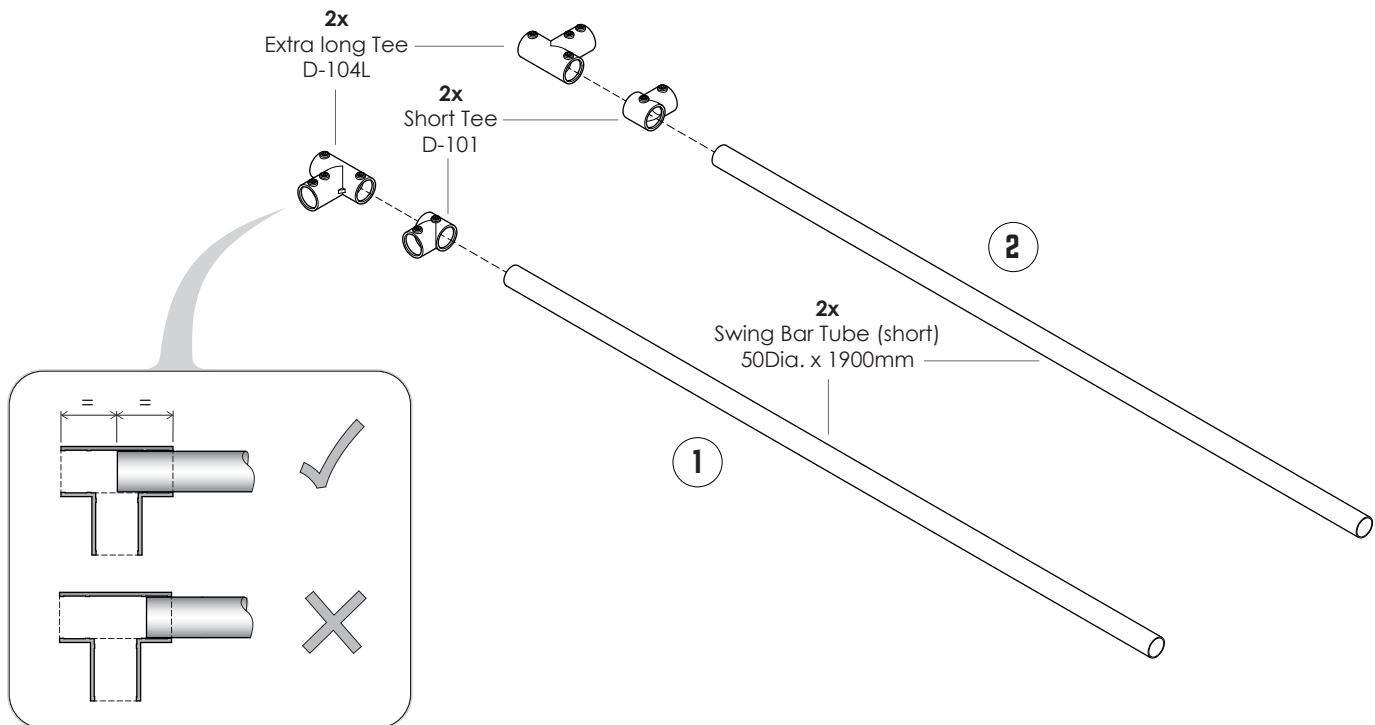

Ensure the swing bar is inserted half way into extra long tee.

### 21 2X ASSEMBLED SHORT SWING BARS

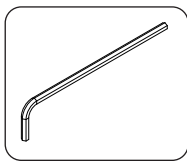

Rotate swing bars into ready position & roughly locate fittings as shown.

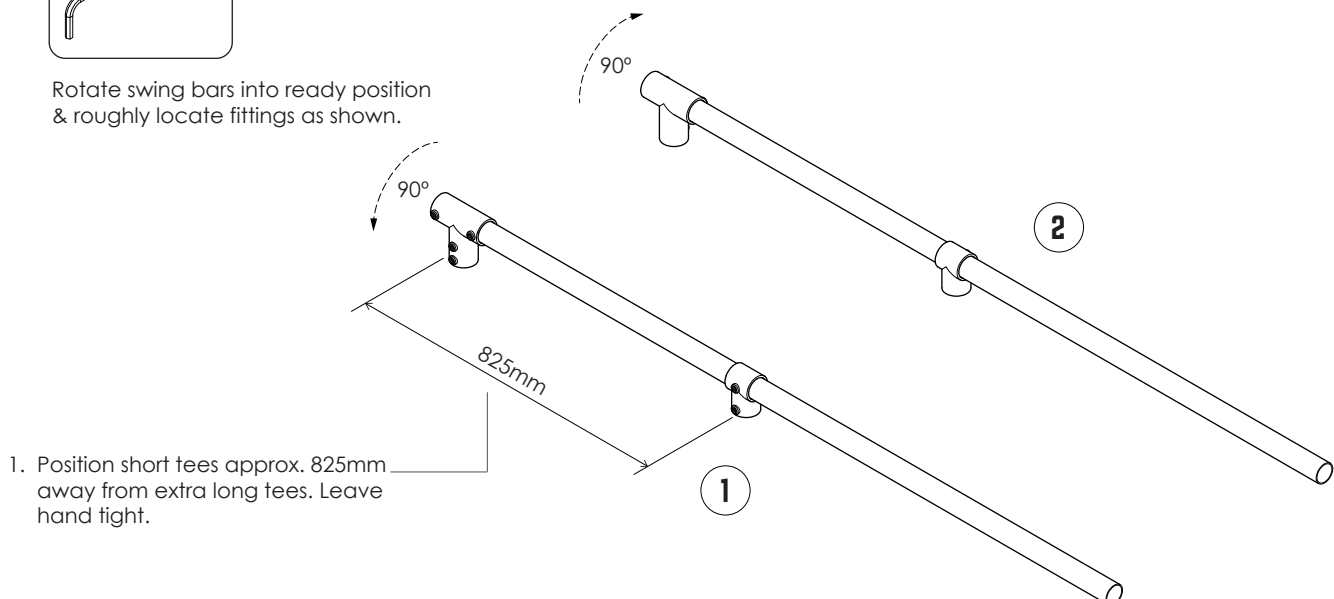

1. Position short tees approx. 825mm away from extra long tees. Leave hand tight.

## 22 ATTACH SHORT SWING BARS

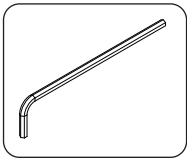

Fit short swing bar assemblies from step 21 to the top of the main monkey bar legs, check they are level then fully tighten all grub screws.

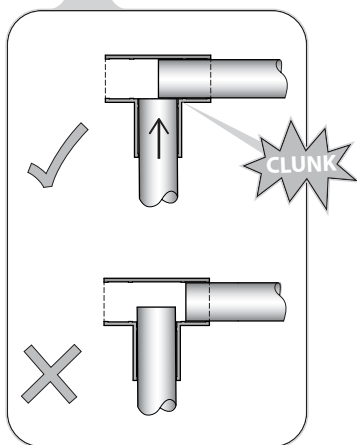
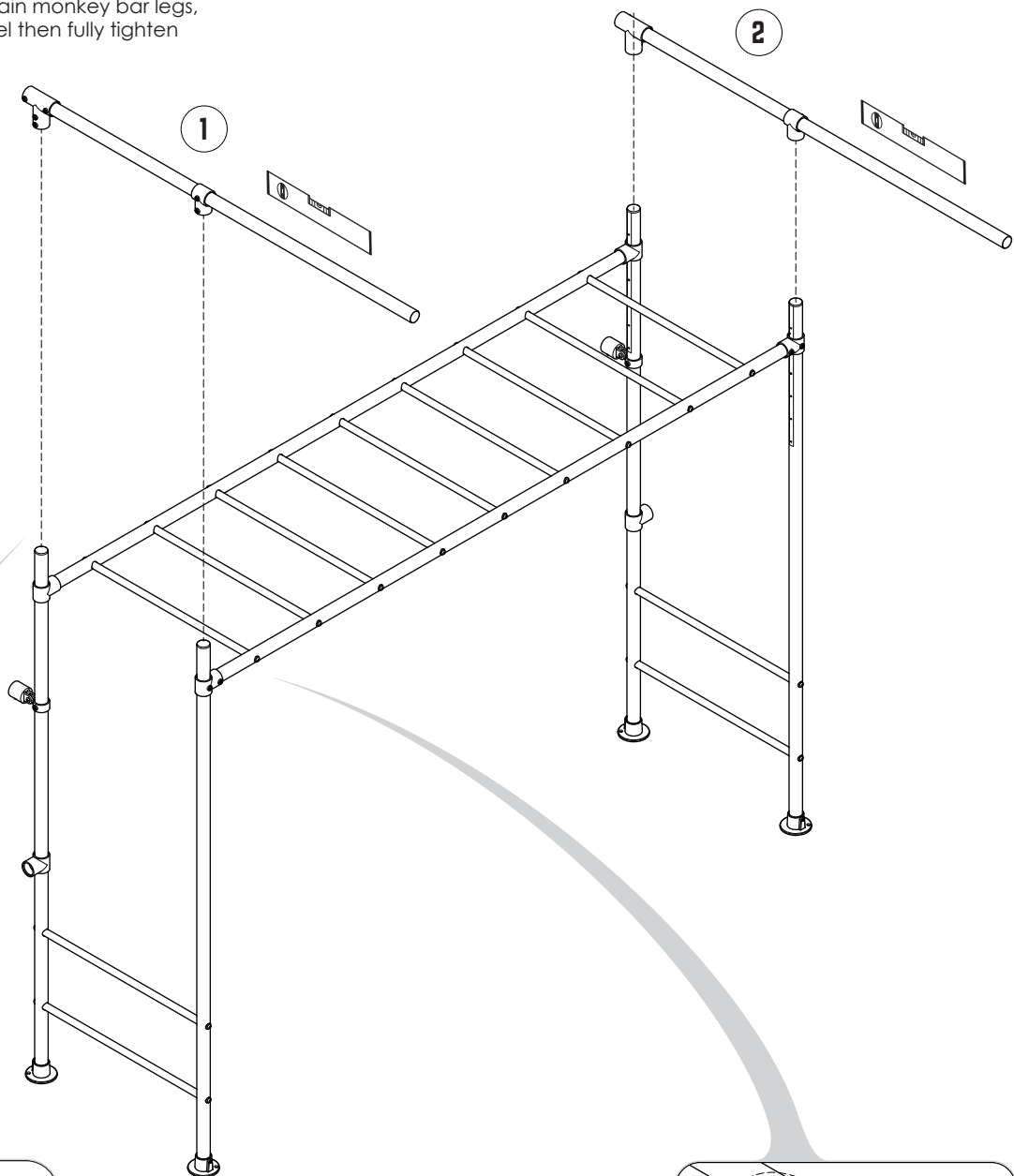

Ensure the extra long tee is correctly fitted.

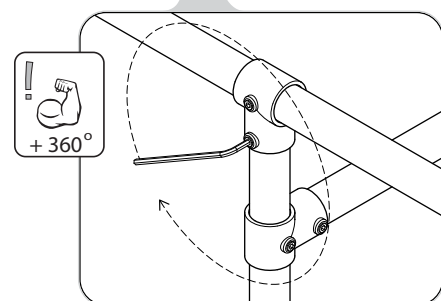

Fully tighten all grub screws.

# ASSEMBLY INSTRUCTIONS - ACCESSORIES BAR ASSEMBLY

## 23 ASSEMBLE ACCESSORIES BARS X2

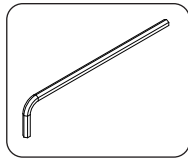

1. On flat level ground slide on 4 long short tees. Fit rocket rings onto bar.
2. Correctly fit the long short tees as shown then firmly tighten elbow & all grub screws.

2x Long Short Tee D-101L

2x Accessories Tube 50Dia. x 2950mm

2x Rocket Rings

2x Long Short Tee D-101L

Ensure accessories tube is not over inserted into extra long tees & is level with through hole.

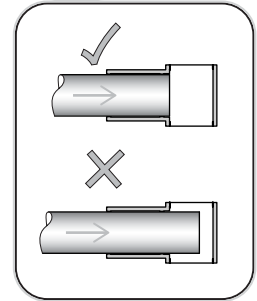

## 24 ATTACH ACCESSORIES BARS

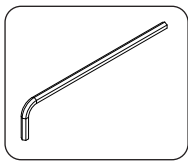

1. Flip assembled accessories bars over 180° so that long short tee grub screws are facing downwards.
2. With 2 people carefully slide the accessories bars onto the swing bars. Centrally locate and separate by approximately 350-500mm. (user preference)
3. Check it is square and level then tighten all grub screws.

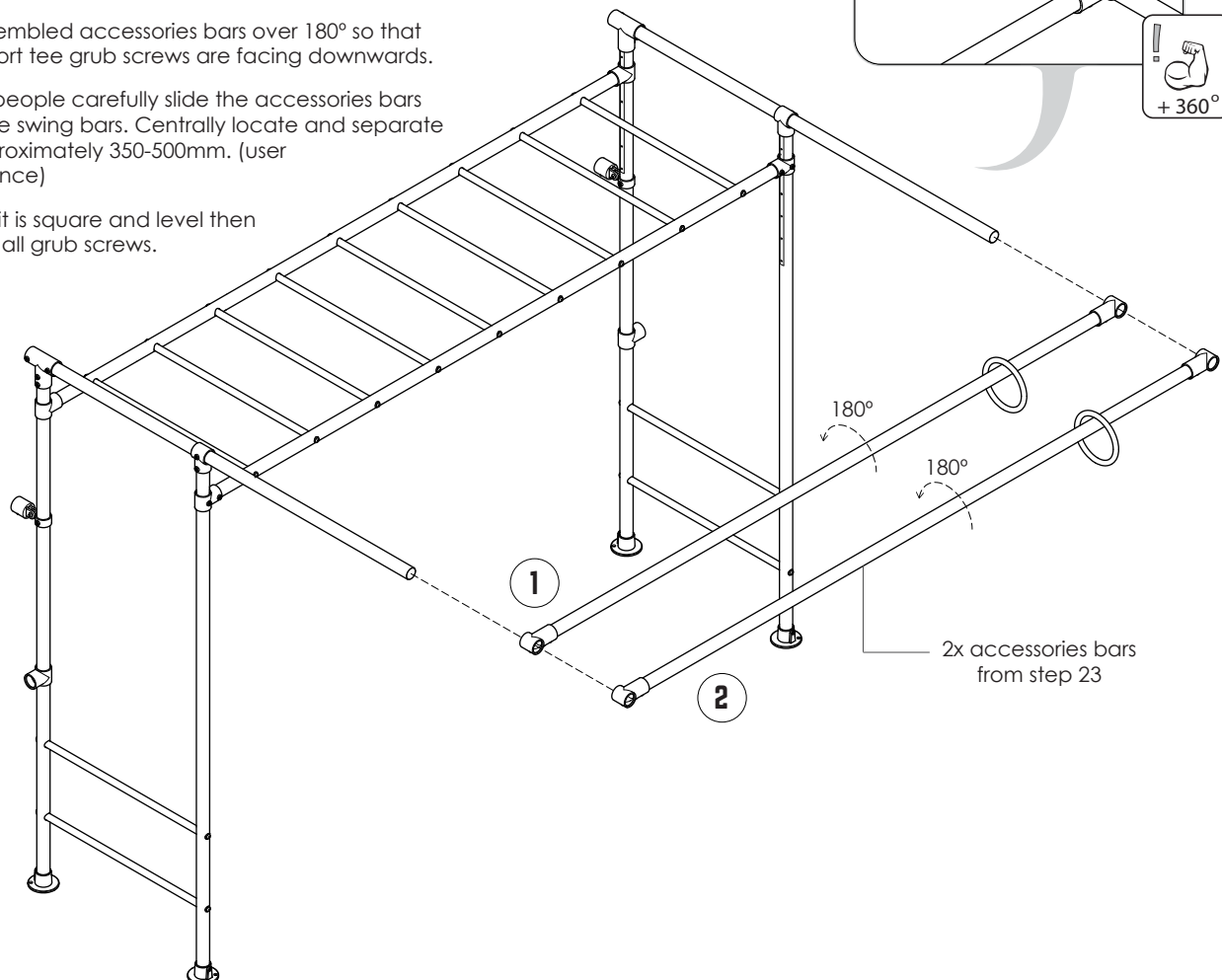
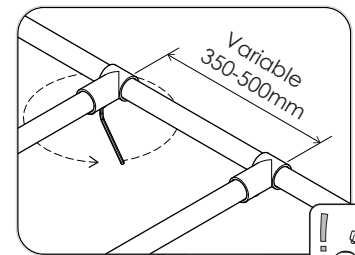

2x accessories bars from step 23

## 25 ATTACH ACCESSORIES SUPPORT TUBE

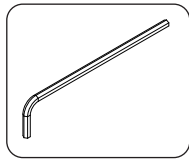

1. On flat level ground feed the accessories tubes through the long side cargo net hoops. Slide long short tees onto the ends of the accessories tubes.
2. Ensure the long short tees are correctly fitted.
3. Leave grub screws hand tight only

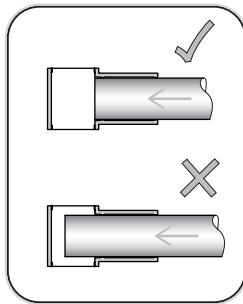

Ensure accessories tube is not over inserted into extra long tees & is level with through hole.

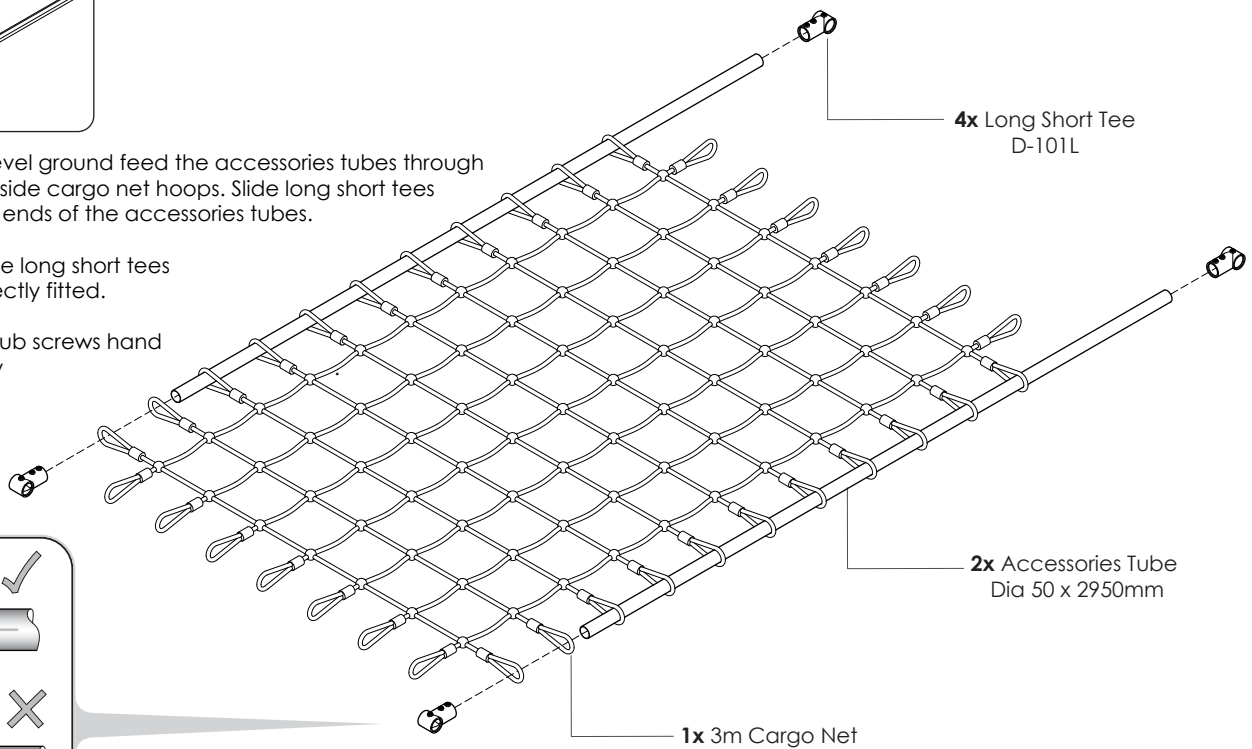

## 26 ATTACH CARGO LEG TUBES

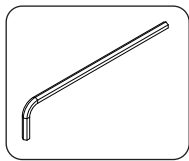

1. Feed the leg tubes through the accessories support tube long short tees, side cargo net hoops and short tees A & B. A & B (located between cargo hoops 2 & 3)
2. Attach elbows and base plates. Ensure they are fully inserted and fully tighten grub screws.
3. Ensure the elbows and top accessories support tube C are hard up together.
4. Fully tighten all grub screws. (Leave grub screws on D & E loose).

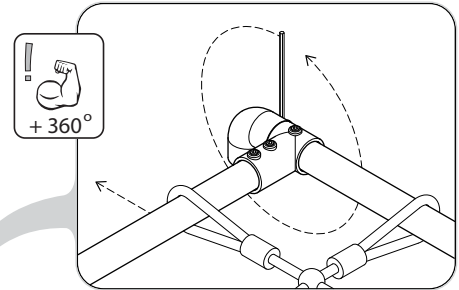

Fully tighten all elbow grub screws.

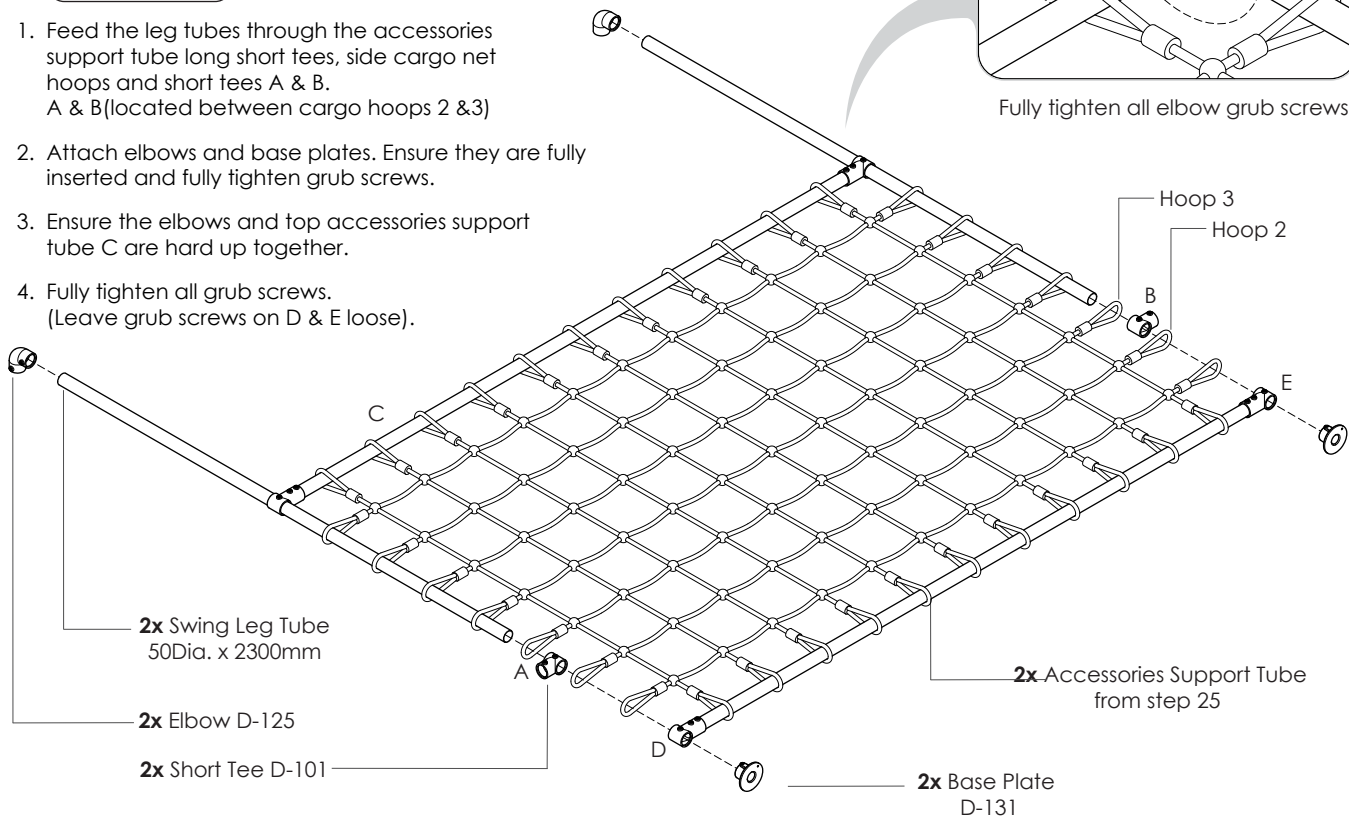

## 27 ATTACH CARGO NET INTO POSITION

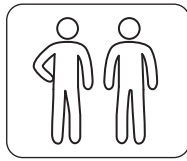
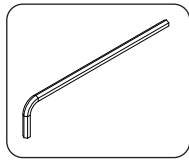

1. With 2 people lift the cargo net frame into position and fully insert elbows into the swing bars
2. Fully tighten all grub screws.

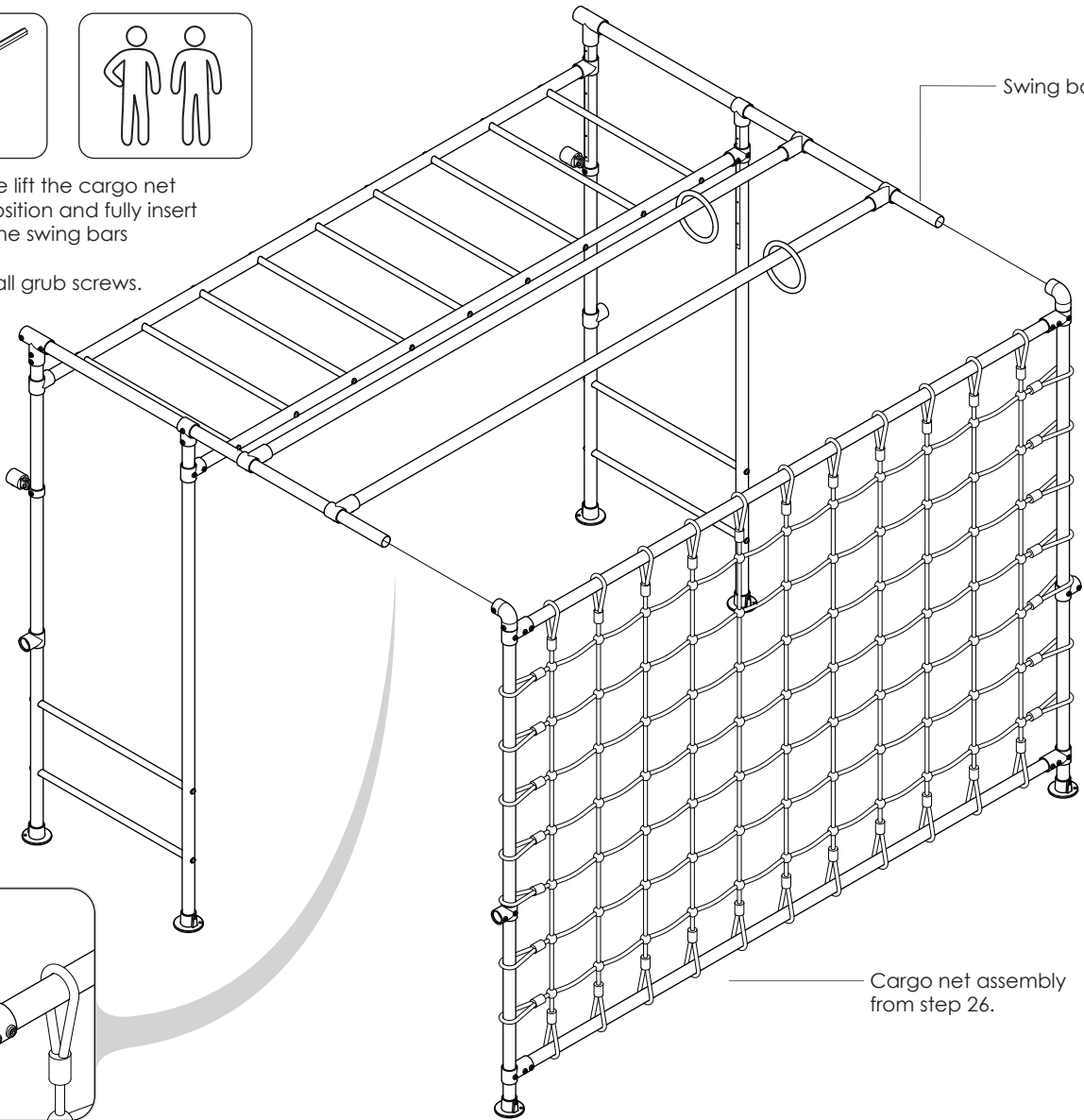
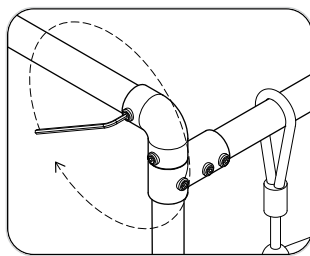

## 28 SECURE TO GROUND

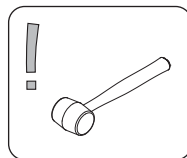
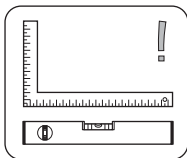

1. Check level and square.
2. Hammer in pegs x2.

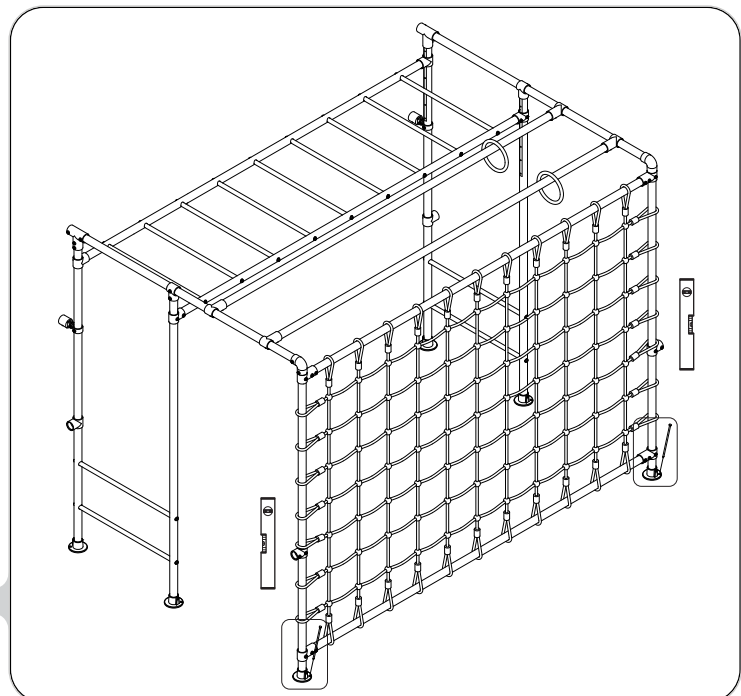
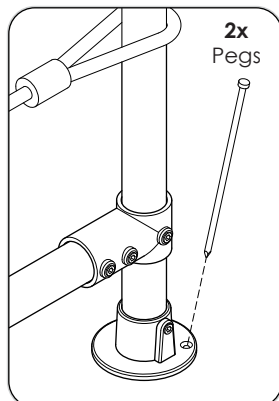



## 29 TIGHTEN CARGO NET

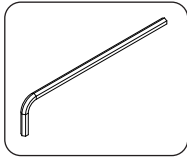

1. Loosen outside grub screws on long short tees A & B connecting to leg.
2. Get a second person to stand on lower tube to make cargo net taught and level.
3. Fully tighten all grub screws on long short tees A & B.

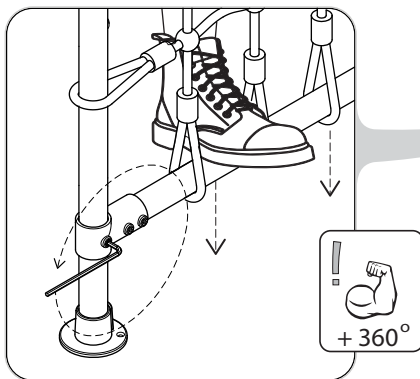
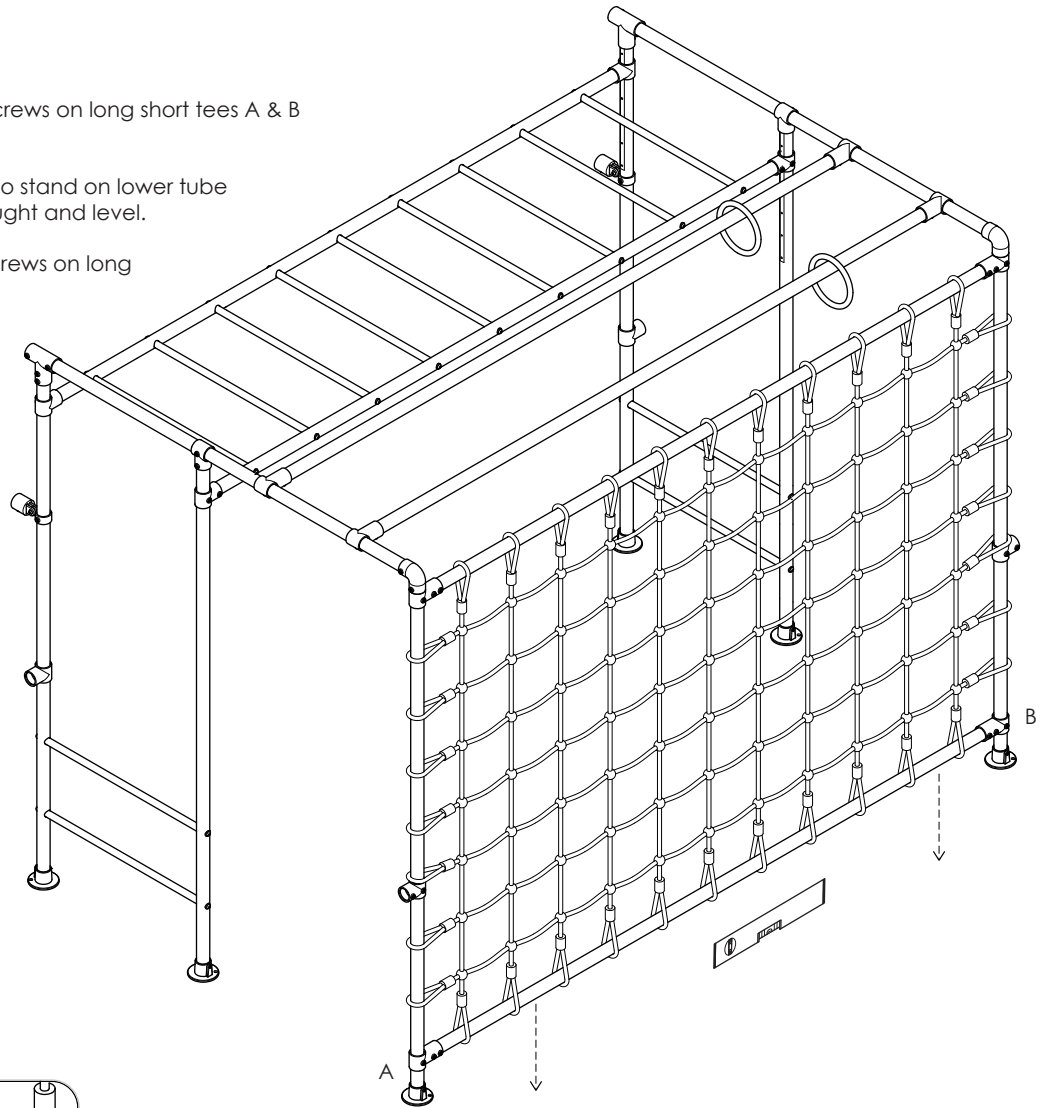

**30** THE FOLLOWING STEPS ARE PERFORMED ON THE OTHER SIDE OF THE FRAME.  
FOR DRAWING CLARITY THE VIEW WILL BE ON THE OTHER SIDE FROM HERE ON FORTH.

# ASSEMBLY INSTRUCTIONS - FLOATING ACCESSORIES BAR ASSEMBLY

## 31 ASSEMBLE EXTENSION TUBES

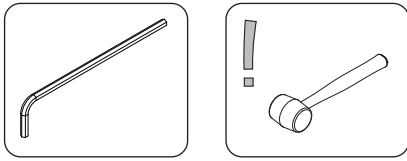

1. Tap end caps into extension tube ends.

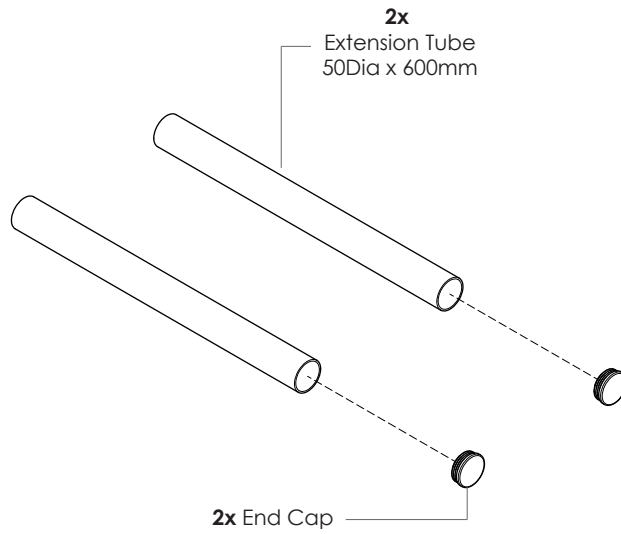

## 32 ATTACH EXTENSION TUBES

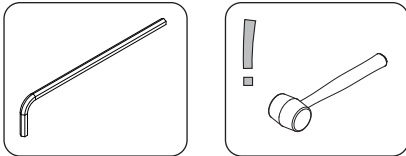

1. Fully insert extension tubes into extra long tees. Plastic end cap facing outwards.
2. Tighten grub screws

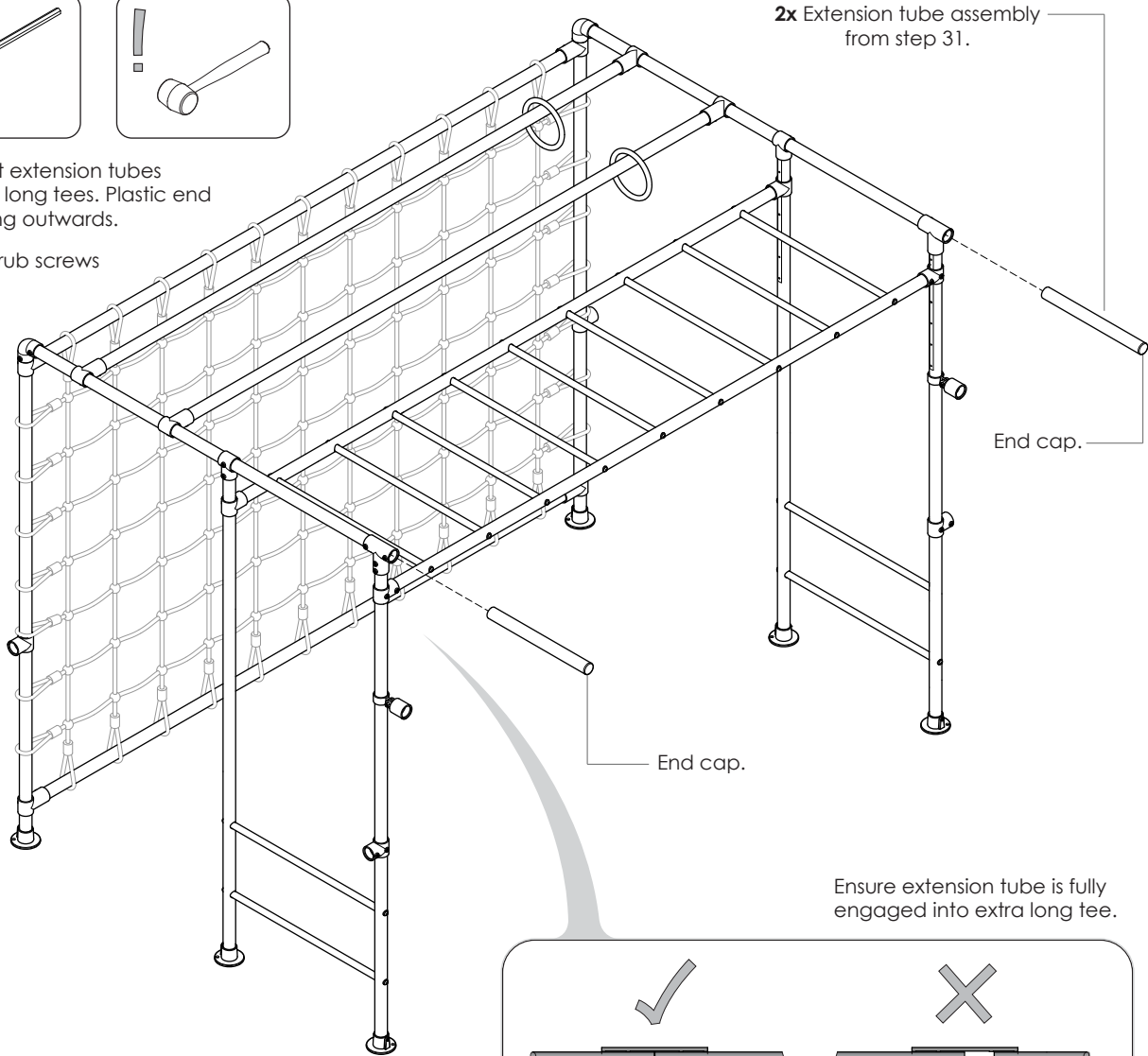

Ensure extension tube is fully engaged into extra long tee.

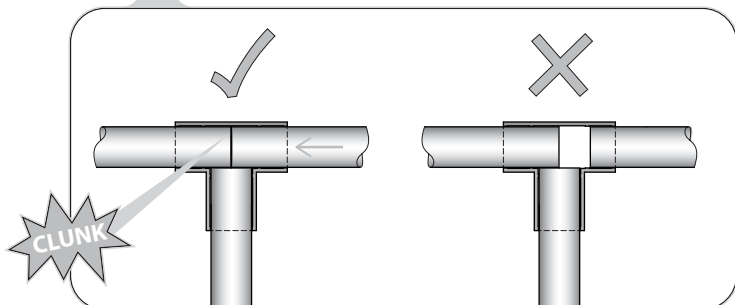

### 33 ASSEMBLE ACCESSORIES BAR

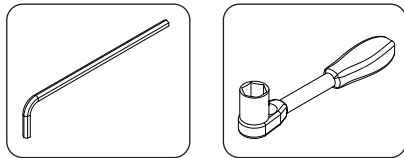

1. Evenly space swing hooks along accessories tube (approx. 600mm). Fasten swing hook bolts with ratchet (17mm socket).
2. Slide swivel brace and extra long tee on at each end.
3. Fit extra long tee correctly as shown.
4. Fully tighten grub screws. Leave grub screws hand tight on swivel brace for later adjustment.

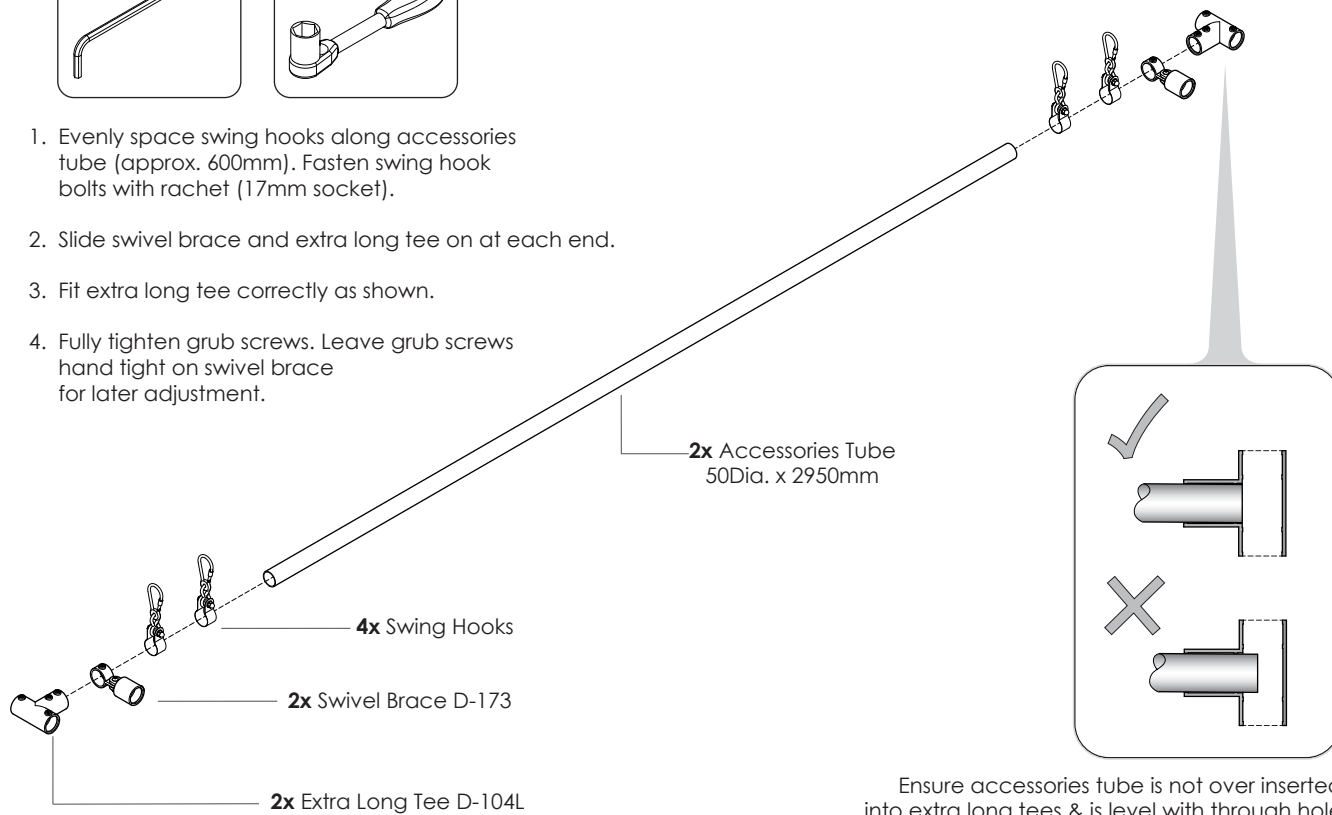

Ensure accessories tube is not over inserted into extra long tees & is level with through hole.

### 34 ATTACH BRACE BARS

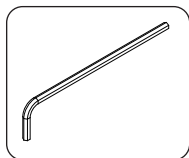

1. Flip accessories bar over so that grub screws are facing downwards.
2. Fully insert brace bars into swivel brace and fully tighten grub screws. Leave grub screw A & B fixing swivel brace to accessories bar loose for adjustment in following steps.

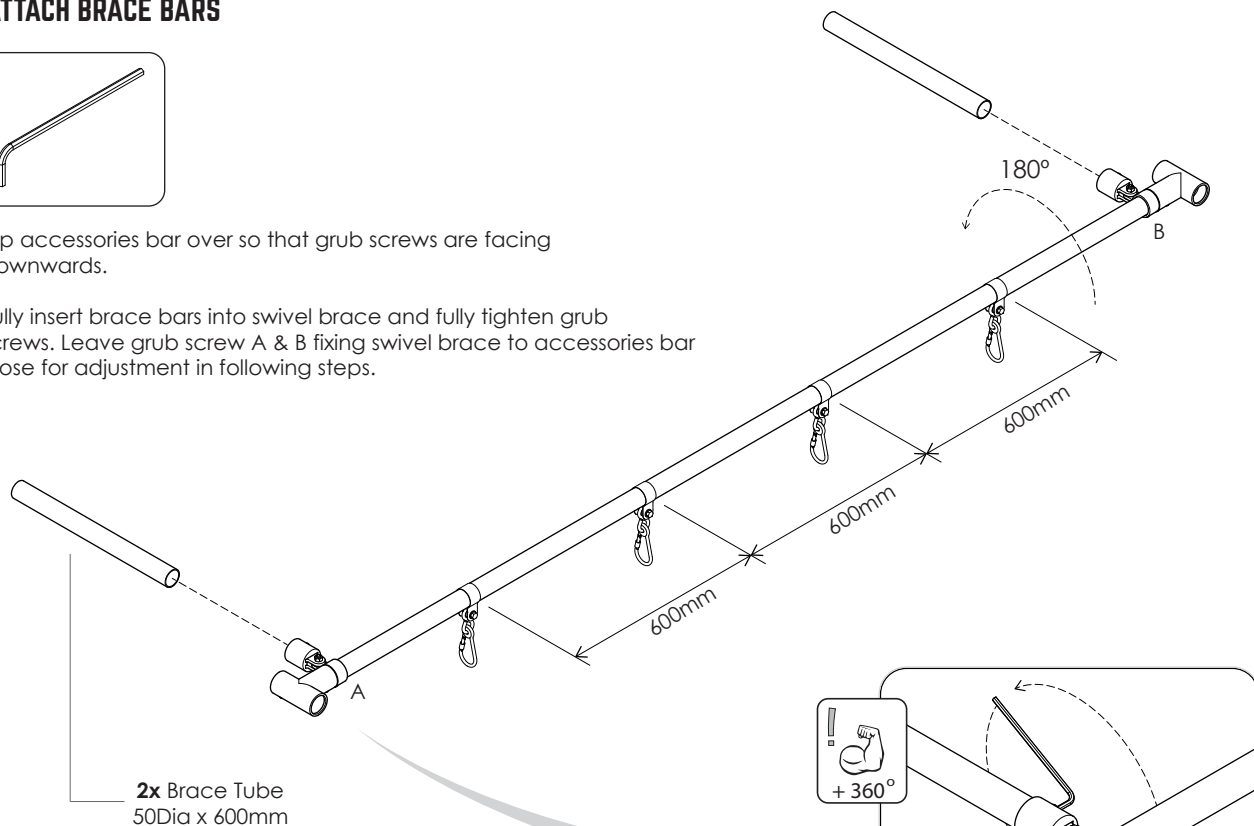

Fully tighten grub screws, leave 'A' loose

## 35 ATTACH FLOATING ACCESSORIES BAR

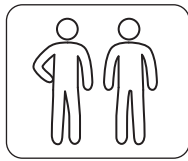
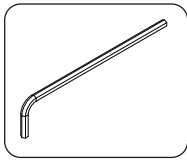

1. With 2 people slide on floating accessories bar.
2. Align plastic end cap on extension tube with edge of extra long tee and fully tighten grub screws.
3. Leave brace tubes hanging loose.

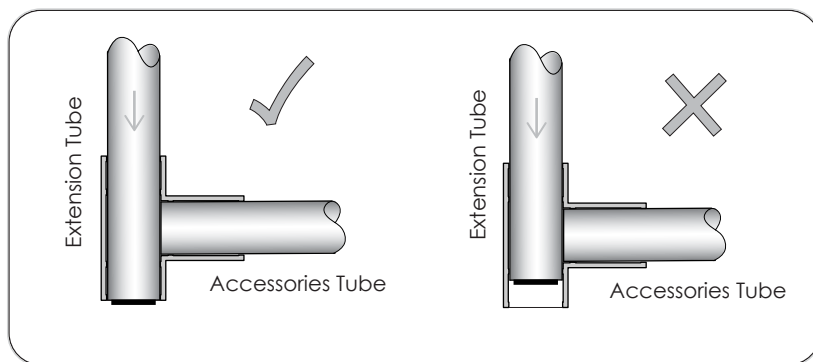
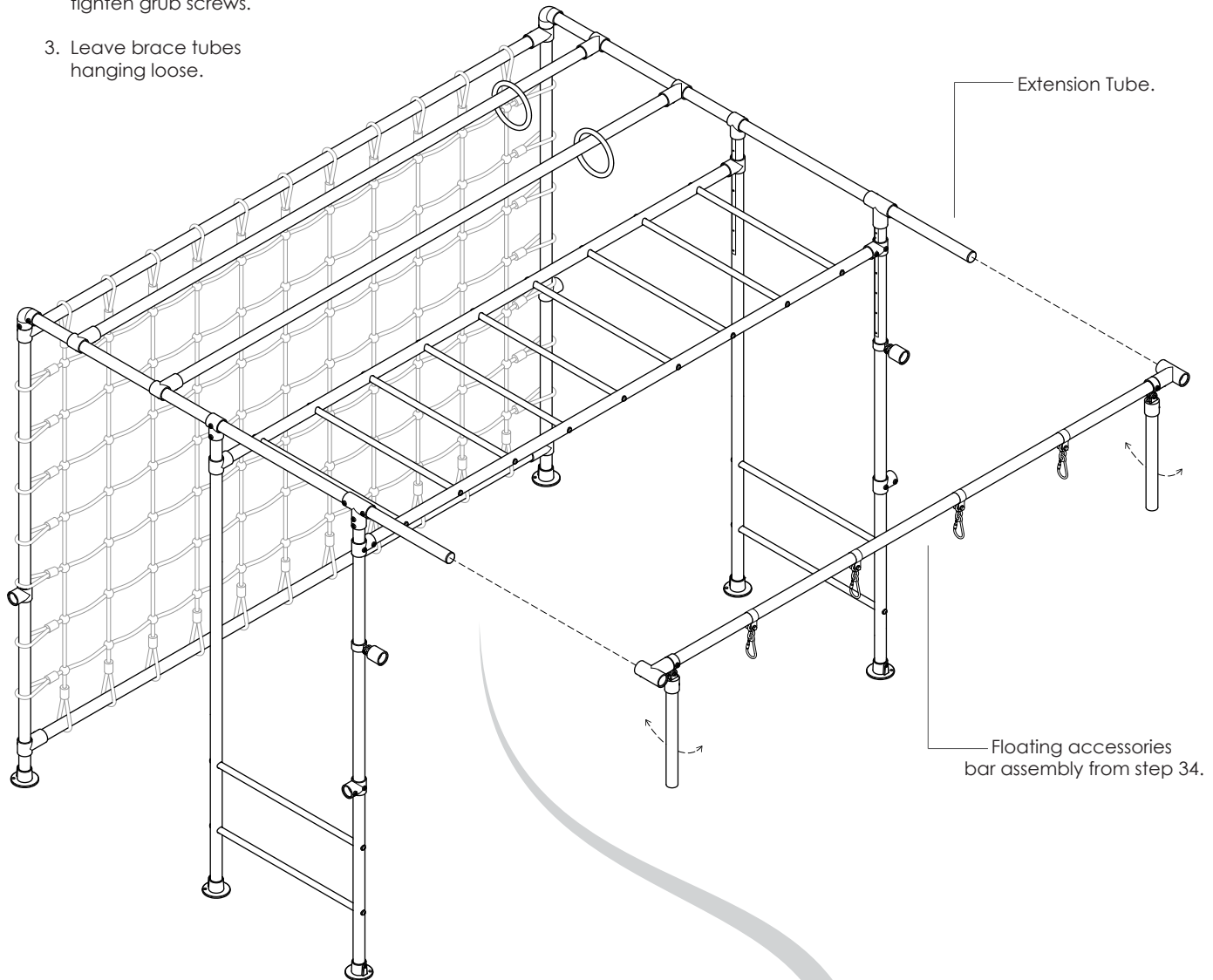

Align end cap with end of extra long tee.

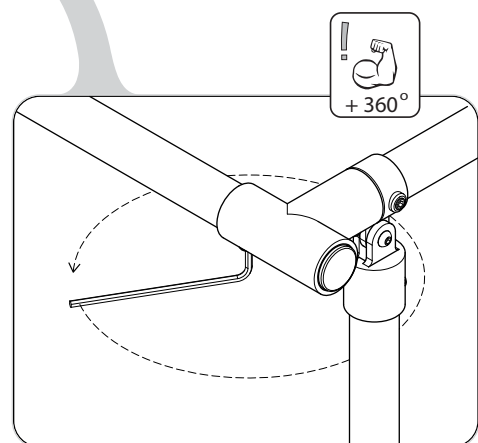

Fully tighten all extra long tee grub screws.

## 36 CONNECT THE BRACE TUBES.

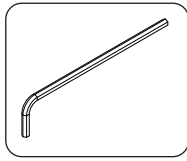

1. Following the order of steps below, fit 2x brace tubes into position by rotating and sliding swivel brace fittings on the swing legs.
2. Fully tighten all grub screws.

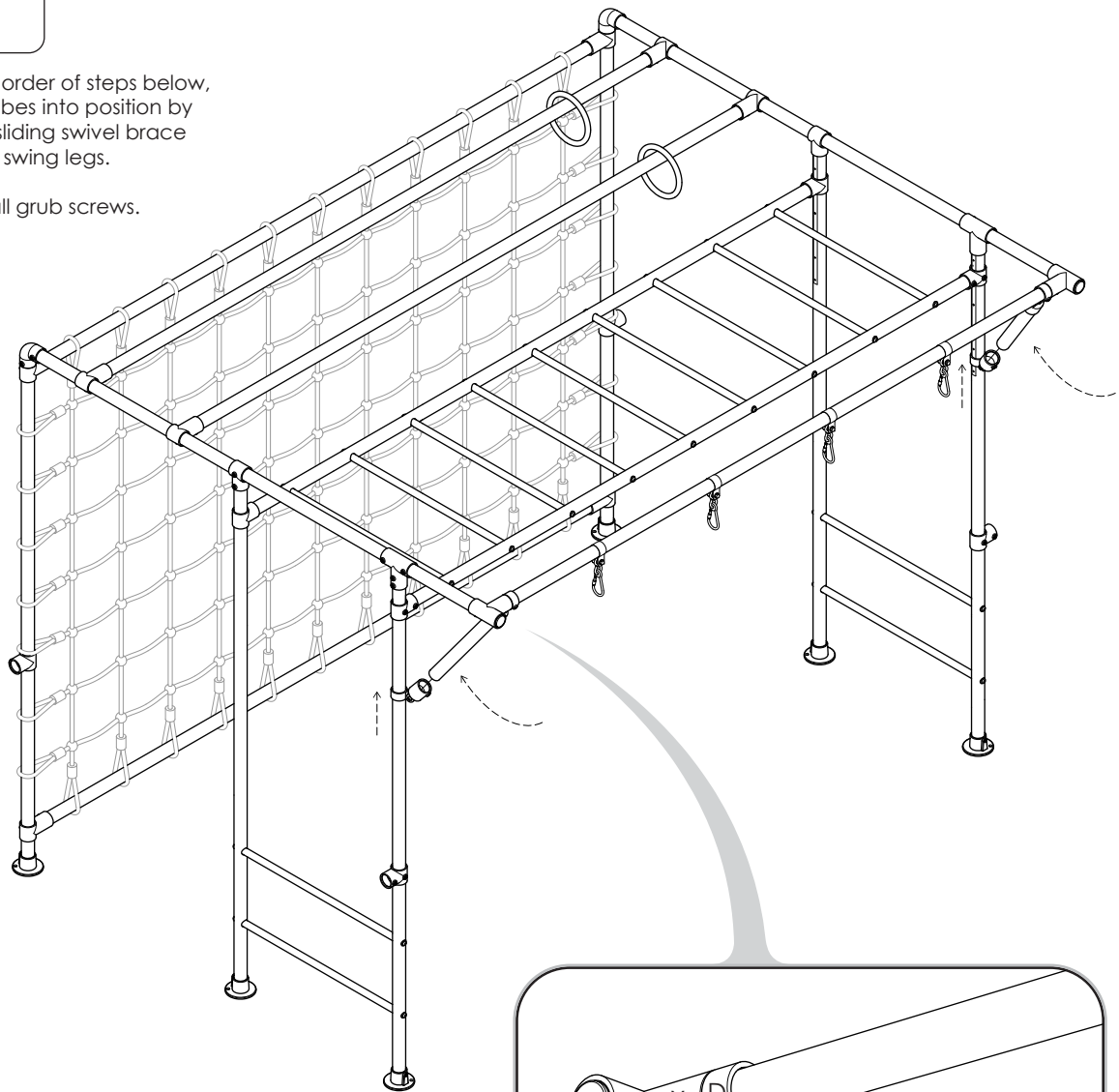

### ORDER OF STEPS:

1. Slide brace tubes into swivel braces (A)
2. Tighten grub screws on (A) & (B).
3. Slide (D) hard up against extra long tee (X).
4. Tighten grub screw on (D)
4. Slide (C) towards extra long tee (Y).
5. Tighten grub screws on (C) whilst pushing (C) towards (Y).
6. Ensure the top extension bar is level.

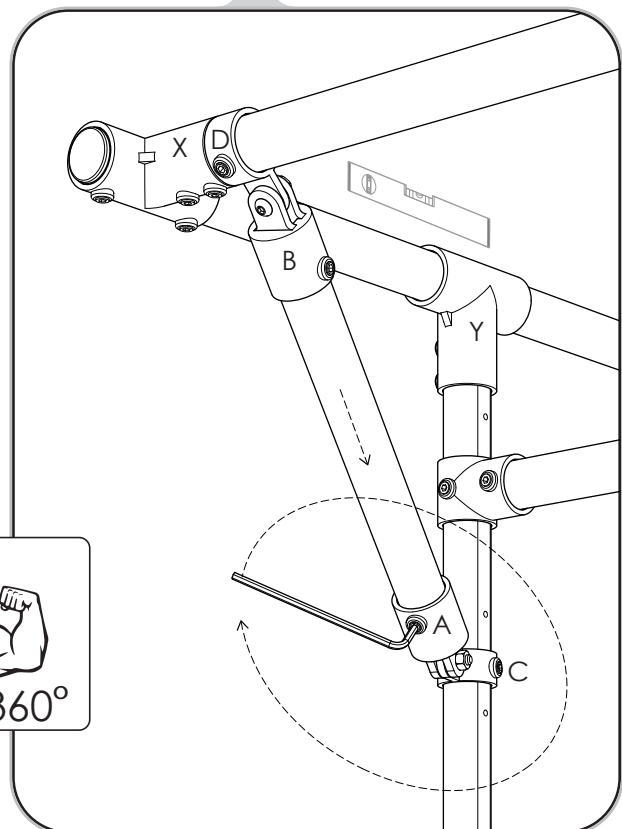

**APPLY TO BOTH ENDS**

# ASSEMBLY INSTRUCTIONS - TWIRLY WHIRLY BAR ASSEMBLY

## 37 ASSEMBLE VERTICAL TWIRLY TUBE

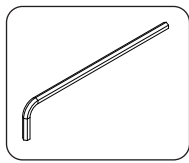

Tighten all grub screws.



1x  
Elbow  
D-125



1x  
Twirly Tube  
50Dia x 900mm



1x  
Base Plate  
D-131

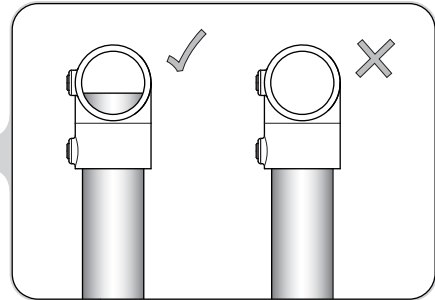

Insert Twirly Tube fully into Elbow.

## 38 ATTACH HORIZONTAL TWIRLY TUBE

Fully insert twirly tube then firmly tighten all grub screws.

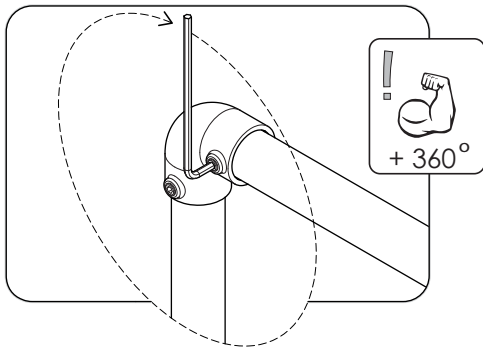

1x  
Twirly Tube  
50Dia x 900mm

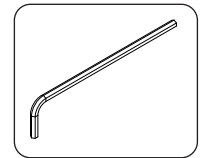

## 39 REPEAT STEPS 37 - 38 FOR 3 MORE TWIRLY WHIRLY BARS.

## 40 TWIRLY WHIRLY BAR x4

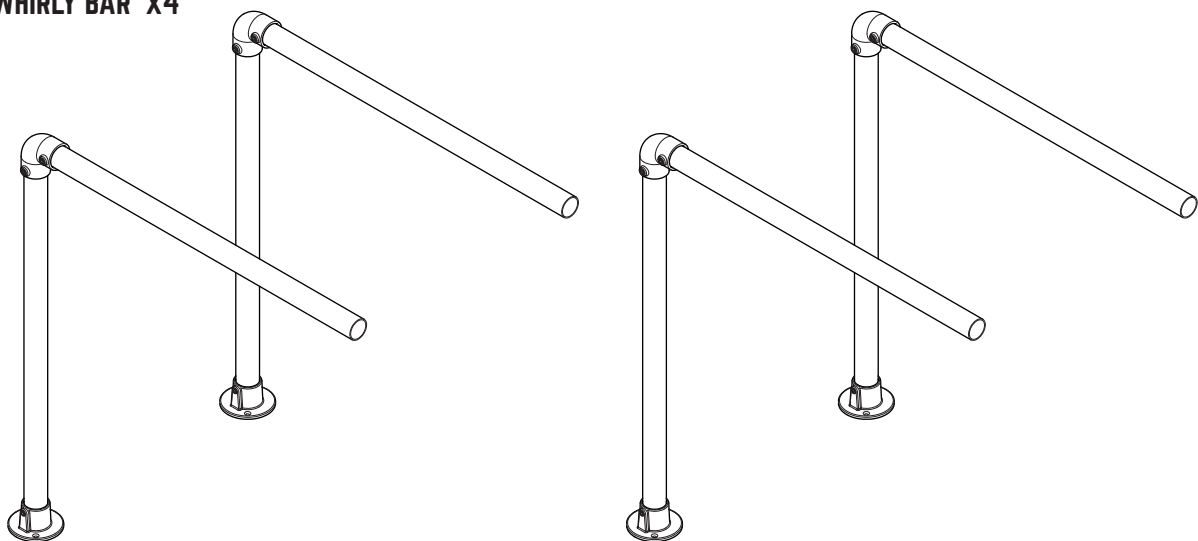

## 41 ATTACH TWIRLY WHIRLY BARS x4

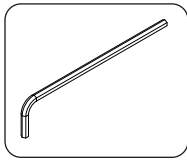

1. Adjust short tees to align level with twirly whirly bars
2. Tighten all grub screws fixing twirly whirlys to legs.

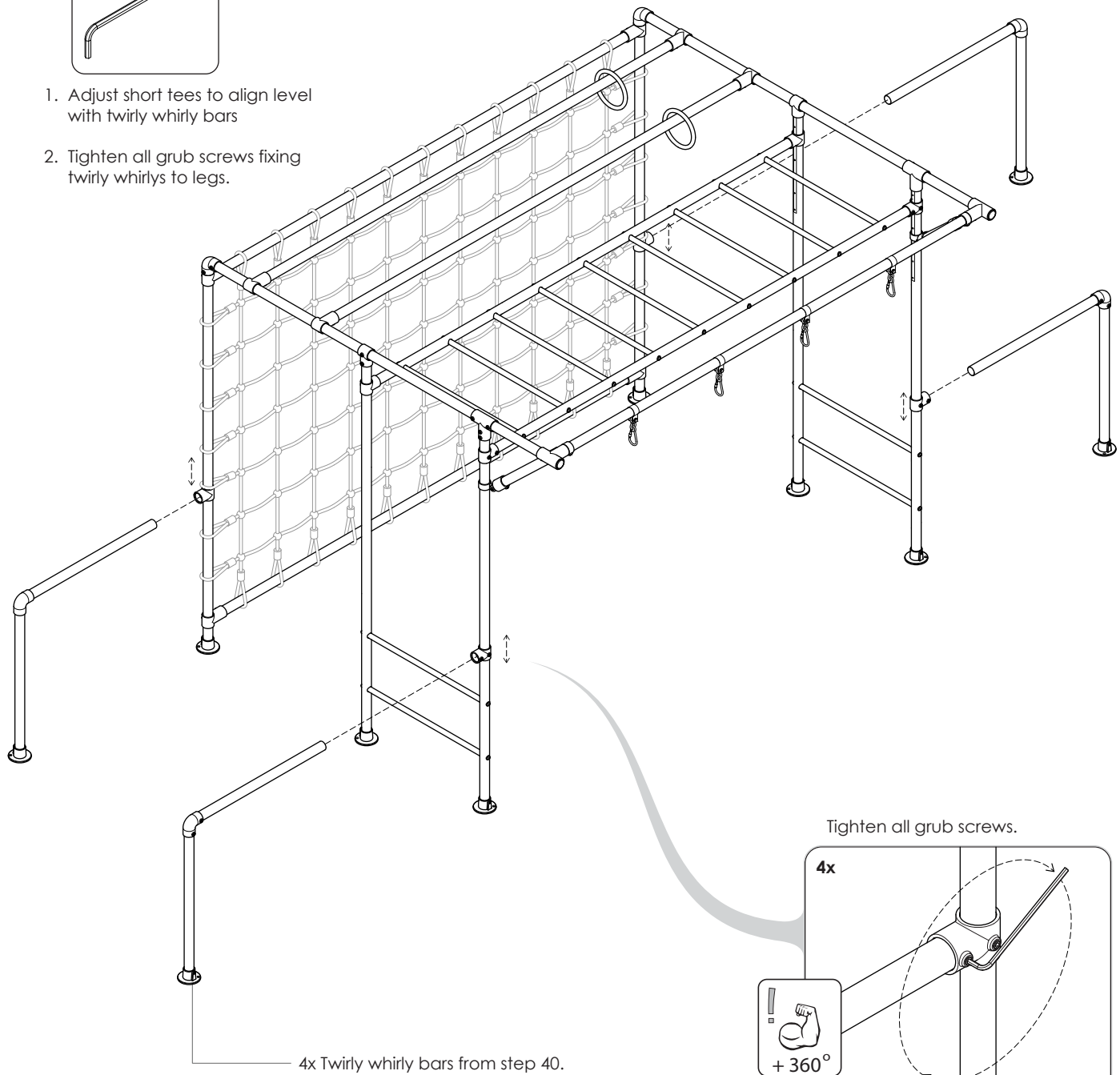

## 42 CHECK ALL FITTING GRUB SCREWS ARE FULLY TIGHTENED

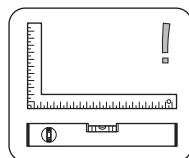
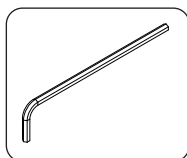

1. Ensure frame is square and level.
2. Firmly tighten all grub screws and bolts.

# ASSEMBLY INSTRUCTIONS - LOAD TWIRLY WHIRLY BARS

## 43 LOAD YOUR TWIRLY WHIRLY BARS x4

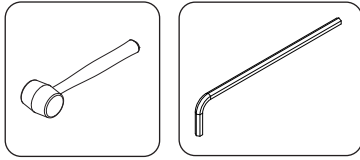

To reduce movement in your frame load your twirly whirly bars as follows.

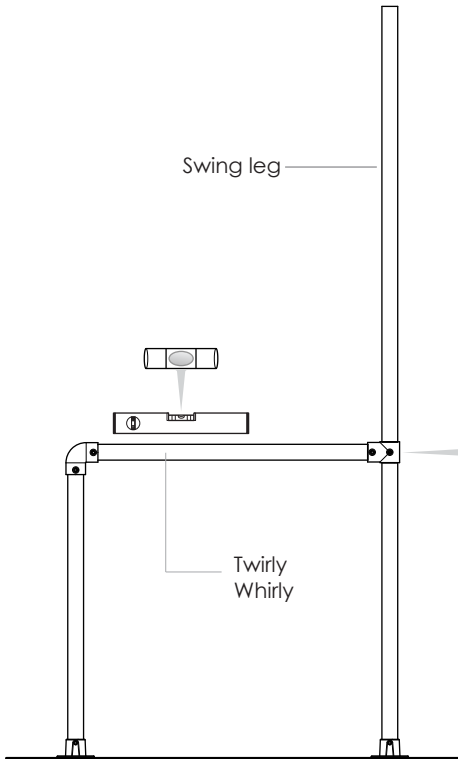

1. Ensure twirly whirly is level and square & swing leg is pegged down.

2. Loosen the grub screw fixing the short tee to the swing leg.

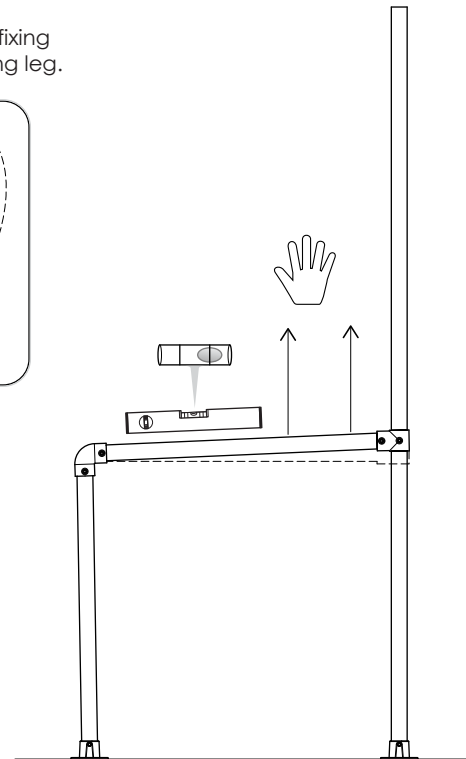
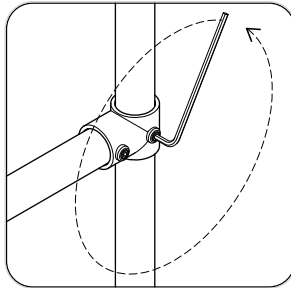

3. Pull upwards on the twirly whirly bar to make a slight angle. (Half a bubble off center on the level)

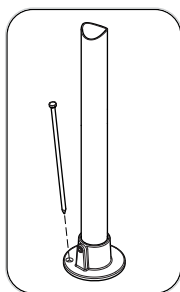

4. Peg down base plates on twirly whirly.

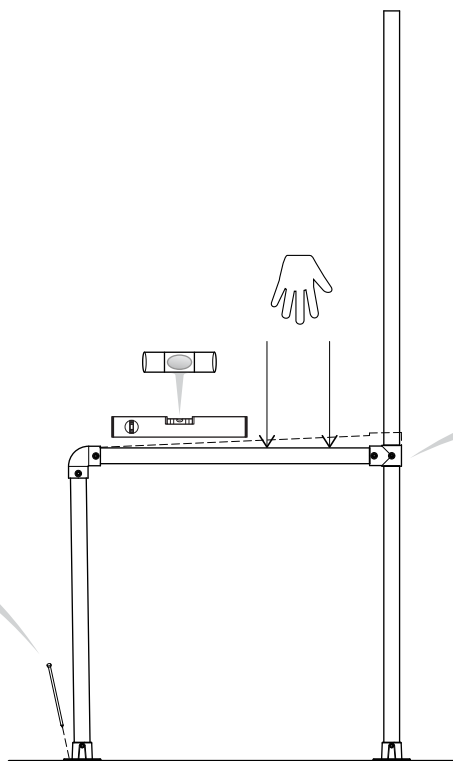

5. Push down on the twirly whirly bar until horizontal bar is level.

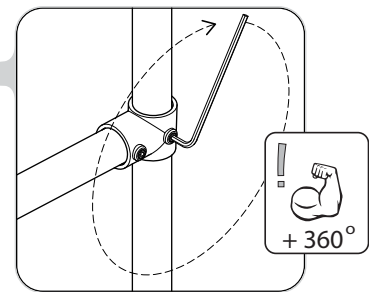

6. Tighten grub screw fixing the short tee to the swing leg tube. Apply to all twirly whirls.

REFER TO VIDEO SECTION OF WEBSITE [HTTP://WWW.FUNKYMONKEYBARS.COM/PAGES/VIDEOS](http://www.funkymonkeybars.com/pages/videos)



## 44 ATTACH ACCESSORIES (IF APPLICABLE)

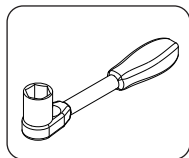

Attach new accessories in desired position (if applicable) and ensure swing hook bolts are tightened with a ratchet.

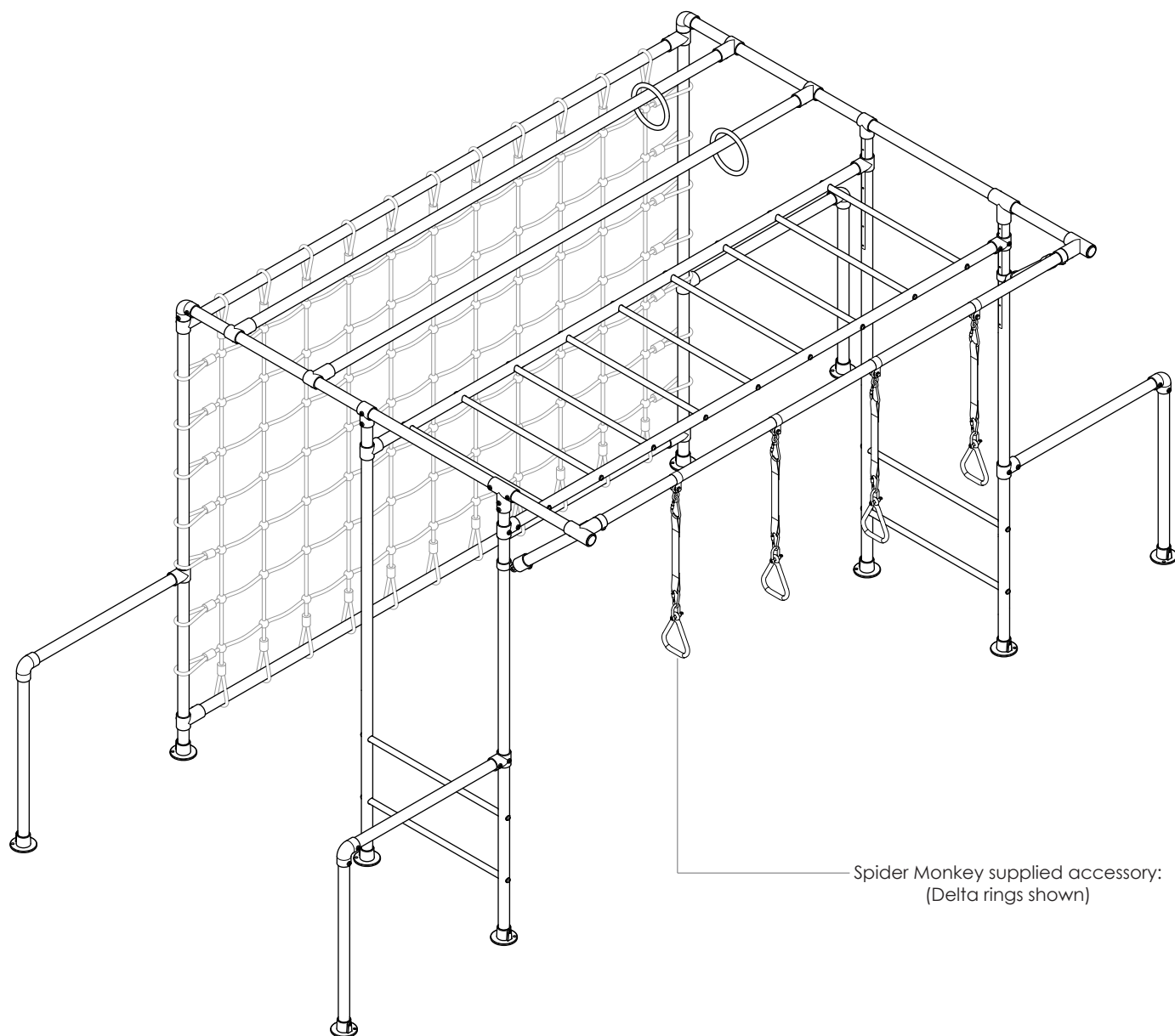

### REFER TO SEPARATE ACCESSORIES INSTRUCTIONS IF APPLICABLE

One of the best things about Funky Monkey Bars® is the ability to add new equipment and accessories as your child and family grows. You can swap or add accessories to your existing frame, or add extra frames that will give you more versatility to attach equipment. Check out what we've got in store now at...

[WWW.FUNKYMONKEYBARS.COM](http://WWW.FUNKYMONKEYBARS.COM)



## 46 FINAL CHECKS



1. Ensure frame is square and level.
2. Firmly tighten all grub screws and bolts.
3. All base plates are pegged down.

## 47 MAINTENANCE.

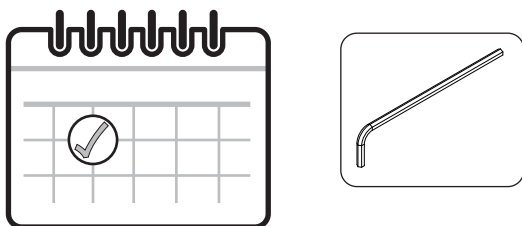

At the beginning of each heavy play session (especially a party) and twice a month during play season ensure;

1. Tighten all hardware - grub screws, nuts and bolts.
2. Pegs are in place and fully secure.
3. Lubricate all metallic moving parts with WD40 or Vaseline - (trolley and swing hooks.)
4. Ensure your frame is level and square.

**FAILURE TO DO SO COULD RESULT IN SERIOUS INJURY OR DEATH.**

**FOR MORE INFORMATION AND ASSEMBLY TIPS  
PLEASE REFER TO OUR WEBSITE VIDEO INSTRUCTION SECTION AT  
[HTTP://WWW.FUNKYMONKEYBARS.COM/PAGES/VIDEOS](http://www.funkymonkeybars.com/pages/videos)**

## 48 HAVE FUN





ABN 72 164 496 520  
 1300 912 198  
 info@funkymonkeybars.com  
 www.funkymonkeybars.com  
 9 Cutting Way,  
Yangebup WA 6164



WE ARE SOCIAL MONKEYS



Australian Government  
IP Australia

All Funky Monkey Bars® designs are registered and protected under IP Australian certification.