

# FUNKY Monkey bars<sup>®</sup>

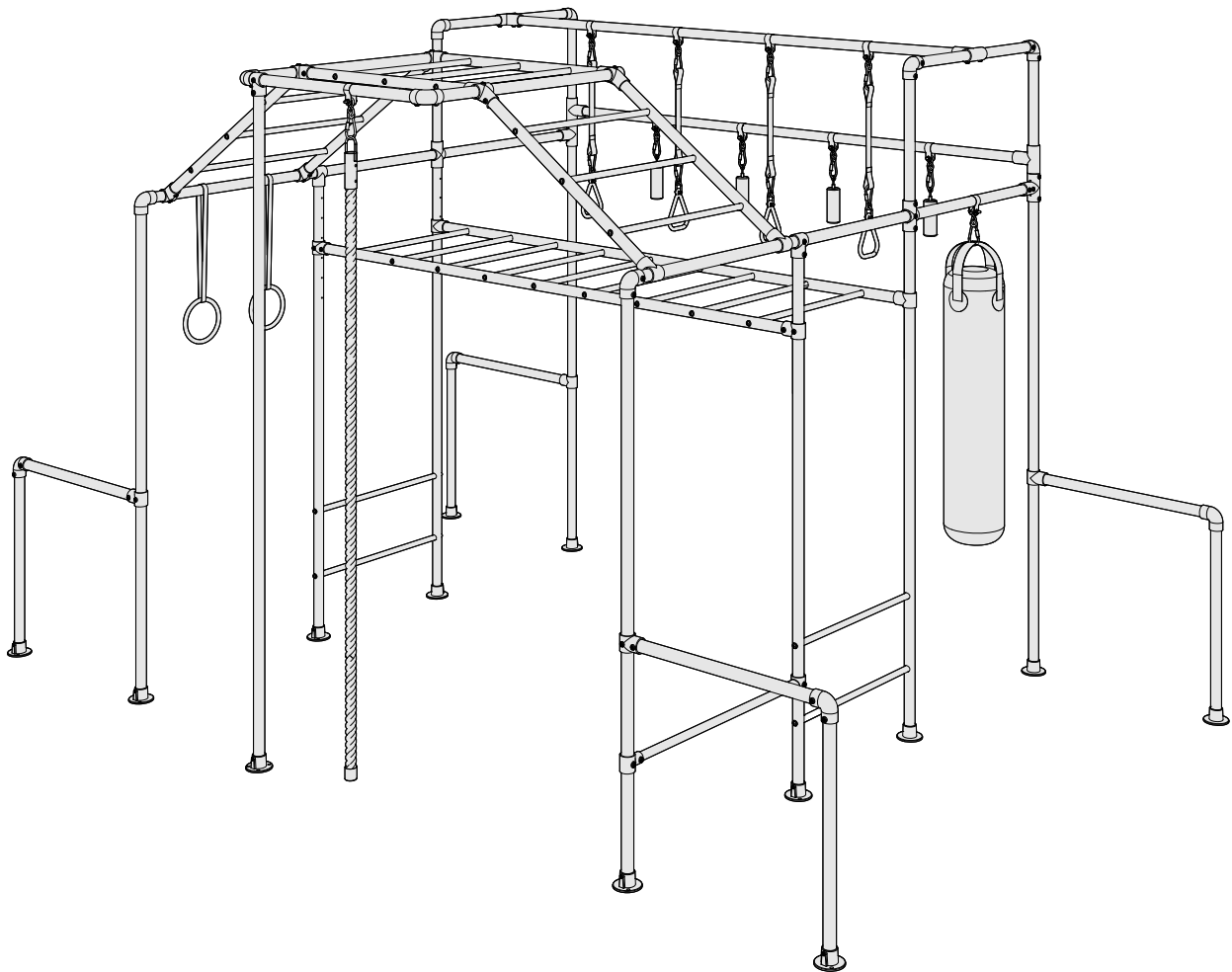

## THE COMBAT NINJA ASSEMBLY INSTRUCTIONS

## CONTENTS

Warnings . . . . .	Page 1
Load Rating . . . . .	Page 3
Dimensions . . . . .	Page 4
Assembly Tips . . . . .	Page 5
Inventory . . . . .	Page 7
Assembly Instructions . . . . .	Page 9
Ladder Bar Assembly . . . . .	Page 9
Combat Ladder Assembly. . . . .	Page 11
Leg Assembly . . . . .	Page 13
Twirly Whirly Bar Assembly . . . . .	Page 17
Main Monkey Bar Assembly . . . . .	Page 18
Swing Bar Assembly . . . . .	Page 20
Combat Ladder Installation . . . . .	Page 22
3m Overhead Extender Assembly . . . . .	Page 26
Maintenance . . . . .	Page 32

## WARNING

PLEASE CAREFULLY READ ALL INFORMATION CONTAINED IN THIS ASSEMBLY MANUAL BEFORE YOU INSTALL AND USE YOUR FUNKY MONKEY BARS®.

## SAFETY NOTICE

1. Any person handling or using the Funky Monkey Bars® products must follow the instructions as described in this document. The person in charge of assembling and using the equipment must ensure that the recommendations for use given in this document are seen by all users.
2. Only use the Funky Monkey Bars® after they have been fully assembled and after checking that the fittings are tightened properly (*refer to page 5 - Correct Tightening Method*).
3. DO NOT install your Funky Monkey Bars® over concrete, asphalt, packed earth, wood decking or any other hard surface. A fall onto a hard surface can result in serious injury or death.
4. Inspect all grub screws, bolts and nuts at the beginning of each play session to ensure your Funky Monkey Bars® are tight and secure.
5. Ensure all tubes are fully inserted into fittings until you hear the magic "CLUNK" sound.
6. Ensure your Funky Monkey Bars® are properly secure at ALL times. Pegs are in place and inserted fully into the ground.
7. DO NOT exceed the maximum load/weight limit as recommended by Funky Monkey Bars®.
8. Children should be supervised by an adult at all times.
9. Installing a gym/crash mat under the fall zone area of your Funky Monkey Bars® would be recommended for children learning this new skill. This will reduce the chance of injury and build the child's confidence while they build strength and master the skill.
10. Ensure you have thoroughly read your assembly and installation instructions and viewed our on-line installation videos at <https://www.funkymonkeybars.com/blogs/installation-maintenance-videos>
11. DO NOT climb, sit or stand on top of the monkey bar (horizontal ladder) section.
12. DO NOT jump from the top of any section of the monkey bar.
13. DO NOT use your Funky Monkey Bars® when wet as the steel will be slippery.
14. DO NOT attach items to your frame that are not designed specifically to be used with Funky Monkey Bars®, especially lower quality products that have not been approved by Funky Monkey Bars®.
15. Ensure the height of your Funky Monkey Bars® (horizontal ladder) are set at a level that is age appropriate.
16. DO NOT install your Funky Monkey Bars® over or near objects that could interfere with users in an unsafe way. Maintain a clear area around your Funky Monkey Bars®.
17. DO NOT use your Funky Monkey Bars® while under the influence of drugs and alcohol.
18. Wear clothing free of drawstrings, hooks, loops or anything that could get caught while using your Funky Monkey Bars® and result in entanglement and/or strangulation.

## ASSEMBLY

1. Keep small children away from the Funky Monkey Bars® during assembly.
2. Do not attempt to use the Funky Monkey Bars® until it is completely assembled and every fitting is tight and secured.
3. Installation typically takes 2-4 hours to complete. Two people are recommended for assembly.
4. Ensure all fittings are tightened to the correct tightening method as described on page 5.
5. Assembly should be carried out on clean, dry, level surface

Please refer to the video section on the Funky Monkey Bars® website for more handy tips and assembly instructions at <http://www.funkymonkeybars.com/pages/videos>

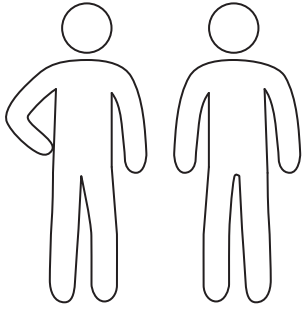

Assembly requires 2 adults.

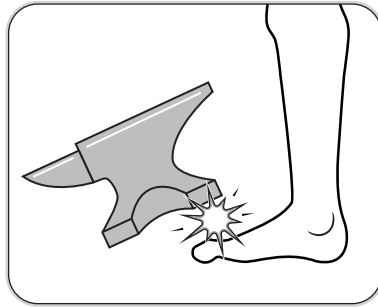

Heavy items !

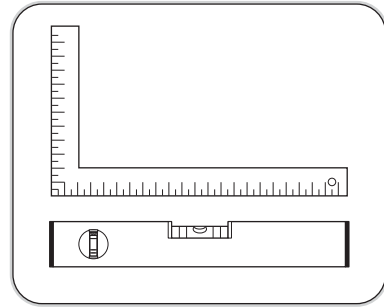

Work on flat level surface.

## LOCATION

1. A safe fall zone around your Funky Monkey Bars® is essential. A minimum distance of 1.5m to 2m (5 ft to 6.5ft) is recommended around the elevated hanging points of your Funky Monkey Bars®.
2. Place your Funky Monkey Bars® on level ground, away from any structure or obstruction such as a fence, garage, house, overhanging branches, laundry lines or electrical wires and remove any obstructions beneath your Funky Monkey Bars®.
3. Ensure your Funky Monkey Bars® are positioned away from retaining walls, pool fences, structures and other play equipment. Maintain a clear space around the whole perimeter of your Funky Monkey Bars®.
4. Place your Funky Monkey Bars® on the most level surface available.

## MAINTENANCE

1. At the beginning of each heavy play session we recommend the following maintenance processes be performed on your Funky Monkey Bars®:
  - Tighten all bolts, grub screws and applicable hardware (as per page 5)
  - Lubricate all metallic moving parts as per instructions (flying fox, swing hooks etc)
  - Check all protective coverings on bolts, pipes, edges and corners. Replace if they are loose, cracked or missing.
  - Check all moving parts including swing seats, shackles, snap hooks, chains and trolleys for wear, rust, or other deterioration. Replace as needed.
2. Twice a month during play season we would recommend the following maintenance processes be performed on your Funky Monkey Bars®:
  - Tighten all connections and hardware
  - Check all protective coverings on bolts, pipes, edges and corners. Replace if they are loose, cracked or missing.
3. Once a month during play season we would recommend the following maintenance processes be performed on your Funky Monkey Bars®:
  - Lubricate all metallic moving parts as per instructions (flying fox, swing hooks etc). If swings start to squeek then lubricate swing hooks.
  - Check all moving parts including swing seats, ropes, chains and trolleys for wear, rust, or other deterioration. Replace as needed.
  - Owners shall be responsible for maintaining the legibility of any warning labels.

For additional information concerning your Funky Monkey Bars®, please contact our customer service team or check our website for any important updates. Phone - 1300 912 198 or [www.funkymonkeybars.com](http://www.funkymonkeybars.com)



**QUALITY & INDEPENDENT TESTING**

At Funky Monkey Bars® we take the quality of our designs and safety very seriously. All Funky Monkey Bars® frames go through a stringent, independent structural testing process prior to being made available for release to our customers.

Our frames are designed within the parameters of the Australian Standard for Playground Equipment AS4685.1:2014.

The structural integrity of our frames has been tested for performance through a combination of engineering calculations and physical testing. The tests have been performed by independent, certified structural engineers in accordance with Australian Standard for Playground Equipment AS4685.1:2014 and European Standards EN1176-1:2008.

The independent testing conducted on The Combat Ninja certified the frame to a load rating of 1920kgs or 32 users.

<b>LOAD TESTING CERTIFICATION</b>				
<b>DATE OF TEST</b>	<b>MODEL</b>	<b>NUMBER OF USERS</b>	<b>USER LOAD (KG)</b>	<b>LOAD RATING (KG)</b>
27 May 2019	Combat Ninja	32	60	1920
I hereby confirm all testing was undertaken in accordance with Physical Testing of Structural Integrity requirements of AS 4685.1: 2014 App C / EN 1176-1:2008 <sup>o</sup> except where noted below;				
<b>COMMENTS:</b> Maximum of 4 users on Combat Ladder. Maximum of 3 users on Accessories Bar.				
<b>APPROVED BY:</b> Funky Monkey Bars®			<b>WITNESSED BY:</b> Independent Engineer	
				
<b>DATE :</b> 27 May 2019			<b>DATE :</b> 27 May 2019	

# DIMENSIONS

## FUNKY MONKEY BARS® COMBAT NINJA OVERALL DIMENSIONS

A minimum of 2.0 Metres clear fall zone is recommended around the elevated hanging points of your Funky Monkey Bars®.

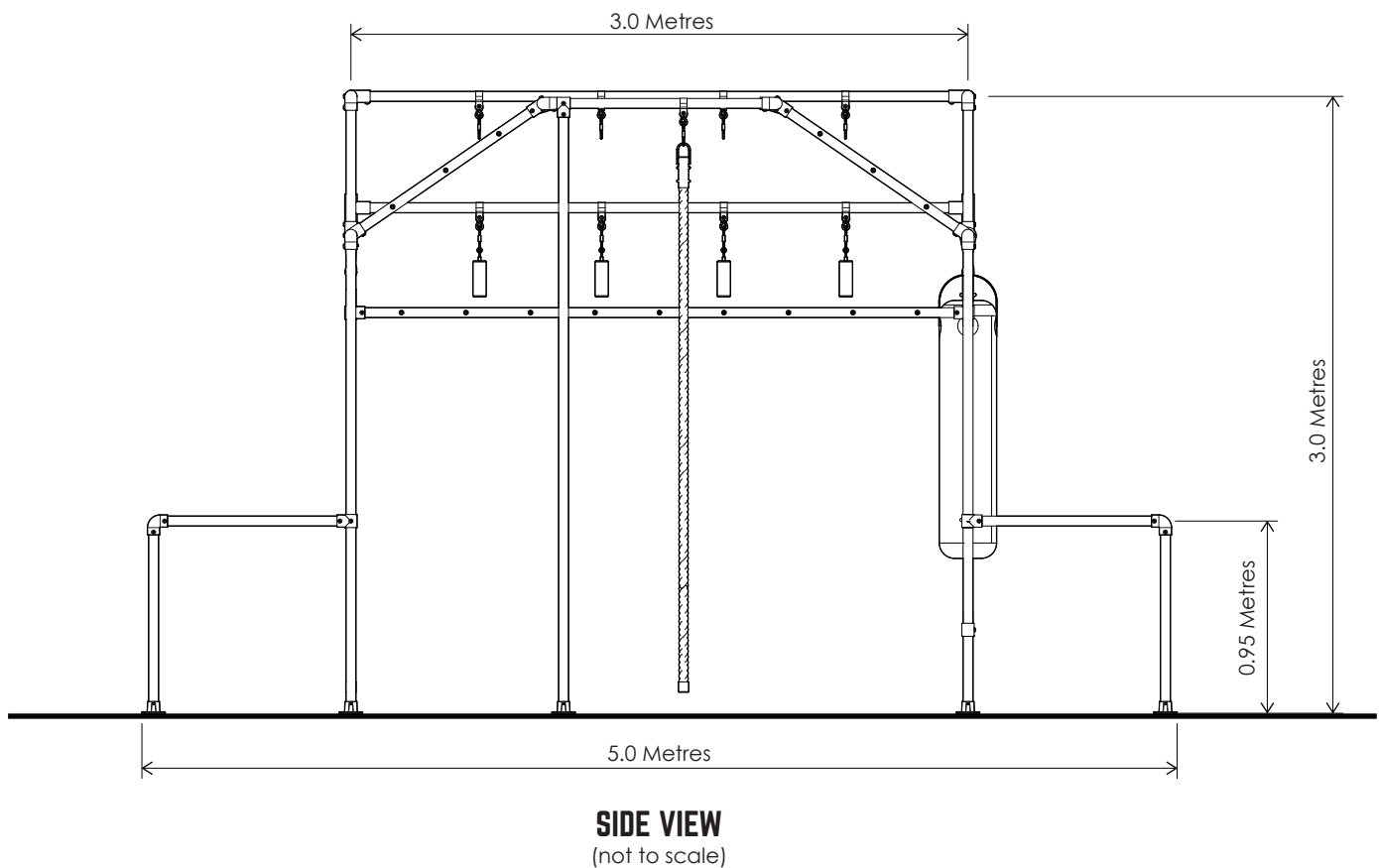
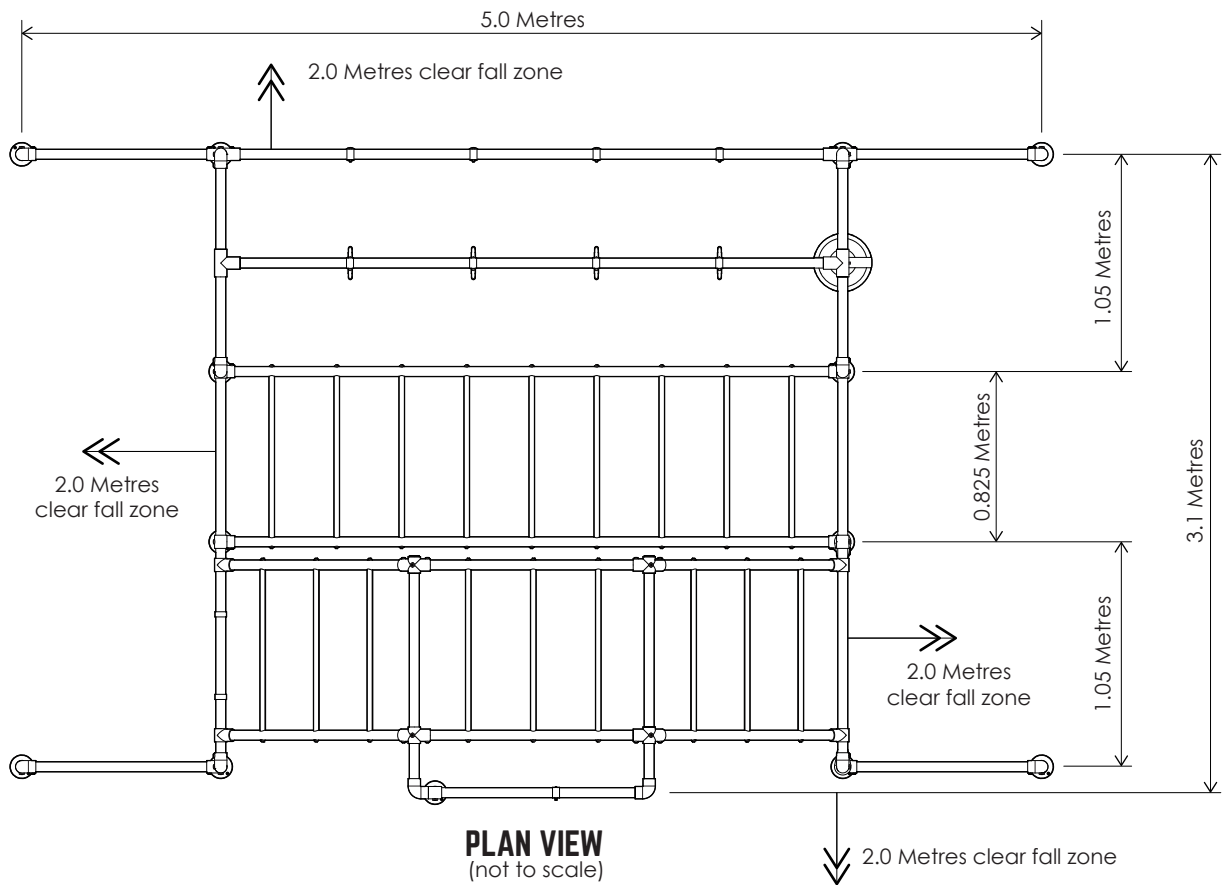

## ASSEMBLY TIPS

### CORRECT INSERTION INTO FITTINGS - (INDICATIVE DIAGRAM SHOWN)

All tubes must be fully inserted until contact is made with adjoining tube.

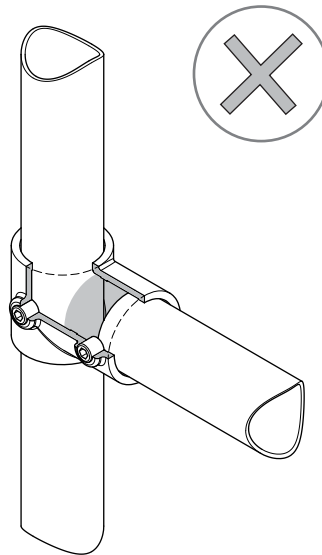

Gap.

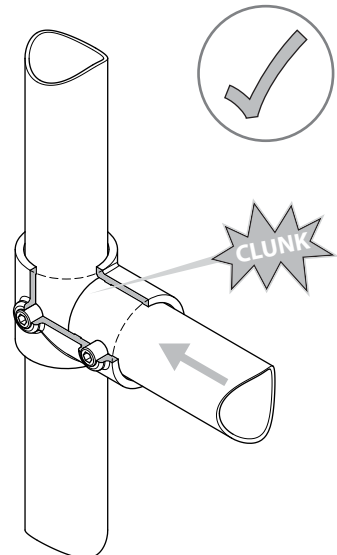

No gap.

### CORRECT TIGHTENING METHOD OF GRUB SCREWS - (INDICATIVE DIAGRAM SHOWN)

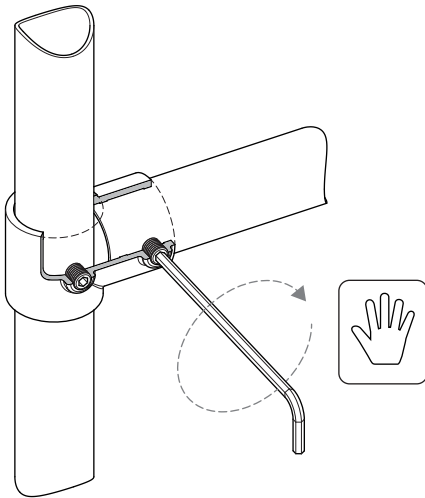

1. With long end of allen key, hand tighten grub screw as much as possible.

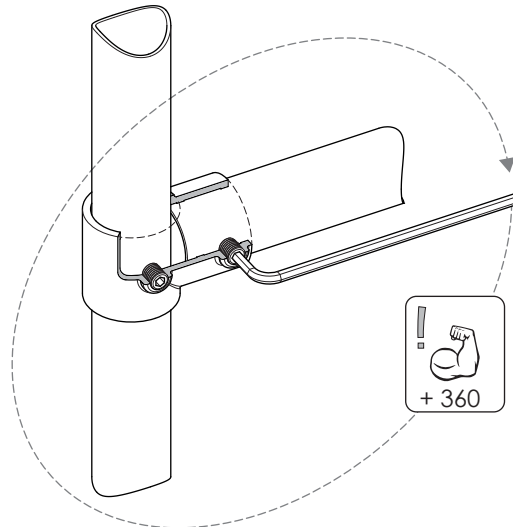

2. Using other end of the allen key do one full 360 degree turn as a minimum, use muscles!



### CORRECT TIGHTENING METHOD OF RUNG BOLTS - (INDICATIVE DIAGRAM SHOWN)

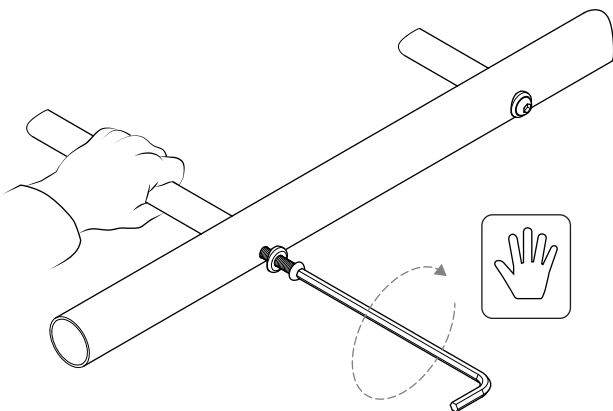

1. With long end of allen key, hand tighten bolt hard up against washer and outside of tube. Hold rung to avoid rotation.

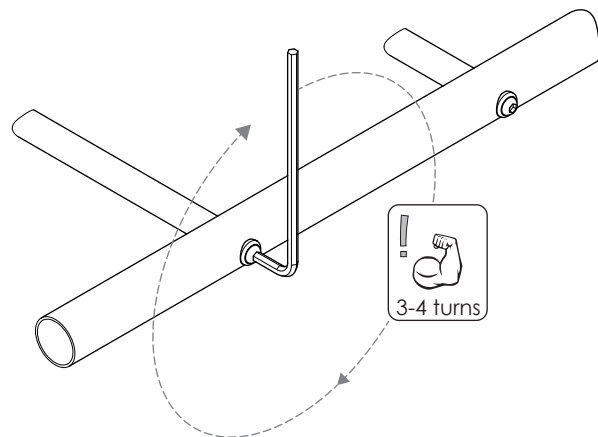

2. Using short end of the allen key fully tighten, approximately 3-4 full turns .



## ASSEMBLY TIPS (CONTINUED)

### IT IS CRITICAL YOUR MAIN FRAME IS 100% SQUARE AND LEVEL (INDICATIVE DIAGRAM SHOWN)

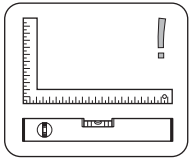

Check assembly is 100% level, square & straight.

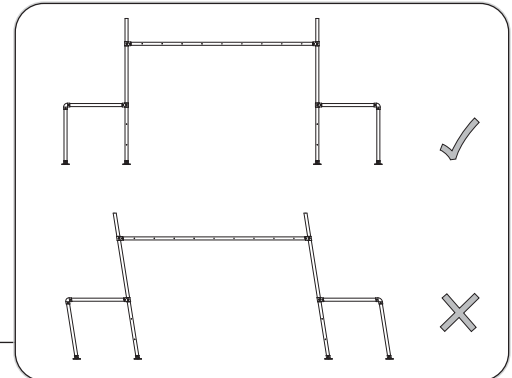
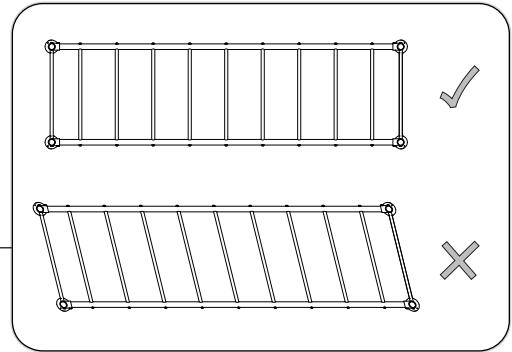
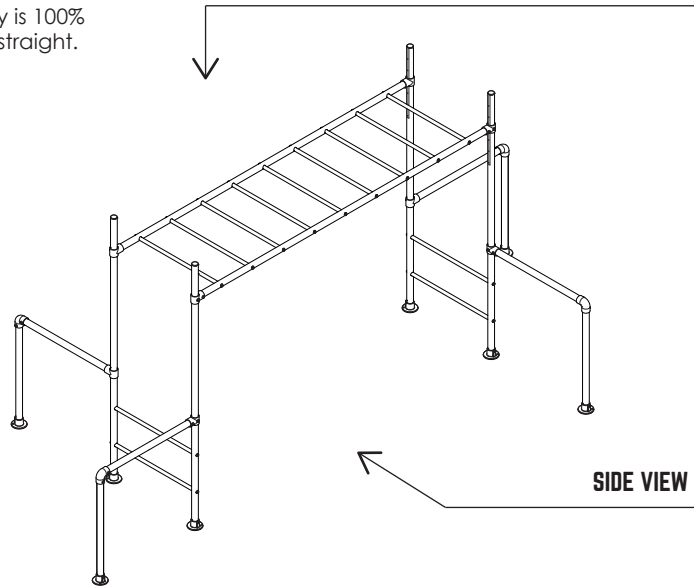

If your frame is not straight or level remove pegs, loosen grub screws, re-adjust re-tighten and re-peg the frame.

### INSTALLATION ON A SLOPE

If your frame is being installed on a slope ensure the monkey ladder bar is level. Either install at different heights on the legs or dig down at one end until level.

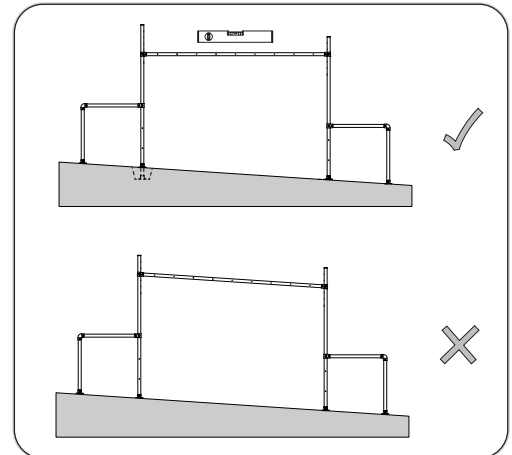

### FIXING TYPICAL ORIENTATION - (INDICATIVE DRAWING SHOWN)

Unless otherwise stated all grub screws and fittings should face downwards and outwards. This will reduce weathering damage, help with assembly and ease of maintenance.

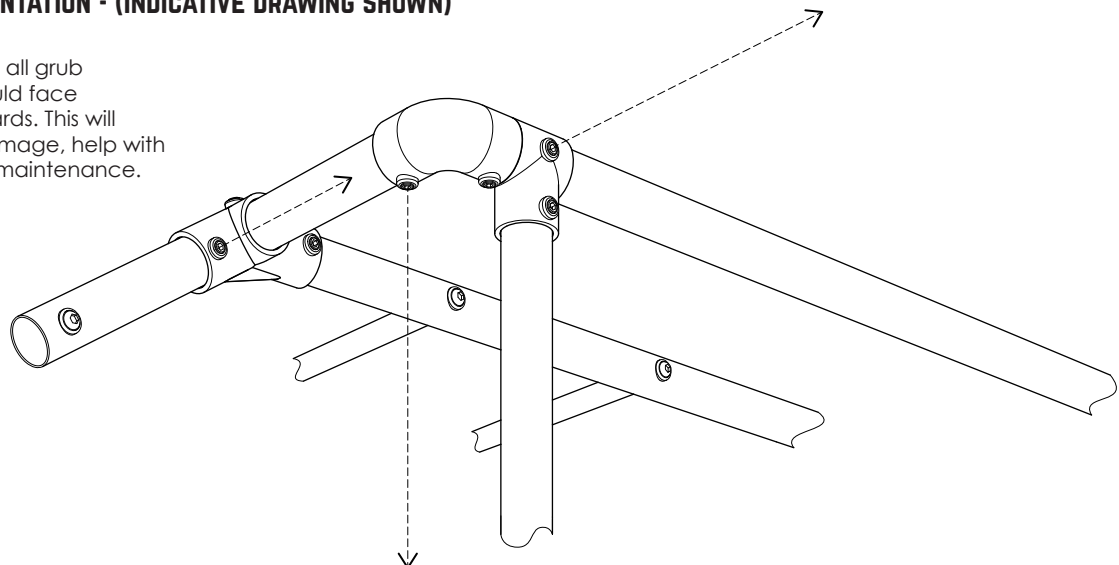

# INVENTORY

## TOOLS REQUIRED FOR INSTALLATION

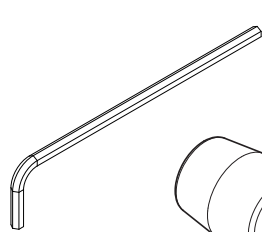

**1x**  
8mm Allen key  
(Included)

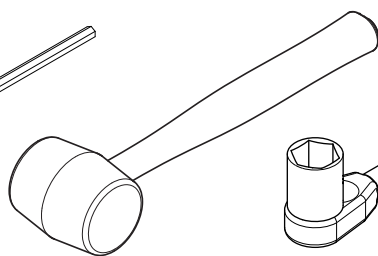

**1x**  
Soft Hammer  
(Not included)

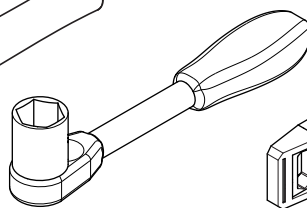

**1x**  
17mm Ratchet  
(Not included)

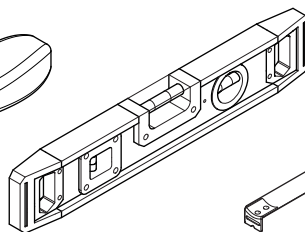

**1x**  
Spirit Level  
(Not included)

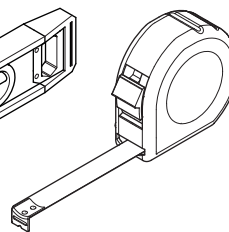

**1x**  
Tape Measure  
(Not included)

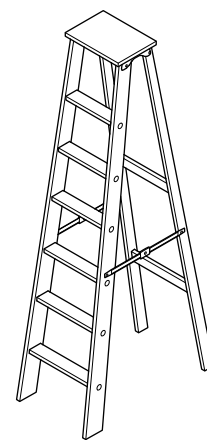

**2x**  
3m Step Ladder  
(Not included)

## TUBES

**4x** 50Dia. x 2300mm  
Swing Leg Tube

25Dia. x 850mm  
**22x** Rung Tube

33Dia. x 1040mm  
**1x** Step Tube

**5x** 50Dia. x 2950mm  
Accessories Tube

50Dia. x 900mm  
**8x** Twirly Tube

**6x** 50Dia. x 1085mm  
Half Ladder tube

50Dia. x 1085mm  
**3x** Top Support Tube

**4x** 50Dia. x 2300mm  
Leg Tube

50Dia. x 1040mm  
**2x** Cargo Tube

**2x** 50Dia. x 2950mm  
Ladder Tube

50Dia. x 600mm  
**4x** Extender Tube

## FITTINGS

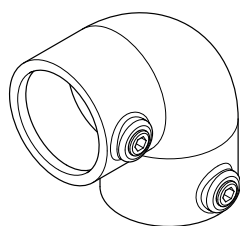

**12x**  
Elbow  
D-125

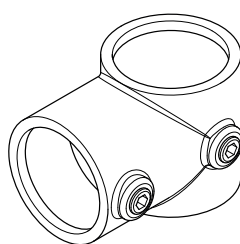

**15x**  
Short Tee  
D-101

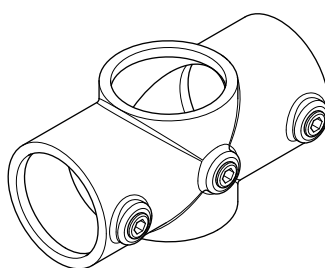

**2x**  
Straight Through  
D-119

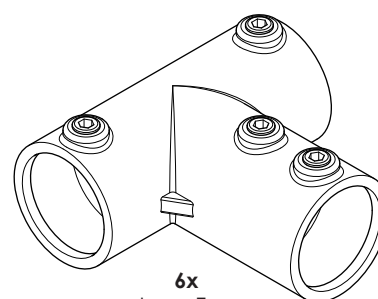

**6x**  
Long Tee  
D-104L

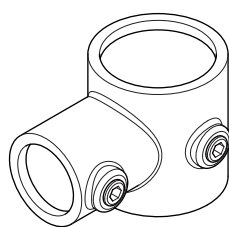

**2x**  
Reducing Tee  
D-101 D48-B34

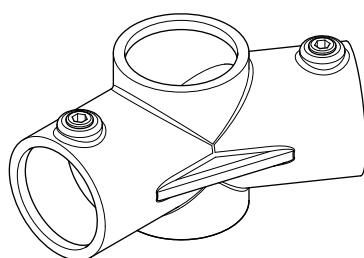

**4x**  
145° 3 Way  
D-120

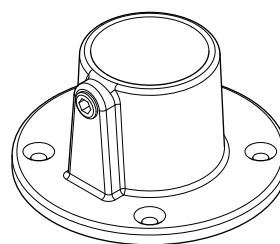

**1x**  
4 Hole Base Plate  
D-131

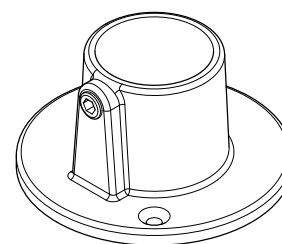

**12x**  
Base Plate  
D-131



**16x**  
Peg



## INVENTORY (CONTINUED)

### HARDWARE

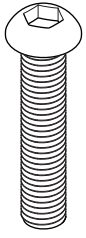

**45x**  
M10 Bolt

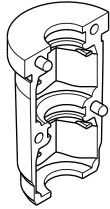

**90x**  
Rung Insert

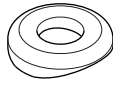

**45x**  
Washer



**90x**  
M10 Hex Nut

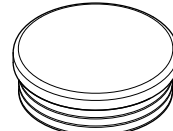

**2x**  
Plastic End Cap



**1x**  
Manufacture Sticker

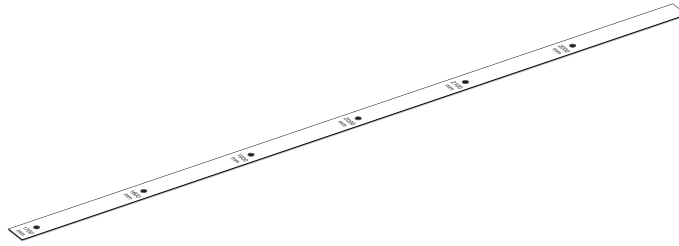

**4x**  
Height Sticker

### COMPONENTS (ACCESSORIES)

**10x**  
Swing Hooks



**1x**  
3m  
Jungle Rope



**1x**  
Boxing Bag



**2x**  
Roman Rings

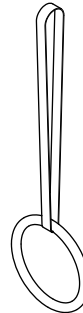

**4x**  
Delta Rings



**4x**  
Ninja Grips



One of the best things about a Funky Monkey Bar is the ability to add new equipment and accessories as your child and family grows. You can swap or add accessories to your existing frame, or add extra frames that will give you more versatility to attach equipment. Check out what we've got in store now at...

[WWW.FUNKYMONKEYBARS.COM](http://WWW.FUNKYMONKEYBARS.COM)

# ASSEMBLY INSTRUCTIONS - LADDER BAR ASSEMBLY

## 1 RUNG ASSEMBLY (X22)

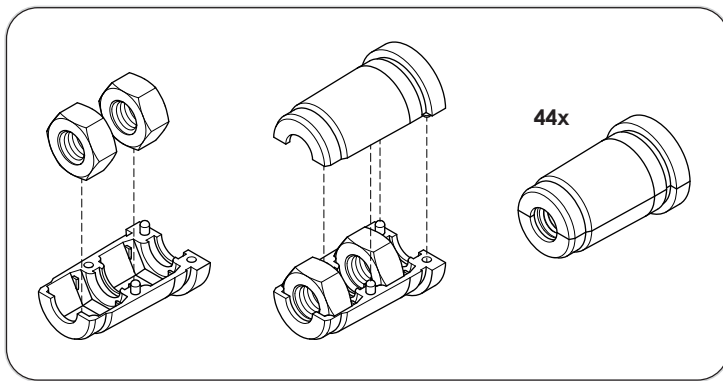

1. Assemble plastic rung inserts as shown above.

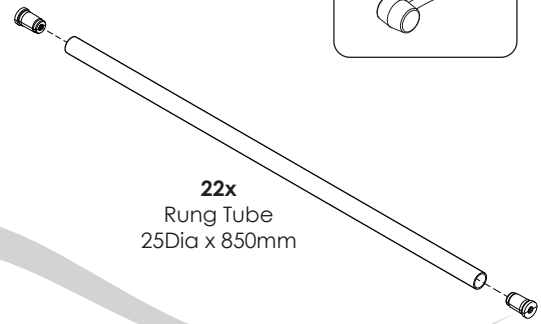

2. Push inserts into both ends of all rungs.

## 2 MONKEY BAR LADDER ASSEMBLY

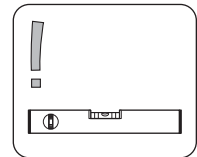
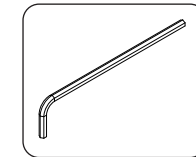
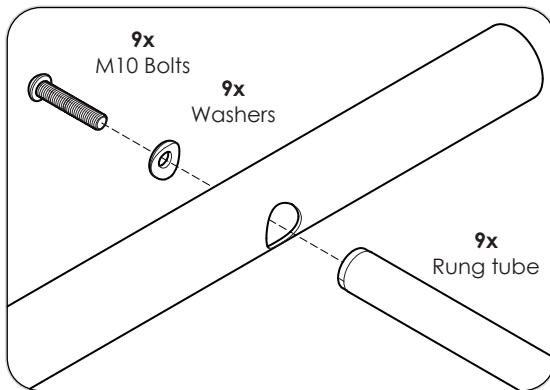

Hand tighten all bolts.

Assemble on flat surface.

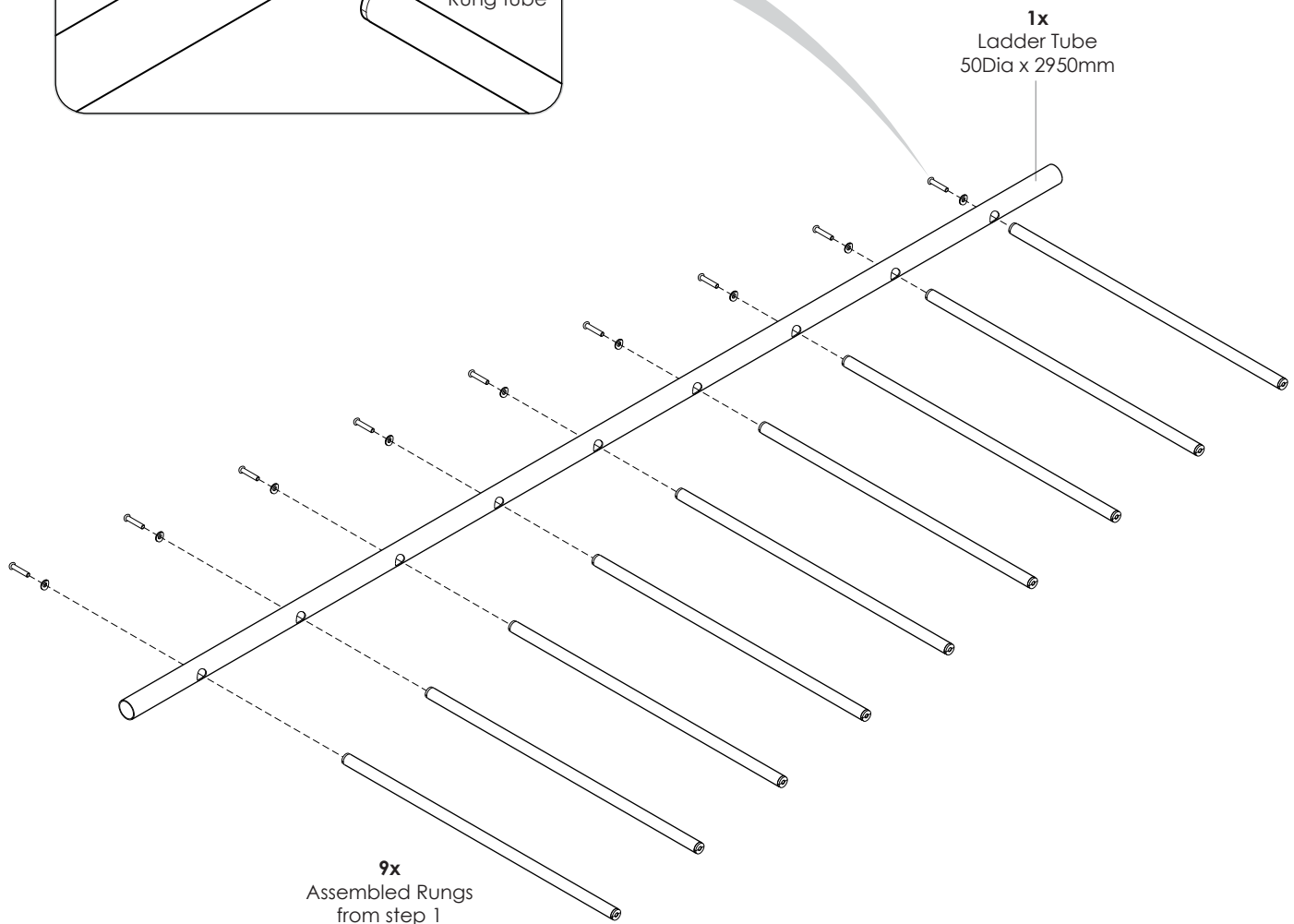

### 3 ATTACH SECOND LADDER TUBE

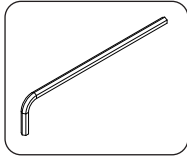

Hand tighten all bolts

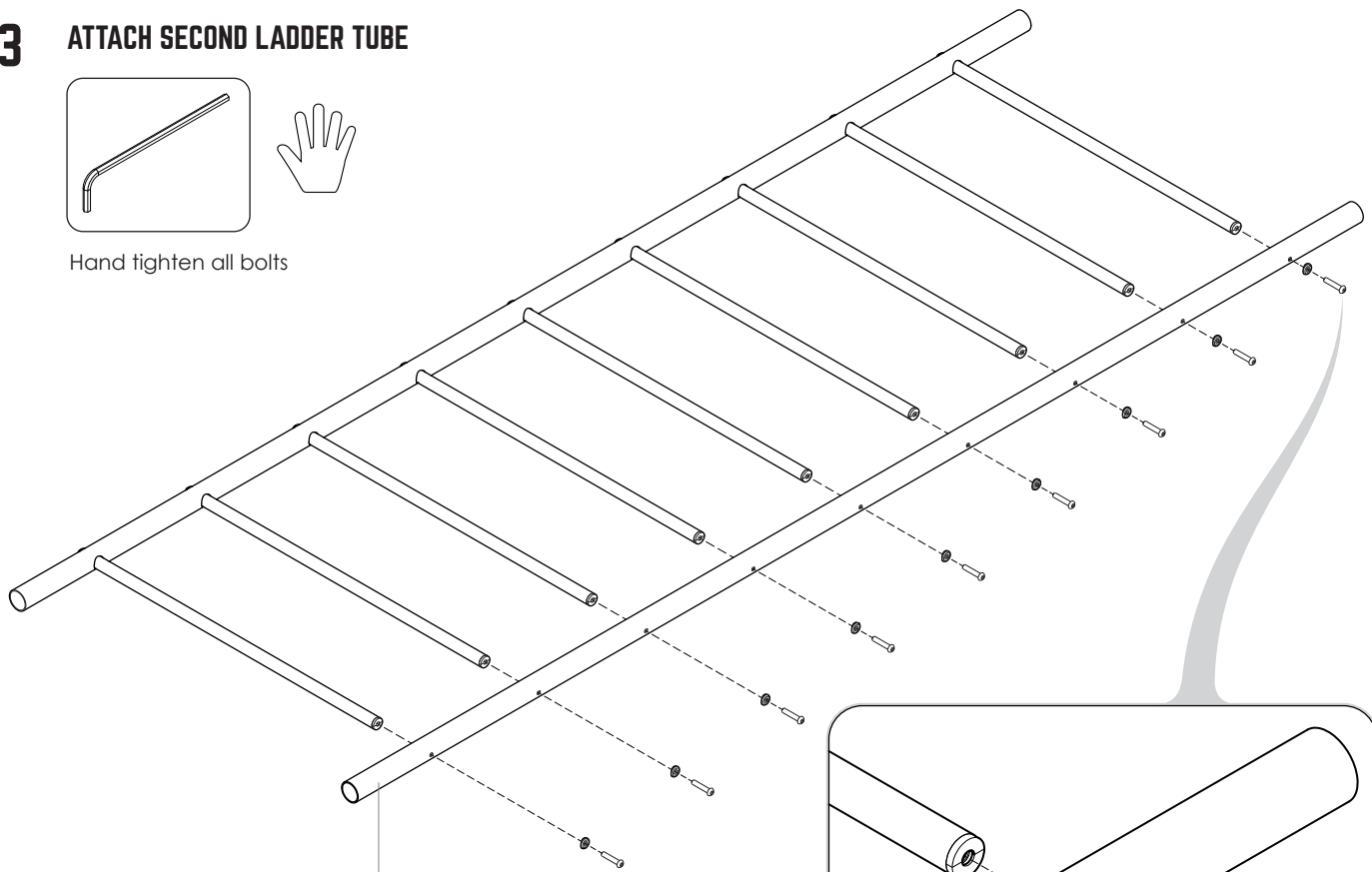

1x  
Ladder Tube  
50Dia x 2950mm

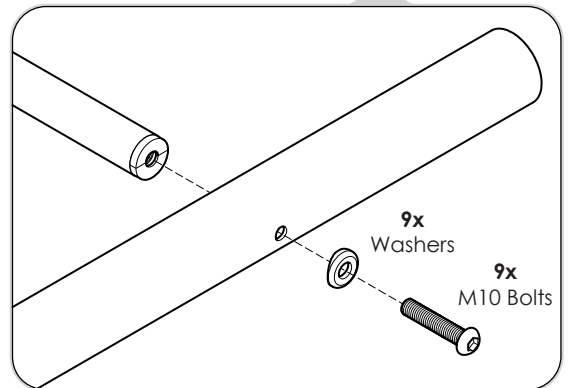

9x  
Washers

9x  
M10 Bolts

### 4 FIRMLY TIGHTEN ALL GRUB SCREWS.

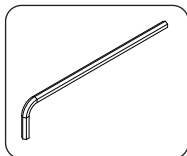

See page 5 for correct  
tightening method.

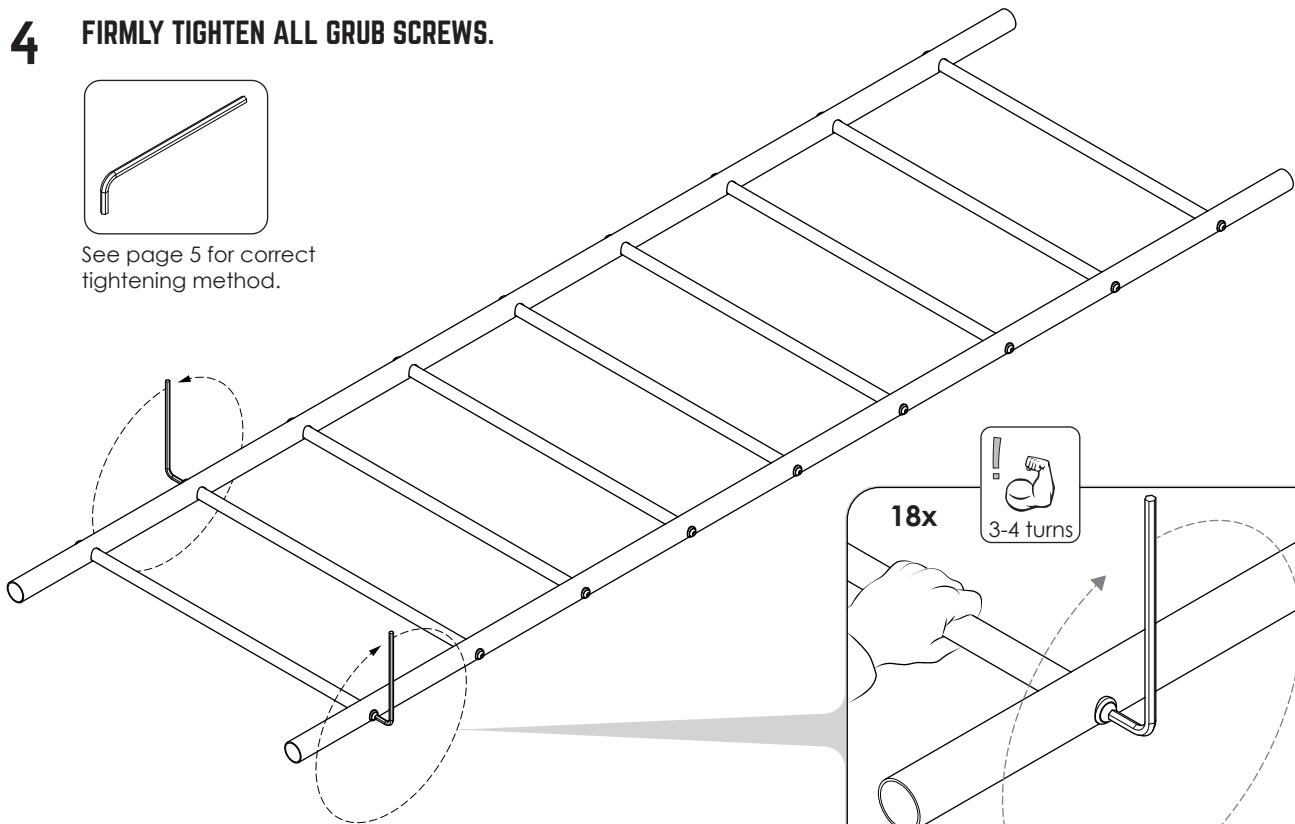

18x



3-4 turns

# ASSEMBLY INSTRUCTIONS - COMBAT LADDER ASSEMBLY

## 5 COMBAT LADDER (x3)

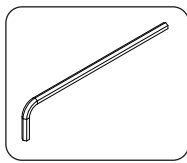

Hand tighten all bolts.

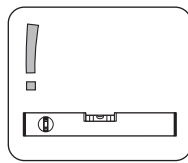

Assemble on flat surface.

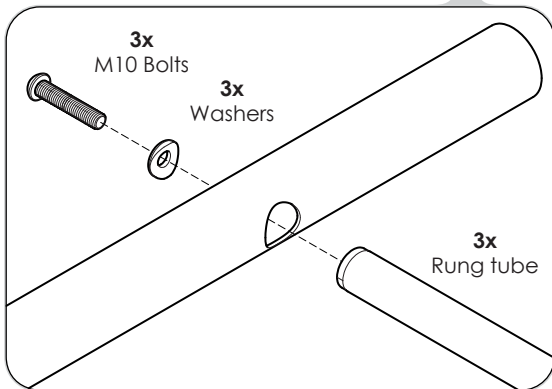
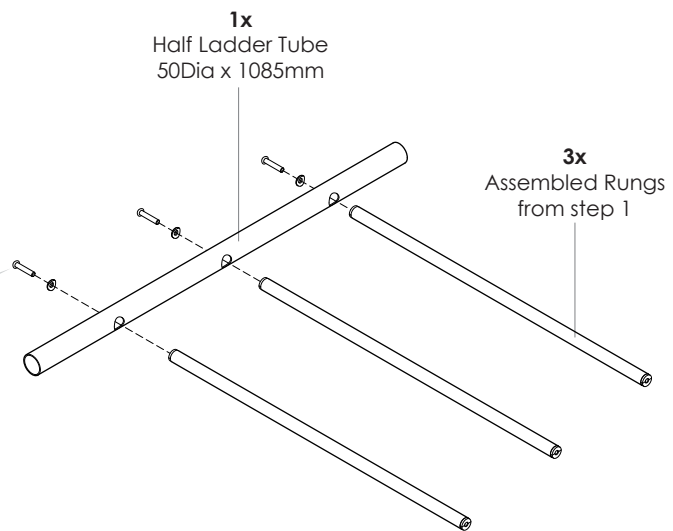

## 6 ATTACH SECOND HALF LADDER TUBE

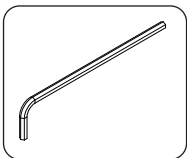

Hand tighten all bolts

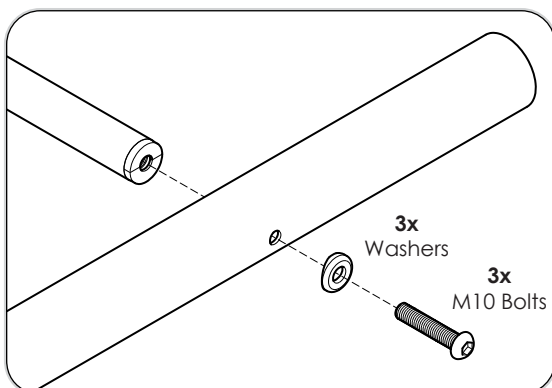
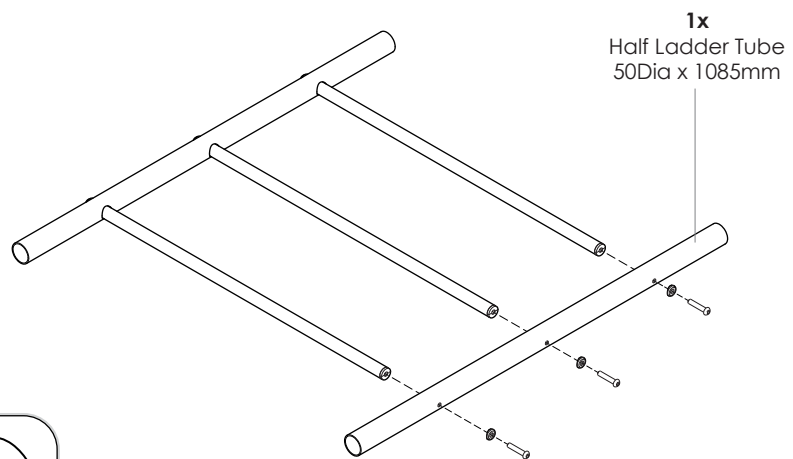

**7** FIRMLY TIGHTEN ALL GRUB SCREWS.

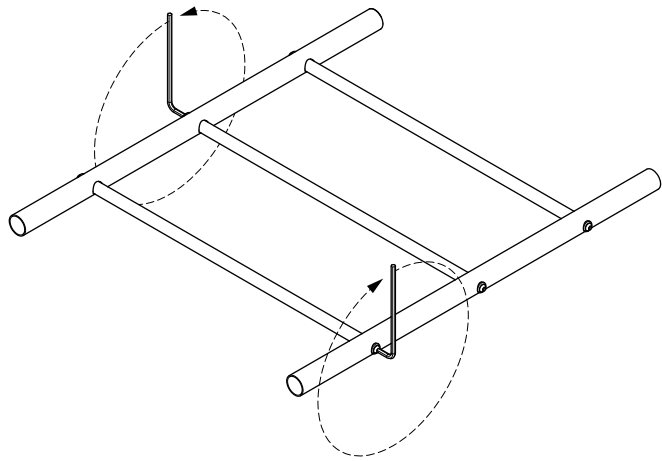
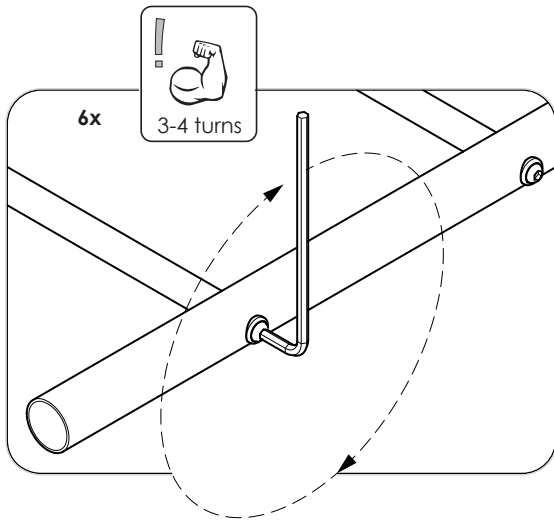
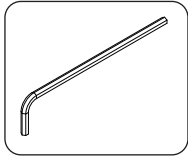

**8** REPEAT STEPS 5 - 7 FOR 2 MORE COMBAT LADDERS.

**9** COMBAT LADDER X3.

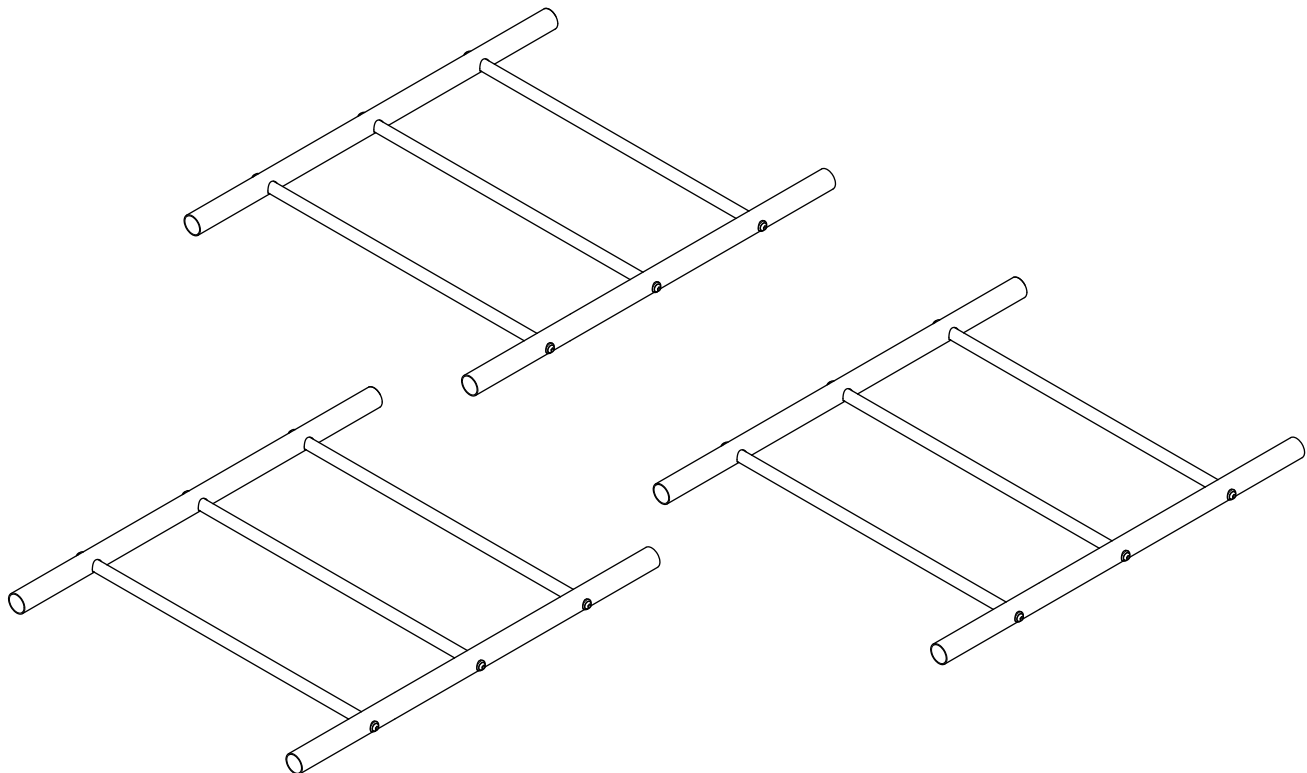

**10** INSERT RUNGS INTO LEG

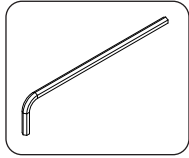

Tighten all bolts.

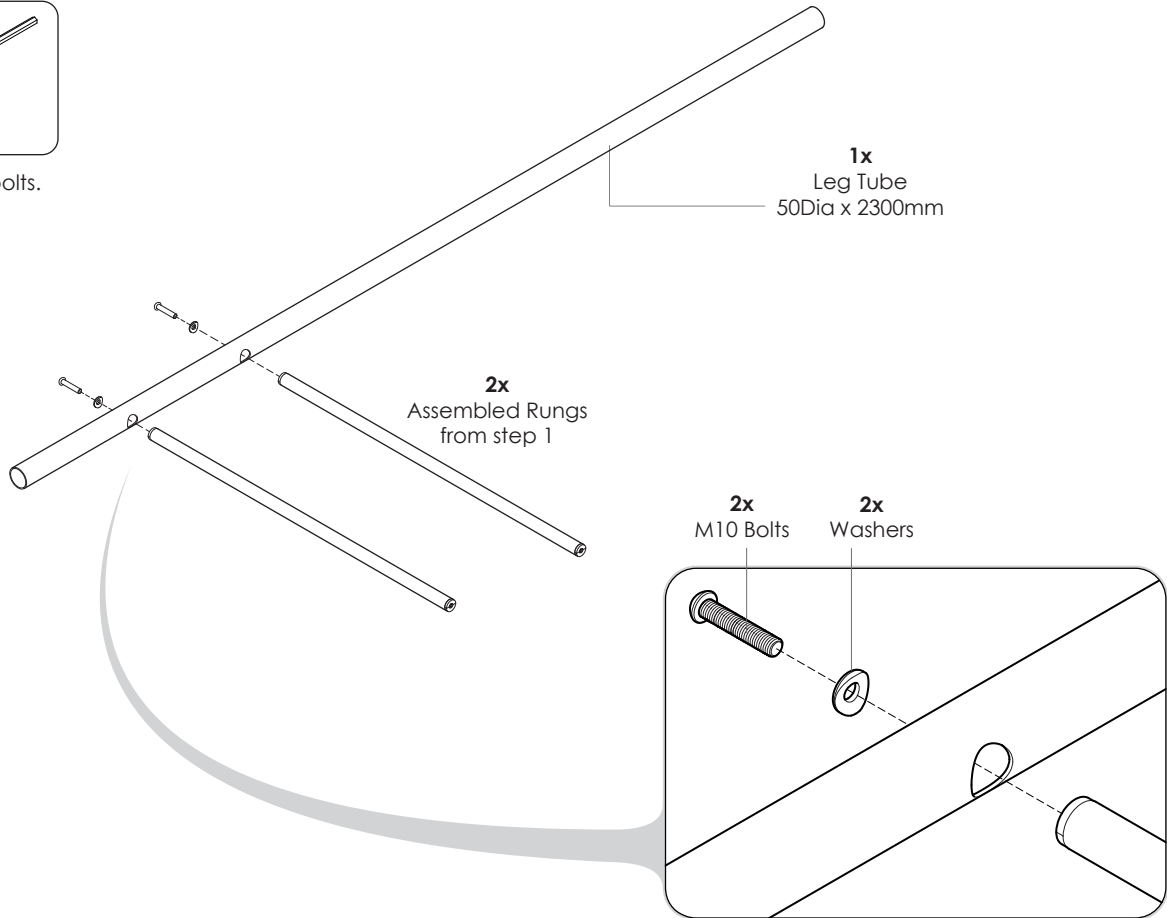

**11** SLIDE ON REDUCING TEE

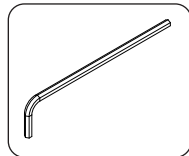

1. Slide reducing tee onto 2nd leg tube and position between the rung holes.
2. Hand tighten grub screw.

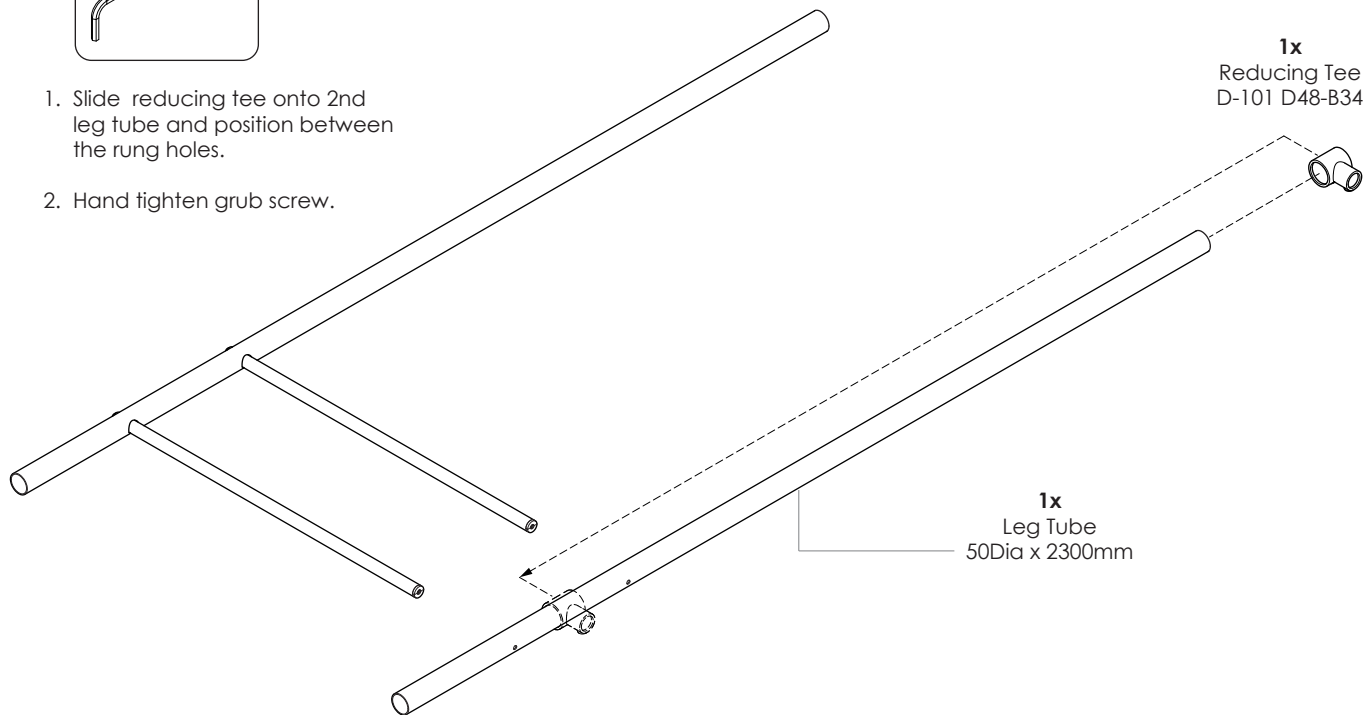

## 12 ATTACH SECOND LEG

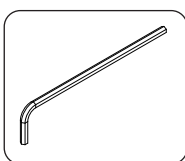

1. Slide on reducing tee and position between the rungs.
2. Tighten all bolts.

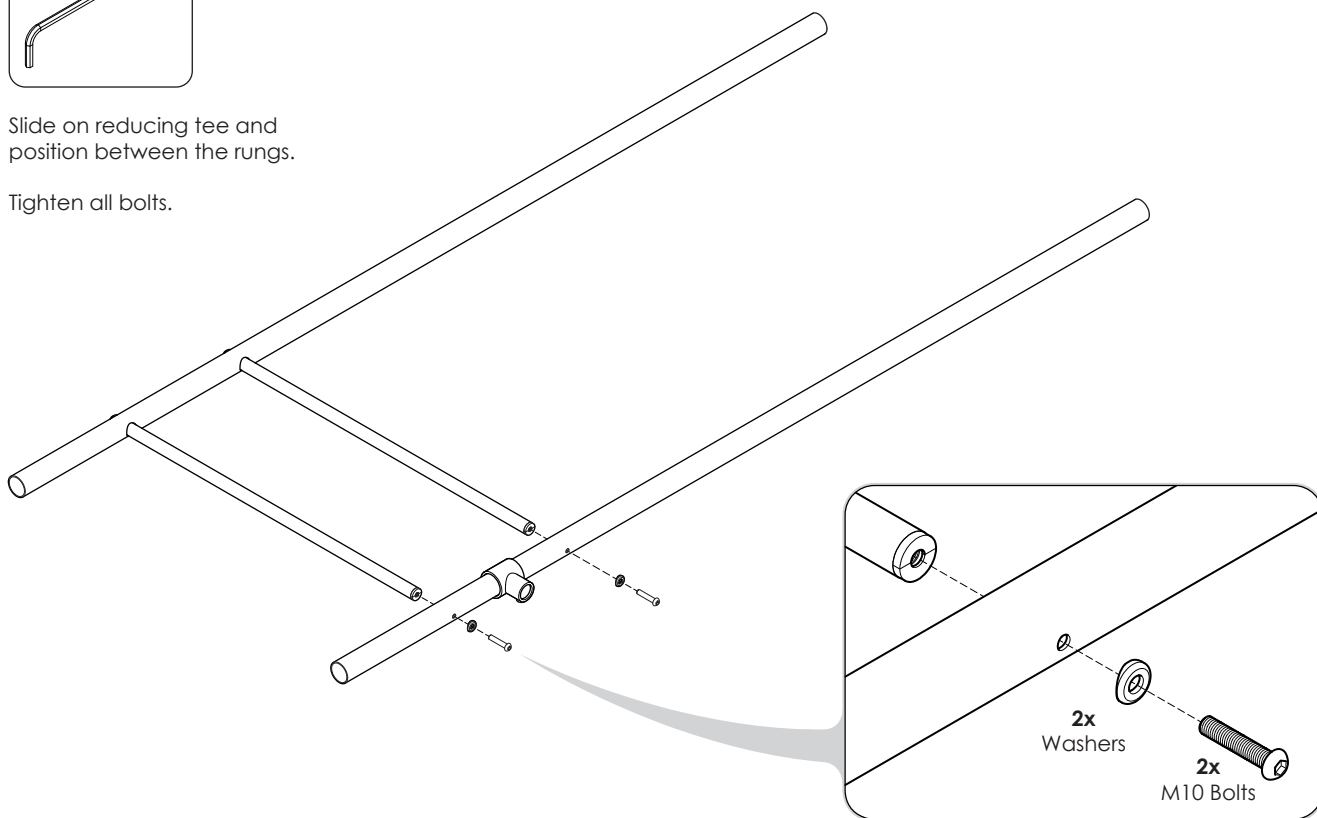

## 13 ATTACH BASE PLATES

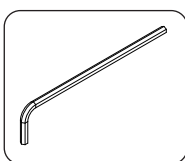

Tighten all grub screws.

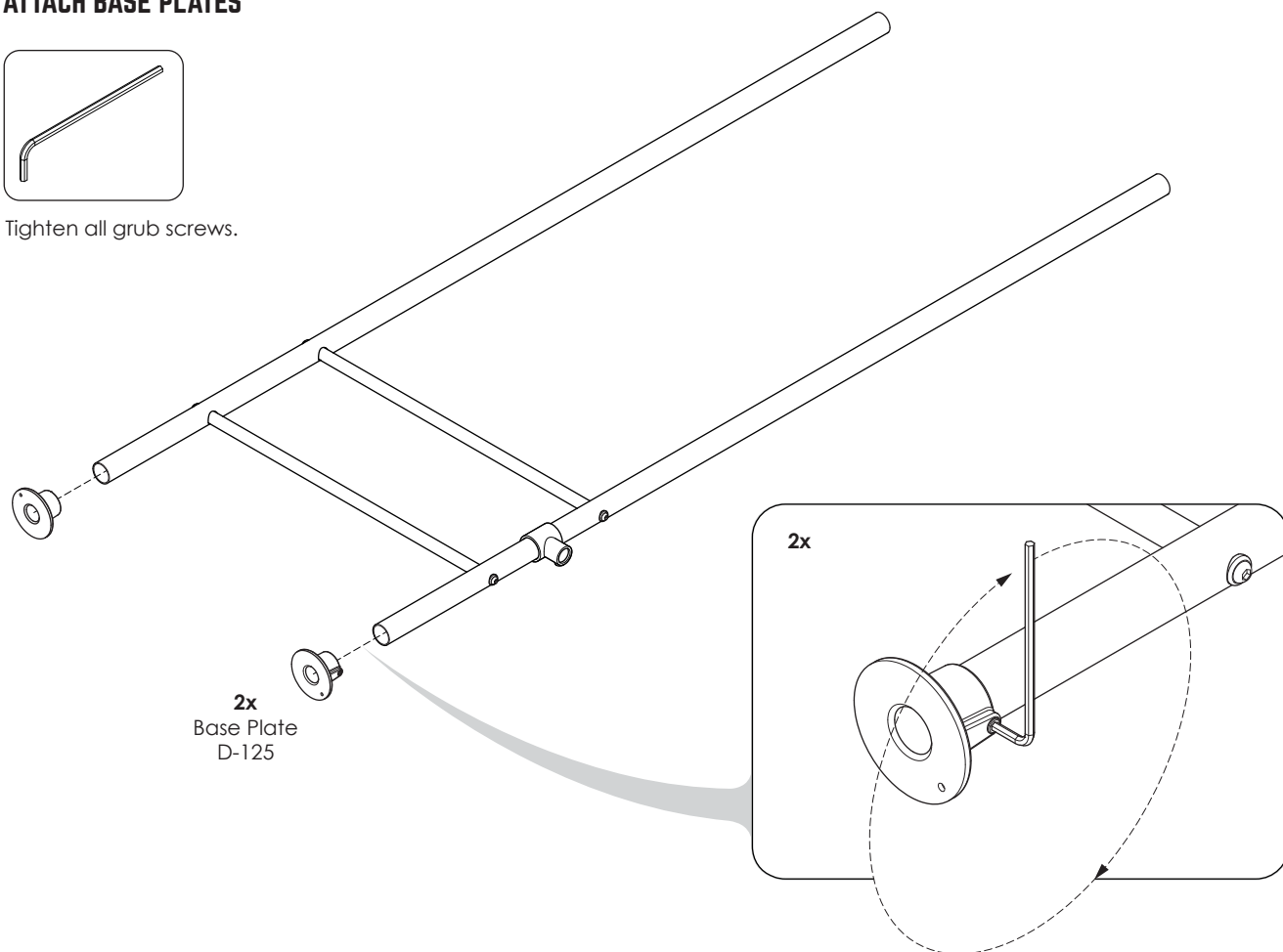

# 14 APPLY HEIGHT STICKERS.

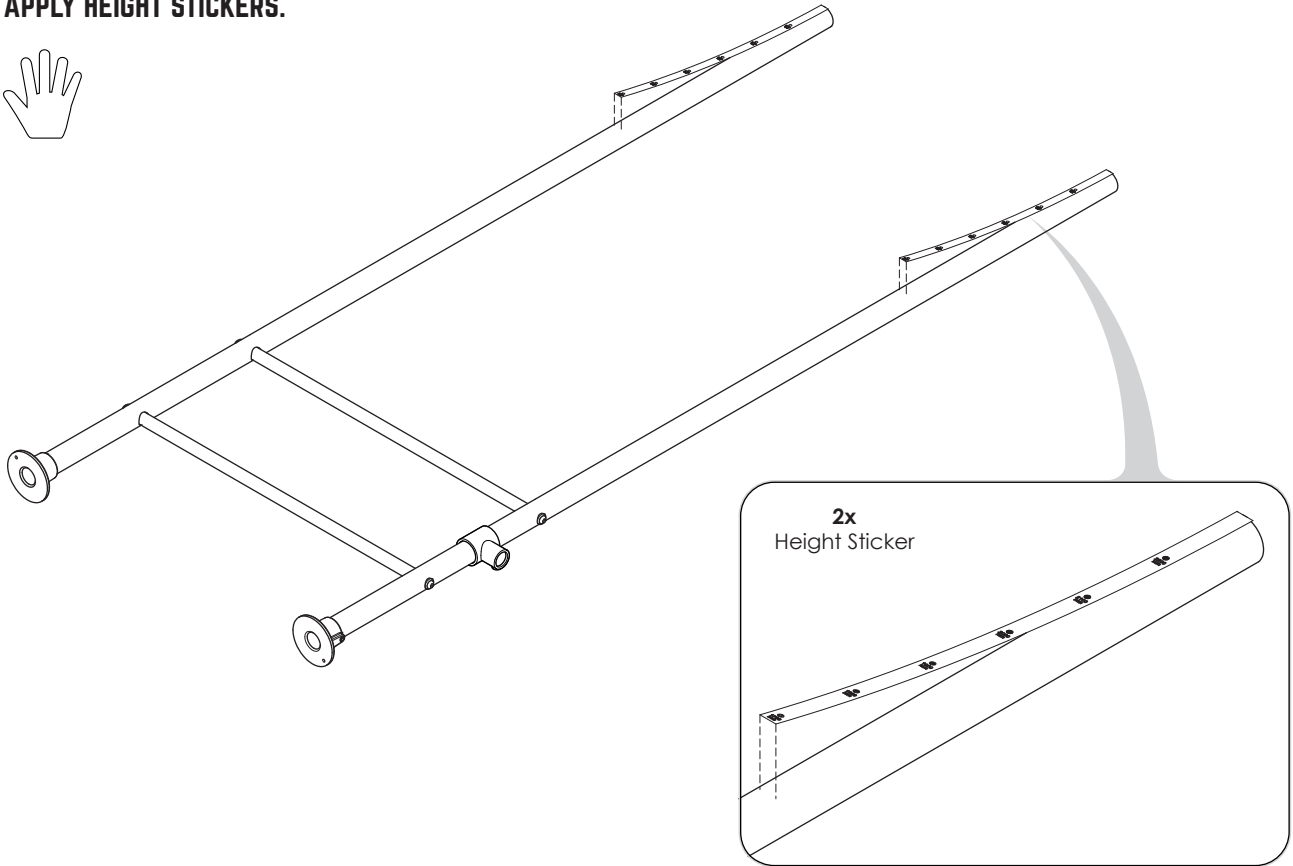

# 15 SET LADDER BAR HEIGHT.

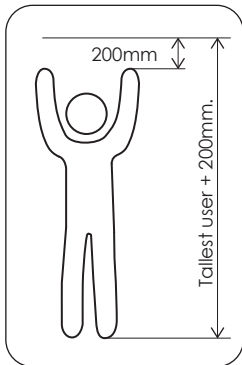

Good starting height is 100-200mm above reach.

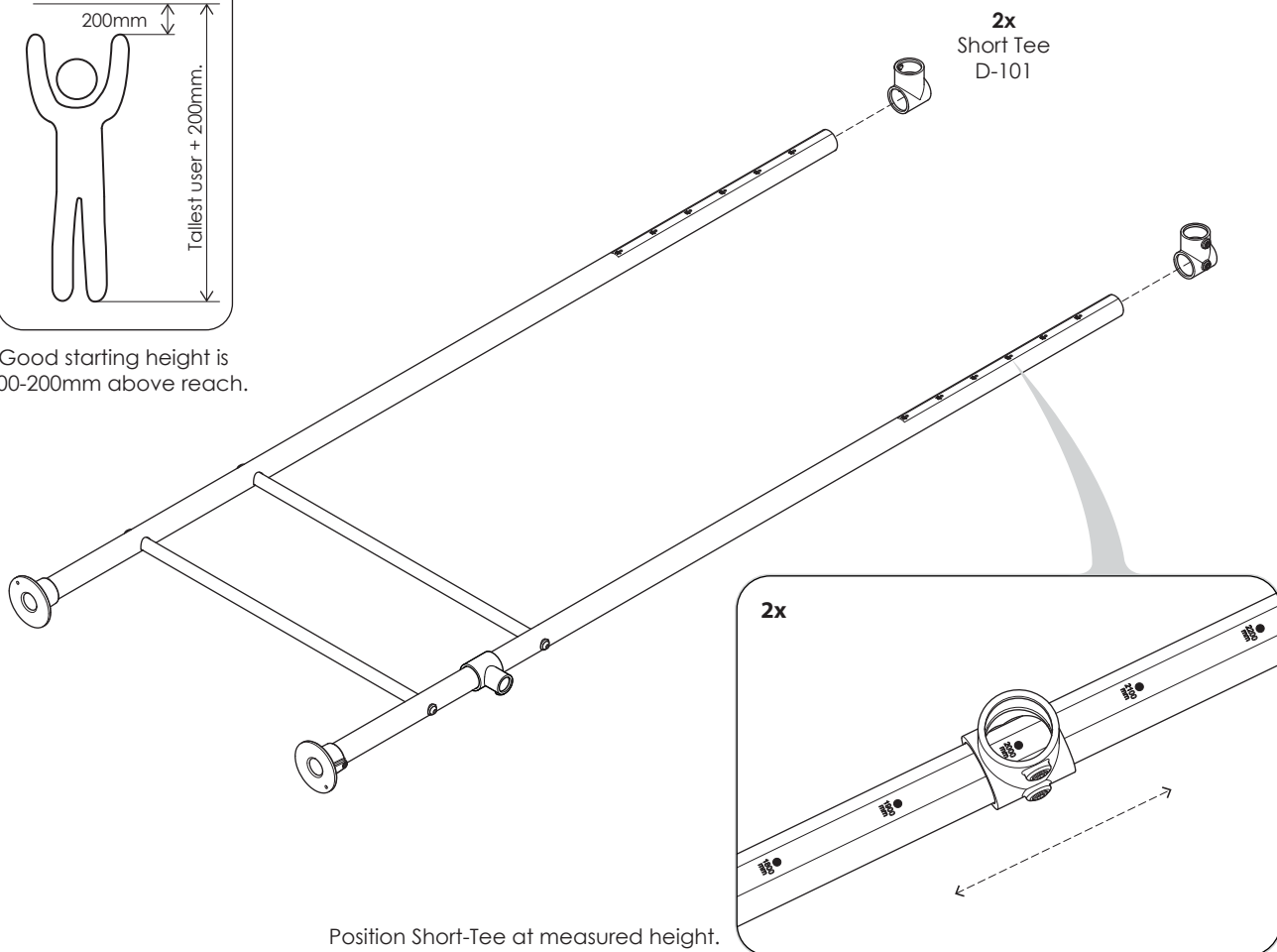



## 16 FIRMLY TIGHTEN ALL GRUB SCREWS AND RUNG BOLTS.

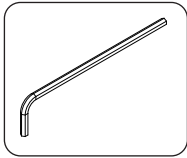

Hand tighten grub screw A. (Temporary location). Fully tighten all others.

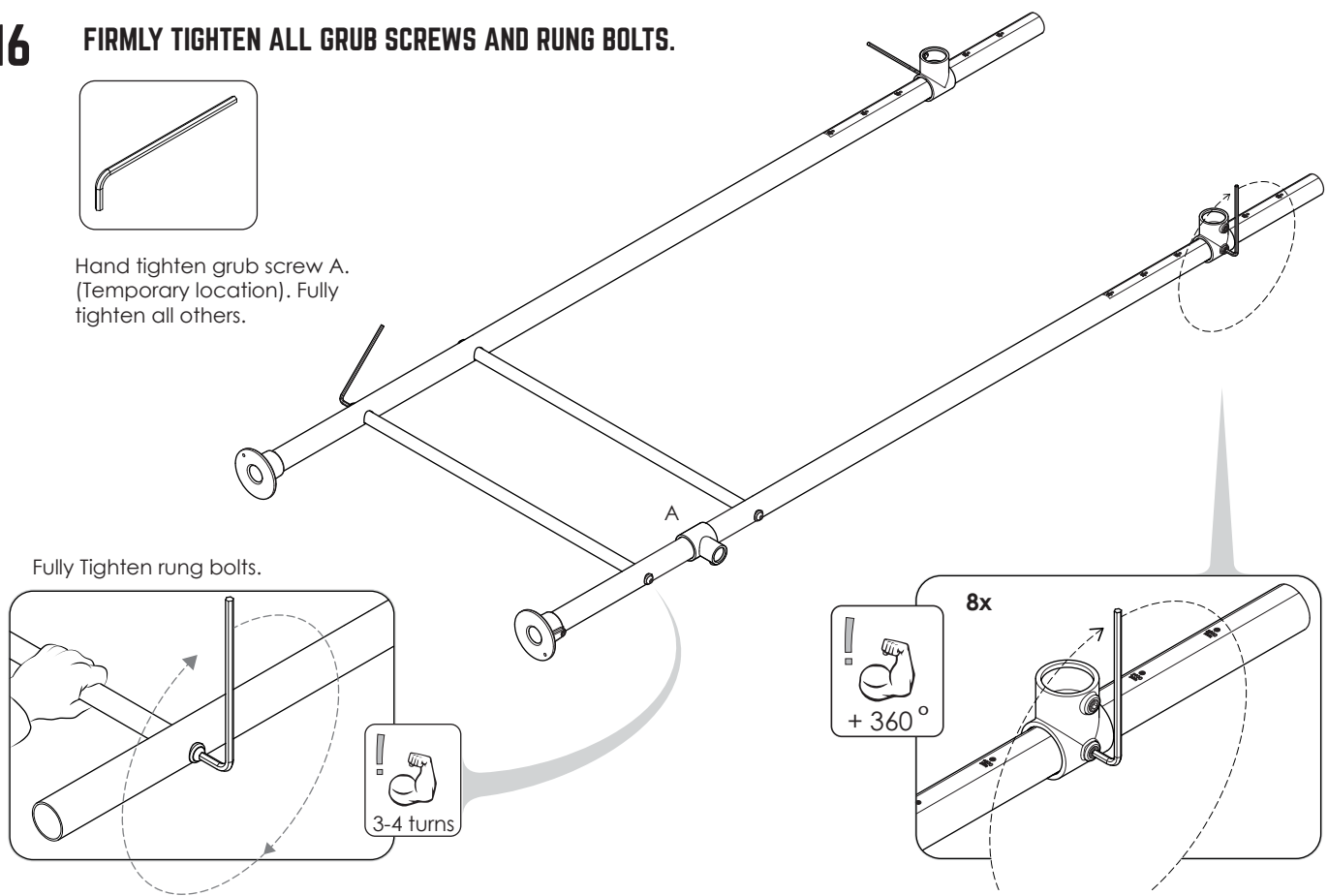

## 17 REPEAT STEPS 10 - 16 FOR SECOND PAIR OF LEGS. SAME PROCEDURE BUT WITHOUT REDUCING TEE.

## 18 LEG ASSEMBLY X 2.

Standing up with top tees facing each other. Check all grub screws are fully tightened.

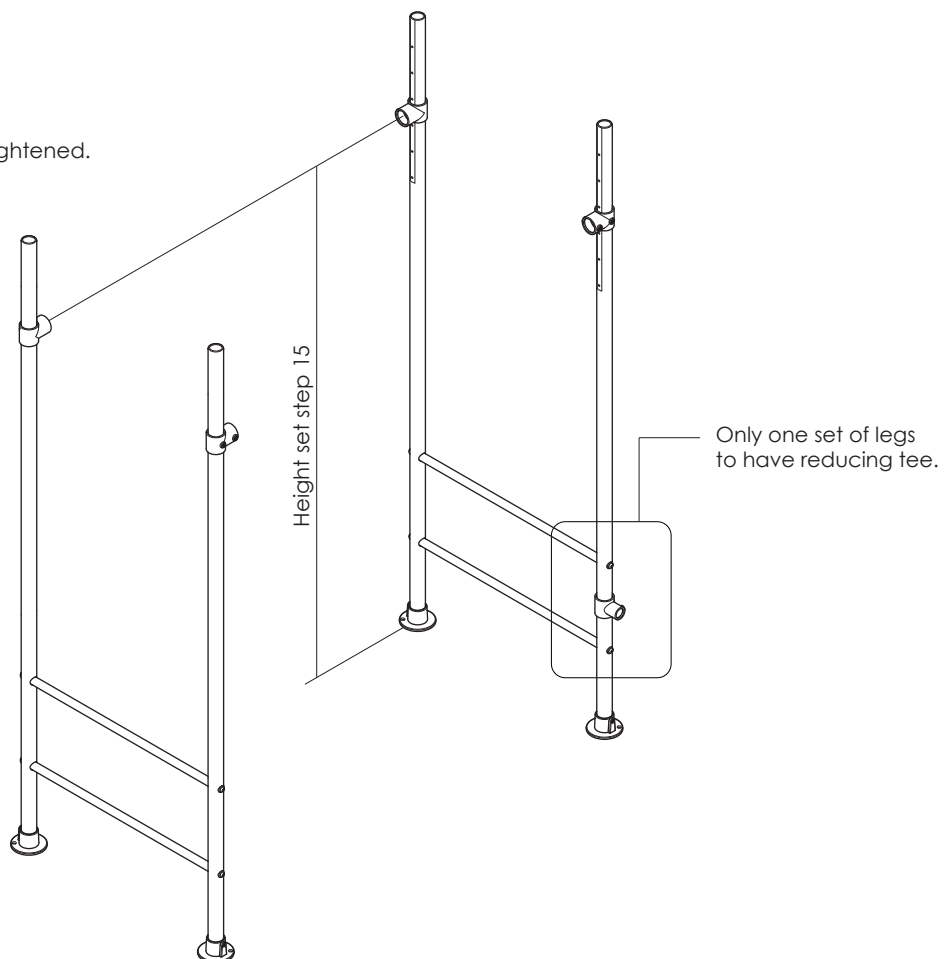

# ASSEMBLY INSTRUCTIONS - TWIRLY WHIRLY BAR ASSEMBLY

## 19 ASSEMBLE VERTICAL TWIRLY TUBE

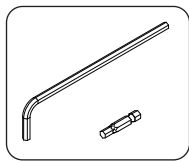

Tighten all grub screws.

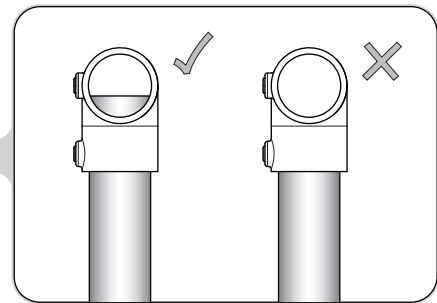
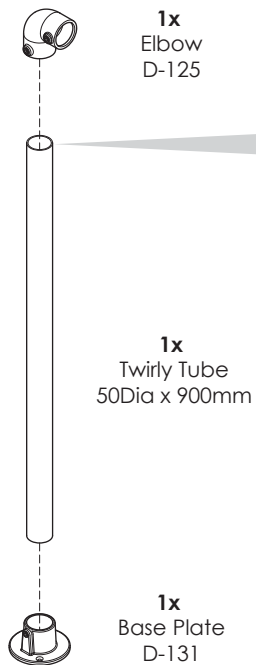

Insert Twirly Tube fully into Elbow.

## 20 ATTACH HORIZONTAL TWIRLY TUBE

Fully insert twirly tube then firmly tighten all grub screws.

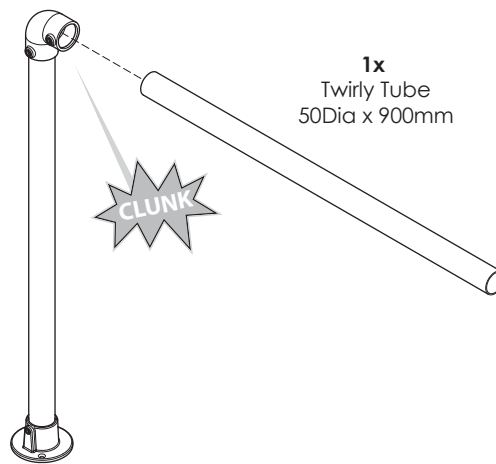
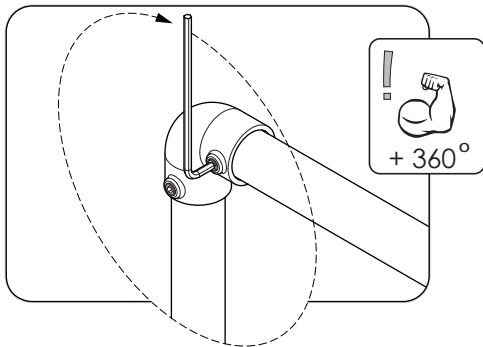

## 21 REPEAT STEPS 19 - 20 FOR 3 MORE TWIRLY WHIRLY BARS.

## 22 TWIRLY WHIRLY BAR x4

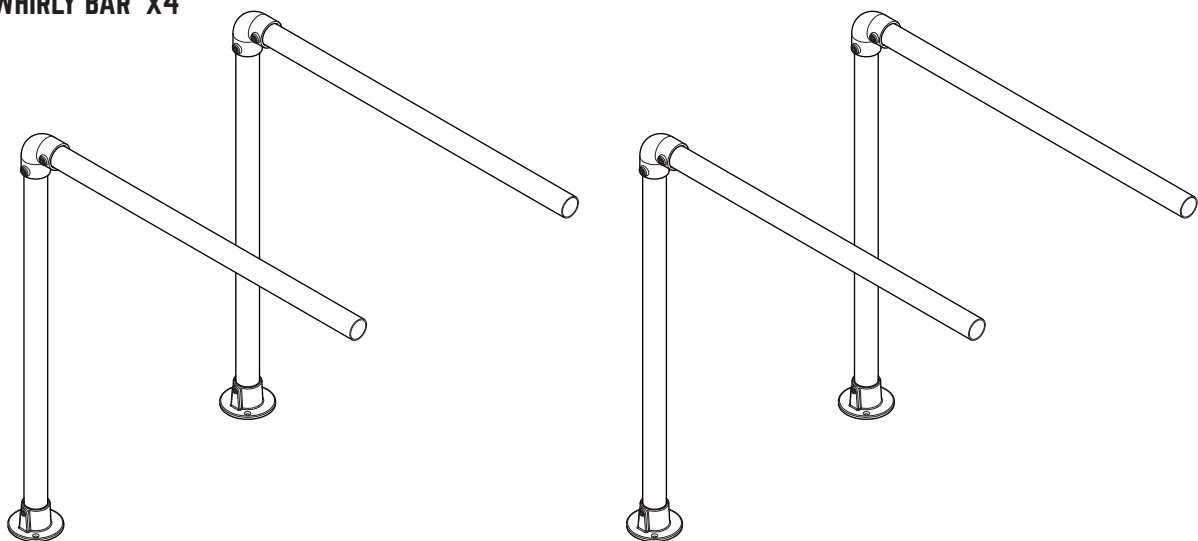

**23** FLIP LEGS OVER

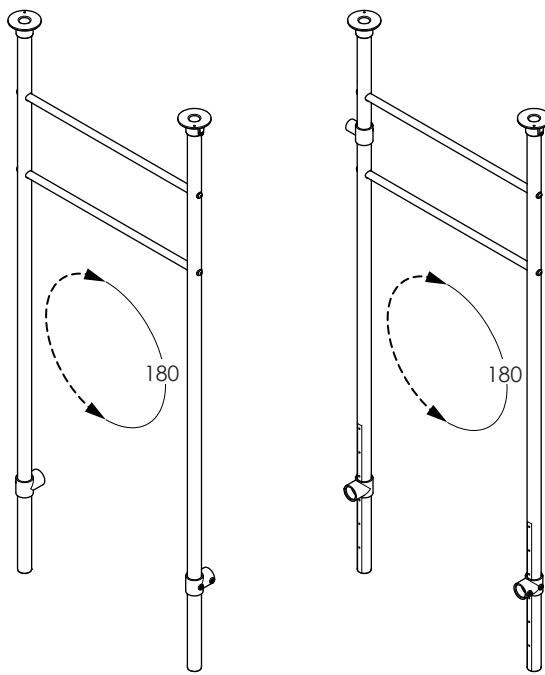
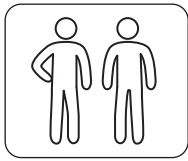

**24** ATTACH 2X LEGS TO LADDER

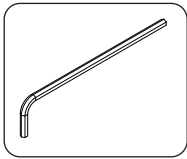

Tighten all grub screws.

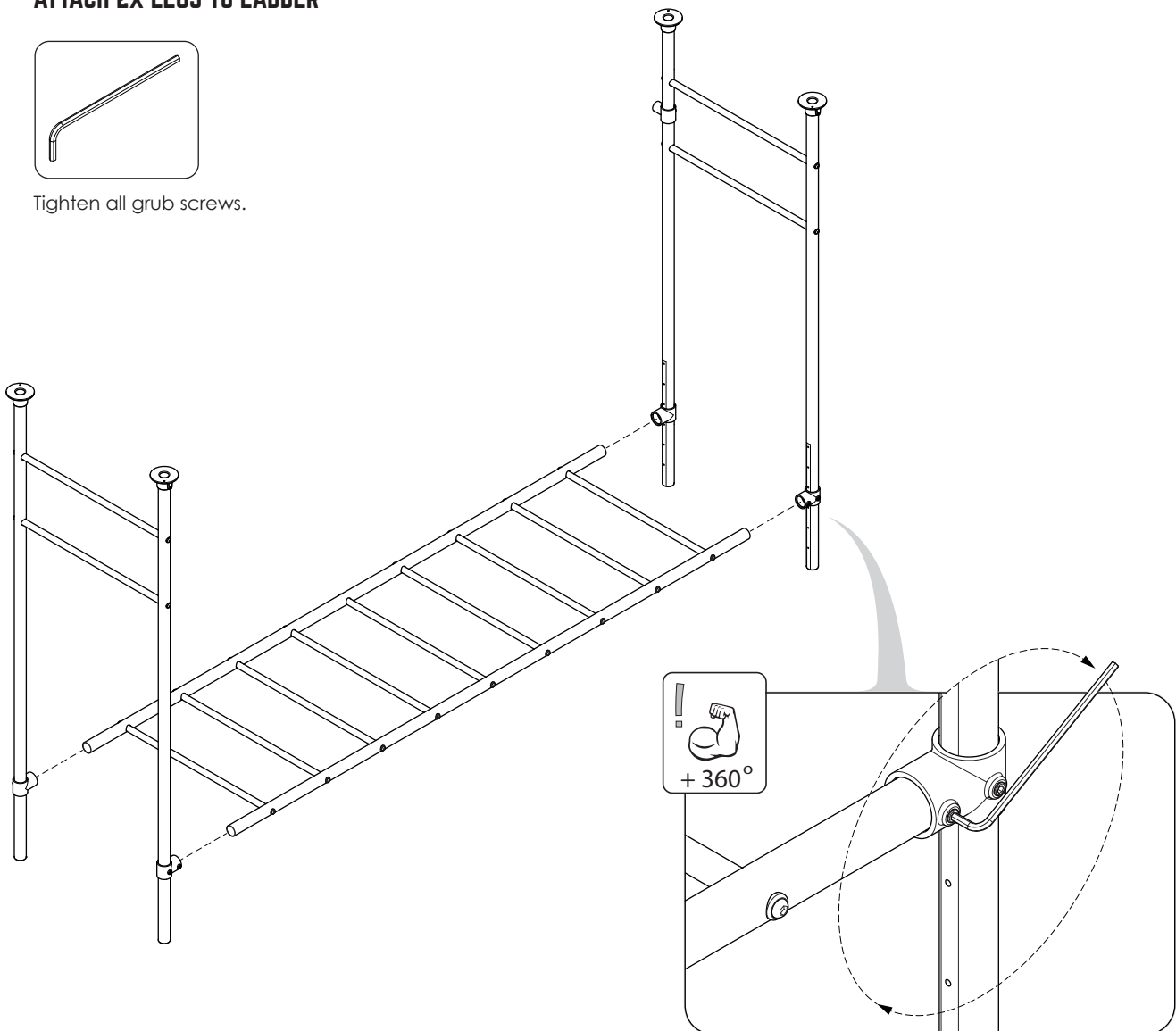

## 25 FLIP ASSEMBLY OVER

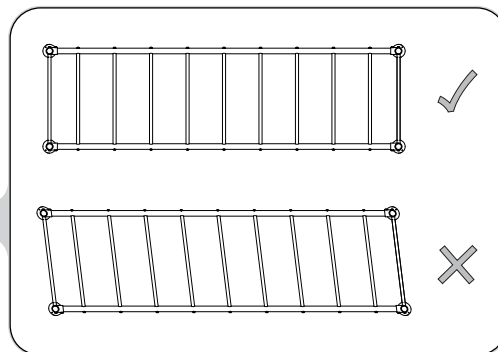
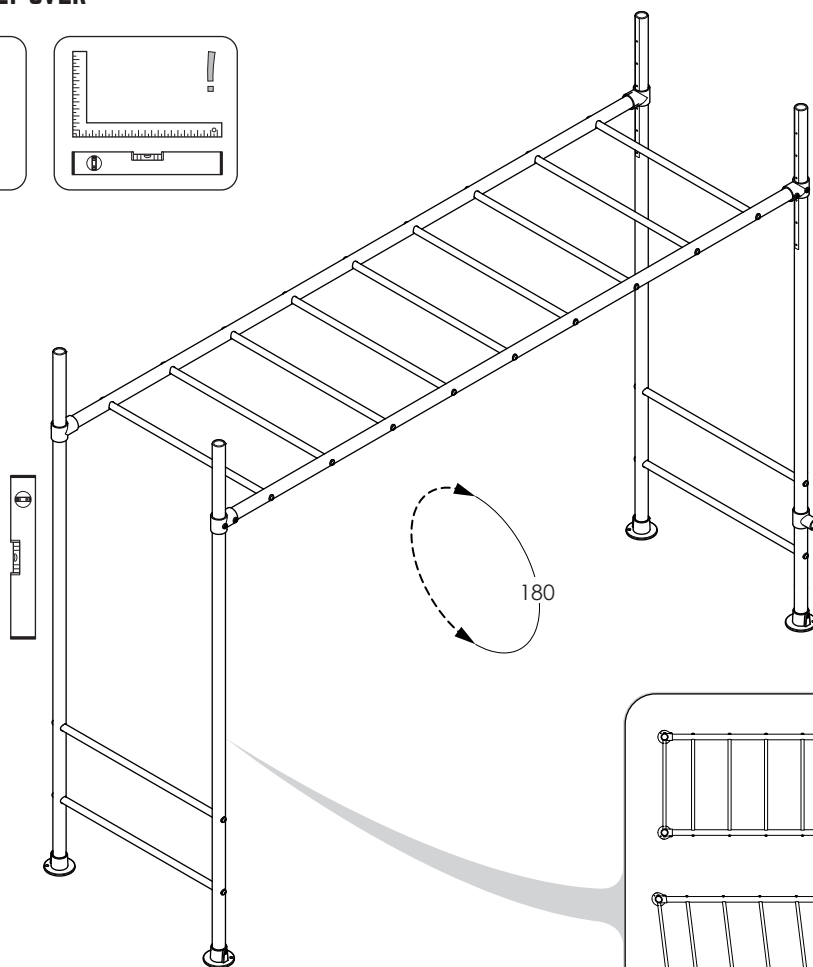
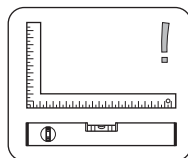
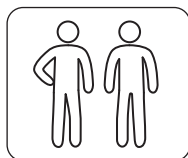

**CRITICAL : ENSURE YOUR FRAME IS 100% SQUARE AND LEVEL (AS PER PAGE 6) BEFORE MOVING ONTO THE REST OF THE ASSEMBLY**

## 26 SECURE TO GROUND

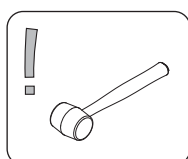

Select suitable location.  
Hammer in pegs x4.

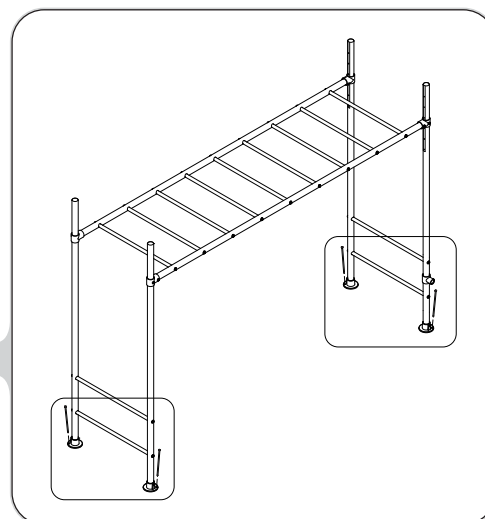
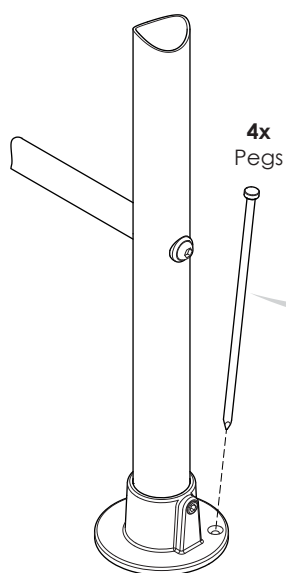

# ASSEMBLY INSTRUCTIONS - SWING BARS

## 27 ASSEMBLE SWING BARS X2



Slide straight through fitting and short tee onto 2950 tube- loosely tighten.

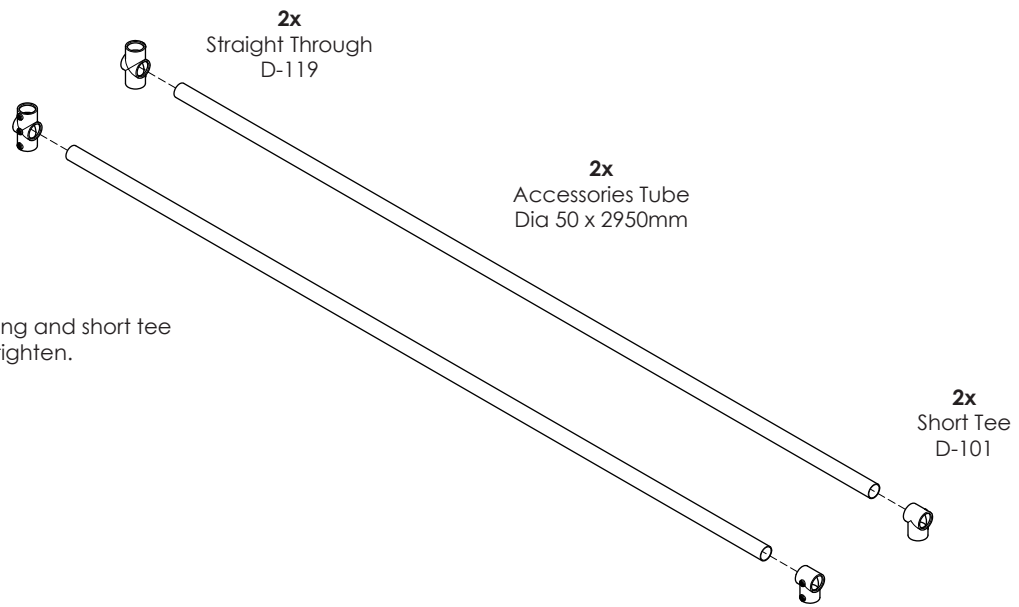

## 28 PLACE SWING BAR ASSEMBLY ON TOP X2

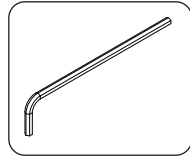
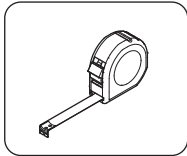

1. Make sure 2950mm tube is centered and level on ladder.

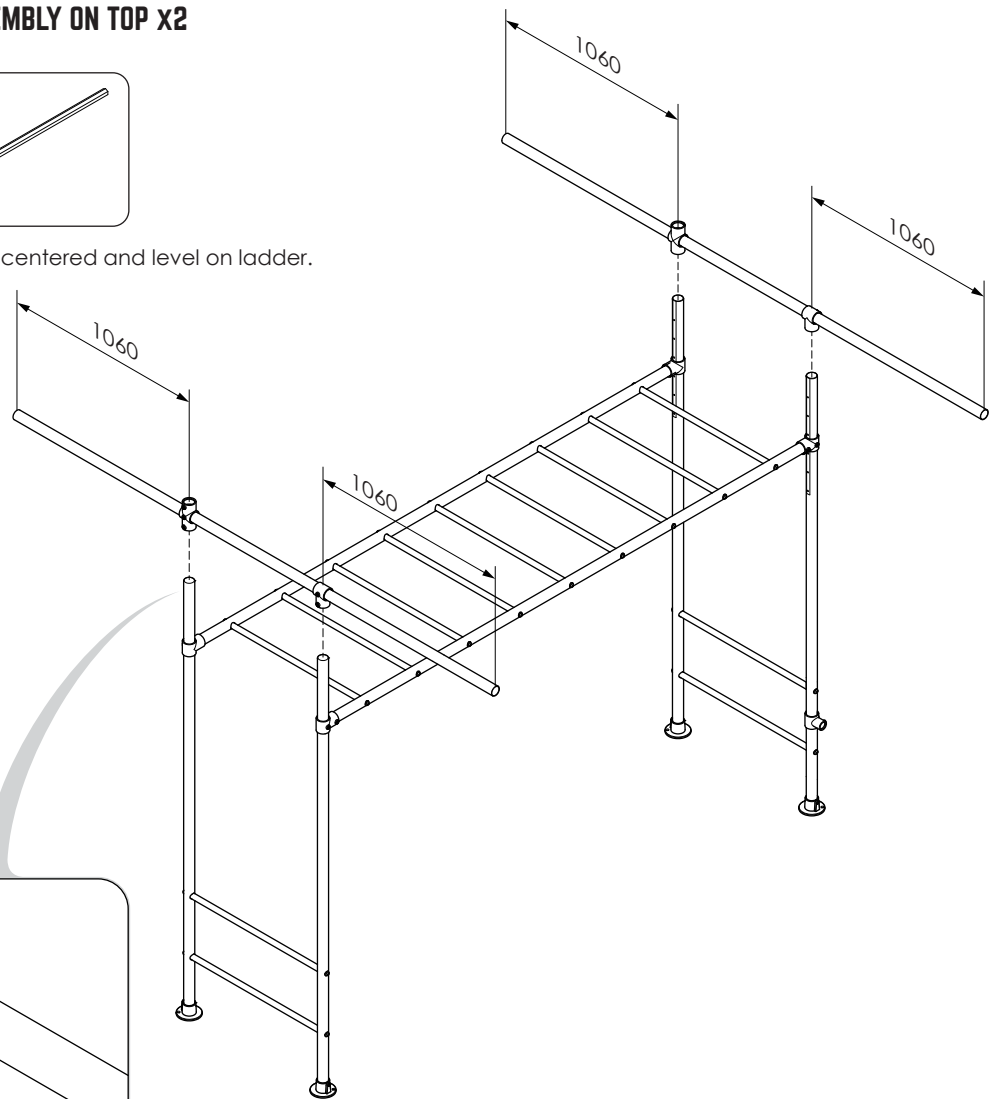

2. Tighten lower grub screws.

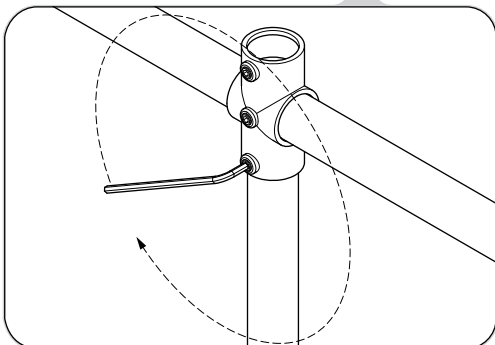

## 29 SLIDE ON SHORT TEES BOTH ENDS



Leave short tees loose.

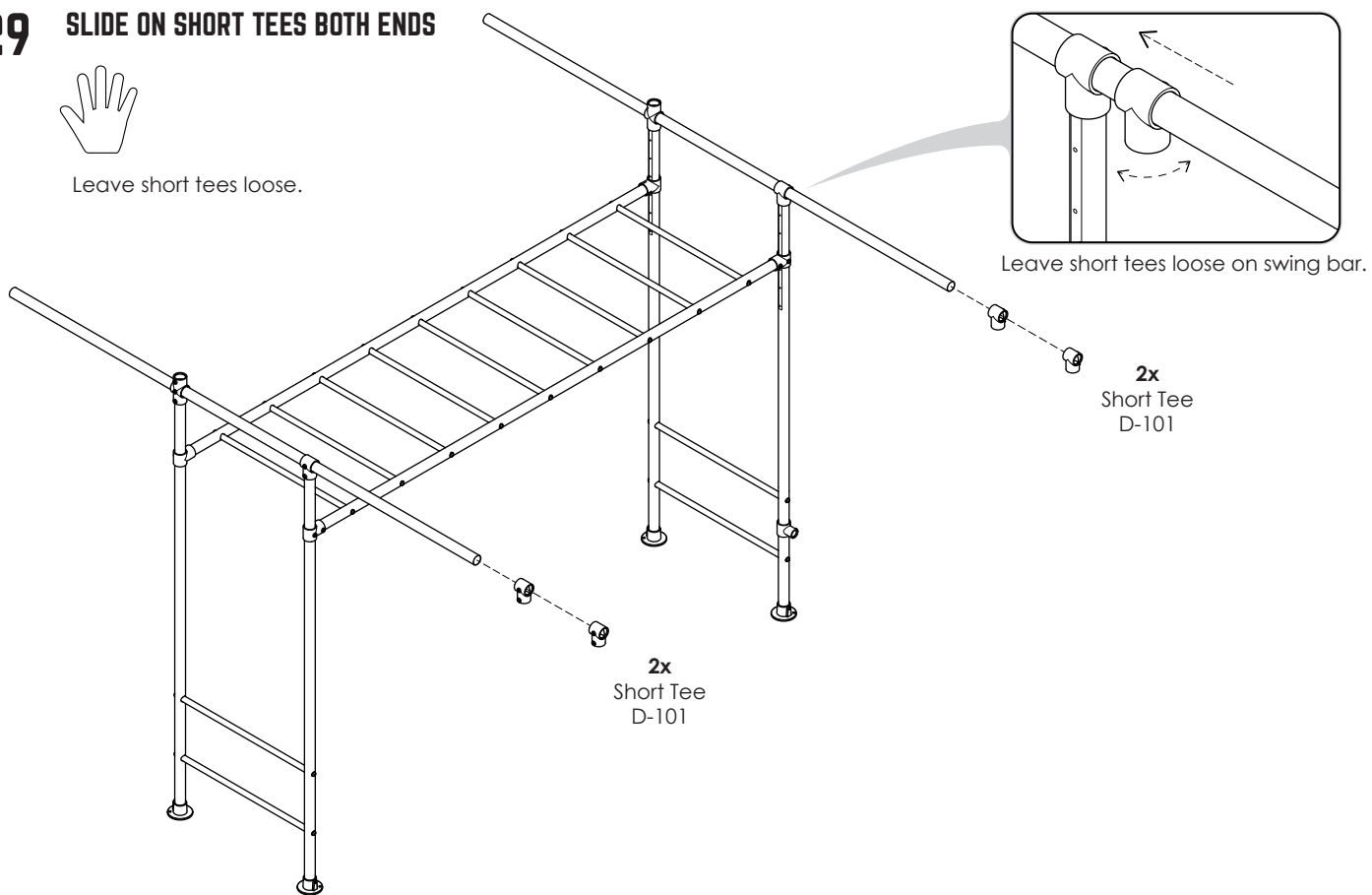

## 30 ATTACH SWING LEGS X2

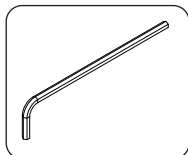

Fully tighten grub screws on bases, elbows and reducing tees.

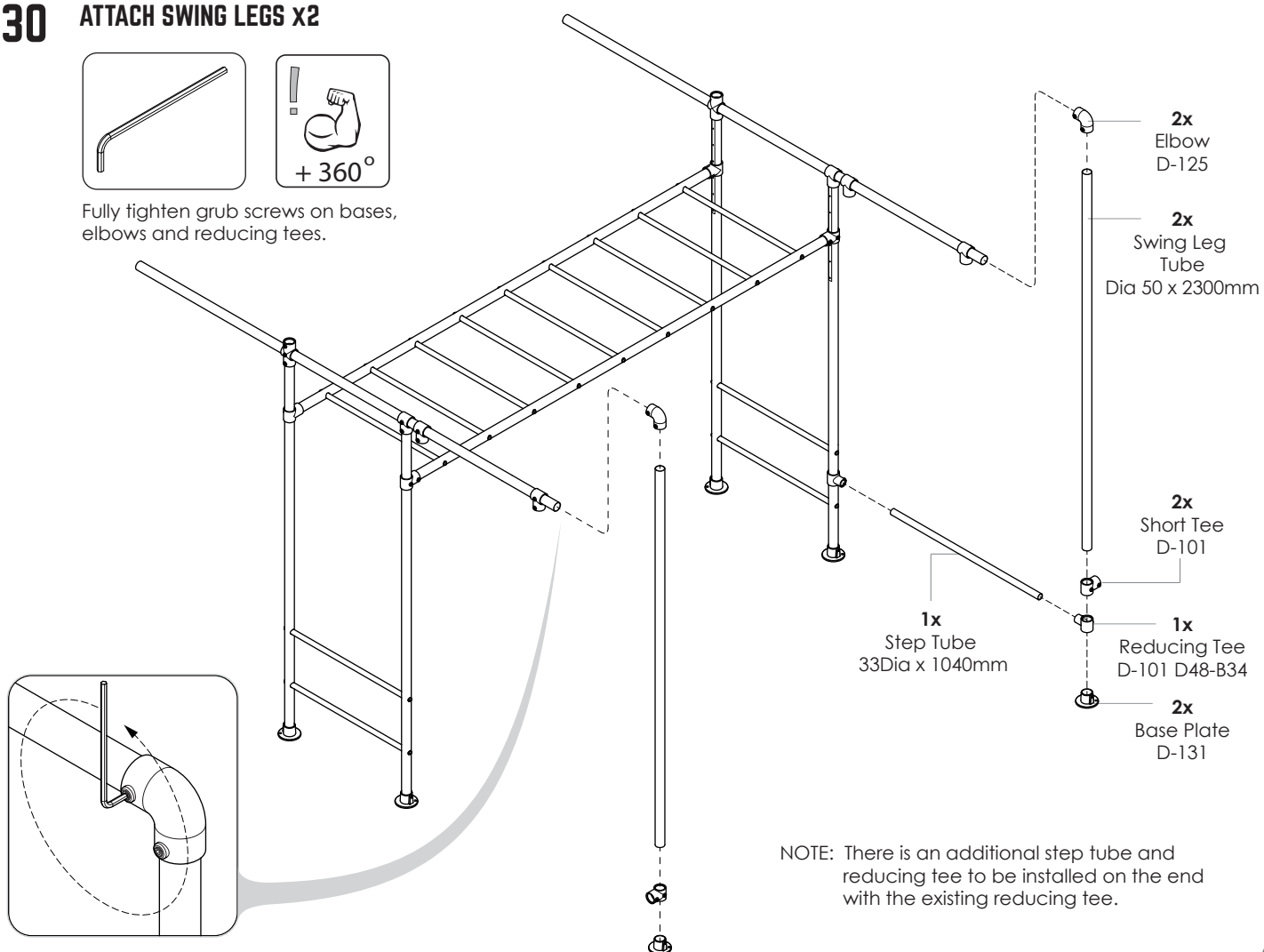

# ASSEMBLY INSTRUCTIONS - COMBAT LADDER

## 31 ASSEMBLE COMBAT LADDER JOINER X2

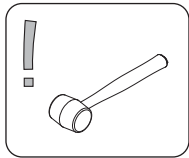

Insert plastic end caps into top support tubes. Slide on 145° 3 way fittings.

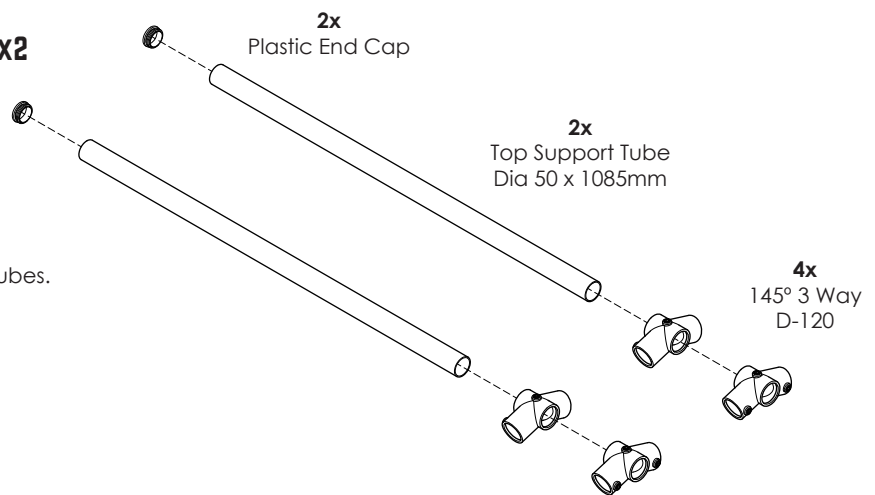

## 32 ATTACH FIRST COMBAT LADDER & JOINER

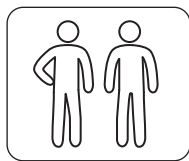
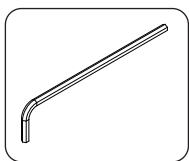

1. Attach combat ladder to short tees on one swing bar end (step end shown). Position centrally
2. Ensure plastic end cap in top support tube is flush with end of 145° fitting.

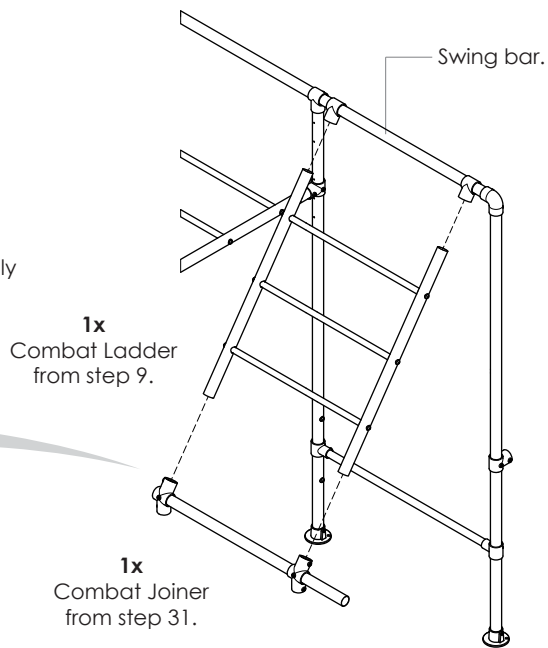
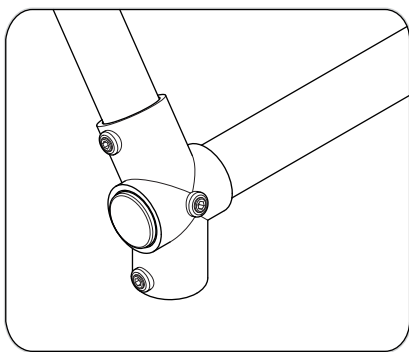

## 33 ATTACH SECOND COMBAT LADDER & JOINER

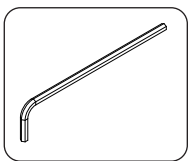

1. Attach second combat ladder to 145° joiner then attach second joiner.
2. Ensure plastic end cap in top support tube is flush with end of 145° fitting.

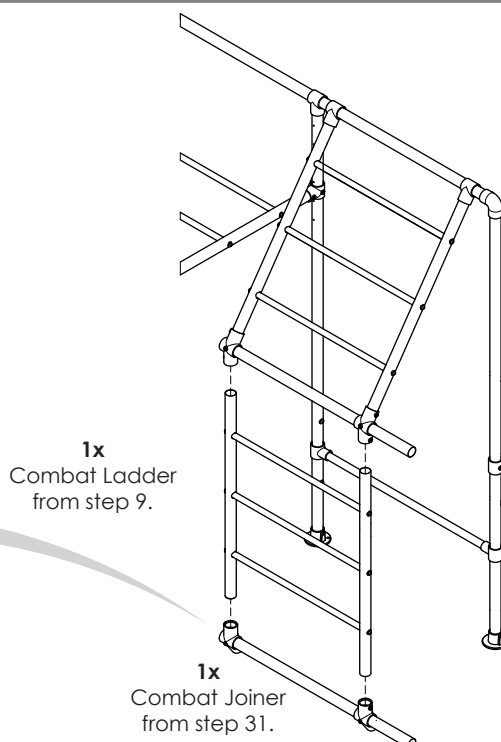
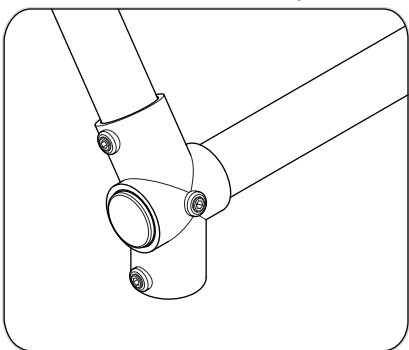

### 34 ATTACH THIRD COMBAT LADDER

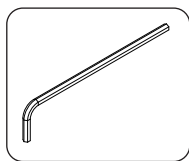

1. Attach final combat ladder to 145° fitting.
2. Fully tighten all fixings except onto swing bar.

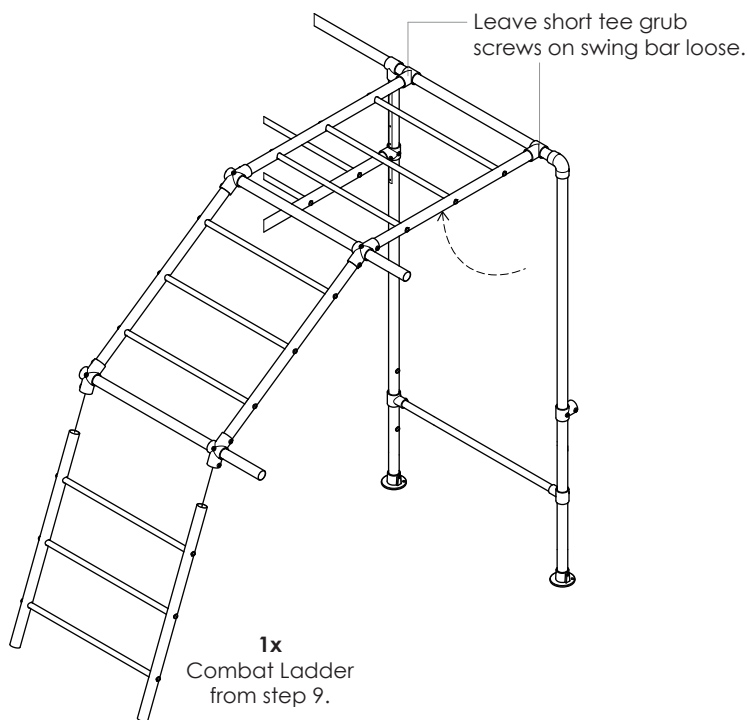
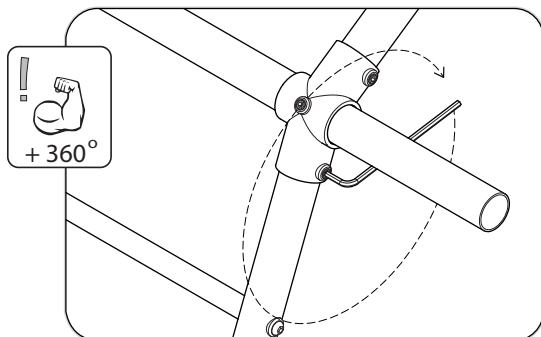

### 35 ASSEMBLE SUPPORT SECTION

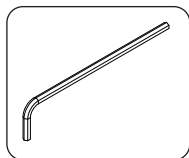

1. Tighten grub screws on elbows. Leave short tee and swing hook loose on support tube.
2. Flip over assembly for installation

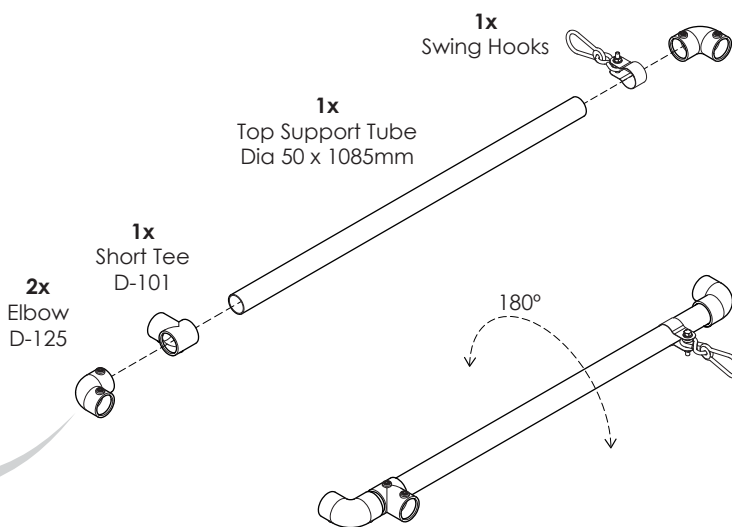
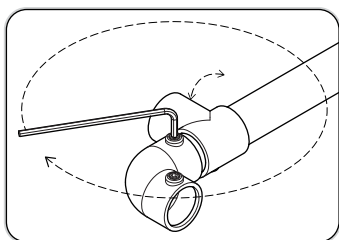

### 36 ATTACH SUPPORT SECTION TO COMBAT LADDER

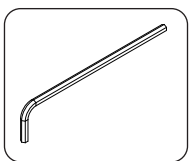

Tighten all elbow grub screws.

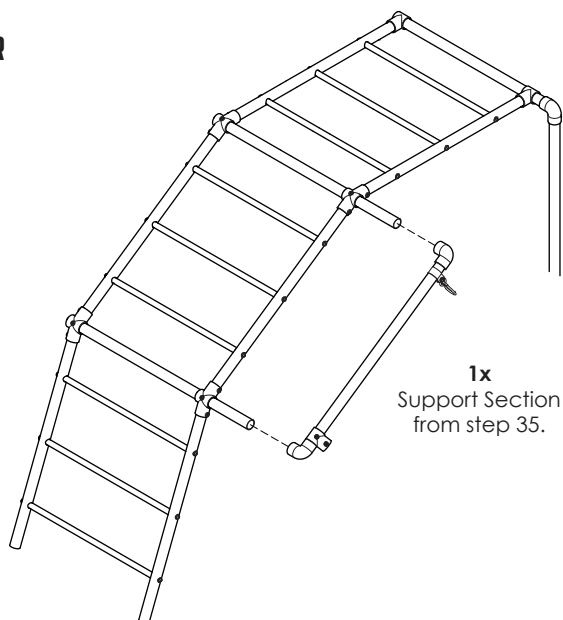



### 37 ASSEMBLE SUPPORT LEG

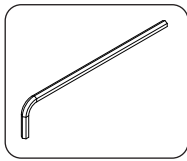

1. Tighten grub screw on 4 hole base plate.

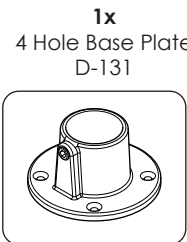

1x  
4 Hole Base Plate  
D-131

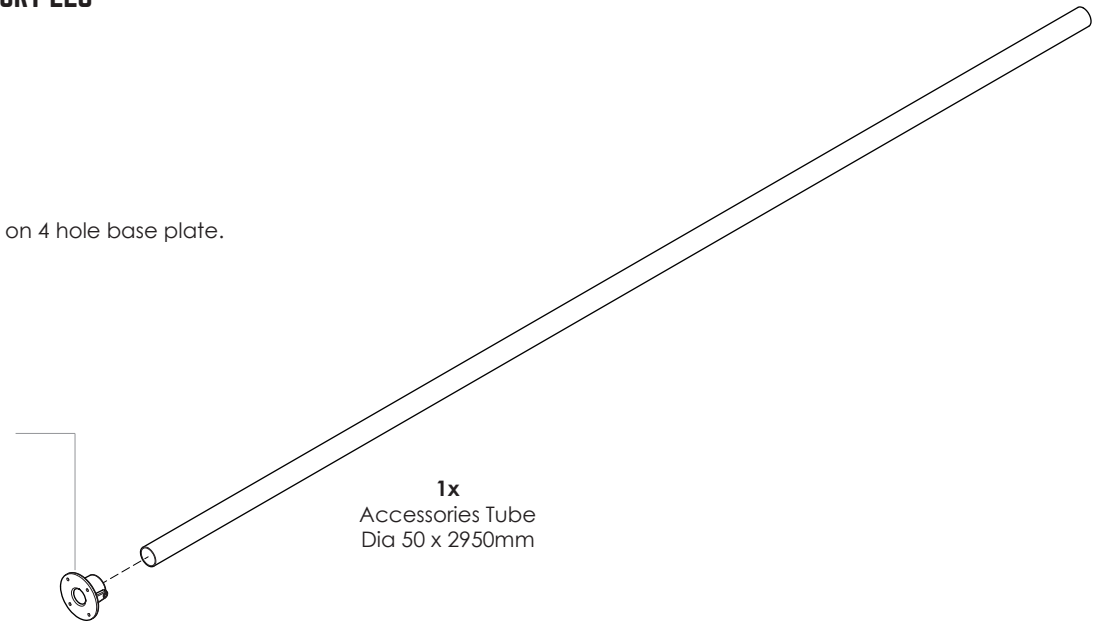

1x  
Accessories Tube  
Dia 50 x 2950mm

### 38 ATTACH SUPPORT LEG TO COMBAT LADDER

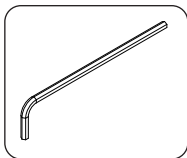

Fully tighten fixing to leg.

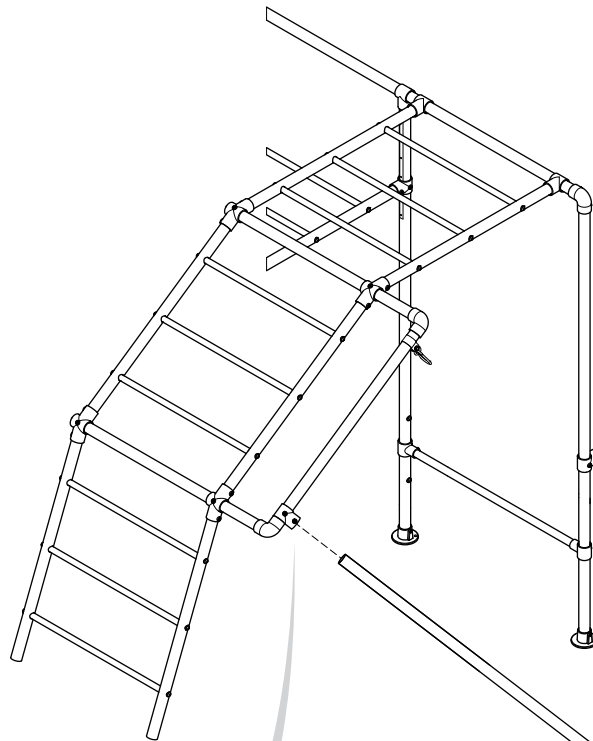

Leave short tee loose on support tube.

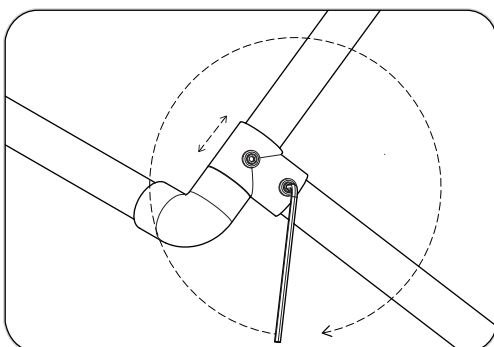

1x  
Support Leg  
from step 37.

## 39 LIFT COMBAT LADDER INTO POSITION

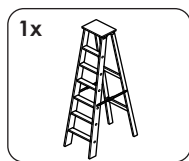
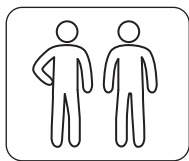

1. By pushing inwards and upwards on the support leg move the combat ladder up into position.
2. The second person up a 3m ladder should guide the combat ladder into the short tees.

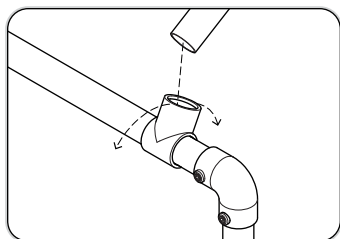

2. Fully Tighten all grub screws.

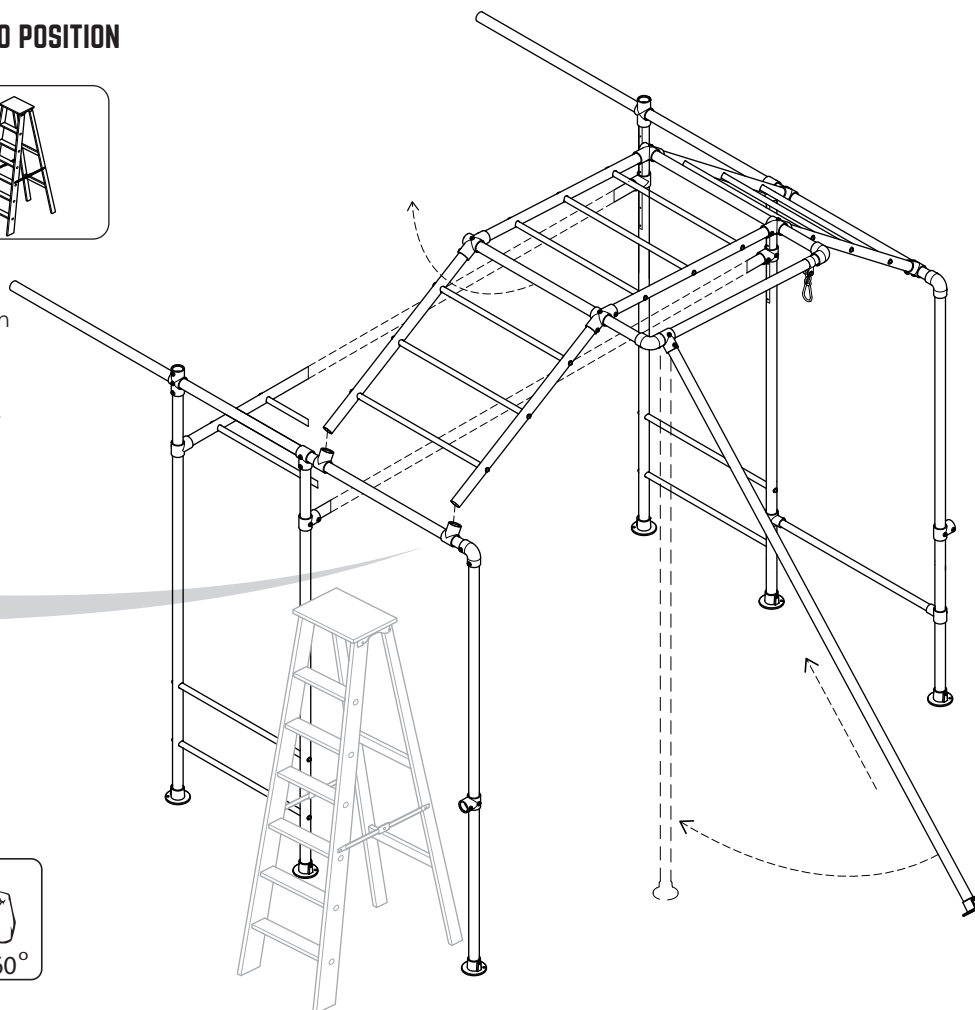
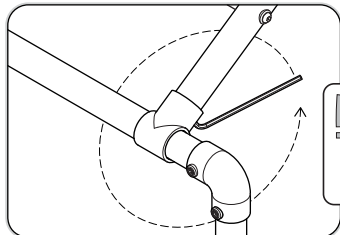

## 40 SECURE TO GROUND

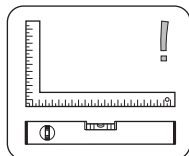
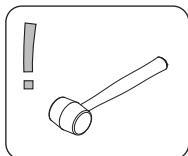

1. Check level and square.
2. Hammer in pegs x6.

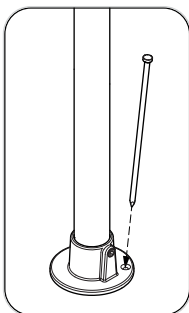

Base plate A & B

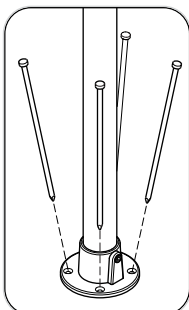

Base plate C

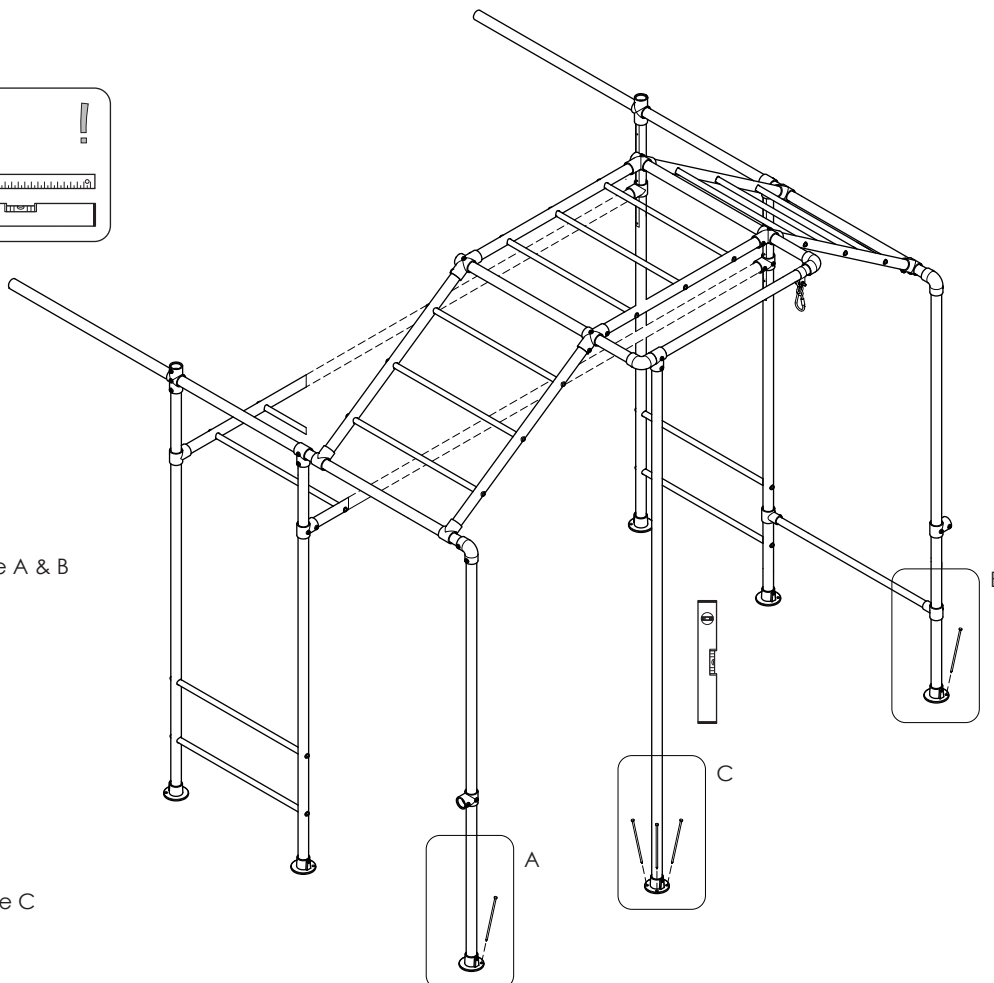

# ASSEMBLY INSTRUCTIONS - 3M OVERHEAD EXTENDER

## 41 ASSEMBLE LEGS X2

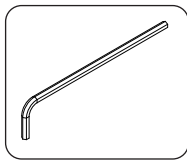

1. Slide on fittings and tighten - leave short tees loose.

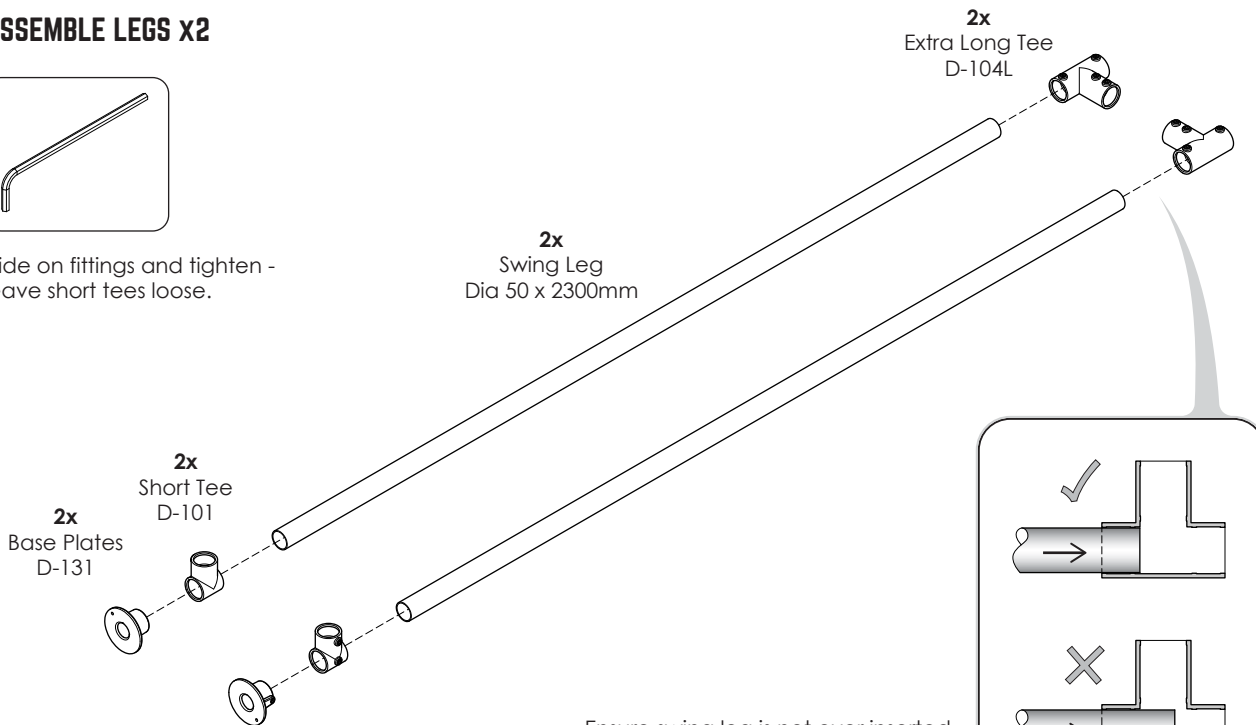

Ensure swing leg is not over inserted - & is level with side hole.

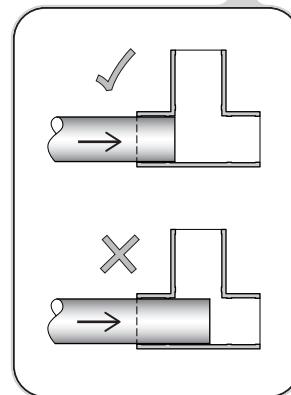

## 42 ATTACH SWING LEGS

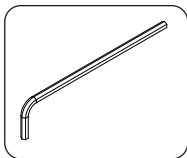

1. Slide on swing hook and legs.
2. Tighten grub screws.

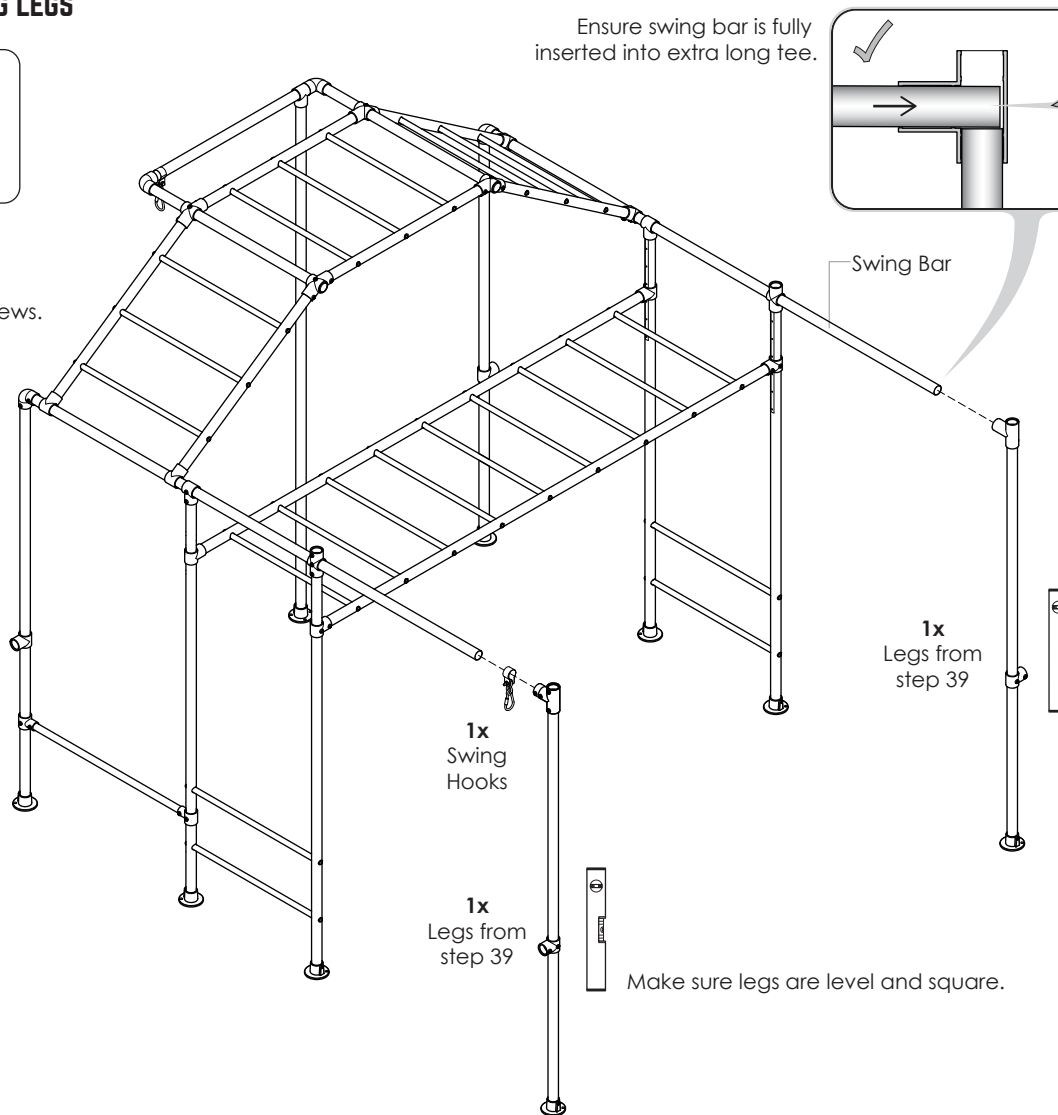

Ensure swing bar is fully inserted into extra long tee.

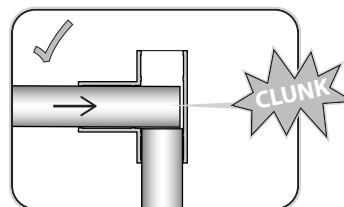

Make sure legs are level and square.

### 43 INSERT EXTENDER TUBES X4



Insert extender tubes and leave loose whilst installing extender frame.

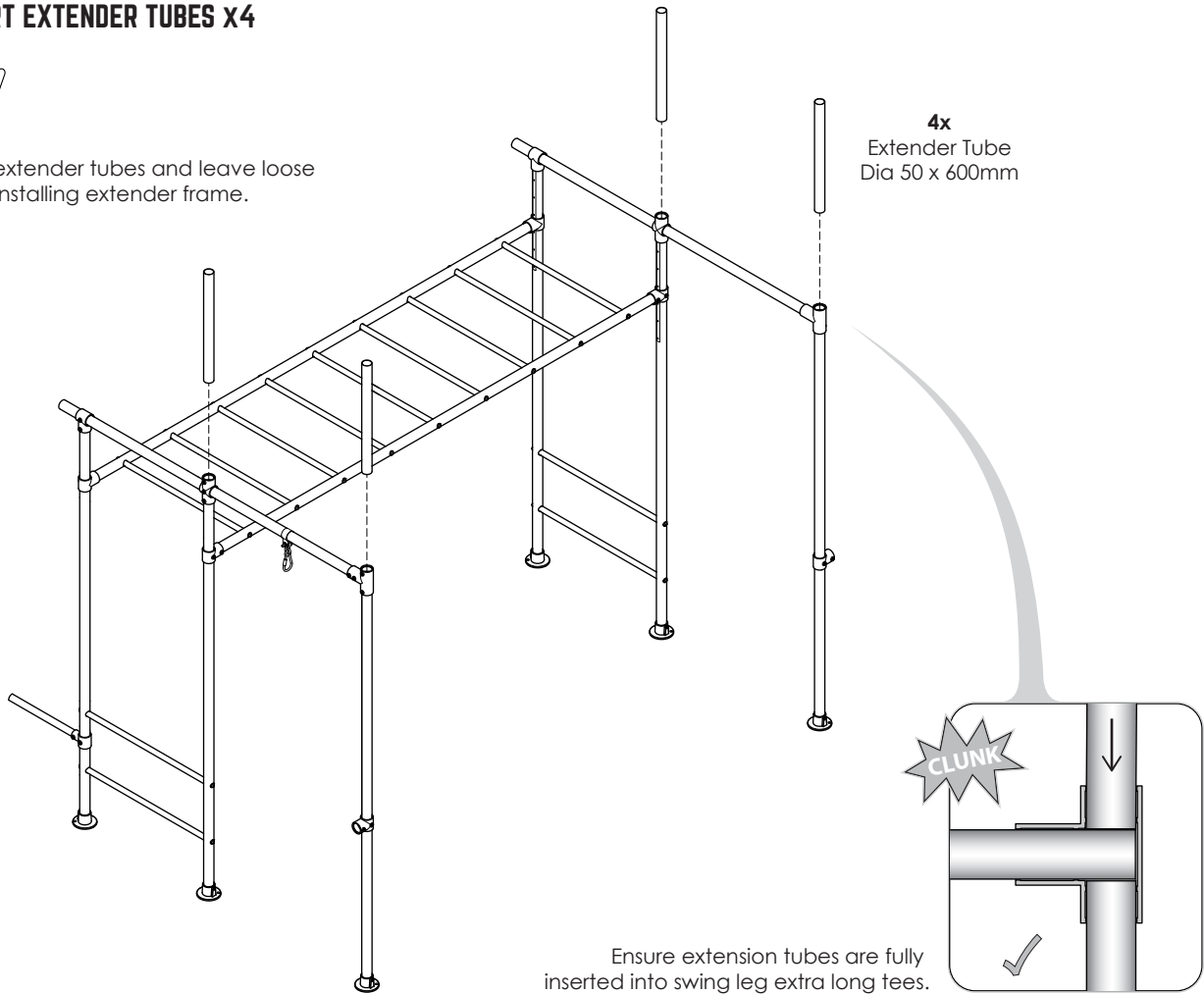

### 44 ASSEMBLE ACCESSORY BARS X2

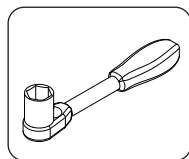
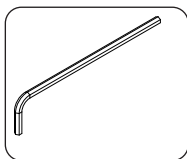

Equally space out swing hooks (if applicable), and tighten the bolts in place.

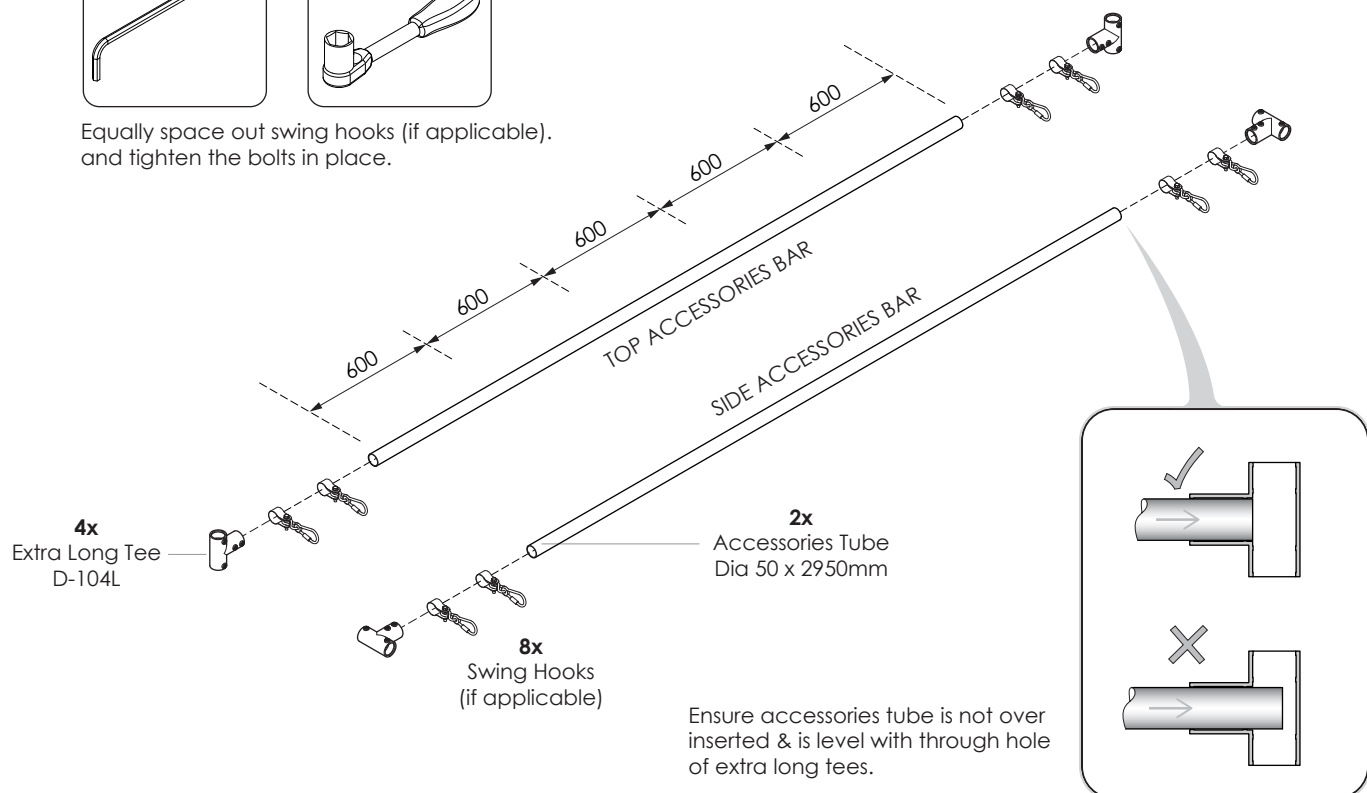

## 45 INSTALL SIDE ACCESSORY BAR

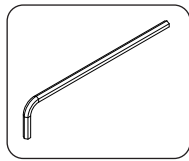
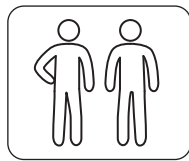
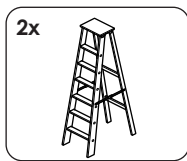

With a ladder at each end slide on side accessory bar and tighten grub screws at desired height. Ensure bar is level.

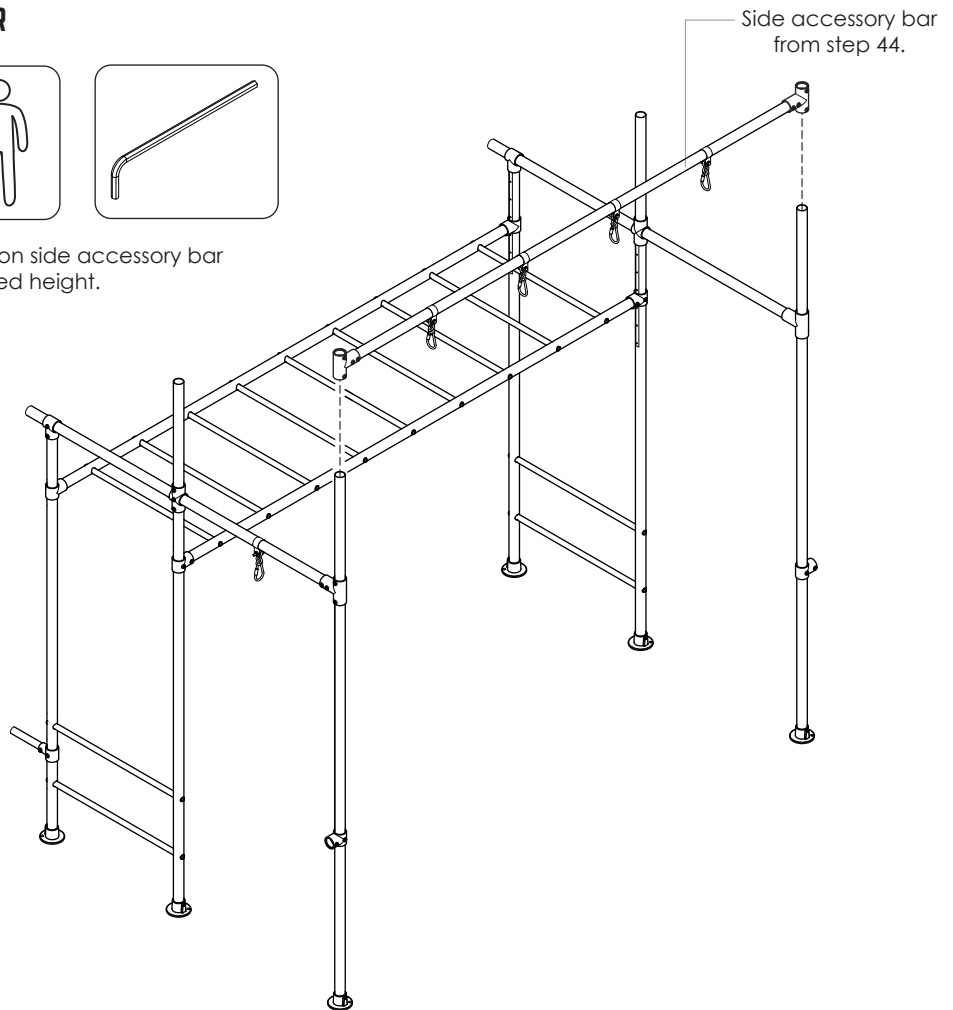

## 46 ASSEMBLE TOP ACCESSORY BAR

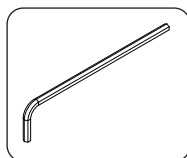

1. Centre accessory bar on cargo tubes.

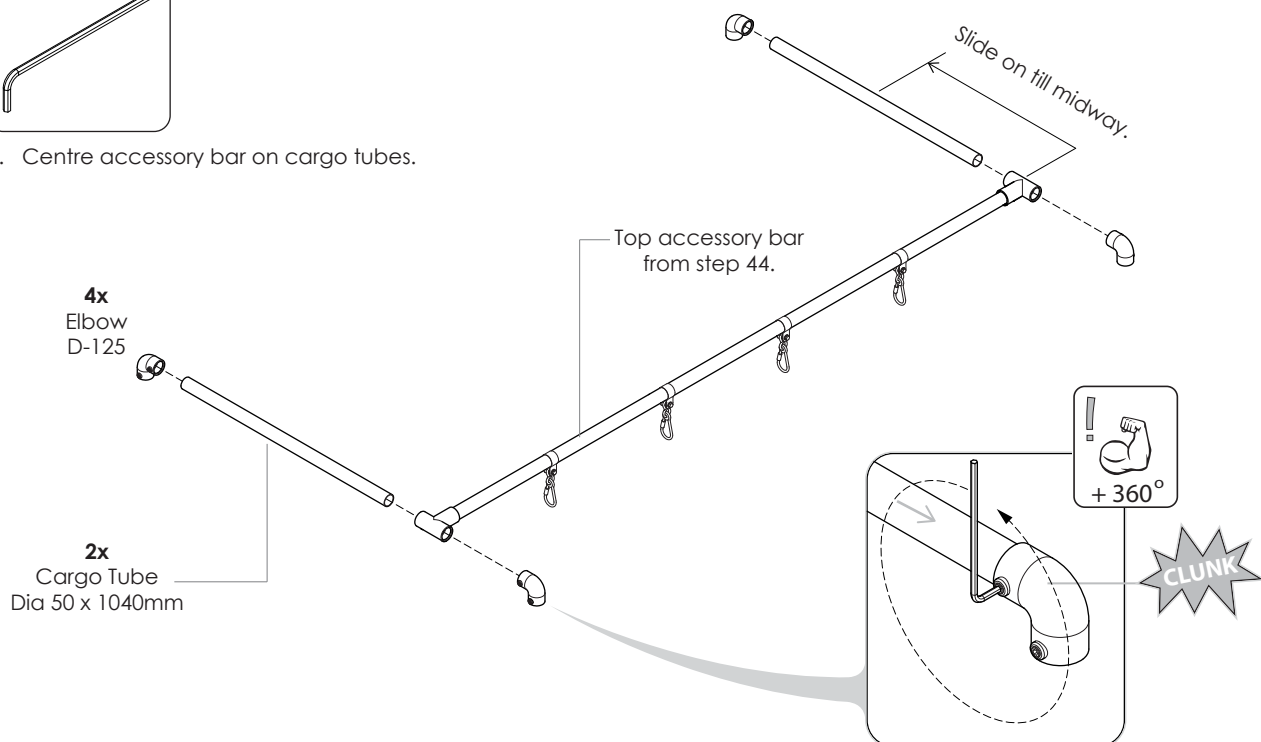

2. Fully insert cargo tubes into elbows until you hear the clunk sound.
3. Tighten all grub screws.

## 47 INSTALL SIDE ACCESSORY BAR

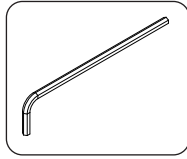
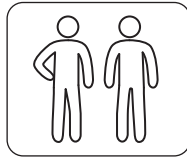
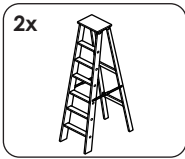

1. With a ladder at each end install top accessory bar assembly.

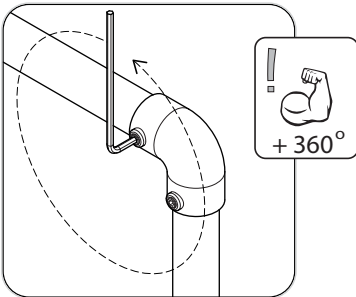

2. Tighten all grub screws firmly.

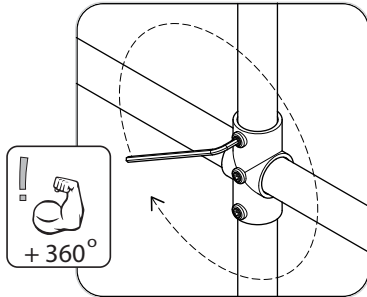

2. Don't forget to tighten all extender tube fixings.

Top accessory bar  
from step 46.

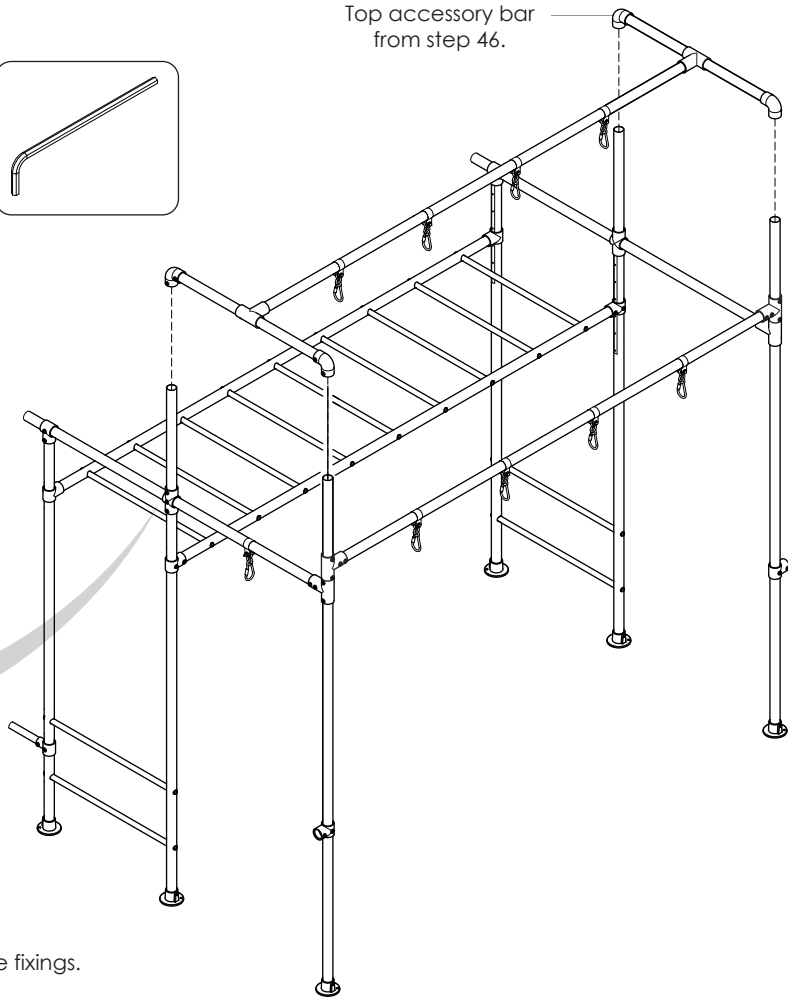

## 48 SECURE TO GROUND

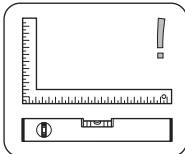

1. Check level and square.

2. Hammer in pegs x3.

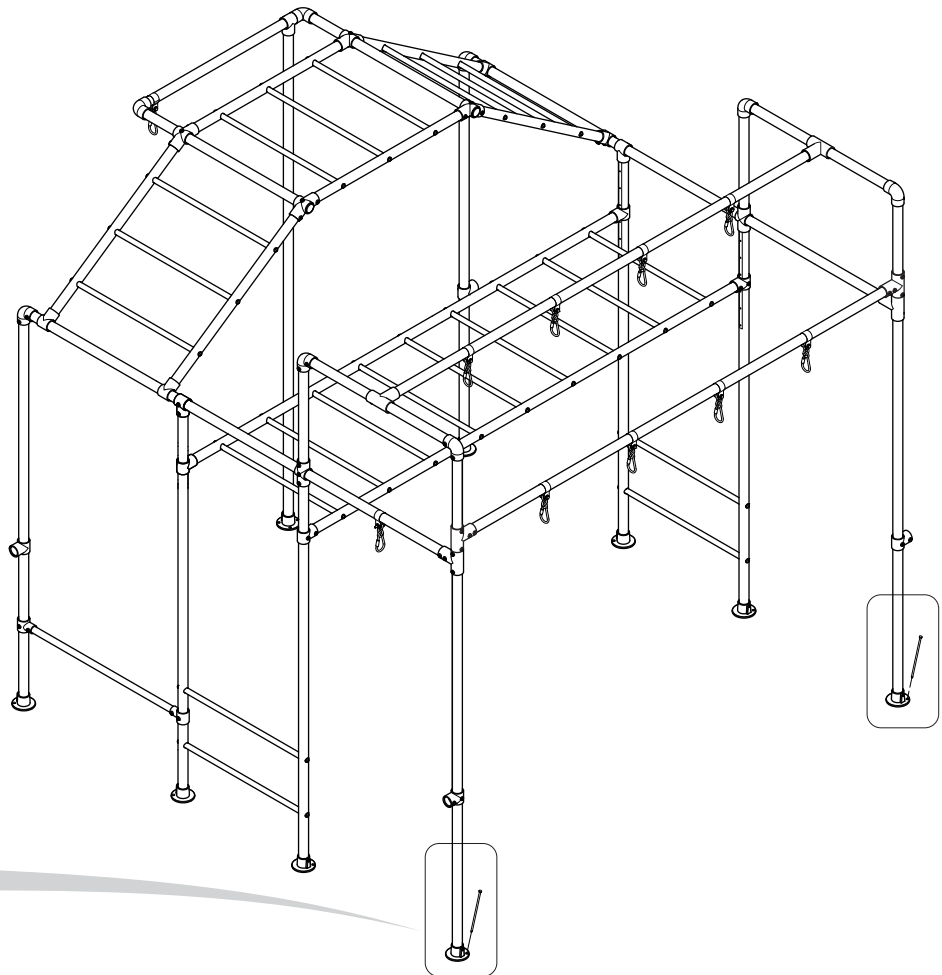
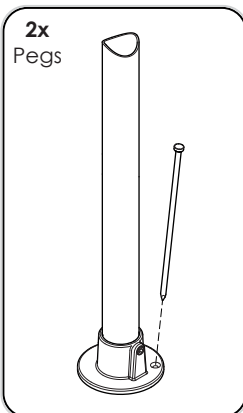

## 49 ATTACH TWIRLY WHIRLY BARS x4

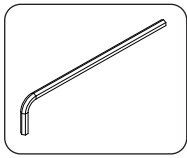

Tighten all grub screws.

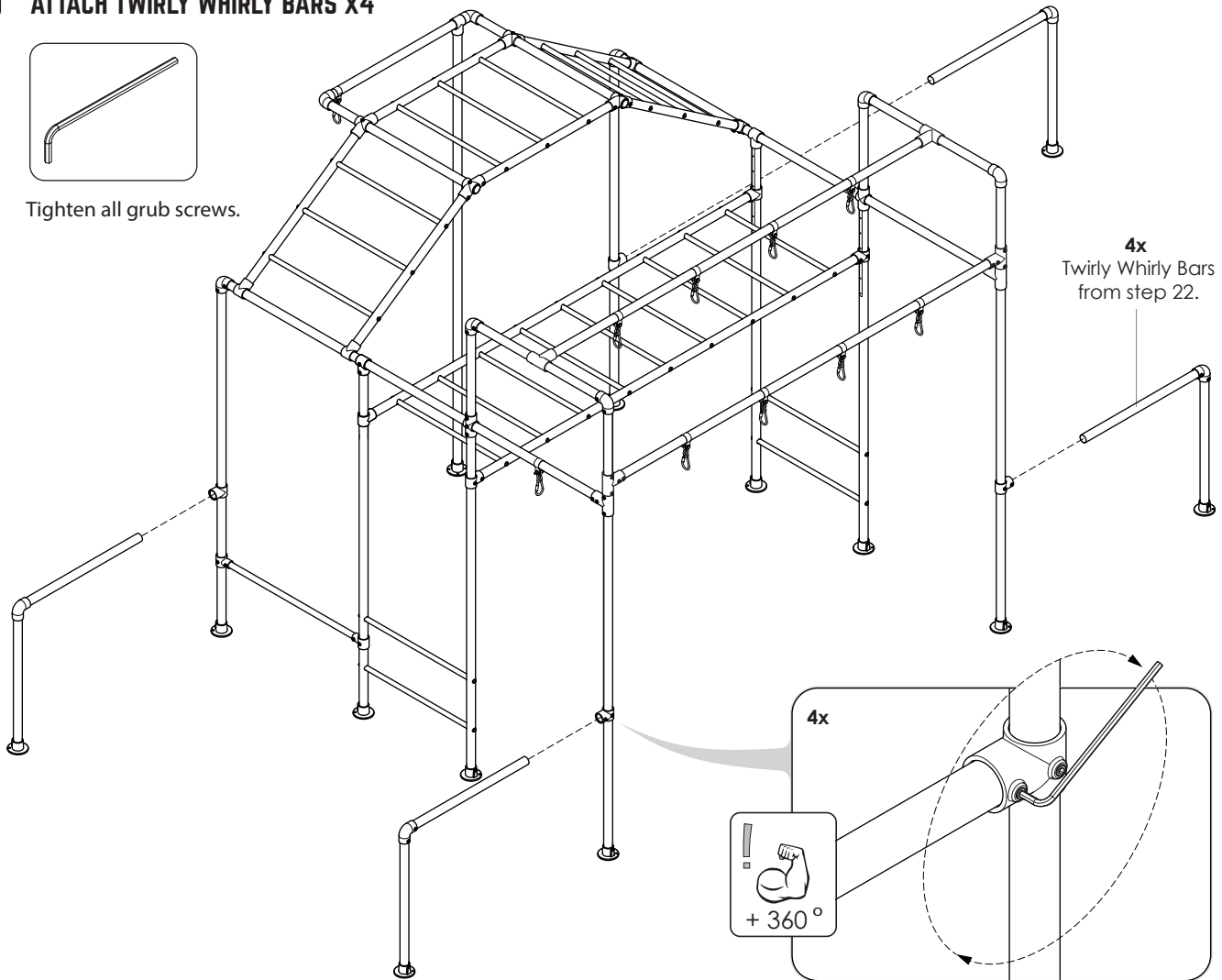

## 50 LOAD YOUR TWIRLY WHIRLY BARS x4

To reduce movement in your frame load your twirly whirly bars as follows.

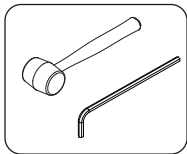

2. Loosen the grub screw fixing the short tee to the swing leg.

4. Peg down base plates on twirly whirly.

6. Tighten grub screw fixing the short tee to the swing leg tube.

Swing leg

Twirly Whirly

1. Insert the twirly whirly bar and tighten grub screw on the short tee as per step 49.

3. Pull upwards on the twirly whirly bar to make a slight angle.

5. Push down on the twirly whirly bar until horizontal bar is level.

REFER TO VIDEO SECTION OF WEBSITE [HTTP://WWW.FUNKYMONKEYBARS.COM/PAGES/VIDEOS](http://www.funkymonkeybars.com/pages/videos)

## 51 ATTACH ACCESSORIES

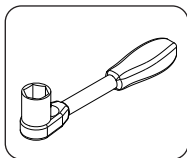

Attach accessories in desired position and tighten swing hook bolts with ratchet.

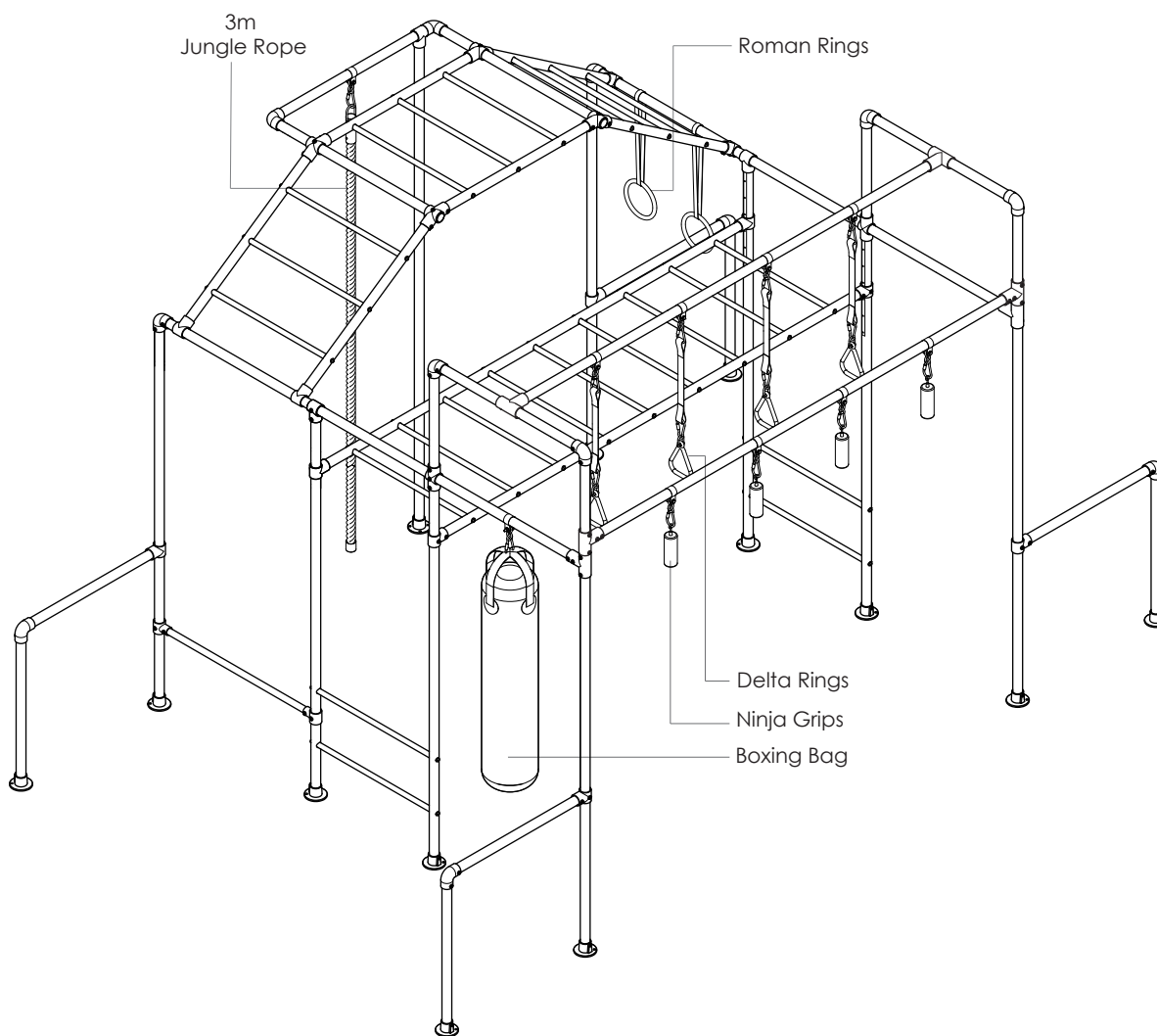

## 52 FINAL CHECKS

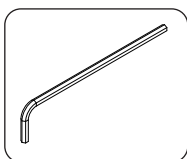

Firmly tighten all grub screws.

Apply your manufacturing sticker to a leg tube.





## 53 MAINTENANCE.

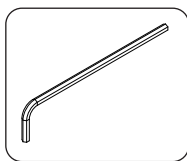
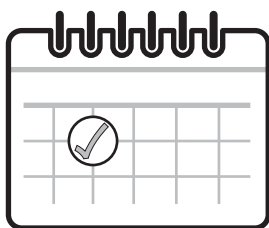

At the beginning of each heavy play session (especially a party) and twice a month during play season ensure;

1. Tighten all hardware - grub screws, nuts and bolts.
2. Pegs are in place and fully secure.
3. Lubricate all metallic moving parts (trolley and swing hooks.)
4. Ensure your frame is level and square.

**FAILURE TO DO SO COULD RESULT IN SERIOUS INJURY OR DEATH.**

**FOR MORE INFORMATION AND ASSEMBLY TIPS  
PLEASE REFER TO OUR WEBSITE VIDEO INSTRUCTION SECTION AT  
[HTTP://WWW.FUNKYMONKEYBARS.COM/PAGES/VIDEOS](http://www.funkymonkeybars.com/pages/videos)**

## 54 HAVE FUN





ABN 72 164 496 520  
 1300 912 198  
 info@funkymonkeybars.com  
 www.funkymonkeybars.com  
 9 Cutting Way,  
Yangebup WA 6164



WE ARE SOCIAL MONKEYS



Australian Government  
IP Australia

All Funky Monkey Bars® designs are registered and protected under IP Australian certification.