

FUNKY Monkey bars®

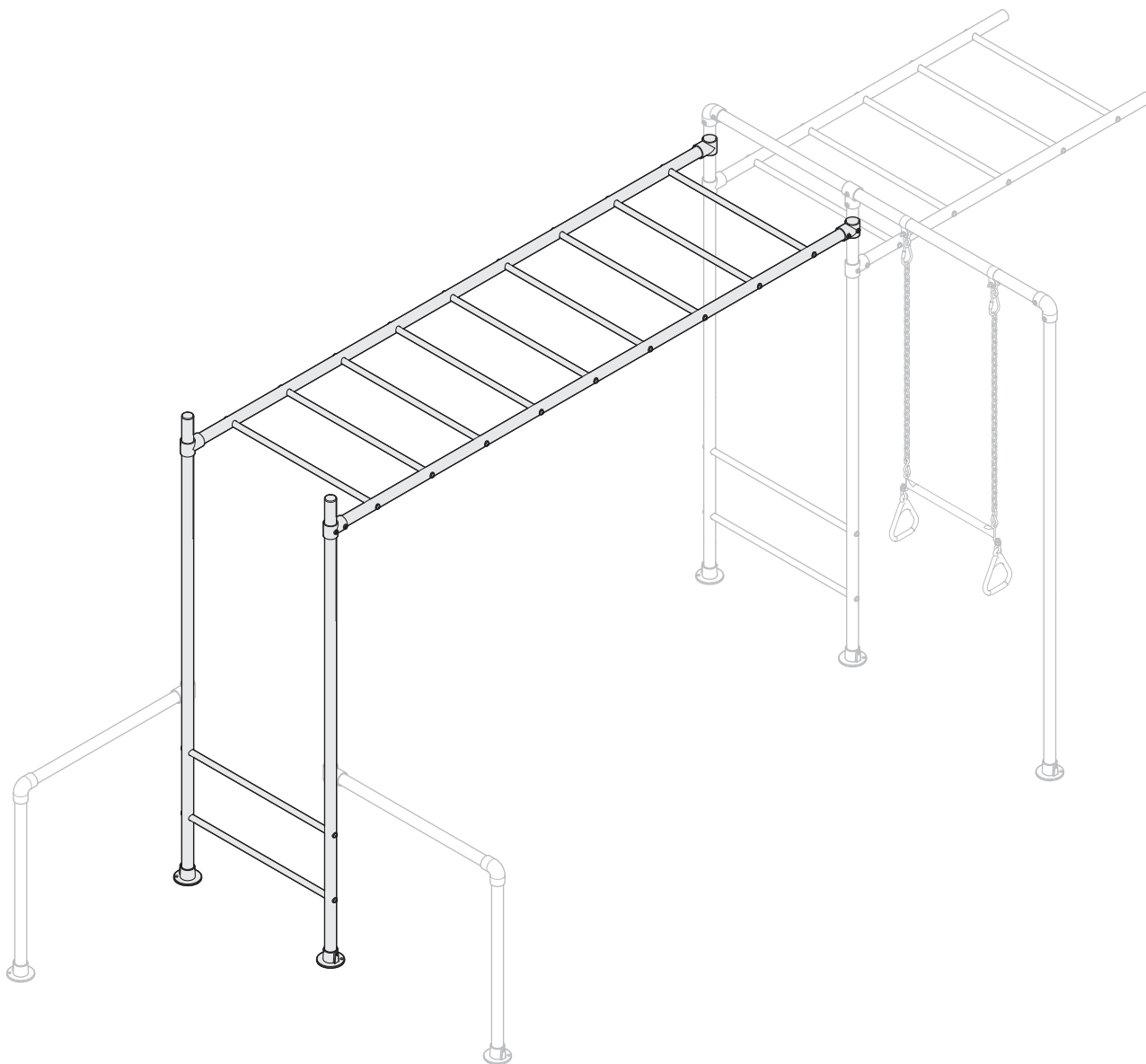

MONKEY BAR ADD-ON ASSEMBLY INSTRUCTIONS

CONTENTS

Warnings	Page 1
Load Rating	Page 3
Dimensions	Page 4
Assembly Tips	Page 5
Inventory	Page 7
Assembly Instructions	Page 8
Pre-installation Frame Preparation	Page 8
Ladder Bar Assembly	Page 11
Leg Assembly	Page 13
Monkey Bar Assembly	Page 16
Load Twirly Whirly Bars	Page 19
Maintenance	Page 21

WARNING

PLEASE CAREFULLY READ ALL INFORMATION CONTAINED IN THIS ASSEMBLY MANUAL BEFORE YOU INSTALL AND USE YOUR FUNKY MONKEY BARS®.

SAFETY NOTICE

1. Any person handling or using the Funky Monkey Bars® products must follow the instructions as described in this document. The person in charge of assembling and using the equipment must ensure that the recommendations for use given in this document are seen by all users.
2. Only use the Funky Monkey Bars® after they have been fully assembled and after checking that the fittings are tightened properly (*refer to page 5 - Correct Tightening Method*).
3. DO NOT install your Funky Monkey Bars® over concrete, asphalt, packed earth, wood decking or any other hard surface. A fall onto a hard surface can result in serious injury or death.
4. Inspect all grub screws, bolts and nuts at the beginning of each play session to ensure your Funky Monkey Bars® are tight and secure.
5. Ensure all tubes are fully inserted into fittings until you hear the magic "CLUNK" sound.
6. Ensure your Funky Monkey Bars® are properly secure at ALL times. Pegs are in place and inserted fully into the ground.
7. DO NOT exceed the maximum load/weight limit as recommended by Funky Monkey Bars®.
8. Children should be supervised by an adult at all times.
9. Installing a gym/crash mat under the fall zone area of your Funky Monkey Bars® would be recommended for children learning this new skill. This will reduce the chance of injury and build the child's confidence while they build strength and master the skill.
10. Ensure you have thoroughly read your assembly and installation instructions and viewed our on-line installation videos at <https://www.funkymonkeybars.com/blogs/installation-maintenance-videos>
11. DO NOT climb, sit or stand on top of the monkey bar (horizontal ladder) section.
12. DO NOT jump from the top of any section of the monkey bar.
13. DO NOT use your Funky Monkey Bars® when wet as the steel will be slippery.
14. DO NOT attach items to your frame that are not designed specifically to be used with Funky Monkey Bars®, especially lower quality products that have not been approved by Funky Monkey Bars®.
15. Ensure the height of your Funky Monkey Bars® (horizontal ladder) are set at a level that is age appropriate.
16. DO NOT install your Funky Monkey Bars® over or near objects that could interfere with users in an unsafe way. Maintain a clear area around your Funky Monkey Bars®.
17. DO NOT use your Funky Monkey Bars® while under the influence of drugs and alcohol.
18. Wear clothing free of drawstrings, hooks, loops or anything that could get caught while using your Funky Monkey Bars® and result in entanglement and/or strangulation.

ASSEMBLY

1. Keep small children away from the Funky Monkey Bars® during assembly.
2. Do not attempt to use the Funky Monkey Bars® until it is completely assembled and every fitting is tight and secured.
3. Installation typically takes 2-3 hours to complete. Two people are recommended for assembly.
4. Ensure all fittings are tightened to the correct tightening method as described on page 4.
5. Assembly should be carried out on clean, dry, level surface

Please refer to the video section on the Funky Monkey Bars® website for more handy tips and assembly instructions at <http://www.funkymonkeybars.com/pages/videos>

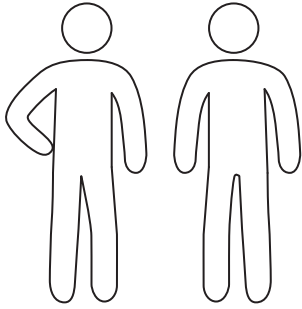

Assembly requires 2 adults.

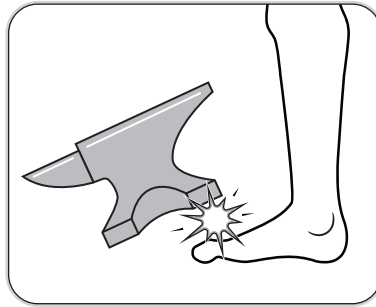

Heavy items !

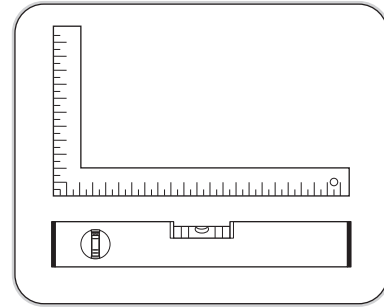

Work on flat level surface.

LOCATION

1. A safe fall zone around your Funky Monkey Bars® is essential. A minimum distance of 1.5m to 2m (5 ft to 6.5ft) is recommended around the elevated hanging points of your Funky Monkey Bars®.
2. Place your Funky Monkey Bars® on level ground, away from any structure or obstruction such as a fence, garage, house, overhanging branches, laundry lines or electrical wires and remove any obstructions beneath your Funky Monkey Bars®.
3. Ensure your Funky Monkey Bars® are positioned away from retaining walls, pool fences, structures and other play equipment. Maintain a clear space around the whole perimeter of your Funky Monkey Bars®.
4. Place your Funky Monkey Bars® on the most level surface available.

MAINTENANCE

1. At the beginning of each heavy play session we recommend the following maintenance processes be performed on your Funky Monkey Bars®:
 - Tighten all bolts, grub screws and applicable hardware (as per page 3)
 - Lubricate all metallic moving parts as per instructions (flying fox, swing hooks etc)
 - Check all protective coverings on bolts, pipes, edges and corners. Replace if they are loose, cracked or missing.
 - Check all moving parts including swing seats, shackles, snap hooks, chains and trolleys for wear, rust, or other deterioration. Replace as needed.
2. Twice a month during play season we would recommend the following maintenance processes be performed on your Funky Monkey Bars®:
 - Tighten all connections and hardware
 - Check all protective coverings on bolts, pipes, edges and corners. Replace if they are loose, cracked or missing.
3. Once a month during play season we would recommend the following maintenance processes be performed on your Funky Monkey Bars®:
 - Lubricate all metallic moving parts as per instructions (flying fox, swing hooks etc). If swings start to squeek then lubricate swing hooks.
 - Check all moving parts including swing seats, ropes, chains and trolleys for wear, rust, or other deterioration. Replace as needed.
 - Owners shall be responsible for maintaining the legibility of any warning labels.

For additional information concerning your Funky Monkey Bars®, please contact our customer service team or check our website for any important updates. Phone: 1300 912 198 or www.funkymonkeybars.com



QUALITY & INDEPENDENT TESTING

At Funky Monkey Bars® we take the quality of our designs and safety very seriously. All Funky Monkey Bars® frames go through a stringent, independent structural testing process prior to being made available for release to our customers.

Our frames are designed within the parameters of the Australian Standard for Playground Equipment AS4685.1:2014.

The structural integrity of our frames has been tested for performance through a combination of engineering calculations and physical testing. The tests have been performed by independent, certified structural engineers in accordance with Australian Standard for Playground Equipment AS4685.1:2014 and European Standards EN1176-1:2008.

The independent testing conducted on The Monkey bar add-on (Original) certified the frame to a load rating of 486kgs or 7 users.

LOAD TESTING CERTIFICATION				
DATE OF TEST	MODEL	NUMBER OF USERS	USER LOAD (KG)	LOAD RATING (KG)
October 2015	Monkey Bar	7	69.5	486
I hereby confirm all testing was undertaken in accordance with Physical Testing of Structural Integrity requirements of AS 4685.1: 2014 App C / EN 1176-1:2008 ^o except where noted below;				
COMMENTS: N/A				
APPROVED BY: Funky Monkey Bars® 			WITNESSED BY: Independent Engineer 	
DATE : October 2015			DATE : October 2015	

DIMENSIONS

FUNKY MONKEY BARS® EXTRA MONKEY BAR ADD-ON DIMENSIONS

A minimum of 2.0 Metres clear fall zone is recommended around the elevated hanging points of your Funky Monkey Bars®.

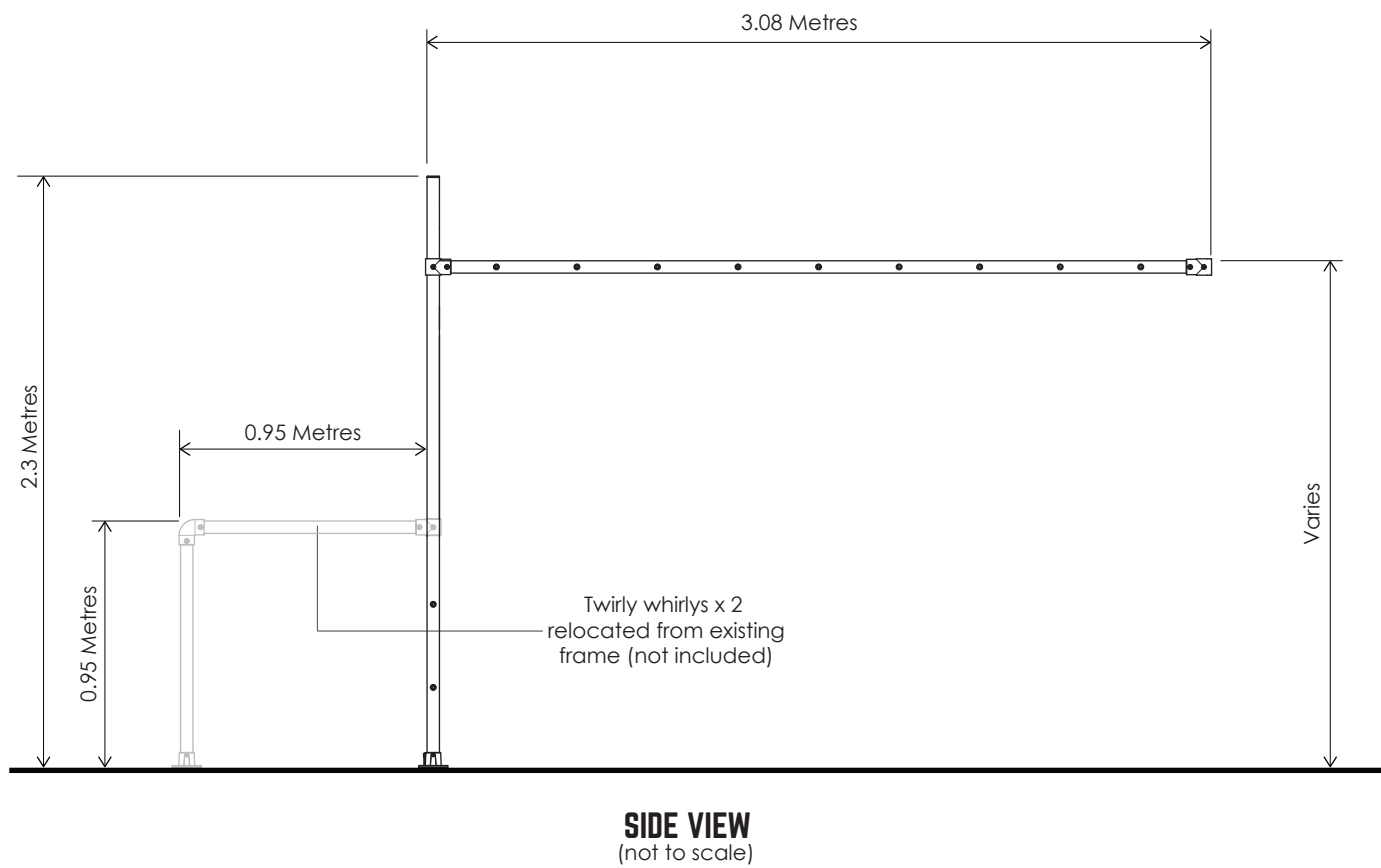
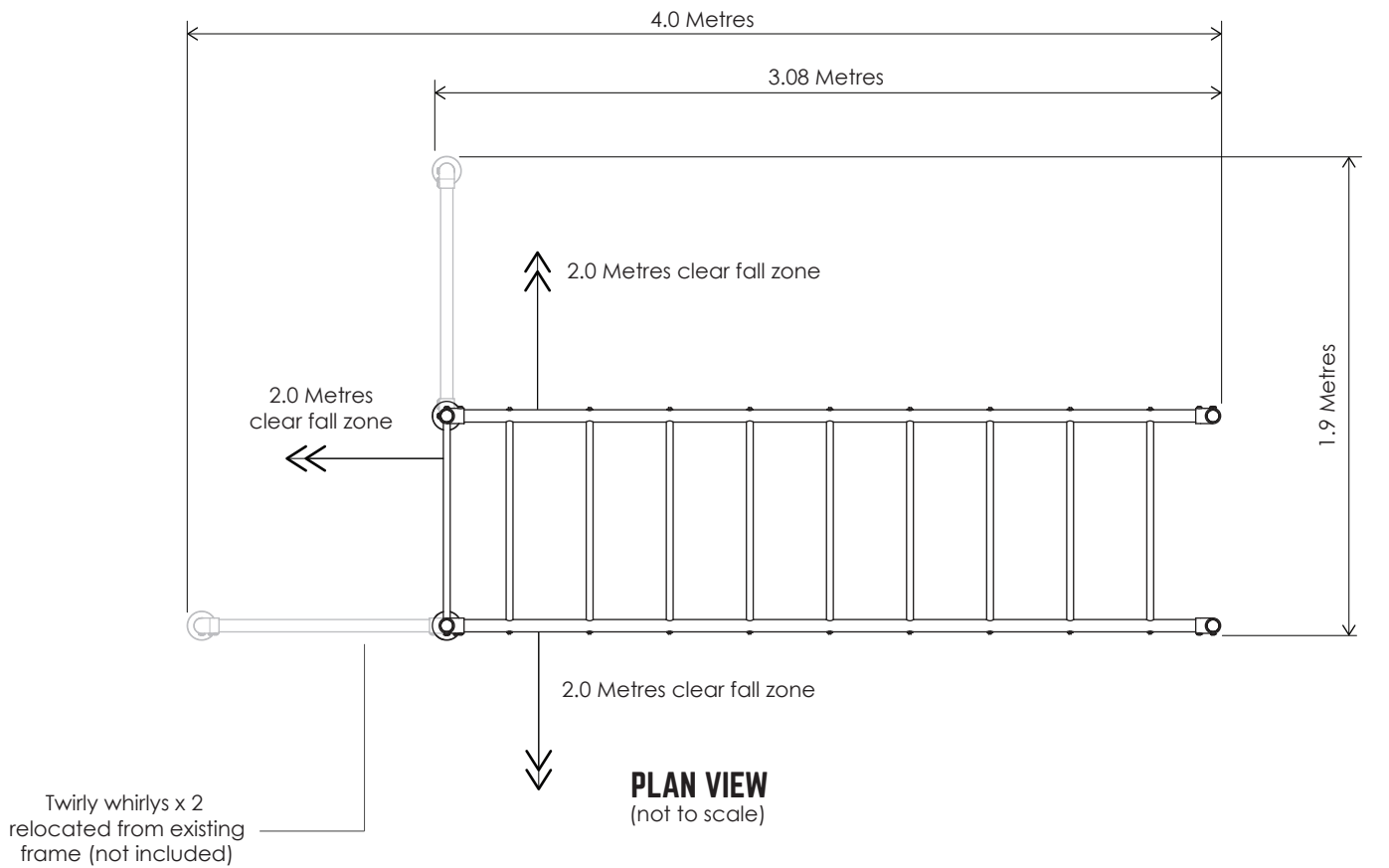

ASSEMBLY TIPS

CORRECT INSERTION INTO FITTINGS - (INDICATIVE DIAGRAM SHOWN)

All tubes must be fully inserted until contact is made with adjoining tube.

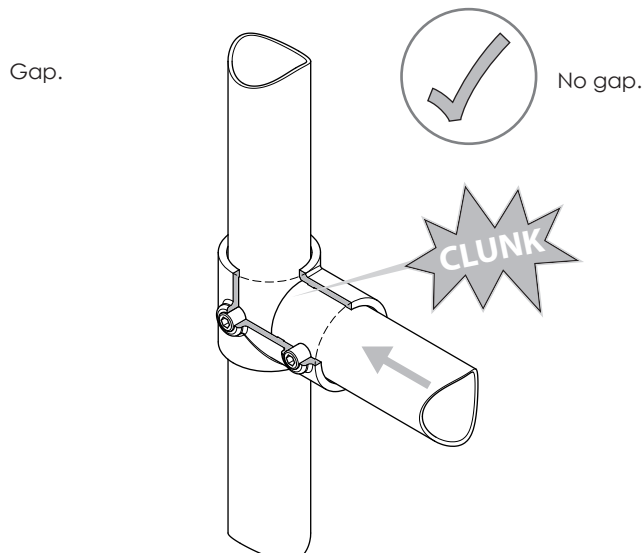
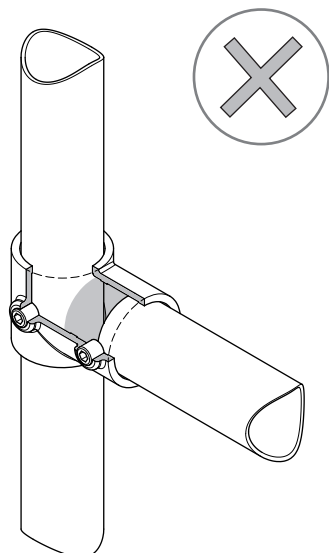

CORRECT TIGHTENING METHOD OF GRUB SCREWS - (INDICATIVE DIAGRAM SHOWN)

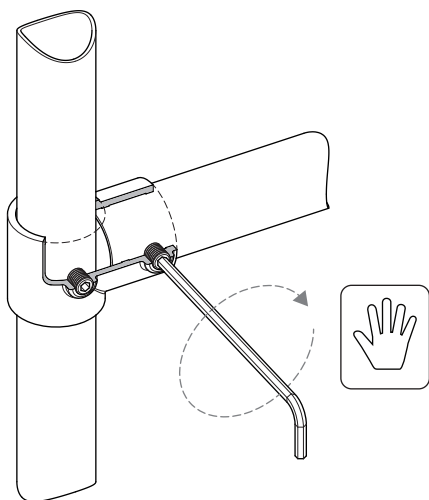

1. With long end of allen key, hand tighten grub screw as much as possible.

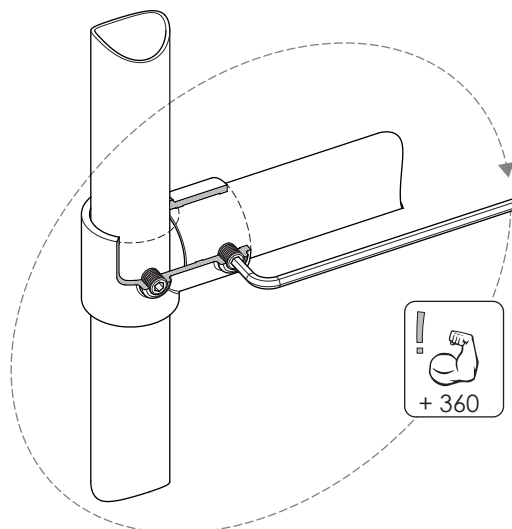

2. Using other end of the allen key do one full 360 degree turn as a minimum, use muscles!



CORRECT TIGHTENING METHOD OF RUNG BOLTS - (INDICATIVE DIAGRAM SHOWN)

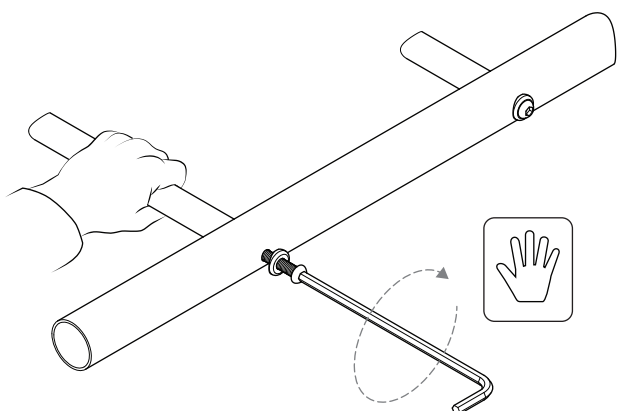

1. With long end of allen key, hand tighten bolt hard up against washer and outside of tube. Hold rung to avoid rotation.

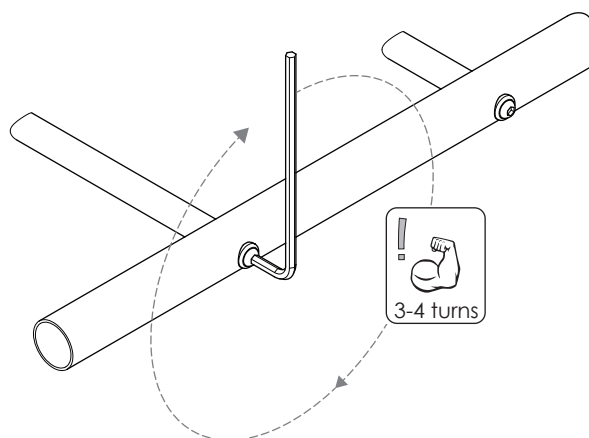

2. Using short end of the allen key fully tighten, approximately 3-4 full turns .



ASSEMBLY TIPS (CONTINUED)

IT IS CRITICAL YOUR MAIN FRAME IS 100% SQUARE AND LEVEL (INDICATIVE DIAGRAM SHOWN)

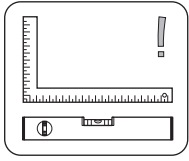

Check assembly is 100% level, square & straight.

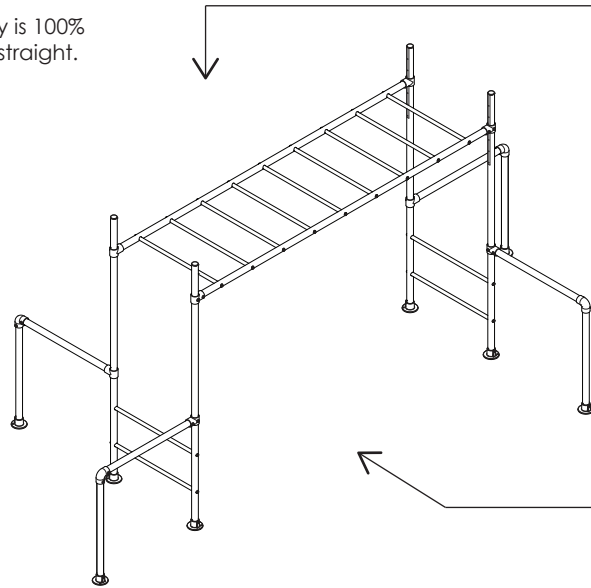

PLAN VIEW

SIDE VIEW

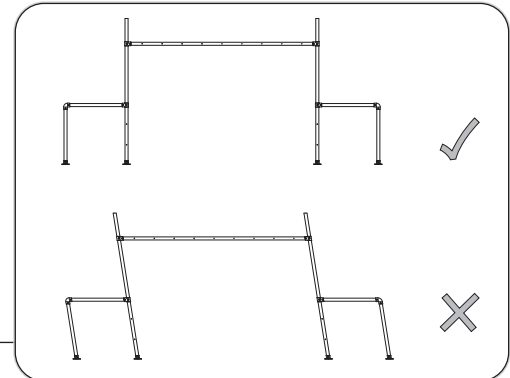
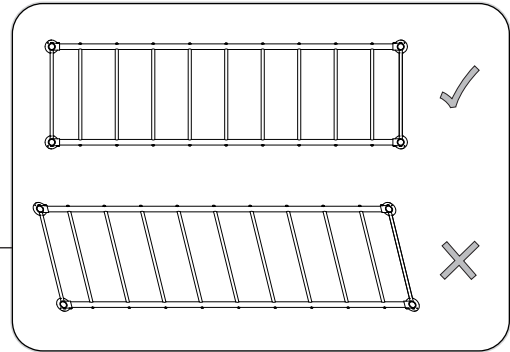

If your frame is not straight or level remove pegs, loosen grub screws, re-adjust re-tighten and re-peg the frame.

INSTALLATION ON A SLOPE

If your frame is being installed on a slope ensure the monkey ladder bar is level. Either install at different heights on the legs or dig down at one end until level.

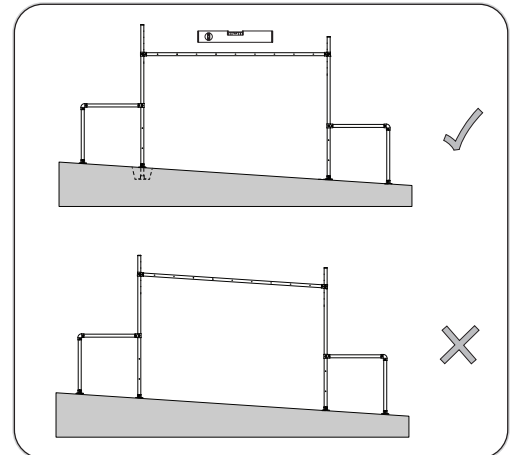

FIXING TYPICAL ORIENTATION - (INDICATIVE DRAWING SHOWN)

Unless otherwise stated all grub screws and fittings should face downwards and outwards. This will reduce weathering damage, help with assembly and ease of maintenance.

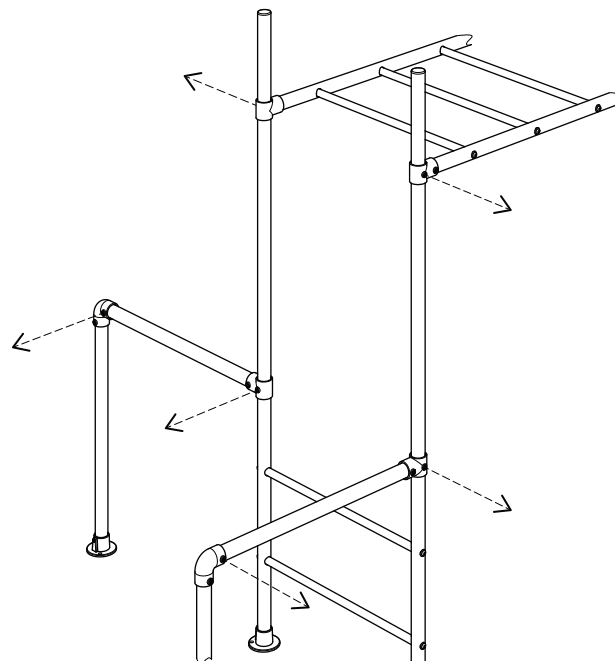

INVENTORY

TOOLS REQUIRED FOR INSTALLATION

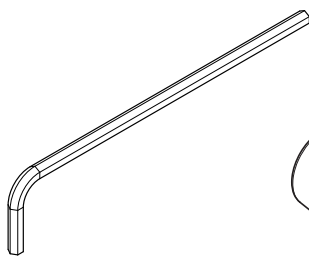

1x
8mm Allen key
(Included)

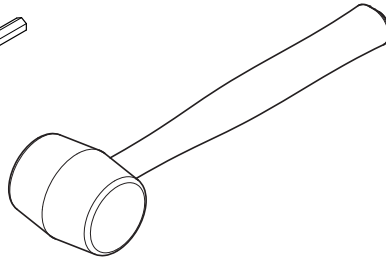

1x
Soft Hammer
(Not included)

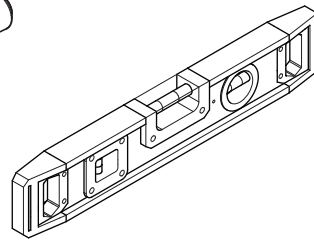

1x
Spirit Level
(Not included)

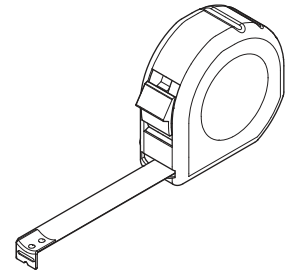

1x
Tape Measure
(Not included)

TUBES

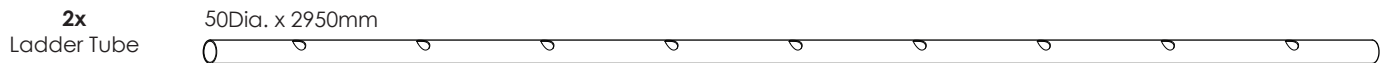
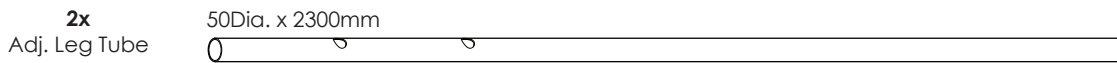
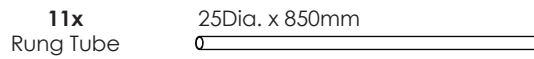

FITTINGS

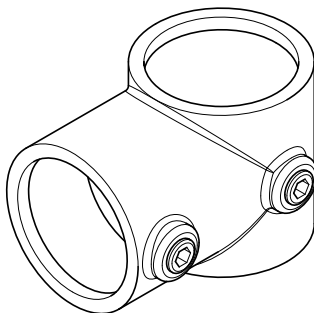

4x
Short Tee
D-101

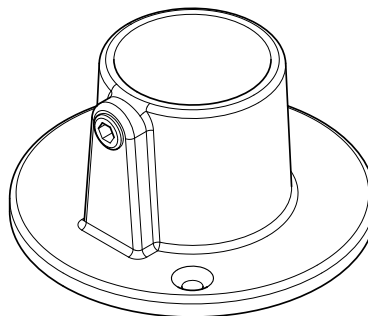

2x
Base Plate
D-131



2x
Peg

HARDWARE

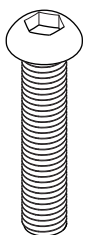

23x
M10 Bolt

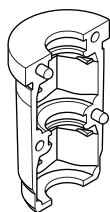

46x
Rung Insert



23x
Washer



46x
M10 Hex Nut

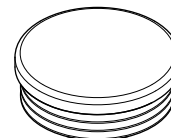

2x
Plastic End Cap

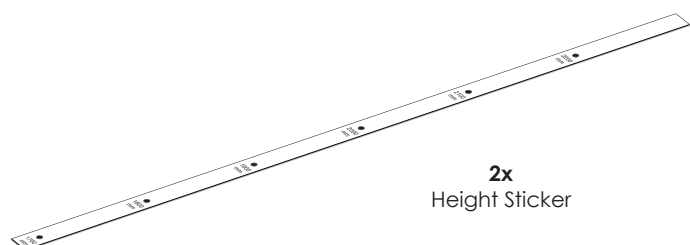

2x
Height Sticker

ASSEMBLY INSTRUCTIONS - PRE-INSTALLATION FRAME PREPARATION

1 SELECT THE LOCATION FOR THE ADD-ON MONKEY BAR - (ORANGUTAN MODEL SHOWN)

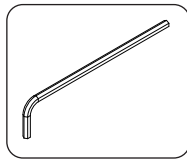
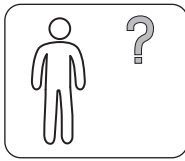

1. Depending on your Funky Monkey Bars® model and configuration select an existing monkey bar end for the add-on monkey bar to be installed.

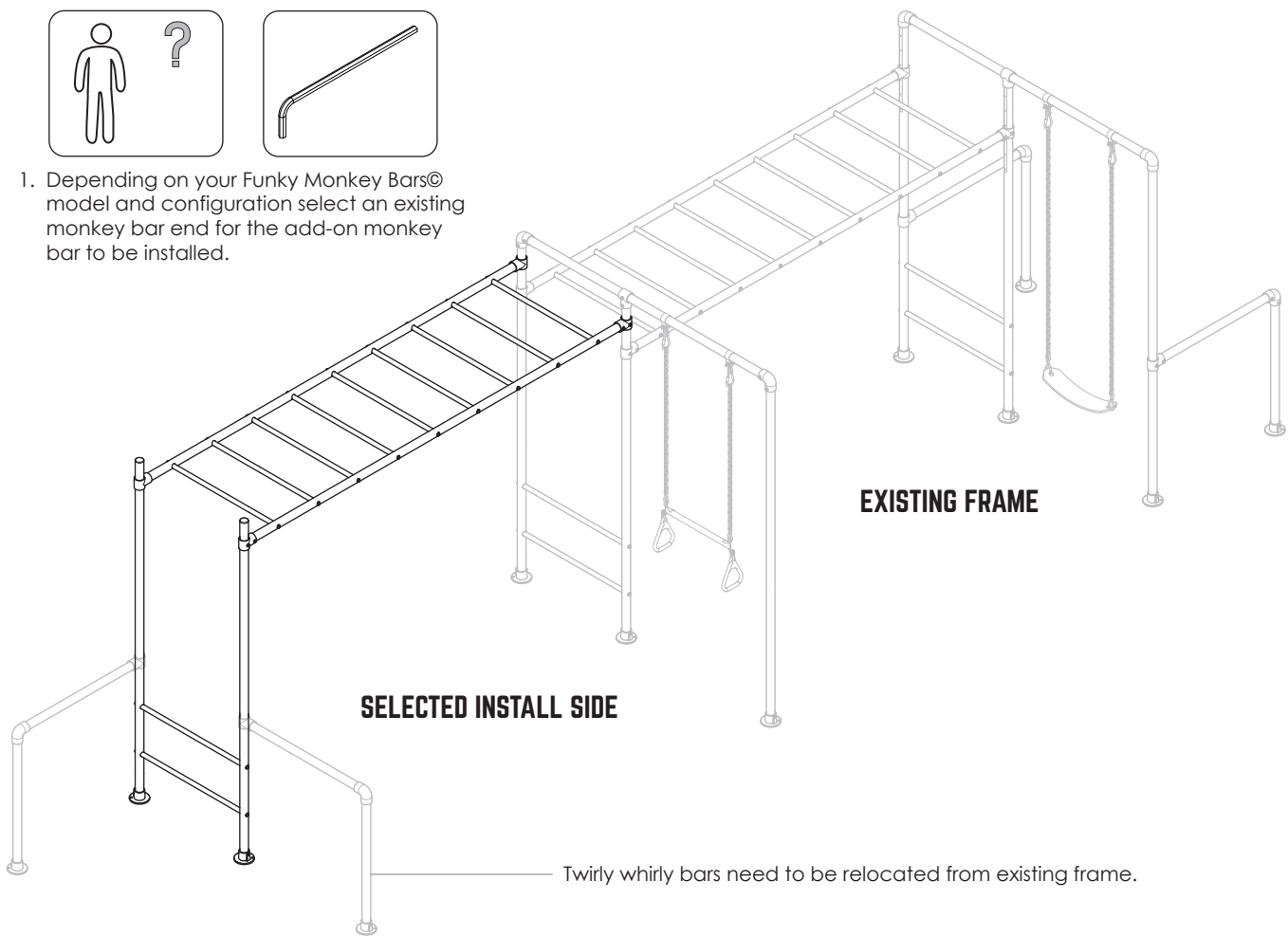

2 REMOVE TWIRLY WHIRLY PEGS & ACCESSORIES FROM EXISTING FRAME - SELECTED INSTALL END ONLY

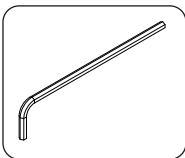

1. Remove base plate pegs from twirly whirly bars on selected end.
2. Remove any accessories from the existing swing bar on selected end.

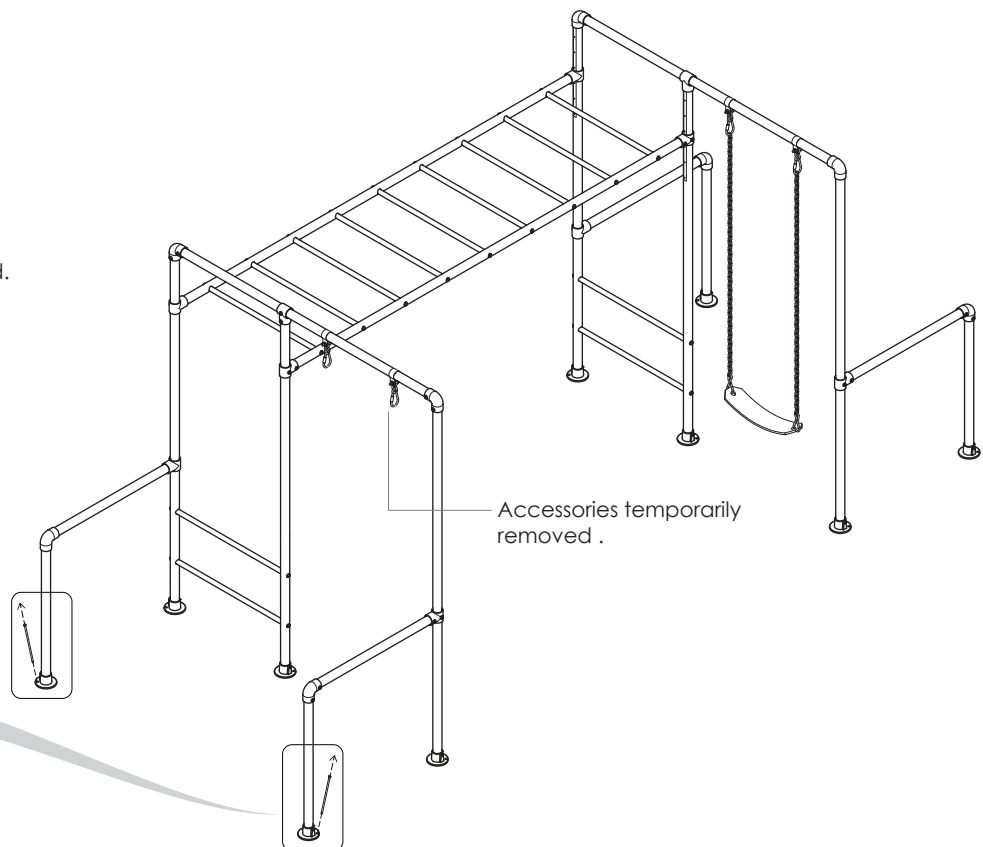
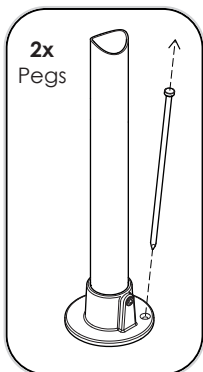

3 REMOVE TWIRLY WHIRLY BARS & SWING BAR

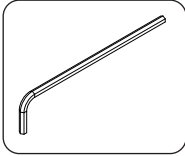

1. Loosen all grub screws on short tees A & B, and lower grub screws on C, D & E.
2. Remove twirly whirly bars and swing bar from selected install end, place to one side to re install later.

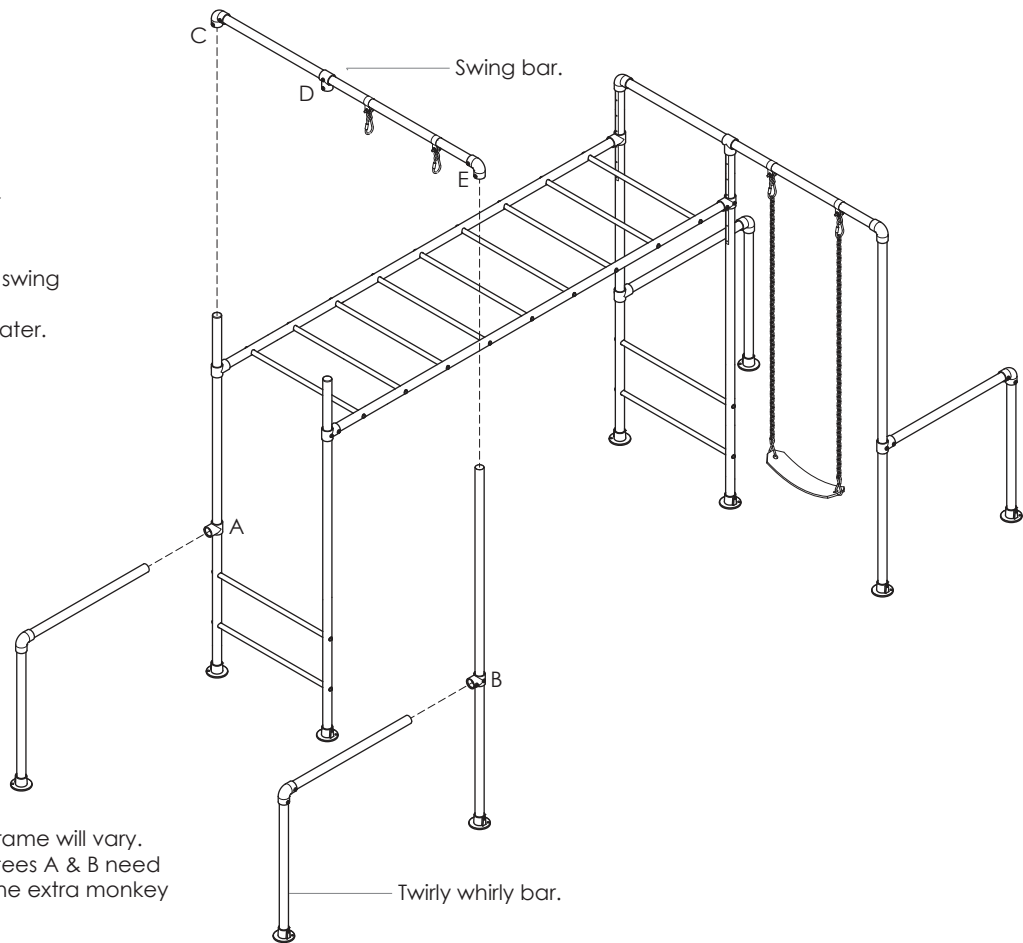

NOTE: Every Funky Monkey Bars® frame will vary. At this stage the twirly whirly small tees A & B need to be removed for installation on the extra monkey bar add-on.

4 REMOVE TWIRLY WHIRLY SHORT TEES FROM LEGS x2

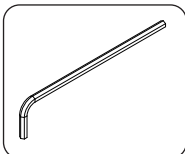

1. Loosen all grub screws on short tees A, B & F.
2. Pull leg tube away from ladder tube and remove short tee F.
3. Replace in position with twirly whirly short tee A.
4. Retighten grub screws connecting leg to ladder.
5. Remove short tee B from swing leg.

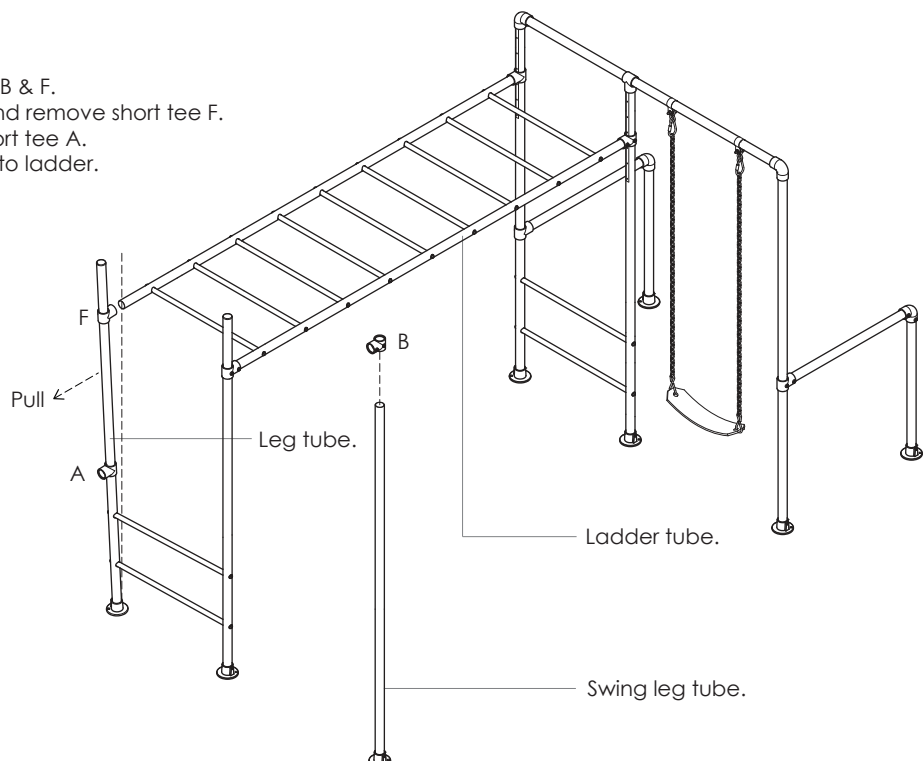
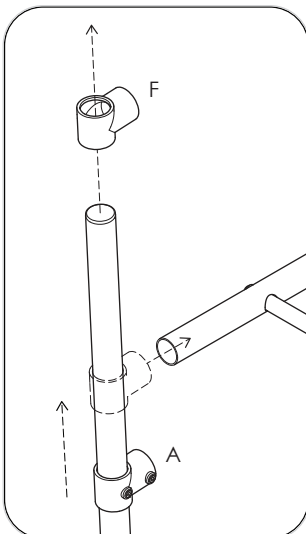

5 ATTACH SHORT TEES & RE-INSTALL SWING BAR

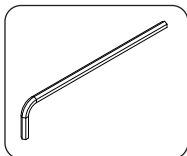

1. Attach leg tube back onto ladder tube at short tee A.
2. Slide 2 x short tees onto leg tube ends.
3. With 2 people reattach swing bar and swing leg.
4. Fully tighten all grub screws.

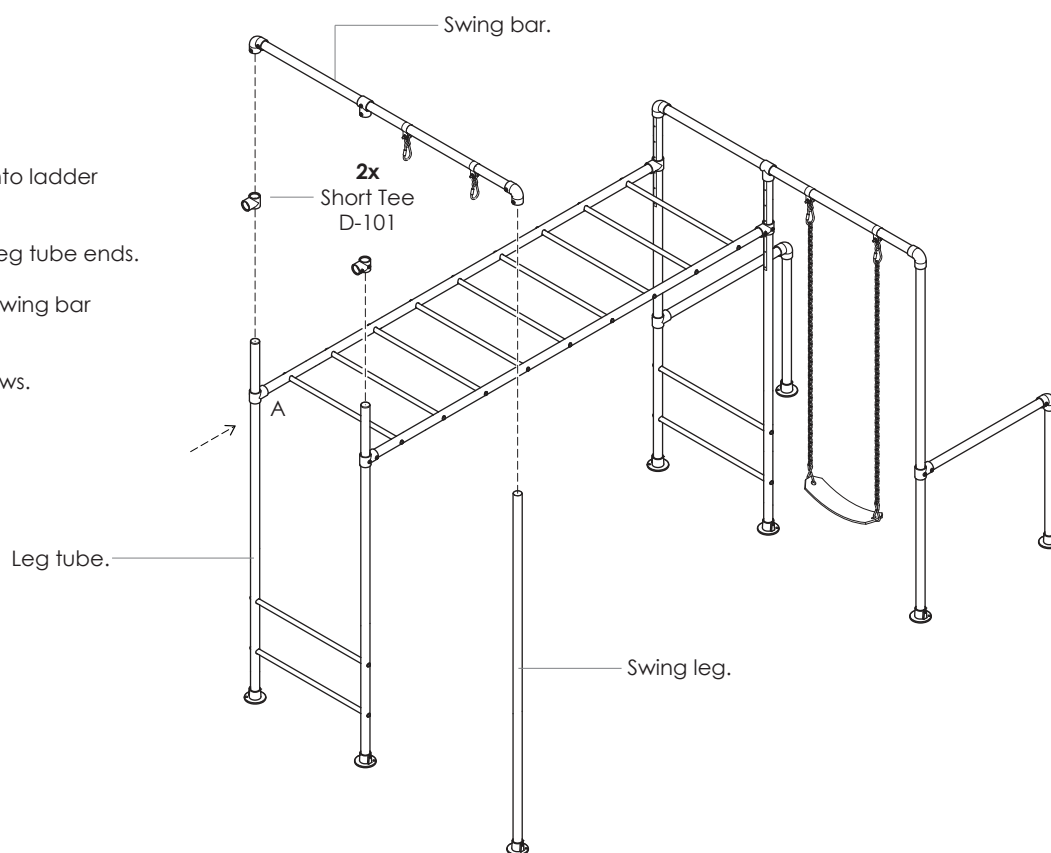

6 PRE-INSTALLATION CHECKS

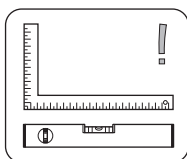
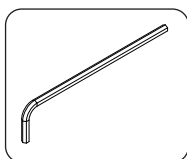

1. Adjust top short tees to desired height for extra monkey bar add-on.
2. Ensure the frame is level and square.
3. Fully tighten all grub screws.

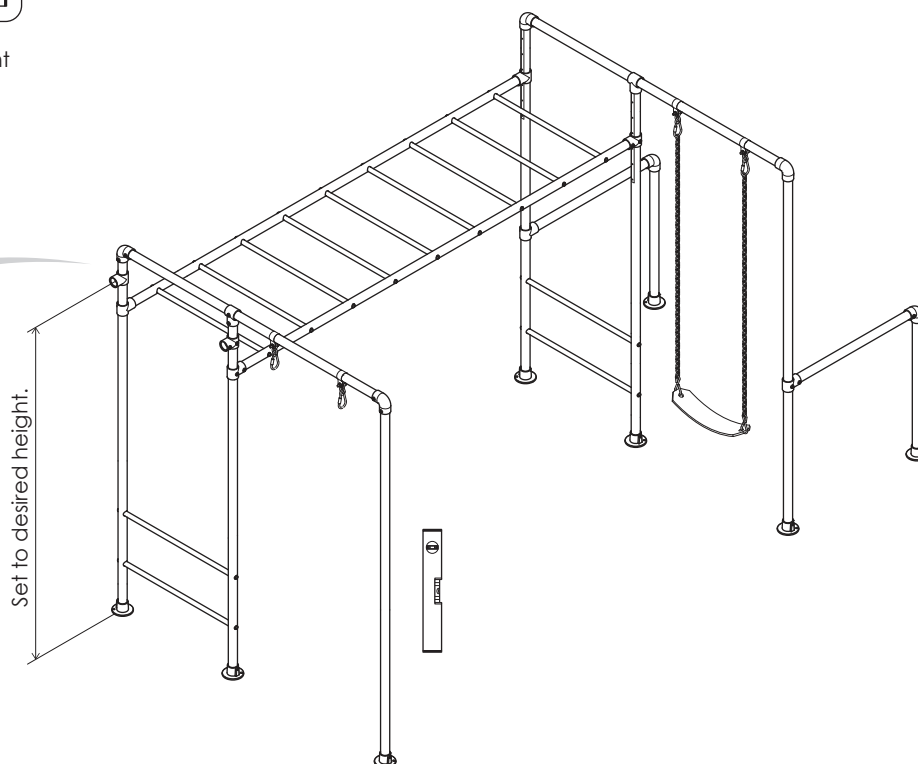
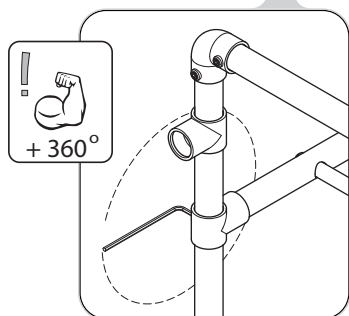

ASSEMBLY INSTRUCTIONS - LADDER BAR ASSEMBLY

7 RUNG ASSEMBLY (X11)

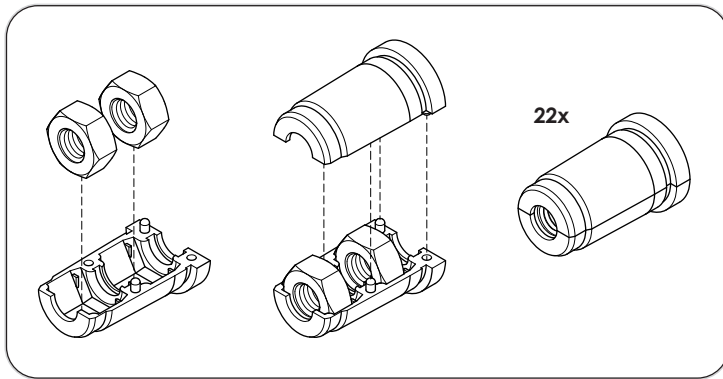

1. Assemble plastic rung inserts as shown above.

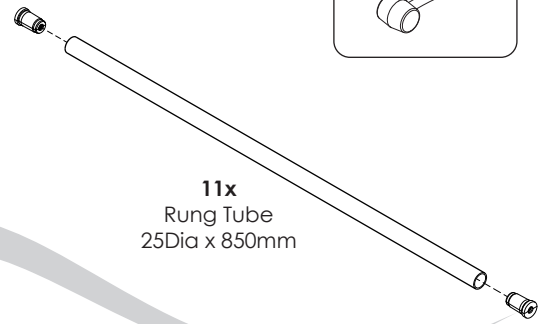

2. Push inserts into both ends of all rungs.

8 MONKEY BAR LADDER ASSEMBLY

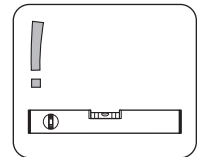
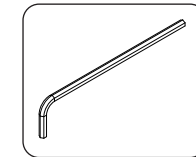
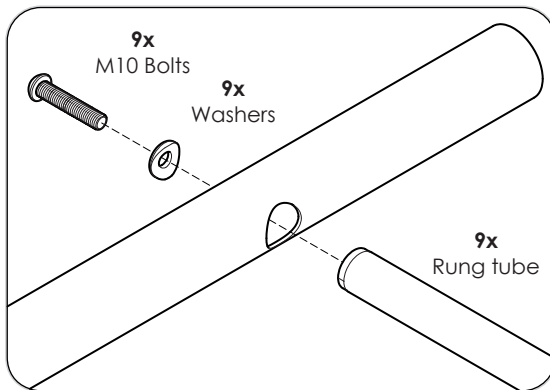

Hand tighten all bolts.

Assemble on flat surface.

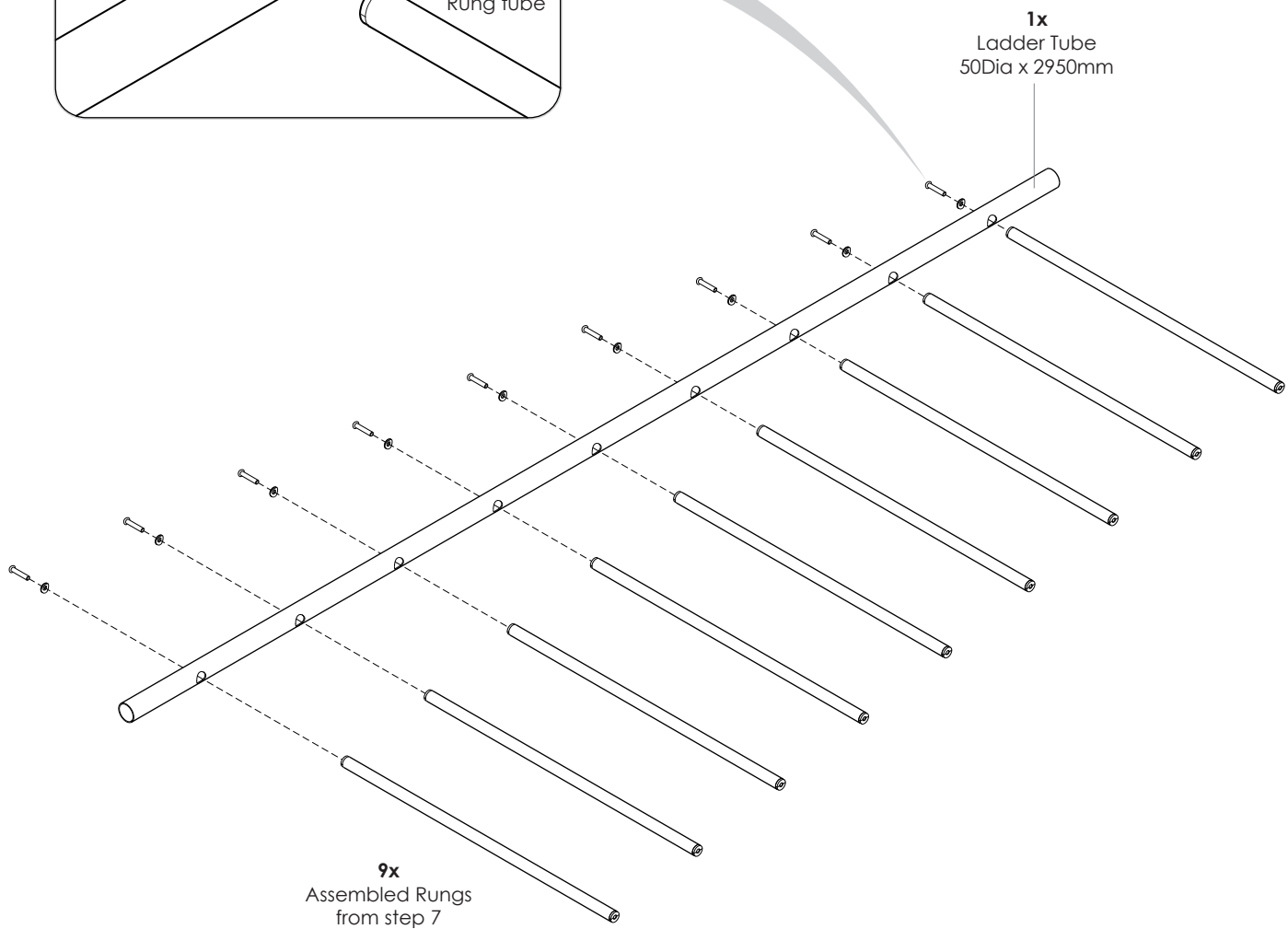

9 ATTACH SECOND LADDER TUBE

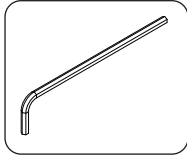

Hand tighten all bolts

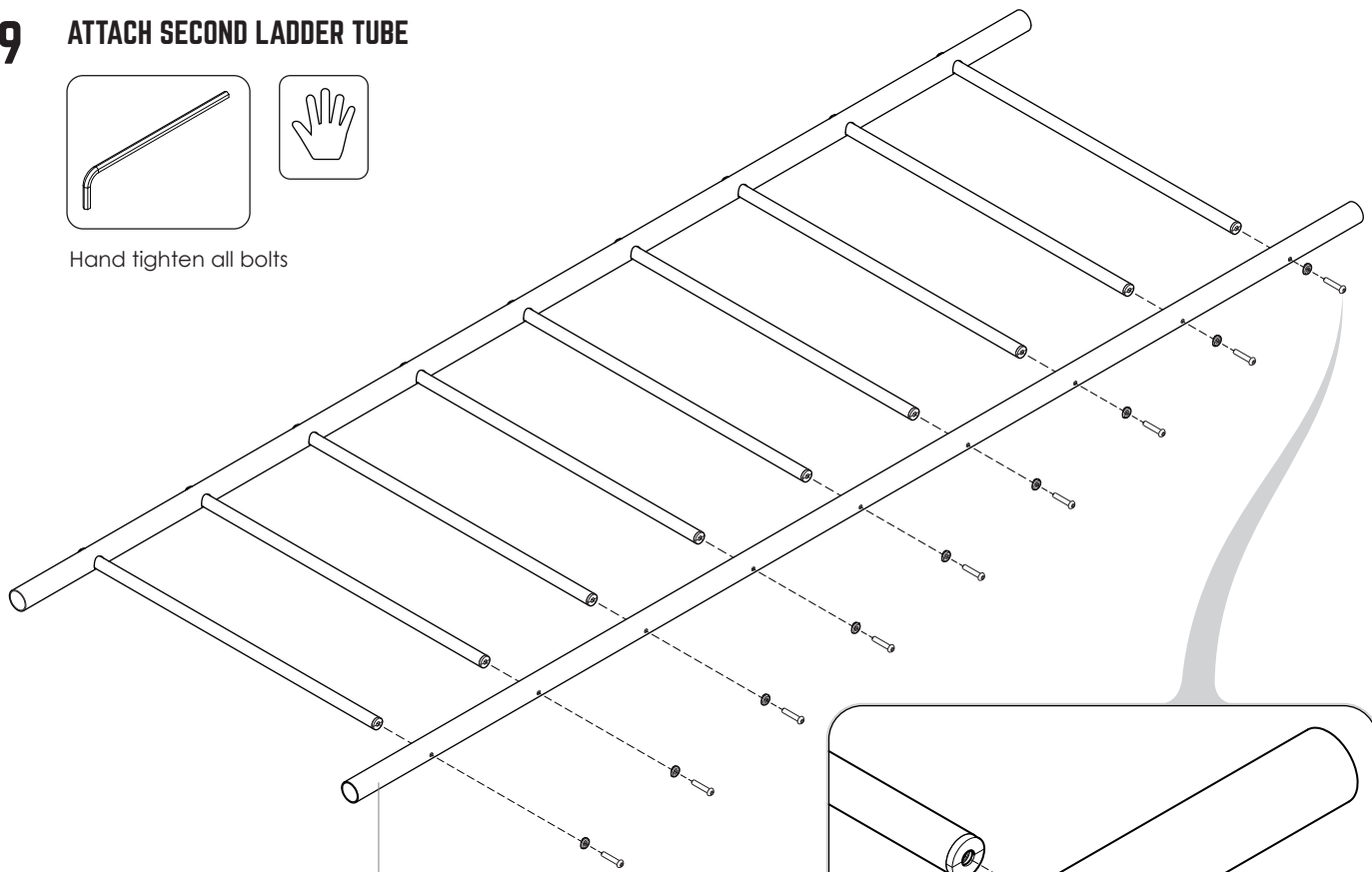

1x
Ladder Tube
50Dia x 2950mm

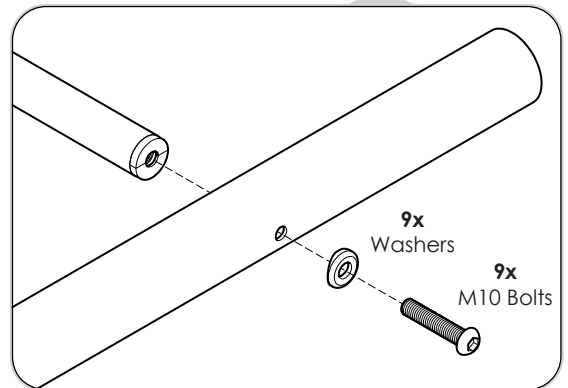

10 FIRMLY TIGHTEN ALL RUNG BOLTS.

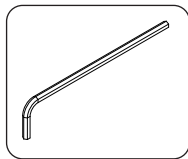

See page 5 for correct tightening method.

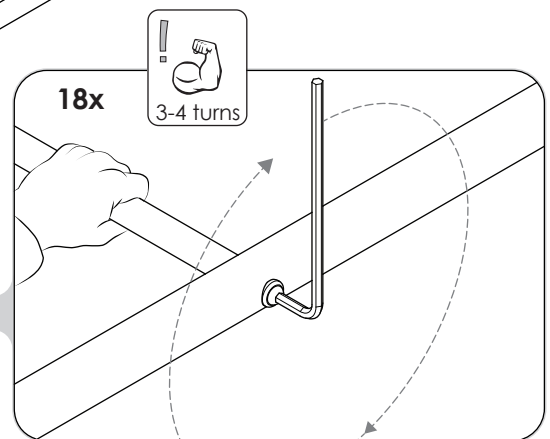
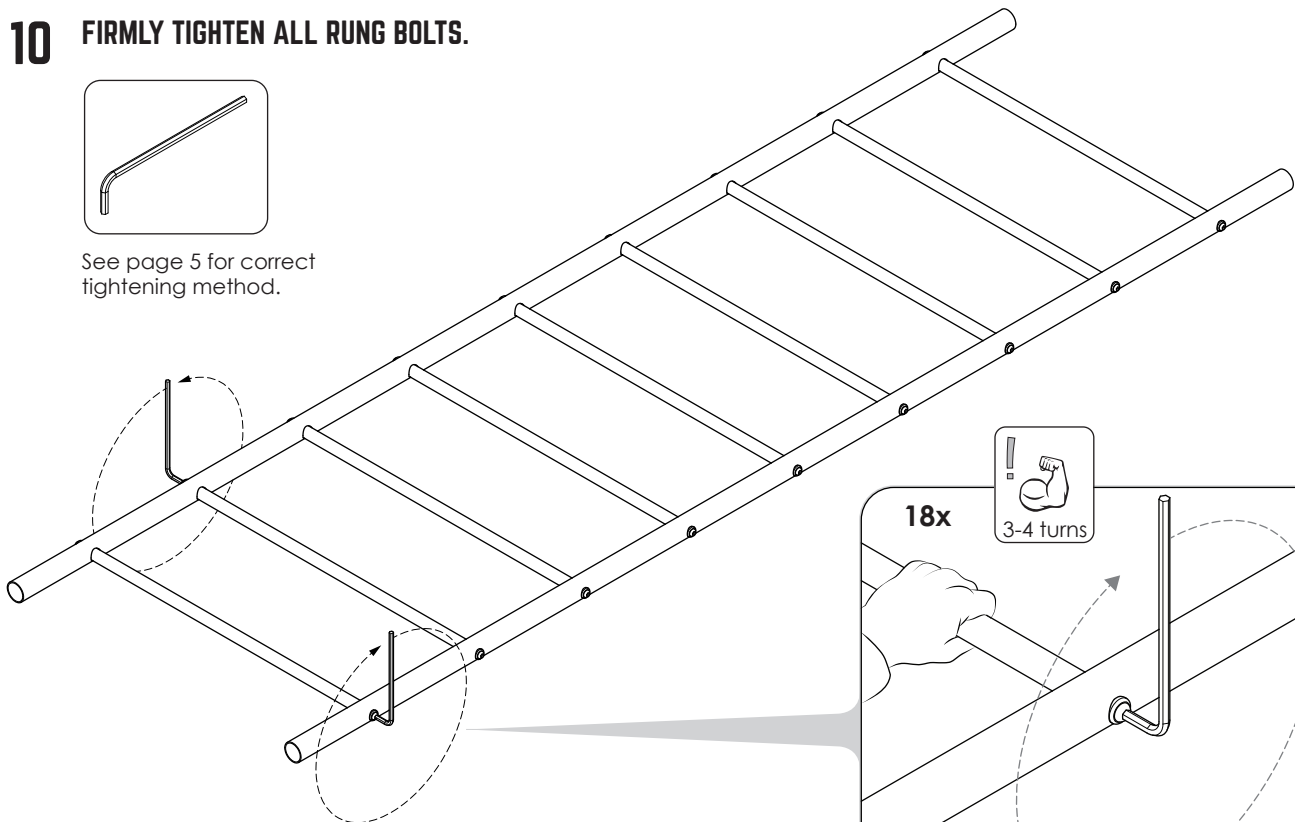

ASSEMBLY INSTRUCTIONS - LEG ASSEMBLY

11 LEG ASSEMBLY

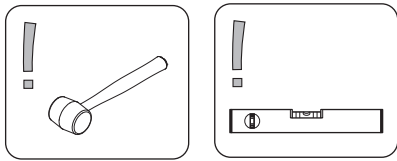

On a flat level surface insert plastic end caps into leg tubes.

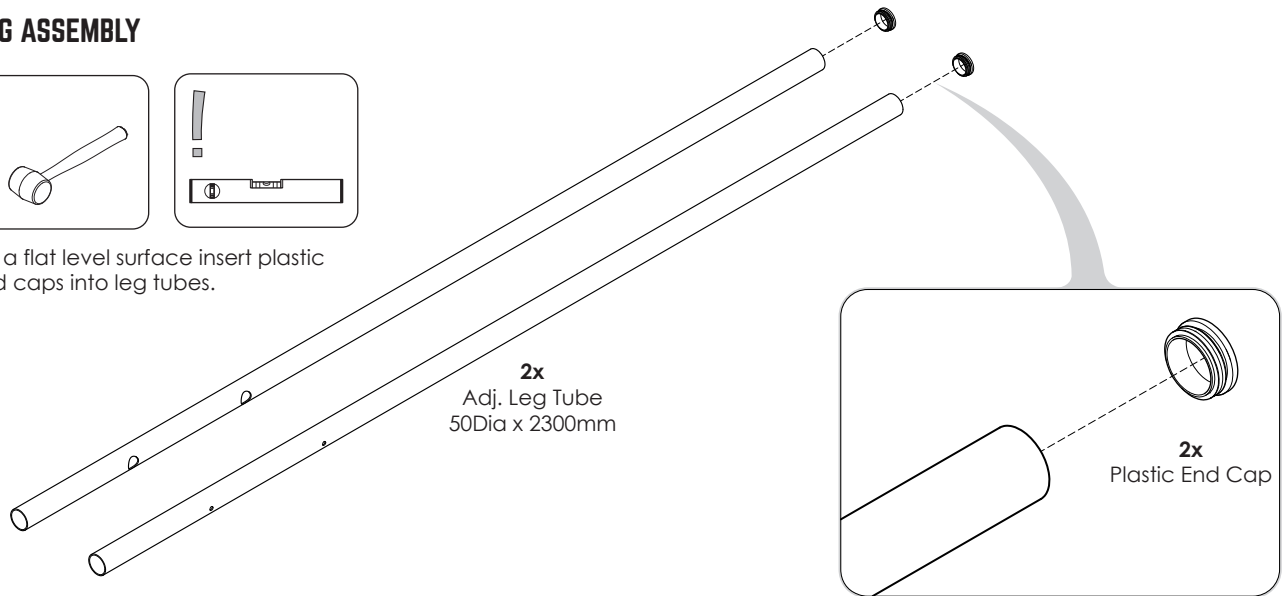

12 INSERT RUNGS

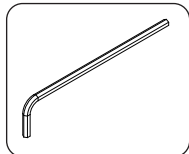

Tighten all bolts.

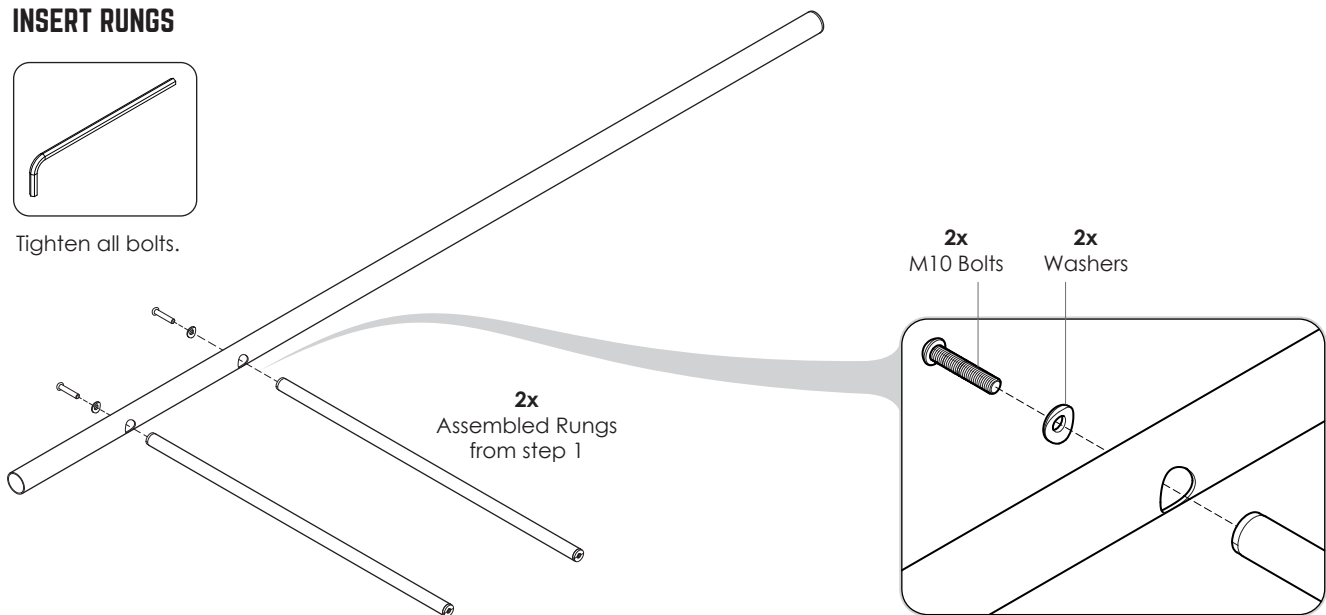

13 ATTACH SECOND LEG

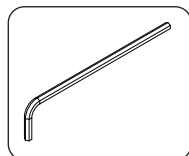

Tighten all bolts.

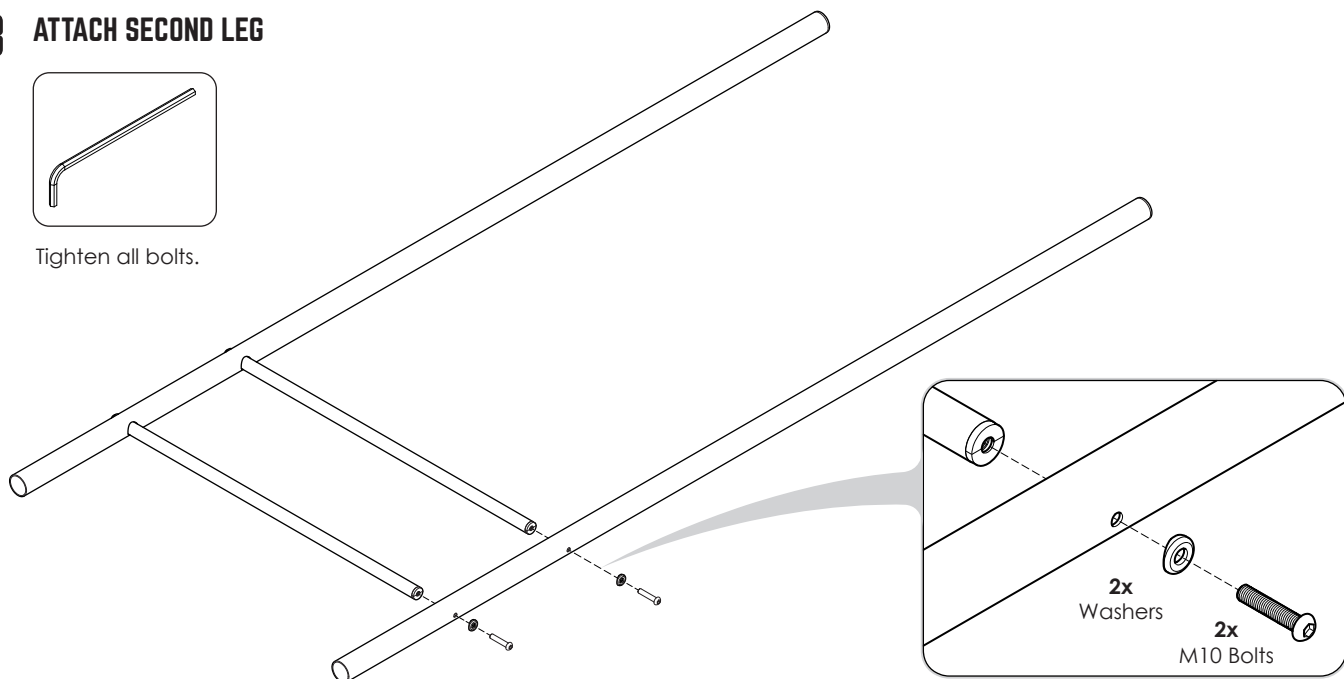

14 ATTACH BASE PLATES

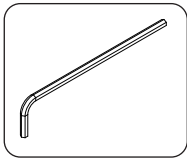

Tighten all grub screws.

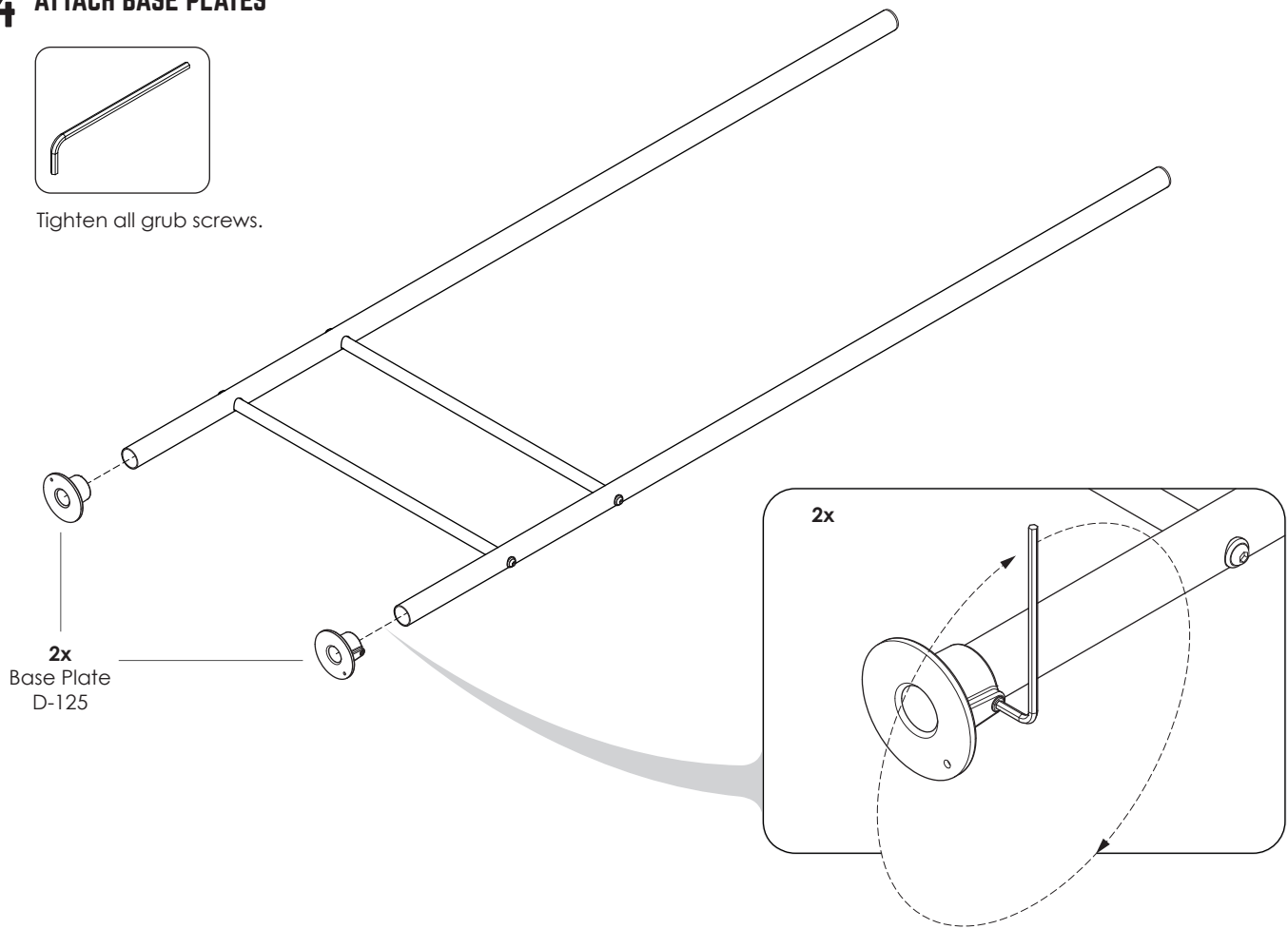

15 SLIDE ON SHORT TEES

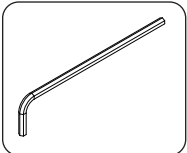

Hand tighten grub screws.
Temporary location.

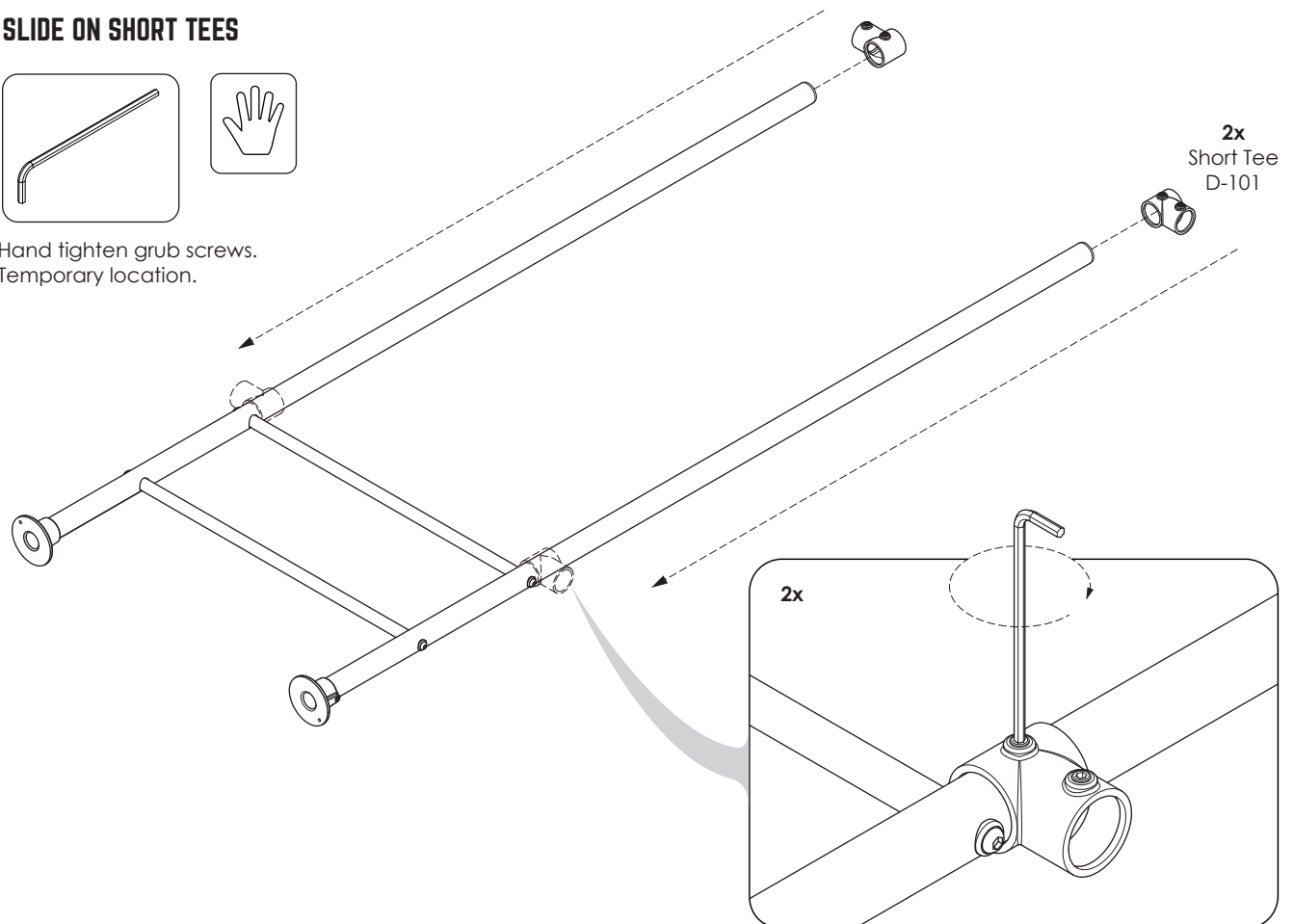

10 APPLY HEIGHT STICKERS.

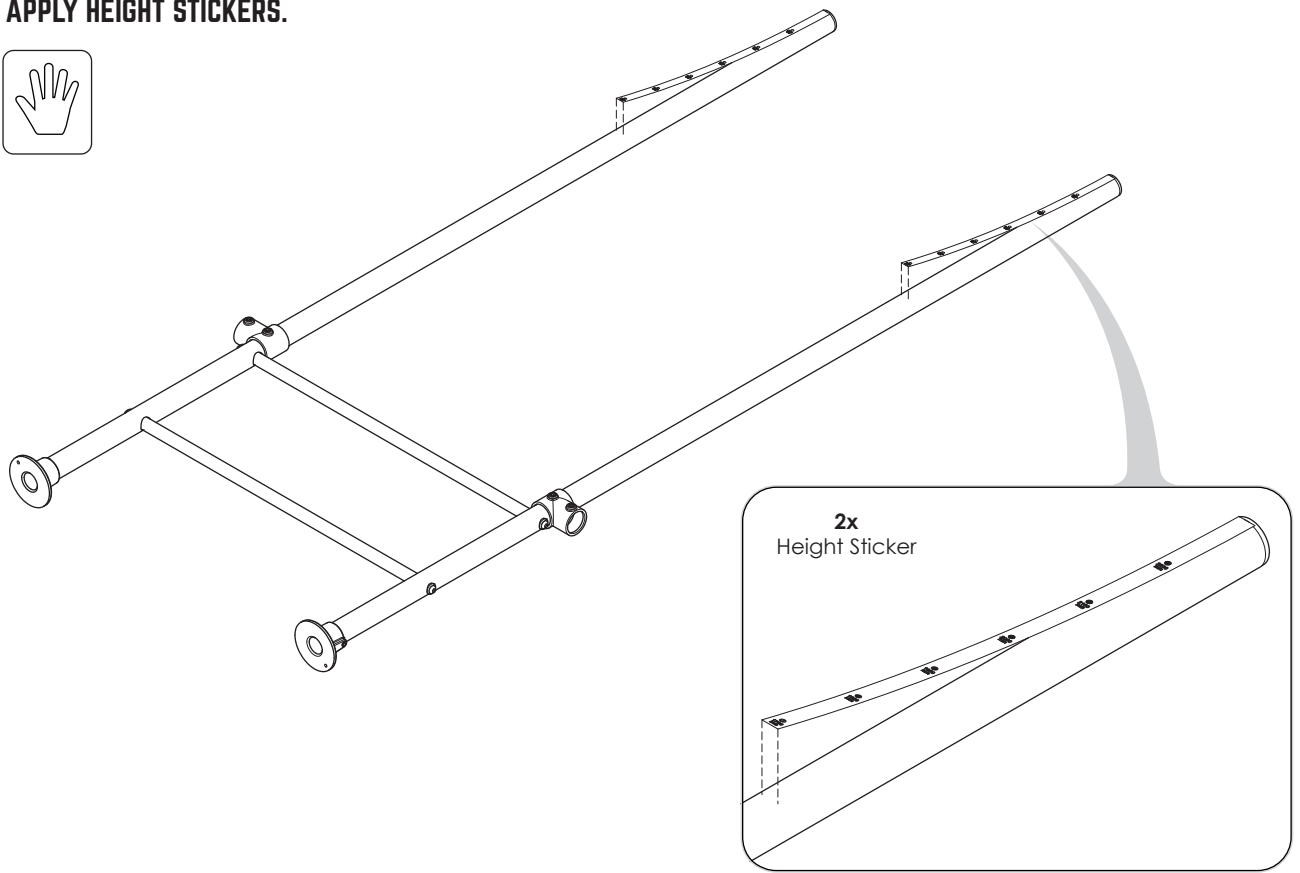

2x
Height Sticker

11 SET LADDER BAR HEIGHT.

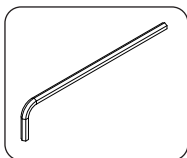

Set top 2x short tees at same height as top short tees set in step 6.

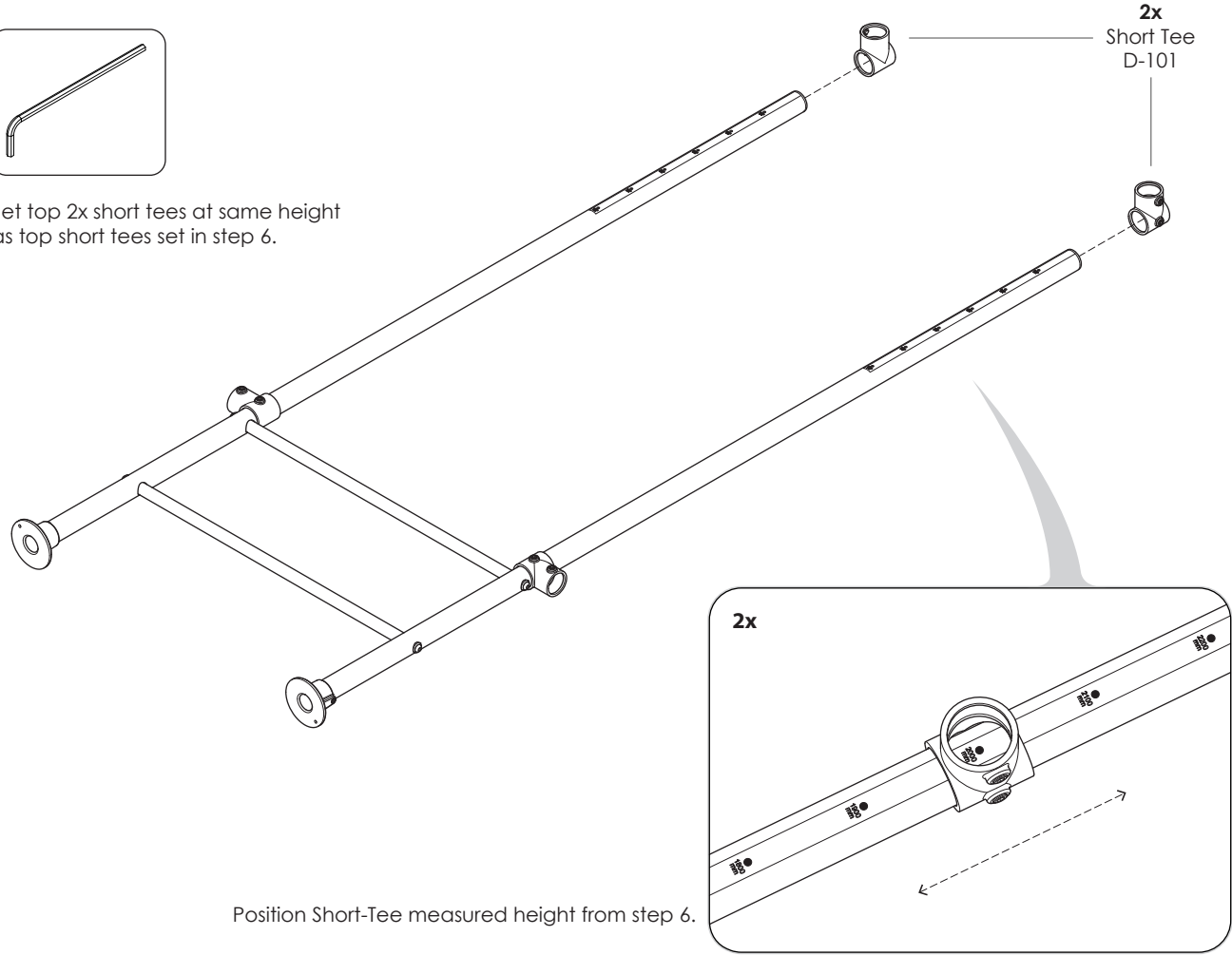

2x
Short Tee
D-101

2x

Position Short-Tee measured height from step 6.

ASSEMBLY INSTRUCTIONS - MONKEY BAR ASSEMBLY

12 FIRMLY TIGHTEN ALL RUNG BOLTS & GRUB SCREWS.

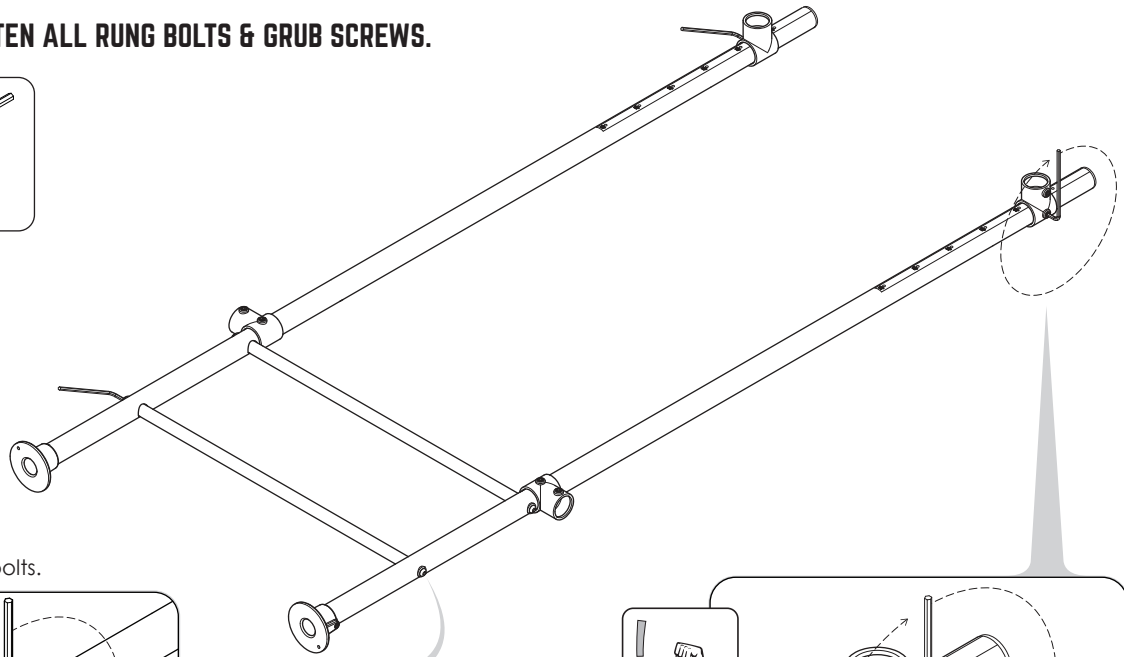
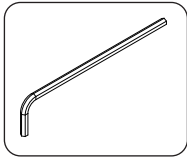

Fully Tighten rung bolts.

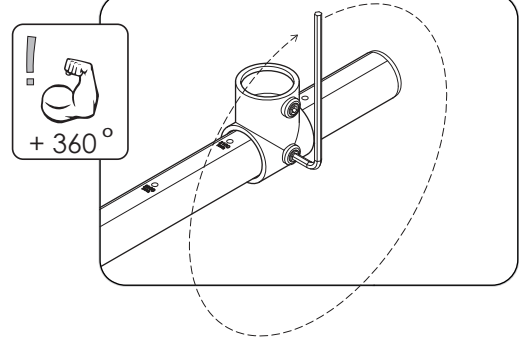
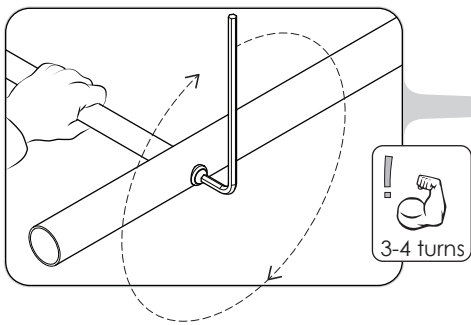

13 ATTACH LADDER BAR TO LEG ASSEMBLY.

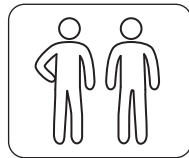
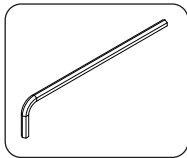

Using two people insert ladder bar assembly from step 10 into short tees on leg assembly from step 12.

Fully tighten all grub screws.

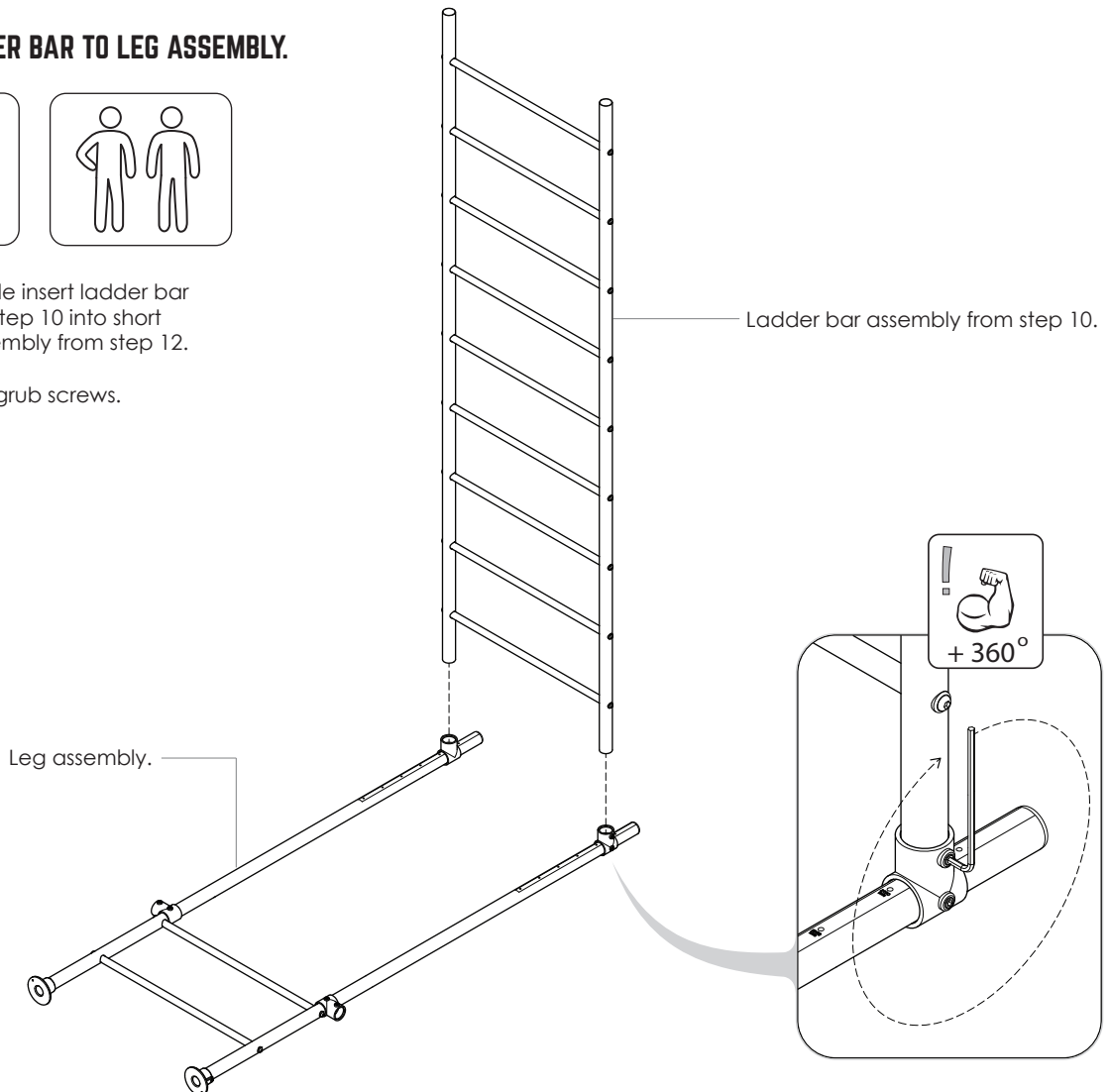

14 ATTACH MONKEY BAR ASSEMBLY TO EXISTING FRAME LEGS

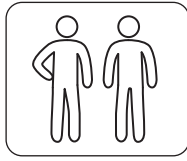
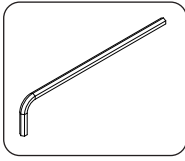

Using two people flip the monkey bar assembly over and attach to the existing frame.

Fully tighten all grub screws.

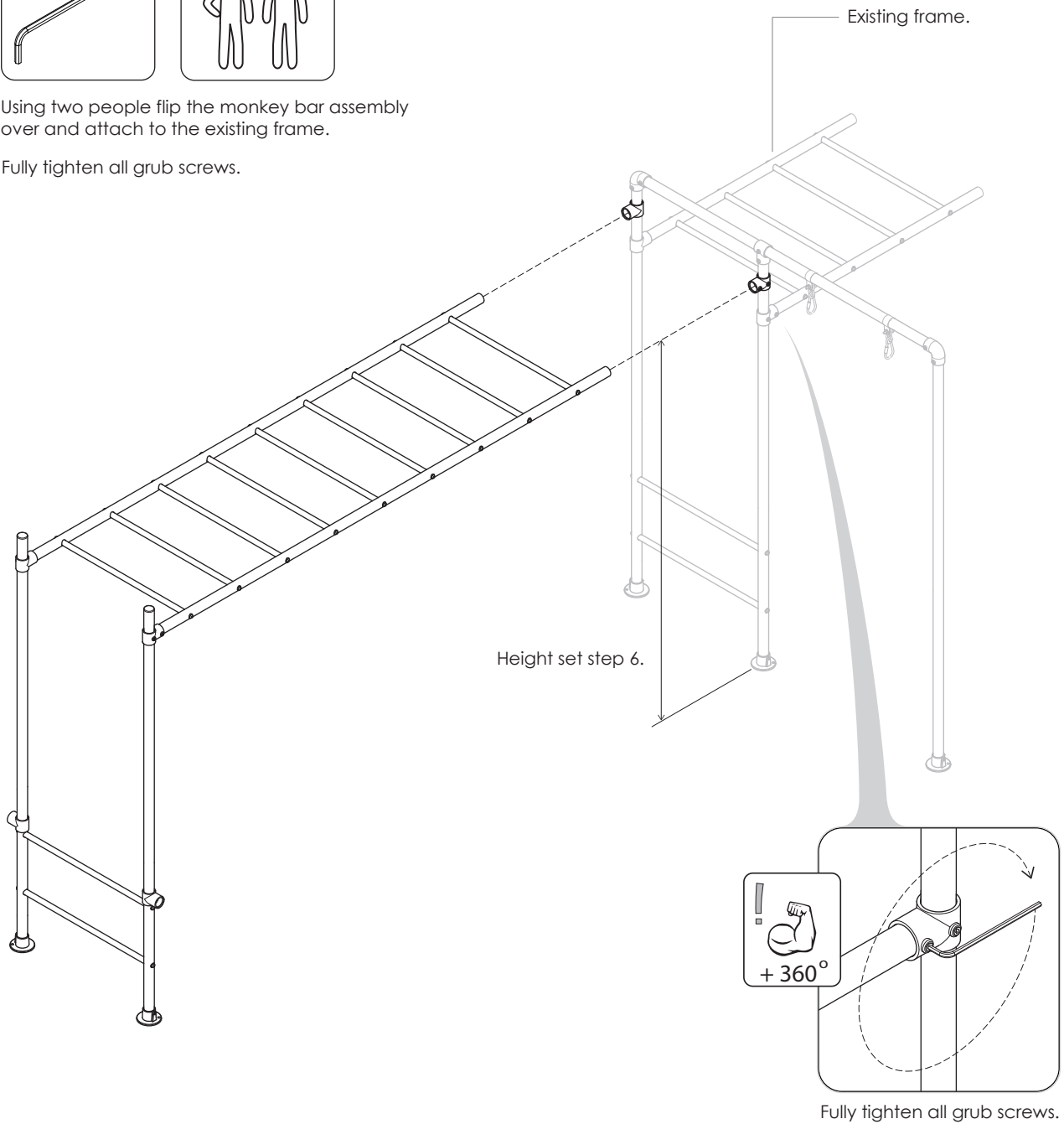

15

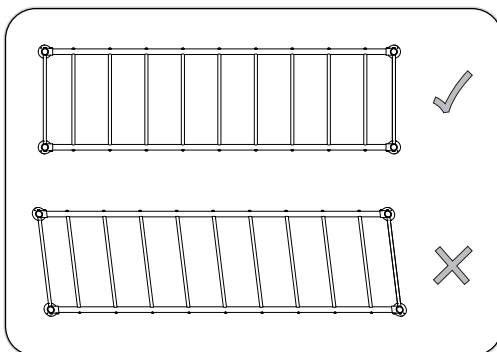

CRITICAL : ENSURE YOUR FRAME IS 100% SQUARE AND LEVEL (AS PER PAGE 6) BEFORE MOVING ONTO THE REST OF THE ASSEMBLY.

16 SECURE TO GROUND

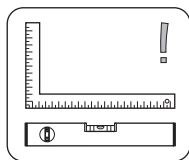
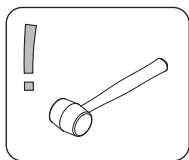

1. Ensure frame is square and level.
2. Firmly tighten all grub screws.
3. Hammer in pegs x2.

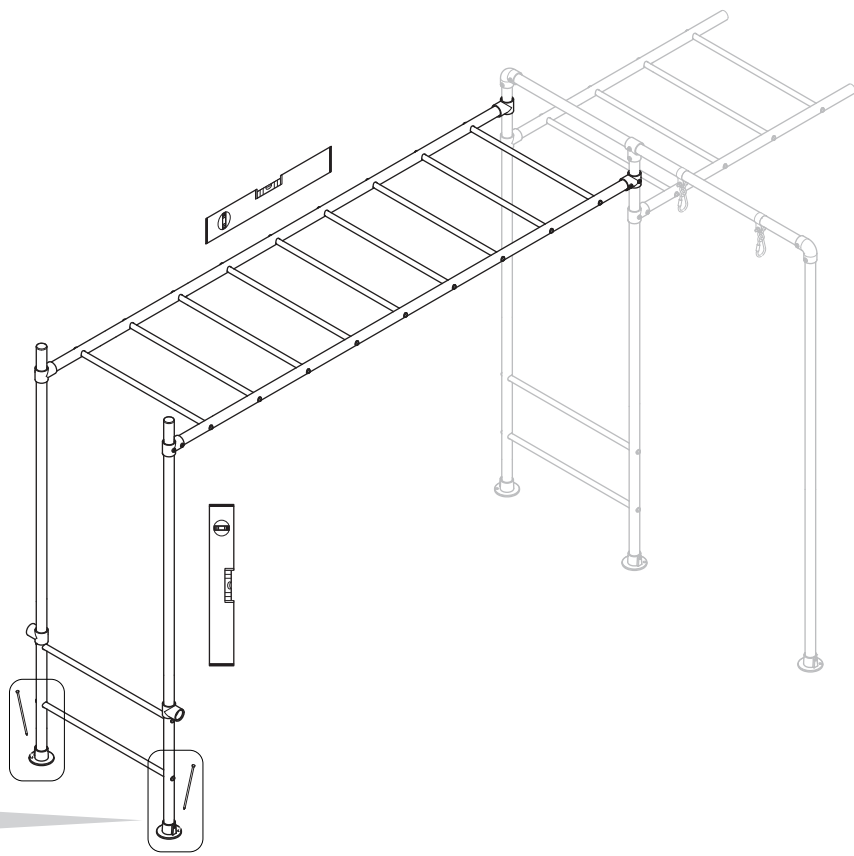
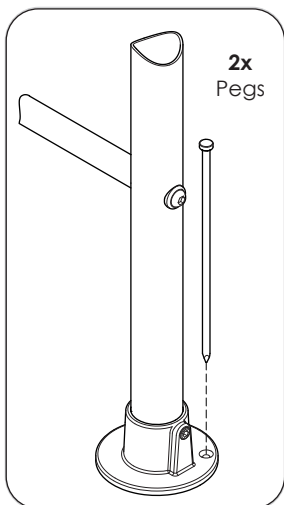

17 RE-ATTACH TWIRLY WHIRLY BARS X2

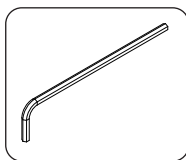

Adjust height of short tees A & B to align with horizontal twirly whirly bars.

Attach 2x twirly whirly bars re-used from existing frame in step 3

Tighten all grub screws fixing twirly whirlys to legs.

2x Twirly whirly bars reused from step 3.

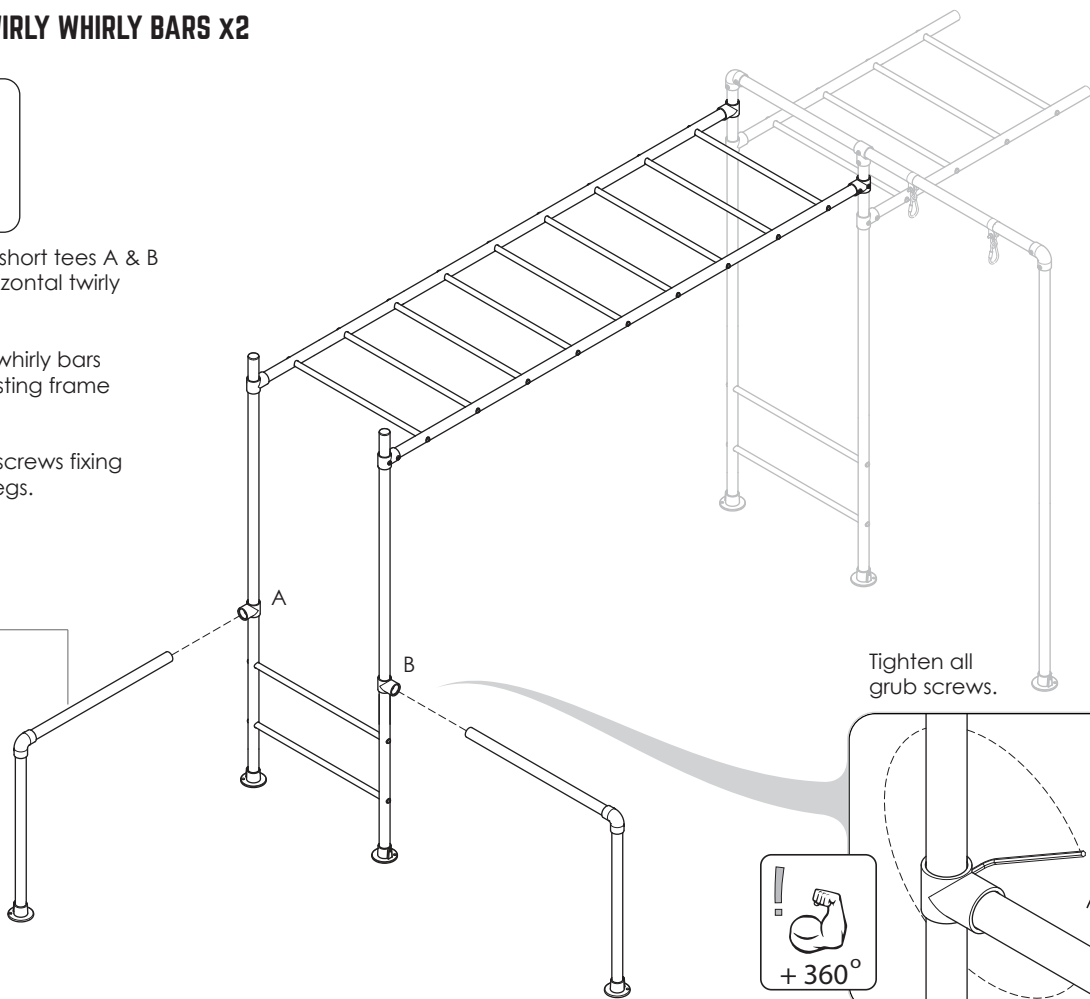

18 LOAD YOUR TWIRLY WHIRLY BARS x2

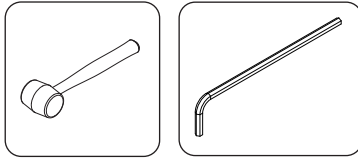

To reduce movement in your frame load your twirly whirly bars as follows.

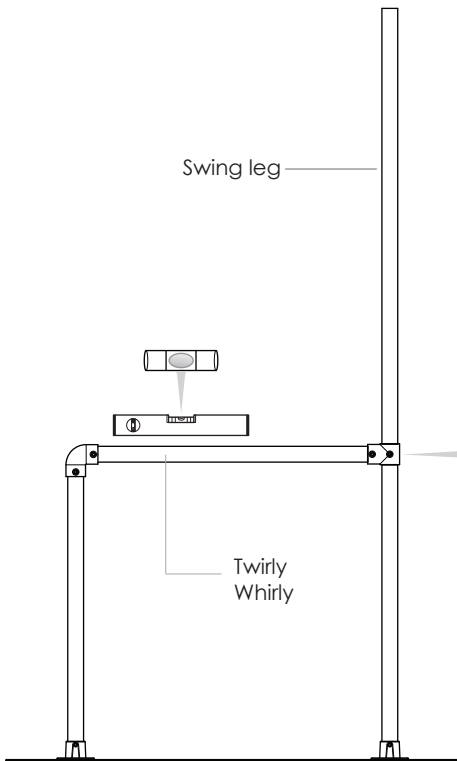

1. Ensure twirly whirly is level and square & swing leg is pegged down.

2. Loosen the grub screw fixing the short tee to the swing leg.

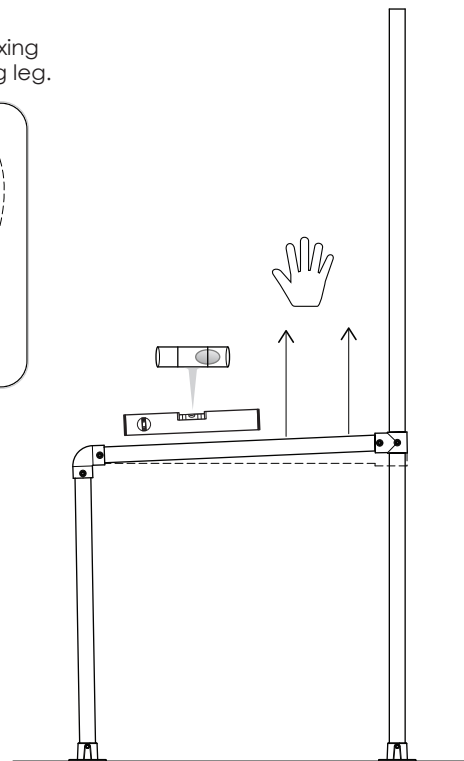
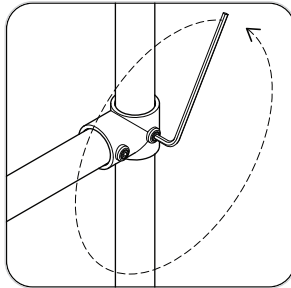

3. Pull upwards on the twirly whirly bar to make a slight angle. (Half a bubble off center on the level)

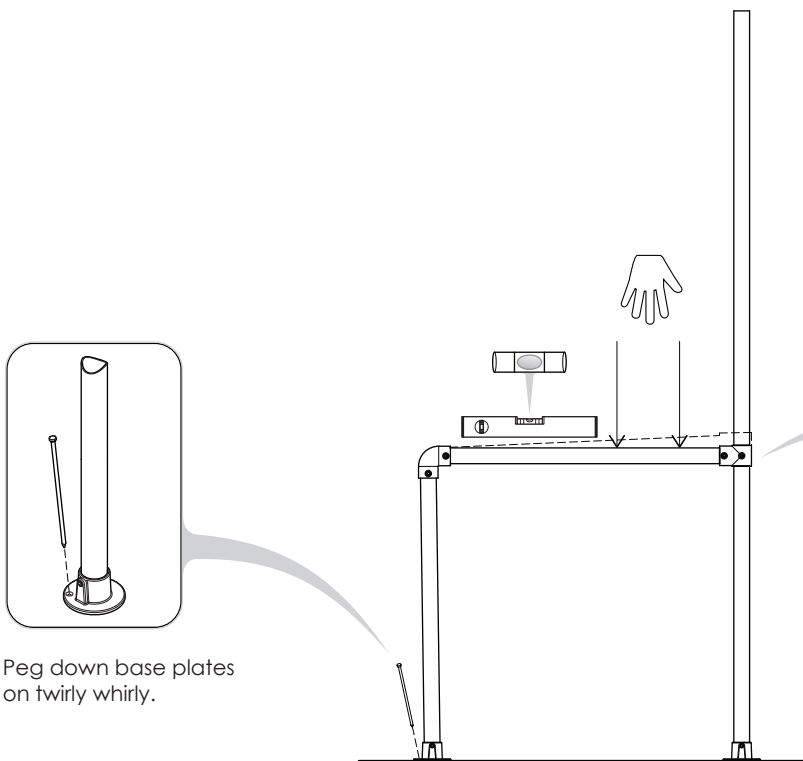

4. Peg down base plates on twirly whirly.

5. Push down on the twirly whirly bar until horizontal bar is level.

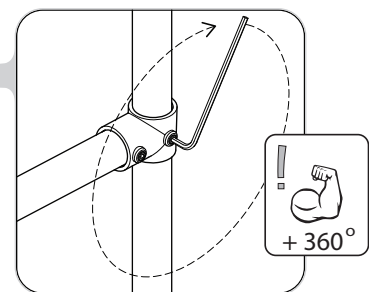

6. Tighten grub screw fixing the short tee to the swing leg tube. Apply to all twirly whirlys.

REFER TO VIDEO SECTION OF WEBSITE [HTTP://WWW.FUNKYMONKEYBARS.COM/PAGES/VIDEOS](http://www.funkymonkeybars.com/pages/videos)

19 FINAL CHECKS

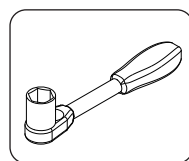
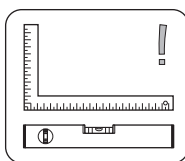
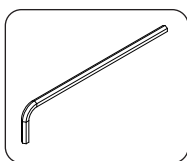

1. Ensure frame is square and level.
2. Check all grub screws are firmly tightened.
3. Check all base plates are pegged down.

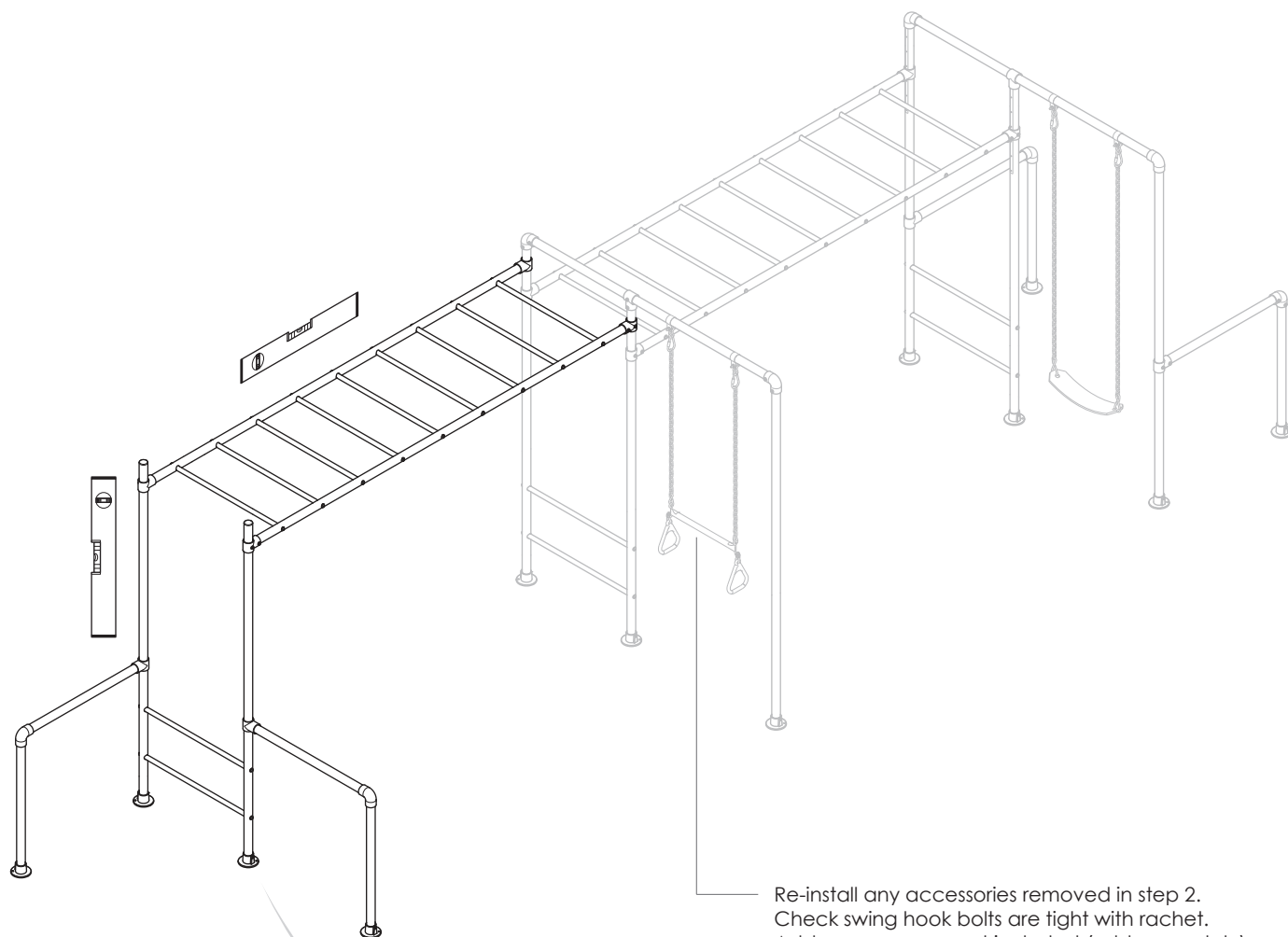

Re-install any accessories removed in step 2.
Check swing hook bolts are tight with ratchet.
Add-on accessory not included-(sold seperately)

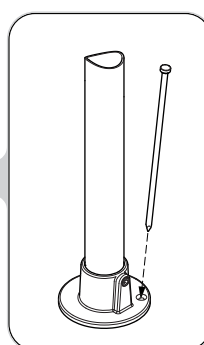

Check all pegs are hammered in.

20 MAINTENANCE.

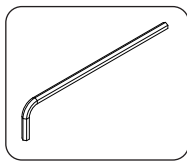
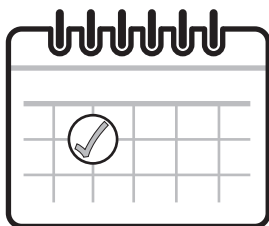

At the beginning of each heavy play session (especially a party) and twice a month during play season ensure;

1. Tighten all hardware - grub screws, nuts and bolts.
2. Pegs are in place and fully secure.
3. Lubricate all metallic moving parts (trolley and swing hooks.)
4. Ensure your frame is level and square.

FAILURE TO DO SO COULD RESULT IN SERIOUS INJURY OR DEATH.

**FOR MORE INFORMATION AND ASSEMBLY TIPS
PLEASE REFER TO OUR WEBSITE VIDEO INSTRUCTION SECTION AT
[HTTP://WWW.FUNKYMONKEYBARS.COM/PAGES/VIDEOS](http://www.funkymonkeybars.com/pages/videos)**

21 HAVE FUN



NOTES.



ABN 72 164 496 520
 1300 912 198
 info@funkymonkeybars.com
 www.funkymonkeybars.com
 9 Cutting Way,
Yangebup WA 6164



WE ARE SOCIAL MONKEYS



Australian Government
IP Australia

All Funky Monkey Bars® designs are registered and protected under IP Australian certification.