

FUNKY Monkey bars[®]

THE DOOR KNOB - ASSEMBLY INSTRUCTIONS

COMPONENTS

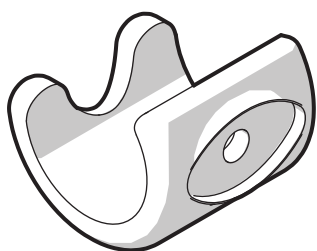

PIPE GRIP

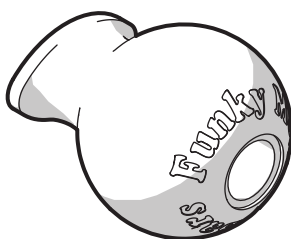

DOOR KNOB

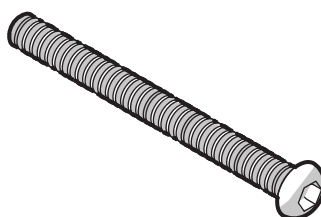

M10X110 BOLT



CAP

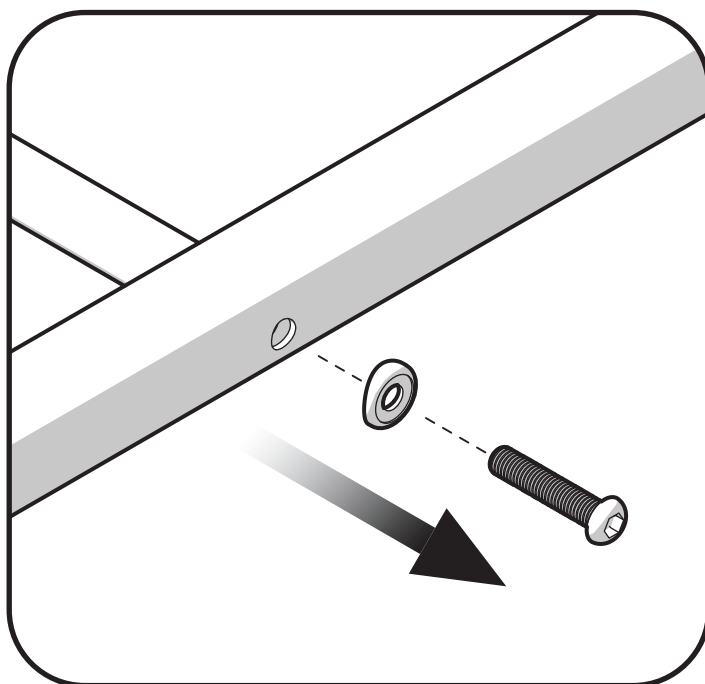
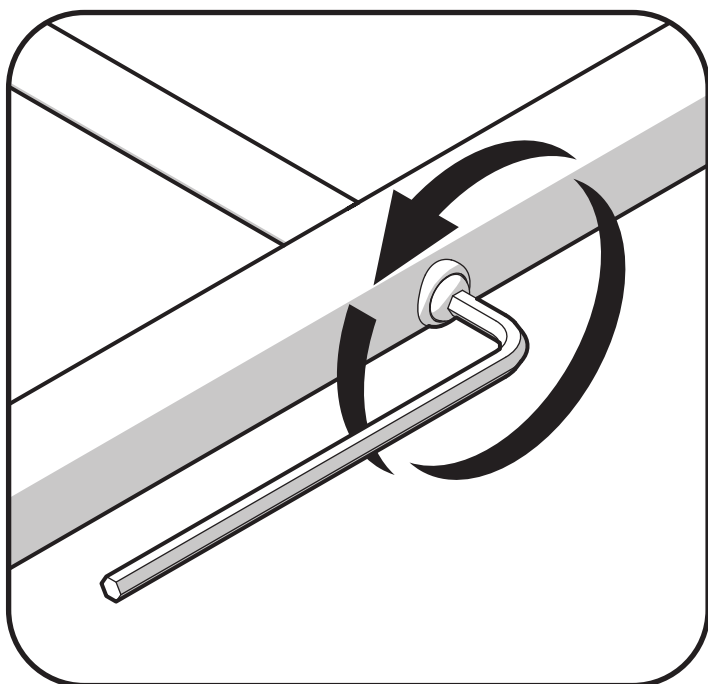

IF ADDING TO AN EXISTING LADDER, REMOVE RUNG BOLT AND WASHER

1

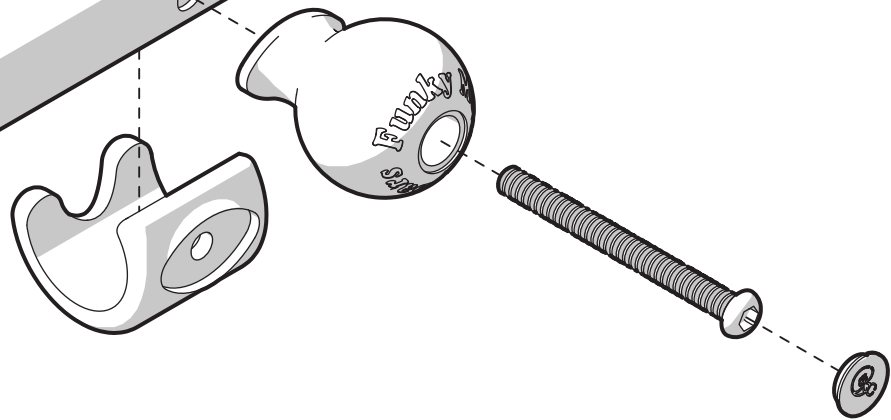

CLIP PIPE GRIP ONTO LADDER. ALIGN HOLES

2

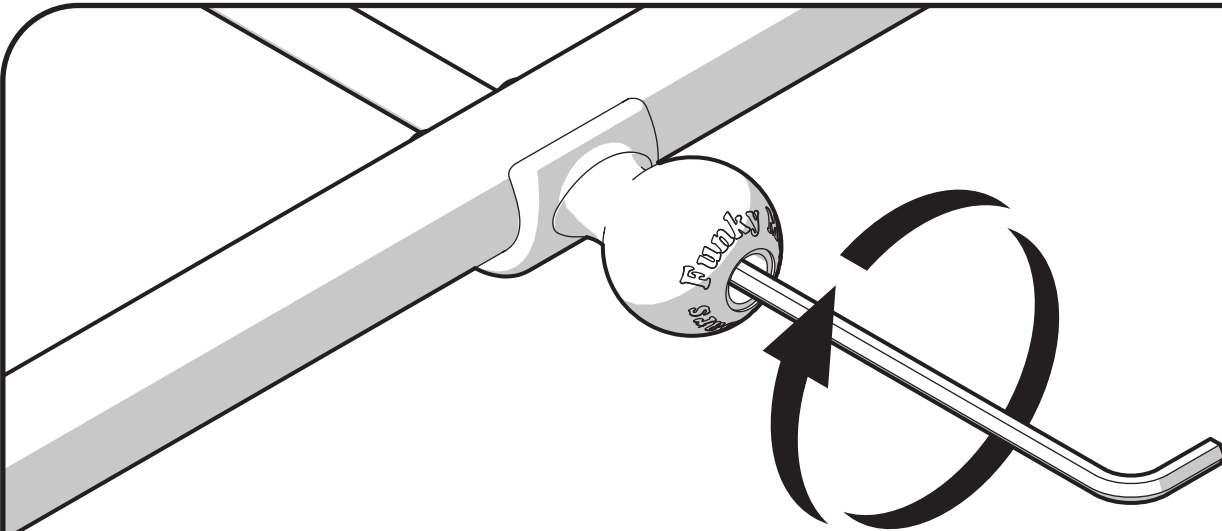

TIGHTEN BOLT USING THE LONG END OF THE ALLEN KEY

3

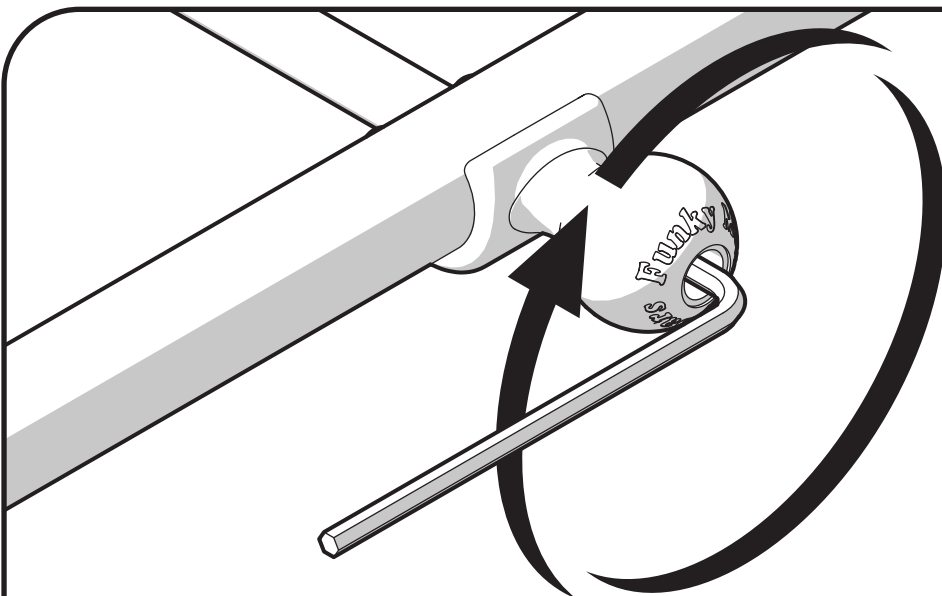

ONCE TIGHT, USE THE SHORT END OF THE ALLEN KEY TO COMPLETE ANOTHER FULL ROTATION