

# Instruction Manual

---

Dual Display Multifunction USB-C Hub

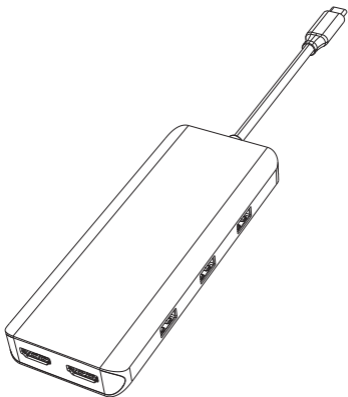

ENGLISH

## Product Introduction

This is a multifunctional USB-C hub. It can expand the USB-C, interface on MacBook and other USB-C notebooks to 4K HDMI, USB-C PD charging, USB 3.0, USB 2.0. Just plug and play to connect to multiple external devices to meet the needs of different interfaces.

The product support Mac OS /Windows/Android system.

## Structure Diagram

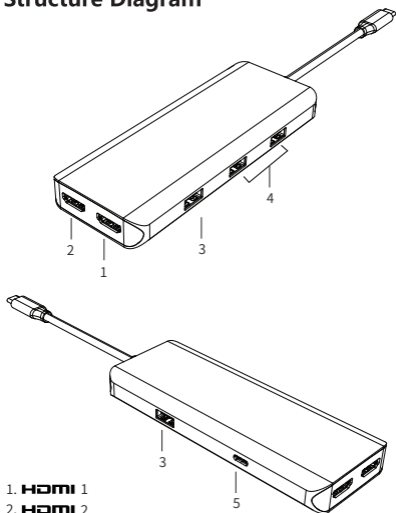

1. **HDMI 1**
2. **HDMI 2**
3. **USB 2.0**
4. **USB 3.1**
5. **USB-C PD 3.0**

# Feature

1. HDMI 1:  
4Kx2K 30Hz / 3840x2160.
2. HDMI 2:  
1080p 60Hz.
3. USB 2.0  
Up to 480Mbps data speed. Designed for the connection of 2.4 GHz wireless devices, such as wireless keyboards/ mouse adapters etc.
- 4.USB 3.1  
Up to 10Gbps data speed ,backwards compatible with USB3.0/2.0/1.1/1.0
- 5.USB-C PD3.0 Charging  
Upstream charging the source devices, support 100W PD adapter, but max charging limited to 87-96W for safety and affected by different firmware.

# Connection

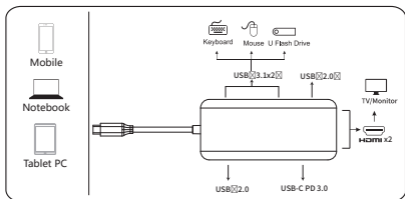

# Operating instructions

- 1.USB-C to connect to computers



- 2.Open the "INSTANTVIEW", Check the instructions on your usb flash drive.



# Resolution Setting for Mac

Apple logo > System Preferences > Displays

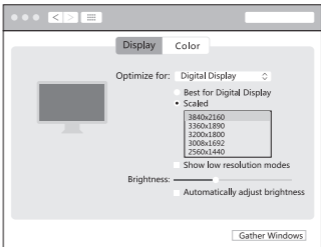

# Sound Setting for Mac

Apple logo > System Preferences > Sound

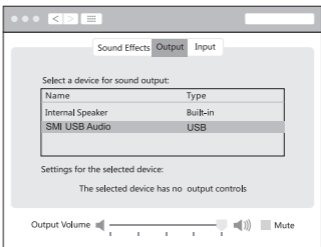

# Graphics Settings for Mac

## 1. Mirror Display

Apple logo > System Preferences > Displays

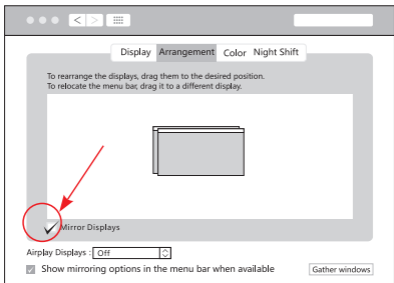

Source device



HDMI 1 Display



Source device



HDMI 2 Display



Source device



HDMI 1 Display



HDMI 2 Display

## 2. Extend Display

Apple logo > System Preferences > Displays

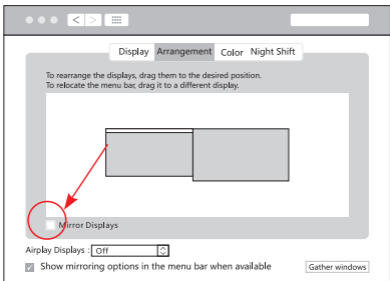

Source device



HDMI 1 Display



Source device



HDMI 2 Display



Source device



HDMI 1 Display



HDMI 2 Display

# Windows System display settings

Right click desktop > Display Settings

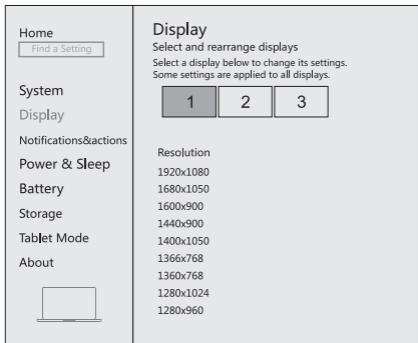

The screenshot shows the Windows Settings application with the 'Display' section selected. On the left, a navigation pane lists 'Home', 'System', 'Display', 'Notifications & actions', 'Power & Sleep', 'Battery', 'Storage', 'Tablet Mode', and 'About'. Below 'About' is a laptop icon. The main area is titled 'Display' and contains the text 'Select and rearrange displays' and 'Select a display below to change its settings. Some settings are applied to all displays.' Below this text are three numbered boxes (1, 2, 3) representing displays. Underneath is a 'Resolution' list with the following options: 1920x1080, 1680x1050, 1600x900, 1440x900, 1400x1050, 1366x768, 1360x768, 1280x1024, and 1280x960.

## Sound Settings for win10

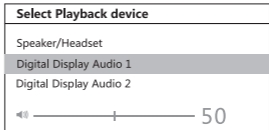

The screenshot shows a 'Select Playback device' dialog box. It has a title bar and a list of three options: 'Speaker/Headset', 'Digital Display Audio 1', and 'Digital Display Audio 2'. 'Digital Display Audio 1' is highlighted with a grey background. Below the list is a volume slider with a speaker icon on the left and the number '50' on the right.

# Windows System display settings

## 1.Clone mode

Right click desktop > Graphics Settings > Display

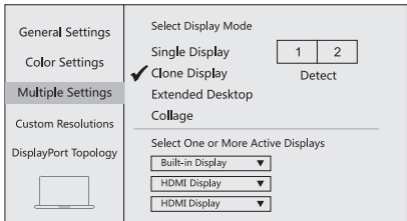

Source device



HDMI 1 Display



Source device



HDMI 2 Display



Source device



HDMI 1 Display



HDMI 2 Display



## 2.Extended Desktop

Right click desktop > Graphics Settings > Display

General Settings	Select Display Mode
Color Settings	Single Display <input type="checkbox"/> 1 <input checked="" type="checkbox"/> 2 <input type="checkbox"/> 3
<b>Multiple Settings</b>	Clone Display <input type="checkbox"/> Detect
Custom Resolutions	<input checked="" type="checkbox"/> Extended Desktop
DisplayPort Topology	Collage <input type="checkbox"/>
	Select One or More Active Displays
	<input type="text" value="Built-in Display"/> ▼
	<input type="text" value="HDMI Display"/> ▼
	<input type="text" value="HDMI Display"/> ▼



Source device



HDMI 1 Display



Source device



HDMI 2 Display



Source device



HDMI 1 Display



HDMI 2 Display

# Android System display settings

## 1.Clone mode

Equipment Status:

Device Connected **USB2.0**

Display Status:



Source device



HDMI 1 Display



Source device



HDMI 2 Display



Source device



HDMI 1 Display



HDMI 2 Display

# Storage Conditions

Environmental Working Temperature: 0°C to 40°C (32°F to 104°F)

Storage Temperature: -20°C to 85°C (-4°F to 185°F)

Environmental Working Humidity: 20%-90%RH

Storage Humidity: 5%-95%RH

## FAQ

A. Why is there no video output ?

1. Pls make sure if the connection is good.
2. Pls use standard HDMI cable.
3. Re-install the product's built-in instantview App.

B. Why is there no audio output from HDMI ?

1. Pls make sure if there's audio output on the Monitor.
2. Pls set the external monitor as default audio output device.

C. What if the WIFI drops when the hard drive has been connected to the hub ?

1. 2.4G is easily interfered, you can switch to 5G network, or try to move the hard drive to a suitable place.

D. What if the USB driver can't be identified ?

1. Restart the device and connect the hub again.

E. What should I do if the display screen drops after connecting a large current HDD/SSD?

1. Please connect your laptop charger/adaptor to the USB-C PD charging port of product.



Made in China

**HDMI**<sup>®</sup>  
HIGH-DEFINITION MULTIMEDIA INTERFACE

The terms HDMI, HDMI High-Definition Multimedia Interface, and the HDMI Logo are trademarks or registered trademarks of HDMI Licensing Administrator, Inc.