

Instruction Manual

USB-C Triple-Display Docking Station

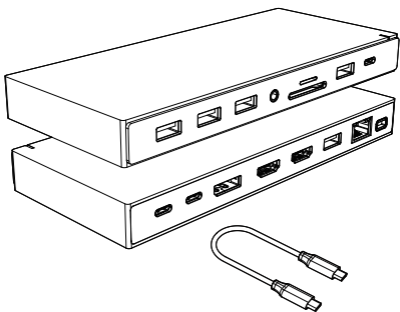

ENGLISH

Product Introduction

This is a full-featured desktop usb-c high-speed expansion base, which can connect your usb-c laptop to all other devices with just one cable to keep everything in order. You can output three monitors through two HDMI and one DP interface. One HDMI has a resolution of up to 4K@60Hz [supported when the host is DisplayPort (DP1.4)]; enjoy the high speed transmission and excellent image quality of 4K video.

Structure Diagram

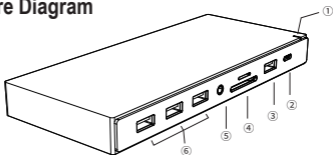

Front:

1. LED indicator
2. USB-C Data
3. USB-A 3.1
4. SD&Micro SD Card Reader
5. 3.5mm Audio & Microphone:
6. USB3.0

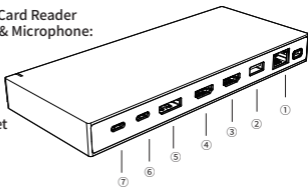

Back:

1. RJ45 Ethernet
2. USB2.0
3. **HDMI 1**
4. **HDMI 2**
5. DP
6. Host
7. USB-C PD+Data

Features

Front:

1. LED indicator
2. USB-C 3.1: 10Gbps, 5V/0.9A @4.5W.
3. USB-A 3.1
Up to 10Gbps data speed & maximum power output 5V/0.9A, backwards compatible with USB3.0/2.0/USB1.1.

4. SD&Micro SD Card Reader:

SD Read: 200-250MB/s Write: 100-250MB/s

Micro SD Read: 50-104MB/s Write: 30-80MB/s

(Data transfer rates are subject to the speed of the memory card itself .)

5. 3.5mm Audio & Microphone

6. USB-A 3.0: 5Gbps, 5V/0.9A @4.5W

Back:

1. RJ45 Gigabit Ethernet: 1000Mbps

2. USB-A 2.0 : 480Mbps, 5V/0.5A @2.5W

3. HDMI 1:

4Kx2K 60Hz / 3840x2160 (work separately while host is DP1.4)

4Kx2K 30Hz / 3840x2160 (work separately while host is DP1.2)

4. HDMI 2: 4K x 2K @30Hz / 3840x2160

5. DP:

4Kx2K 60Hz / 3840x2160 (work separately while host is DP1.4)

4Kx2K 30Hz / 3840x2160 (work separately while host is DP1.2)

6. USB-C Host: Connected to laptop with a USB-C cable.

7. USB-C PD + Data

Support 100W power in, up to 480Mbps data speed.

Connection

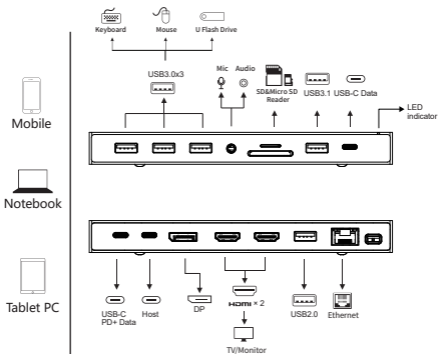

Graphics Settings for Windows 10

1.Clone Mode

Right click desktop > Graphics Settings > Display

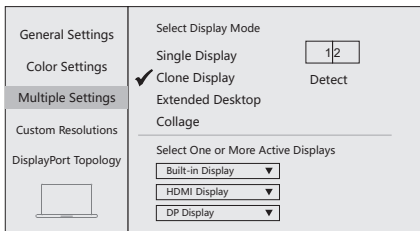

Source device



HDMI 1 Display



HDMI 2 Display



DP Display

2.Extended Desktop

Right click desktop > Graphics Settings > Display

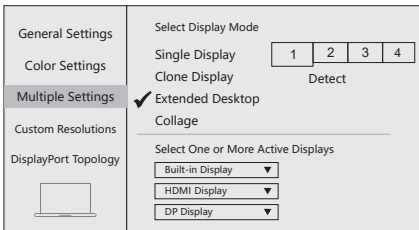

The screenshot shows the Windows Graphics Settings application with the Display tab selected. On the left is a navigation pane with options: General Settings, Color Settings, Multiple Settings (highlighted), Custom Resolutions, and DisplayPort Topology. Below this is a laptop icon. The main area is titled 'Select Display Mode' and lists: Single Display, Clone Display, Extended Desktop (checked with a checkmark), and Collage. To the right of these options are four numbered buttons (1, 2, 3, 4) and a 'Detect' button. Below this is a section titled 'Select One or More Active Displays' with three dropdown menus: 'Built-in Display', 'HDMI Display', and 'DP Display'.



Source device

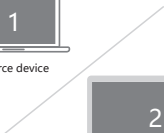

HDMI 1 Display



HDMI 2 Display



DP Display

Graphics Settings for Mac

1. Mirror Display

Apple logo > System Preferences > Displays

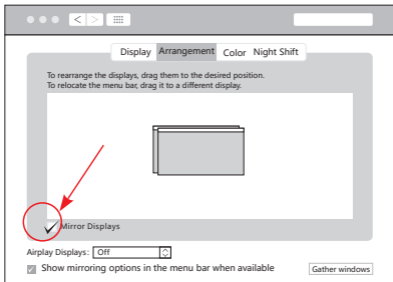

Source device



HDMI 1 Display



HDMI 2 Display



DP Display

2. Extend Display

Apple logo > System Preferences > Displays

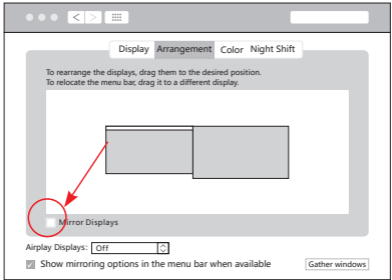

Source device



HDMI 1 Display



HDMI 2 Display



DP Display

Storage Conditions

Environmental Working Temperature: 0°C to 40°C (32°F to 104°F)

Storage Temperature: -20°C to 85°C (-4°F to 185°F)

Environmental Working Humidity: 20%-90%RH

Storage Humidity: 5%-95%RH

FAQ

A. Why is there no video output?

1. Please make sure the USB-C port of your devices (Laptop/Tablet) support video output.
2. Please check if the cable is well connected.
3. Please use the standard HDMI cable.

B. Why is there no audio output from HDMI?

1. Please make sure your monitor support audio output function.
2. Please set the external monitor as default audio output device.

C. What should I do if the display screen drops after connecting a large current HDD/SSD?

Please connect your laptop charger/adaptor to the USB-C PD charging port of product.

D. Why does the output not reach 4K 60Hz?

1. Please make sure your monitor support 4K 60Hz.
2. Please make sure the video source is 4K 60Hz.
3. Please make sure to use the 2.0 or higher version HDMI cable.
4. Please make sure your computer specification support DP1.4 signal output.



Made in China

HDMI[®]
HIGH-DEFINITION MULTIMEDIA INTERFACE

The terms HDMI, HDMI High-Definition Multimedia Interface, and the HDMI Logo are trademarks or registered trademarks of HDMI Licensing Administrator, Inc.