

# Tuya Smart Camera User Manual

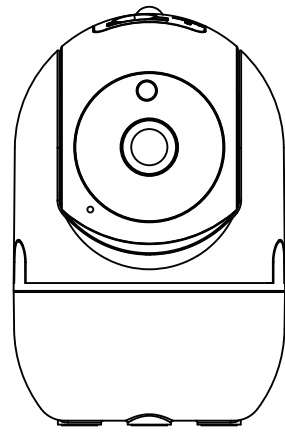

## 1. What's Included

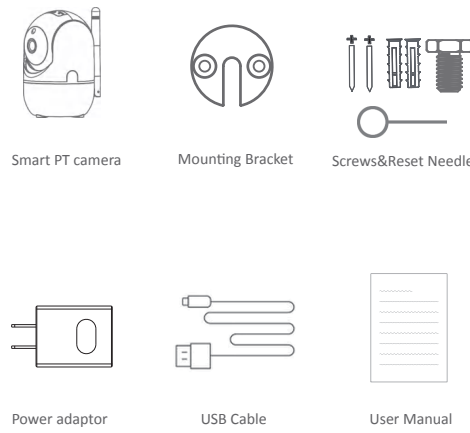

## 2. Interface Introduction

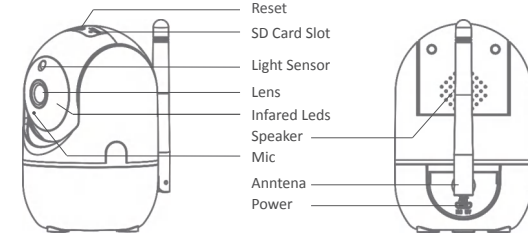

- Reset : Long press with the needle for 5s to reset the camera
- SD Card Slot : Support local SD Card storage (Max 128GB)
- Light Sensor: To control the IR switch in night
- Lens: 3.6mm 110degree view lens
- IR Leds: 6pcs IR leds inside with 10m IR distance
- Speaker: Support two way audio so you can hear the voice
- Mic: Capture sound for your video
- Antenna: 5DB antenna to get wifi access
- Power: DCSV/1.5A input

## 3. Installation Stps

### 3.1.Ceiling Install

Use the included mounting bracket to fix the camera to a clean surface.

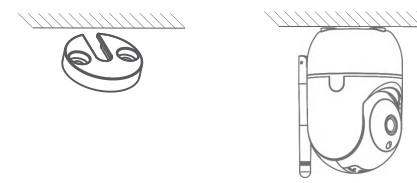

### 3.2.Desk Install

Put the camera on a flat table or surface.

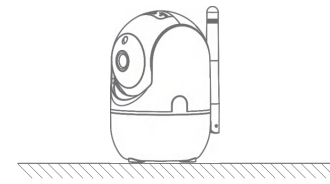

## 4. Download the APP

Search for Tuya Smart in APP store or Google Play or Scan the QR Code below to download.



## 5. Register/Log in with existing account

### 5.1.Register

If you don't have account yet you can register an account.Click "Creat New Account " and read the Privacy Policy on APP ,click agree to enter the registration page for Mobile (only support China mobile numbers) or Email address to get the verify code to finish the registration.

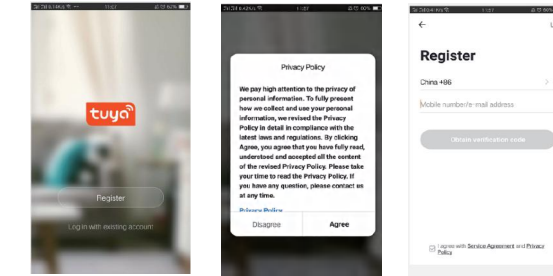

### 5.2. Login with existing account

If you already have an account click "Log in with existing account" (1) The system automatically select the current Country/Region or you could manually select the Country/Region.

(2) Enter your registered mobile number or email address ,enter the password to log in the APP.

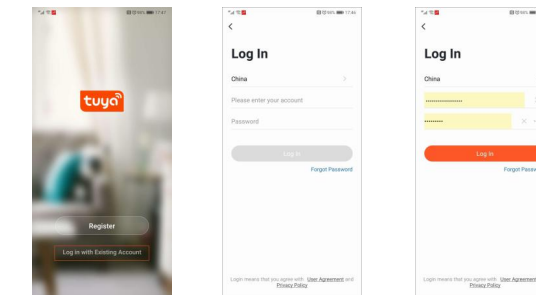

## 6. Add devices

### 6.1. QR Code Conenction

**Tips:** The devices only support 2.4GHz wifi currently not 5GHz wifi . And the WIFI password should not contain any special characters eg. !@#%&\*() when configuring please put your phone and devices as closer as possible.

Power on the camera ,you will hear the broadcast "Wait for wifi configure" If you heard nothing at all kindly reset the camera to factory settings.

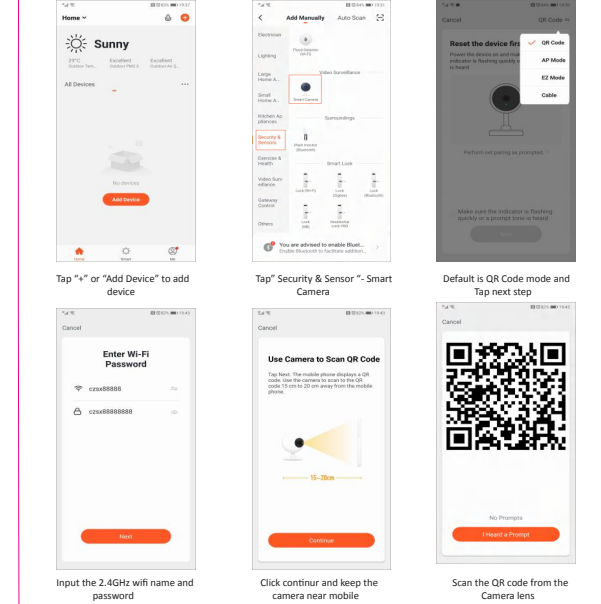

## 6.2. EZ Mode Connection

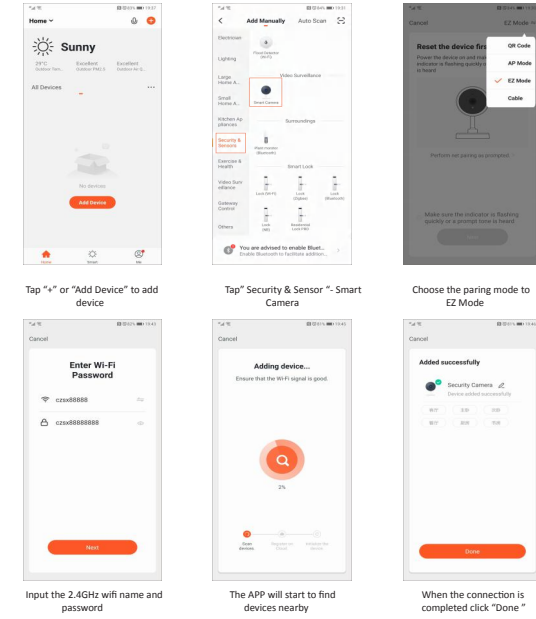

## 6.3. Cable Mode(Only for ODM model with Lan port)

Power on the camera and connect the camera with a network cable, waiting for the LED signal light is on.

## 7. APP Settings

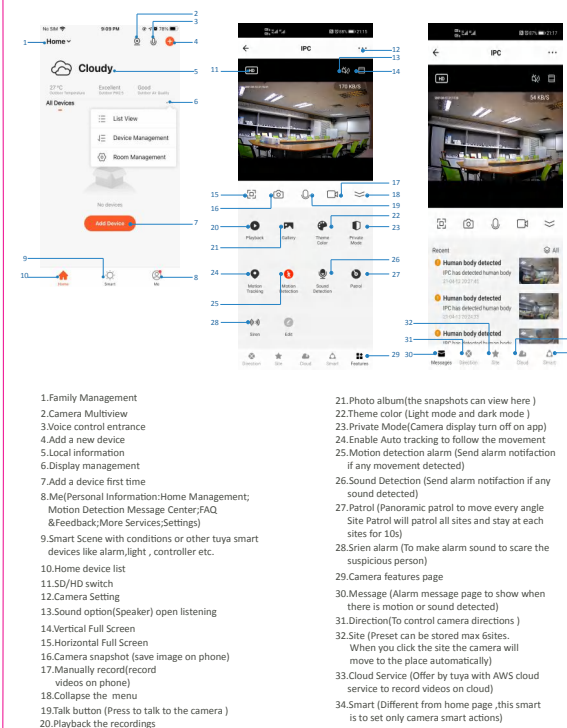

- Family Management
- Camera Multiview
- Voice control entrance
- Add a new device
- Local Information
- Display management
- Add a device first time
- Me(Personal Information:Home Management; Motion Detection Message Center:FAQ &Feedback:More Services:Settings)
- Smart Scene with conditions or other tuya smart devices like alarm,light , controller etc.
- Home device list
- 5.0/HD switch
- Camera Setting
- Sound option(Speaker) open listening
- Vertical Full Screen
- Horizontal Full Screen
- Manually record(record videos on phone)
- Collaps the menu
- Talk button (Press to talk to the camera )
- Playback the recordings
- Photo album(the snapshots can view here )
- Theme color (light mode and dark mode )
- Private Mode(Camera display turn off on app)
- Enable Auto tracking to follow the movement if any movement detected)
- Sound Detection (Send alarm notification if any sound detected)
- Patrol (Panoramic: patrol to move every angle Star Patrol will patrol all sites and stay at each sites for 10s)
- Siren alarm (To make alarm sound to scare the suspicious person)
- Camera features page
- Message (Alarm message page to show when there is motion or sound detected)
- Direction(To control camera directions )
- Sie (Preset can be stored max 6times. When you click the site the camera will move to the place automatically)
- Cloud Service (Offer by tuya with AWS cloud service to record videos on cloud)
- Smart (Different from home page ,this smart is to set only camera smart actions)

## 8. Camera Settings

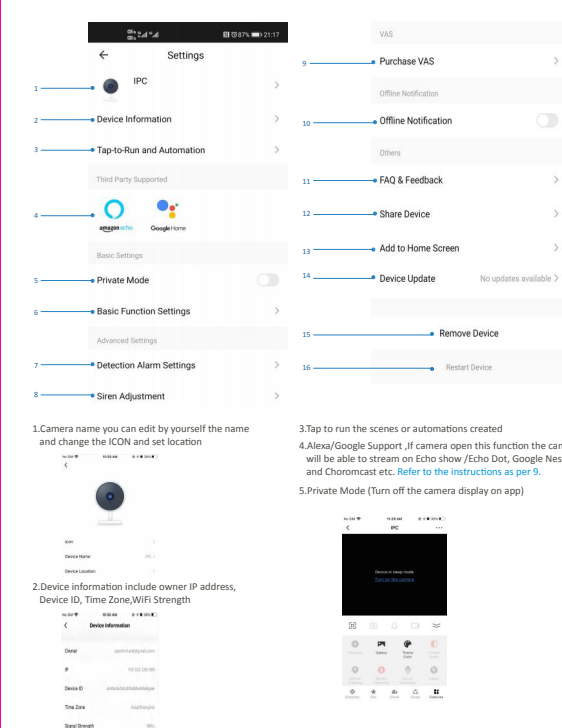

- Camera name you can edit by yourself the name and change the icon and set location
- Device information includes owner IP address, Device ID, Time Zone,Wifi Strength
- Tap to run the scenes or automations created
- Alexa/Google Support ,If camera open this function the camera will be able to stream on Echo show (Echo Dot, Google Nest Hub and Chromecast etc. Refer to the instructions as per 9.
- Private Mode (Turn off the camera display on app)
- Offline Notification
- Offline Notification
- Others
- FAQ & Feedback
- Share Device
- Add to Home Screen
- Device Update (No updates available)
- Remove Device
- Restart Device
- Human Body Filtering : Only alarm if camera detect human shape
- Motion Tracking : Auto tracking people or moving object.
- Sound Detection: Enable sound detection alarm.
- Schedule: To add alarm schedule.
- Device update : Update notification here, or you can choose choose auto upgrade so the camera will upgrade automatically.
- Remove device: When you want to delete or change wifi of camera need to remove to unbud the camera from the account.
- Restart Device: Restart the device remotely.

## 9. Google Assistant And Alexa

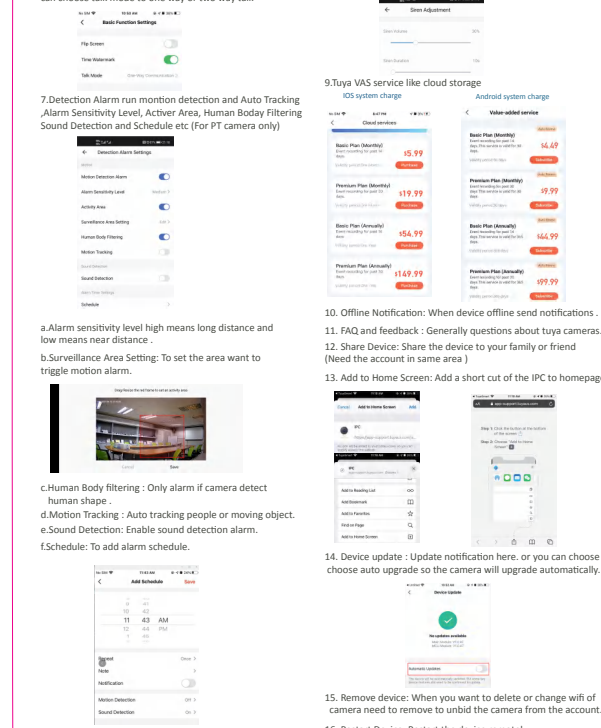

- Basic function contact Flip screen, Time watermark and can choose talk mode to one way or two way talk
- 7.Detection Alarm run motion detection and Auto Tracking ,Alarm Sensitivity Level, Activer Area, Human Body Filtering Sound Detection and Schedule etc. (For PT camera only)
- 9.Tuya VAS service like cloud storage
10. Offline Notification: When device offline send notifications .
11. FAQ and feedback - Generally questions about tuya cameras.
12. Share Device: Share the device to your family or friend (Need the account in same area )
13. Add to Home Screen: Add a short out of the IPC to homepage.
14. Device update : Update notification here, or you can choose choose auto upgrade so the camera will upgrade automatically.
15. Remove device: When you want to delete or change wifi of camera need to remove to unbud the camera from the account.
16. Restart Device: Restart the device remotely.

## 9. Google Assistant And Alexa

**Please make sure your device have enable this function**

### 9.1. Precondition

(1)Download and install the Google Home or Amazon Alexa APP according to the Smart speaker you have.  
(2)Register the account and pair your smart speaker with APP.

### 9.2. Paring Tuya Smart to Smart Speaker APP

Link with Google Home APP .Support Google Nest Hub, Chromecast Display etc  
(1) Login on Google Home APP click the right corner of individual settings--Assistant Settings --choose Assistant --HomeControl--Search the Tuya Smart APP ,the page will direct to the tuya smart login page please input your tuya smart account and password and click "Authorise" to link tuya smart app with your Google Home APP. Then you will be able to see the devices support Google Assistant in your home device list.  
(2)Control your devices through Google Home APP .For the smart camera you could say as below: "Ok Google ,show me the smart camera"  
"Ok Google ,show me the security camera"  
And you could also give some familiar name to the device like front door , bedroom , haha etc. "Ok google show me front door /bedroom/haha"

Link with Amazon Alexa APP .Support Echo Spot , Echo Show 5/8/10 etc  
(1)Login on Amazon Alexa APP and click menu on the left corner . Select skill menu to enter skill store --search Tuya smart --Click Enable button --it will direct to tuya smart login page please input your tuya smart account and password --then speak to Echo "Alexa ,Discover the devices"--then you will be able to see the devices in your tuya smart app account.  
(2)Control your devices through Amazon Alexa APP .For the smart camera you could say as below: "Alexa ,show me the smart camera"  
"Alexa ,show me the IPC"  
"Alexa ,show me the security camera"

### Q1: How do I reset my camera to factory settings ?

A1: Delete the camera from your app list directly or long press the reset button for 8s until you hear the voice "Reset ,camera reboot"

### Q2: I have select the 2.4GHz Wi-Fi and input password correctly why does the camera still not connected to Wi-Fi?

A2: (1)Please make sure the network you used is the same one for your phone and the camera .  
(2)Please make sure your Router enable DHCP you could login the router settings to check .if it's disabled the camera will not get ip and fail.  
(3)Please press the reset button for 8s to restart the camera .  
(4)Please make sure the Wifi signal intensity is over 80%.

### Q3: How do I change the camera from one router to another?

A3: First delete the camera from your app list or long press the reset button for 8s . Then configure the camera again.

### Q4:Why SD card can't be recognized? After a period the video and cycle videos can not be recorded?

A4: Please check the camera settings and make sure you set up the camera to record on SD card. And currently support 128GB SD card do not exceed. And please make sure the SD card is not damaged and support only FAT32 .

### Q5: Why i can't recieve the alarm information when i see device online and has an motion detection event ?

A5: Please make sure you have enable the push notification from the Tuya Smart APP. And please enable alarm notification on app .

### Q6: How do i access the camera on WEB ?

A6:Open the page <https://ipc.ismartlife.me/login> and use your own Tuya app to scan the QR code then you will see the camera on IE.



## 10. FAQ

As mentioned that in the camera settings there are FAQ page and you could also read the Q&A below to have a brief understanding of the common issues.