

EK-GPK1 Level 1

Thank you very much for purchasing the Olympus Embroidery Kit

Please read this manual carefully before you start!

Precautions 注意事項

- * Please be careful when handling the needle.
- * Please make sure you have all the kit listed before you start.
- * If you run out of thread, such as a stitch mistake, please contact at EmmaCreation.
EmmaCreation : info@emmacreation.com
- * The print design may bleed when it gets wet.

How to use thread 刺しゅう糸の扱い方

Olympus embroidery thread has a beautiful luster.

Please handle it carefully so as not to damage the thread.

The #25 floss is made by loosely twisting 6 thin threads.
Pull out some of these thin threads and call it [O strands].

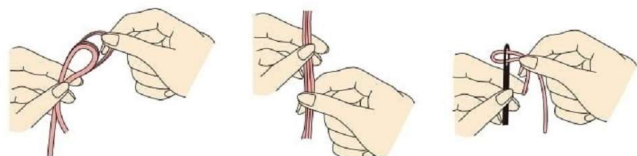
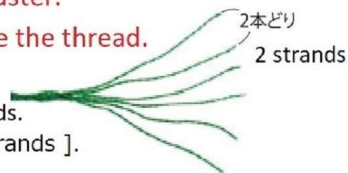

- ① Fold the thread in half and pull out the required number of threads one by one from pile.
- ② Align the threads
- ③ Pass the end the thread in a loop through the needle hole.

<Start stitching> Make a knot As shown in the figure below, wind the thread 2 to 3 times on the needle and pull out the needle.



<End of stitching> Pass through the stitches on the back of the cloth ※ Do not make a knot!

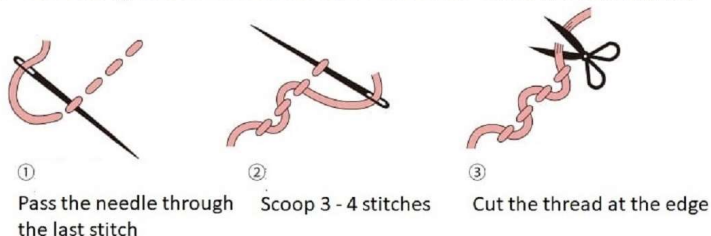

How to make a coaster Finished size / 10cm X 10cm

コースターの仕立て方 出来上がりサイズ/約10cm×10cm

- ◆ It is a one-layer coaster. You can make two coasters with this cloth.
- ◆ What to prepare
 - Sewing needle ● Hand-sewn thread ● Scissors ● Sewing gauge ● Chaco pen

- ① For those who have a pattern (right side) that becomes a coaster when all stitches are finished, copy the finished line with a chaco pen.
- ② Cut the outside by 1.5cm from the finished line so that it becomes 13cm x 13cm

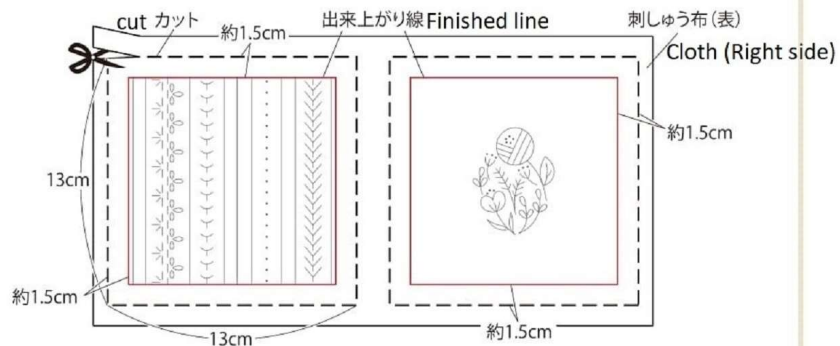

- ③ Fold the seam allowance in three

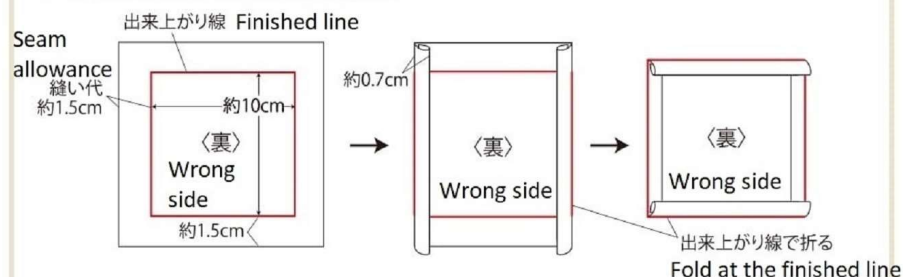

- ④ 手縫い糸でまわりをたてまつりします。

Blind stitch with hand-sewn thread

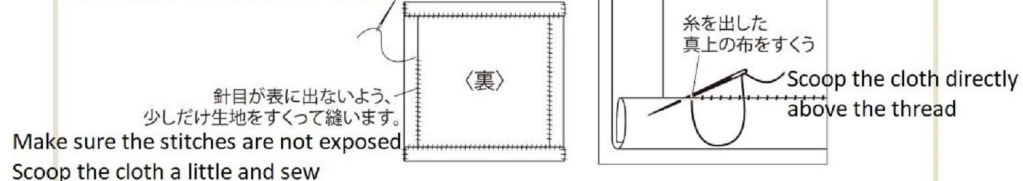

Imported by EmmaCreation
www.emmacreation.com

All copying and diversion is prohibited for copying protection.

オリムパス製絲株式会社
〒461-0018 名古屋市東区主税町4-92

EK-GPK1

Real size pattern

実物大図案

※ All stitches with 2 strands

※ ★ = Mark of the beginning of stitch ★のないものはどちらからでも刺せます。

You can stitch from either side where there is no ★ mark.

※ Please refer to the stitch list display for stitch instructions.

(Example) ①1705 = ① Running S Thread color #1705(Pink)

※ Let's stitch with reference to the design and the cover photo.

※ The same pattern is stitched in the same way.

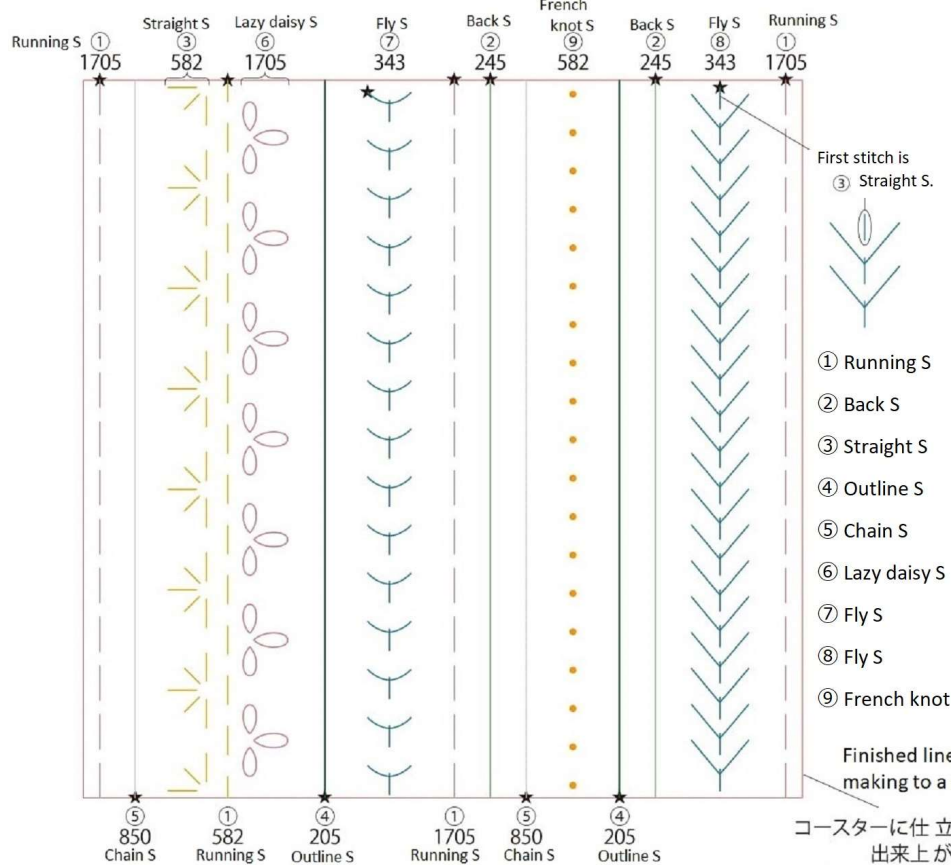

※ Do not stitch this line

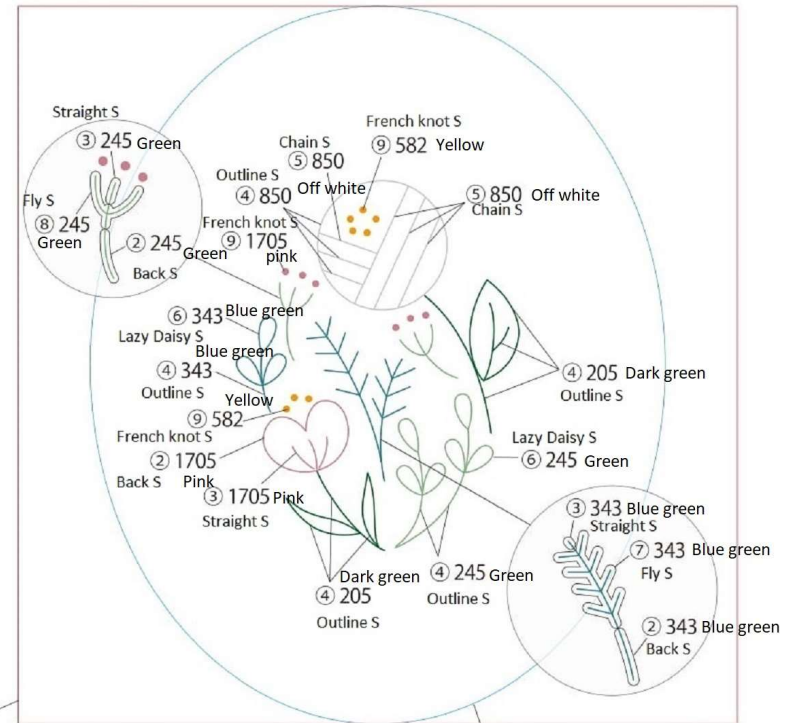

※ Do not stitch this line
 ※ チャームの詳しい仕立て方レシピは特集ページにて公開中
 ※ Wrap button : KB-3