

**LINEAR SERIES**

# Operation/Installation Manual

---

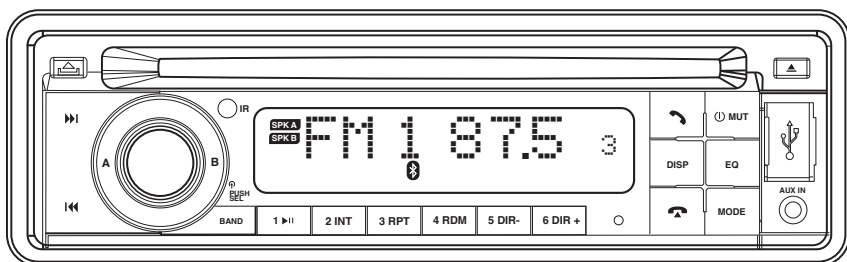

---

## M3039 AM/FM/Bluetooth/DVD Multimedia Receiver

For Technical Assistance, please call (310) 735-2000,  
or for more accessories or replacement parts visit [www.magnadyne.com](http://www.magnadyne.com).

## Introduction

Please take the time to read all of the information in this manual. Familiarity with operation and installation procedures will help you obtain the best possible performance from your new AM/FM Stereo Multi-Media Receiver.

**WARNING!** To prevent fire or electrical shock hazard, do not expose this product to moisture. No user-serviceable parts inside. Refer servicing to qualified personnel.

## Index

Getting Started.....	4-5		
General Operations .....	6	Radio Operations.....	7
Audio Menu		DISC/USB Operations .....	7
Settings Menu		Bluetooth Operations.....	7
CT INDEP/SYNC		AUX 1 / AUX 2 Operation.....	8
Clock 12/24		Video In / Out Function .....	8
Beep ON/OFF		HDMI Arc Function .....	8
P-VOL		Remote Control Locations and Functions .....	8-9
Area (AUS/USA)		BT APP Operations.....	10-11
DX/LOC (Distance/Local)		Installation .....	12-13
Stereo/MONO		Wiring.....	14
Speaker Zones A and B		Trouble Shooting.....	15
Information or Clock Priority		Specifications .....	15
Manual Clock Setting		Warranty.....	16
Reset Function			
AUXIN1 / AUXIN2 Operation			
ARC Function			
RCA / HDMI Output			

## Getting Started

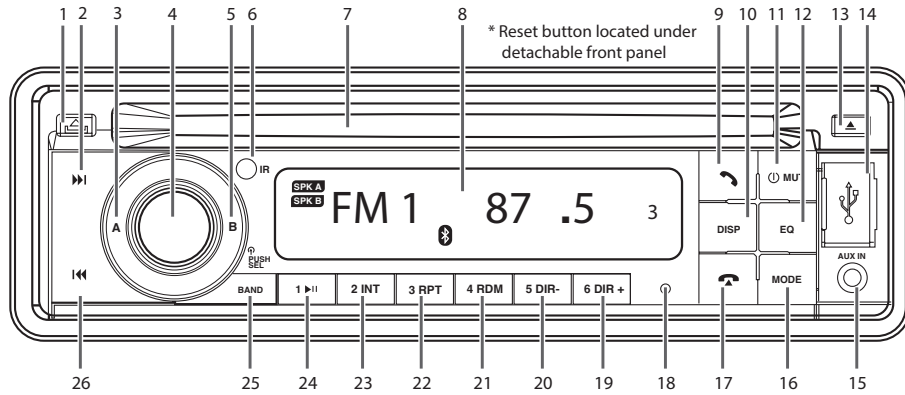

1. **Release Button:** To release the detachable front panel of the radio, press the release button.
2. **Seek UP Button:** Press to tune the radio to a higher frequency or to navigate to the next track for USB, Disc or Bluetooth Streaming modes.

3. **Speaker Volume (A) Control:** Press and release to select speaker A (icon will flash). Adjust the volume of speaker A. Press and hold to mute speaker A. Press and hold again to un-mute speaker A.

4. **Volume/ Select knob:** Rotate the knob to increase or decrease the volume level.

- Press and release to select display menu 1 (BASS 0 will display). Press and release to select menu items (BASS, TREBLE, BALANCE, EQ, LOUD). Rotate knob to adjust selected item.

- Press and hold to select display menu 2 (CLOCK 12 will display). Press and release to select menu items (CLOCK, P-VOL, CT-INDEP, AREA, DX/LO, STEREO/MONO). Rotate knob to adjust selected item.

**Note1:** P-VOL is the volume the radio will be at when you turn the radio on.

**Note 2:** CT-INDEP is for setting the clock time. CT-INDEP is manual mode and CT-SYNC synchronizes with the signal from an FM radio broadcast. If the radio station does not broadcast this signal, the clock will be inaccurate in this mode.

5. **Speaker Volume (B) Control:** Press and release to select speaker B (icon will flash). Adjust the volume of speaker B. Press and hold to mute speaker B. Press and hold again to un-mute speaker B.

6. **IR Sensor Window:** Point the remote control at this location to control the radio. IR transmission is line-of-sight.

7. **Disk Slot:** Insert DVD or CD discs with the label facing up. Play will start automatically.

8. **LCD Display Area:** Displays all functions and operation of this multi-media device.

9. **Phone Pickup Button:** When the phone rings, press and release this button to answer the call.

10. **(DISP) Display button:** Press and release to toggle between source and clock display. Press and hold to enter clock setting mode.

11. **Power On/Off/Mute:** Press and release to turn the unit on. With the unit ON, press and release to Mute and un-mute all speakers. Press and hold to turn the unit off.

12. **EQ Control:** Press and release repeatedly to select 1 of 5 preset sound settings.

13. **Disk Eject Button:** Press and release to eject the DVD or CD disk.

## Getting Started (continued)

14. **USB Port:** Slide door from left to right to expose the USB port. Insert a USB drive to play music.

15. **AUX-IN 1 Audio port:** Plug in any external sound device using a 3.5mm audio cable.

16. **Mode Button:** Press and release repeatedly to select 1 of 5 input sources.

17. **Phone Hang-up Button:** Press and release to end a call or to reject an incoming call.

18. **Microphone:** This is the microphone used for the phone function.

19. **6/DIR+ Button:** Press and release to recall the #6 pre-set radio station or search ahead in the DISK or USB mode. Press the hold to memorize a new radio station to the button.

20. **5/DIR- Button:** Press and release to recall the #5 pre-set radio station or search back in the DISK or USB mode. Press the hold to memorize a new radio station to the button.

21. **4/RDM Button:** Press and release to recall the #4 pre-set radio station or turn RANDOM search on/off in the DISK or USB mode. Press the hold to memorize a new radio station to the button.

22. **3/RPT Button:** Press and release to recall the #3 pre-set radio station or toggle between REPEAT ALL or REPEAT ONE in the DISK or USB mode. Press the hold to memorize a new radio station to the button.

23. **2/INT Button:** Press and release to recall the #2 pre-set radio station or turn on/off INTRO playback in the DISK or USB mode. Press the hold to memorize a new radio station to the button.

24. **1/Play-Pause Button:** Press and release to recall the #1 pre-set radio station or control PAUSE or PLAY in the DISK or USB mode. Press the hold to memorize a new radio station to the button.

25. **BAND Button:** Press and release repeatedly to select one of three FM radio band or two AM radio bands.

26. **Seek DOWN Button:** Press to tune the radio to a lower frequency or to navigate to the previous track for USB, Disc or Bluetooth Streaming modes.

## M3039 General Operations

### Power On/Off/Mute

Press /MUTE button to turn on the unit. When the unit is on, short presses will mute / unmute both Speaker Zone A and Speaker Zone B. Press and hold this button to turn off the unit.

### Sound and Setting Adjustments

#### Repeatedly press VOL button for the audio menu:

BAS(Bass)->TRE(Treble)->BAL(Balance)  
->EQ(class/rock/pop/flat/off)->LOUD(on/off)

#### Press and hold VOL button for the setting menu:

CLK(12/24)->BEEP(on/off)-P\_VOL(preset VOL)  
->CT(indep/sync)->AREA(AUS/USA)  
->DX/LOC->STEREO/MONO

Rotate the **VOL** knob to adjust levels and make selections within each setting.

### CT INDEP / SYNC

**CT INDEP:** The clock works independently.

**CT SYNC:** The clock will be synchronized to the received RDS station's time.

**Note:** When the time is set manually, the CT automatically goes to INDEP mode.

**CLOCK 12/24:** Sets the time to 12 hour or 24 hour format.

**BEEP (ON/OFF):** Turns the beep sound on/off.

**P-VOL (Preset VOL):** Sets the power on volume. If the volume at shutdown is quieter than a set P-VOL, the next time the unit is turned on the volume will be maintained to that quieter shutdown volume. If the volume at shutdown is louder than the set P-VOL, the units volume will be restored to the quieter P-VOL next time the unit is turned on.

**AREA (AUS/USA):** Chooses USA or Europe frequency.

### DX/LOC (Distance/Local):

**LOC:** Receive only strong signal stations in seek mode.

**DX:** Receive strong and weak signal stations in seek mode.

### STEREO/MONO:

**STEREO:** Receive FM stereo signal.

**MONO:** Change FM stereo to monophonic, to help reduce noise in weak radio signals.

### Zone A and Zone B Operation

Press Zone A or B button to independently control the volume of that zone. Rotate the **VOL** knob to adjust the volume level. After 5 seconds of inactivity, both Zone A and B volume will again be adjusted jointly.

Press and hold Zone A or Zone B button for 2 seconds to MUTE on/off that selected zone.

### Information or Clock Priority Operation

Press the **DISP** button to switch to clock priority or information priority.

**Note:** In FM mode, the radio station name is shown by default for RDS stations. To switch to clock or frequency display press the **DISP** button.

### Manual Clock Setting

Press and hold the **DISP** button until HH flashes on the display. Rotate the **VOL** knob to set the hour. Then press **SEL/DISP** button until MM flashes in the display. Rotate the **VOL** knob to set the minutes. Press **SEL/DISP** button to exit.

**Note:** When the clock is set, the CT will go back to INDEP mode automatically.

### Reset Function

Press the reset button to return radio back to factory settings. All stored presets will not be saved.

### AUXIN 1/AUXIN 2 Operation

Press the **MODE** button to switch to **AUX IN 1/AUX IN 2**. AUX IN 1 is used for 3.5mm jack connected device and AUX IN 2 is for an RCA connected device.

### ARC (Audio Return Control) Function

Run a TV set's sound through the M3039 connected speakers by connecting the TV to the back of this unit with an HDMI cable. Press the **MODE** button to switch to HDMI ARC mode.

**Note:** The HDMI connector on the TV must support the ARC function.

### RCA / HDMI Output

RCA output is located on the back of the unit. Refer to the wiring diagram in this manual for connecting. The HDMI port can also be used to connect a TV set. (The TV settings will need to be set to HDMI source.)

## Radio Operations

### Receiving Radio Stations

Press **MODE** button to select FM/AM source. Next, press the **BAND** button to select desired band AM1 or 2 or FM 1, 2 or 3. Short presses of either or button will seek to the nearest reachable radio frequency. Press and hold to manually find a desired station.

### Manually Storing Stations & Recalling Preset Stations

Tune into a desired station and press and hold one of the preset buttons (1-6) for 2 seconds. The current station will be stored into that number buttons memory and then can be recalled with a short press of that button.

### Auto Storing Stations

Press and hold the **BAND** button for 2 seconds to auto scan and store AM 1, 2 and FM 1, 2, and 3 stations into numeric buttons, 1-6.

## DISC / USB Operations

When a DISC or USB device is inserted into the unit, the unit will play a song automatically. If a DISC or USB device is already inserted into the unit, press the **MODE** button to switch to either the DISC/USB desired mode.

### File / Track Selection

Press / button to skip to next/previous track. Press and hold / button to fast forward or fast reverse through the track.

### Pausing the Audio

Press the button to pause the audio file. Press again to resume playback

### Intro playing

Press **INT** button to play first 10 seconds of each track. Press again to stop this function.

### Repeat

Press **RPT** button to select RPT ONE/ALL mode.

### Random

Press **RDM** button to on/off playing tracks from a playlist in random order.

### Directory+/- function (for MP3/WMA only)

Press **DIR+ / DIR-** button to select next/previous folder to play.

## Track Search - 2 Search Methods: Directory Search and Number Search.

### 1) Directory search:

Pressing and holding the **BAND** button for 2 seconds will display "DIR SCH". Rotate the **VOL** knob to navigate to a desired folder and press the **SEL** knob to select it. Rotate the **VOL** knob again to select a specific track and press the **SEL** knob again to play it. (Press button to navigate back to a previous folder.)

### 2) Number search:

Pressing and holding the **BAND** button for 2 seconds twice will display "NUM SCH". In this mode, you can directly select the track number by pressing the numeric buttons on the unit: 0-9 (EQ=7, =8, =9, DISP=0). You also can rotate the **VOL** knob to select the track number. With the desired track selected, press **SEL** to play.

### Video/Photo/Music Selection

Short press the **MODE** button to switch between MUSIC->VIDEO->PHOTO. Press the button to play/display.

### CAUTION

Magnadyne is not responsible for any DISC or USB device stored files that are lost due to user operational errors.

## Bluetooth Operation

### Pairing Bluetooth Devices

With Bluetooth activated from the settings on your mobile phone, select "LINEAR SERIES" after your phone scans for available devices. If a password is requested, enter "0000". When the mobile device is successfully paired, the BT icon will appear on the units display. **Note:** Do not try to pair to "LS APP"

### Answering / Rejecting an Incoming Call

Press the key to answer the coming call. Press key to reject or hang up the call.

### Dial a call

Use your mobile phone to dial out.

### Bluetooth Audio

Press the BT button on the unit to switch to BT MUSIC source. Queued music from your mobile device will automatically begin playing. Press the button to pause/play the track. Press the / button to select next/previous track.

### Disconnect the Bluetooth

To disconnect your paired phone from the unit, press the button. Press and hold again to reconnect.

## AUX 1 / AUX 2 Operation

### Selecting the Audio Source:

**Note:** The M3039 does not control AUX connected devices, it just allows the audio to be played through the system.

### Front Audio Input:

Insert the 3.5mm jack from the audio device into the AUX input socket on the front of the unit. Press the **AUX** button until "AUX 1" appears in the display. Refer to the audio device's owner's manual for proper operation.

### Rear Audio Input:

To select the rear RCA connected audio play source, press and hold the **AUX** button until "AUX 2" appears in the display. Refer to the audio device's owners manual for proper operation.

**Note:** The volume setting of the connected audio device has an effect on the overall loudness of the M3039.

## Video In / Out Function

There is a V-IN and a V-OUT 2 connector behind the unit. The V-IN connector is directly connected passthrough to the V-OUT 2 connector, so you do not need to operate the unit for V-IN/V-OUT 2 function. The V-OUT 1 is for Video out from the radio's DVD player.

## Remote Control Locations and Functions

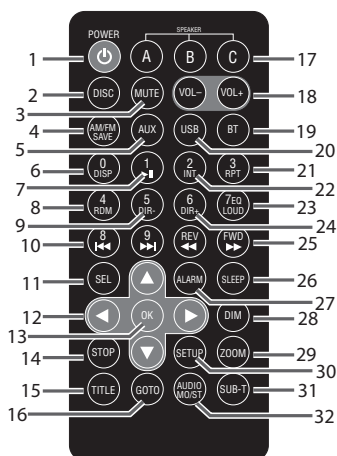

## HDMI Arc Function

The radio's HDMI output supports the **ARC (Audio Return Channel)** feature and will allow audio from the TV set to be played through the radio without additional connection cables. ARC is a relatively new feature and not all TV sets will have it available. In these cases, the HDMI connection from the radio will only deliver video signal to your TV set. If your TV's HDMI input connection supports ARC, it will be identified as HDMI (ARC). In some cases, TV's with HDMI (ARC) input may require some activation of the ARC feature through the TV's setting menu. Check your TV user manual.

1. To play sound from the TV through the radio speakers, use the **MODE** button to select "HDMI ARC on the radio (You must eject any disk that is inside the radio) and the display will read HDMI ARC. Wait a few seconds for the system to handshake and the TV sound will play through the radio speakers. Volume level of the radio speakers is controlled at the radio.
2. If you change the source on the radio (go back to FM radio for example) the TV will stop and the alternate source will play through the radio speakers.
3. If you want to play the radio's DVD sound through the TV speakers only, you can lower the sound at the radio and turn up the sound of the TV speakers.

1. **Power On/Off Button (⏻):** Press to turn the unit on or off.
2. **DISC Button:** Press to access disc mode.
3. **Mute Button:** Press to mute audio.
4. **AM/FM, Save Button:** Press to select the radio mode. Sequential presses will select radio band: FM1, FM2, FM2 (MHz) and AM1, AM2 (KHz). Press and hold for automatic radio station memory storing.
5. **AUX Button:** Press to select between AUX IN and AV IN1.
6. **Display Button (DISP):** Press to toggle through the available display information. Press and hold to access clock setting function.

## Remote Control Locations and Functions (continued)

7. **Play/Pause and Mute Button (⏮|⏭):**
  - Disc:** Press to pause DISC/USB play, press again to resume play.
8. **Random Button:** Press to play tracks in random order in DISC/USB mode.
9. **DIR- Button:** Press to navigate back through directories in DISC/USB mode.
10. **Down ⏮, Up ⏭ Buttons:**
  - Radio Mode:** Press to seek/select next available lower or higher radio frequency.
  - DISC/USB Mode:** Press to search for the beginning or next track or chapter.
11. **SEL Button:** Short press to access sound adjustment settings: BASS, TRE, BAL, EQ, and LOUD and settings BEEP ON/OFF and 12/24 CLOCK. Long press to access AF ON/OFF, TA ON/OFF, radio genre settings, REG ON/OFF, P-VOL, AREA selection, DX/LOC, STEREO/MONO.
12. **Navigation Buttons (▲, ▼, ◀, ▶):** Moves feature selection up, down, left or right.
13. **OK Button:** Executes a selected item.
14. **Stop Button:** Press to stop disc play.
15. **TITLE Button:** Back to title menu in DVD DISC mode.
16. **GOTO Button:** Select exact time, track or chapter in DVD DISC mode.
17. **Speakers A, B, C Buttons:** Press to select speakers to adjust independently or in groups. Press and hold any of the 3 buttons to mute the selected speakers. Press and hold again to resume the sound.
18. **Volume Buttons (VOL ▲ / VOL ▼):** Press **VOL ▲** to increase or **VOL ▼** decrease the volume level. Use these button to adjust manual sound settings up and down or when selecting ON/OFF settings.
19. **BT Button:** Press to enter Bluetooth mode and access files off bluetooth connected device.
20. **USB Button:** Press to enter USB mode and access files off USB connected device.
21. **RPT Button:** Press to select REPEAT ONE or REPEAT ALL in DISC/USB mode.
22. **INT Button:** Press to play 1st 10 seconds of tracks in DISC/USB mode.
23. **EQ/LOUD Button:** Short press to select between EQ presets: FLAT, POP, ROCK, CLASS, EQ OFF. Press and hold to toggle between LOUD ON/OFF.
24. **DIR+ Button:** Press to navigate up through directories in DISC/USB mode.
25. **REV ◀, FWD ▶ Buttons:**
  - Radio Mode:** Press to manually tune into lower or higher radio frequency. Press and hold to rapidly move forward or back.
  - DISC/USB Mode:** Press and hold to fast forward or backward through current selected track.
26. **SLEEP Button:** Press to toggle between SLEEP ON/OFF. Press and hold to enter SLEEP time setting. Once in SLEEP time setting, the time is adjusted using the **VOL+** and **VOL-** buttons.
27. **ALARM Button:** Press to toggle between ALARM ON/ALARM OFF. Press and hold to enter ALARM time setting mode. Once in ALARM time setting, toggle between hours and minutes by again pressing the ALARM button. With either hours or minutes selected (flashing), use the **VOL+** and **VOL-** buttons to adjust to the desired time.
  - Note:** Make sure desired AM or PM is selected.
28. **DIM Button:** Press to select screen brightness: LOW, MED, HIGH or OFF.
29. **ZOOM Button:** Zoom in/out in picture mode.
30. **SETUP Button:** Press to access DVD setup menu.
31. **SUB-T Button:** Press to access the movie disc's subtitle languages.
32. **AUDIO/MO/ST Button:**
  - Radio Mode:** Select STEREO or MONO.
  - DVD DISC Mode:** Press to change audio soundtrack on a multi-audio soundtrack DVD.

## Bluetooth APP Operation

Your smartphone can be used as the remote control to your M3039 radio. Download and Install the LINEAR SERIES App.

The App can be found in the Google Play Store (Android Phones) or the App Store (Apple Phones). Search for "LINEAR SERIES". Install the App per the instructions listed and accept all permissions.

**Note 1:** Phones must have Bluetooth version 4.0 or higher

**Note 2:** Your phone must be Bluetooth paired to the M3039 prior to starting the App.

**Note 3:** In Radio Mode, the App displays radio station that were manually or automatically memorized. See instructions on page 7 under "Radio Operations" for memorizing radio stations.



LINEAR SERIES

Start the App by touching the LINEAR SERIES app Icon on your phone. Select "L.S. APP" to connect the app to the M3039 radio.

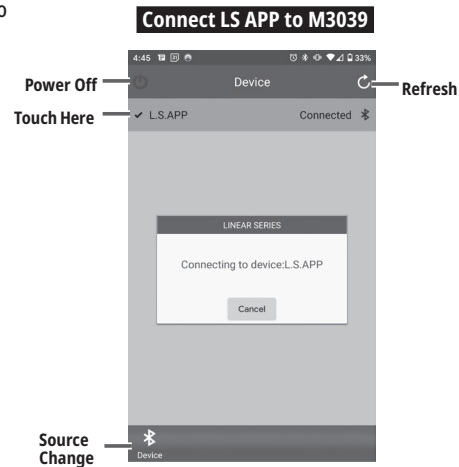

## Navigation and operation of the LINEAR SERIES APP

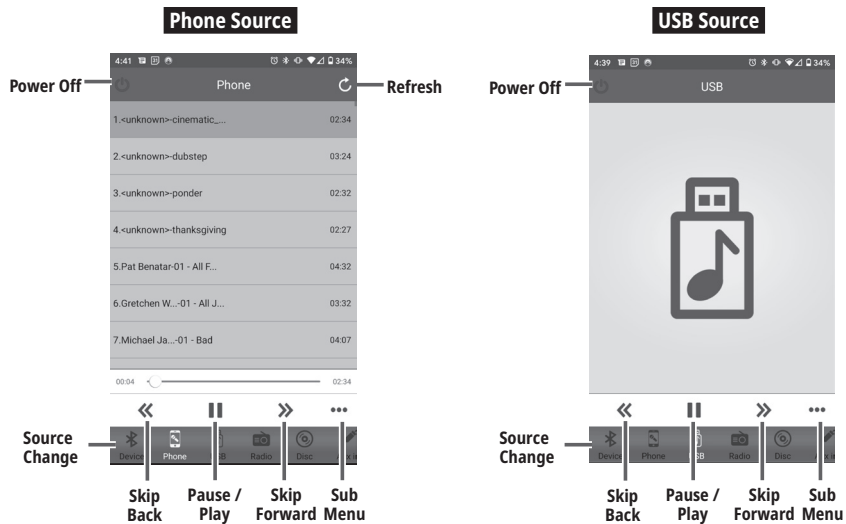

## Bluetooth APP Operation (continued)

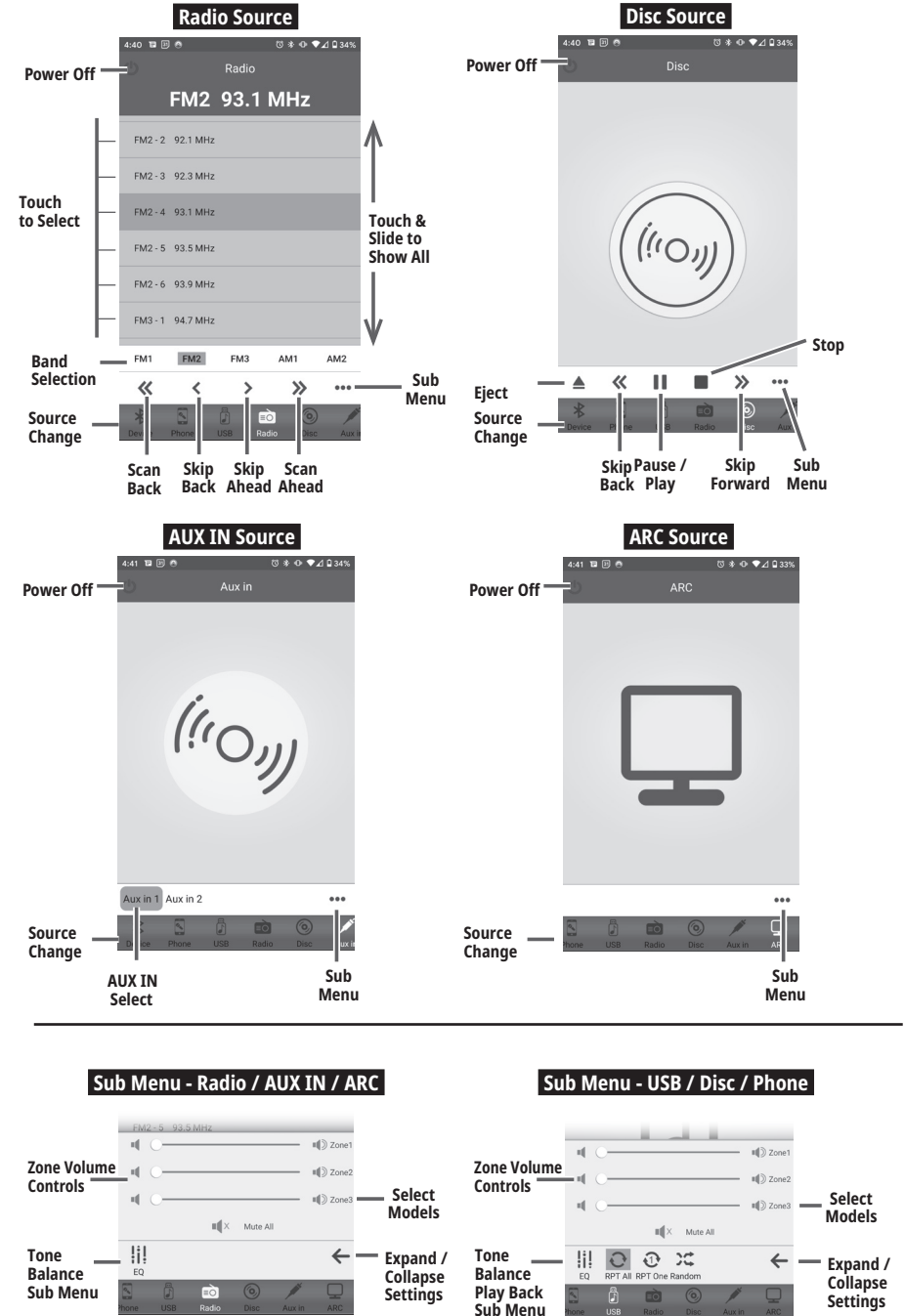

# Installation

- Read the instruction manual carefully before installing the unit
- Make sure to connect other wires before powering on the unit.
- To avoid short circuit, make sure all the exposed wires are insulated.
- Secure all wires after installation.
- Connect the player according to the wiring connection instruction on page 14 of this manual. Wrong connection may cause damage to the unit.
- This player only fit for 12V DC device.

1. Before you install the unit, completely remove the two transportation screws on top of the unit.

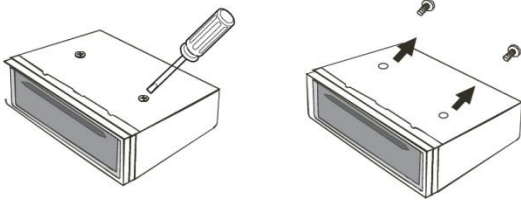

2. DIN Front Mount

1. Insert mounting sleeve into car.

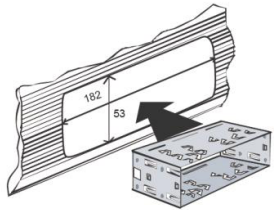

2. Bend claws to secure mounting sleeve.

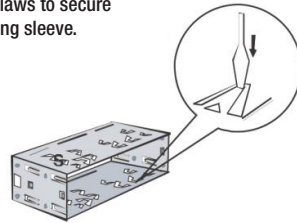

3. Insert outer trim frame to the unit.

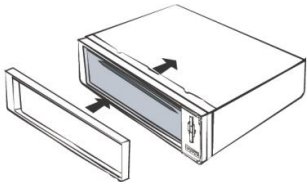

4. Insert unit into sleeve. Attach the metal strap to the back of the unit as shown. Then attach to dashboard.

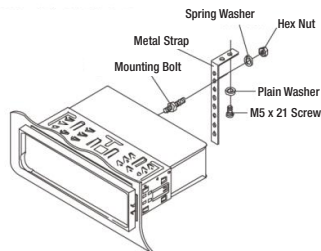

3. To remove the unit, first take off the outer trim frame.

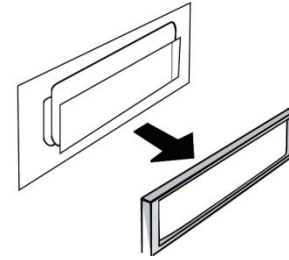

4. Insert the supplied removal keys on both sides as shown until they click. Pull the keys outward to remove the unit from the dashboard.

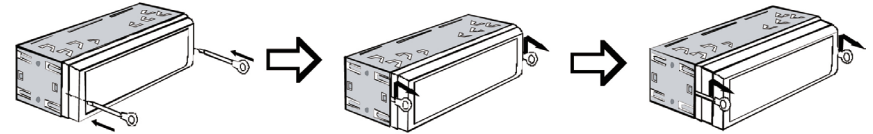

## Wiring

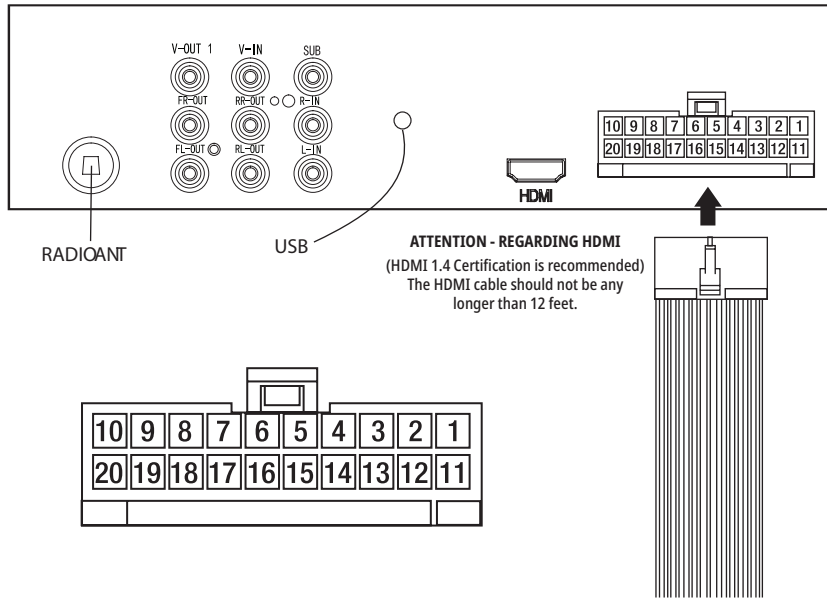

NO	WIRE COLOR	DESCRIPTION	NO	WIRE COLOR	DESCRIPTION
01			11		
02			12		
03			13		
04			14	RED	ACC
05	BLUE	AMP TURN ON	15	YELLOW	B+
06			16	BLACK	GND
07	GRAY/BLACK	SPEAKER A RIGHT -	17	WHITE/BLACK	SPEAKER A LEFT-
08	GRAY	SPEAKER A RIGHT+	18	WHITE	SPEAKER A LEFT+
09	PURPLE/BLACK	SPEAKER B RIGHT-	19	GREEN/BLACK	SPEAKER B LEFT-
10	PURPLE	SPEAKER B RIGHT+	20	GREEN	SPEAKER B LEFT+

1. This player operates on 12V DC.
2. Do not connect to the battery until the player is completely connected.
3. Make sure the yellow wire is connected to the batteries positive (+) terminal.
4. When changing the fuse, make sure the specifications are the same.
5. For the best sound from this equipment, use good quality 4-8 ohm speakers.

## Trouble Shooting

Symptom	Cause	Solution
No power.	The car ignition switch is not on.	If the power supply is connected to the car accessory circuits, but the engine is not moving, switch the ignition key to "ACC".
	The fuse is blown.	Replace the fuse.
No sound.	Volume is in minimum.	Adjust volume to a desired level.
	Wiring is not properly connected.	Check wiring connection.
The operation keys do not work.	The built-in microcomputer is not operating properly due to noise.	Press the reset button.
The radio does not work.	The antenna cable is not connected.	Insert the antenna cable firmly.
The radio station automatic selection does not work.	The signals are too weak.	Select a station manually.
APP play phone music sound can't send to unit.	Unit paired with another mobile phone.	1) Turn off the Bluetooth function of another mobile. 2) Exit APP and turn on APP again.

## Specifications

### GENERAL

Power Supply Requirements: DC 12 Volts, Negative Ground  
Chassis Dimensions: 129(W) x 112(D) x 65(H)

Tone Controls:

Bass (at 100 Hz): ±10 dB

Treble (at 10 kHz): ±10 dB

Maximum Output Power: 4 x 40 watts

Current Drain: 10A (max.)

### RADIO

	FM	AM
Frequency Coverage:	87.5 to 107.9 MHz	520 to 1710 kHz
IF:	10.7 MHz	450 KHz
Sensitivity:	4µV(S/N=30dB)	36dBuV(S/N=20dB)
Stereo Separation:	>25dB	/



## ONE (1) YEAR LIMITED WARRANTY

Magnadyne Corporation or its authorized agents will within one year from the date of sale to you, repair, replace or refund the retail sales price of said product or any part thereof, at the option of the Magnadyne Corporation or its authorized agents, if said product or part is found defective in materials or workmanship, when properly connected and operating on the correct power requirements designated for the specific product. This warranty and Magnadyne Corporation or its authorized agent's obligations hereunder do not apply where the product was; damaged while in the possession of the consumer, subjected to unreasonable or unintended use, not reasonably maintained, utilized in commercial or industrial operations, or serviced by anyone other than Magnadyne Corporation or its authorized agents, or where the warning seal on the product is broken or the power and/or plugs are detached from the unit. Magnadyne Corporation or any of its authorized agents will not assume any labor costs for the removal and reinstallation of any product found to be defective, or the cost of transportation to Magnadyne Corporation or its authorized agents. Such cost are the sole responsibility of the purchaser.

This warranty does not cover the cabinet appearance items or accessories used in connection with this product, or any damage to recording or recording tape, or any damage to the products resulting from improper installation, alteration, accident, misuse, abuse or acts of nature.

MAGNADYNE CORPORATION OR ITS AUTHORIZED AGENTS SHALL NOT BE LIABLE TO ANYONE FOR CONSEQUENTIAL OR INCIDENTAL DAMAGES OR CLAIMS EXCEPT THOSE ACCORDED BY LAW. NO EXPRESSED WARRANTY OR IMPLIED WARRANTY IS GIVEN EXCEPT THOSE SET FORTH HEREIN. NO IMPLIED WARRANTY SHALL EXTEND BEYOND ONE YEAR FROM THE DATE OF SALE.

This warranty extends only to the original purchaser of the product and is not transferable. Some states do not allow limitations on how long an implied warranty lasts, and some states do not allow the exclusion or limitation of incidental or consequential damages, so the above limitations or exclusion may not apply to you. This warranty gives you specific legal rights, and you may have other rights that vary from state to state.

**“NOTE: The manufacturer is not responsible for any radio or TV interference caused by unauthorized modifications to this equipment. Such modifications could void the User's authority to operate the equipment.”**

Defective merchandise should be returned to the original point of purchase or secondly, to Magnadyne Corporation, 1111 W. Victoria Street, Compton CA 90220.

Return Authorization must be obtained before sending, or merchandise may be refused.