

Installation Guide - Boucle Wall Panels

1. Select the desired location for your Wall Panel Piece.

Note: All panels are equipped with 2 x 19mm timber battens fixed to the back to ensure a secure fit over existing skirting board/base board.

2. Clean the wall using isopropyl rubbing alcohol, gently wiping the surface. Avoid household cleaners such as wipes or sprays, as they may leave a slippery residue.



3. Unpack the supplied 3m Command Strips*. Press two strips together until they audibly click.

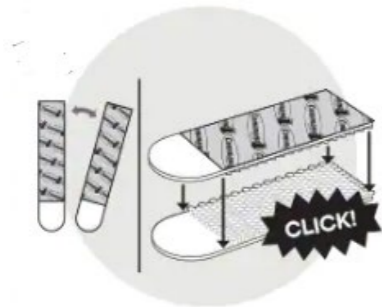

4. Remove one of the green liners and firmly press it onto the edge of the timber batten. For optimal strength, apply 2 sets on each batten horizontally (4 sets are provided).

5. Place the wall panel on the wall, ensuring the top and bottom battens are pressed firmly against the wall for 30 seconds.

6. To ensure proper adhesive bonding, remove the panel by grasping the bottom corners and peeling it up and away from the wall. Avoid pulling straight off. Subsequently, press the remaining strips on the wall for an additional 30 seconds, ensuring the entire strip is pressed.

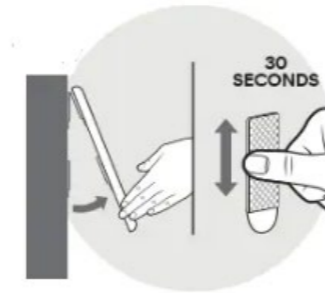

7. Allow 1 hour before reattaching the panels. Align the strips on the panel with those on the wall. Press until each pair of strips clicks and securely locks in place.

For the clean removal of 3M Command Strips*:

1. Remove the panel by grabbing the bottom corners and peeling the frame up and away from the wall. Avoid pulling straight off.

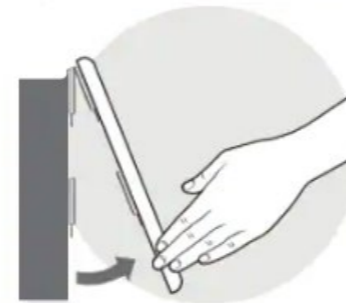

2. Never pull the strips towards you or peel them from the wall. Always pull straight down slowly. Gradually stretch the strip straight down, keeping your hand against the wall as you proceed. Continue stretching up to 15 inches for a smooth removal.

