

GOLF RACK

Assembly Instructions

CUSTOMER SERVICE

NEED ASSISTANCE?

Should you have questions regarding the instruction provided you can reach out to our awesome customer service and we'd be happy to help!

- **PHONE:** (877) 655-3443
- **EMAIL:** support@saferracks.com
- **HOURS:** **MONDAY - FRIDAY** 7:00 AM - 6:00 PM CST, **SATURDAY** 8:00 AM - 12:00 PM CST

877-655-3443 • www.SafeRacks.com

US PATENTS: D553,401 | 7,357,262 | D697,785 | 7,152,145 | OTHER PATENTS PENDING

COMPONENTS:

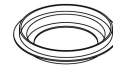

NOTE: Circular, plastic tops between shelves are used for packaging ONLY.

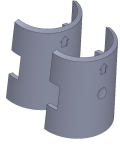

Clip Sleeves **x74**



Lower Side Attachment **x2**



Upper Side Attachment **x2**

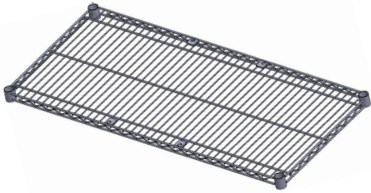

Lower Shelf **x1**



Small Shelf with Support **x2**



Small Shelf **x1**



Outer Curved Post **x2**



Outer Straight Post **x2**



Post Screws **x4** (w/Hex Key)



Inner Curved Post **x2**



Inner Straight Post **x2**



Bottle Opener **x1**



Hat Hook **x5**

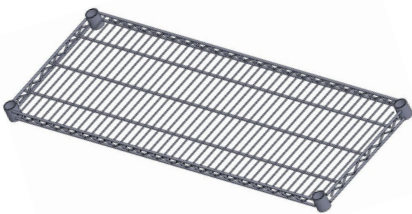

Upper Shelf **x2**



Upper Straight Post **x2**



Threaded Insert **x4**

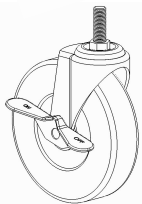

3" Caster **x4**

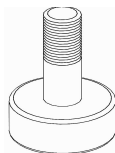

Adjustable Foot **x4**

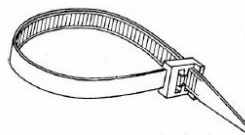

Cable Tie **x2**



Drywall Anchor and Screw **x2**

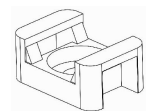

Cable Tie Base **x2**

INSTALLATION TIP:

Bring sleeves together just above the desired groove and slide down until a "click" is heard.

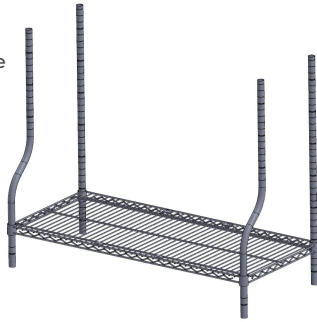
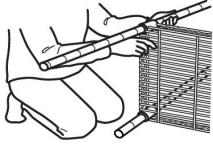

- 1 Install Outer Post to Lower Shelf:** Locate Outer Curved Post x2 and Outer Straight Post x2; these posts will not have Plastic Caps. Place Sleeves on the 3rd and 4th grooves on the bottom of the posts and install Lower Shelf. Use a rubber mallet if necessary.

INSTALLATION TIP:

Always follow directional arrows when installing clip sleeves. Arrows should point up.

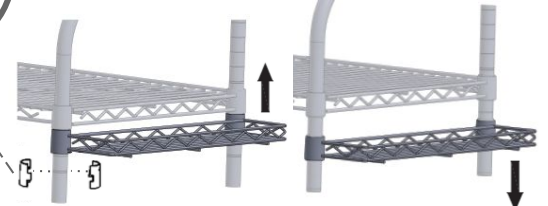
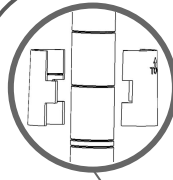

- 2 Install Lower Side Attachments:** Locate Lower Side Attachment x2. Slide Lower Side Attachment through outer posts and underneath Lower Shelf, exposing the bottom two grooves. Place Sleeves on grooves and lower attachment into place. Repeat for other side.

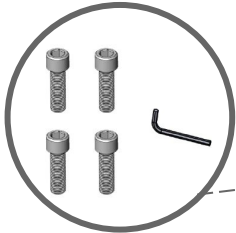

- 3 Install Inner Post to Lower Shelf:** Locate Inner Curved Posts and Inner Straight Posts; these posts have Plastic Caps. Using the post screws, install the posts to the lower shelf. Ensure the orientation of the posts are identical to the four outer posts. Ensure the top of all 8 posts are equal in height.



- 4 Install Small Shelf With Support:** Locate Small Shelf With Support. Place Sleeves at desired level on all posts and install shelf.



- 5 Install Upper Side Attachments:** Locate Upper Side Attachment x2. Place sleeves at desired level on outer posts and install attachment. Repeat for other side.



- 6 Install Small Shelf:** Locate Small Shelf. Place Sleeves at desired level on inner posts and install shelf. **Note:** If Bottle Opener is desired on bottom half of unit, install now at the desired location.



7 Install Small Shelf With Support: Locate Small Shelf With Support. Place Sleeves at the top of all posts and install shelf.



8 Install Casters/Adjustable Feet: Locate Caster x4 or Adjustable Feet x4. Place unit on side and install Casters or Adjustable Feet into bottom of outer posts. **Note:** if upper shelf is not desired, install plastic caps on upper opening of all posts.

COMPLETE IF UPPER SHELF IS NOT DESIRED // CONTINUE IF UPPER SHELF IS DESIRED

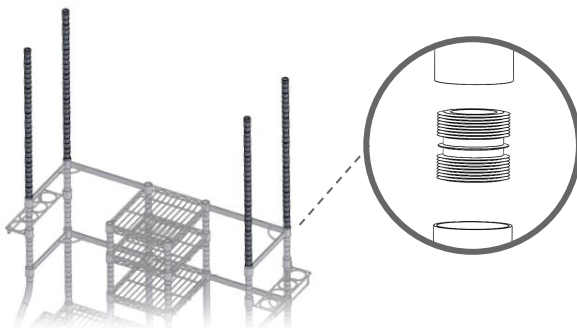

9 Install Upper Posts: Locate Upper Straight Post x4 and Threaded Inserts x4. Using the Threaded Inserts, install the Upper Straight Posts into the outer base posts. **Note:** If Bottle Opener is desired on top half of unit, install now at the desired location.

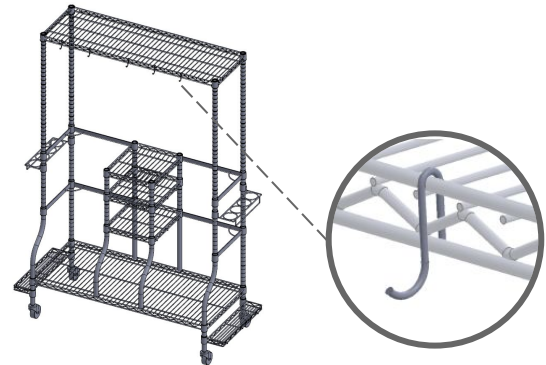

10 Install Upper Shelf: Locate Upper Shelf. Place Sleeves on top of upper posts or at desired level and install shelf. **Note:** Install Hat Hooks in desired locations on upper shelf.

Secure Golf Rack to a Wall: If you wish to secure your Golf Rack to a wall, mark the location where your rear posts will be secured to the wall.

1) Drive the plastic drywall anchor until the anchor is flush against the wall. 2) Secure the cable tie base to the wall by inserting the metal screw into the plastic anchor and tightening.

Repeat for the second cable tie base. Once both mounts are secured, use the provided cable ties to secure both rear posts to the wall.

