

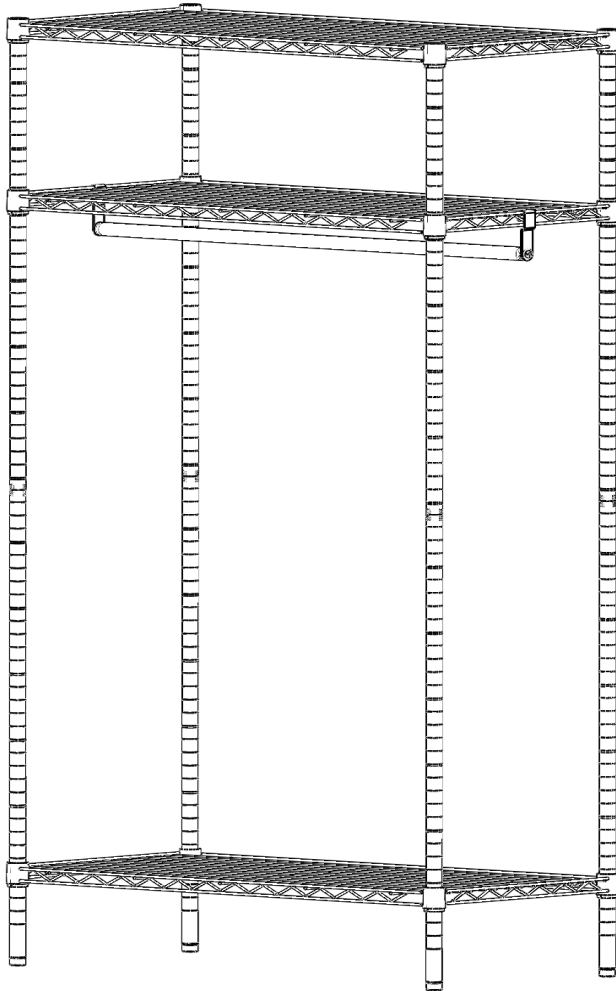

18" x 36"

Garment Rack

Assembly Instructions



**200LB CAPACITY
PER SHELF**

**175LB CAPACITY
ON HANGER ROD**

**© 2020 Copyright
Eagle Industrial Group Inc.**

US Patents D553,401 / 7,357,262 / D697,785 /
7,152,145. Other Patents Pending

Limited Lifetime Warranty

WARNING:

This product can expose you to chemicals including lead, which is know to the State of California to cause cancer and birth defect or other reproductive harm. For more information, go to:

www.P65Warnings.ca.gov

Components:

Upper Post (x4)

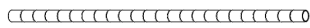

Lower Post (x4)



Hanger Rod (x1)

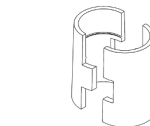
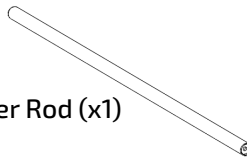

Sleeve Pair (x12)



Top Cap (x4)

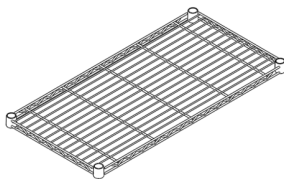

18"x36" Shelf (x3)

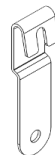

Hanger Rod
Hook (x2)



Hanger Rod
Screw (x2)

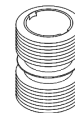

Threaded Insert (x4)

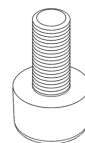

Adjustable Foot (x4)

877-655-3443 / www.SafeRacks.com

SafeRacks®

1.

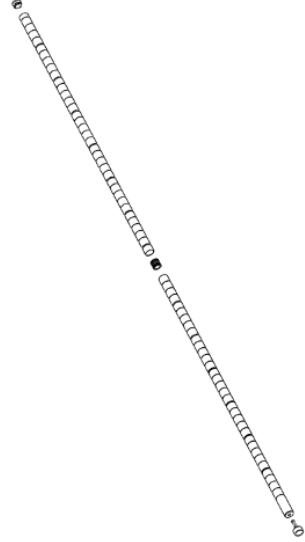

Assemble post by using threaded insert to connect upper post to lower post. Place top cap on upper post and threaded foot on lower post. Repeat for all 4 posts.

2.

*Position sleeves slightly above the notch, then compress and lower until secured to desired notch.

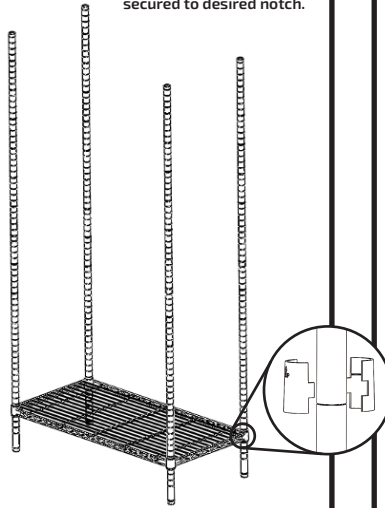

Connect sleeve pairs to the bottom of each post and ensure they are of equal height. Slide lower shelf over post and secure to a snug fit. (NOTE: A rubber mallet can be used to ensure the shelves are tight.)

3.

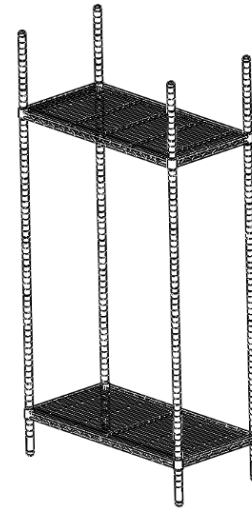

Repeat for second shelf at desired height. (Note: The second shelf will be used to secure the hangar rod.)

4.

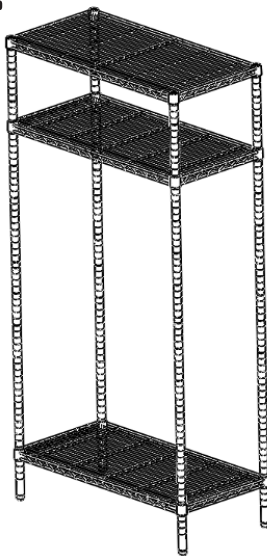

Connect sleeve pairs to the top of each post and ensure they are of equal height. Slide top shelf over post and secure to a snug fit.

5.

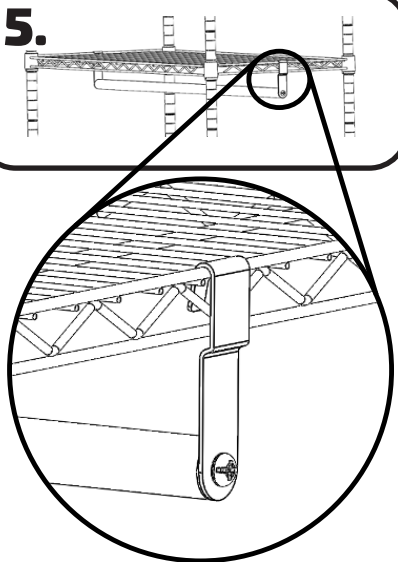

Position hanger rod hooks at desired location and secure by hooking to the outside of the shelf. (NOTE: It may be easier to assemble the hanger rod hooks to the hanger rod beforehand.)

6.

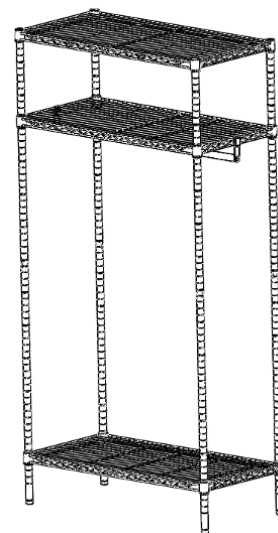

NOTE: The second shelf can be installed in a number of configurations (i.e. towards the top or the bottom of the garment rack) based on your preference.

