

SafeRacks® Bin Rack - Assembly Instructions

Holds **50lb**
Per Bin!

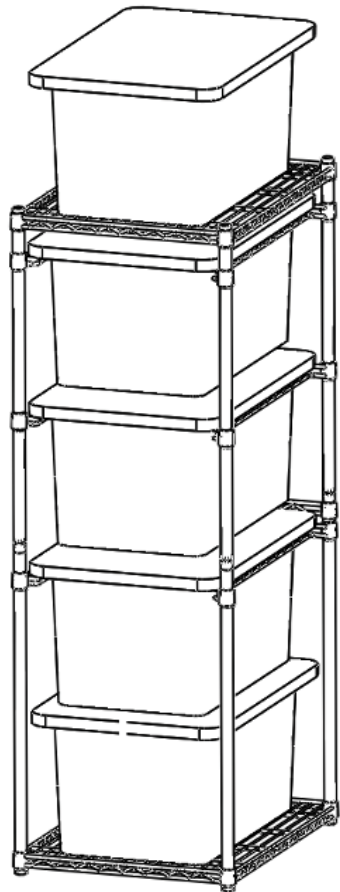

Bins NOT Included

Components:

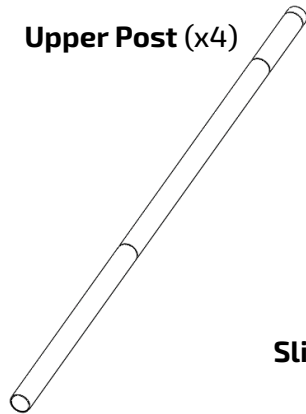

Upper Post (x4)

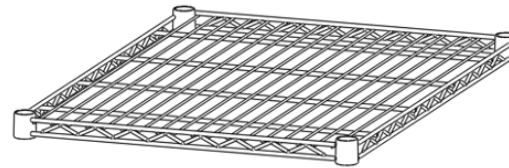

Upper/Lower Shelf (x2)

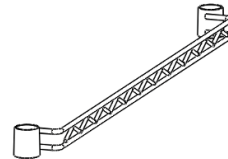

Sliding Rail (x6)

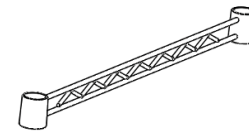

Tie Support (x1)

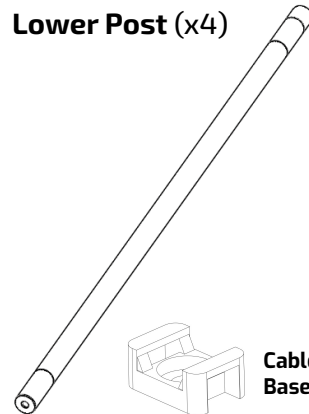

Lower Post (x4)

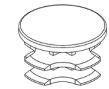

Top Cap (x4)

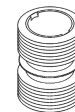

Threaded Insert (x4)

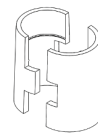

Sleeve Pair (x22)

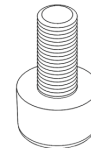

Threaded Foot (x4)

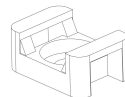

Cable Tie Base (x2)

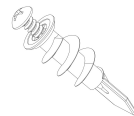

Drywall Anchor & Screw (x2)

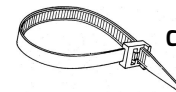

Cable Tie (x2)

*Screwdriver required - not included

WARNING:

This product can expose you to chemicals including lead, which is known to the State of California to cause cancer and birth defects or other reproductive harm. For more information, go to: www.P65Warnings.ca.gov.

©2021 Copyright Eagle Industrial Group Inc.

US Patents D553,401 / 7,357,262 / D697,785 / 7,152,145. Other Patents Pending.

Limited Lifetime Warranty U.S. Only. If you have any questions, please visit our website or give us a call at:

877-655-3443
www.SafeRacks.com

WARNING



Children have died from furniture tipover. To reduce the risk of furniture tipover:

- ALWAYS install tipover restraint provided.
- NEVER put a TV on this product.
- NEVER allow children to stand, climb or hang on drawers, doors, or shelves.
- NEVER open more than one drawer at a time.
- Place heaviest items in the lowest drawers.



This is a permanent label. Do not remove!

SafeRacks®

NOTE: This product holds 50 lbs per bin. Store heavier bins towards the bottom, and never load a bin with more weight that you can safely raise above your head. Our design is for use with 27 gallon bins only. Do not use with anything other than 27 gallon bins. Ensure the sides of the bin are properly secured before sliding in and out.

1.

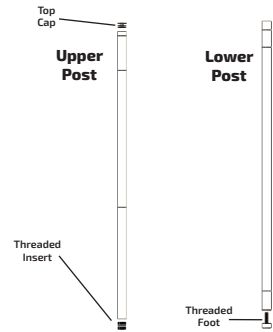

Before you begin, you may choose to assemble the posts fully, but this is not required. These instructions show the post assembly in **Step 5**.

2.

*Position sleeves slightly above the notch, then compress and lower until secured to desired notch.

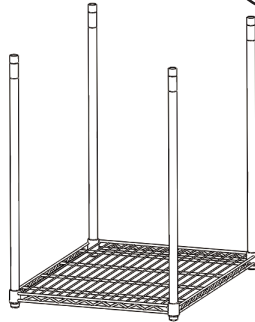

Connect sleeve pairs to the lowest notch on each post. Slide lower shelf over post and secure to a snug fit. (Note: A rubber mallet can be used to ensure the shelf is tight.)

3.

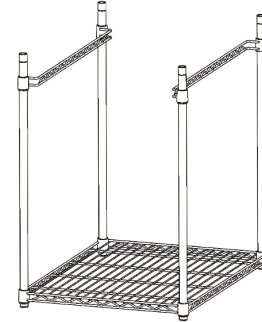

Connect sleeve pairs to the notches above those in **Step 2** and ensure they are of equal height. Place sliding rails on each side and secure to a snug fit.

4.

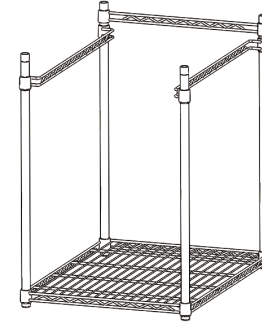

Connect sleeve pairs to the next set of notches. Slide tie support over and secure to a snug fit. (Note: The two notches at the top of the lower-front posts are not used.)

5.



Attach upper posts to lower posts using the threaded insert. (Note: This step can be skipped if you have already assembled the posts.)

6.

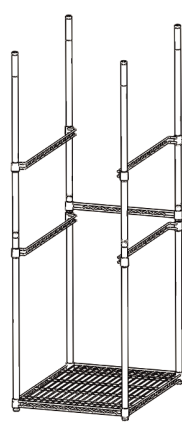

Connect sleeve pairs to the marked notches near the middle of the upper posts. Place sliding rails on each side and secure to a snug fit. Repeat for remaining sliding rails.

7.



Connect sleeve pairs to the top of each post and ensure they are of equal height. Slide upper shelf over and secure to a snug fit.

8.

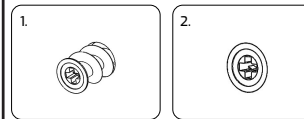

A. To secure your rack against a wall, drive the plastic drywall anchor until the anchor is flush against the wall. Secure the cable tie base to the wall by inserting the metal screw into the plastic anchor and tightening. Do not over tighten.

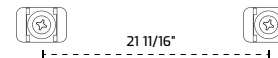

B. Repeat the steps above ensuring that the center-center distance is 21 11/16". Once both mounts are secured, use the provided cable ties to secure the rear vertical posts to the wall.

