



**HAVING QUESTION WITH WOOLAB?**

**WE CAN HELP!**

Woohlab  
[www.woohlab.com](http://www.woohlab.com)

Contact us at [support@woohlab.com](mailto:support@woohlab.com)  
Our team of experts can help you resolve any issues.



# Painter Light

## User Manual



Scan QR code for  
product usage video



# Directions for Use

## Step 1: Plug in the painter light

Connect the light's cable to the control box. And when you connect to the light 1 port, the APP will be able to control the light 1. Next, connect the adapter cable to the port on the control box and plug the other end into a power outlet. When plugged into an outlet, the power indicator light will turn blue.

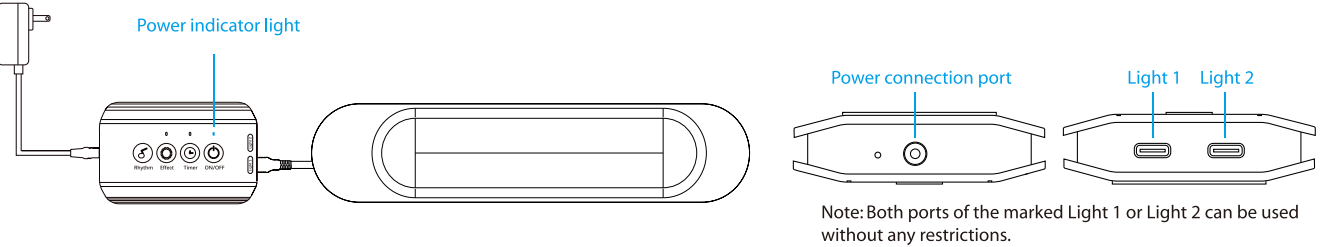

## Step 3: Download the Woohlab app

Download the Woohlab app on your smartphone and create an account.



IOS: Download the Woohlab app on App Store.  
Andorid: Download the Woohlab app on Google Play.



## Step 2: Light it up

Press the Power button to turn on the light.

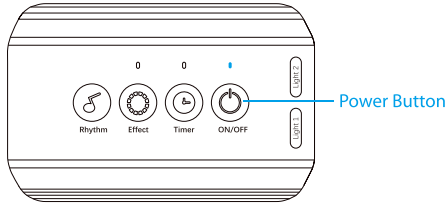

## Step 4: Connect the device to the Woohlab app

Follow the steps in the Woohlab app to connect your device. Your phone's Bluetooth must be turned on to find and properly connect to the light.

Note: If you can't connect to the device, press and hold the Power Button until the power indicator light flashes 3 times. This will reset the Bluetooth pairing setting.

Next, press the Rescan link on the Woohlab app to start reconnecting the device.

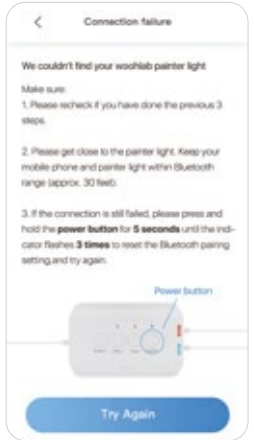

# Buttons Control

### MIC

In the music rhythm mode, the built-in microphone will collect sound signals from music played nearby. The device will then display light effects according to the rhythm of the music.

### Rhythm

Press the Rhythm button to enable music rhythm mode. When the device is placed next to a music player, the light effects will follow the beat of any audible music.

### Timer Indicator

When the timer function is turned on, the timer indicator will light up.

### Power Indicator

The power indicator will light up blue when the light is plugged in.

### Power Button

Press the Power button to power on /off the device.

### Timer Button

When the Timer button is pressed, the painter light will automatically turn off after 1 hour. You can also modify the default timing setting (1 hour) in the Woohlab app.

### Effect

Press the Effect button to change light effects.

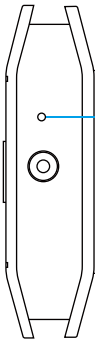

### Reset Hole

Insert a paperclip into the hole and press and hold the button for 5 seconds. This will restore the device to factory settings.

# App Control Functions

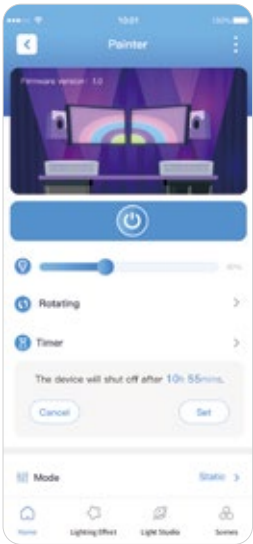

**Rotating:** To adjust the direction of the painter light rotation, select either [Positive](#) or [Negative](#) or choose to keep the light [Static](#). The rotating speed can also be adjusted.

**Timer:** Adjust the Timer setting. For example, if you select “1 hour” and then “[Save](#),” the timer indicator on the control box will light up, and the painter light will automatically turn off after 1 hour.

To modify this time setting, select “[Set](#)”. To turn off the timer function, select “[Cancel](#)”.

**Mode:** Choose your favorite light mode. Options include Static, Breathe, Marquee, Gradient, and Rhythm.

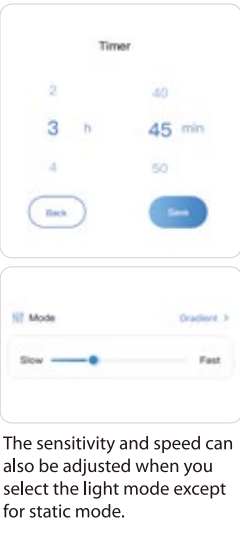
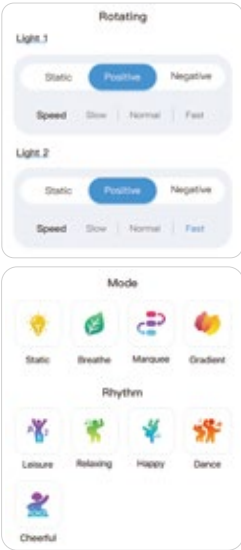

The sensitivity and speed can also be adjusted when you select the light mode except for static mode.

## Painter Light Color Setting :

You can choose any light color from the [Basic colors](#) and [My colors](#) options.



**Basic colors:**  
Red, Green, Blue and Warm White.



**My colors:**  
You can add your favorite colors from the [Color Wheel](#) into [My colors](#).

## Save the Painter Light Effect Settings



Once you finish customizing the painter light effect settings, you can save and name the customization.

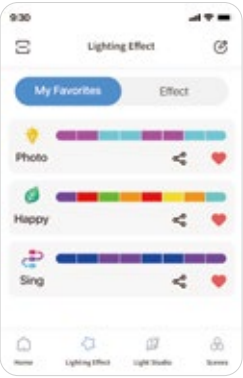

The saved lighting effect can be found under [My Favorites](#) in [Lighting Effect](#).

## Create a Scene

You can customize the start and end times of the light by creating a scene. Select from effects in [Effect](#) or [My Favorites](#) to choose lighting for your scene.

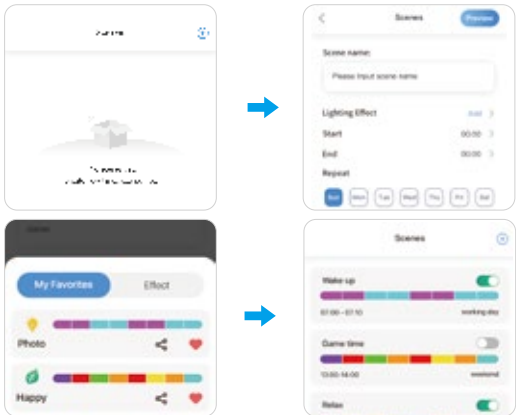

## Share the Painter Light Effect

To save and share custom light effect settings, select “[Share](#)”. You’ll be prompted to name the setting, and then the effect will be saved in [My Favorites](#) within [Lighting Effect](#) on the mobile app. The settings will also be automatically shared to the [Light Studio](#).

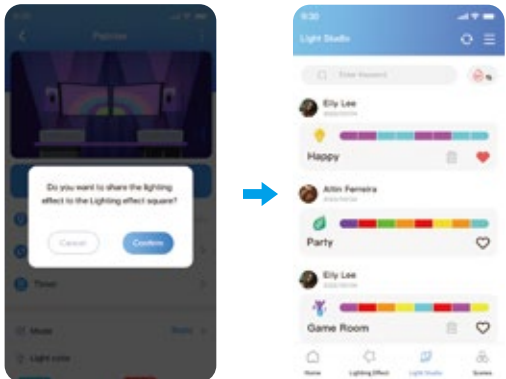

## Share Your Lighting Effect With Friends

Generate a QR code for your lighting effect and save it to your mobile phone. Your friend can then scan the QR code you shared and apply the lighting effect to their own light.

### Statement

This device complies with part 15 of the FCC Rules. Operation is subject to the following two conditions: (1) This device may not cause harmful interference, and (2) this device must accept any interference received, including interference that may cause undesired operation.

NOTE: This equipment has been tested and found to comply with the limits for a Class B digital device, pursuant to part 15 of the FCC Rules. These limits are designed to provide reasonable protection against harmful interference in a residential installation. This equipment generates, uses and can radiate radio frequency energy and, if not installed and used in accordance with the instructions, may cause harmful interference to radio communications. However, there is no guarantee that interference will not occur in a particular installation. If this equipment does cause harmful interference to radio or television reception, which can be determined by turning the equipment off and on, the user is encouraged to try to correct the interference by one or more of the following measures:

- Reorient or relocate the receiving antenna.
- Increase the separation between the equipment and receiver.
- Connect the equipment into an outlet on a circuit different from that to which the receiver is connected.
- Consult the dealer or an experienced radio/TV technician for help.

Warning: Changes or modifications not expressly approved by the party responsible for compliance could void the user's authority to operate the equipment.

The distance between user and products should be no less than 20cm.

FCC ID 2A6UYWX001